

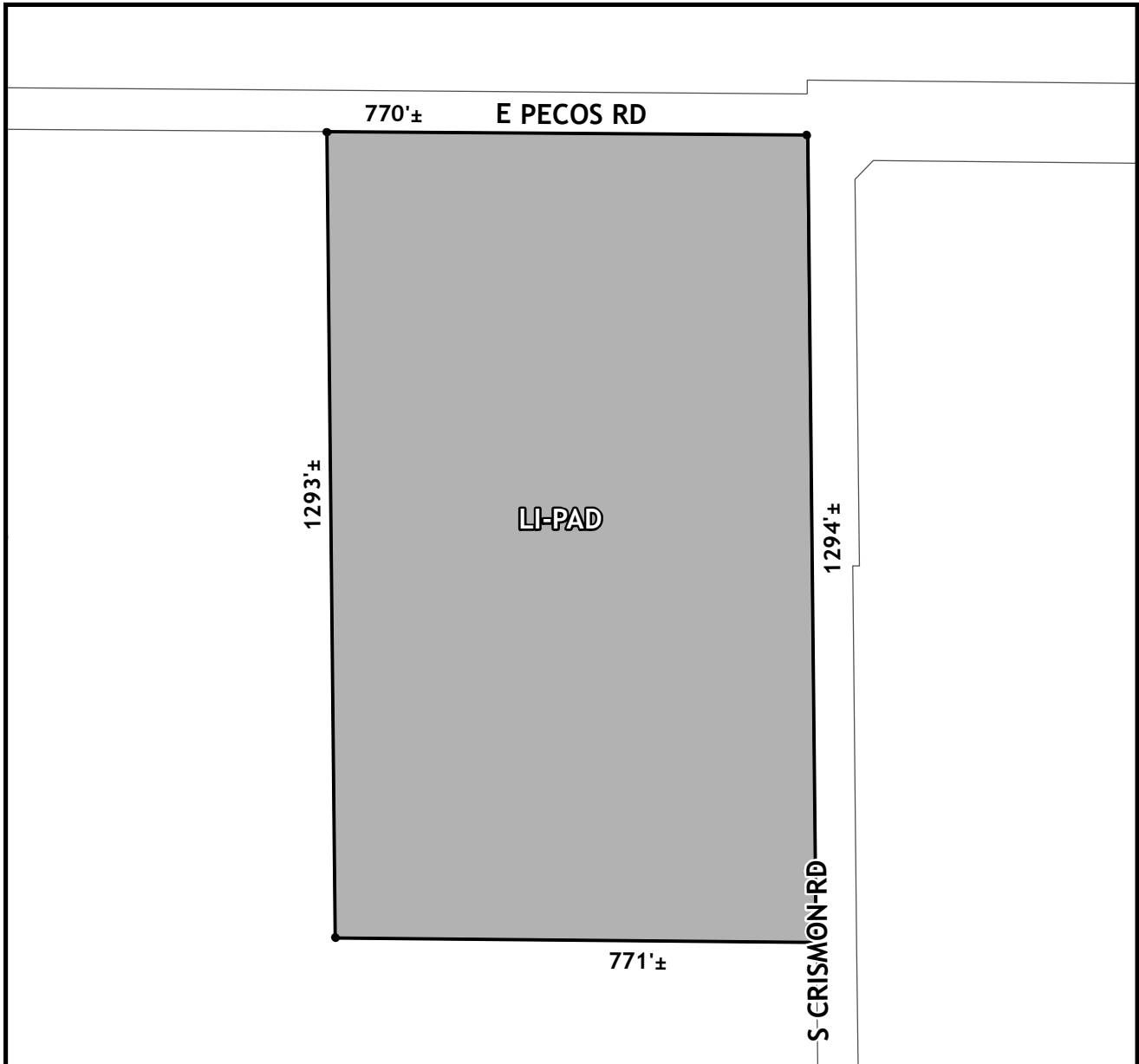

OFFICIAL SUPPLEMENTARY ZONING MAP  
AMENDING THE CITY OF MESA ZONING MAP



CASE: ZON24-00474  
 ACREAGE: 22.4±  
 REQUEST: Rezone from Light Industrial (LI) to Light Industrial with a Planned Area Development overlay (LI-PAD) and Site Plan Review.

**ORDINANCE: 5908**

Please be advised that the attached zoning changes were approved by the Mesa City Council on December 9, 2024 by Ordinance # 5908. If you have any questions concerning these changes, contact the City of Mesa Planning Division at 480-644-2385.

\_\_\_\_\_ ATTEST: \_\_\_\_\_ DATE: \_\_\_\_\_  
 MAYOR CITY CLERK