

PROJECT DATA		
PROPOSED ZONING	LI WITH A PLANNED AREA DEVELOPMENT OVERLAY AND COUNCIL USE PERMIT	
APN#	313-25-962	
FLOOD ZONE	ZONE X	
GROSS SITE AREA	7,561,330 SF	173.584 AC
TOTAL BUILDING AREA	2,257,581	51.83 AC
BUILDING COVERAGE	15%	
LOT COVERAGE (IMPERVIOUS SURFACES)	54.50%	
COMMON SPACE REQUIRED		
DC1	399,753 SF @ 1%	3,997 SF
DC2	309,638 SF @ 1%	3,096 SF
DC3	309,638 SF @ 1%	3,096 SF
DC4	309,638 SF @ 1%	3,096 SF
DC5	309,638 SF @ 1%	3,096 SF
DC6	309,638 SF @ 1%	3,096 SF
DC7	309,638 SF @ 1%	3,096 SF
TOTAL COMMON SPACE REQUIRED	22,573 SF	
TOTAL COMMON SPACE PROVIDED	228,251 SF	
PARKING REQUIRED		
DC1		
OFFICE + WAREHOUSE BUILDING AREA	399,753 @ 1/7270 SF	55
TOTAL REQUIRED	55	
PARKING PROVIDED	55	
DC2		
OFFICE BUILDING AREA	309,638 @ 1/7270 SF	43
TOTAL REQUIRED	43	
PARKING PROVIDED	55	
DC3		
OFFICE BUILDING AREA	309,638 @ 1/7270 SF	43
TOTAL REQUIRED	43	
PARKING PROVIDED	55	
DC4		
OFFICE BUILDING AREA	309,638 @ 1/7270 SF	43
TOTAL REQUIRED	43	
PARKING PROVIDED	55	
DC5		
OFFICE BUILDING AREA	309,638 @ 1/7270 SF	43
TOTAL REQUIRED	43	
PARKING PROVIDED	55	
DC6		
OFFICE BUILDING AREA	309,638 @ 1/7270 SF	43
TOTAL REQUIRED	43	
PARKING PROVIDED	55	
DC7		
OFFICE BUILDING AREA	309,638 @ 1/7270 SF	43
TOTAL REQUIRED	43	
PARKING PROVIDED	55	
TOTAL SOFT	2,257,584	
TOTAL REQUIRED	2,257,584 @ 1/7270 SF	
TOTAL PROVIDED	313	
BICYCLE PARKING		
CODE REQUIRED	385 @ 1/10	39
PROVIDED	39	

LEGEND:

- PROPERTY LINE
- SWALE FLOWLINE
- BUILDING ENTRANCE FACILITY (6'X8'X7')
- TELECOMM MAINTENANCE HOLE (TMH 12'X12'X8')
- ZERO VAULT (10'X12'X8')
- EXISTING WATER LINE
- EXISTING NATURAL GAS LINE
- EXISTING GATE VALVE
- EXISTING SEWER MANHOLE
- SETBACK
- CONCRETE PAVEMENT
- ASPHALT PAVEMENT
- RIPRAP
- TOP OF SWALE
- TRENCH DRAIN
- CONCRETE CHANNEL
- LIGHT POLE
- BOLLARDS
- ADA PARKING
- CRISMON PROPOSED AREA
- FUTURE 100' ELECTRICAL EASEMENT
- ENTRY AND TEMPORARY CONSTRUCTION EASEMENT
- MIN 5' TALL BERM

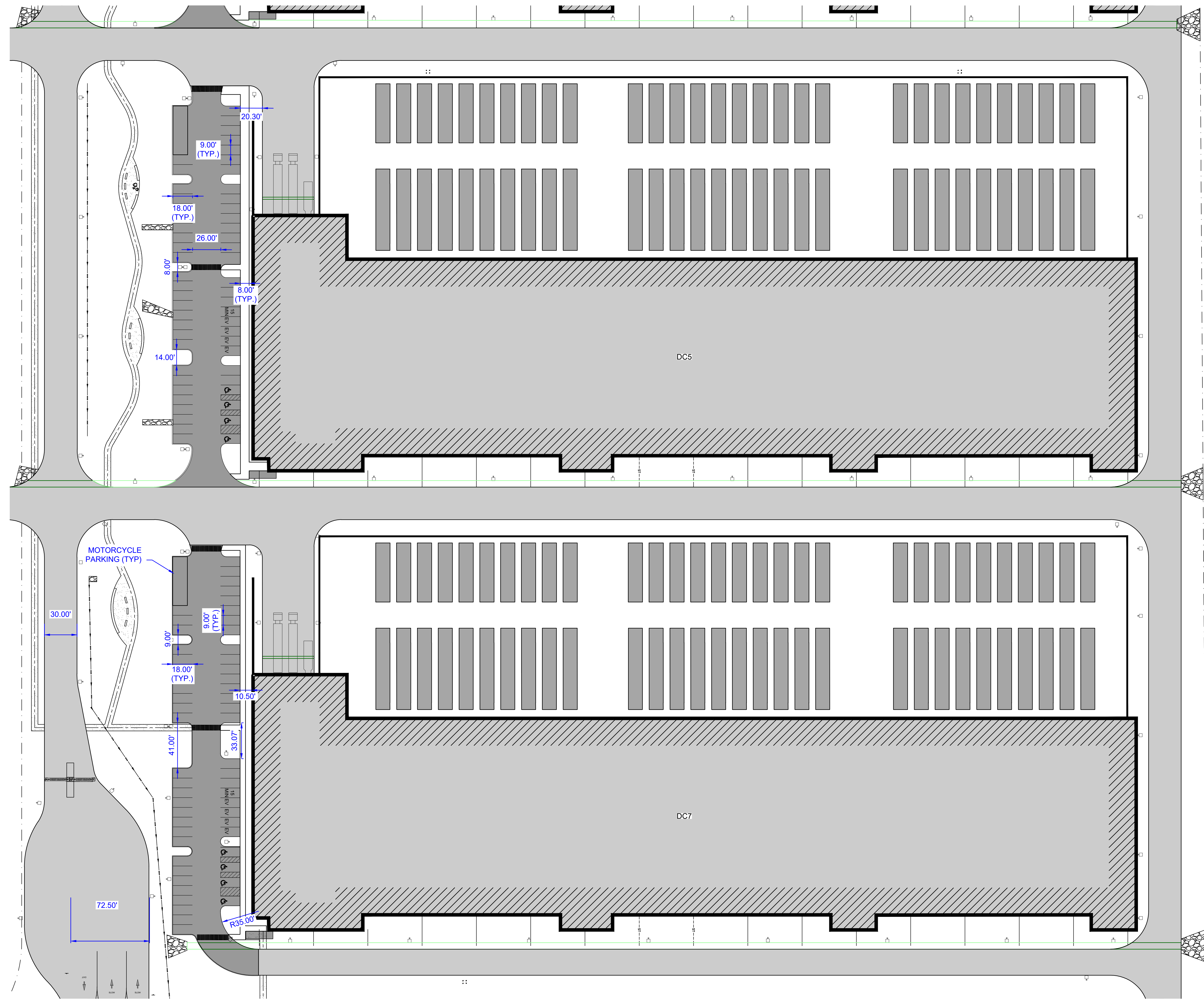

Scale For Microfitting
 Millimeters
 Inches

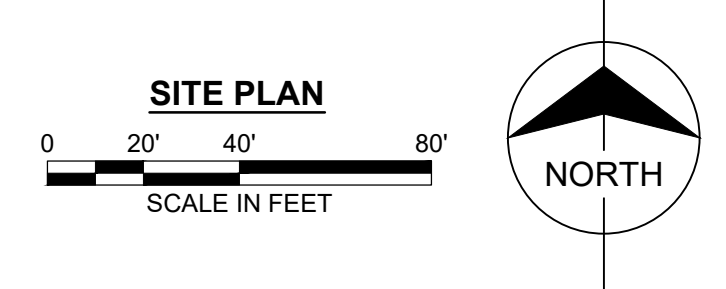

no.	date	by	ckd	description

BURNS & MCDONNELL
 9400 WARD PARKWAY
 KANSAS CITY, MO 64114
 816-333-9400
 Burns & McDonnell Engineering Co., Inc.
 LICENSEE NO. 000165

date	03/09/2026	detailed	SE
designed	SA	checked	CAK

PRELIMINARY - NOT FOR CONSTRUCTION

10010 E PECOS RD, MESA, ARIZONA, 85212

TYPICAL PARKING CONFIGURATION

project	187028	contract	
drawing	CS101	rev.	
sheet	of	sheets	
file	187028_CS100.dwg		

Name Discipline License No.