

RESOLUTION NO. \_\_\_\_\_

A RESOLUTION OF THE CITY COUNCIL OF THE CITY OF MESA, MARICOPA COUNTY, ARIZONA, ABANDONING THROUGH EXTINGUISHMENT A PORTION OF A WATER AND SEWER LINE EASEMENT LOCATED AT 4559 SOUTH POWER ROAD.

WHEREAS, pursuant to Arizona Revised Statutes Title 28 §§ 7201-7215 and/or Mesa City Code Title 9, Chapter 10, the City Council has the authority to abandon, vacate or extinguish (collectively, hereafter, “abandon”) unnecessary roadway, right-of-way, or easements to which the City holds right or title to. Additionally, the City generally has the right to release restrictive covenants it holds on real property.

WHEREAS, the City Council has determined that a portion of a water and sewer line easement recorded in Document No. 2020-1146770, records of Maricopa County, Arizona, located at 4559 South Power Road, as hereafter described and depicted in **Exhibit A** (“Water and Sewer Line Easement”), is no longer needed.

WHEREAS Mesa City Code 9-10-2 permits the City Council to extinguish easements no longer needed by the City upon application and payment of the application fee.

NOW THEREFORE, BE IT RESOLVED BY THE CITY COUNCIL OF THE CITY OF MESA, MARICOPA COUNTY, ARIZONA, AS FOLLOWS:

Section 1: All rights of the City of Mesa in and to the portion of the Water and Sewer Line Easement below are abandoned and deemed extinguished:

PLEASE REFER TO THE LEGAL DESCRIPTION AND DEPICTION ON **EXHIBIT A** ATTACHED HERETO AND MADE A PART HEREOF FOR THE EXTINGUISHED AREA.

PASSED AND ADOPTED by the City Council of the City of Mesa, Maricopa County,  
Arizona, this 8<sup>th</sup> day of December, 2022.

APPROVED:

---

Mayor

ATTEST:

---

City Clerk



EXHIBIT A

**Legal Description  
Water and Sewer Easement Abandonment  
Cannon Beach**

Job No. 19-1090.3

September 29, 2022

A PORTION OF THE FINAL PLAT OF CANNON BEACH AS RECORDED IN BOOK 1622, PAGE 20, OFFICIAL RECORDS OF MARICOPA COUNTY, ARIZONA, LOCATED IN THE NORTHWEST QUARTER OF SECTION 19, TOWNSHIP 1 SOUTH, RANGE 7 EAST, OF THE GILA AND SALT RIVER MERIDIAN, MARICOPA COUNTY, ARIZONA, AND MORE PARTICULARLY DESCRIBED AS FOLLOWS:

COMMENCING AT THE NORTHWEST CORNER OF SAID SECTION 19, FROM WHICH THE WEST QUARTER CORNER OF SAID SECTION 19, BEARS SOUTH 00 DEGREES 54 MINUTES 54 SECONDS EAST, 2628.50 FEET;

THENCE ALONG THE WEST LINE OF THE NORTHWEST QUARTER OF SAID SECTION 19, SOUTH 00 DEGREES 54 MINUTES 54 SECONDS EAST, 1314.26 FEET;

THENCE LEAVING SAID WEST LINE, NORTH 89 DEGREES 05 MINUTES 06 SECONDS EAST, 65.00 FEET TO A POINT ON THE EAST RIGHT OF WAY LINE FOR SOUTH POWER ROAD, SAID POINT ALSO BEING THE SOUTHWEST CORNER OF SAID FINAL PLAT - CANNON BEACH AND THE SOUTHWEST CORNER OF A CROSS ACCESS MAINTENANCE AND UTILITIES EASEMENT AS RECORDED IN DOCUMENTS NUMBER 2020-1146770 AND 2020-0856755, OFFICIAL RECORDS OF MARICOPA COUNTY, ARIZONA;

THENCE ALONG THE WEST LINE OF SAID CROSS ACCESS MAINTENANCE AND UTILITIES EASEMENT, NORTH 00 DEGREES 54 MINUTES 54 SECONDS WEST, 22.80 FEET TO THE NORTHWEST CORNER OF SAID CROSS ACCESS MAINTENANCE AND UTILITIES EASEMENT;

THENCE LEAVING THE WEST LINE OF, AND ALONG THE NORTH LINE OF SAID CROSS ACCESS MAINTENANCE AND UTILITIES EASEMENT NORTH 89 DEGREES 05 MINUTES 06 MINUTES EAST, 78.04 FEET TO THE BEGINNING OF A TANGENT CURVE CONCAVE NORTHWEST;

THENCE CONTINUING ALONG THE NORTH LINE OF SAID CROSS ACCESS MAINTENANCE AND UTILITIES EASEMENT AND SAID CURVE TO THE LEFT, HAVING A RADIUS OF 65.75 FEET THROUGH A CENTRAL ANGLE OF 17 DEGREES 13 MINUTES 32 SECONDS, A LENGTH OF 19.77 FEET;

(SHEET 1 OF 4)



THENCE CONTINUING ALONG THE NORTH LINE OF SAID CROSS ACCESS MAINTENANCE AND UTILITIES EASEMENT, NORTH 71 DEGREES 51 MINUTES 34 SECONDS EAST, 70.14 FEET;

THENCE CONTINUING ALONG THE NORTH LINE OF SAID CROSS ACCESS MAINTENANCE AND UTILITIES EASEMENT, NORTH 81 DEGREES 19 MINUTES 38 SECONDS EAST, 54.71 FEET;

THENCE CONTINUING ALONG THE NORTH LINE OF SAID CROSS ACCESS MAINTENANCE AND UTILITIES EASEMENT, NORTH 71 DEGREES 51 MINUTES 34 SECONDS EAST, 57.83 FEET TO THE BEGINNING OF A TANGENT CURVE CONCAVE TO THE SOUTHEAST;

THENCE CONTINUING ALONG THE NORTH LINE OF SAID CROSS ACCESS MAINTENANCE AND UTILITIES EASEMENT AND SAID CURVE TO THE RIGHT, HAVING A RADIUS OF 200.00 FEET THROUGH A CENTRAL ANGLE OF 02 DEGREES 13 MINUTES 29 SECONDS, AND A LENGTH OF 7.77 FEET TO THE **POINT OF BEGINNING**;

THENCE CONTINUING ALONG THE NORTH LINE OF SAID CROSS ACCESS MAINTENANCE AND UTILITIES EASEMENT AND SAID CURVE TO THE RIGHT, HAVING A RADIUS OF 200.00 FEET THROUGH A CENTRAL ANGLE OF 15 DEGREES 00 MINUTES 01 SECONDS, AND A LENGTH OF 52.36 FEET;

THENCE CONTINUING ALONG THE NORTH LINE OF SAID CROSS ACCESS MAINTENANCE AND UTILITIES EASEMENT, NORTH 89 DEGREES 05 MINUTES 06 SECONDS EAST, 830.36 FEET TO THE NORTHEAST CORNER OF SAID CROSS ACCESS MAINTENANCE AND UTILITIES EASEMENT;

THENCE ALONG THE EAST LINE OF SAID CROSS ACCESS MAINTENANCE AND UTILITIES EASEMENT, SOUTH 00 DEGREES 47 MINUTES 38 SECONDS EAST, 10.00 FEET;

THENCE LEAVING THE EAST LINE OF SAID CROSS ACCESS MAINTENANCE AND UTILITIES EASEMENT, SOUTH 89 DEGREES 05 MINUTES 06 SECONDS WEST, 881.11;

THENCE NORTH 18 DEGREES 08 MINUTES 26 SECONDS WEST, 3.33 FEET RETURNING TO THE **POINT OF BEGINNING**.

SAID WATER AND SEWER EASEMENT ABANDONMENT CONTAINING 8703 SQUARE FEET, OR 0.2000 ACRES, MORE OR LESS.

(SHEET 2 OF 4)

# LEGEND

FD MON IN HANDHOLE AS NOTED

FND FOUND

MON MONUMENT

BCHH BRASS CAP IN HAND HOLE

SECTION LINE

PLAT BOUNDARY LINE

EXISTING EASEMENT LINE

EASEMENT ABANDONMENT

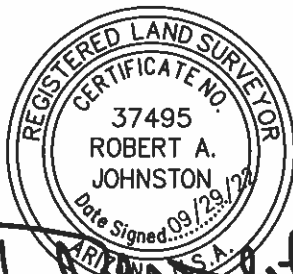

*[Handwritten Signature]*

## LINE TABLE

LINE	BEARING	LENGTH
L1	N89°05'06"E	65.00'
L2	S00°54'54"E	22.80'
L3	N89°05'06"E	78.04'
L4	N71°51'34"E	70.14'
L5	N81°19'38"E	54.71'
L6	N71°51'34"E	57.83'
L7	S00°47'38"E	10.00'
L8	N18°08'26"W	3.33'
L9	S89°05'06"W	82.09'
L10	S71°51'34"W	158.91'
L11	S00°54'54"E	28.50'
L12	N89°05'06"E	88.00'
L13	N71°51'34"E	151.60'
L14	N67°44'04"E	92.30'
L15	N00°52'29"W	15.00'

## CURVE TABLE

CURVE	LENGTH	RADIUS	DELTA	TANGENT	CHORD	CHORD BRG
C1	19.77'	65.75'	17°13'32"	9.96'	19.69'	N80°28'20"E
C2	7.77'	200.00'	2°13'29"	3.88'	7.77'	S72°58'19"W
C3	52.36'	200.00'	15°00'01"	26.33'	52.21'	N81°35'06"E
C4	60.13'	200.00'	17°13'32"	30.29'	59.90'	N80°28'20"E
C5	60.13'	200.00'	17°13'32"	30.29'	59.90'	S80°28'20"W

(SHEET 4 OF 4)

19-1090.3

CANNON BEACH WATER AND SEWER  
EASEMENT ABANDONMENT

EXHIBIT "A"



1130 N. Alma School Rd.  
Ste. 120 Mesa, AZ 85201  
T:480.503.2250 | F:480.503.2258  
www.epsgroupinc.com

Sep 29, 2022 11:22am S:\Projects\2019\19-1090\Legal Survey\Legals\SRP Easement Abandonment\19-1090.3 EA.dwg

Sep 29, 2022 11:21am S:\Projects\2019\19-1090\Legal Survey\Legals\SRP Easement Abandonment\19-1090.3 EA.dwg

# SPOWER ROAD

(BASIS OF BEARINGS)  
S00°54'54"E 2628.50'

1314.26'

NW COR SEC 19, T1S, R7E, G&SRM FND  
3" MARICOPA HIGHWAY DEPARTMENT BCHH

CROSS ACCESS MAINTENANCE AND  
UTILITIES EASEMENT PER DOC. NO.  
2020-1146770 AND  
2020-0856755, MCR

PROPOSED WATER AND SEWER  
EASEMENT ABANDONMENT

POINT OF BEGINNING

C2

L6

C3

L8

IC5

L3

C1

L4

L5

L10

L14

L1

L2

L9

C4

L13

S89°05'06"W  
881.11'

SOUTH PROPERTY LINE OF "FINAL  
PLAT - CANNON BEACH"  
BOOK 1622, PAGE 20, MCR

MATCH LINE  
BELOW LEFT

W1/4 COR SEC 19, T1S, R7E, G&SRM  
FND 3" TOWN OF GILBERT BCHH

PROPOSED WATER AND SEWER  
EASEMENT ABANDONMENT

N89°05'06"E 830.36'

S89°05'06"W 881.33'

S89°05'06"W 881.11'

N89°05'06"E 844.74'

SOUTH PROPERTY LINE OF  
"FINAL PLAT - CANNON  
BEACH"  
BOOK 1622, PAGE 20, MCR

CROSS ACCESS MAINTENANCE AND  
UTILITIES EASEMENT PER DOC. NO.  
2020-1146770 AND 2020-0856755,  
MCR

MATCH LINE  
BELOW LEFT

PROPOSED WATER AND SEWER  
EASEMENT ABANDONMENT

N89°05'06"E 830.36'

S89°05'06"W 881.33'

S89°05'06"W 881.11'

N89°05'06"E 844.74'

SOUTH PROPERTY LINE OF  
"FINAL PLAT - CANNON  
BEACH"  
BOOK 1622, PAGE 20, MCR

CROSS ACCESS MAINTENANCE AND  
UTILITIES EASEMENT PER DOC. NO.  
2020-1146770 AND 2020-0856755,  
MCR



30 0 60  
scale feet

(SHEET 3 OF 4)

19-1090.3

CANNON BEACH WATER AND SEWER  
EASEMENT ABANDONMENT

EXHIBIT "A"



1130 N. Alma School Rd.  
Ste. 120 Mesa, AZ 85201  
T:480.503.2250 | F:480.503.2258  
www.epsgroupinc.com