

GENERAL NOTES:

1. ALL LIGHTING DESIGN AND CONTROLS SHALL BE IN COMPLIANCE WITH MESA ARIZONA REQUIREMENT AND LOCALLY ADOPTED CODES.

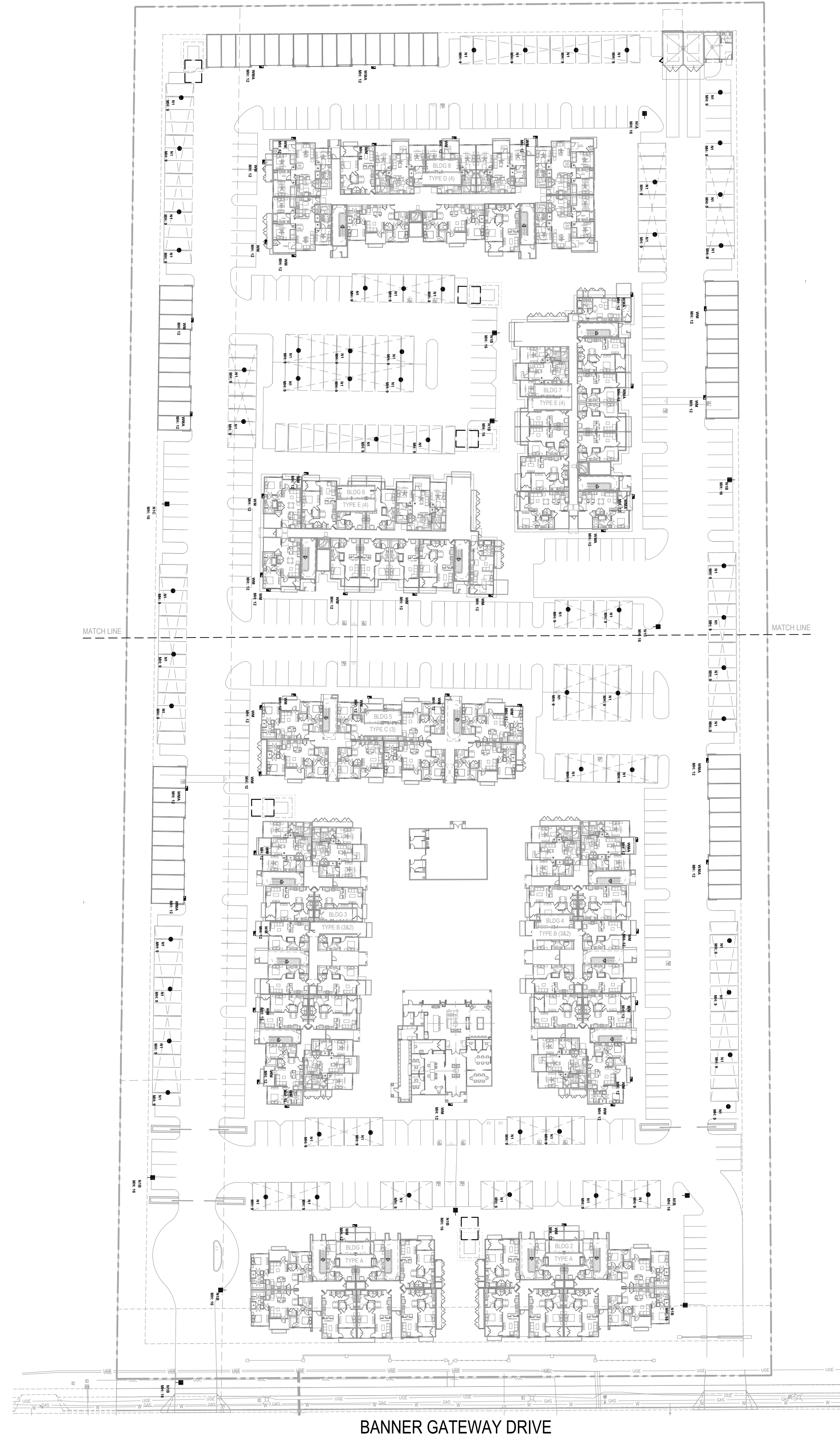

ELAINE FOCKE
LAI HOUSTON
MESA, AZ
713-805-1525

Luminaire Schedule							
Symbol	Qty	Label	LLF	Arrangement	Description	Lum Watts	MTG HT
ORX-1-CM-TS-16L-53-30K7-CM	58	N1	0.950	Single	ORX-1-CM-TS-16L-53-30K7-CM	28	9
NV-1-T5-32L-1-30K-SINGLE	1	N1A	0.950	Single	NV-1-T5-32L-1-30K-SINGLE	106	16
NV-1-T4-32L-1-30K-SINGLE	9	N1B	0.950	Single	NV-1-T4-32L-1-30K-SINGLE	106	16
NV-1-T3-32L-1-30K-SINGLE	2	N1C	0.950	Single	NV-1-T3-32L-1-30K-SINGLE	106	16
NV-W-T4-16L-1-30K-WALL	35	WM	0.950	Single	NV-W-T4-16L-1-30K-WALL	56	12
NV-W-T3-16L-1-30K-WALL	12	WMA	0.950	Single	NV-W-T3-16L-1-30K-WALL	56	12

GATEWAY BANNER - MESA, ARIZONA

Calculation Summary							
Label	CalcType	Units	Avg	Max	Min	Avg/Min	Max/Min
SITE CALCS	Illuminance	Fc	1.77	11.7	0.0	N.A.	N.A.
CANOPY	Illuminance	Fc	2.20	3.3	1.7	1.29	1.94
PARKING LOT	Illuminance	Fc	2.02	3.2	1.0	2.02	3.20

1 PHOTOMETRIC OVERALL PLAN
SCALE: 1" = 50'-0"

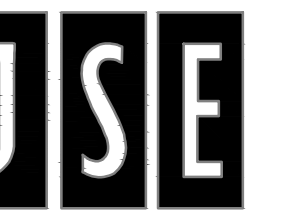

**Jordan & Skala
Engineers**

10375 Richmond Avenue • Suite 300
Houston, TX 77042
p. 281.617.3200 • f. 281.617.3207

Project Number: 24060530
Drawn By: TD Checked By: TD



THIS DRAWING IS THE PROPERTY OF JORDAN & SKALA ENGINEERS INC. AND IS NOT TO BE REPRODUCED IN WHOLE OR IN PART WITHOUT WRITTEN PERMISSION BY JORDAN & SKALA ENGINEERS.

**BANNER GATEWAY
APARTMENTS
MESA, ARIZONA**

PRINT RECORD

DATE	ISSUED FOR
08/16/24	REDZONE SUBMITTAL

REVISIONS

DATE	DESCRIPTION
------	-------------

SHEET TITLE

**PHOTOMETRIC -
OVERALL PLAN**

SHEET NUMBER

E1-01

NOT ISSUED FOR CONSTRUCTION

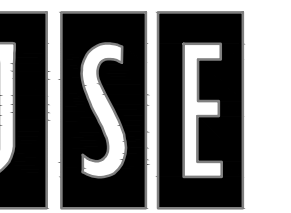

Jordan & Skala Engineers

10375 Richmond Avenue • Suite 300
Houston, TX 77042
p. 281.617.3200 • f. 281.617.3207

Project Number: 24060530
Drawn By: TD Checked By: TD



THIS DRAWING IS THE PROPERTY OF JORDAN & SKALA ENGINEERS INC. AND IS NOT TO BE REPRODUCED IN WHOLE OR IN PART WITHOUT WRITTEN PERMISSION BY JORDAN & SKALA ENGINEERS.

BANNER GATEWAY APARTMENTS

MESA, ARIZONA

PRINT RECORD

DATE	ISSUED FOR
08/16/24	REDZONE SUBMITTAL

REVISIONS

DATE	DESCRIPTION

SHEET TITLE

PHOTOMETRIC - PARTIAL PLAN

SHEET NUMBER

E1-02

NOT ISSUED FOR CONSTRUCTION

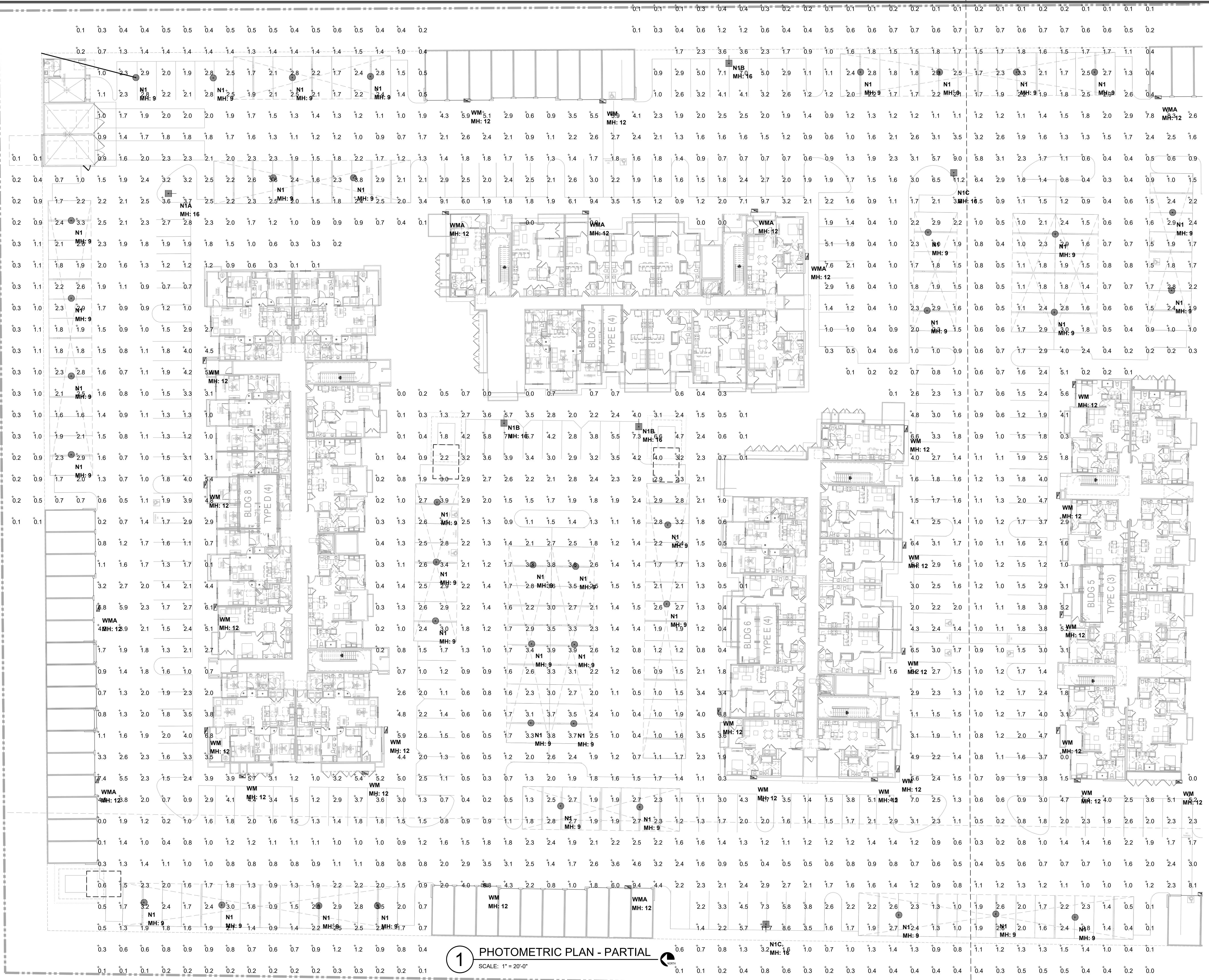

1 PHOTOMETRIC PLAN - PARTIAL
SCALE: 1" = 20'-0"

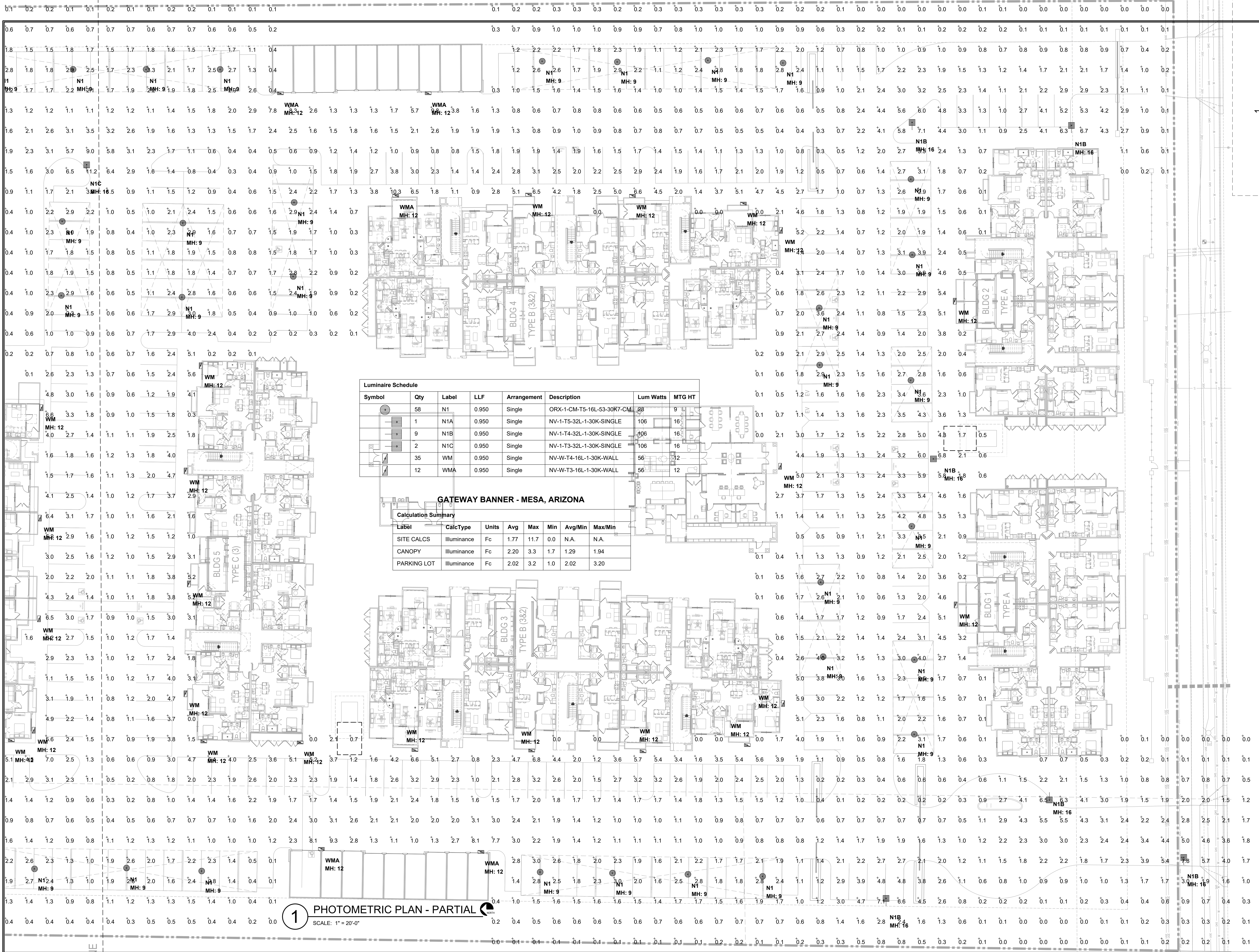

Symbol	Qty	Label	LLF	Arrangement	Description	Lum Watts	MTG HT
☉	58	N1	0.950	Single	ORX-1-CM-T5-16L-53-30K7-CM	28	9
☉	1	N1A	0.950	Single	NV-1-T5-32L-1-30K-SINGLE	106	16
☉	9	N1B	0.950	Single	NV-1-T4-32L-1-30K-SINGLE	106	16
☉	2	N1C	0.950	Single	NV-1-T3-32L-1-30K-SINGLE	106	16
☉	35	WM	0.950	Single	NV-W-T4-16L-1-30K-WALL	56	32
☉	12	WMA	0.950	Single	NV-W-T3-16L-1-30K-WALL	56	12

GATEWAY BANNER - MESA, ARIZONA

Label	CalcType	Units	Avg	Max	Min	Avg/Min	Max/Min
SITE CALCS	Illuminance	Fc	1.77	11.7	0.0	N.A.	N.A.
CANOPY	Illuminance	Fc	2.20	3.3	1.7	1.29	1.94
PARKING LOT	Illuminance	Fc	2.02	3.2	1.0	2.02	3.20

1 PHOTOMETRIC PLAN - PARTIAL
SCALE: 1" = 20'-0"



THIS DRAWING IS THE PROPERTY OF JORDAN & SKALA ENGINEERS INC. AND IS NOT TO BE REPRODUCED IN WHOLE OR IN PART WITHOUT WRITTEN PERMISSION BY JORDAN & SKALA ENGINEERS.

**BANNER GATEWAY
APARTMENTS
MESA, ARIZONA**

PRINT RECORD	
DATE	ISSUED FOR
08/16/24	REDZONE SUBMITTAL

REVISIONS	
DATE	DESCRIPTION

SHEET TITLE
PHOTOMETRIC - PARTIAL PLAN

SHEET NUMBER
E1-03
NOT ISSUED FOR CONSTRUCTION

BANNER GATEWAY APARTMENTS
FIXTURE TYPE "N1"



ORGANIX ORX-1-CM
ARCHITECTURAL CEILING MOUNT



Drive Current	16L
425 millamps	22W (1068-2147 Lumens)
530 millamps	28W (1416-2331 Lumens)
700 millamps	37W (2416-4294 Lumens)
850 millamps	42W (2833-4214 Lumens)

FORM

- Elegant Die-Cast Aluminum Housing
- Corrosion Resistant Stainless Steel External Hardware
- Sleek, Low Profile Housing
- Spec Grade Performance
- Engineered For Optimum Thermal Management
- 9 Architectural Finishes Standard, RAL Colors Available

FUNCTION

- Micro Optics IES Distributions T2, T3, T4, T5
- 0-10V Dimming Drivers THD @ Max Load < 15%
- Power factor @ Max Load < 0.95
- Amber, 2700K, 3000K, 3500K, 4000K, or 5000K
- 16L LED Configuration
- CRI 70, 80, or 90
- 5 Mills Powder Coat
- Up to 5214 Lumens

RELIABILITY

- Silicone Micro Optics
- 5 Year Standard Warranty
- IP67 Optics
- IP66 Fixture

BUY AMERICAN

To ensure the latest BAA/TAA/BABA Standards are being met, please select BAA, TAA, or BABA in the options section. Please contact the factory before placing an order for any NLS products requesting BAA (Buy American Act), TAA (Trade Agreement Act), or BABA (Build America, Buy America).



701 Kingshill Place, Carson, CA 90746
Call Us Today (310) 341-2037

1 LIGHT FIXTURE "N1"
SCALE: N.T.S.

BANNER GATEWAY APARTMENTS
FIXTURE TYPE "N1"

ORGANIX - 1 CEILING MOUNT ORDERING GUIDE

Cat#	Light Dist.	No. of LEDs	Millamps	Kelvin Temp	Volts
ORX-1	T5	16	53	30K7	UNV
Organix - 1 Ceiling Mount (ORX-1)	Type 2 (T2)	16 (16L)	425 (42)	Amber 585-600nm (AMBER) 16, 15, 13	120-277 (UNV)
	Type 3 (T3)		530 (53)	2700K, 80 CRI (27K7) 16	
	Type 4 (T4)		700 (7)	2700K, 80 CRI (27K7) 16	
	Type 5 (T5)		850 (85)	3000K, 70 CRI (30K7) 16	
				3000K, 80 CRI (30K8) 16	
				3500K, 80 CRI (35K8)	
				4000K, 70 CRI (40K7)	
				4000K, 80 CRI (40K8) 16	
				5000K, 70 CRI (50K7)	
				5000K, 80 CRI (50K8) 16	

Mounting	Color	Control Options	Options	Lens Options
CM				
Ceiling Mount (CM)	Bronze Textured (BRZ) White Textured (WHT) Smooth White Gloss (SWT) Silver Metallic (SVR) Black Textured (BLK) Smooth Black Gloss (SBK) Graphite Textured (GPH) Grey Textured (GRY) Green Textured (GRN) Hunter Green Textured (HGR) Custom (CS)	Microwave Motion Sensor (MMS) 16 Emergency Battery 4w (EM4) 16 Custom Controls Integration (CCI) 16	Marine Grade Finish (MRF) 16 House Side Shield (HSS) 16 Tamper Proof Hardware (TPH) 16 Bird Stroud (BSC) 16 Buy American Act (BAA) 16 Trade Agreement Act (TAA) 16 Build America Buy American (BABA) 16	Clear Tempered Glass Lens (CL) 16

NOTES:

- Consult Factory for Lead Time, Consult Factory for 90 CRI Requests.
- Consult Factory.
- Please contact Factory for Custom Control Integration requests (Light, NK, WaveLine, Casambi, DALI, AveOn, or other control systems).
- Trade Agreement Act (TAA) 16.
- Consult Factory for all BAA/TAA/BABA requests.
- AMBER and CM are not available in the same fixture.
- 1000K or lower, with fixed mounting options only, must be selected to meet International Dark Sky Association certifications.
- Not available with some fixtures (HSS, HSL, HSL, HSL).

701 Kingshill Place, Carson, CA 90746
Call Us Today (310) 341-2037

JSE
Jordan & Skala
Engineers

10375 Richmond Avenue • Suite 300
Houston, TX 77042
p. 281.617.3200 • f. 281.617.3207

Project Number: 24060530
Drawn By: TD
Checked By: TD



THIS DRAWING IS THE PROPERTY OF JORDAN & SKALA ENGINEERS INC. AND IS NOT TO BE REPRODUCED IN WHOLE OR IN PART WITHOUT WRITTEN PERMISSION BY JORDAN & SKALA ENGINEERS.

BANNER GATEWAY
APARTMENTS

MESA, ARIZONA

PRINT RECORD

DATE	ISSUED FOR
08/16/24	REDZONE SUBMITTAL

REVISIONS

DATE	DESCRIPTION

SHEET TITLE

SITE LIGHT FIXTURE CUT SHEETS

SHEET NUMBER

E1-04

NOT ISSUED FOR CONSTRUCTION

BANNER GATEWAY APARTMENTS
FIXTURE TYPE "N1A" & "N1B"



NV-1
AREA, SITE & ROADWAY



40L	32L	44L	64L
450 millamps	21w	—	—
530 millamps	28w	71w	104w
700 millamps	36w	108w	136w
1050 millamps	56w	108w	205w

FORM AND FUNCTION

- Sleek, low profile housing
- Spec grade performance
- Engineered for optimum thermal management
- Low depreciation rate
- Reduces energy consumption and costs up to 65%
- Exceeds IES foot candle levels utilizing the least number of poles and fixtures per project
- Optical system designed for:
 - Parking Lots
 - Auto Dealerships
 - General Area Lighting

CONSTRUCTION

- Die Cast Aluminum
- External cooling fins
- Corrosion resistant external hardware
- One-piece silicone gasket ensures IP65 seal for electronics compartment
- One-piece Optics Plate™ mounting silicone Micro Optics
- Two-piece silicone Micro Optic system ensures IP67 level seal around each PCB
- Grade 2 Clear Anodized Optics Plate™ standard

FINISH

- 3-5 mils electrostatic powder coat.
- NLS' standard high-quality finishes prevent corrosion, protects against extreme environmental conditions

WARRANTY

Five-year limited warranty for drivers and LEDs.

BUY AMERICAN

To ensure the latest BAA/TAA/BABA Standards are being met, please select BAA, TAA, or BABA in the options section. Please contact the factory before placing an order for any NLS products requesting BAA (Buy American Act), TAA (Trade American Act), or BABA (Build America, Buy America).



701 Kingshill Place, Carson, CA 90746
Call Us Today (310) 341-2037

2 LIGHT FIXTURE "N1A" & "N1B"
SCALE: N.T.S.

BANNER GATEWAY APARTMENTS
FIXTURE TYPE "N1A" & "N1B"

NV-1 ORDERING GUIDE

Cat#	Light Dist.	# of LEDs	Millamps	Kelvin	Volts
NV-1	T5	32L	1	30K7	UNV
NV-1 (NV-1)	Type 2 (T2)	16 (16L)	400 (40)	Amber 585-600nm (AMBER) 16, 15, 13	120-277 (UNV)
	Type 3 (T3)	32 (32L)	53 (53)	2700K, 70 CRI (27K7) 16	347-480 (UNV)
	Type 4 (T4)	48 (48L)	700 (7)	2700K, 80 CRI (27K8) 16	
	Type 5 (T5)	64 (64L)	85 (85)	3000K, 70 CRI (30K7) 16	
				3000K, 80 CRI (30K8) 16	
				3500K, 80 CRI (35K8) 16	
				4000K, 70 CRI (40K7)	
				4000K, 80 CRI (40K8) 16	
				5000K, 70 CRI (50K7)	
				5000K, 80 CRI (50K8) 16	

Mounting	Color	Controls Options	Options	Lens Options
NV-1				
Architectural Sweep Arm (ASA) 16	Bronze Textured (BRZ) White Textured (WHT) Smooth White Gloss (SWT) Silver Metallic (SVR) Black Textured (BLK) Smooth Black Gloss (SBK) Graphite Textured (GPH) Grey Textured (GRY) Green Textured (GRN) Hunter Green Textured (HGR) Custom (CS)	Nema 3 Pin Receptacle (PE7) PhotoCell + Receptacle (PCR) Receptacle + Sporting Cap (RSC) FSP-211 with Motion Sensor (FSP-20) 16 21'-42' Heights (FSP-40) 16 Custom Controls Integration (CCI) 16 Button Type PhotoCell (PC) 16	Bird Spikes (BS) Marine Grade Finish (MRF) Optic Plate Painted to Match Fixture (OPP) Quick Mount Bracket (QMB) Retrol Mount Bracket (RMB) Round Pole Adaptor (RPA) Round Pole Adaptor 5'-4' Pole (RPA5) Rotated Optic Left (ROL) Rotated Optic Right (ROK) Automotive House Side Shield (ANS) House Side Shield (HSS) 16 Black Hardware (BH) Black Optic Frame (OPF) Buy American Act (BAA) 16 Trade Agreement Act (TAA) 16 Build America Buy American (BABA) 16	Glass Lens (GL) 16 HSL Lens (HSL) 16, 14

NOTES:

- Consult Factory for Lead Time, Consult Factory for 90 CRI Requests.
- For Round Pole Specify (RPA) or (RPA5).
- Standard finish is stainless steel. Can be painted to match fixture.
- Universal Voltage 120-277
- HSS not applicable with Nema 2.
- 3000K or lower, with fixed mounting options only, must be selected to meet International Dark Sky Association certifications.
- Glass Lens: Low Iron glass, fully tempered per ANSI C1047 (CCH-2201-37)
- HSL Lens: Yellow Polycarbonate Lens - less than 2% Blue Light Content
- Please contact Factory for Custom Control Integration requests (Light, NK, WaveLine, Casambi, DALI, AveOn, or other control systems).
- Trade Agreement Act (TAA) 16.
- Consult Factory for all BAA/TAA/BABA requests
- Consult Factory for Lead Time
- Not available above 1000mA
- Consult Factory

701 Kingshill Place, Carson, CA 90746
Call Us Today (310) 341-2037

BANNER GATEWAY APARTMENTS
FIXTURE TYPE "WM"

NLS LIGHTING **NV-W**
ARCHITECTURAL HIGH PERFORMANCE FULL CUTOFF WALL PACK

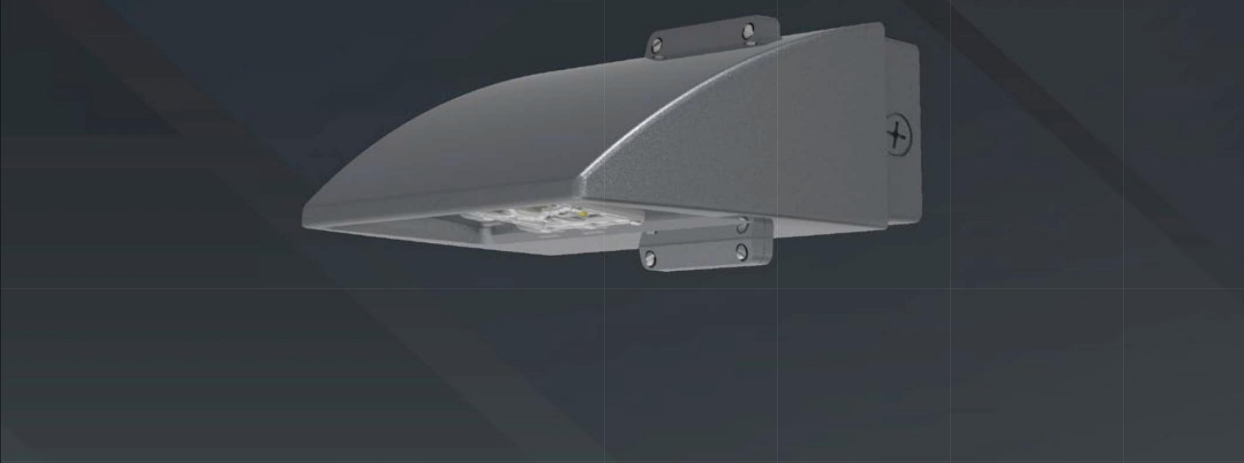

LED WATTAGE CHART

LED WATTAGE	16L	32L
400 milliwatts	27w	-
800 milliwatts	27w	-
1000 milliwatts	37w	77w
1000 milliwatts	-	100w
1000 milliwatts	50w	-

KEY FEATURES

- Ideal for Exterior Walls, Entryways, Pathways, New Construction and Renovation, Warehouse and Receiving Docks, Court Yards, and School Playgrounds
- Sleek Minimalistic Design of the the NV-W (up to 11,000 Lumens, 12"W x 9"D x 5.5"H) Complements the Design of the NV-W2 (up to 24,000 Lumens, 18"W x 9.38"D x 5"H)
- Amber, 2700K, 3000K, 3500K, 4000K, 5000K CCT Multichip High Power 70 & 80 CRI LEDs
- IP65 Rated Against Dust & Water Ingress, IK10 Rated for Tamper/ Vandalism/Impact Protection
- 20KA Surge Protection (120V - 480V) Cold Weather Integrated Battery Back-Up Safety Options
- Silicone Optics providing 96% Clarity and Heat Resistant up to 150°C
- +9 Standard Finishes, Custom Finish and Marine Grade Finish Available

Controls Agnostic, Compatible with Most Control Systems and Sensors

- Environmentally Friendly Product Which Reduces Energy Consumption, L70 > 100,000 hours
- IDA qualified for 3000K CCT and Lower for Down-light Application, Reducing Light Pollution and Trespass
- Buy America(n) Option Available, Quick Mount for Easy Installation
- Cost Competitive and Short Shipping Lead Times in Days & Weeks

BUY AMERICAN
To ensure the latest BAA/TAA/BABA Standards are being met, please select BAA, TAA, or BABA in the options section. Please contact the factory before placing an order for any NLS products requesting BAA (Buy American Act), TAA (Trade American Act), or BABA (Build America, Buy America).

701 Kingshill Place, Carson, CA 90746
Call Us Today (310) 341-2037

USA

BANNER GATEWAY APARTMENTS Type: **FIXTURE TYPE "WM"**

NV-W ORDERING GUIDE

Cat#	Light Dist.	# of LEDs	Milliwatts	Kelvin	Volts
NV-M		16L	(1)	30K7	UNV
NV-W (NV-W)	Type 2 (T2)	16 (16L)	400 (40)	Amber 2700K (AMBER) 1.14"	120/277 (UNV)
	Type 3 (T3)	32 (32L)	530 (53)	2700K, 30 CR (270K) 1"	347-480 (UNV)
WMA (T3)	Type 4 (T4)	32 (32L)	700 (7)	2700K, 80 CR (270K) 1"	
WM (T4)			1000 (1A)*	3000K, 70 CR (300K) 1"	
			1000 (1)*	3000K, 80 CR (300K) 1"	
				3500K, 80 CR (350K)	
				4000K, 70 CR (400K)	
				4000K, 80 CR (400K)	
				4000K, 80 CR (400K) 1"	
				5000K, 80 CR (500K)	
				5000K, 80 CR (500K) 1"	

Mounting	Color	Controls Options	Options	Lens Options
Wall Mount (WM)	Bronze Textured (BZT) White Textured (WHT) Smooth White Glass (SWT) Silver Metallic (SLV) Black Textured (BLK) Smooth Black Glass (SBK) Green Textured (GRN) Hunter Green Textured (HGRN) Custom (CS)	None 7 Pole Receptacle (RPT) Button Photocell (PB) FSP-211 with Motion Sensor (MOTION) (MOTION) FSP-81* (FSP-81)* FSP-20* (FSP-20)*	Marine Grade Finish (MFG) Vanity Plate 22"x16" (VP) Housing Extension (HE) Surge Protector (SP) Emergency Battery 4W (EB4) Emergency Battery 8W (EB8) Emergency 2x4 Pb Battery (E24) Black Hardware (BH) Black Optic Frame (BOF) Buy American Act (BAA) Trade Agreement Act (TAA)	Glass Lens (GL) HAL Lens (HAL)

NOTES:

- Consult Factory for Lead Time. Consult Factory for 90 CRI Requests
- Requires Housing Extension
- Universal Voltage 120/277
- All Emergency Battery Options Certified CA Title 20
- (1A) 32L only
- (1) 16L only
- 3000K or lower must be selected to meet International Dark Sky Association certification
- Glass Lens: Low temp glass. Fully tempered per ANSI C10.07
- HAL Lens: Yellow Polycarbonate Lens - less than 2% Blue Light Content
- Please contact factory for Custom Control Integration requests (e.g. Light, XLR, Wireless, etc., Crestron, LUMI, Synapse, Casambi, DALI II, Axiom, or other control systems)
- Turn In Sale
- Consult Factory for all BAA/TAA/BABA requests
- Consult Factory for Lead Time
- Not Available above 1000ma.
- Consult Factory
- Consult Factory

701 Kingshill Place, Carson, CA 90746
Call Us Today (310) 341-2037

nslighting.com

1 LIGHT FIXTURE "WM" & "WMA"
SCALE: N.T.S.

SOLID STATE AREA LIGHTING

GALAXY1 SERIES-LED

SPECIFICATIONS

HOUSING
Heavy cast low copper aluminum assembly (A356 alloy, <0.2% copper). Minimum wall thickness is .188". Housing attaches to pole via a one piece, extruded aluminum arm and a gasketed wiring access door. Housing/pole junction is gasketed. All exposed hardware is stainless steel. Internal protected hardware is electro-zinc plated.

LED OPTICAL MODULE
Low copper A356 alloy (<.2% copper) cast aluminum housing. Integrated clear tempered 3/16" glass lens sealed with a continuous silicone gasket protects emitters (LED's) and emitter Reflector-Prism optics, and seals the module from water intrusion and environmental contaminants. LED's are available in standard Neutral White (4000K), or optional Cool White (5000K) or Warm White (3000K). Each emitter is optically controlled by a Reflector-Prism injection molded from H12 acrylic (3 types per module; one from 0° - 50°; one from 50° - 65°; one from 65° - 72°). Each Reflector-Prism has indexing pins for aiming and is secured to an optical plate made of matte black anodized aluminum. The optical plate locates every Reflector-Prism over an emitter. Reflector-Prisms are secured to the optical plate with a UV curing adhesive. The Reflector-Prism are arrayed to produce LED Type II, III, IV, and V SQ distributions. The entire Optical Module is field rotatable in 90° increments. Both module and drivers are factory wired using water resistant, insulated cord. Lens, module and drivers are field replaceable.

LED EMITTERS
High Output LED's are driven at 350mA for nominal 1 Watt output each or 525mA for nominal 1.5 Watt output each. LED's are available in standard Neutral White (4000K), or optional Cool White (5000K) or Warm White (3000K). Consult Factory for other LED options.

LED DRIVER
UL and CUL recognized High Power Factor, Constant Current LED drivers operate on input voltages from 120-277VAC, 50/60hz. Consult Factory for 347-480VAC. Driver is mechanically fastened to a retaining bracket. Main power quick disconnect provided. Driver has a minimum 4kV of internal surge protection, 10kV & 20kV Surge Protector optional. Dimming and High-Low Driver options available.

FINISH
Electrostatically applied TGIC Polyester Powder Coat on substrate prepared with 20 PSI power wash at 140°F. Four step iron phosphate pretreatment for protection and paint adhesion. 400°F bake for maximum hardness and durability. Texture finish is standard.

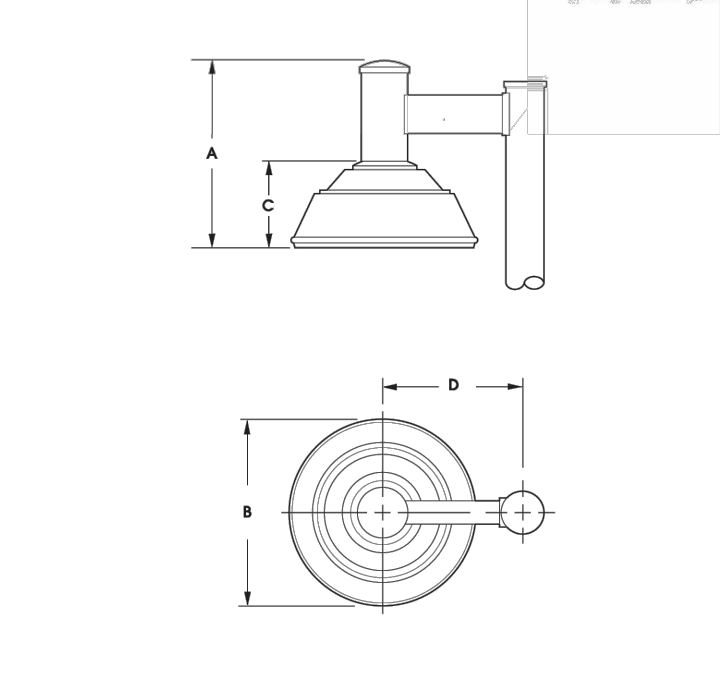

FIXTURE	A	B	C	D
GLX1	24"	24" DIA.	11"	18"
	610mm	610mm	279mm	457mm
GLX1M1	18.5"	18" DIA.	9"	15"
	470mm	457mm	229mm	381mm

U.S. ARCHITECTURAL LIGHTING

2 LIGHT FIXTURE "CP"
SCALE: N.T.S.

GALAXY1 SERIES - LED

SPECIFICATIONS

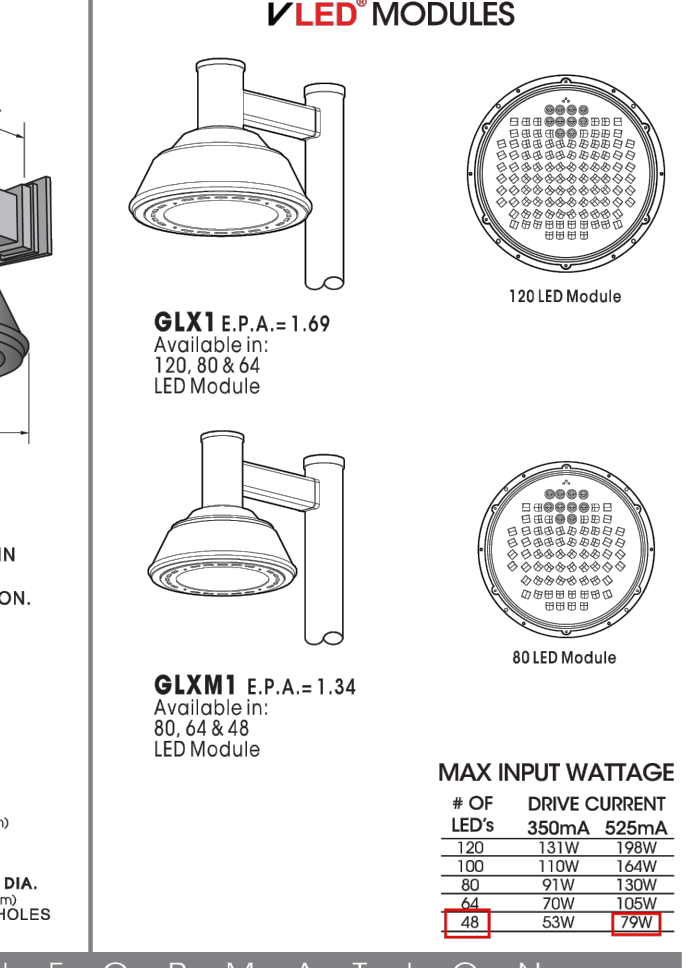
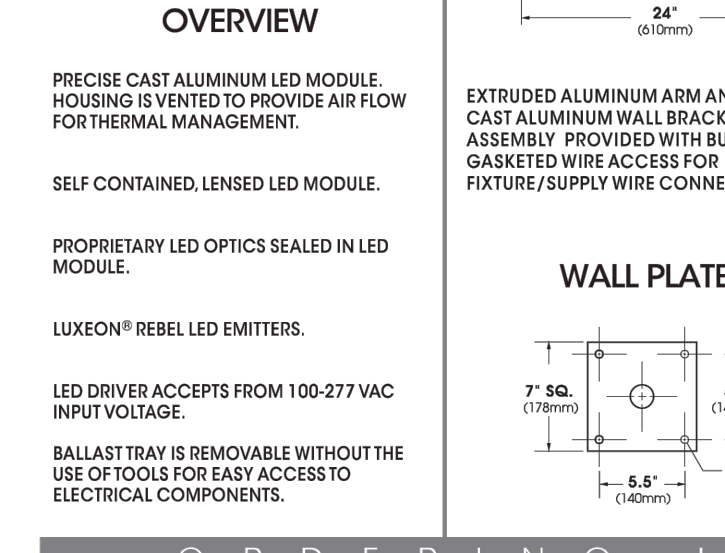
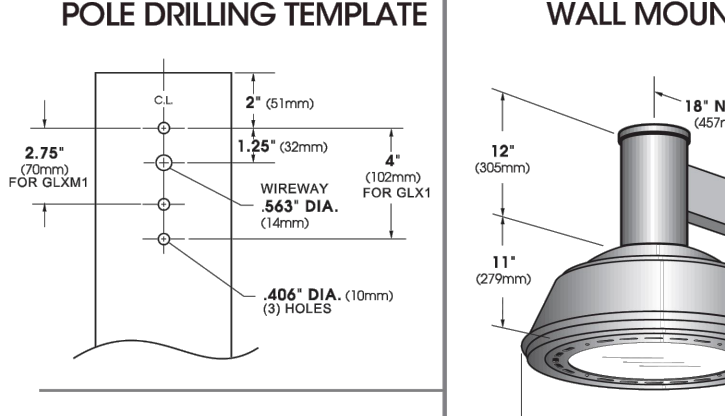

ORDERING INFORMATION

LUMINAIRE	OPTICS	# of LED'S	DRIVE CURRENT	COLOR	VOLTAGE	MOUNTING	FINISH	OPTIONS
GLX1	LED II	GLX1	350mA	NW (4000K)	120	2100	RAL-9005-1	INTERNAL HOUSE SIDE SHELD. HS
GLX1M1	LED III	GLX1	525mA	NW (3000K)	80	2400	RAL-9003-1	EXTERNAL HOUSE SIDE SHELD. EHS
	LED IV	GLX1		NW (3000K)	64	3400	RAL-7004-1	DIMMABLE DRIVER (D-10V) DIM
	LED V-SQ	GLX1			48	3120	RAL-6005-1	HIGH-LOW DIMMING FOR HANDHELD SWITCHING OR INTEGRATED MOTION SENSORS HLBW
		GLX1M1			48	4400		PHOTO CELL + VOLTAGE (EXAMPLE PC-350) PC-V
		GLX1			48	WM		TWIST LOCK PHOTOCELL RECEPTACLE ONLY - TPL
		GLX1			48			10KV SURGE PROTECTOR - 10SP
		GLX1			48			20KV SURGE PROTECTOR - 20SP

U.S. ARCHITECTURAL LIGHTING

JSE
Jordan & Skala Engineers
10375 Richmond Avenue • Suite 300
Houston, TX 77042
p. 281.617.3200 • f. 281.617.3207
Project Number: 24060530
Drawn By: TD Checked By: TD



THIS DRAWING IS THE PROPERTY OF JORDAN & SKALA ENGINEERS INC. AND IS NOT TO BE REPRODUCED IN WHOLE OR IN PART WITHOUT WRITTEN PERMISSION BY JORDAN & SKALA ENGINEERS.

BANNER GATEWAY APARTMENTS
MESA, ARIZONA

PRINT RECORD

DATE	ISSUED FOR
08/16/24	REDZONE SUBMITTAL

REVISIONS

DATE	DESCRIPTION
------	-------------

SHEET TITLE
SITE LIGHT FIXTURE CUT SHEETS

SHEET NUMBER
E1-05

NOT ISSUED FOR CONSTRUCTION