



revisions

- 1
- 2
- 3
- 4

issued for

- design dev. ○
- permit set ●
- bid package ○
- construction ○

date issued 05.26.2020

scale 1:50

drawn by jd, la

checked by ba

project number 217-002-19

sheet number

PLANT MATERIALS LEGEND

Trees	Size	Quantity	Groundcovers	Size	Quantity
Acacia aneura	15 gal.	67	Eremophila prostrata 'Outback Sunrise'	1 gal.	1,361
Mulga Acacia			Outback Sunrise Eremophila		
Chitalpa tashkinensis	15 gal.	23	Lantana montevidensis	1 gal.	3
Chitalpa			Purple Trailing Lantana		
Parkinsonia hyb.	24" box	40	Lantana sp.	1 gal.	474
'Desert Museum' Palo Verde			'New Gold' Lantana		
Phoenix dactylopera	18"	5	Sotressea pallida	1 gal.	7
Date Palm			Purple Heart		
Pistacia atlantica x intergerima	24" box	15	Cacti Accents		
Red Push Pistache			Agave vilmoreniana	15 gal.	5
Prosopis hybrid	15 gal.	21	Octopus Agave		
Thornless Mesquite			Bouteloua gracilis	1 gal.	433
Quercus virginiana	24" box	97	Blond Ambition		
'Cathedral' Oak			Echinocereus grusonii	5 gal.	8
			Golden Barrel		
			Hesperaloe funifera	5 gal.	88
			Giant Hesperaloe		
			Hesperaloe parviflora	3 gal.	233
			'Brakelights' Red Yucca		
			Hesperaloe sp. Pink Parade	3 gal.	373
			Pink Parade Hesperaloe		
			Opuntia ficus indica	8 Pad Min.	19
			Indian Fig Prickly Pear		
			Opuntia santa rita	5 gal.	11
			Purple Prickly Pear		
			Pedilanthus macrocarpus	5 gal.	5
			Slipper Plant		
			Stenocereus thurberi	3 Arm, 4' Min.	10
			Organ Pipe Cactus		
			Yucca pallida	5 gal.	53
			Pale Leaf Yucca		

Extra Large Shrubs	Size	Quantity	Inerts	Quantity
Pistacia lentiscus	15 gal.	3	Decomposed Granite 3" Minus	111,955 s.f.
Mastic			Express Carmel - See Detail 1, Sheet L7.1	26,281 s.f.
Tecoma sp. 'Sparky	5 gal.	241	Turf- Mid-Iron Sod	67 lf.
Sparky			Concrete Header Standard Color and Finish	1,292 s.f.
Vauquelinia californica	5 gal.	75	See Detail 2, Sheet L7.2	
Arizona Rosewood			See Detail 2, Sheet L7.2	
Large Shrubs	Size	Quantity		
Leucophyllum langmaniae 'Lynn's Legacy'	5 gal.	466		
Lynn's Legacy Sage				
Simmondsia Chinensis	5 gal.	249		
Jogoba				
Medium Shrubs	Size	Quantity		
Eremophila hygrophana Blue Bells	5 gal.	508		
Blue Bells				
Ruellia brittoniana	1 gal.	546		
Ruellia				
Small Shrubs	Size	Quantity		
Bougainvillea x Alexandra	5 gal.	23		
Alexandra Bougainvillea				
Russelia equisetiformis	1 gal.	191		
Coral Fountain				

No Symbol	Quantity
Express Carmel - See Detail 1, Sheet L7.1	111,955 s.f.
Turf- Mid-Iron Sod	26,281 s.f.
Concrete Header Standard Color and Finish	67 lf.
Artificial Turf	1,292 s.f.

**LANDSCAPE NOTES:**  
 1. ALL QUANTITIES SHOWN ARE FOR THE LANDSCAPE ARCHITECT'S ESTIMATING AND SUBMITTAL PURPOSES ONLY AND THEREFORE ARE NOT GUARANTEED. THE CONTRACTOR SHALL CALCULATE QUANTITIES BASED ON THIS DRAWING SET AND SHALL CONTACT THE LANDSCAPE ARCHITECT WITH ANY DISCREPANCIES.  
 2. ALL TREE HEIGHTS AND CALIPERS SHALL COMPLY WITH THE LATEST AMENDED EDITION OF THE 'ARIZONA NURSERY ASSOCIATION - RECOMMENDED TREE SPECIFICATIONS' FOR THAT TYPE AND SIZE OF TREE. SEE SECTION 1903(B)(A), ZONING CODE.  
 3. LOCATION OF ALL TREES IN SVT TO BE SURVEYED AND STAKED BY CONTRACTOR. ONCE STAKED, THE LOCATIONS ARE TO BE APPROVED BY CITY TRANSPORTATION DEPARTMENT PRIOR TO INSTALLATION. ALL TREES LOCATED IN THE SVT ARE OF SPECIES THAT WHEN FULLY MATURE WILL HAVE A TRUNK DIAMETER OF LESS THAN 12". BY TIME OF SCHEDULED COMPLETION, ALL TREES IN SVT TO BE PRUNED TO 8'-0" AS MEASURED FROM TOP OF CURB OR SIDEWALK. TREES WITH CANOPY OVER PAVEMENT SHALL BE PRUNED TO 14'-0" AS MEASURED FROM THE HIGHEST POINT OF ADJACENT PAVEMENT. ALL TREES LOCATED WITHIN SVT TO BE 30' BOX AND STANDARD TRUNKS.  
 4. ALL TREES AND SHRUBS LOCATED IN THE LINE-OF-SIGHT/SIGHT VISIBILITY TRIANGLES WILL BE MAINTAINED FOR A CLEAR AREA BETWEEN 3' AND 7'.  
 5. ALL BACKFLOW PREVENTERS 2" OR LARGER SHALL BE SCREENED WITH LANDSCAPE MATERIALS LOCATED WITHIN A 6' RADIIUS OF THE BACKFLOW PREVENTER. ALL BACKFLOW PREVENTERS 2" SHALL BE PLACED IN A WIRE MESH BASKET AND PAINTED GREEN (CITY OF MESA HAS REQUESTED THE CHANGE TO GREEN TO DISCOURAGE THEFT).  
 6. ALL LANDSCAPE MATERIAL INSTALLED SHALL BE MAINTAINED BY OWNER/OR LESSEE IN ACCORDANCE WITH THE APPROVED LANDSCAPE PLAN.  
 7. ALL TRACTS SHALL BE OWNED AND MAINTAINED BY THE HOMEOWNER'S ASSOCIATION.  
 8. NO TREES ARE TO BE PLANTED WITHIN 6'-0" OF ANY WATER METER BOX PER CITY OF MESA DETAILS M-49.01, M-103.2, AND M-103.3.

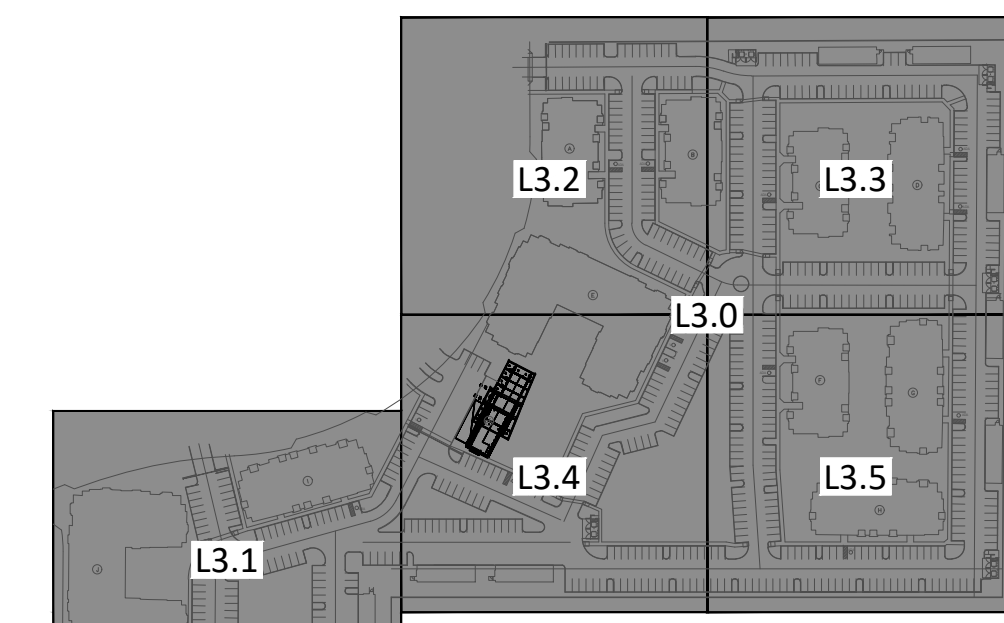

Key Map Not To Scale

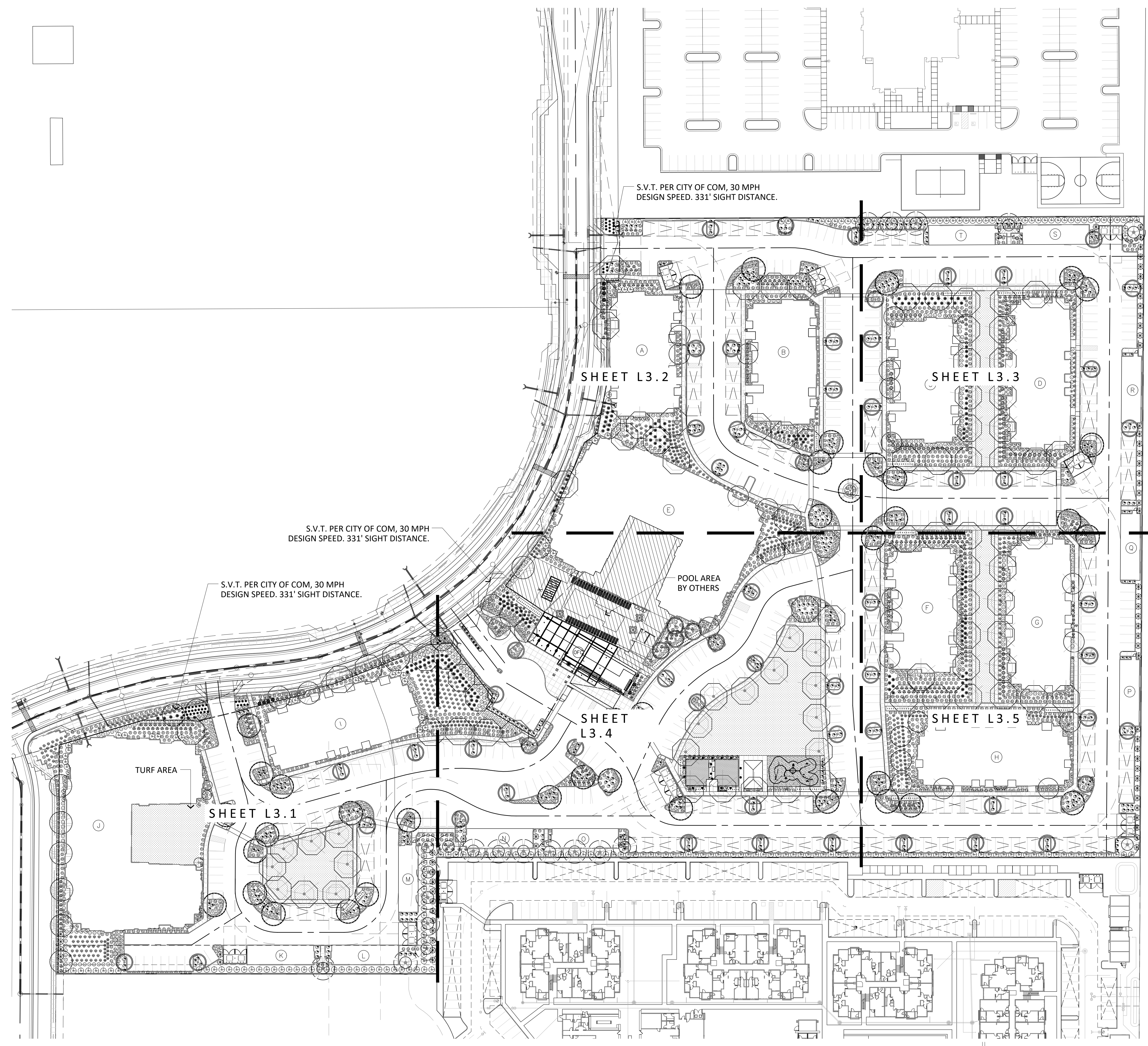

© copyright 2020 anderson design company, llc





revisions

- 1
- 2
- 3
- 4

issued for

- design dev.
- permit set
- bid package
- construction

date issued 05.26.2020

scale 1:20

drawn by jd, la

checked by ba

project number 217-002-19

sheet number

PLANT MATERIALS LEGEND

Trees	Size	Quantity	Groundcovers	Size	Quantity
Acacia aneura	15 gal.	67	Eremophila prostrata 'Outback Sunrise'	1 gal.	1,361
Mulga Acacia			Outback Sunrise Eremophila		
Chilopa tashkinensis	15 gal.	23	Lantana montevidensis	1 gal.	3
Chilopa			Purple Trailing Lantana		
Parkinsonia hyb.	24" box	40	Lantana sp.	1 gal.	474
'Desert Museum' Palo Verde			'New Gold' Lantana		
Phoenix dactylifera	18'	5	Setcreasea pallida	1 gal.	7
Date Palm			Purple Heart		
Pistacia atlantica x intergerima	24" box	15	Cacti/ Accents		
Red Pash Pistache			Agave vilmoreniana	15 gal.	5
Prosopis hybrid	15 gal.	21	Octopus Agave		
Thornless Mesquite			Bouteloua gracilis	1 gal.	433
Quercus virginiana	24" box	97	Blond Ambition		
'Cathedral' Oak			Echinocereus grusonii	5 gal.	8
			Golden Barrel		
			Hesperaloe funifera	5 gal.	88
			Giant Hesperaloe		
			Hesperaloe parviflora	3 gal.	233
			'Brakelights' Red Yucca		
			Hesperaloe sp. Pink Parade	3 gal.	373
			Pink Parade Hesperaloe		
			Opuntia ficus indica	8 Pad Min.	19
			Indian Fig Prickly Pear		
			Opuntia santa rita	5 gal.	11
			Purple Prickly Pear		
			Pedicularis macrocarpus	5 gal.	5
			Slipper Plant		
			Stenocereus thurberi	3 Arm, 4' Min.	10
			Organ Pipe Cactus		
			Yucca pallida	5 gal.	53
			Pale Leaf Yucca		

Extra Large Shrubs	Size	Quantity	Inerts	Quantity
Pistacia lentiscus	15 gal.	3	Decomposed Granite 3" Minus	111,955 s.f.
Mastic			Express Carmel - See Detail 1, Sheet L7.1	111,955 s.f.
Tecoma sp. 'Sparky	5 gal.	241	Turf- Mid-Iron Sod	26,281 s.f.
Sparky			See Detail 3, Sheet L7.2	26,281 s.f.
Vauquelinia californica	5 gal.	75	Concrete Header Standard Color and Finish	67 lf.
Arizona Rosewood			See Detail 2, Sheet L7.2	
Large Shrubs	Size	Quantity	Artificial Turf	1,292 s.f.
Leucophyllum langmaniae 'Lynn's Legacy'	5 gal.	466		
Lynn's Legacy Sage				
Simmondsia Chinensis	5 gal.	249		
Jogoba				
Medium Shrubs	Size	Quantity		
Eremophila hygrophana Blue Bells	5 gal.	508		
Blue Bells				
Ruellia brittoniana	1 gal.	546		
Ruellia				
Small Shrubs	Size	Quantity		
Bougainvillea x Alexandra	5 gal.	23		
Alexandra Bougainvillea				
Russelia equisetiformis	1 gal.	191		
Coral Fountain				

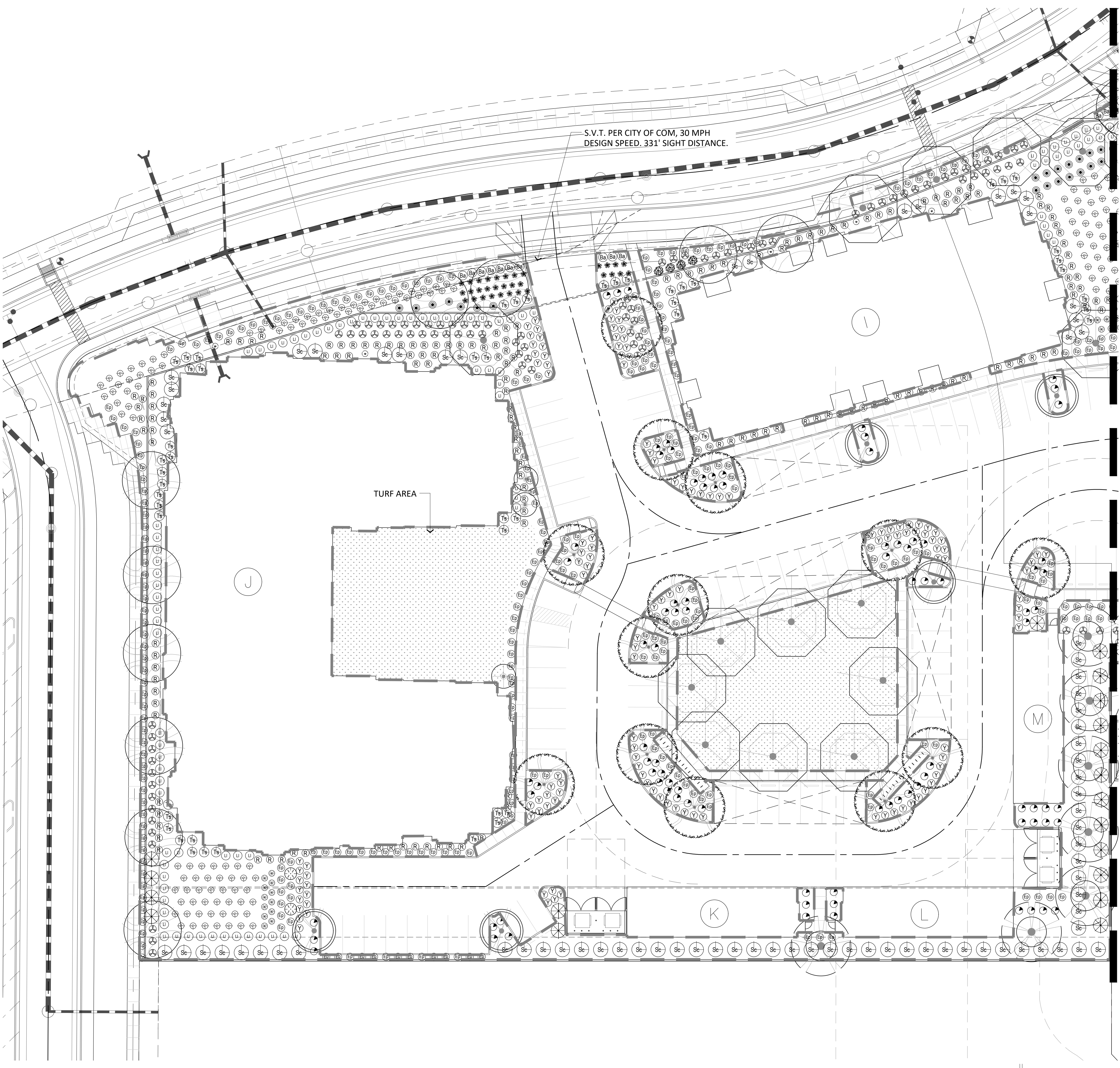

S.V.T. PER CITY OF COM, 30 MPH  
DESIGN SPEED, 331' SIGHT DISTANCE.

TURF AREA

MATCHLINE - SEE SHEET L3.4

- LANDSCAPE NOTES:**
1. ALL QUANTITIES SHOWN ARE FOR THE LANDSCAPE ARCHITECT'S ESTIMATING AND SUBMITTAL PURPOSES ONLY AND THEREFORE ARE NOT GUARANTEED. THE CONTRACTOR SHALL CALCULATE QUANTITIES BASED ON THIS DRAWING SET AND SHALL CONTACT THE LANDSCAPE ARCHITECT WITH ANY DISCREPANCIES.
  2. ALL TREE HEIGHTS AND CALIPERS SHALL COMPLY WITH THE LATEST AMENDED EDITION OF THE 'ARIZONA NURSERY ASSOCIATION - RECOMMENDED TREE SPECIFICATIONS' FOR THAT TYPE AND SIZE OF TREE. SEE SECTION 190306(A), ZONING CODE.
  3. LOCATION OF ALL TREES IN SVT TO BE SURVEYED AND STAKED BY CONTRACTOR. ONCE STAKED, THE LOCATIONS ARE TO BE APPROVED BY CITY TRANSPORTATION DEPARTMENT PRIOR TO INSTALLATION. ALL TREES LOCATED IN THE SVT ARE OF SPECIES THAT WHEN FULLY MATURE WILL HAVE A TRUNK DIAMETER OF LESS THAN 12". BY TIME OF SCHEDULED COMPLETION, ALL TREES IN SVT TO BE PRUNED TO 8'-0" AS MEASURED FROM TOP OF CURB OR SIDEWALK. TREES WITH CANOPY OVER PAVEMENT SHALL BE PRUNED TO 14'-0" AS MEASURED FROM THE HIGHEST POINT OF ADJACENT PAVEMENT. ALL TREES LOCATED WITHIN SVT TO BE 30" BOX AND STANDARD TRUNKS.
  4. ALL TREES AND SHRUBS LOCATED IN THE LINE-OF-SIGHT/SIGHT VISIBILITY TRIANGLES WILL BE MAINTAINED FOR A CLEAR AREA BETWEEN 3' AND 7'.
  5. ALL BACKFLOW PREVENTERS 2" OR LARGER SHALL BE SCREENED WITH LANDSCAPE MATERIALS LOCATED WITHIN A 6' RADIUS OF THE BACKFLOW PREVENTER. ALL BACKFLOW PREVENTER SHALL BE PLACED IN A WIRE MESH BASKET AND PAINTED GREEN (CITY OF MESA HAS REQUESTED THE CHANGE TO GREEN TO DISCOURAGE THEFT).
  6. ALL LANDSCAPE MATERIAL INSTALLED SHALL BE MAINTAINED BY OWNER/OR LESSEE IN ACCORDANCE WITH THE APPROVED LANDSCAPE PLAN.
  7. ALL TRACTS SHALL BE OWNED AND MAINTAINED BY THE HOMEOWNER'S ASSOCIATION.
  8. NO TREES ARE TO BE PLANTED WITHIN 6'-0" OF ANY WATER METER BOX PER CITY OF MESA DETAILS M-49.01, M-103.2, AND M-103.3.

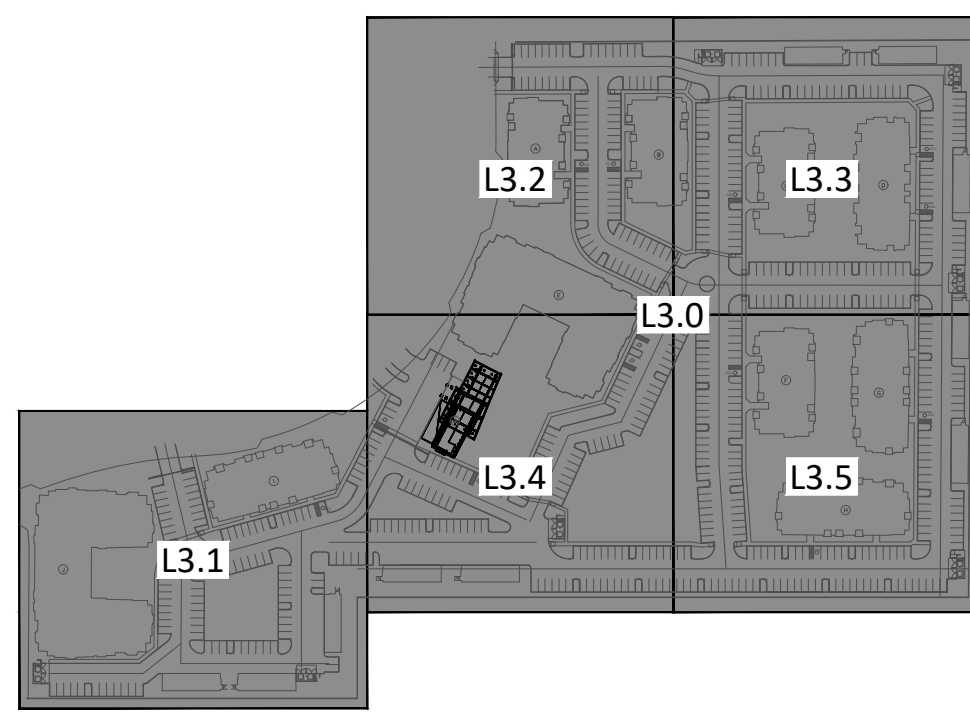

Key Map Not To Scale





revisions

- 1
- 2
- 3
- 4

issued for  
design dev.   
permit set   
bid package   
construction

date issued 05.26.2020

scale 1:20

drawn by jd, la

checked by ba

project number 217-002-19

sheet number

PLANT MATERIALS LEGEND

Trees	Size	Quantity	Groundcovers	Size	Quantity
Acacia aneura	15 gal.	67	Eremophila prostrata 'Outback Sunrise'	1 gal.	1,361
Mulga Acacia			Outback Sunrise Eremophila		
Chilalpa tashkinensis	15 gal.	23	Lantana montevidensis	1 gal.	3
Chilalpa			Purple Trailing Lantana		
Parkinsonia hyb.	24" box	40	Lantana sp.	1 gal.	474
'Desert Museum' Palo Verde			'New Gold' Lantana		
Phoenix dactyloflera	18"	5	Sotressea pallida	1 gal.	7
Date Palm			Purple Heart		
Pistacia atlantica x intergerima	24" box	15	Cacti/ Accents		
Red Push Pistache			Agave vilmoreniana	15 gal.	5
Prosopis hybrid	15 gal.	21	Octopus Agave		
Thornless Mesquite			Bouteloua gracilis	1 gal.	433
Quercus virginiana	24" box	97	Blond Ambition		
'Cathedral' Oak			Echinocereus grusonii	5 gal.	8
			Golden Barrel		
			Hesperaloe funifera	5 gal.	88
			Giant Hesperaloe		
			Hesperaloe parviflora	3 gal.	233
			'Brakelights' Red Yucca		
			Hesperaloe sp. Pink Parade	3 gal.	373
			Pink Parade Hesperaloe		
			Opuntia ficus indica	8 Pad Min.	19
			Indian Fig Prickly Pear		
			Opuntia santa rita	5 gal.	11
			Purple Prickly Pear		
			Pedilanthus macrocarpus	5 gal.	5
			Slipper Plant		
			Stenocereus thurberi	3 Arm, 4' Min.	10
			Organ Pipe Cactus		
			Yucca pallida	5 gal.	53
			Pale Leaf Yucca		

Extra Large Shrubs	Size	Quantity
Pistacia lentiscus	15 gal.	3
Mastic		
Tecoma sp. 'Sparky'	5 gal.	241
Sparky		
Vauquelinia californica	5 gal.	75
Arizona Rosewood		
Large Shrubs	Size	Quantity
Leucophyllum langmaniae 'Lynn's Legacy'	5 gal.	466
Lynn's Legacy Sage		
Medium Shrubs	Size	Quantity
Simmondsia Chinensis	5 gal.	249
Jogoba		
Eremophila hygrophana Blue Bells	5 gal.	508
Blue Bells		
Ruellia brittoniana	1 gal.	546
Ruellia		
Small Shrubs	Size	Quantity
Bougainvillea x Alexandra	5 gal.	23
Alexandra Bougainvillea		
Russelia equisetiformis	1 gal.	191
Coral Fountain		
Inerts	Quantity	
Decomposed Granite 3" Minus	111,955 s.f.	
Express Carmel - See Detail 1, Sheet L7.1		
Turf-Mid-Iron Sod	26,281 s.f.	
See Detail 3, Sheet L7.2		
Concrete Header Standard Color and Finish	67 lf.	
See Detail 2, Sheet L7.2		
Artificial Turf	1,292 s.f.	

MATCHLINE - SEE SHEET L3.3

LANDSCAPE NOTES:

1. ALL QUANTITIES SHOWN ARE FOR THE LANDSCAPE ARCHITECT'S ESTIMATING AND SUBMITTAL PURPOSES ONLY AND THEREFORE ARE NOT GUARANTEED. THE CONTRACTOR SHALL CALCULATE QUANTITIES BASED ON THIS DRAWING SET AND SHALL CONTACT THE LANDSCAPE ARCHITECT WITH ANY DISCREPANCIES.
2. ALL TREE HEIGHTS AND CALIPERS SHALL COMPLY WITH THE LATEST AMENDED EDITION OF THE 'ARIZONA NURSERY ASSOCIATION - RECOMMENDED TREE SPECIFICATIONS' FOR THAT TYPE AND SIZE OF TREE. SEE SECTION 190306(A), ZONING CODE.
3. LOCATION OF ALL TREES IN SVT TO BE SURVEYED AND STAKED BY CONTRACTOR. ONCE STAKED, THE LOCATIONS ARE TO BE APPROVED BY CITY TRANSPORTATION DEPARTMENT PRIOR TO INSTALLATION. ALL TREES LOCATED IN THE SVT ARE OF SPECIES THAT WHEN FULLY MATURE WILL HAVE A TRUNK DIAMETER OF LESS THAN 12". BY TIME OF SCHEDULED COMPLETION, ALL TREES IN SVT TO BE PRUNED TO 8'-0" AS MEASURED FROM TOP OF CURB OR SIDEWALK. TREES WITH CANOPY OVER PAVEMENT SHALL BE PRUNED TO 14'-0" AS MEASURED FROM THE HIGHEST POINT OF ADJACENT PAVEMENT. ALL TREES LOCATED WITHIN SVT TO BE 30" BOX AND STANDARD TRUNKS.
4. ALL TREES AND SHRUBS LOCATED IN THE LINE-OF-SIGHT/SIGHT VISIBILITY TRIANGLES WILL BE MAINTAINED FOR A CLEAR AREA BETWEEN 3' AND 7'.
5. ALL BACKFLOW PREVENTERS 2" OR LARGER SHALL BE SCREENED WITH LANDSCAPE MATERIALS LOCATED WITHIN A 6' RADIUS OF THE BACKFLOW PREVENTER. ALL BACKFLOW PREVENTER SHALL BE PLACED IN A WIRE MESH BASKET AND PAINTED GREEN (CITY OF MESA HAS REQUESTED THE CHANGE TO GREEN TO DISCOURAGE THEFT).
6. ALL LANDSCAPE MATERIAL INSTALLED SHALL BE MAINTAINED BY OWNER/OR LESSEE IN ACCORDANCE WITH THE APPROVED LANDSCAPE PLAN.
7. ALL TRACTS SHALL BE OWNED AND MAINTAINED BY THE HOMEOWNER'S ASSOCIATION.
8. NO TREES ARE TO BE PLANTED WITHIN 6'-0" OF ANY WATER METER BOX PER CITY OF MESA DETAILS M-49.01, M-103.2, AND M-103.3.

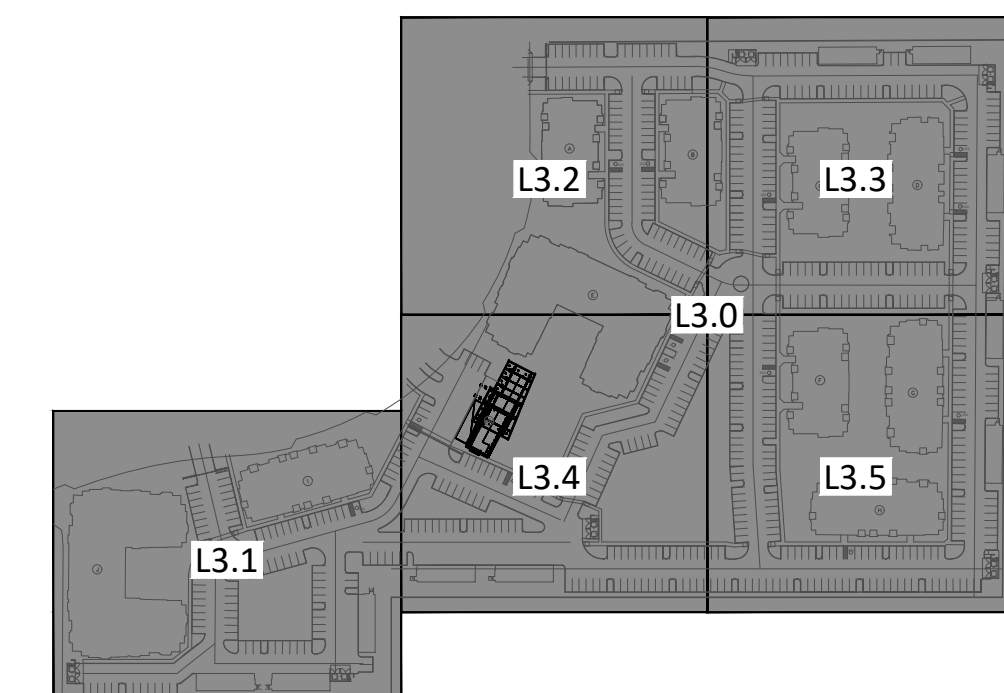

Key Map

Not To Scale

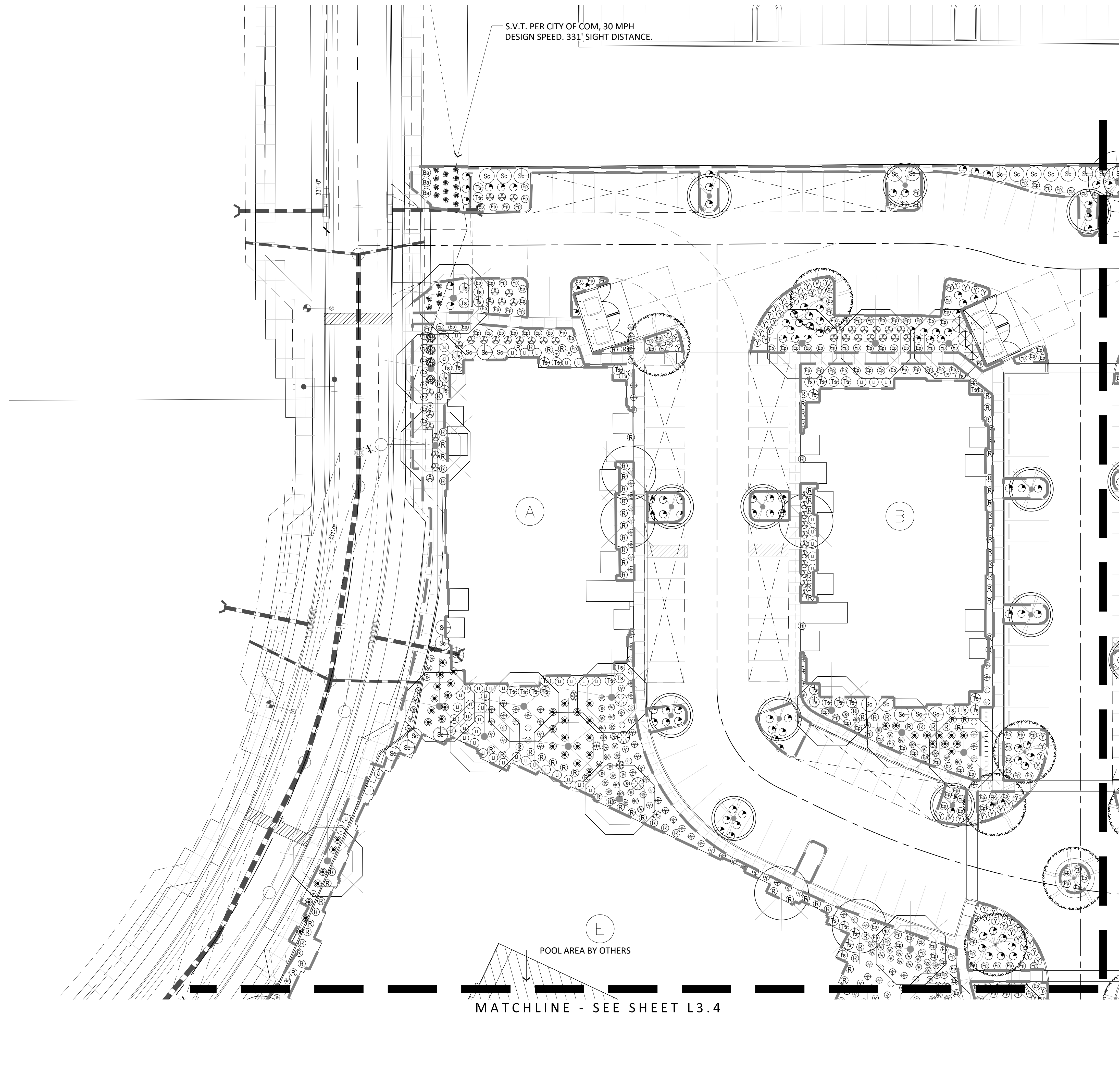

MATCHLINE - SEE SHEET L3.4

A

B

E

POOL AREA BY OTHERS

PLANT MATERIALS LEGEND

Trees	Size	Quantity	Groundcovers	Size	Quantity
Acacia aneura	15 gal.	67	Eremophila prostrata 'Outback Sunrise'	1 gal.	1,361
Mulga Acacia			Outback Sunrise Eremophila		
Chitalpa tashkinensis	15 gal.	23	Lantana montevidensis	1 gal.	3
Chitalpa			Purple Trailing Lantana		
Parkinsonia hyb.	24" box	40	Lantana sp.	1 gal.	474
'Desert Museum' Palo Verde			'New Gold' Lantana		
Phoenix dactylopera	18"	5	Sotressea pallida	1 gal.	7
Date Palm			Purple Heart		
Pistacia atlantica x intergerima	24" box	15	Cacti Accents		
Red Push Pistache			Agave vilmoreniana	15 gal.	5
Prosopis hybrid	15 gal.	21	Octopus Agave		
Thornless Mesquite			Bouteloua gracilis	1 gal.	433
Quercus virginiana	24" box	97	Blond Ambition		
'Cathedral' Oak			Echinocereus grusonii	5 gal.	8
			Golden Barrel		
			Hesperaloe funifera	5 gal.	88
			Giant Hesperaloe		
			Hesperaloe parviflora	3 gal.	233
			'Brakelights' Red Yucca		
			Hesperaloe sp. Pink Parade	3 gal.	373
			Pink Parade Hesperaloe		
			Opuntia ficus indica	8 Pad Min.	19
			Indian Fig Prickly Pear		
			Opuntia santa rita	5 gal.	11
			Purple Prickly Pear		
			Pedilanthus macrocarpus	5 gal.	5
			Slipper Plant		
			Stenocereus thurberi	3 Arm, 4' Min.	10
			Organ Pipe Cactus		
			Yucca pallida	5 gal.	53
			Pale Leaf Yucca		

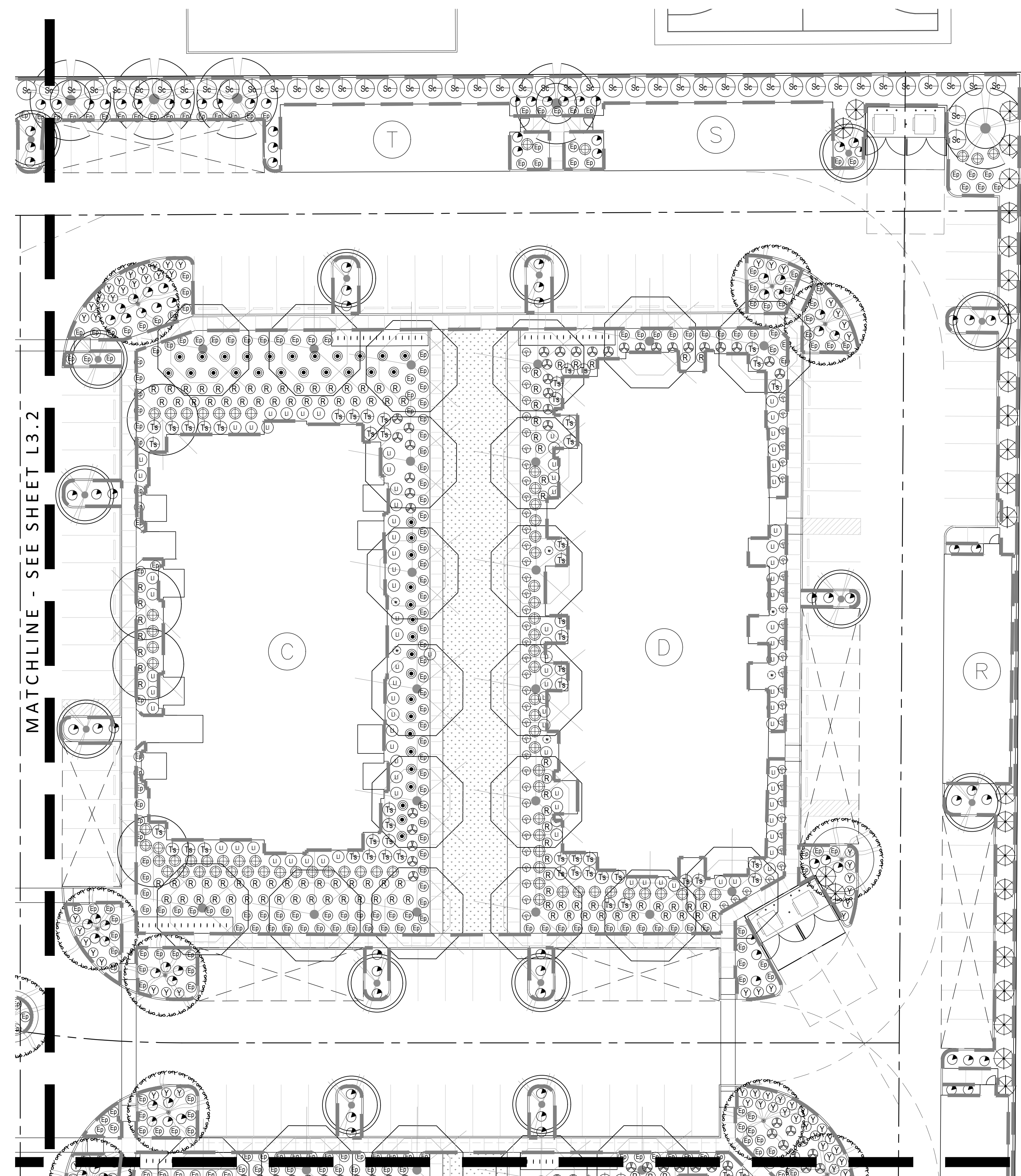

Extra Large Shrubs	Size	Quantity	Medium Shrubs	Size	Quantity
Pistacia lentiscus	15 gal.	3	Eremophila hydrophana Blue Bells	5 gal.	508
Mastic			Blue Bells		
Tecoma sp. 'Sparky	5 gal.	241	Ruellia brittoniana	1 gal.	546
Sparky			Ruellia		
Vauquelinia californica	5 gal.	75	Small Shrubs		
Arizona Rosewood			Bougainvillea x Alexandra	5 gal.	23
Large Shrubs			Alexandra Bougainvillea		
Leucophyllum langmaniae 'Lynn's Legacy'	5 gal.	466	Russelia equistiformis	1 gal.	191
Lynn's Legacy Sage			Coral Fountain		
Simmondsia Chinensis	5 gal.	249	Inerts		
Jogoba			Decomposed Granite 3" Minus	111,955 s.f.	
Medium Shrubs			Express Carmel - See Detail 1, Sheet L7.1		
Eremophila hydrophana Blue Bells	5 gal.	508	Turf, Mid-Iron Sod	26,281 s.f.	
Blue Bells			See Detail 3, Sheet L7.2		
Ruellia brittoniana	1 gal.	546	Concrete Header Standard Color and Finish	67 lf.	
Ruellia			See Detail 2, Sheet L7.2		
Small Shrubs			Artificial Turf	1,292 s.f.	
Bougainvillea x Alexandra	5 gal.	23			
Alexandra Bougainvillea					
Russelia equistiformis	1 gal.	191			
Coral Fountain					

- No Symbol
- Express Carmel - See Detail 1, Sheet L7.1
- Turf, Mid-Iron Sod
- See Detail 3, Sheet L7.2
- Concrete Header Standard Color and Finish
- See Detail 2, Sheet L7.2
- Artificial Turf

**LANDSCAPE NOTES:**

1. ALL QUANTITIES SHOWN ARE FOR THE LANDSCAPE ARCHITECT'S ESTIMATING AND SUBMITTAL PURPOSES ONLY AND THEREFORE ARE NOT GUARANTEED. THE CONTRACTOR SHALL CALCULATE QUANTITIES BASED ON THIS DRAWING SET AND SHALL CONTACT THE LANDSCAPE ARCHITECT WITH ANY DISCREPANCIES.
2. ALL TREE HEIGHTS AND CALIPERS SHALL COMPLY WITH THE LATEST AMENDED EDITION OF THE 'ARIZONA NURSERY ASSOCIATION - RECOMMENDED TREE SPECIFICATIONS' FOR THAT TYPE AND SIZE OF TREE. SEE SECTION 190306(A), ZONING CODE.
3. LOCATION OF ALL TREES IN SVT TO BE SURVEYED AND STAKED BY CONTRACTOR. ONCE STAKED, THE LOCATIONS ARE TO BE APPROVED BY CITY TRANSPORTATION DEPARTMENT PRIOR TO INSTALLATION. ALL TREES LOCATED IN THE SVT ARE OF SPECIES THAT WHEN FULLY MATURE WILL HAVE A TRUNK DIAMETER OF LESS THAN 12". BY TIME OF SCHEDULED COMPLETION, ALL TREES IN SVT TO BE PRUNED TO 8'-0" AS MEASURED FROM TOP OF CURB OR SIDEWALK. TREES WITH CANOPY OVER PAVEMENT SHALL BE PRUNED TO 14'-0" AS MEASURED FROM THE HIGHEST POINT OF ADJACENT PAVEMENT. ALL TREES LOCATED WITHIN SVT TO BE 30" BOX AND STANDARD TRUNKS.
4. ALL TREES AND SHRUBS LOCATED IN THE LINE-OF-SIGHT/SIGHT VISIBILITY TRIANGLES WILL BE MAINTAINED FOR A CLEAR AREA BETWEEN 3' AND 7'.
5. ALL BACKFLOW PREVENTERS 2" OR LARGER SHALL BE SCREENED WITH LANDSCAPE MATERIALS LOCATED WITHIN A 6' RADIIUS OF THE BACKFLOW PREVENTER. ALL BACKFLOW PREVENTER THAN 2" SHALL BE PLACED IN A WIRE MESH BASKET AND PAINTED GREEN (CITY OF MESA HAS REQUESTED THE CHANGE TO GREEN TO DISCOURAGE THEFT).
6. ALL LANDSCAPE MATERIAL INSTALLED SHALL BE MAINTAINED BY OWNER/OR LESSEE IN ACCORDANCE WITH THE APPROVED LANDSCAPE PLAN.
7. ALL TRACTS SHALL BE OWNED AND MAINTAINED BY THE HOMEOWNER'S ASSOCIATION.
8. NO TREES ARE TO BE PLANTED WITHIN 6'-0" OF ANY WATER METER BOX PER CITY OF MESA DETAILS M-49.01, M-103.2, AND M-103.3.

The Premiere at Eastmark 2.0  
Multi-Family  
Mesa, Arizona  
Planting Plan



revisions

1	
2	
3	
4	

issued for

- design dev. ○
- permit set ●
- bid package ○
- construction ○

date issued 05.26.2020

scale 1:20

drawn by jd, la

checked by ba

project number 217-002-19

sheet number

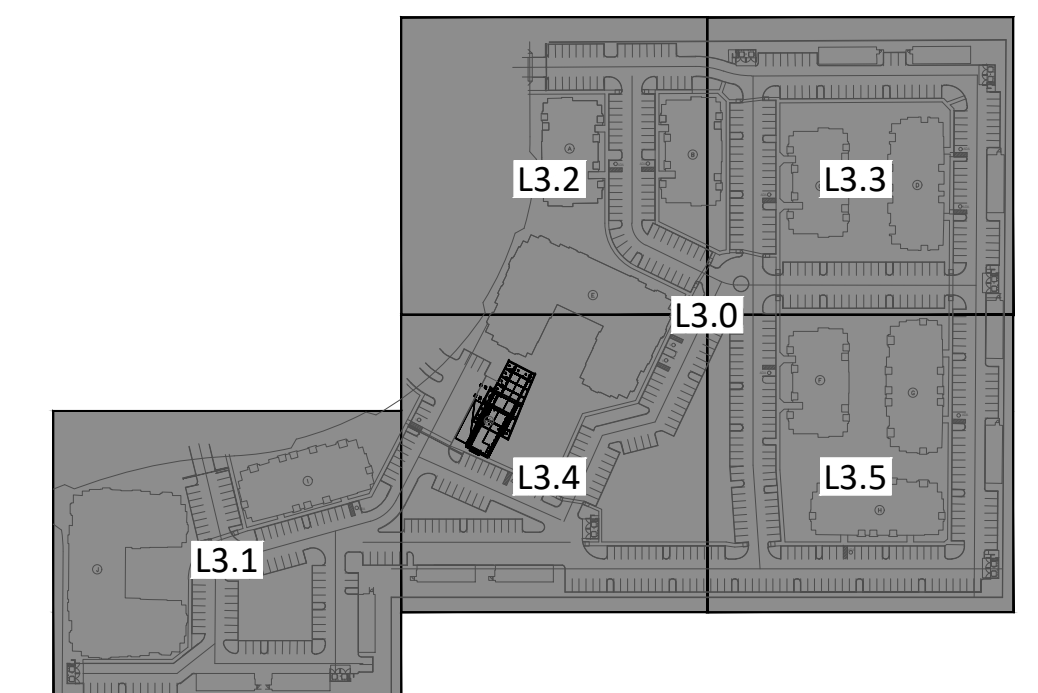

Key Map Not To Scale



S.V.T. PER CITY OF COM, 30 MPH  
DESIGN SPEED. 331' SIGHT DISTANCE.

MATCHLINE - SEE SHEET L3.2

POOL AREA BY OTHERS

MATCHLINE - SEE SHEET L3.5

PLANT MATERIALS LEGEND

Trees	Size	Quantity	Groundcovers	Size	Quantity
Acacia aneura	15 gal.	67	Eremophila prostrata 'Outback Sunrise'	1 gal.	1,361
Mulga Acacia			Outback Sunrise Eremophila		
Chilopa tashkinensis	15 gal.	23	Lantana montevidensis	1 gal.	3
Chilopa			Purple Trailing Lantana		
Parkinsonia hyb.	24" box	40	Lantana sp.	1 gal.	474
Desert Museum Palo Verde			'New Gold' Lantana		
Phoenix dactylopera	18"	5	Setcreasea pallida	1 gal.	7
Date Palm			Purple Heart		
Pistacia atlantica x intergerima	24" box	15	Cacti Accents		
Red Push Pistache			Agave vilmoreniana	15 gal.	5
Prosopis hybrid	15 gal.	21	Octopus Agave		
Thornless Mesquite			Bouteloua gracilis	1 gal.	433
Quercus virginiana	24" box	97	Blond Ambition		
'Cathedral' Oak			Echinocereus grusonii	5 gal.	8
			Golden Barrel		
			Hesperaloe funifera	5 gal.	88
			Giant Hesperaloe		
			Hesperaloe parviflora	3 gal.	233
			'Brakelights' Red Yucca		
			Hesperaloe sp. Pink Parade	3 gal.	373
			Pink Parade Hesperaloe		
			Opuntia ficus indica	8 Pad Min.	19
			Indian Fig Prickly Pear		
			Opuntia santa rita	5 gal.	11
			Purple Prickly Pear		
			Pedilanthus macrocarpus	5 gal.	5
			Slipper Plant		
			Stenocereus thurberi	3 Arm, 4' Min.	10
			Organ Pipe Cactus		
			Yucca pallida	5 gal.	53
			Pale Leaf Yucca		

Extra Large Shrubs	Size	Quantity	Medium Shrubs	Size	Quantity
Pistacia lentiscus	15 gal.	3	Eremophila hygrophana Blue Bells	5 gal.	508
Mastic			Blue Bells		
Tecoma sp. 'Sparky'	5 gal.	241	Ruellia brittoniana	1 gal.	546
Sparky			Ruellia		
Vauquelinia californica	5 gal.	75	Small Shrubs		
Arizona Rosewood			Bougainvillea x Alexandra	5 gal.	23
Large Shrubs			Alexandra Bougainvillea		
Leucophyllum langmaniae 'Lynn's Legacy'	5 gal.	466	Russelia equisetiformis	1 gal.	191
Lynn's Legacy Sage			Coral Fountain		
Simmondsia Chinensis	5 gal.	249	Inerts		
Jogoba			Decomposed Granite 3" Minus	111,955 s.f.	
Medium Shrubs			Express Carmel - See Detail 1, Sheet L7.1		
Eremophila hygrophana Blue Bells	5 gal.	508	Turf-Mid-Iron Sod	26,281 s.f.	
Blue Bells			See Detail 3, Sheet L7.2		
Ruellia brittoniana	1 gal.	546	Concrete Header Standard Color and Finish	67 lf.	
Ruellia			See Detail 2, Sheet L7.2		
Small Shrubs			Artificial Turf	1,292 s.f.	
Bougainvillea x Alexandra	5 gal.	23			
Alexandra Bougainvillea					
Russelia equisetiformis	1 gal.	191			
Coral Fountain					
Inerts					
Decomposed Granite 3" Minus	111,955 s.f.				
Express Carmel - See Detail 1, Sheet L7.1					
Turf-Mid-Iron Sod	26,281 s.f.				
See Detail 3, Sheet L7.2					
Concrete Header Standard Color and Finish	67 lf.				
See Detail 2, Sheet L7.2					
Artificial Turf	1,292 s.f.				

- LANDSCAPE NOTES:**
1. ALL QUANTITIES SHOWN ARE FOR THE LANDSCAPE ARCHITECT'S ESTIMATING AND SUBMITTAL PURPOSES ONLY AND THEREFORE ARE NOT GUARANTEED. THE CONTRACTOR SHALL CALCULATE QUANTITIES BASED ON THIS DRAWING SET AND SHALL CONTACT THE LANDSCAPE ARCHITECT WITH ANY DISCREPANCIES.
  2. ALL TREE HEIGHTS AND CALIPERS SHALL COMPLY WITH THE LATEST AMENDED EDITION OF THE 'ARIZONA NURSERY ASSOCIATION - RECOMMENDED TREE SPECIFICATIONS' FOR THAT TYPE AND SIZE OF TREE. SEE SECTION 1903(B)(A), ZONING CODE.
  3. LOCATION OF ALL TREES IN SVT TO BE SURVEYED AND STAKED BY CONTRACTOR. ONCE STAKED, THE LOCATIONS ARE TO BE APPROVED BY CITY TRANSPORTATION DEPARTMENT PRIOR TO INSTALLATION. ALL TREES LOCATED IN THE SVT ARE OF SPECIES THAT WHEN FULLY MATURE WILL HAVE A TRUNK DIAMETER OF LESS THAN 12". BY TIME OF SCHEDULED COMPLETION, ALL TREES IN SVT TO BE PRUNED TO 8'-0" AS MEASURED FROM TOP OF CURB OR SIDEWALK. TREES WITH CANOPY OVER PAVEMENT SHALL BE PRUNED TO 14'-0" AS MEASURED FROM THE HIGHEST POINT OF ADJACENT PAVEMENT. ALL TREES LOCATED WITHIN SVT TO BE 30" BOX AND STANDARD TRUNKS.
  4. ALL TREES AND SHRUBS LOCATED IN THE LINE-OF-SIGHT/SIGHT VISIBILITY TRIANGLES WILL BE MAINTAINED FOR A CLEAR AREA BETWEEN 3' AND 7'.
  5. ALL BACKFLOW PREVENTERS 2" OR LARGER SHALL BE SCREENED WITH LANDSCAPE MATERIALS LOCATED WITHIN A 6' RADIUS OF THE BACKFLOW PREVENTER. ALL BACKFLOW PREVENTER SHALL BE PLACED IN A WIRE MESH BASKET AND PAINTED GREEN (CITY OF MESA HAS REQUESTED THE CHANGE TO GREEN TO DISCOURAGE THEFT).
  6. ALL LANDSCAPE MATERIAL INSTALLED SHALL BE MAINTAINED BY OWNER/OR LESSEE IN ACCORDANCE WITH THE APPROVED LANDSCAPE PLAN.
  7. ALL TRACTS SHALL BE OWNED AND MAINTAINED BY THE HOMEOWNER'S ASSOCIATION.
  8. NO TREES ARE TO BE PLANTED WITHIN 6'-0" OF ANY WATER METER BOX PER CITY OF MESA DETAILS M-49.01, M-103.2, AND M-103.3.

anderson

815 N 1st St  
Phoenix, AZ 85003  
602 682 6070

Client:  
PCS Development LLC

8802 E. Diamond Rim Dr.  
Scottsdale, AZ 85255

The Premiere at Eastmark 2.0  
Multi-Family  
Mesa, Arizona  
Planting Plan



revisions

1	
2	
3	
4	

issued for  
design dev. ○  
permit set ●  
bid package ○  
construction ○

date issued 05.26.2020  
scale 1:20  
drawn by jd, la  
checked by ba  
project number 217-002-19  
sheet number

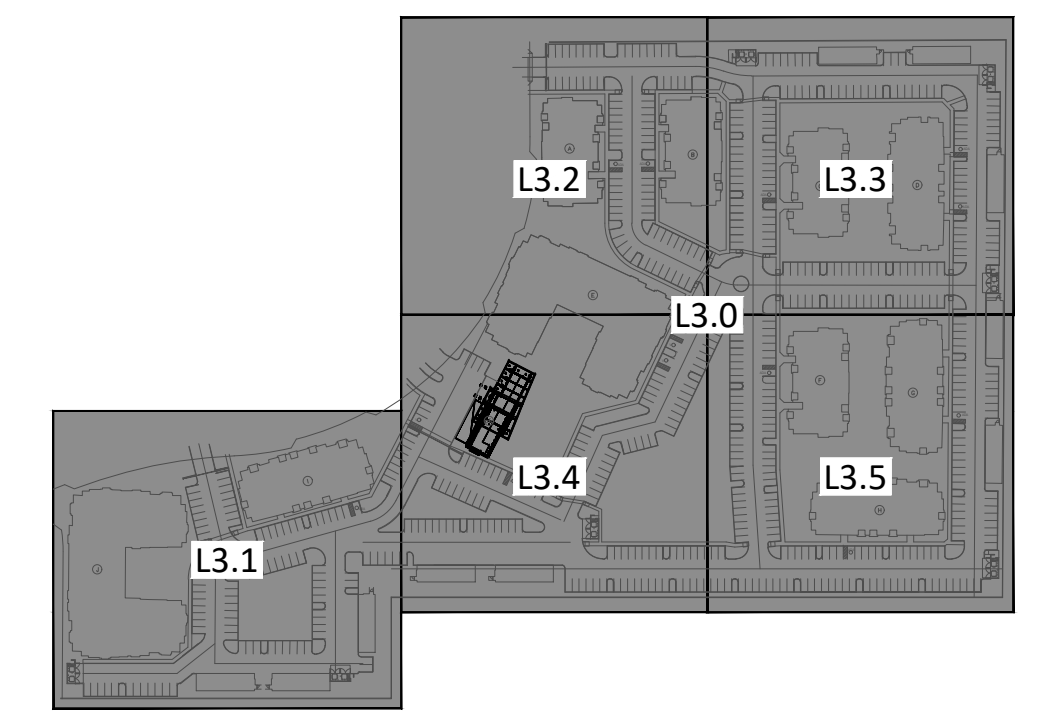

Key Map Not To Scale

L3.4





Client:

**PCS Development LLC**

8802 E. Diamond Rim Dr.  
Scottsdale, AZ 85255

**The Premiere at Eastmark 2.0**  
**Multi-Family**  
Mesa, Arizona  
**Planting Plan**

**PLANT MATERIALS LEGEND**

Trees	Size	Quantity	Groundcovers	Size	Quantity
Acacia aneura	15 gal.	67	Eremophila prostrata 'Outback Sunrise'	1 gal.	1,361
Mulga Acacia			Outback Sunrise Eremophila		
Chitalpa tashkinensis	15 gal.	23	Lantana montevidensis	1 gal.	3
Chitalpa			Purple Trailing Lantana		
Parkinsonia hyb.	24" box	40	Lantana sp.	1 gal.	474
'Desert Museum' Palo Verde			'New Gold' Lantana		
Phoenix dactyloflera	18"	5	Setcreasea pallida	1 gal.	7
Date Palm			Purple Heart		
Pistacia atlantica x intergerima	24" box	15	Cacti Accents		
Red Push Pistache			Agave vilmoreniana	15 gal.	5
Prosopis hybrid	15 gal.	21	Octopus Agave		
Thornless Mesquite			Bouteloua gracilis	1 gal.	433
Quercus virginiana	24" box	97	Blond Ambition		
'Cathedral' Oak			Echinocereus grusonii	5 gal.	8
			Golden Barrel		
			Hesperaloe funifera	5 gal.	88
			Giant Hesperaloe		
			Hesperaloe parviflora	3 gal.	233
			'Brakelights' Red Yucca		
			Hesperaloe sp. Pink Parade	3 gal.	373
			Pink Parade Hesperaloe		
			Opuntia ficus indica	8 Pad Min.	19
			Indian Fig Prickly Pear		
			Opuntia santa rita	5 gal.	11
			Purple Prickly Pear		
			Pedilanthus macrocarpus	5 gal.	5
			Slipper Plant		
			Stenocereus thurberi	3 Arm, 4' Min.	10
			Organ Pipe Cactus		
			Yucca pallida	5 gal.	53
			Pale Leaf Yucca		

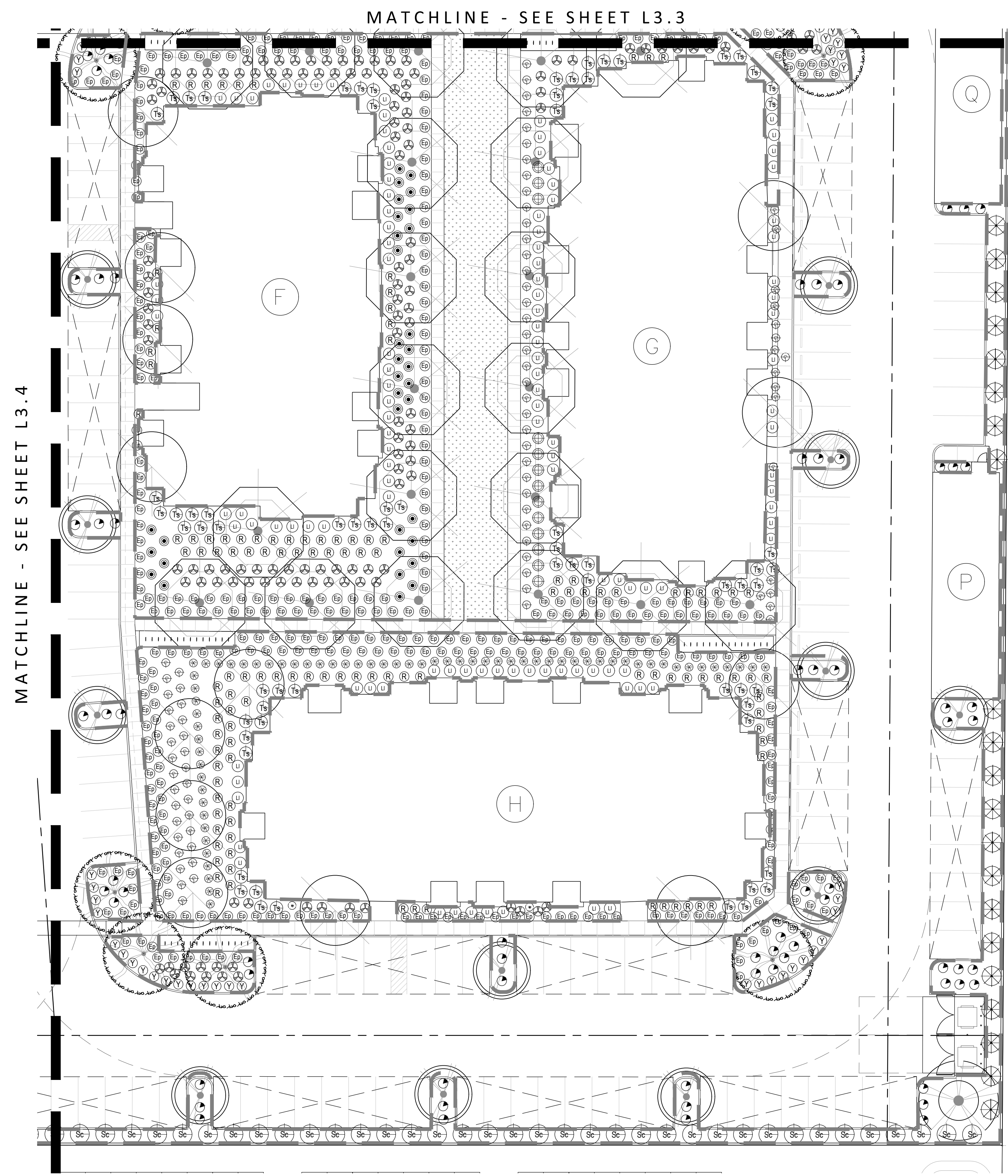

**LANDSCAPE NOTES:**  
 1. ALL QUANTITIES SHOWN ARE FOR THE LANDSCAPE ARCHITECT'S ESTIMATING AND SUBMITTAL PURPOSES ONLY AND THEREFORE ARE NOT GUARANTEED. THE CONTRACTOR SHALL CALCULATE QUANTITIES BASED ON THIS DRAWING SET AND SHALL CONTACT THE LANDSCAPE ARCHITECT WITH ANY DISCREPANCIES.  
 2. ALL TREE HEIGHTS AND CALIPERS SHALL COMPLY WITH THE LATEST AMENDED EDITION OF THE 'ARIZONA NURSERY ASSOCIATION - RECOMMENDED TREE SPECIFICATIONS' FOR THAT TYPE AND SIZE OF TREE. SEE SECTION 1903(B)(A), ZONING CODE.  
 3. LOCATION OF ALL TREES IN SVT TO BE SURVEYED AND STAKED BY CONTRACTOR. ONCE STAKED, THE LOCATIONS ARE TO BE APPROVED BY CITY TRANSPORTATION DEPARTMENT PRIOR TO INSTALLATION. ALL TREES LOCATED IN THE SVT ARE OF SPECIES THAT WHEN FULLY MATURE WILL HAVE A TRUNK DIAMETER OF LESS THAN 12". BY TIME OF SCHEDULED COMPLETION, ALL TREES IN SVT TO BE PRUNED TO 8'-0" AS MEASURED FROM TOP OF CURB OR SIDEWALK. TREES WITH CANOPY OVER PAVEMENT SHALL BE PRUNED TO 14'-0" AS MEASURED FROM THE HIGHEST POINT OF ADJACENT PAVEMENT. ALL TREES LOCATED WITHIN SVT TO BE 30" BOX AND STANDARD TRUNKS.  
 4. ALL TREES AND SHRUBS LOCATED IN THE LINE-OF-SIGHT/SIGHT VISIBILITY TRIANGLES WILL BE MAINTAINED FOR A CLEAR AREA BETWEEN 3' AND 7'.  
 5. ALL BACKFLOW PREVENTERS 2" OR LARGER SHALL BE SCREENED WITH LANDSCAPE MATERIALS LOCATED WITHIN A 6' RADIIUS OF THE BACKFLOW PREVENTER. ALL BACKFLOW PREVENTER SHALL BE PLACED IN A WIRE MESH BASKET AND PAINTED GREEN (CITY OF MESA HAS REQUESTED THE CHANGE TO GREEN TO DISCOURAGE THEFT).  
 6. ALL LANDSCAPE MATERIAL INSTALLED SHALL BE MAINTAINED BY OWNER/OR LESSEE IN ACCORDANCE WITH THE APPROVED LANDSCAPE PLAN.  
 7. ALL TRACTS SHALL BE OWNED AND MAINTAINED BY THE HOMEOWNER'S ASSOCIATION.  
 8. NO TREES ARE TO BE PLANTED WITHIN 6'-0" OF ANY WATER METER BOX PER CITY OF MESA DETAILS M-49.01, M-103.2, AND M-103.3.

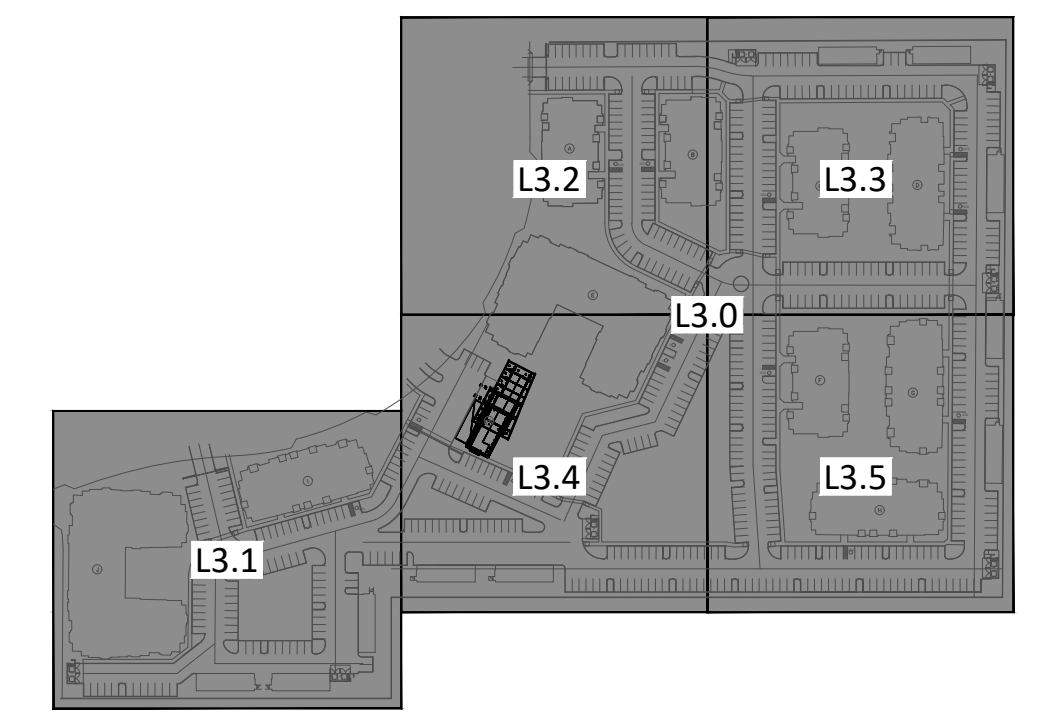

**revisions**

1	
2	
3	
4	

**issued for**

design dev.	○
permit set	●
bid package	○
construction	○

**date issued** 05.26.2020

**scale** 1:20

**drawn by** jd, la

**checked by** ba

**project number** 217-002-19

**sheet number**

