

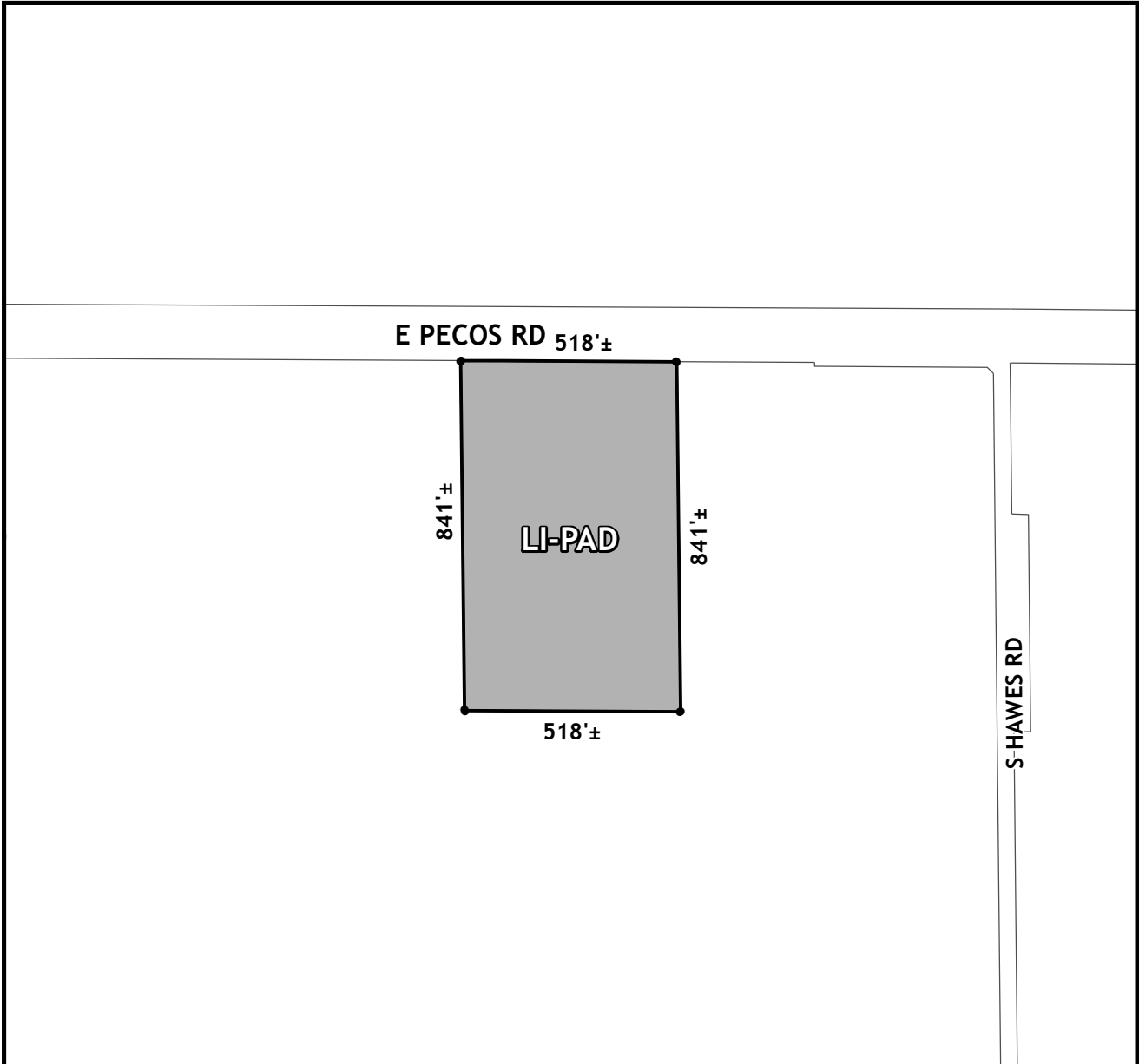

OFFICIAL SUPPLEMENTARY ZONING MAP AMENDING THE CITY OF MESA ZONING MAP



CASE: ZON24-00137
ACREAGE: 10±
REQUEST: Rezone from Light Industrial (LI) to LI with a Planned Area Development Overlay (LI-PAD) and Site Plan Modification.

ORDINANCE: 5867

Please be advised that the attached zoning changes were approved by the Mesa City Council on August 26, 2024 by Ordinance #5867. If you have any questions concerning these changes, contact the City of Mesa Planning Division at 480-644-2385.

_____ ATTEST: _____ DATE: _____
MAYOR CITY CLERK