

FILE LOCATION: S:\BPH\2024\002024\1000\RECKER GARDENS\DWG\LANDSCAPE\PRELIM\RYLT01.DWG

GARDENS AT RECKER

MESA, ARIZONA

PRELIMINARY LANDSCAPE PLAN

SOUTHWEST QUARTER OF SECTION 24, TOWNSHIP 1 NORTH,
RANGE 6 EAST, OF THE GILA AND SALT RIVER BASE AND MERIDIAN,
MARICOPA COUNTY, ARIZONA

GENERAL NOTES

- PRIOR TO BEGINNING ANY WORK ON THE SITE, THE CONTRACTOR SHALL CONTACT THE OFFICE OF THE OWNER'S REPRESENTATIVE FOR SPECIFIC INSTRUCTIONS RELEVANT TO THE SEQUENCING OF WORK.
- READ THOROUGHLY AND BECOME FAMILIAR WITH THE DRAWINGS, NOTATIONS, DETAILS AND SPECIFICATIONS FOR THIS AND RELATED WORK PRIOR TO CONSTRUCTION.
- LANDSCAPE NOTES AND LANDSCAPE DETAILS PROVIDED APPLY FOR ENTIRE SCOPE OF WORK SHOWN ON LANDSCAPE PLANS.
- LANDSCAPE CONTRACTOR SHALL PROVIDE ALL LABOR, MATERIALS AND SERVICES NECESSARY TO FURNISH AND INSTALL LANDSCAPE ELEMENTS AND PLANTINGS AS SPECIFIED HEREIN AND AS SHOWN ON THESE PLANS.
- REPORT ANY DISCREPANCIES IN THE LANDSCAPE PLANS IMMEDIATELY TO THE OWNER/ OWNER'S REPRESENTATIVE.
- NO MATERIAL SUBSTITUTIONS SHALL BE MADE WITHOUT LANDSCAPE ARCHITECT'S APPROVAL. ALTERNATE MATERIALS OF SIMILAR SIZE AND CHARACTER MAY BE CONSIDERED IF SPECIFIED PLANT MATERIALS CANNOT BE OBTAINED. OWNER'S REPRESENTATIVE RESERVES THE RIGHT TO REVISE PLANT LIST AS DEEMED NECESSARY.
- ALL PLANT LOCATIONS ARE APPROXIMATE, ADJUST AS NECESSARY TO AVOID CONFLICTS.
- QUANTITIES OF MATERIALS SHOWN IN PLANT SCHEDULE TAKE PRECEDENCE OVER QUANTITIES SHOWN ON THE LANDSCAPE PLAN. LANDSCAPE CONTRACTOR SHALL BE RESPONSIBLE FOR VERIFYING ALL QUANTITIES IN PLANT SCHEDULE.
- CONTRACTOR SHALL LOCATE ALL UTILITIES BEFORE WORK. UTILITIES HAVE BEEN SHOWN ON PLAN FOR ROUGH LOCATION OF SERVICES. LOCATE EXACT UTILITY LOCATIONS BY CONTACTING "CALL BEFORE YOU DIG" AT (800) 922-1987 OR 811. CONTRACTOR WILL BE RESPONSIBLE FOR THE REPAIR OF ANY DAMAGE CAUSED TO UTILITIES.
- REMOVE ALL RUBBISH, EQUIPMENT AND MATERIAL AND LEAVE THE AREA IN A NEAT, CLEAN CONDITION EACH DAY. MAINTAIN PAVED AREAS UTILIZED FOR HAULING EQUIPMENT AND MATERIALS BY OTHER TRADES IN A CLEAN AND UNOBSTRUCTED CONDITION AT ALL TIMES.
- STORAGE OF ANY MATERIALS, BUILDINGS, VEHICLES OR EQUIPMENT, FENCING AND WARNING SIGNS SHALL BE MAINTAINED THROUGHOUT THE SITE WORK AND CONSTRUCTION PERIODS BY THE CONTRACTOR.
- A 5' DIAMETER CLEAR SPACE SHALL BE MAINTAINED AROUND ALL FIRE HYDRANTS.

PLANT SCHEDULE

SYMBOL	CODE	QTY	BOTANICAL / COMMON NAME	PLANT SIZE	CONTAINER	MAT. H.	MAT. W.
DECIDUOUS TREES							
	OE	17	OLEA EUROPAEA 'FRUITLESS' FRUITLESS OLIVE	24" BOX	CONT.	30"	25"
	QV	3	QUERCUS VIRGINIANA SOUTHERN LIVE OAK	36" BOX	CONT.	40"	30"
EVERGREEN TREES							
	OT	31	OLNEYA TESOTA DESERT IRONWOOD	36" BOX	CONT.	25"	25"
	SL	38	SEARSIA LANCEA AFRICAN SUMAC	24" BOX	CONT.	30"	25"
ORNAMENTAL TREES							
	PL	18	PISTACIA LENTISCUS MASTIC TREE	24" BOX	CONT.	20"	15"
	CP	8	X CHITALPA TASHKENTENSIS 'PINK DAWN' PINK DAWN CHITALPA	36" BOX	CONT.	25"	25"
PALMS							
	CH	2	CHAMAEROPS HUMILIS MEDITERRANEAN FAN PALM	36" BOX	CONT.	15"	15"
EVERGREEN SHRUBS							
	CMB	71	CARISSA MACROCARPA 'BOXWOOD BEAUTY' BOXWOOD BEAUTY NATAL PLUM	#5 CONT.	CONT.	2'	2'
	CMG	67	CARISSA MACROCARPA 'GREEN CARPET' GREEN CARPET NATAL PLUM	#5 CONT.	CONT.	1.5'	4'
	CME	81	CHRYSACTINIA MEXICANA DAMIANITA	#5 CONT.	CONT.	1.5'	3'
	HPS	233	HESPERALOE PARVIFLORA 'STOPLIGHTS' STOPLIGHTS DWARF RED YUCCA	#5 CONT.	CONT.	2'	2'
	JUS	36	JUSTICIA SPICIGERA MEXICAN HONEYSUCKLE	#5 CONT.	CONT.	3'	5'
	RUP	72	RUELLIA PENINSULARIS DESERT RUELLIA	#5 CONT.	CONT.	4'	4'
	TSG	32	TECOMA STANS STANS 'GOLD STAR' GOLD STAR YELLOW BELLS	#5 CONT.	CONT.	6'	6'
	TS	37	TECOMA X SMITHII ORANGE BELLS	#5 CONT.	CONT.	8'	5'
ORNAMENTAL GRASSES							
	MCL	59	MUHLENBERGIA CAPILLARIS 'LENCA' REGAL MIST® PINK MUHLY GRASS	#5 CONT.	CONT.	4'	4'

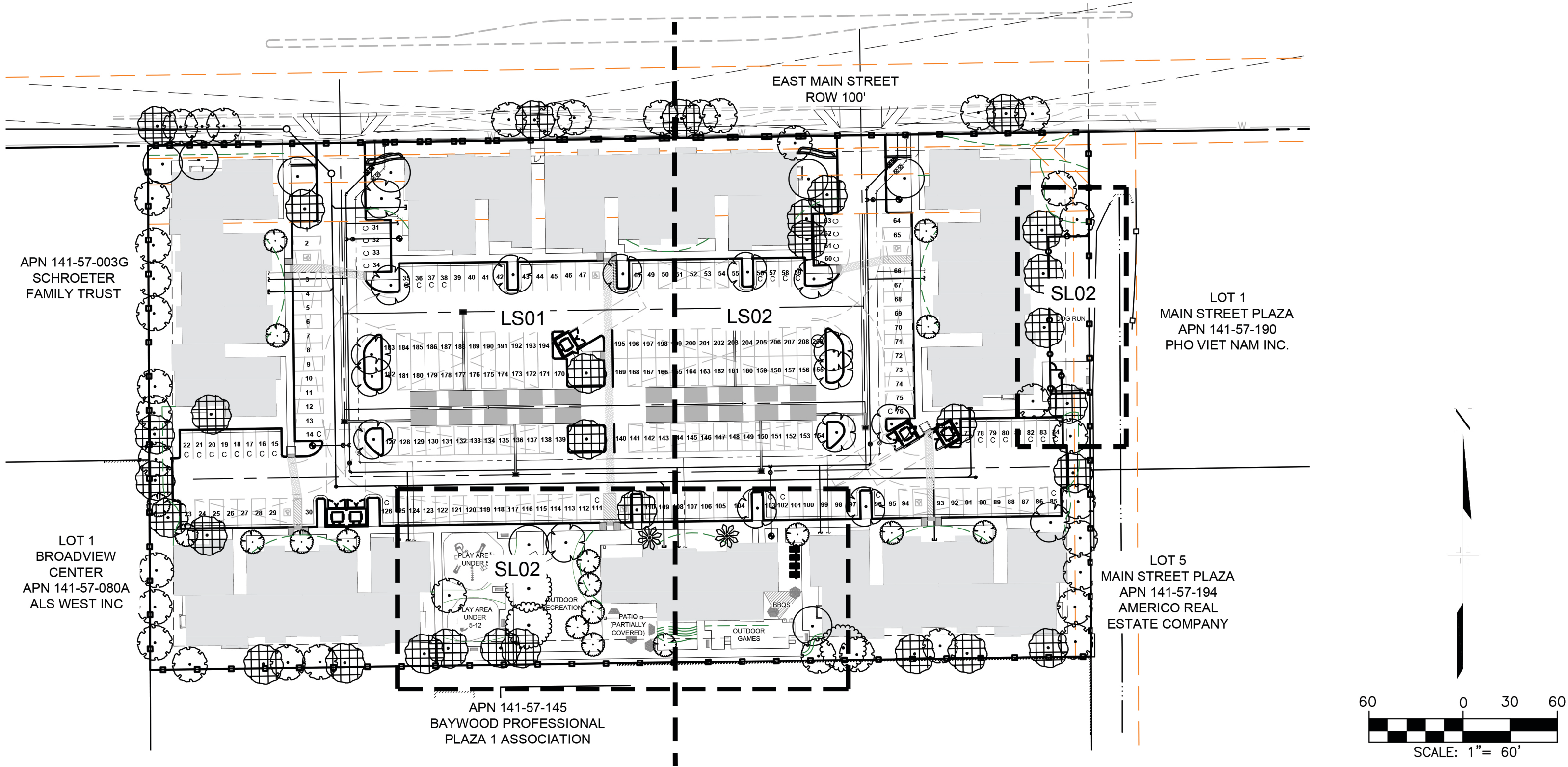

LANDSCAPE REQUIREMENTS

SITE DATA:			
AREA OF PARCEL:	259,809 SF (4.96 AC)		
EAST MAIN STREET:	549 LF		
WEST BOUNDARY:	334 LF		
EAST BOUNDARY:	334 LF		
SOUTH BOUNDARY:	600 LF		
FOUNDATION BASE (10% OF ADJACENT EXT. WALL):	282 LF		
PARKING (2.1 PER DWELLING UNIT):	218 PROVIDED		
LANDSCAPE AREA			
OPEN SPACE (150 SF PER DWELLING UNIT)	REQ. 19,800 SF	PROV. 56,000 SF	
REQUIRED TREES			
EAST MAIN STREET (1 TREE PER 25 LF)	REQ. 22	PROV. 22	
WEST BOUNDARY (3 EVERGREEN PER 100 LF)	12	12	
EAST BOUNDARY (3 EVERGREEN PER 100 LF)	12	12	
SOUTH BOUNDARY (3 EVERGREEN PER 100 LF)	18	18	
FOUNDATION TREES (1 TREE PER 50 LF OF EXT. WALL)	6	6	
PARKING (1 SHADE TREE PER PLANTING ISLAND)	19	19	
ADDITIONAL PARKING (1 TREE PER 8 PARKING SPACES)	28	28	
TOTAL TREES	117	117	
REQUIRED SHRUBS			
EAST MAIN STREET (6 SHRUB PER 25 LF)	REQ. 132	PROV. 132	
WEST BOUNDARY (20 PER 100 LF)	67	67	
EAST BOUNDARY (20 PER 100 LF)	67	67	
SOUTH BOUNDARY (20 PER 100 LF)	120	120	
PARKING (3 SHRUBS PER PLANTING ISLAND)	57	57	
ADDITIONAL PARKING (6 SHRUBS PER 8 PARKING SPACES)	164	164	
TOTAL SHRUBS	607	607	
TREE CANOPY			
118,748 SF (TREE CANOPY @ MATURE WIDTH) OF 259,809 SF (TOTAL SITE) = 45.7%			

SHEET INDEX

DESCRIPTION	NUMBER	TITLE
LANDSCAPE TITLE SHEET	1	LT01
SITE DETAILS	2	SD01
FENCING / WALL PLAN	3	SL01
FENCING / WALL DETAILS	4	SL02
AMENITY AREAS	5	SL03
LANDSCAPE NOTES AND DETAILS	6	LD01
PRELIMINARY LANDSCAPE PLAN	7	LS01
LANDSCAPE PLAN	8	LS02

CONSULTANTS:

PLANNER/ LANDSCAPE ARCHITECT/ CIVIL ENGINEER:



2435 RESEARCH PARKWAY, SUITE 300
COLORADO SPRINGS, CO 80920
PHONE: (719) 575-0100
FAX: (719) 575-0208

OWNER/DEVELOPER:

RECKER GARDENS

APPROVAL:

VICINITY MAP:



PROJECT:

RECKER GARDENS
PRELIMINARY LANDSCAPE PLAN

MESA, ARIZONA
MAY 23, 2024

REVISION HISTORY:

NO.	DATE	DESCRIPTION	BY
1	07/15/2024	PER CITY COMMENTS	EA
2	09/23/2024	PER CITY COMMENTS	HV

DRAWING INFORMATION:

PROJECT NO: 24.1489.002

DRAWN BY: HV

CHECKED BY: JG

APPROVED BY: JG

SHEET TITLE:

LANDSCAPE TITLE
SHEET

LT01

SHEET 1 OF 8

CITY FILE NO.: ZON24-00469



PRODUCT
MANUFACTURER
MODEL
COLOR
WEBSITE
PHONE

SARAH'S PLACE
PLAYWORLD
350-2120
GREEN
INFO@PLAYWORLD.COM
1.570.522.9800

1 UNDER 5 PLAYGROUND

NTS

MA-PR-18



PRODUCT
MANUFACTURER
MODEL
COLOR
WEBSITE
PHONE

TRAILBLAZER
PLAYWORLD
350-2201
BLUE AND PURPLE
INFO@PLAYWORLD.COM
1.570.522.9800

2 5-12 PLAYGROUND

NTS

MA-PR-07



PRODUCT
MANUFACTURER
MODEL
COLOR
MOUNTING
WEBSITE
PHONE

6' STEEL CONTOUR BENCH
PACIFIC OUTDOOR PRODUCTS
SE-5110
BLACK
SURFACE MOUNT
WWW.PACIFICOUTDOOR.COM
425.432.6000

3 BENCH

NTS

MA-PR-14



PRODUCT
MANUFACTURER
MODEL
COLOR
MOUNTING
WEBSITE
PHONE

PICNIC TABLE
ULINE
H-2560
CEDAR
SURFACE MOUNT
WWW.ULINE.COM
1-800-295-5510

4 PICNIC TABLE

NTS

MA-PR-16



PRODUCT
MANUFACTURER
MODEL
COLOR
MOUNTING
WEBSITE
PHONE

PICNIC TABLE
ULINE
H-26575
CEDAR
SURFACE MOUNT
WWW.ULINE.COM
1-800-295-5510

5 ADA PICNIC TABLE

NTS

MA-PR-20



PRODUCT
MANUFACTURER
MODEL
COLOR
WEBSITE
PHONE

COVERED PARK-STYLE GRILL
ASH & EMBER
899456
BLACK
INFO@ASHANDEMBEROUTDOOR.COM
1.888.794.1455

6 CHARCOAL GRILL

NTS

MA-PR-04



PRODUCT
MANUFACTURER
COLOR
WEBSITE
PHONE

CORN HOLE SET
PHOENIX PRECAST PRODUCTS
GREY
SALES@PHOENIXPRECASTPRODUCTS.COM
602.569.6090

7 CORN HOLE SET

NTS

MA-PR-11



PRODUCT
MANUFACTURER
MODEL
COLOR
WEBSITE
PHONE

TERRABOUND ELITE DOG WASTE
TERRA BOUND SOLUTIONS
44-ELITESTATION
GREEN AND WHITE
TERRABOUNDSOLUTIONS.COM
281.288.6693

8 PET WASTE STATION

NTS

MA-PR-15



PRODUCT
MANUFACTURER
COLOR
WEBSITE
PHONE

SHADE SAIL
ARIZONA SHADE SAILS
YELLOW
SHADESAILSAZ.COM
408.418.8438

9 SHADE SAIL

NTS

MA-PR-17



PRODUCT
MANUFACTURER
MODEL
COLOR
MOUNTING
WEBSITE
PHONE

1-LOOP BIKE RACK
ULINE
H-2892
BLACK
SURFACE MOUNT
WWW.ULINE.COM
1-800-295-5510

10 BIKE RACK

NTS

MA-PR-19

CONSULTANTS:

PLANNER/ LANDSCAPE ARCHITECT/ CIVIL ENGINEER:



2435 RESEARCH PARKWAY, SUITE 300
COLORADO SPRINGS, CO 80920
PHONE: (719) 575-0100
FAX : (719) 575-0208

OWNER/DEVELOPER:

RECKER GARDENS

APPROVAL:

VICINITY MAP:

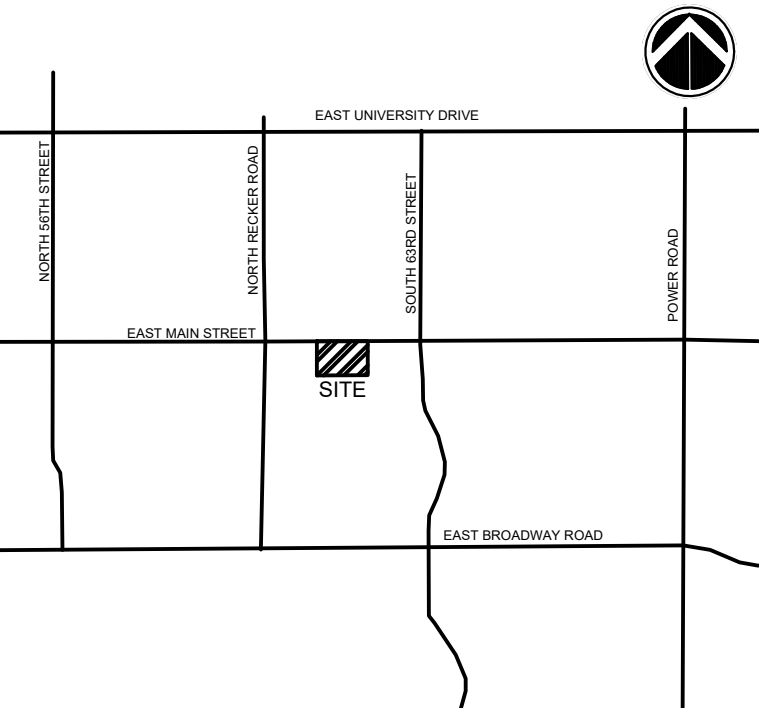

PROJECT:

RECKER GARDENS
PRELIMINARY LANDSCAPE PLAN

MESA, ARIZONA
MAY 23, 2024

REVISION HISTORY:

NO.	DATE	DESCRIPTION	BY
1	07/15/2024	PER CITY COMMENTS	EA
2	09/23/2024	PER CITY COMMENTS	HV

DRAWING INFORMATION:

PROJECT NO: 24.1489.002

DRAWN BY: HV

CHECKED BY: JG

APPROVED BY: JG

SHEET TITLE:

SITE DETAILS

SD01

SHEET 2 OF 8

CITY FILE NO.: ZON24-00469

FILE LOCATION: S:\BPH\2024\002024\1002\RECKER GARDENS\DWG\LANDSCAPE\PRELIMINARY\SL01.DWG

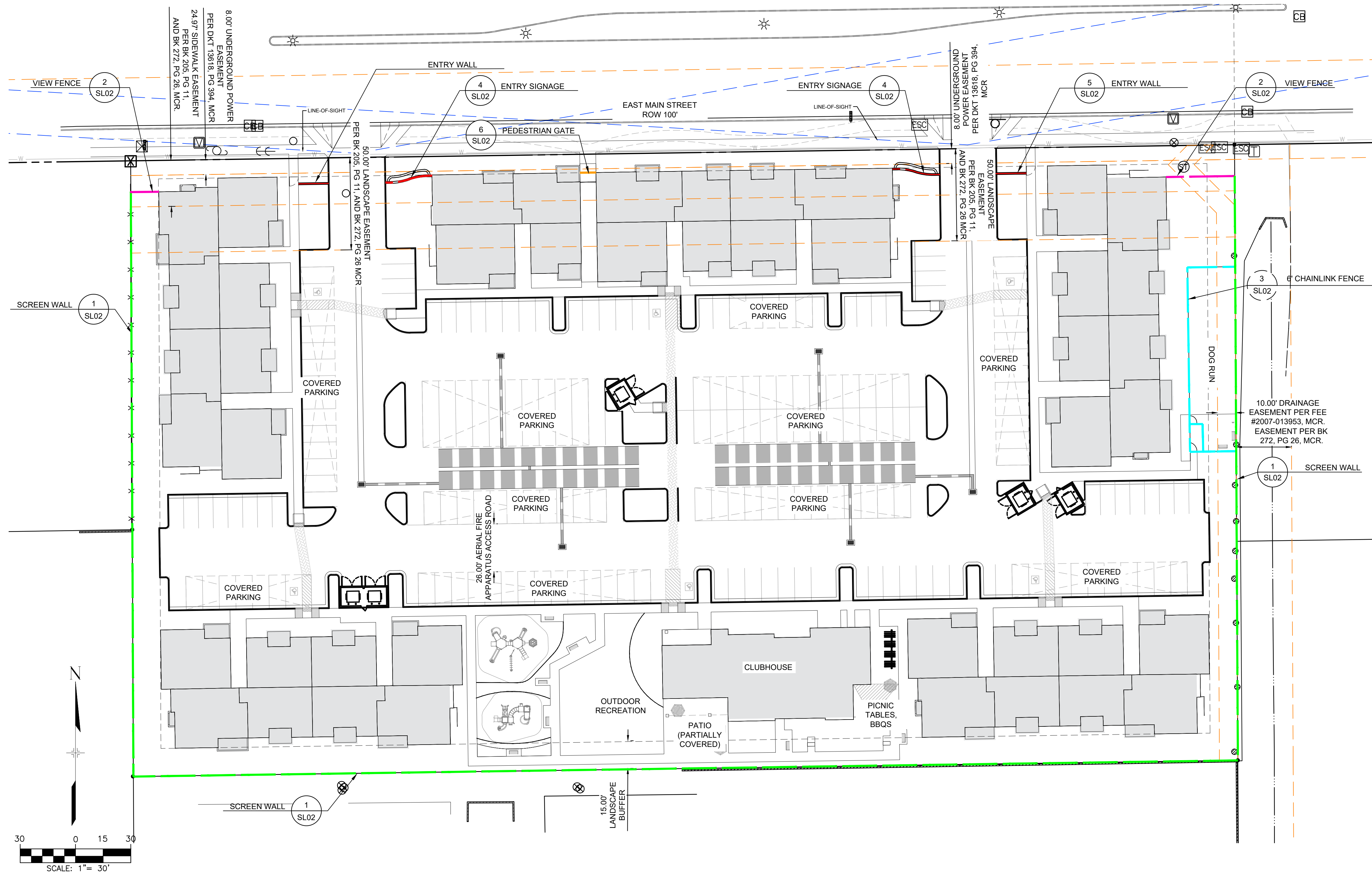

LEGEND	
	SCREEN WALL
	VIEW FENCE
	6' CHAIN LINK FENCE
	ENTRY SIGNAGE
	PEDESTRIAN GATE

CONSULTANTS:
PLANNER/ LANDSCAPE ARCHITECT/ CIVIL ENGINEER:



2435 RESEARCH PARKWAY, SUITE 300
COLORADO SPRINGS, CO 80920
PHONE: (719) 575-0100
FAX: (719) 575-0208

OWNER/DEVELOPER:

RECKER GARDENS

APPROVAL:

VICINITY MAP:

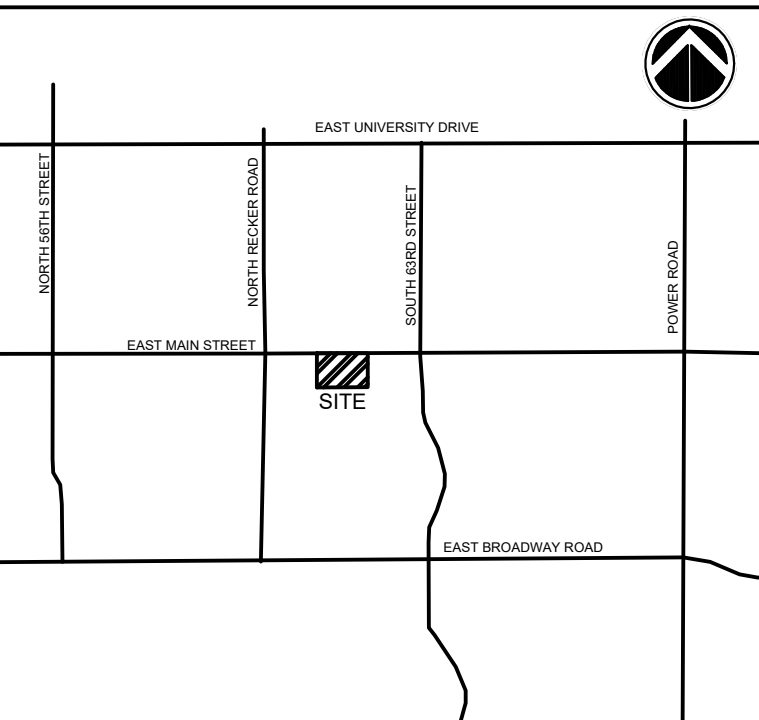

PROJECT:

RECKER GARDENS
PRELIMINARY LANDSCAPE PLAN

MESA, ARIZONA
MAY 23, 2024

REVISION HISTORY:

NO.	DATE	DESCRIPTION	BY
1	07/15/2024	PER CITY COMMENTS	EA
2	09/23/2024	PER CITY COMMENTS	HV

DRAWING INFORMATION:

PROJECT NO: 24.1489.002

DRAWN BY: HV

CHECKED BY: JG

APPROVED BY: JG

SHEET TITLE:

FENCING/WALL
PLAN

SL01

SHEET 3 OF 8

CITY FILE NO: ZON24-00469

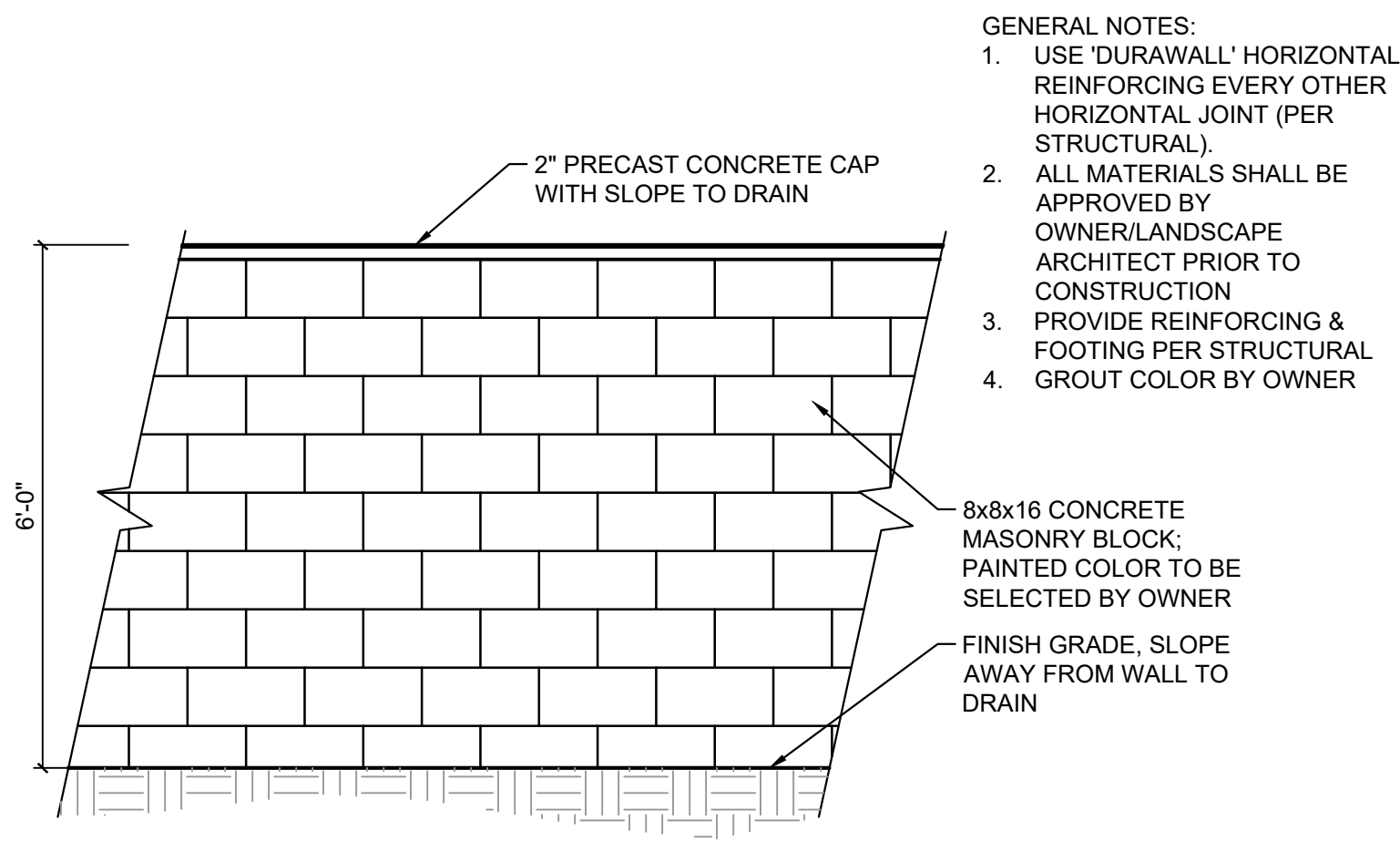

1 SCREEN WALL
NTS
MA-RE-01

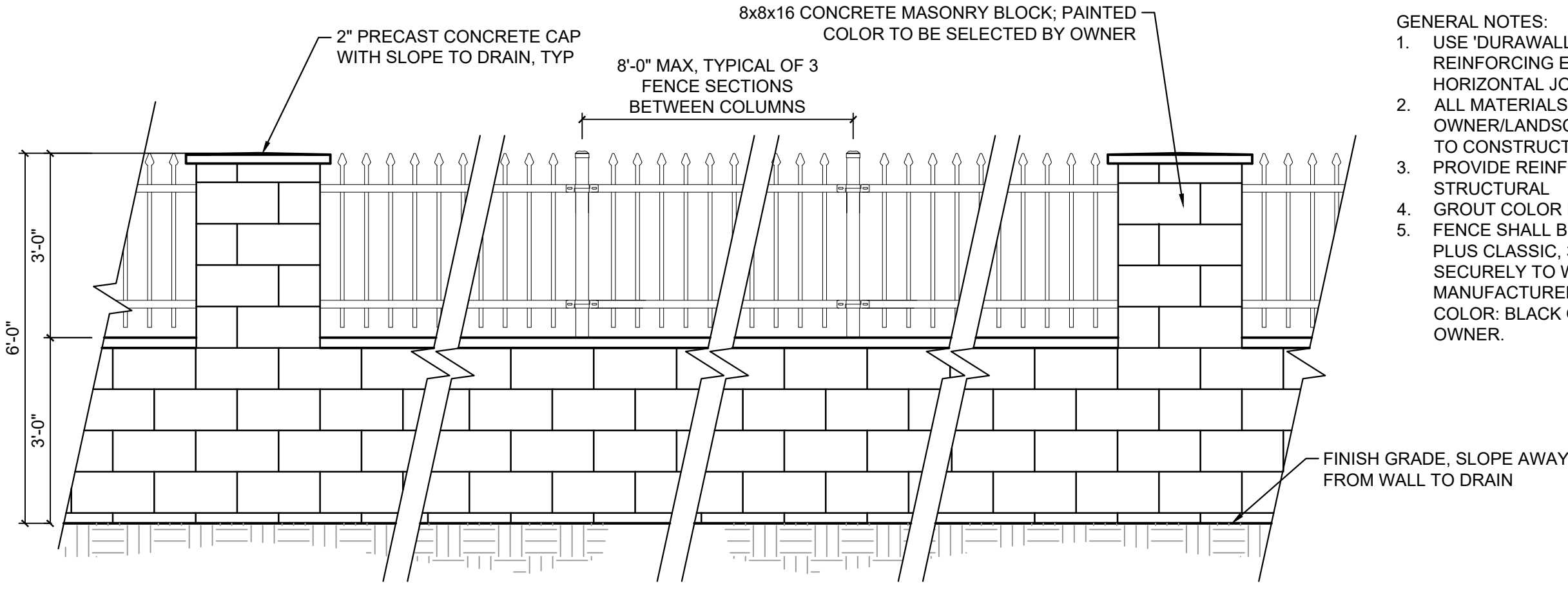

2 VIEW FENCE
NTS
MA-RE-02

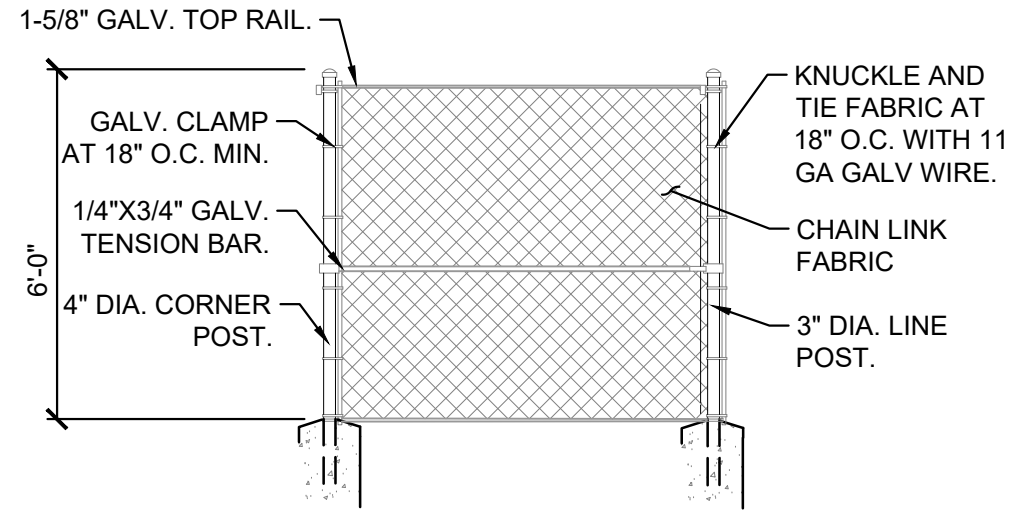

3 6' CHAINLINK FENCE
NTS
MS-STD-FC-14

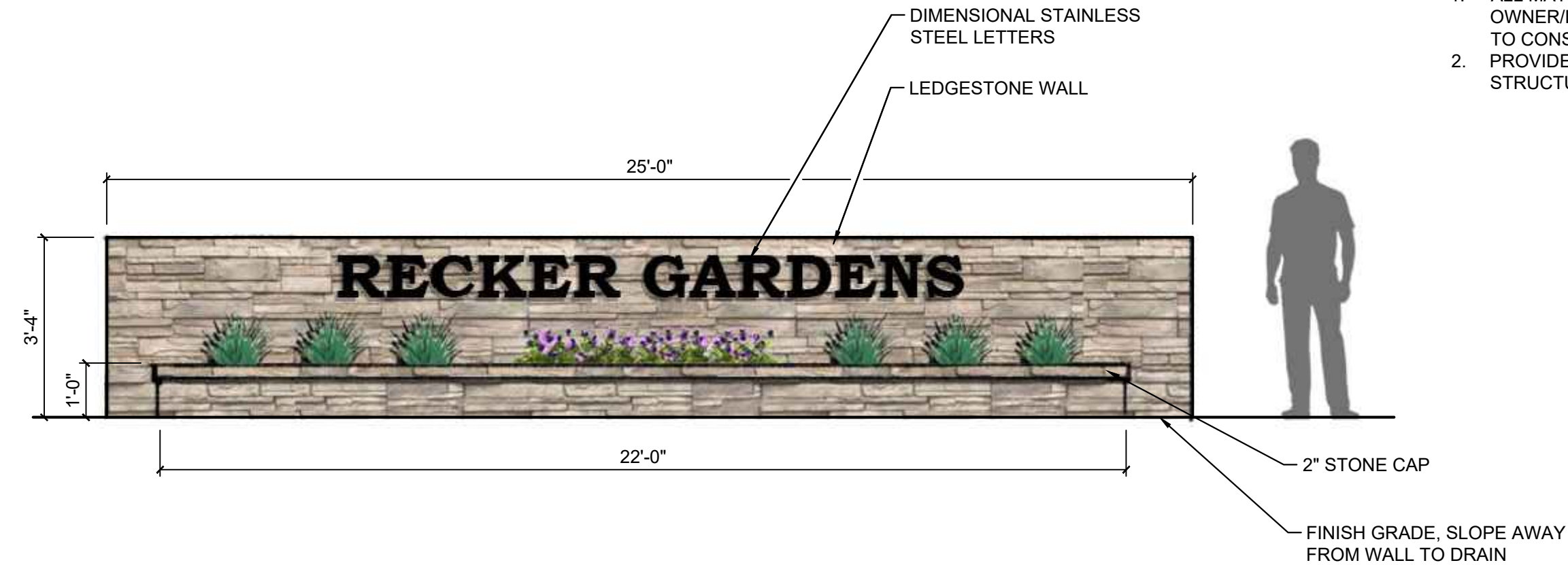

4 ENTRY SIGNAGE
NTS
MA-RE-04

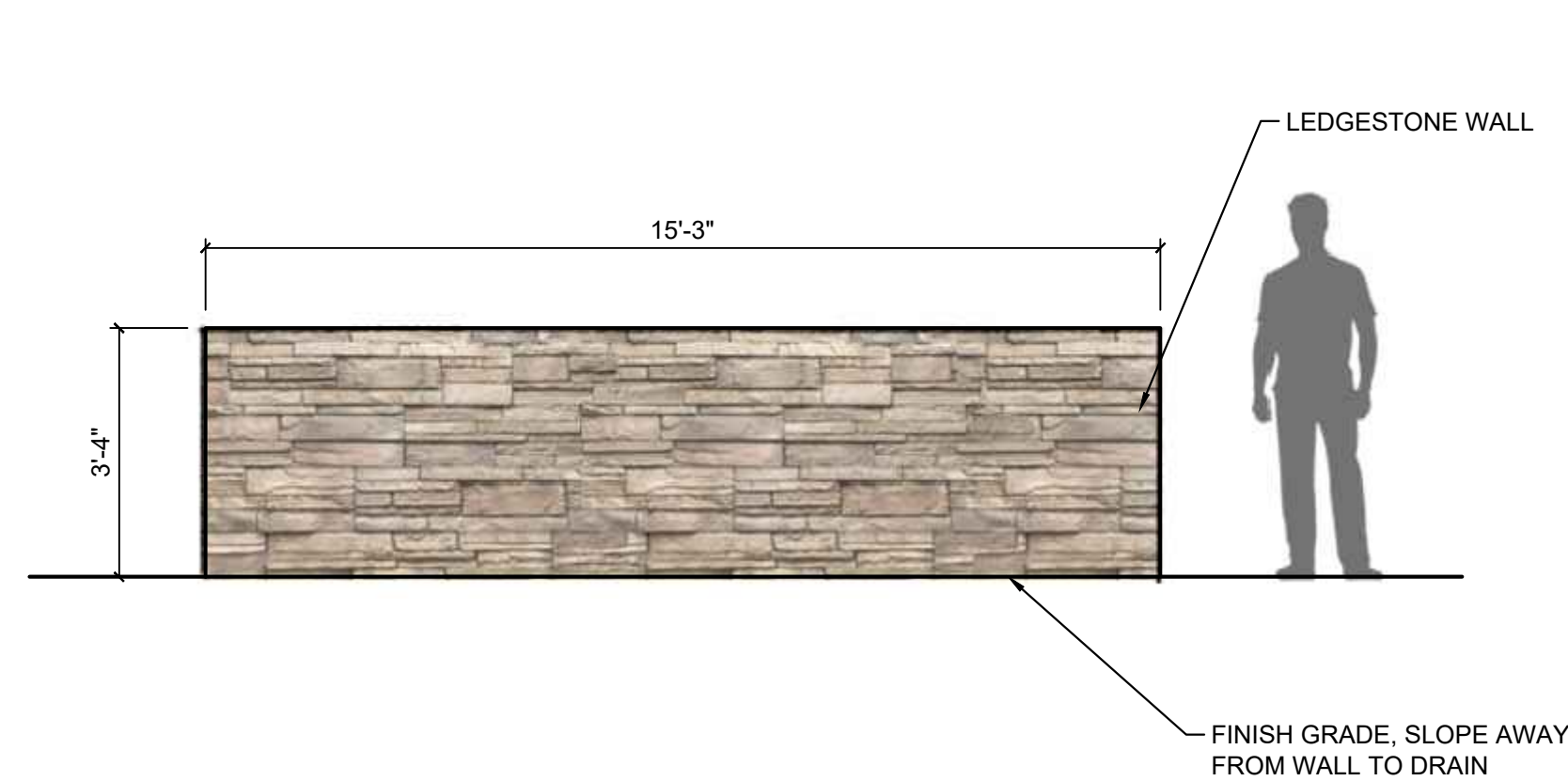

5 ENTRY WALL
NTS
MA-RE-05

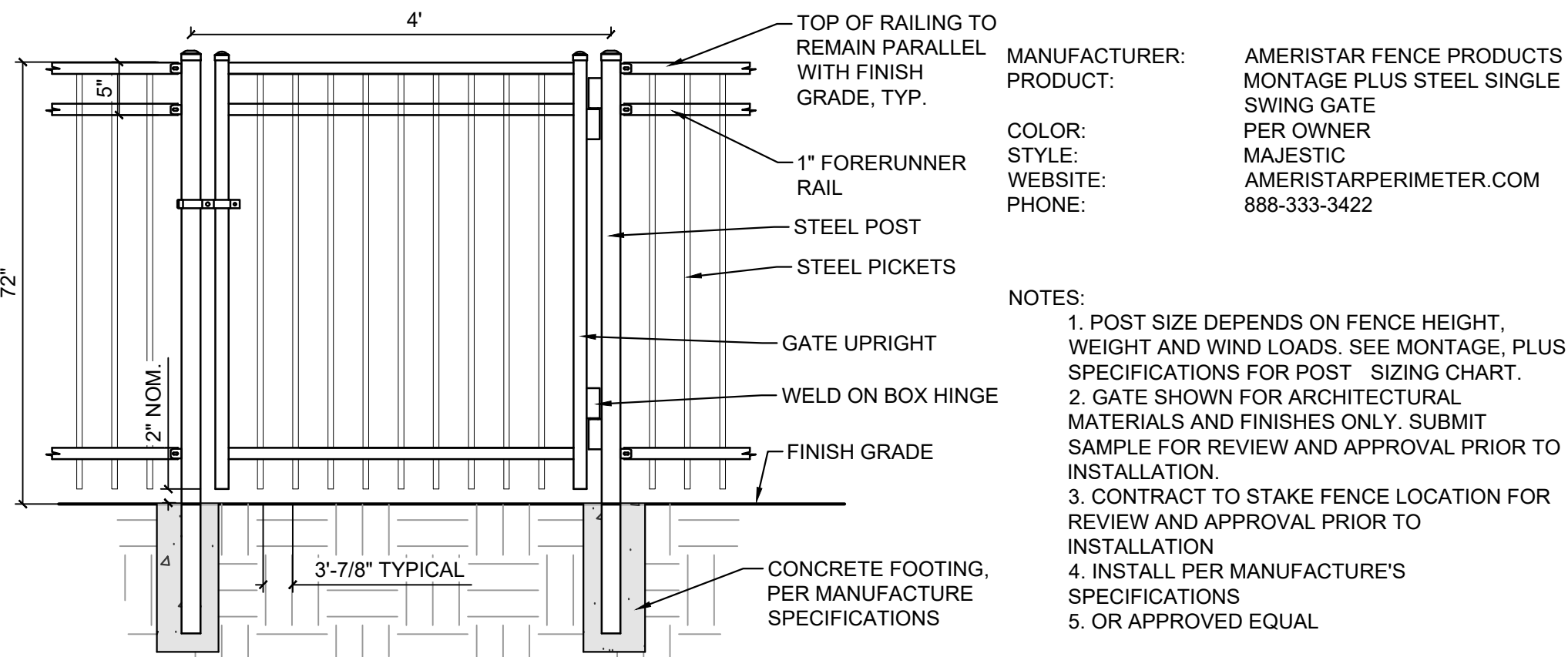

6 PEDESTRIAN GATE
NTS
MA-RE-06

CONSULTANTS:
PLANNER/ LANDSCAPE ARCHITECT/ CIVIL ENGINEER:
Matrix
2435 RESEARCH PARKWAY, SUITE 300
COLORADO SPRINGS, CO 80920
PHONE: (719) 575-0100
FAX : (719) 575-0208

OWNER/DEVELOPER:
RECKER GARDENS

APPROVAL:

VICINITY MAP:

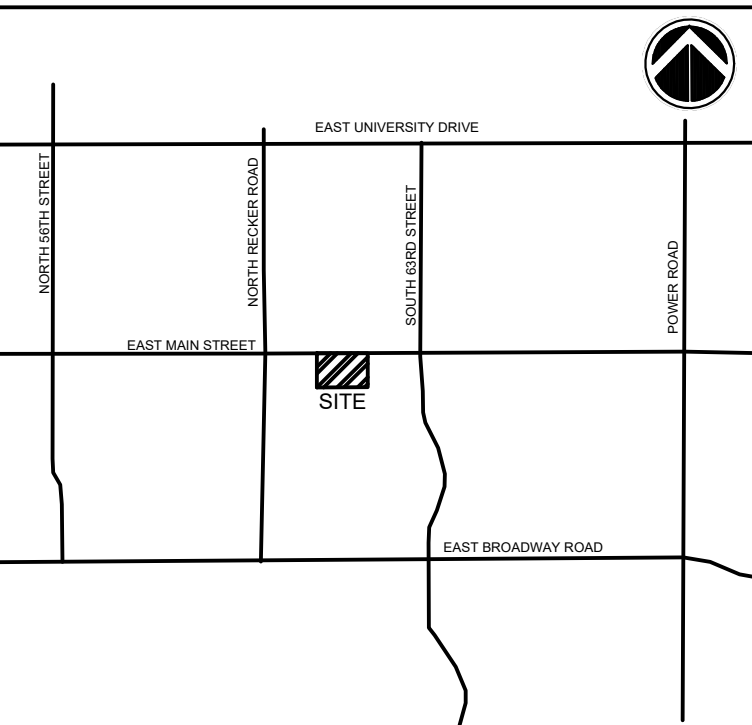

PROJECT:
**RECKER GARDENS
PRELIMINARY LANDSCAPE PLAN**

**MESA, ARIZONA
MAY 23, 2024**

REVISION HISTORY:

NO.	DATE	DESCRIPTION	BY
1	07/15/2024	PER CITY COMMENTS	EA
2	09/23/2024	PER CITY COMMENTS	HV

DRAWING INFORMATION:

PROJECT NO: 24.1489.002

DRAWN BY: HV

CHECKED BY: JG

APPROVED BY: JG

SHEET TITLE:

FENCE DETAILS

SL02

SHEET 4 OF 8

CITY FILE NO.: ZON24-00469

TREE AND SHRUB PLANTING NOTES

- ALL TREE AND SHRUB LOCATIONS ARE APPROXIMATE. ADJUST AS NECESSARY TO AVOID CONFLICTS. OBTAIN OWNER OR OWNER'S REPRESENTATIVE'S APPROVAL OF LOCATIONS PRIOR TO PLANTING TREES AND SHRUBS.
- ALL PLANT MATERIAL SHALL BE WELL-FORMED AND DEVELOPED IN GOOD CONDITION, HEALTHY AND DISEASE-FREE, AND BE TYPICAL OF THE SPECIES. PLANTS SHALL COMPLY IN ALL APPLICABLE RESPECTS WITH ACCEPTABLE STANDARDS RELATIVE TO CALIPER SIZE AND APPROPRIATE CONTAINER SIZE.
- OWNER AND OWNER'S REPRESENTATIVE RESERVES THE RIGHT TO REJECT AT ANY TIME OR PLACE PRIOR TO FINAL ACCEPTANCE OF WORK, ANY AND ALL PLANTS WHICH, IN THEIR OPINION, FAIL TO MEET THE REQUIREMENTS OF THE SPECIFICATIONS.
- AT THE COMPLETION OF PLANTING OPERATIONS ALL PLANTS SHALL BE INSPECTED BY THE OWNER AND OWNER'S REPRESENTATIVE. CONTRACTOR SHALL REPLACE IMMEDIATELY ANY PLANTS NOT IN HEALTHY AND VIGOROUS CONDITION AT THAT TIME AT NO EXPENSE TO THE OWNER. ANY PLANT NOT IN HEALTHY CONDITION DURING THE WARRANTY PERIOD SHALL BE REPLACED AS PER THE ORIGINAL SPECIFICATIONS, AT NO CHARGE TO THE OWNER.
- DETERMINE SOIL TYPE, CHARACTERISTICS, AND NUTRIENT LEVELS PRIOR TO PLANTING OPERATIONS. CULTIVATE COMPACTED SOILS TO A DEPTH OF 8-10" MINIMUM.
- CONDUCT A DRAINAGE TEST OF THE PLANTING AREAS TO ENSURE THAT SOILS DRAIN PROPERLY.
 - DIG A HOLE APPROXIMATELY ONE (1) FT DEEP IN DRY SOIL. FILL HOLE COMPLETELY WITH WATER TWICE DURING THE DAY. DRAINAGE IS POOR IF WATER IS STILL STANDING 24 HOURS AFTER THE SECOND FILLING.
 - CHIMNEY HOLES MAY IMPROVE POOR DRAINAGE DUE TO SHALLOW, THIN HARD PAN. DIG 3-4 CHIMNEY HOLES BESIDE, NOT BENEATH, THE ROOT BALL.
 - FILL THESE HOLES WITH THE SAME SOIL USED FOR BACKFILL MATERIAL, NOT GRAVEL.
- PLANTING - DEFINE AN AREA 3-5 TIMES THE DIAMETER OF THE ROOT BALL. LOOSEN THE ENTIRE AREA TO A DEPTH NO DEEPER THAN THE ROOT BALL. WALLS OF THE UNDISTURBED SOIL SHOULD BE ROUGH AND SLOPING OUTWARDLY.
 - DIG A HOLE IN THE CENTER OF THE TILLED AREA SLIGHTLY WIDER AND NO DEEPER THAN THE ROOT BALL.
 - SCORE THE ROOT BALL TO DISTURB THE SURFACE AND CUT ANY CIRCLING ROOTS. MAKE VERTICAL CUTS ONE-FOURTH TO ONE-HALF INCH DEEP FOUR TIMES AROUND THE SIDES AND TWICE ACROSS THE BOTTOM.
 - WHEN PLANTING BALLED AND BURLAPPED (B&B) MATERIAL, REMOVE ALL OF THE BURLAP AND THE TOP THREE RINGS IF NOT ALL OF THE WIRE BASKET PRIOR TO PLANTING.
 - GRAFTED TREES SHOULD HAVE THE GRAFT UNION ABOVE THE FINAL GRADE AND FACING AWAY FROM THE AFTERNOON SUN.
 - THE TOP OF THE ROOT BALL SHALL BE LEVEL WITH OR SLIGHTLY ABOVE THE FINISHED GRADE.
 - BACKFILL HOLE WITH UNAMENDED SOIL. DO NOT ADD ORGANIC AMENDMENTS, SUCH AS MANURE, COMPOST, OR WOOD CHIPS, TO SOIL. DO NOT PACK THE SOIL.
 - REMOVE ONLY DEAD, BROKEN, OR DISEASED BRANCHES. DO NOT COVER WOUNDS WITH SEALANT OR PAINT.
 - FORM AN IRRIGATION WELL/BERM AT THE EDGE OF THE ROOT BALL, NOT WIDER.
 - IRRIGATE THE PLANT AND THE ENTIRE TILLED AREA. APPLY ENOUGH WATER TO THOROUGHLY WET THE SOIL TO THE DEPTH OF THE ROOT BALL.
 - ADD SOIL IF SETTLING OCCURS AFTER THE INITIAL WATERING.
 - MULCH THE ENTIRE TILLED AREA WITH 3-4" OF ORGANIC MULCH AS SPECIFIED.
 - STAKE TREES ONLY IF THEY CANNOT STAND ON THEIR OWN OR NEED PROTECTION FROM OTHER INFLUENCES OR WIND.
 - USE ONLY TWO STAKES, PLACED OUTSIDE OF THE ROOTBALL AND IRRIGATION WELL/BERM AT RIGHT ANGLES TO THE PREVAILING WINDS.
 - PLACE TIES SIX (6) INCHES ABOVE THE HIGHEST LOCATION ON THE TRUNK AT WHICH IT WILL NOT BEND.
- PLANTING BEDS RECEIVING MULCH ARE TO BE FREE OF WEEDS AND GRASS.
- LANDSCAPE CONTRACTOR TO REMOVE TREE STAKES, TREE WRAP, AND ALL DEAD WOOD ON TREES AND SHRUBS ONE YEAR AFTER PROVISIONAL ACCEPTANCE.
- ALL WORK ON TREES TO REMAIN, INCLUDING CROWN AND ROOT PRUNING SHALL BE PERFORMED BY A TREE SERVICE LICENSED BY THE CITY FORESTER.
- THE CONTRACTOR SHALL PROVIDE ALL WATER, WATERING DEVICES AND LABOR NEEDED TO IRRIGATE PLANT MATERIALS UNTIL AUTOMATIC IRRIGATION SYSTEMS ARE OPERATIONAL AND ACCEPTED. THE CONTRACTOR SHALL SUPPLY ENOUGH WATER TO MAINTAIN THE PLANTS' HEALTHY CONDITION BASED ON SEASONAL CONSIDERATIONS.
- ALL PLANT MATERIALS SHALL BE PROTECTED FROM THE DRYING ACTION OF THE SUN AND WIND AFTER BEING DUG, WHILE BEING TRANSPORTED, AND WHILE AWAITING PLANTING. BALLS OF PLANTS THAT CANNOT BE PLANTED IMMEDIATELY SHALL BE PROTECTED FROM DRYING ACTION BY COVERING THEM WITH MOIST MULCH. PERIODICALLY, APPLY WATER TO MULCH-COVERED BALLS TO KEEP MOIST. IF PLANTING SHOULD OCCUR DURING GROWING SEASON, APPLY ANTI-DESSICANT TO LEAVES BEFORE TRANSPORT TO REDUCE LIKELIHOOD OF WINDBURN. REAPPLY ANTI-DESSICANT AFTER PLANTING TO REDUCE TRANSPIRATION.

PALM PLANTING NOTES

- PLANT PALMS IN WELL-DRAINED SOIL. PERFORM SOIL TEST TO DETERMINE SOIL CHARACTERISTICS AND NUTRIENT LEVELS PRIOR TO PLANTING.
- PERFORM DRAINAGE TEST(S) ON SOIL PRIOR TO PLANTING. DIG A HOLE THE DEPTH OF THE ROOTBALL, FILL WITH WATER, AND ALLOW TO DRAIN. FILL A SECOND TIME AND LEAVE. IF WATER DOES NOT DRAIN WITHIN 24 HOURS ALTERNATE PROVISIONS MUST BE MADE FOR DRAINAGE IE: DIG A CHIMNEY DOWN TO A POROUS STRATA TO PERMIT EXCESS WATER TO DRAIN OR MOVE PALM TO DIFFERENT LOCATION. CONTACT OWNER'S REPRESENTATIVE TO DISCUSS OPTIONS.
- DIG A PLANTING HOLE THAT IS AS DEEP AS THE ROOT BALL AND TWO (2) FEET WIDER ALL AROUND. SET CROWN OF CONTAINERIZED PALM AT THE ORIGINAL SOIL LEVEL. DO NOT COVER THE CROWN OR YOUNG TRUNK WITH SOIL.
- LOOSEN SOIL ON THE EDGE OF THE PLANTING PIT TO ENCOURAGE LATERAL GROWTH.
- DO NOT AMEND BACKFILL SOIL, USE NATIVE SOIL. SETTLE BACKFILL WITH WATER FROM A HOSE. IF PALM SETTLES ADJUST UP TO ENSURE THE CROWN IS NOT BELOW THE ORIGINAL SOIL LEVEL.
- CONTRACTOR TO SUBMIT A WATERING SCHEDULE FOR ESTABLISHMENT TO OWNER'S REPRESENTATIVE FOR REVIEW.
- INSTALL IRRIGATION SYSTEM PER DRAWINGS.
- WATER TO A DEPTH OF TWO (2) FEET. CHECK WITH A PROBE TO ENSURE PALM IS GETTING A DEEP WATERING.
- INSTALL MULCH MATERIAL, 2-4" DEPTH, AS SPECIFIED OVER THE IRRIGATED ZONE.
- LARGE PRE-DUG PALMS:
 - HANDLE CAREFULLY AND SECURELY AT ALL TIMES. PROTECT THE TERMINAL BUD THROUGHOUT TRANSPORTING AND PLANTING.
 - ROOT BALL TO BE KEPT MOIST AND SECURELY BRACED DURING TRANSIT.
 - WATER OF DUG PALMS IS STORED IN THE TRUCK AND LOST THROUGH THE LEAVES. ONLY ONE-HALF OF THE OLDER LIVING FRONDS MAY BE REMOVED FOR TRANSPORT. THE REMAINDER SHALL BE TIED TOGETHER OVER THE TERMINAL BUD WITH A BIODEGRADABLE TWINE TO PROTECT THE BUD FROM DRYING AND SUN SCALD.
 - LEAVE FRONDS TIED AROUND BUD FOR 2-3 MONTHS DEPENDING ON THE TIME OF YEAR.
 - PLANTING HOLE SHOULD BE A DEEP AS THE ROOT BALL, NOT DEEPER, AND SHOULD DRAIN WITHIN 24 HOURS. LOOSEN THE SOIL THREE (3) FEET BEYOND EACH SIDE OF THE ROOT BALL TO ENCOURAGE LATERAL GROWTH.
 - DO NOT AMEND BACKFILL MATERIAL.
 - LARGE PALMS MAY BE BRACED WITH AT LEAST THREE (3) 2X4 LUMBER BRACES AT 45 DEGREES FROM THE GROUND AGAINST ONE (1) FT LENGTHS OF 2X4 THAT ARE VERTICALLY STRAPPED OR BANDOED TO THE TRUNK.
 - PROTECT THE TRUNK WITH NYLON, BURLAP, OR OTHER SUITABLE MATERIAL WHERE THE ONE (1) FT LENGTHS OF 2X4 ARE SECURED. DO NOT NAIL ANYTHING INTO THE TRUNK OF THE PALM.
 - INSTALL MULCH MATERIAL, 2-4" DEPTH, AS SPECIFIED OVER THE IRRIGATED ZONE.

SODDING NOTES

- ALL FINISH GRADING SHALL BE PERFORMED BY LANDSCAPE CONTRACTOR.
- FINE GRADE SOD AREAS AND RE-WET TO ELIMINATE IRREGULARITIES ON THE SURFACE. ROLL OR PERFORM ADDITIONAL FINE GRADING. INSPECT SITE AND REMOVE SURFACE DEBRIS AND LARGE STONES.
- EXTRACT SOIL SAMPLE TO BE SENT TO AN AGRICULTURAL SOILS LAB TO DETERMINE, SOIL CHARACTERISTICS, COMPOSITION, AND NUTRIENT LEVELS.
- WET SOIL THOROUGHLY THEN LET IT DRY ENOUGH TO BE ROTOTILLED.
- BASED ON RESULTS AND RECOMMENDATIONS OF THE SOILS TEST, ADD THE APPROPRIATE FERTILIZER TYPE AND AMOUNT.
- ROTO-TILL SOIL, INCORPORATING THE FERTILIZER TO A DEPTH OF SIX INCHES (6") MINIMUM.
- IF SOIL TEST RECOMMENDATION SUGGESTS INCORPORATING ORGANIC MATTER, APPLY TYPE AT THE RATE RECOMMENDED, THOROUGHLY TILL TO INCORPORATE INTO EXISTING SOIL.
- FINE GRADE SITE AND RE-WET THE AREA.
- THE CONTRACTOR SHALL PROVIDE ALL WATER, WATERING DEVICES AND LABOR NEEDED TO IRRIGATE PLANT MATERIALS UNTIL AUTOMATIC IRRIGATION SYSTEMS ARE OPERATIONAL AND ACCEPTED. THE CONTRACTOR SHALL SUPPLY ENOUGH WATER TO MAINTAIN THE PLANTS' HEALTHY CONDITION BASED ON SEASONAL CONSIDERATIONS.
- REWORK THE SOIL WITH A RAKE OR TILLER SET AT SHALLOW DEPTH. IF SOIL TOO FLUFFY (SHOE MARKS GO DOWN OVER ONE INCH (1") DEPTH) ROLL SOIL WITH A ROLLER. RE-RAKE SLIGHTLY TO PROVIDE A TWO INCH (2") SOIL CRUST.

05/18/24

05/18/24

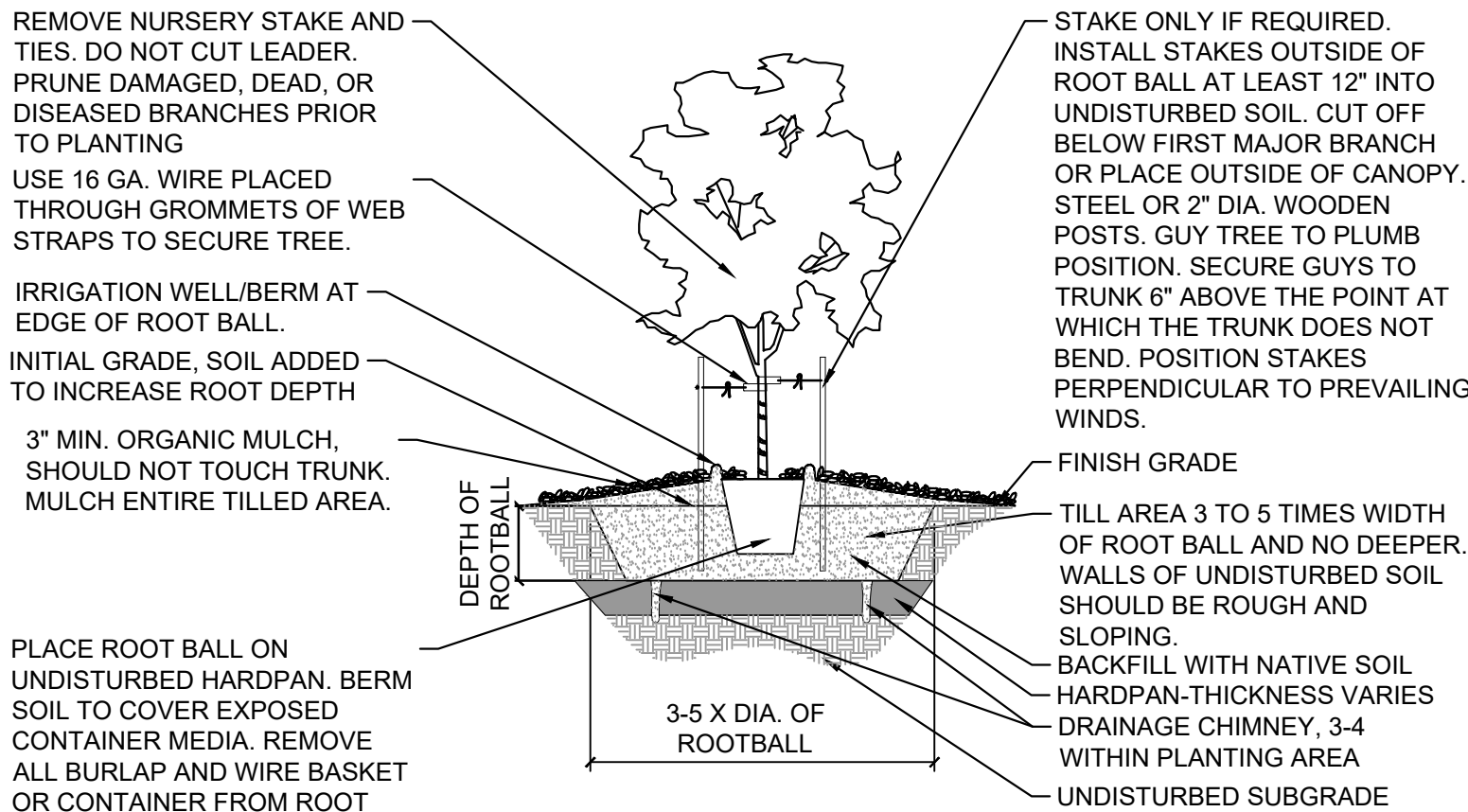

1 TREE - SOILS WITH HARDPAN

NTS

MA-STD-LS-01

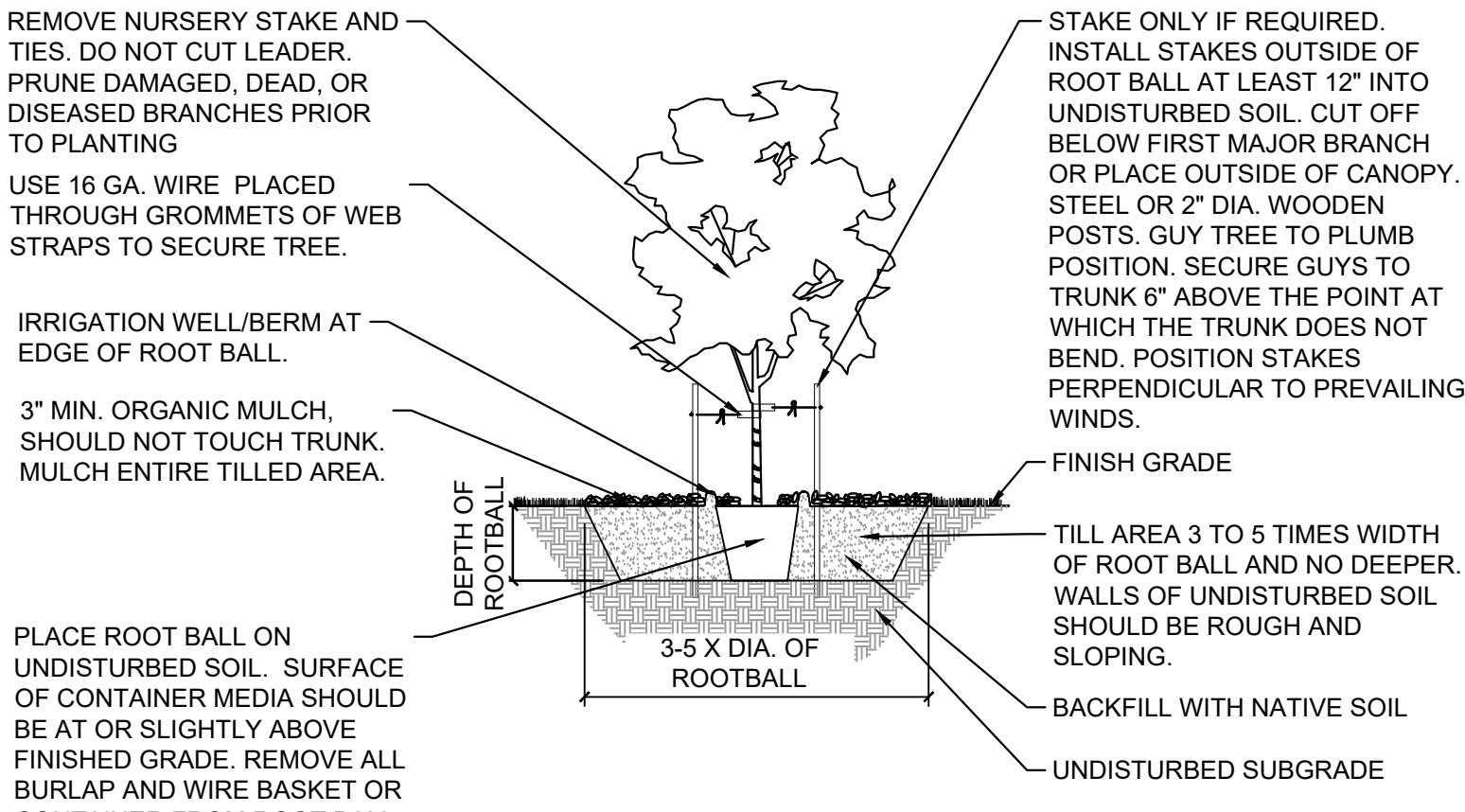

2 TREE - SOILS WITHOUT HARDPAN

NTS

MA-STD-LS-02

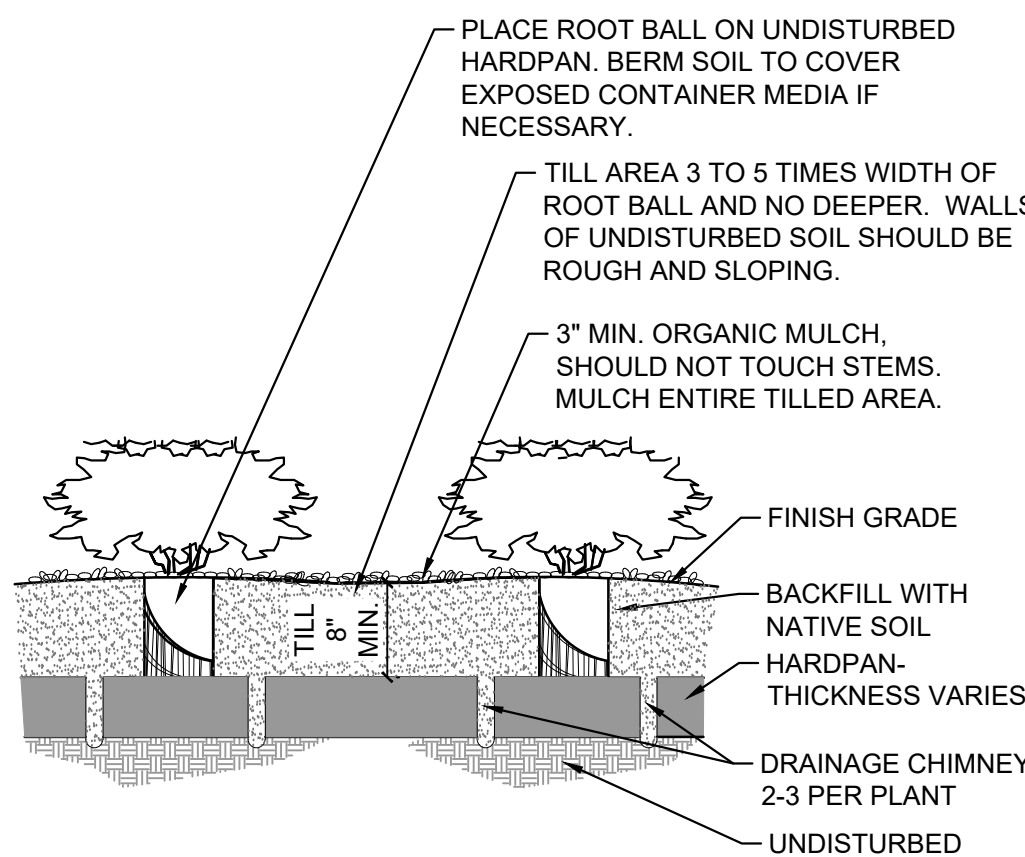

3 SHRUBS - SOIL WITH HARDPAN

NTS

MA-STD-LS-03

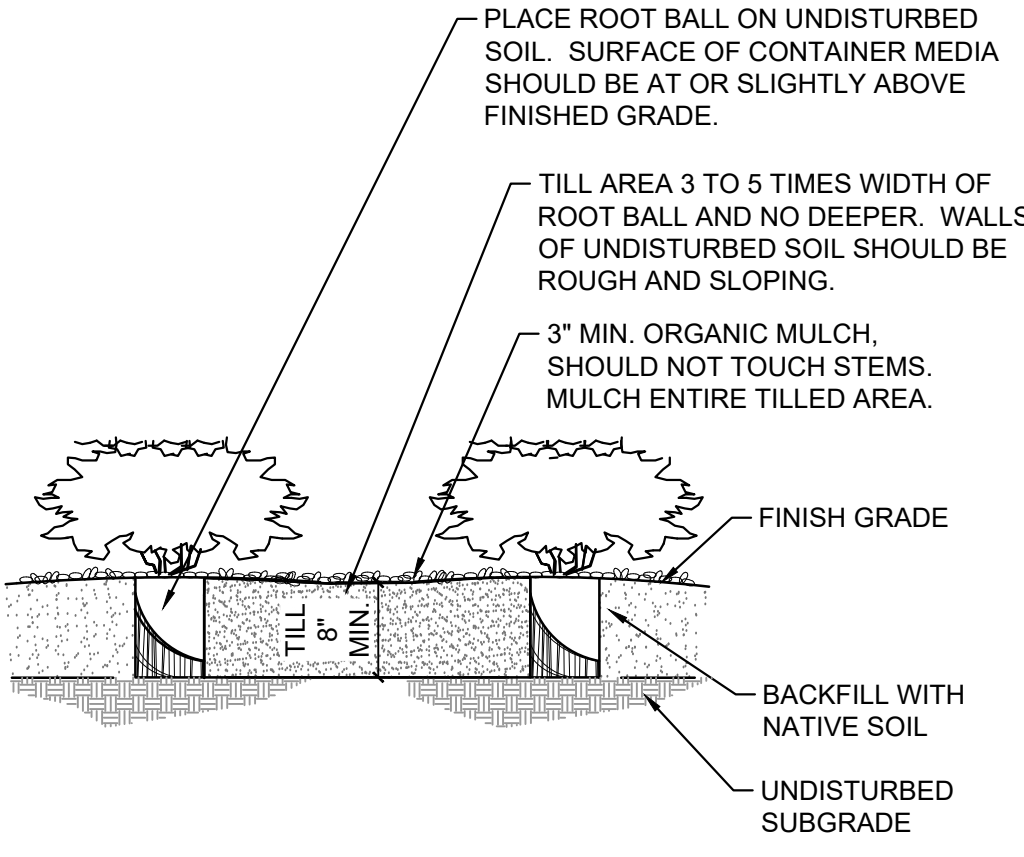

4 SHRUBS - SOIL WITHOUT HARDPAN

NTS

MA-STD-LS-04

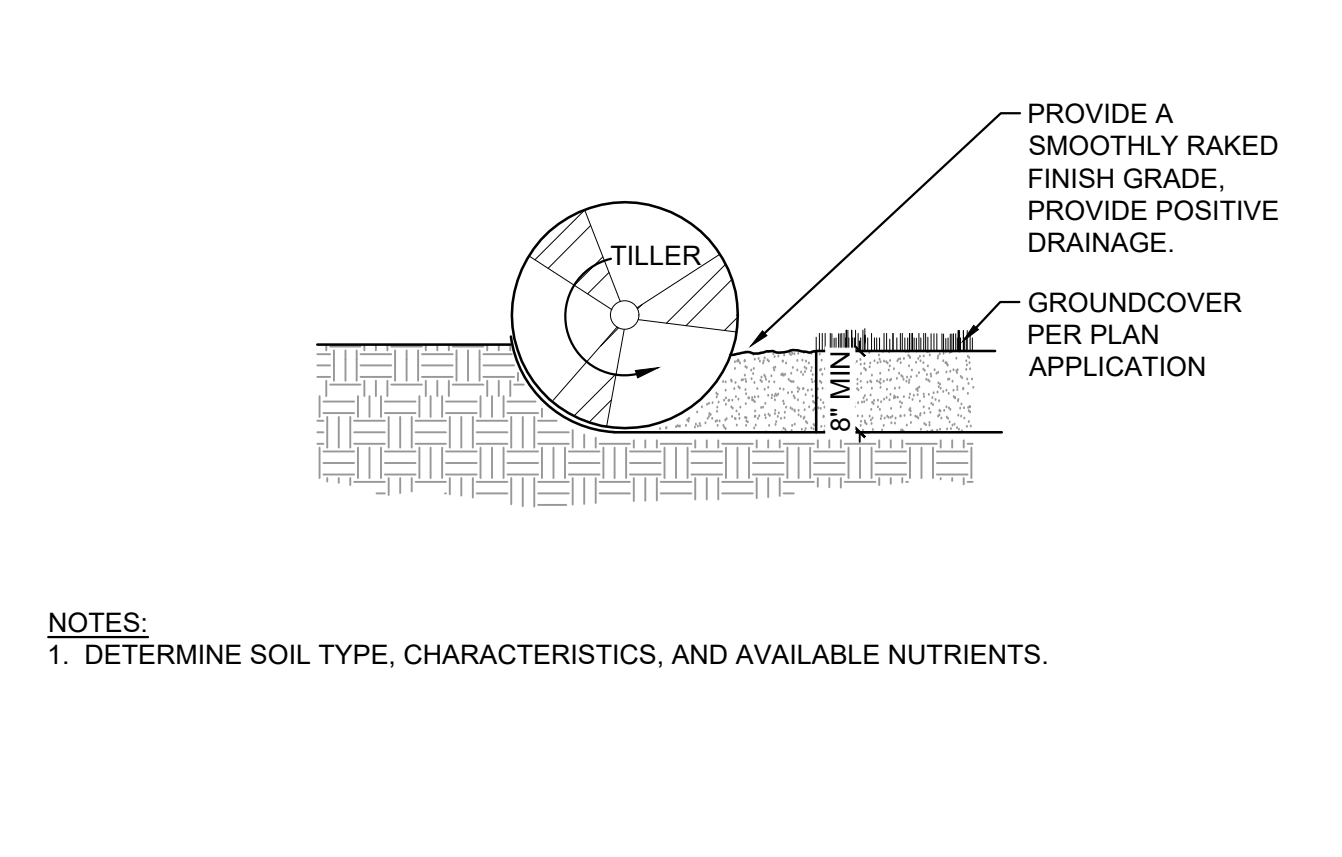

5 SOIL PREP FOR ALL AREAS

NTS

MA-STD-LS-05

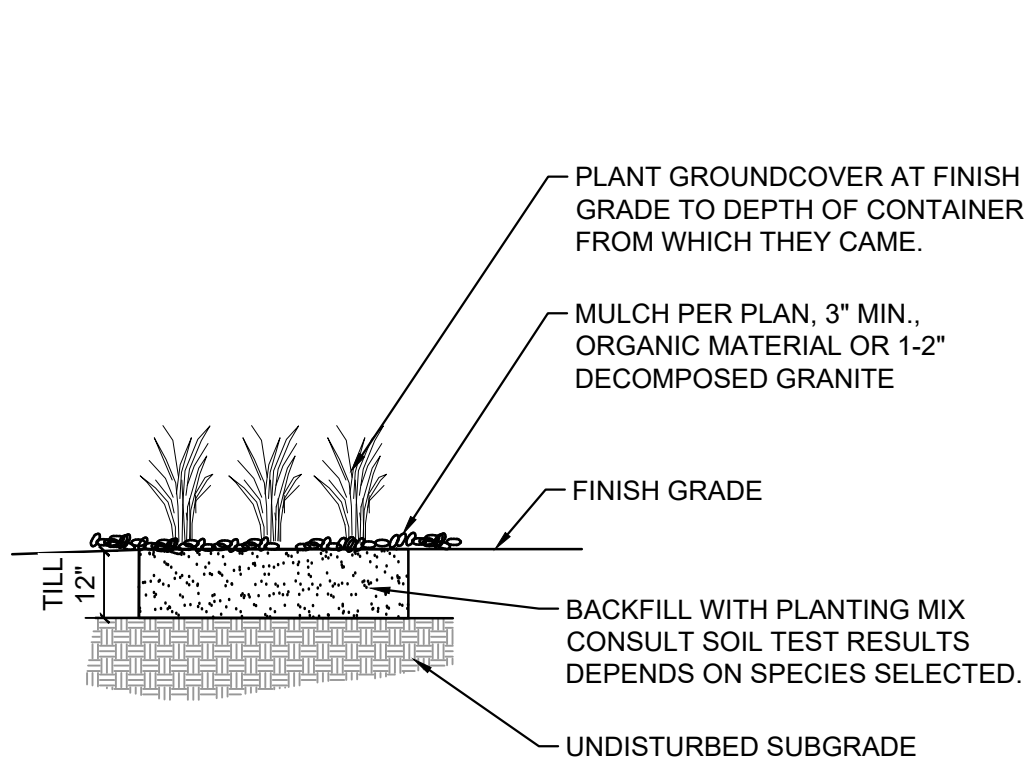

6 GROUNDCOVERS

NTS

MA-STD-LS-06

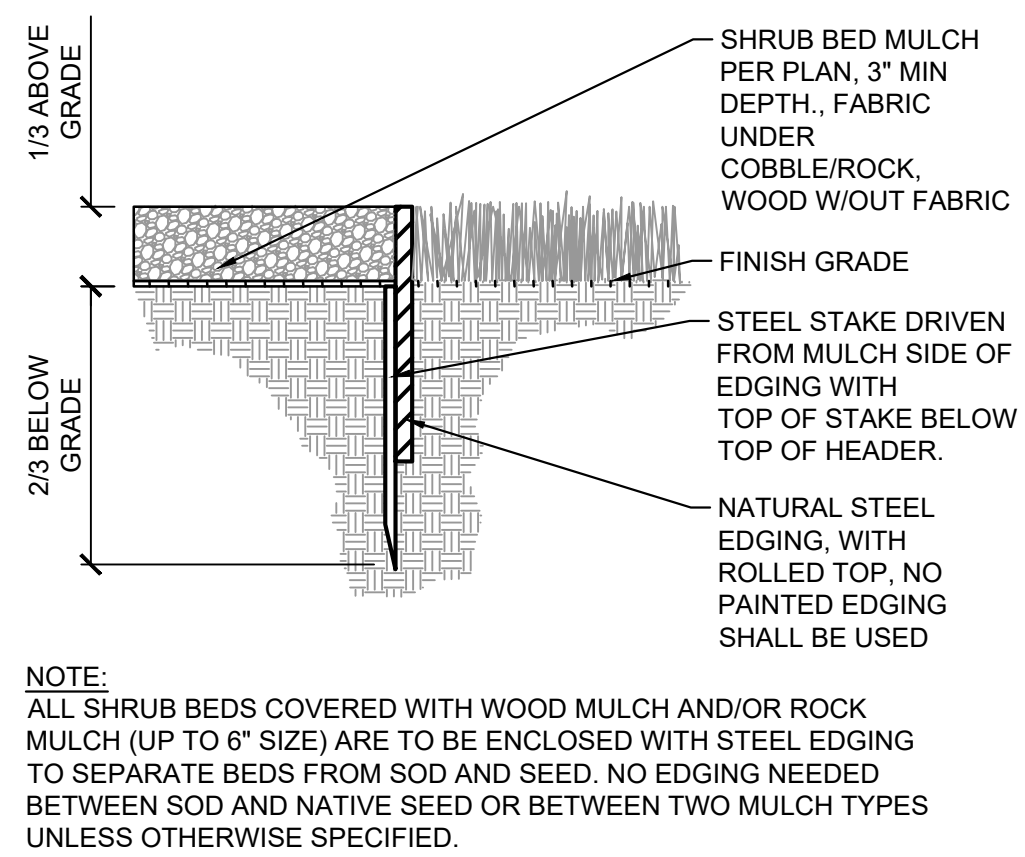

7 STEEL EDGING

NTS

MS-STD-LS-12

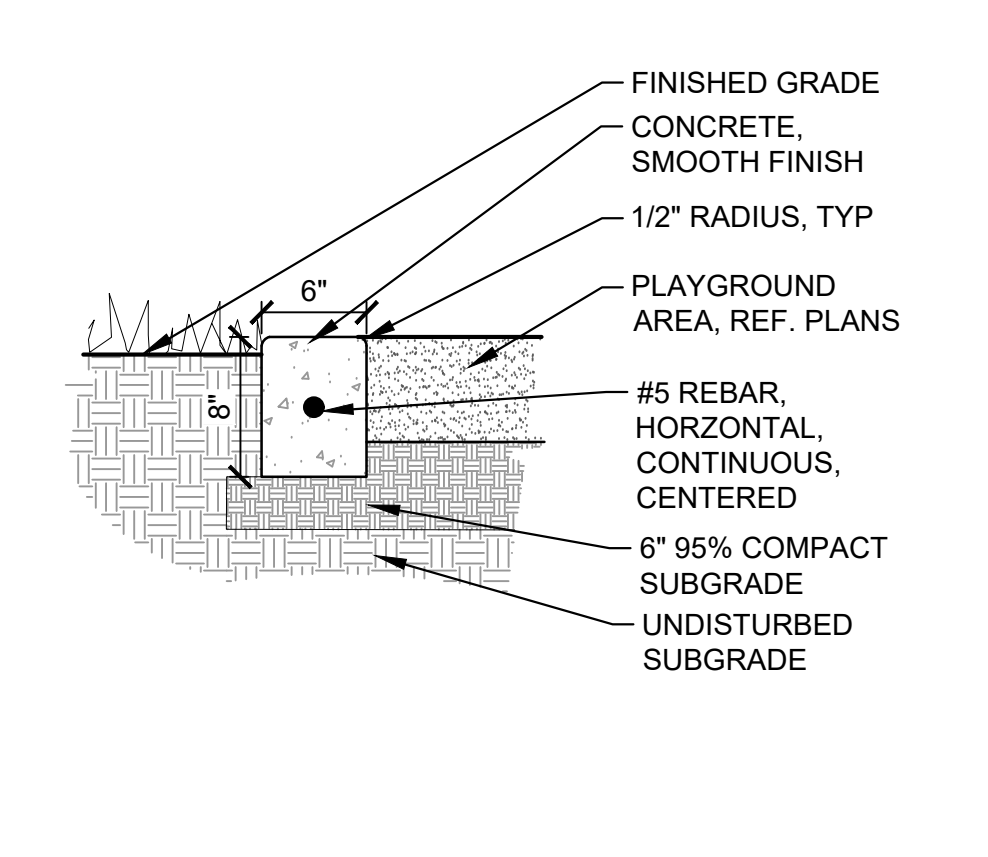

8 CONCRETE EDGING

NTS

MA-RE-03

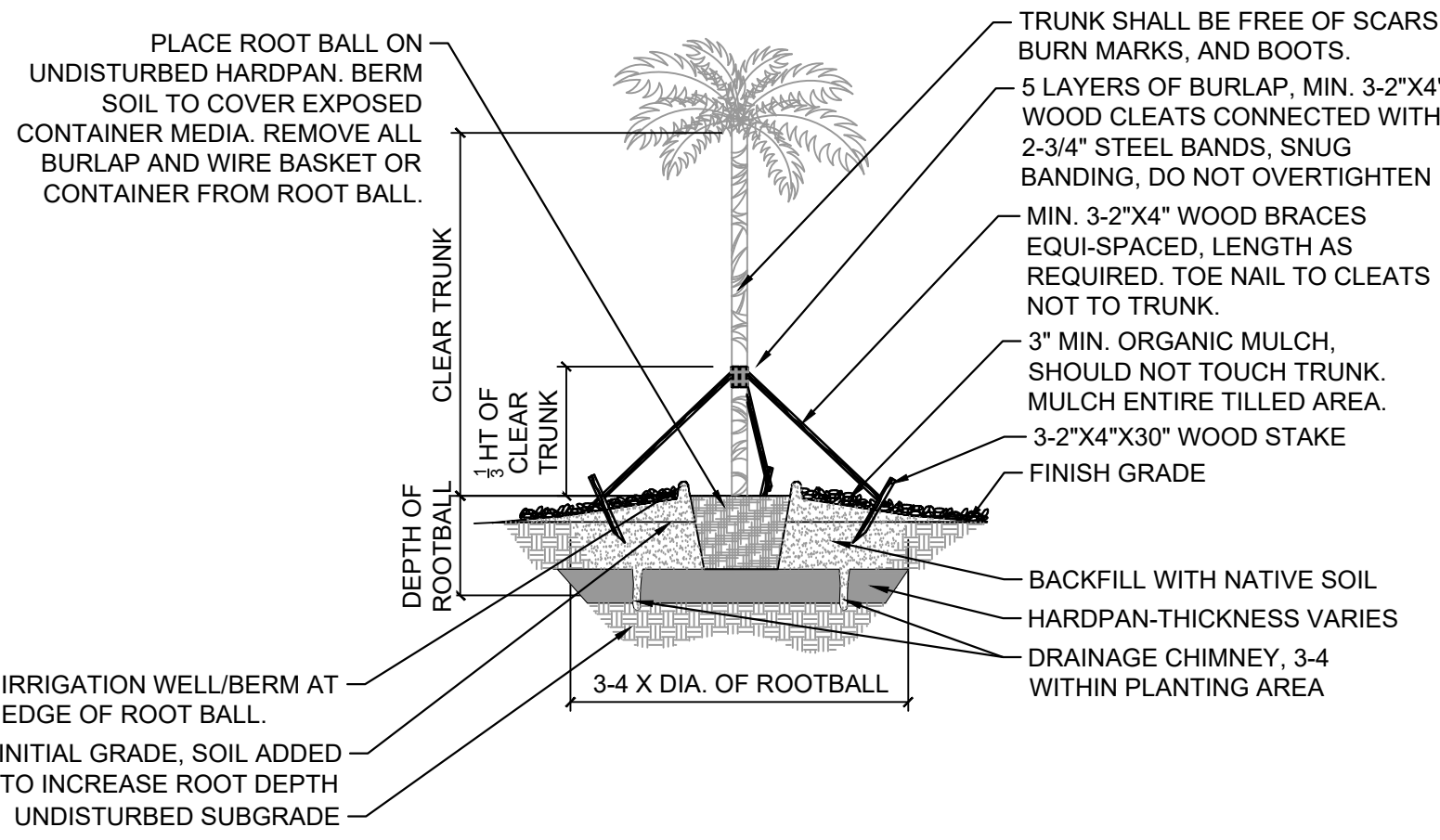

9 PALM TREE - SOILS WITH HARDPAN

NTS

MA-STD-LS-07

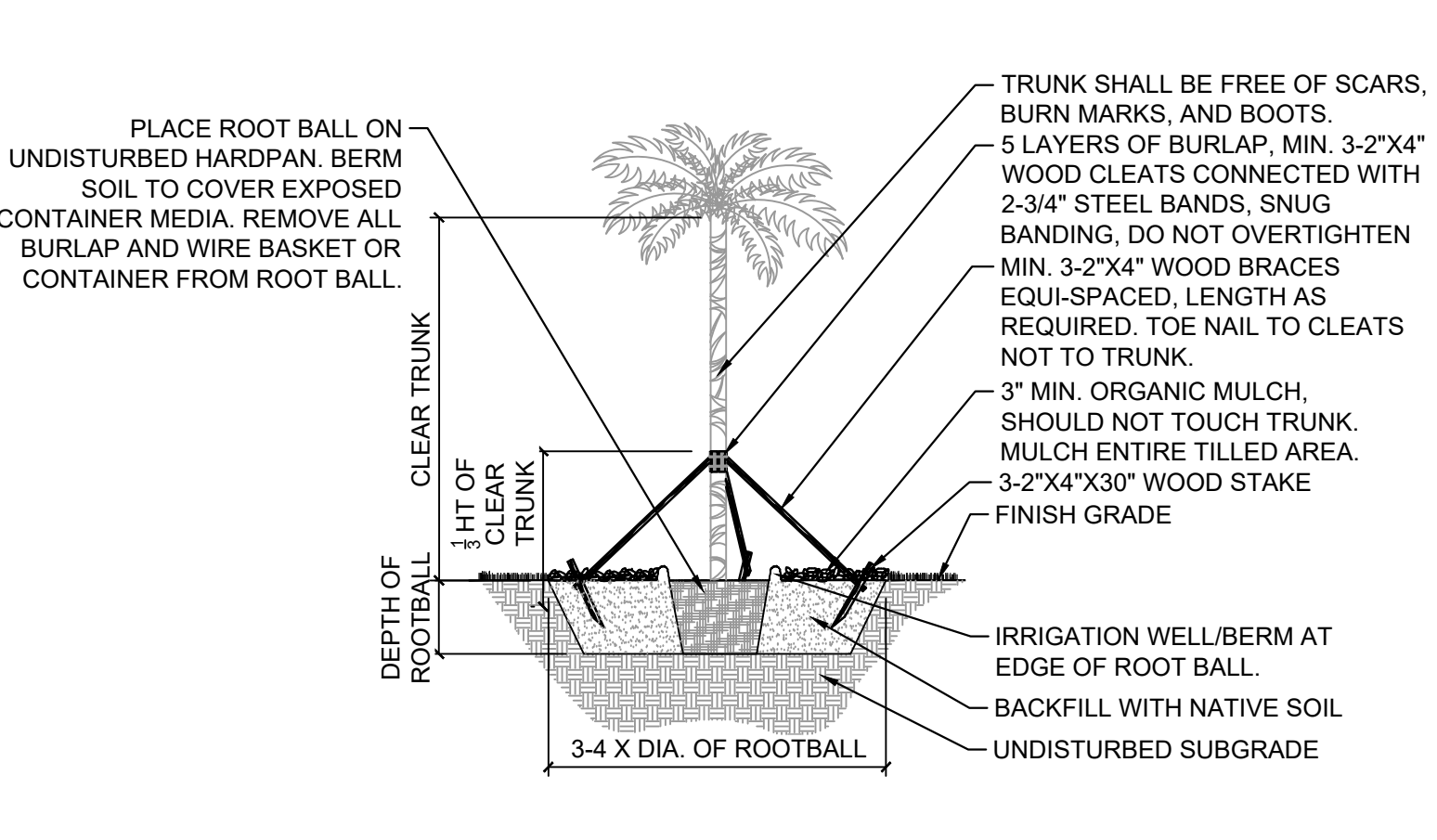

10 PALM TREE - SOILS WITHOUT HARDPAN

NTS

MA-STD-LS-11

CONSULTANTS:

PLANNER/ LANDSCAPE ARCHITECT/ CIVIL ENGINEER:

Matrix

2435 RESEARCH PARKWAY, SUITE 300
COLORADO SPRINGS, CO 80920
PHONE: (719) 575-0100
FAX: (719) 575-0208

OWNER/DEVELOPER:

RECKER GARDENS

APPROVAL:

VICINITY MAP:

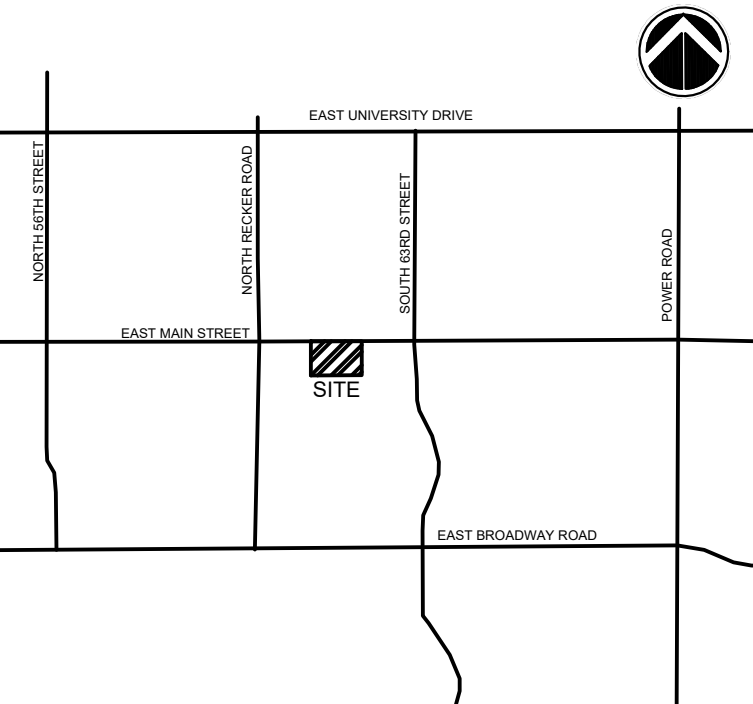

PROJECT:

RECKER GARDENS
PRELIMINARY LANDSCAPE PLAN

MESA, ARIZONA
MAY 23, 2024

REVISION HISTORY:

NO	DATE	DESCRIPTION	BY
1	07/15/2024	PER CITY COMMENTS	EA
2	09/23/2024	PER CITY COMMENTS	HV

DRAWING INFORMATION:

PROJECT NO: 24.1489.002

DRAWN BY: HV

CHECKED BY: JG

APPROVED BY: JG

SHEET TITLE:

LANDSCAPE
NOTES AND
DETAILS

LD01

SHEET 6 OF 8

CITY FILE NO.: ZON24-00469

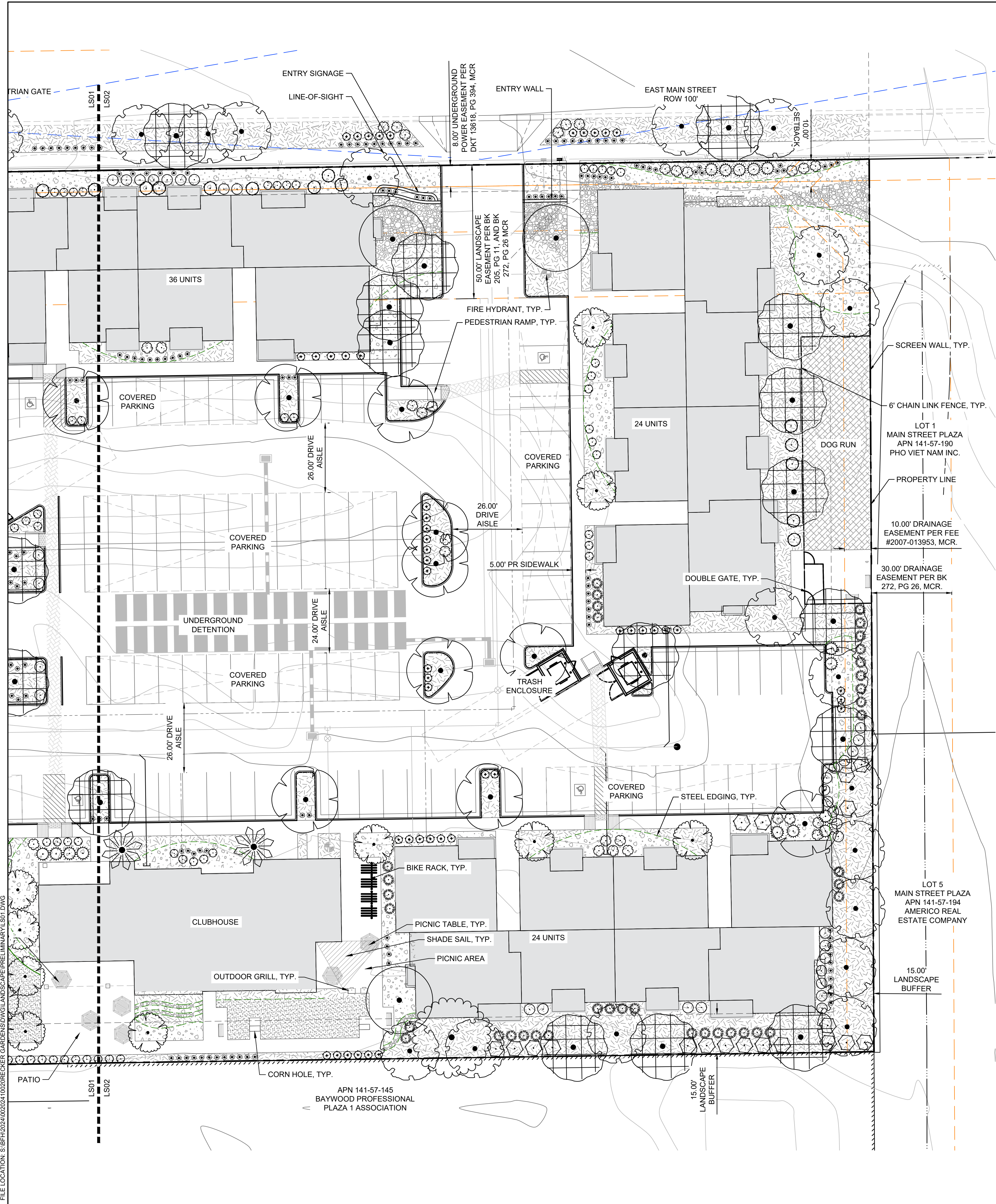

FILE LOCATION: S:\BPH\2024\002024\1002\RECKER GARDENS\DWG\LANDSCAPE\PRELIMINARY\LS01.DWG

2024-09-16 17:01

PLANT SCHEDULE

SYMBOL	CODE	QTY	BOTANICAL / COMMON NAME	PLANT SIZE	CONTAINER	MAT. H.	MAT. W.
DECIDUOUS TREES							
	OE	17	OLEA EUROPAEA 'FRUITLESS' FRUITLESS OLIVE	24" BOX	CONT.	30"	25"
	QV	3	QUERCUS VIRGINIANA SOUTHERN LIVE OAK	36" BOX	CONT.	40"	30"
EVERGREEN TREES							
	OT	31	OLNEYA TESOTA DESERT IRONWOOD	36" BOX	CONT.	25"	25"
	SL	38	SEARSIA LANCEA AFRICAN SUMAC	24" BOX	CONT.	30"	25"
ORNAMENTAL TREES							
	PL	18	PISTACIA LENTISCUS MASTIC TREE	24" BOX	CONT.	20"	15"
	CP	8	X CHITALPA TASHKENTENSIS 'PINK DAWN' PINK DAWN CHITALPA	36" BOX	CONT.	25"	25"
PALMS							
	CH	2	CHAMAEROPS HUMILIS MEDITERRANEAN FAN PALM	36" BOX	CONT.	15"	15"
EVERGREEN SHRUBS							
	CMB	71	CARISSA MACROCARPA 'BOXWOOD BEAUTY' BOXWOOD BEAUTY NATAL PLUM	#5 CONT.	CONT.	2'	2'
	CMG	67	CARISSA MACROCARPA 'GREEN CARPET' GREEN CARPET NATAL PLUM	#5 CONT.	CONT.	1.5'	4'
	CME	81	CHRYSACTINIA MEXICANA DAMIANITA	#5 CONT.	CONT.	1.5'	3'
	HPS	233	HESPERALOE PARVIFLORA 'STOPLIGHTS' STOPLIGHTS DWARF RED YUCCA	#5 CONT.	CONT.	2'	2'
	JUS	36	JUSTICIA SPICIGERA MEXICAN HONEYSUCKLE	#5 CONT.	CONT.	3'	5'
	RUP	72	RUPELLIA PENINSULARIS DESERT RUELLIA	#5 CONT.	CONT.	4'	4'
	TSG	32	TECOMA STANS STANS 'GOLD STAR' GOLD STAR YELLOW BELLS	#5 CONT.	CONT.	6'	6'
	TS	37	TECOMA X SMITHII ORANGE BELLS	#5 CONT.	CONT.	8'	5'
ORNAMENTAL GRASSES							
	MCL	59	MUHLENBERGIA CAPILLARIS 'LENCA' REGAL MIST® PINK MUHLY GRASS	#5 CONT.	CONT.	4'	4'

2024-09-13 14:17

LEGEND

	SOD	3,746 SF
	CRUSHED GRANITE	30,958 SF
	1 1/2" ROCK	12,717 SF
	2-4" COBBLE	2,172 SF
	PLAYGROUND SURFACE	2,465 SF
	WOOD MULCH	1,978 SF
	STEEL EDGING	
	CONCRETE EDGING	

20

0

10

20

SCALE: 1" = 20'

N

↑

CONSULTANTS:

PLANNER/ LANDSCAPE ARCHITECT/ CIVIL ENGINEER:

2435 RESEARCH PARKWAY, SUITE 300
COLORADO SPRINGS, CO 80920
PHONE: (719) 575-0100
FAX: (719) 575-0208

OWNER/DEVELOPER:

RECKER GARDENS

APPROVAL:

VICINITY MAP:

PROJECT:

RECKER GARDENS
PRELIMINARY LANDSCAPE PLAN

MESA, ARIZONA
MAY 23, 2024

REVISION HISTORY:

NO.	DATE	DESCRIPTION	BY
1	07/15/2024	PER CITY COMMENTS	EA
2	09/23/2024	PER CITY COMMENTS	HV

DRAWING INFORMATION:

PROJECT NO: 24,1489,002

DRAWN BY: HV

CHECKED BY: JG

APPROVED BY: JG

SHEET TITLE:

PRELIMINARY
LANDSCAPE PLAN

LS02

SHEET 8 OF 8

CITY FILE NO.: ZON24-00469