

INDUSTRIAL PARK

project consultants

owner:

CAVAN COMMERCIAL
6032 NORTH SCOTTSDALE ROAD, #200
SCOTTSDALE, ARIZONA 85254
CONTACT: AGNES FICKERA
PHONE: 602.390.4560
EMAIL: agnes@cavancommercial.com

architecture:

PINNACLE DESIGN, INC
1048 NORTH 44th STREET, #200
PHOENIX, AZ 85008
PROJECT CONTACT: MADDIE CULVER
PHONE: 602.952.8585
EMAIL: pdi-az.com

civil engineer:

KBELL ENGINEERING
1355 NORTH 86th PLACE
MESA, ARIZONA 85207
CONTACT: KELLY BELL
PHONE: 602.980.8246
EMAIL: kbell@kbelleng.com

landscape architecture:

DESIGN ETHIC, LLC
7525 EAST 6th AVENUE
SCOTTSDALE, ARIZONA 85251
PROJECT CONTACT: BRANDON PAUL
PHONE: 480.225.7077
EMAIL: bpaul@designethic.net

site data

EXISTING ZONING:	GI
PROPOSED USE:	LIGHT INDUSTRIAL / WAREHOUSE/ OFFICE
NET AREA:	+2.00 AC (+87,121 SF)
GROSS AREA:	+2.25 AC (+97,828 SF)
LOT COVERAGE:	+78% (+67,906 SF)
LANDSCAPE AREA:	+78% (+67,906 SF)
PROPOSED BUILDING:	28,009 SF
PARKING REQUIRED:	OFFICE SF +2,000 SF @ 1/ 375 WAREHOUSE SF: +21,800SF @ 1/ 900 29.55 (30 SPACES)
PARKING PROVIDED:	30 SPACES

sheet index

SHEET	TITLE
L0.01	COVER SHEET & NOTES
L2.01	OVERALL PLANTING PLAN
L2.02	PLANTING PLAN

city of mesa notes

ALL LANDSCAPING WITHIN THE RIGHT-OF-WAY IS IN CONFORMANCE WITH THE LOW WATER USE PLANT LIST PROVIDED BY THE ARIZONA DEPT. OF WATER RESOURCES.

ALL LANDSCAPING INSTALLED WITH THIS PROJECT SHALL BE MAINTAINED BY OWNER/OR LESSEE IN ACCORDANCE WITH THE APPROVED LANDSCAPE PLAN. TREE HEIGHTS & CALIPERS WILL COMPLY WITH "ARIZONA NURSEY ASSOCIATION SPECIFICATIONS" FOR THAT TYPE & SIZE OF TREE.

PLANT MATERIAL WITHIN THE SIGHT DISTANCE TRIANGLE SHALL NOT EXCEED 30-INCHES IN HEIGHT AT FULL MATURITY. TREES PLANTED WITHIN THE SIGHT DISTANCE TRIANGLE SHALL BE 24-INCH TO 42-INCH BOX SPECIMENS WITH NO BRANCHES LOWER THAN 8-FEET ABOVE THE SIDEWALK ELEVATION, AND 14-FEET OVER VEHICULAR TRAFFIC WAYS.

ALL BACKFLOW PREVENTERS 2" OR LARGER SHALL BE SCREENED WITH LANDSCAPE MATERIAL LOCATED WITHIN A 6' RADIUS OF THE BACKFLOW PREVENTER.

ALL BACKFLOW PREVENTERS LESS THAN 2" SHALL BE PLACED IN A WIRE MESH BASKET AND PAINTED GREEN.

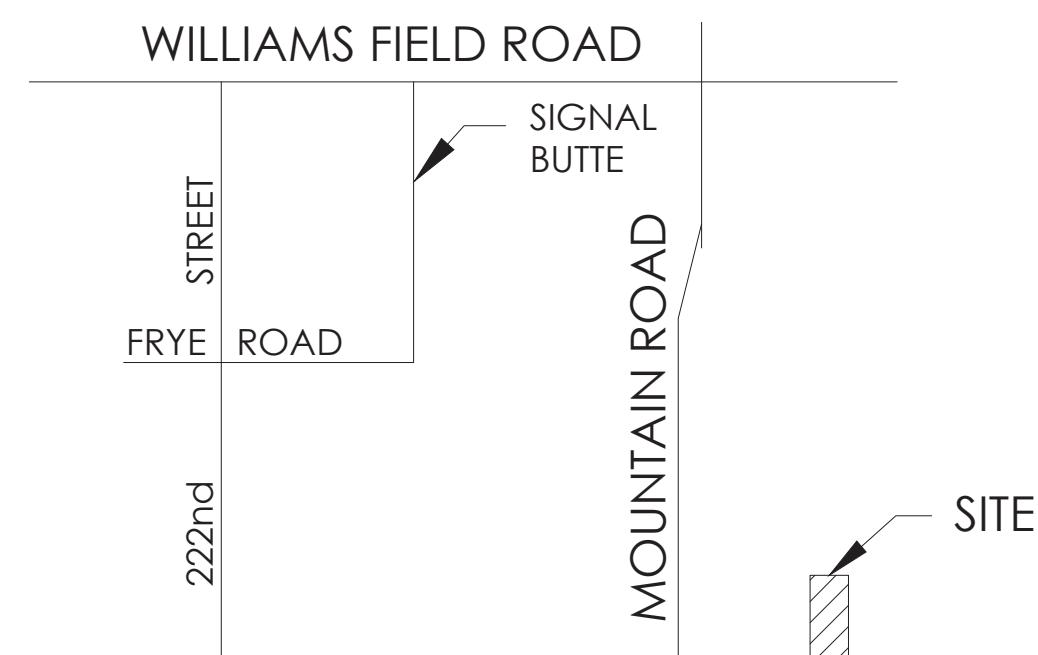

vicinity map



not to scale

city of mesa landscape data

ZONING:	GI
NET SITE AREA:	+2.00 AC (+87,121 S.F.)
TOTAL R.O.W.:	3,272 S.F.
TOTAL FRONTAGE:	134 L.F.
TOTAL ON-SITE LANDSCAPE:	14,425 S.F.
PERCENTAGE OF LANDSCAPE:	16.6%
OVERALL:	
TREES PROVIDED FOR ENTIRE SITE:	35 TREES
36" BOX TREES REQUIRED:	8 TREES
(25% OF TREES REQUIRED FOR ENTIRE SITE)	
36" BOX TREES PROVIDED:	8 TREES
STREET FRONTAGE - 134 LINEAR FEET:	
TREES REQUIRED:	6
(1 PER 25' OF STREET FRONTAGE - 134 / 25 = 6)	
TREES PROVIDED:	6
24" BOX TREES REQUIRED:	3
(50% OF TREES REQUIRED)	
24" BOX TREES PROVIDED:	4
36" BOX TREES REQUIRED:	2
(25% OF TREES REQUIRED)	
36" BOX TREES PROVIDED:	2
SHRUBS REQUIRED:	36
(6 PER 25' OF STREET FRONTAGE)	
SHRUBS PROVIDED:	42

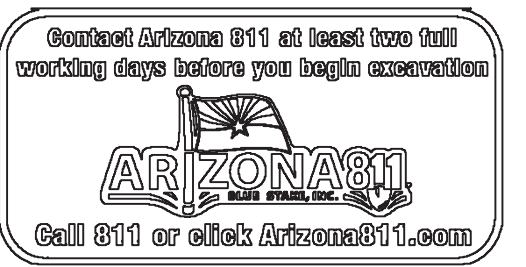
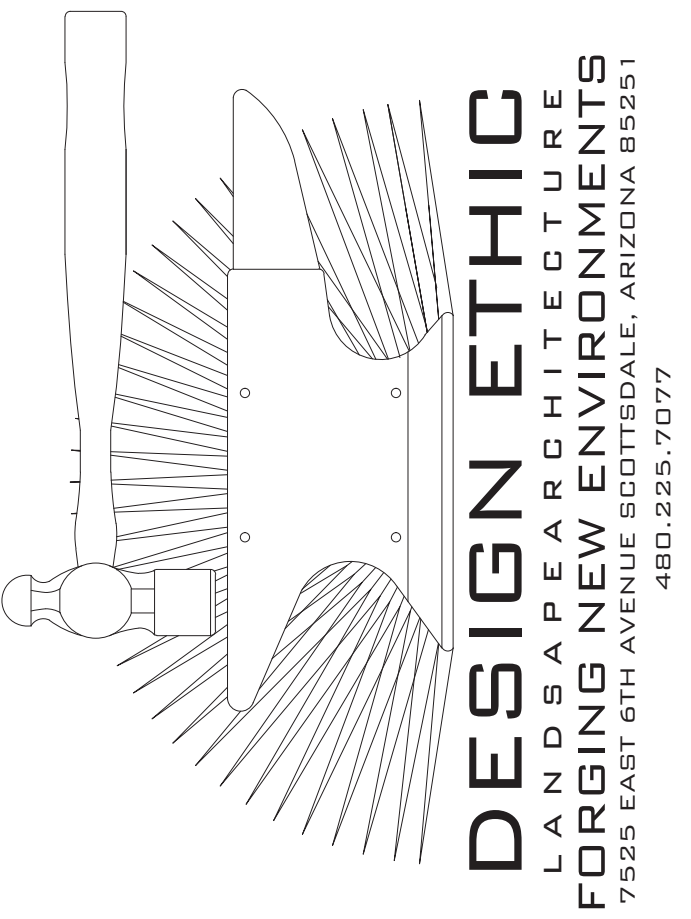

INDUSTRIAL PARK
PECOS ROAD & MOUNTAIN ROAD
MESA, ARIZONA 85212

COVER SHEET & NOTES

PROJECT:

SHEET TITLE:

JOB NO: 23-047
DATE: -
DRAWN BY: B. PAUL
SUBMITTED: 03.01.2024
REVISED:

SHEET

L0.01

1 of 3

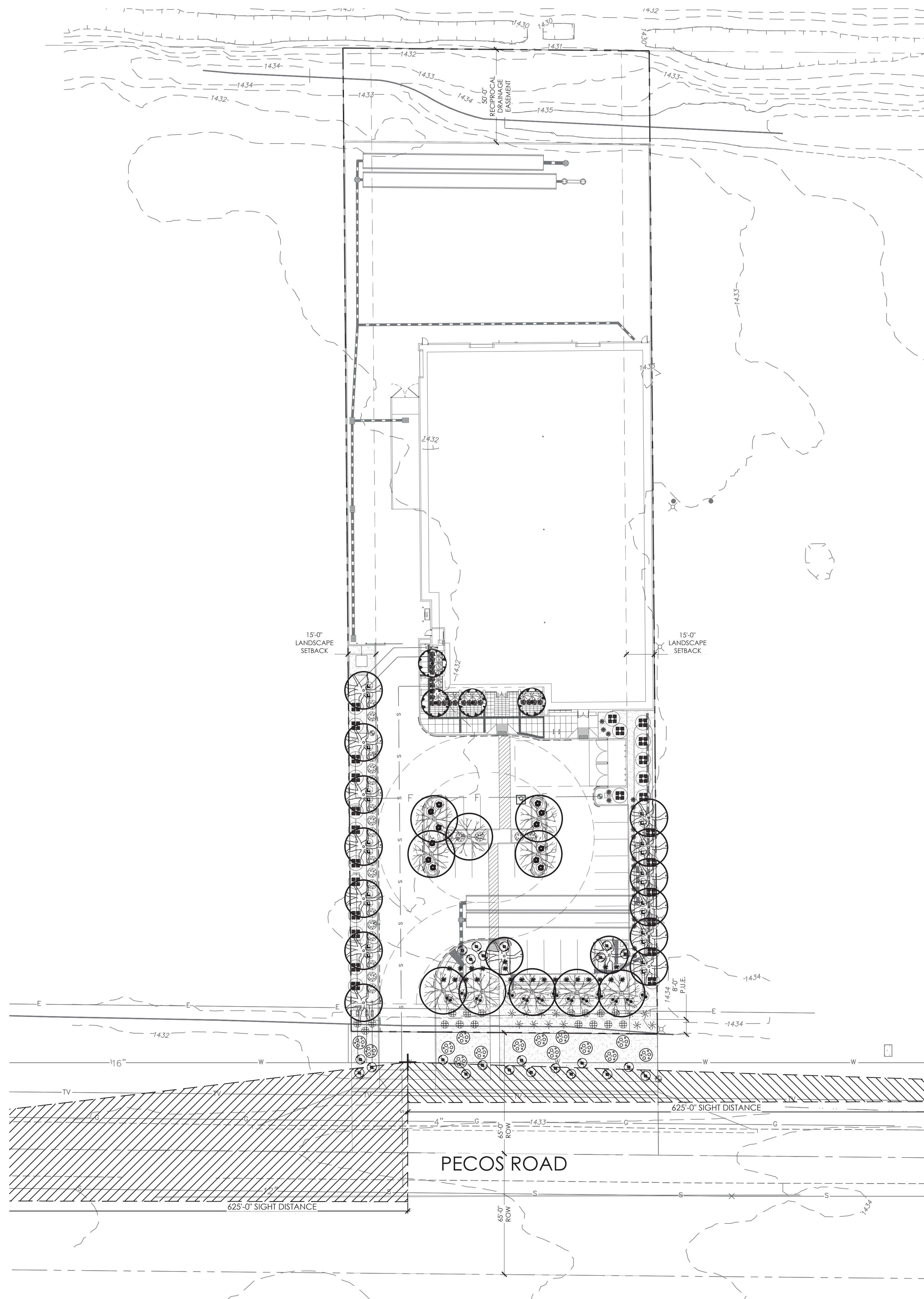

plant legend

	botanical name common name	emitters	size	qty	comments
evergreen trees					
	ACACIA ANEURA MULGA	(5 @ 1.0 GPH)	24" BOX 36" BOX	1 3	6.0H., 2.0W., .75 CAL. 7.0H., 4.0W., 1.5 CAL. STAKE IN PLACE
	PISTACIA X. RED PUSH RED PUSH PISTACHE	(6 @ 2.0 GPH)	24" BOX 36" BOX	14 1	7.0H., 2.5W., 1.0 CAL. 9.0H., 4.0W., 1.75 CAL. STAKE IN PLACE
	TIPUANA TIPU TIPU TREE	(6 @ 2.0 GPH)	24" BOX 36" BOX	6 4	7.0H., 3.0W., 1.0 CAL. 9.0H., 5.0W., 1.75 CAL. STAKE IN PLACE
large shrubs					
	TECOMA ALATA ORANGE JUBILEE	(1 @ 1.0 GPH)	5 GAL.	26	PLANT AT 8' O.C.
medium shrubs					
	Ms. ALICE BOUGAINVILLEA WHITE BOUGAINVILLEA	(1 @ 1.0 GPH)	5 GAL.	13	PLANT AT 5' O.C.
	HESPERALOE FUNIFERA GIANT HESPERALOE	(1 @ 1.0 GPH)	5 GAL.	27	PLANT AT 4' O.C.
	LEUCOPHYLLUM LANGMANIAE RIO BRAVO TEXAS RANGER	(1 @ 1.0 GPH)	5 GAL.	12	PLANT AT 8' O.C.
	SENNA OLIGOPHYLLA OUTBACK CASSIA	(1 @ 1.0 GPH)	5 GAL.	17	PLANT AT 4' O.C.
small shrubs					
	ASCLEPIAS SUBULATA DESERT MILKWEED	(1 @ 1.0 GPH)	5 GAL.	23	PLANT AT 3' O.C.
	EREMOPHILA HYGROPHANA 'BLUE BELLS' EMU	(1 @ 1.0 GPH)	5 GAL.	23	PLANT AT 4' O.C.
	HESPERALOE PARVIFLORA 'DESERT FLAMENCO' DESERT FLAMENCO RED YUCCA	(1 @ 1.0 GPH)	5 GAL.	17	PLANT AT 3' O.C.
	PORTULACARIA AFRA ELEPHANT'S FOOT	(1 @ 1.0 GPH)	5 GAL.	21	PLANT AT 3' O.C.
evergreen groundcovers					
	ACACIA REDOLENS DESERT CARPET	(1 @ 1.0 GPH)	1 GAL.	14	PLANT AT 7' O.C.
	EREMOPHILA GLABRA 'MINGENEW GOLD' OUTBACK SUNRISE EMU	(1 @ 1.0 GPH)	5 GAL.	23	PLANT AT 3' O.C.
inerts					
	1/2" SCREENED DECOMPOSED GRANITE EXPRESS BROWN		3/4" SCRND	14,425 S.F.	2' MINIMUM DEPTH IN ALL PLANTERS

planting key notes

- 1 PROPERTY LINE / RIGHT OF WAY LINE
- 2 DECOMPOSED GRANITE IN ALL PLANTING AREAS.
- 3 SIGHT VISIBILITY TRIANGLE. MAXIMUM MATURE PLANT MATERIAL HEIGHT IN THE SIGHT VISIBILITY TRIANGLES IS 24 INCHES.
- 4 ACCESSIBLE RAMP. SEE CIVIL ENG. PLANS.
- 5 SIDEWALK. SEE CIVIL ENG. PLANS.
- 6 FIRE HYDRANT - 3'-0" CLEAR OF ALL PLANT MATERIAL.
- 7 SITE LIGHTING. SEE ARCH. PLANS.
- 8 3' HIGH PARKING SCREEN WALL. SEE ARCH. PLANS.
- 9 CONCRETE CURB. SEE CIVIL ENG. PLANS.
- 10 TRASH ENCLOSURE. SEE ARCH. SITE PLAN.
- 11 P.U.E. SEE CIVIL ENG. PLANS.
- 12 STORMWATER RETENTION. SEE CIVIL ENG. PLANS.
- 13 DRAINAGE STRUCTURE. SEE CIVIL ENG. PLANS.
- 14 RIP RAP. SEE CIVIL ENG. PLANS.
- 15 DECORATIVE CONCRETE HARDSCAPE SEE ARCH. SITE PLAN.
- 16 8' HIGH CMU WALL. SEE ARCH. PLANS.
- 17 BICYCLE PARKING. SEE ARCH. SITE PLAN.
- 18 PROPOSED TRANSFORMER LOCATION. MAINTAIN 3' ACCESS & CLEARANCE AROUND ALL EDGES. ALLOW FOR 12' CLEAR OPERATIONAL AREA IMMEDIATELY IN FRONT OF TRANSFORMER.

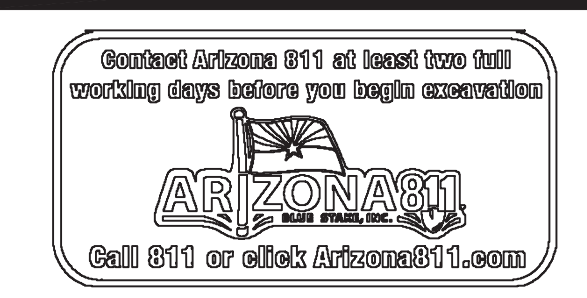
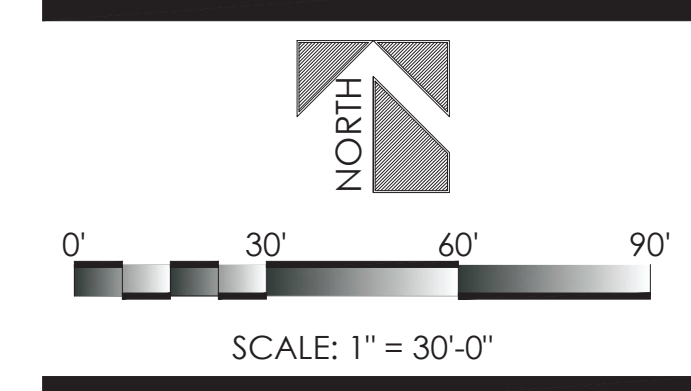
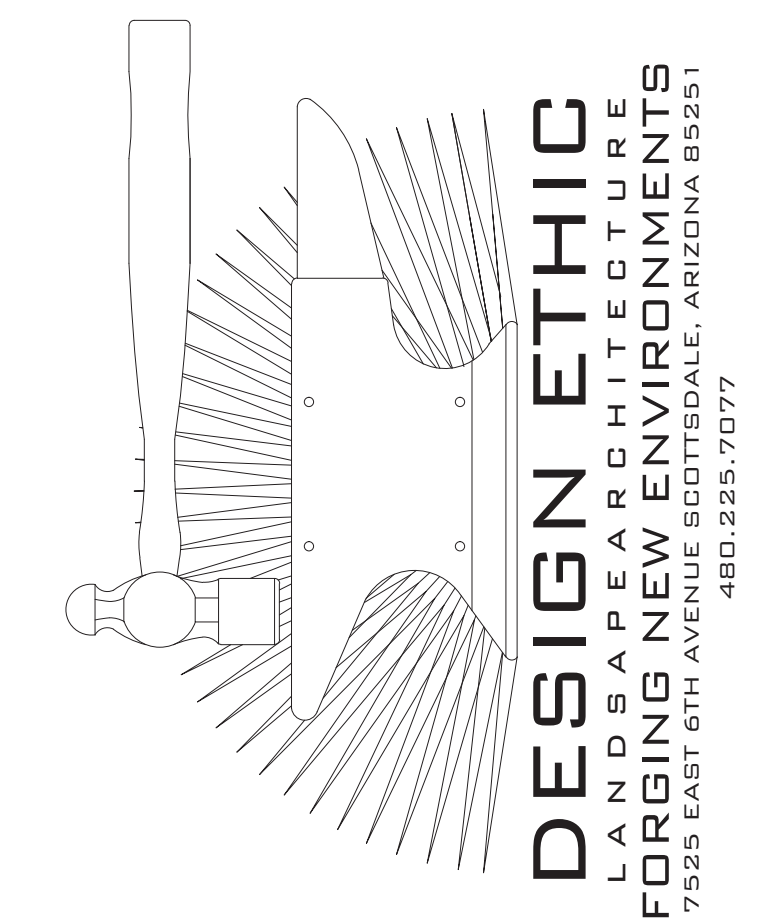

INDUSTRIAL PARK
PECOS ROAD & MOUNTAIN ROAD
MESA, ARIZONA 85212
OVERALL PLANTING PLAN

PROJECT: _____
 SHEET TITLE: _____
 JOB NO: 23-047
 DATE: -
 DRAWN BY: B. PAUL
 SUBMITTED: 03.01.2024
 REVISED: _____

SHEET
L2.01
 2 of 3

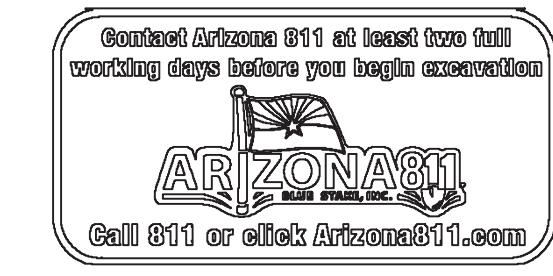
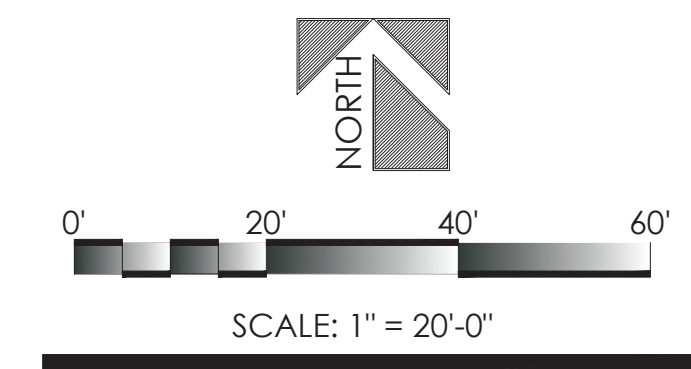

plant legend

botanical name	common name
evergreen trees	
ACACIA ANEURA MULGA	
PISTACIA X. RED PUSH RED PUSH PISTACHE	
TIPUANA TIPU TIPU TREE	
large shrubs	
TECOMA ALATA ORANGE JUBILEE	
medium shrubs	
Ms. ALICE BOUGAINVILLEA WHITE BOUGAINVILLEA	
HESPERALOE FUNIFERA GIANT HESPERALOE	
LEUCOPHYLLUM LANGMANIAE 'RIO BRAVO' RIO BRAVO TEXAS RANGER	
SENNA OLIGOPHYLLA OUTBACK CASSIA	
small shrubs	
ASCLEPIAS SUBULATA DESERT MILKWEED	
EREMOPHILA HYGROPHANA 'BLUE BELLS' EMU	
HESPERALOE PARVIFLORA 'DESERT FLAMENCO' DESERT FLAMENCO RED YUCCA	
PORTULACARIA AFRA ELEPHANTS FOOD	
evergreen groundcovers	
ACACIA REDOLENS DESERT CARPET	
EREMOPHILA GLABRA 'MINGENW GOLD' OUTBACK SUNRISE EMU	
inerts	
1/2" SCREENED DECOMPOSED GRANITE EXPRESS BROWN	

**city of mesa
landscape data**

ZONING:	GI
NET SITE AREA:	+2.00 AC (+87,121 S.F.)
TOTAL R.O.W.:	3,272 S.F.
TOTAL FRONTAGE:	134 L.F.
TOTAL ON-SITE LANDSCAPE:	14,425 S.F.
PERCENTAGE OF LANDSCAPE:	16.6%
OVERALL:	
TREES PROVIDED FOR ENTIRE SITE:	35 TREES
36" BOX TREES REQUIRED:	8 TREES
(25% OF TREES REQUIRED FOR ENTIRE SITE)	
36" BOX TREES PROVIDED:	8 TREES
STREET FRONTAGE - 134 LINEAR FEET:	
TREES REQUIRED:	6
(1 PER 25' OF STREET FRONTAGE - 134 / 25 = 6)	
TREES PROVIDED:	6
24" BOX TREES REQUIRED:	3
(50% OF TREES REQUIRED)	
24" BOX TREES PROVIDED:	4
36" BOX TREES REQUIRED:	2
(25% OF TREES REQUIRED)	
36" BOX TREES PROVIDED:	2
SHRUBS REQUIRED:	36
(6 PER 25' OF STREET FRONTAGE)	
SHRUBS PROVIDED:	42

city of mesa vegetation credit table

	CREDIT (S.F.)	QTY ON PLAN	TOTAL CREDIT (S.F.)
EVERGREEN TREE: (MIN. 25'-0" TALL AT MATURITY)	100	29	2,900
SHADE TREE: (MIN. 25'-0" TALL AT MATURITY)	50	--	--
ORNAMENTAL TREE:	25	--	--
LARGE SHRUB: (MIN. 8'-0" TALL AT MATURITY)	50	26	1,300
MEDIUM SHRUB: (4'-0" - 8'-0" TALL AT MATURITY)	25	69	1,725
SMALL SHRUB: (UNDER 4'-0" TALL AT MATURITY)	10	84	840
EVERGREEN GROUNDCOVER:	25	37	925
TOTAL VEGETATION CREDIT (S.F.)			7,690
TOTAL OPEN SPACE (S.F.)			14,425
VEGETATION COVERAGE (%)			53.31%

visibility triangle info

SITE VISIBILITY TRIANGLES ARE BASED ON CITY OF MESA PUBLIC STREET ACCESS GUIDELINES DATED FEB. 15, 2005.

PECOS ROAD
STREET SPEED: 45 MPH
STREET CROSS SECTION 4LU
FIGURE 2.3 (50 MPH DESIGN SPEED) SD = 625'

planting key notes

- 1 PROPERTY LINE / RIGHT OF WAY LINE
- 2 DECOMPOSED GRANITE IN ALL PLANTING AREAS.
- 3 SIGHT VISIBILITY TRIANGLE. MAXIMUM MATURE PLANT MATERIAL HEIGHT IN THE SIGHT VISIBILITY TRIANGLES IS 24 INCHES.
- 4 ACCESSIBLE RAMP. SEE CIVIL ENG. PLANS.
- 5 SIDEWALK. SEE CIVIL ENG. PLANS.
- 6 FIRE HYDRANT - 3'-0" CLEAR OF ALL PLANT MATERIAL.
- 7 SITE LIGHTING. SEE ARCH. PLANS.
- 8 3' HIGH PARKING SCREEN WALL. SEE ARCH. PLANS.
- 9 CONCRETE CURB. SEE CIVIL ENG. PLANS.
- 10 TRASH ENCLOSURE. SEE ARCH. SITE PLAN.
- 11 P.U.E. SEE CIVIL ENG. PLANS.
- 12 STORMWATER RETENTION. SEE CIVIL ENG. PLANS.
- 13 DRAINAGE STRUCTURE. SEE CIVIL ENG. PLANS.
- 14 RIP RAP. SEE CIVIL ENG. PLANS.
- 15 DECORATIVE CONCRETE HARDSCAPE SEE ARCH. SITE PLAN.
- 16 8' HIGH CMU WALL. SEE ARCH. PLANS.
- 17 BICYCLE PARKING. SEE ARCH. SITE PLAN.
- 18 PROPOSED TRANSFORMER LOCATION. MAINTAIN 3' ACCESS & CLEARANCE AROUND ALL EDGES. ALLOW FOR 12' CLEAR OPERATIONAL AREA IMMEDIATELY IN FRONT OF TRANSFORMER.

PROJECT:

JOB NO: 23-047
DATE: -
DRAWN BY: B. PAUL
SUBMITTED: 03.01.2024
REVISED:

SHEET TITLE:

SHEET
L2.02

3 of 3

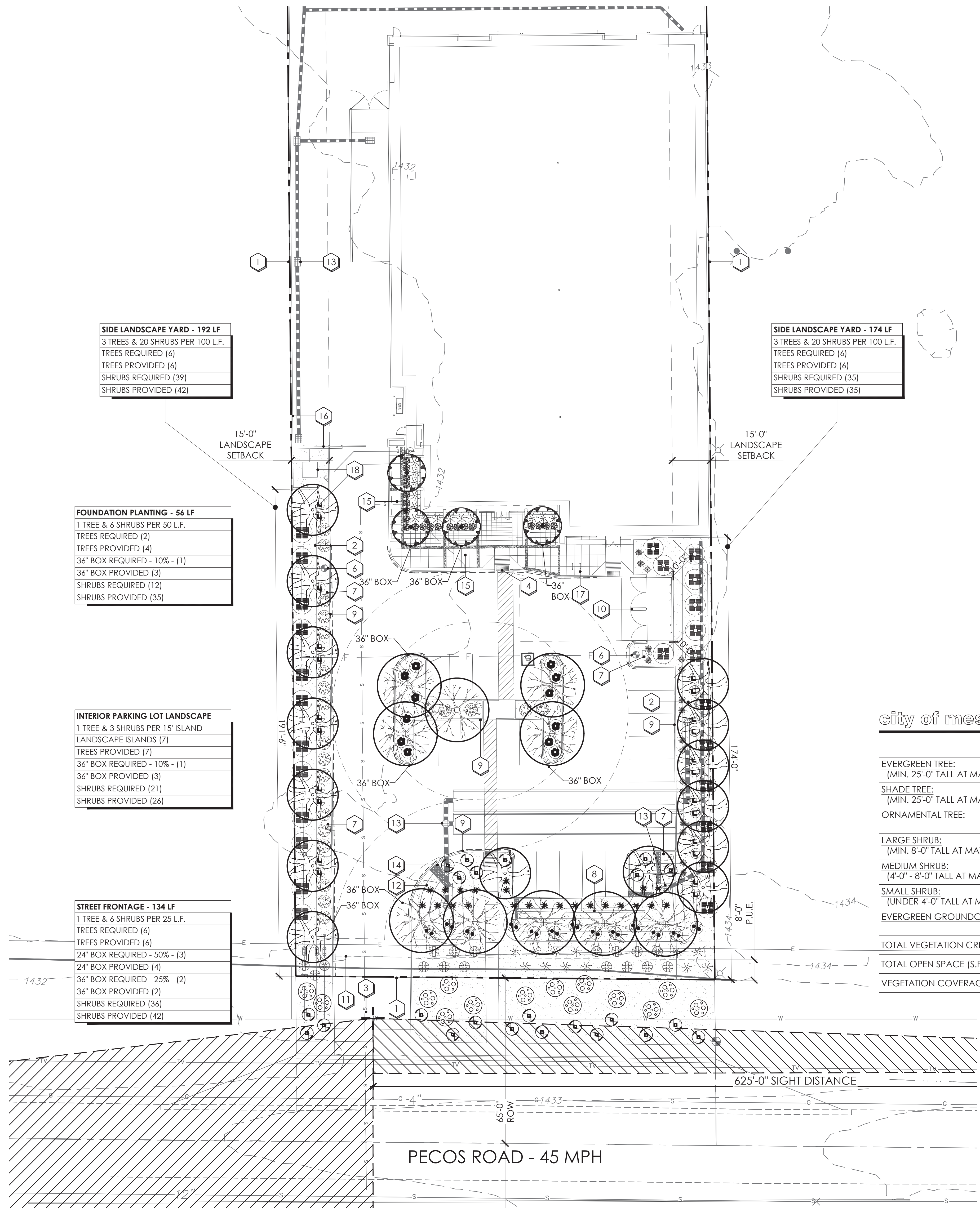

INDUSTRIAL PARK
PECOS ROAD & MOUNTAIN ROAD
MESA, ARIZONA 85212
PLANTING PLAN