

When recorded mail to:  
City of Mesa  
Real Estate Services  
P.O. Box 1466  
Mesa, AZ 85211-1466

4907-6-1-1--  
brodiek

---

**ANNEXATION**

**City of Mesa**

**DO NOT REMOVE**

**This is part of the official document**

When recorded, return to:  
City of Mesa  
Planning Division  
P.O. Box 1466  
Mesa AZ 85211-1466

ANNEXATION PETITION  
ANX20-00206

TO: THE HONORABLE MAYOR AND CITY COUNCIL OF THE  
CITY OF MESA, ARIZONA:

We the undersigned, owners of not less than one-half in value of the real property and personal property and more than one-half of the persons owning real and personal property that would be subject to taxation by the City of Mesa in the event of annexation within the territory proposed to be annexed, which is hereafter described, said territory being contiguous to the corporate limits of the City of Mesa, with the exterior boundaries of the territory proposed to be annexed shown on the map attached hereto, marked Exhibit "A" and made a part hereof, request the City of Mesa to annex the following described territory, provided Section 9-471, Arizona Revised Statutes, and amendments thereto, are fully observed.

The description of the territory proposed to be annexed, not already within the present limits of the City of Mesa and located in Maricopa County, Arizona, is as follows:

A PARCEL OF LAND LOCATED IN SECTION 24 AND SECTION 25, TOWNSHIP 1 SOUTH, RANGE 7 EAST OF THE GILA AND SALT RIVER BASE AND MERIDIAN, MARICOPA COUNTY, ARIZONA DESCRIBED AS FOLLOWS:

THE EAST 288.49 FEET OF THE WEST 328.49 FEET OF THE SOUTH 55 FEET OF THE SOUTHEAST QUARTER OF SECTION 24, TOWNSHIP 1 SOUTH, RANGE 7 EAST;

ALONG WITH THE NORTH 659.51 FEET OF THE EAST 45 FEET OF THE NORTHWEST QUARTER OF SECTION 25, TOWNSHIP 1 SOUTH, RANGE 7 EAST;

ALONG WITH THE NORTH 65 FEET OF THE WEST 328.49 FEET OF THE NORTHEAST QUARTER OF SECTION 25, TOWNSHIP 1 SOUTH, RANGE 7 EAST;

ALONG WITH THE WEST 40 FEET OF THE SOUTH 594.51 FEET OF THE NORTH 659.51 FEET OF THE NORTHEAST QUARTER OF SECTION 25, TOWNSHIP 1 SOUTH, RANGE 7 EAST;

AND ALONG WITH THE FOLLOWING DESCRIBED PARCEL:

COMMENCING AT THE NORTH QUARTER CORNER OF SECTION 25 BEING A 2 INCH MARICOPA COUNTY ALUMINUM CAP RLS# 36563, THENCE SOUTH 89 DEGREES 26 MINUTES 50 SECONDS EAST (BASIS OF BEARING) ALONG THE NORTH LINE OF THE NORTHEAST QUARTER A DISTANCE OF 40.00 FEET, THENCE SOUTH 0 DEGREES 27 MINUTES 0 SECONDS EAST A DISTANCE OF 65 FEET TO THE POINT OF BEGINNING;

THENCE SOUTH 0 DEGREES 27 MINUTES 0 SECONDS EAST PARALLEL TO THE WEST LINE OF THE NORTHEAST QUARTER A DISTANCE OF 594.51 FEET;

THENCE SOUTH 89 DEGREES 28 MINUTES 2 SECONDS EAST A DISTANCE OF 288.53 FEET;

THENCE NORTH 0 DEGREES 27 MINUTES 14 SECONDS WEST A DISTANCE OF 594.41 FEET;

THENCE NORTH 89 DEGREES 26 MINUTES 50 SECONDS WEST A DISTANCE OF 288.49 FEET TO THE POINT OF BEGINNING.

# ANX20-00206

## 6.00± Acres

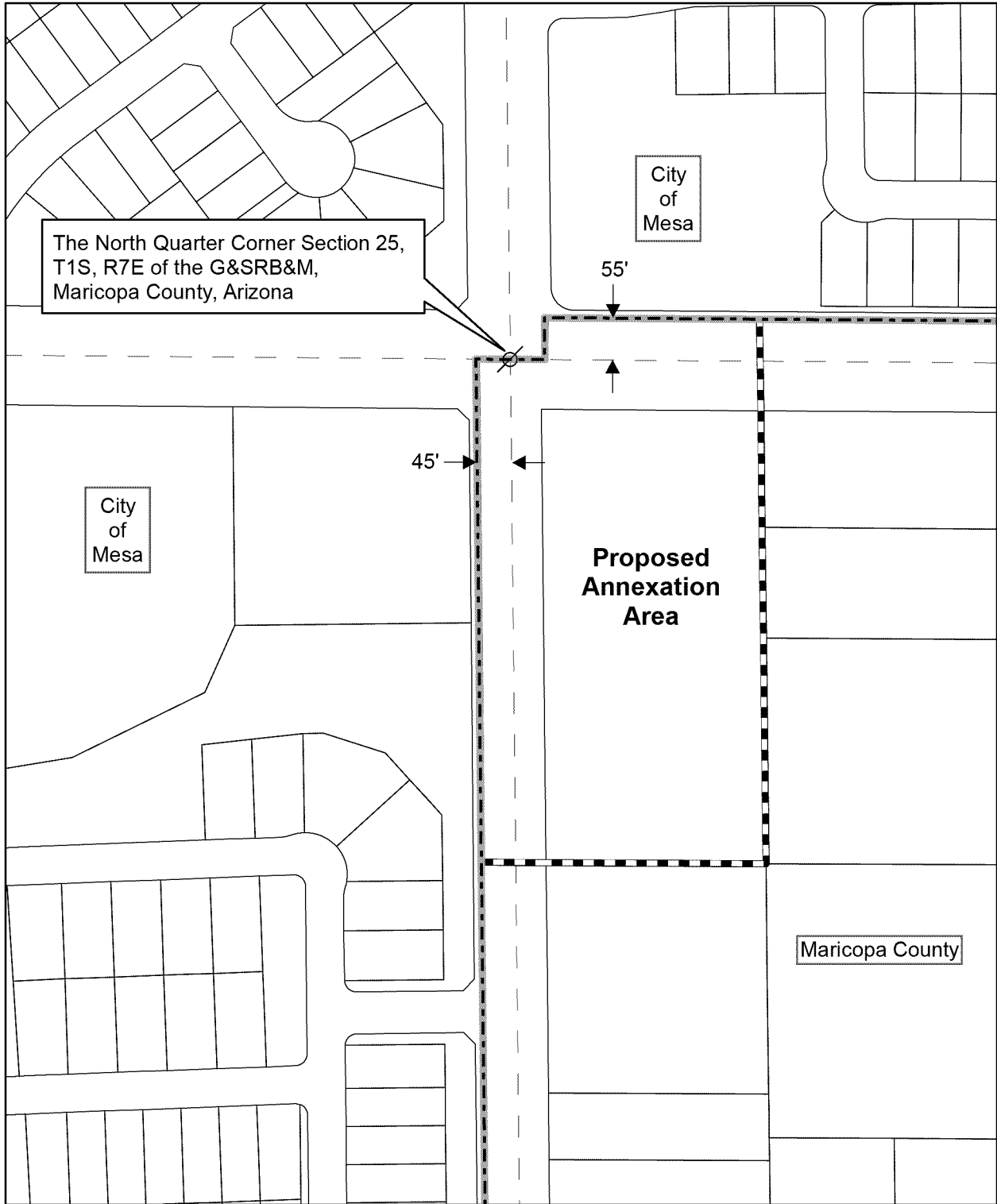

-  Legal Control Point
-  City of Mesa Boundary
-  Quarter Section
-  Proposed Annexation Boundary

# EXHIBIT 'A'



**AFFIDAVIT**

I, Nana Appiah, the Planning Director of the City of Mesa, Maricopa County, Arizona, do hereby certify that Annexation Number ANX20-00206 does not include lands that are subject to an earlier filing for annexation.

I, certify that the information contained in this form is true and accurate to the best of my knowledge, and I acknowledge that this document will be recorded as an official record in the Office of the Maricopa County Recorder.

\_\_\_\_\_  
Nana Appiah, Planning Director

\_\_\_\_\_  
Date

State of Arizona     )  
                                  )ss  
County of Maricopa )

This instrument was acknowledged before me this 9<sup>th</sup> day of June 2020.

WITNESS my hand and official seal the day and year in this affidavit above written.

\_\_\_\_\_  
Notary Public



We the undersigned owners, hereby sign in favor for annexation of our property to the City of Mesa Corporate Limits, as described by the attached annexation petition.

**PLEASE PRINT OR TYPE, EXCEPT FOR SIGNATURES.**

---

Owner (s) \_\_\_\_\_ Phone No. \_\_\_\_\_

Mailing Address \_\_\_\_\_

County Assessor Parcel No. \_\_\_\_\_

Signature (s) \_\_\_\_\_ Date \_\_\_\_\_

---

Owner (s) \_\_\_\_\_ Phone No. \_\_\_\_\_

Mailing Address \_\_\_\_\_

County Assessor Parcel No. \_\_\_\_\_

Signature (s) \_\_\_\_\_ Date \_\_\_\_\_

---

Owner (s) \_\_\_\_\_ Phone No. \_\_\_\_\_

Mailing Address \_\_\_\_\_

County Assessor Parcel No. \_\_\_\_\_

Signature (s) \_\_\_\_\_ Date \_\_\_\_\_

---

Owner (s) \_\_\_\_\_ Phone No. \_\_\_\_\_

Mailing Address \_\_\_\_\_

County Assessor Parcel No. \_\_\_\_\_

Signature (s) \_\_\_\_\_ Date \_\_\_\_\_