

**LANDSCAPE COVER SHEET**

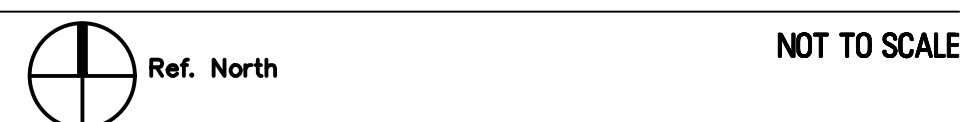

**GENERAL NOTES:**

1. ALL PLANTING AREAS TO HAVE TOP DRESSING OF DECOMPOSED GRANITE, SIZE AND COLOR AS NOTED IN LEGEND, 2" DEPTH, TYP. APPLIED OVER PRE-EMERGENT PER MFG. SPECS, 2 APPLICATIONS, MIN.
2. VERIFY ALL CONDITIONS IN FIELD PRIOR TO BIDDING/ INSTALLATION. DISCREPANCIES SHALL BE BROUGHT TO THE LANDSCAPE ARCHITECT'S ATTENTION, IN WRITING.
3. NO PLANT SUBSTITUTION ALLOWED UNLESS APPROVED BY LANDSCAPE ARCHITECT.
4. LANDSCAPE ARCHITECT TO APPROVE ALL TREES AND SHRUBS PRIOR TO DELIVERY TO SITE.
5. LANDSCAPE ARCHITECT OR HIS REPRESENTATIVE RESERVE THE RIGHT TO REFUSE ANY PLANT HE/SHE DEEMS UNACCEPTABLE.
6. FOR CLARIFICATION OF DISCREPANCIES BETWEEN THE DRAWINGS AND THE SITE, THEY SHOULD BE BROUGHT TO THE ATTENTION OF THE LANDSCAPE ARCHITECT PRIOR TO BEGINNING WORK.
7. LANDSCAPE CONTRACTOR IS RESPONSIBLE TO TAKE PRECAUTIONS TO PROTECT ANY EXISTING IMPROVEMENTS.
8. PLANT LIST/QTY'S PROVIDED FOR CONTRACTOR'S CONVENIENCE ONLY. PLANS TAKE PRECEDENCE.
9. FINISHED GRADE BELOW ALL PLANTERS SHALL BE 1" BELOW ADJACENT HEADER, PAVING, CURBING, ETC.
10. GROUND COVER AND/OR DG SHALL EXTEND UNDER SHRUBS UNLESS NOTED.
11. ALL EARTHWORK IS TO BE DONE SO THAT ALL WATER DRAINS AWAY FROM ALL STRUCTURES.
12. ALL UNDERGROUND CONDUITS/PIPES/UTILITIES ARE TO BE LOCATED PRIOR TO DIGGING.
13. CONTRACTOR IS RESPONSIBLE FOR ALL REQUIRED SLEEVEING WHETHER IT IS SHOWN ON THE PLANS OR NOT.
14. LANDSCAPE CONTRACTOR RESPONSIBLE TO DEMO ALL EXISTING PLANT MATERIAL NOT SHOWN TO REMAIN.

**EXIST. CONDITIONS GENERAL NOTES**

1. ALL PLANT MATERIAL DESIGNATED AS "EXISTING TO REMAIN" SHALL BE PROTECTED DURING ALL PHASES OF CONSTRUCTION. ANY TREE THAT DIES DUE TO LACK OF WATER, MAINTENANCE OR CARE, NEGLIGENCE OR VANDALISM SHALL BE REPLACED BY LIKE TYPE AND SIZE TREE AT NO ADDITIONAL COST TO THE OWNER.
2. ALL SHRUBS/GCOVERS SHALL BE REPLACED W/ 5 GAL PLANTS. LANDSCAPE AREAS DISTURBED BY NEW CONSTRUCTION SHALL BE REPLACED W/ NEW DG MATCHING EXISTING. BLEND ALL DISTURBED AREAS SO THERE IS SMOOTH TRANSITION BETWEEN ALL EDGES.
3. ANY/ALL BROKEN HEADERS TO BE REPLACED.
4. ALL EXISTING PLANT MATERIAL AND ADJACENT PLANT MATERIAL SHALL HAVE UNINTERRUPTED WATERING DURING ALL PHASES OF CONSTRUCTION. THIS SHALL INCLUDE BUT NOT BE LIMITED TO; HAND WATERING, TRUCK WATERING, TEMPORARY SYSTEM, ETC.
5. THE EXISTING IRRIGATION SYSTEM SHALL BE PROTECTED, MAINTAINED AND REPAIRED DURING ALL PHASES OF CONSTRUCTION. THE EXISTING SYSTEM IS TIED TO ADJACENT PROPERTIES. ALL EQUIPMENT SUCH AS MAINLINE, WIRES, LATERALS, HEADS, EMITTERS, ETC SHALL BE REPAIRED/REPLACED AS REQ TO MAINTAIN CONTINUOUS WATER.
6. ALL EXISTING TREES TO REMAIN SHALL BE SELECTIVELY PRUNED PER LANDSCAPE ARCHITECT DIRECTION.

**CITY NOTES:**

1. ALL EXISTING VEGETATION, WEEDS, DEBRIS, ETC... ARE TO BE REMOVED FROM THE PROJECT AREA AND DISPOSED OF PROPERLY OFFSITE AT THE CONTRACTOR'S EXPENSE. THE CONTRACTOR SHALL THEN SCARIFY EXISTING SUBGRADE, TO A MINIMUM 8-INCH DEPTH.
2. SOIL TEST FOR FERTILITY AND ADDITIVE RECOMMENDATIONS (FOR TURF AND ORNAMENTALS) SHALL BE MADE SEVEN (7) DAYS PRIOR TO ANTICIPATED PLANTING TO DETERMINE IF ADDITIVES ARE REQUIRED. CONTRACTOR SHALL PROVIDE AND INCORPORATE SUCH ADDITIVES PRIOR TO OR AT THE TIME OF PLANTING.
3. CONTRACTOR SHALL STAKE TREE AND SHRUB LOCATIONS FOR 5-GALLON PLANTS AND LARGER. STAKES SHALL BE MARKED WITH PLANT NAME OR PLANT NAME OF PLANT LEGEND ITEM NUMBER FROM PLANS.
4. CONTRACTOR SHALL NOTIFY CITY ENGINEERING DIVISION (480-644-2253) 24-HOURS IN ADVANCE FOR APPROVAL OF STAKED PLANT LOCATIONS.
5. PLANT PITS MUST BE INSPECTED BY CITY LANDSCAPE INSPECTOR PRIOR TO PLANTING BY CONTRACTOR. CONTRACTOR TO REQUEST INSPECTION 48-HOURS IN ADVANCE.
6. WHERE CALICHE IS ENCOUNTERED IN PLANT PITS, DEPTH AND WIDTH OF PIT SHALL BE INCREASED BY (1/3) ONE-THIRD OVER SPECIFICATION, AND A LIQUID PENETRATE, "AL-KALICHE" OR APPROVED EQUAL, SHALL BE INCORPORATED FOR EACH PIT PER MANUFACTURER'S RECOMMENDATIONS. CONTRACTOR SHALL ALSO COMPLY WITH SOIL TEST RECOMMENDATIONS.
7. ALL TOP SOIL MIXTURE FOR PLANTS SHALL BE FREE OF GRASS AND NOXIOUS WEEDS. SEE SECTION 795 OF THE M.A.G. SPECIFICATIONS.
8. PLANT SOIL MIXTURE SHALL CONSIST OF 3 1/2-PARTS NATURAL FERTILE, FRIABLE SOIL AND ONE PART HUMUS BY VOLUME, THOROUGHLY MIXED PRIOR TO BACKFILLING IN PITS. BACKFILLING SHALL BE IN 6-INCH LIFTS. EACH LIFT SHALL BE WATER SETTLED, WITHOUT PUDDLING.
9. ALL PLANT MATERIAL SHALL CONFORM TO GRADING, TYPE, ETC..., AS SET FORTH IN THE AMERICAN ASSOCIATION OF NURSERYMEN AND BY THE ARIZONA NURSERY ASSOCIATION RECOMMENDED TREE SPECIFICATIONS.
10. THE CITY OF MESA RESERVES THE RIGHT TO INSPECT SHRUBS AND CONTAINER TREES FOR CONDITION OF ROOT BALLS. FOR ANY SUCH INSPECTIONS FOR CONDITIONS WHICH MAY DESTROY ROOT BALL, CONTRACTOR SHALL SUPPLY ADDITIONAL PLANT AT NO COST.
11. 120 VOLT POWER FOR SPRINKLER SYSTEM CONTROLLER IS TO BE ORDERED FROM APPROPRIATE POWER UTILITY BY CONTRACTOR. CONTRACTOR ACTS AS OWNER AND PAYS RELATED COSTS. IF METER IS INSTALLED, METER IS TO BE IN CONTRACTOR'S NAME UNTIL FINAL APPROVAL AND/OR ACCEPTANCE OF THE PROJECT AND THEN TRANSFERRED TO THE MAINTAINING PARTY.
12. THE CONTRACTOR SHALL PROVIDE ALL THE MATERIALS AND LABOR NECESSARY TO INSTALL THE COMPLETE AUTOMATIC SPRINKLER SYSTEM INCLUDING THE WATER SERVICE AND METER. THE CONTRACTOR SHALL ORDER THE WATER METER AND PAY ALL RELATED CHARGES AT THE PUBLIC WORKS SERVICES. THE CITY MAY INSTALL THE WATER SERVICE AND METER AND CHARGE THE CONTRACTOR AT THE CITY'S DISCRETION.
13. THE PLANT GUARANTEE AND MAINTENANCE SHALL BE AS PER SECTION 430.8 OF M.A.G. SPECIFICATIONS UNTIL PROJECT APPROVAL AND/OR ACCEPTANCE.
14. UNLESS SPECIFIED ON THE PLANS FOR REMOVAL, THE CONTRACTOR SHALL BE RESPONSIBLE FOR:
  1. DAMAGES TO EXISTING WALKS, WALLS, DRIVES, CURBS, ETC....
  2. DAMAGES TO UTILITIES CAUSED AS A RESULT OF HIS WORK.
  3. INSPECTING THE SITE IN ORDER TO BE FULLY AWARE OF EXISTING CONDITIONS PRIOR TO SUBMITTING BID.
15. THE CONTRACTOR SHALL MAINTAIN UNCOVERED, ALL EXISTING UTILITY COVERS, BOXES, LIDS, AND MANHOLES.
16. ALL EQUIPMENT AND MATERIALS NOT SHOWN OR SPECIFIED IN THE PLANS OR IN THE SPECIFICATION WHICH ARE REQUIRED TO COMPLETE THE INSTALLATION, SHALL BE SUPPLIED BY THE CONTRACTOR AS PART OF HIS CONTRACT WORK.

**CITY LANDSCAPE NOTES:**

1. REQUIRED TREES SHALL BE MINIMUM SIZE AS SPECIFIED IN THE ARIZONA NURSERY ASSOCIATION "RECOMMENDED TREE SPECIFICATIONS" LATEST EDITION. 11-33-2(B)
2. ALL LANDSCAPE MATERIAL INSTALLED SHALL BE MAINTAINED BY OWNER /OR LESSEE IN ACCORDANCE WITH THE APPROVED LANDSCAPE PLAN. 11-33-2(I)
3. A "NATURAL" LANDSCAPE MAINTENANCE PROGRAM IS TO BE UTILIZED AND THE LANDSCAPE SHALL BE MAINTAINED IN ACCORDANCE WITH THE BEST MANAGEMENT PRACTICE OF THE LANDSCAPING INDUSTRY. 11-33-2(I)4
4. PLANT MATERIAL WITHIN THE SIGHT DISTANCE TRIANGLE SHALL NOT EXCEED 30-INCHES IN HEIGHT AT FULL MATURITY. 1105.4 TREES PLANTED WITHIN THE SIGHT DISTANCE TRIANGLES SHALL BE 24-INCH TO 42-INCH BOX SPECIMENS WITH NO BRANCHES LOWER THAN 8- FEET ABOVE THE SIDEWALK ELEVATION, AND 14- FEET OVER VEHICULAR TRAFFIC WAYS.
5. REQUIRED LANDSCAPE AREAS SHALL BE FREE FROM ENCROACHMENT BY ANY USE, STRUCTURE, VEHICLE OR FEATURE NOT A PART OF THE LANDSCAPING DESIGN. 11-33-2(A)
6. BACKFLOW PREVENTERS 2" OR LARGER SHALL BE SCREENED WITH LANDSCAPE MATERIAL LOCATED WITHIN A 6' RADIUS OF THE BACKFLOW PREVENTERS. ALL BACKFLOW PREVENTERS LESS THAN 2" SHALL BE PLACED IN A WIRE MESH BASKET AND PAINTED GREEN. (THE POLICE DEPARTMENT'S CRIME PREVENTION DIVISION HAS REQUESTED THE CHANGE TO GREEN TO DISCOURAGE THEFT.) [PAGE 20]

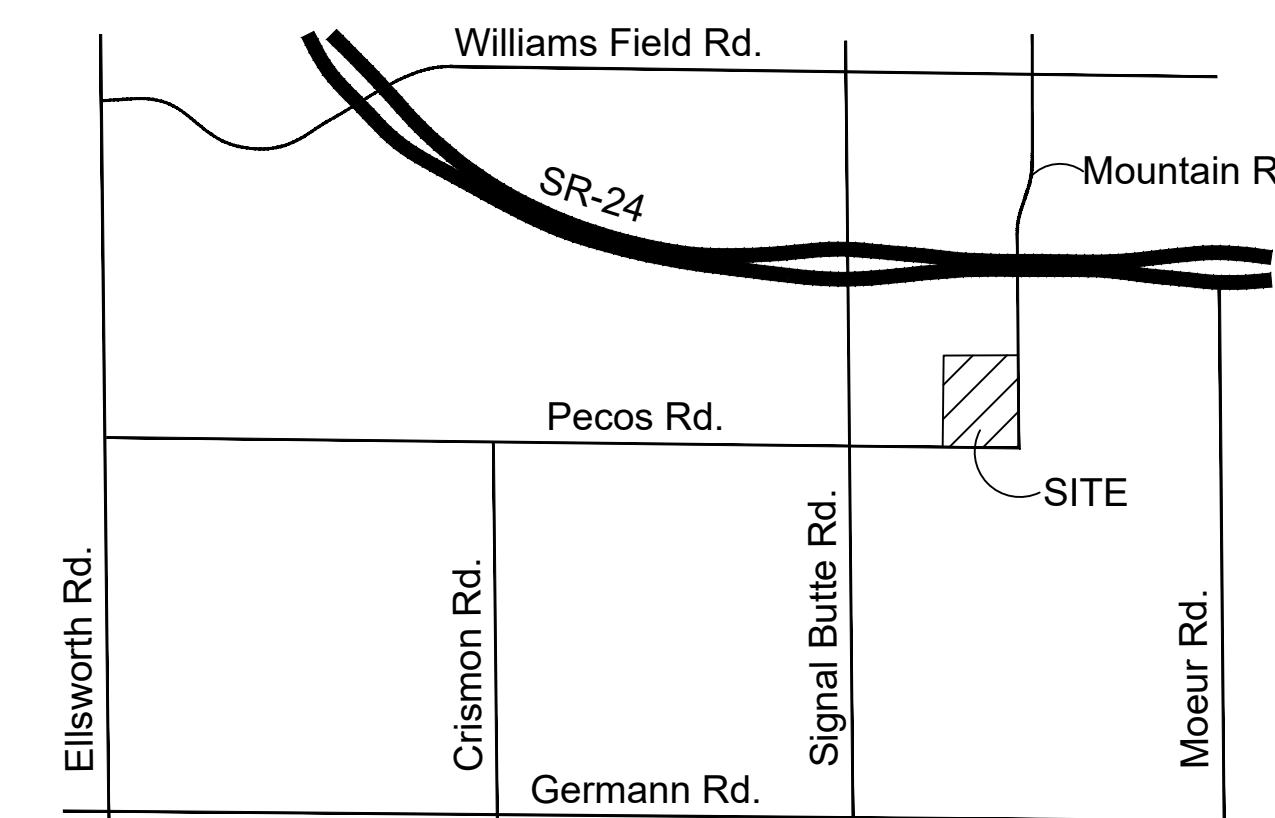

**VICINITY MAP**  
SCALE: N.T.S.

**LANDSCAPE / PLANTING CALCULATIONS:**

	TOTAL TREES	36" TREES	24" BOX	15 GALLON TREES	5 GALLON SHRUBS
MOUNTAIN RD FRONTAGE REQUIREMENTS - 982 L.F.	39 TREES REQUIRED	10 TREES REQUIRED	20 TREES REQUIRED	REMAINDER REQ.	236 SHRUBS REQUIRED
1 TREE/ 6 SHRUB PER 25 L.F.	49 TREES PROVIDED	12 TREES PROVIDED	37 TREES PROVIDED	N / A	239 SHRUBS PROVIDED
PECOS RD FRONTAGE REQUIREMENTS - 985 L.F.	39 TREES REQUIRED	10 TREES REQUIRED	20 TREES REQUIRED	REMAINDER REQ.	236 SHRUBS REQUIRED
1 TREE/ 6 SHRUB PER 25 L.F.	44 TREES PROVIDED	17 TREES PROVIDED	27 TREES PROVIDED	N / A	276 SHRUBS PROVIDED
PARKING LOT REQUIREMENTS	19 TREES REQUIRED	4 TREES REQUIRED	REMAINDER REQ.		57 SHRUBS REQUIRED
1 TREE / 3 SHRUB PER ISLAND	19 TREES PROVIDED	9 TREES PROVIDED	10 TREES PROVIDED	N / A	63 SHRUBS PROVIDED

DOC. REL.#	DATE	DESCRIPTION
8	08/21/2024	PERMIT DOCUMENTS
10	09/23/2024	PERMIT DOCUMENTS
	10/18/2024	PERMIT DOCUMENTS



10 Quality Street  
Lexington, Kentucky 40507-1450  
Telephone: (859) 281-5000  
Facsimile: (859) 252-5300  
Food & Beverage | Manufacturing  
Automotive | Distribution  
Mission Critical | Commercial



GRAY AE, PSC  
10 Quality Street  
Lexington, Kentucky 40507-1450  
Telephone: (859) 281-5000  
Facsimile: (859) 252-5300



4626 N. 44th Street  
PHOENIX, AZ 85018  
602 . 912 . 9691  
602 . 912 . 9693 fax

POLLUTANT FROM OWNER'S OPERATIONS. CUSTOMER'S KNOWLEDGE OF ITS ACTIVITIES SHALL BE CONSIDERED TO BE THE BASIS FOR THE DESIGN OF THIS FACILITY. GRAY AND ITS SUBSIDIARIES SHALL NOT BE RESPONSIBLE FOR POLLUTANTS FROM THE CUSTOMER'S OPERATIONS. GRAY'S KNOWLEDGE, ACCORDINGLY, AND ANYTHING CONTAINED IN THE CONTRACT DOCUMENTS IS TO BE LIMITED TO THE INFORMATION PROVIDED BY THE CUSTOMER. GRAY'S DESIGN SHALL NOT APPLY TO THE DISCHARGE, DISPERSAL, ESCAPE, RELEASE OR SATURATION OF ANY POLLUTANT INTO THE AIR, WATER OR ANY BODY OF WATER OR ON, INTO, UPON, IN OR INTO THE SURFACE OR SUBSURFACE OF LAND. FOR PURPOSE OF THIS SECTION, THE WORD "POLLUTANT" SHALL MEAN AND INCLUDE: LIQUID, GASEOUS, OR THERMAL EFFLUENT OR CONTAMINANT, INCLUDING BUT NOT LIMITED TO: SMOKE, VAPOR, SOOT, FUMES, ACIDS, ALKALIS, CHEMICALS AND WASTE AND SHALL INCLUDE ANY HAZARDOUS SUBSTANCE. THE CAPACITY OF THE FACILITY AND THE DESIGN OF ANY OF ITS PARTS, SO AS TO PREVENT THE ESCAPE, RELEASE, DISCHARGE, DISPERSAL OR SATURATION OF POLLUTANTS SHALL BE THE SOLE RESPONSIBILITY OF THE CUSTOMER.

NOTICE: UNLESS OTHERWISE AGREED IN WRITING, GRAY IS THE SOLE OWNER OF ALL PROPRIETARY RIGHTS, INCLUDING COPYRIGHTS AND ANY TRADE SECRETS IN THE MATTER CONTAINED HEREIN. ANY DISCLOSURE, REPRODUCTION OR REVISION OF THIS DOCUMENT OR ANY PORTION THEREOF IS SPECIFICALLY PROHIBITED UNLESS PREVIOUSLY APPROVED IN WRITING BY GRAY.

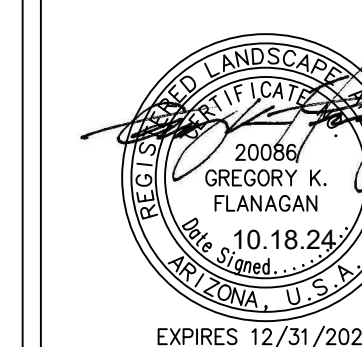

CORP. SEAL

**A NEW MANUFACTURING FACILITY EXPANSION FOR MPCA - AZ4**  
6560 S. Mountain Rd., Mesa, AZ 85212

**LANDSCAPE COVER**

JOB NUMBER: 2024045  
SHEET NUMBER: L-100

FINAL: FOR DESIGN REVIEW  
BOARD APPROVAL 11/12/2024



DOC. REL. #	DATE	DESCRIPTION
8	08/21/2024	PERMIT DOCUMENTS
10	09/23/2024	PERMIT DOCUMENTS
10	10/18/2024	PERMIT DOCUMENTS



10 Quality Street  
Lexington, Kentucky 40507-1450  
Telephone: (859) 281-5000  
Facsimile: (859) 252-5300

Food & Beverage | Manufacturing  
Automotive | Distribution  
Mission Critical | Commercial



GRAY AE, PSC  
10 Quality Street  
Lexington, Kentucky 40507-1450  
Telephone: (859) 281-5000  
Facsimile: (859) 252-5300



G.K. FLANAGAN  
ASSOCIATES

4626 N. 44th Street  
PHOENIX, AZ 85018  
602 . 912 . 9691  
602 . 912 . 9693 fax

POLLUTANTS FROM OWNER'S OPERATIONS... CUSTOMER'S KNOWLEDGE OF ITS ACTIVITIES THAT WILL BE CONDUCTED WITHIN THE FACILITY TO BE DESIGNED BY GRAY AND CONSTRUCTED BY GRAY AND THE MATERIALS INVOLVED IN THESE ACTIVITIES IS SUPERIOR TO GRAY'S KNOWLEDGE. ACCORDINGLY, ANYTHING CONTAINED IN THE CONTRACT DOCUMENTS TO THE CONTRACT NOTWITHSTANDING, AND ONLY OR WARRANTY BY GRAY HEREIN SHALL NOT APPLY TO THE DISCHARGE, DISPERSAL, ESCAPE, RELEASE OR SATURATION OF ANY POLLUTANT INTO THE ATMOSPHERE OR ANY BODY OF WATER OR ON, ONTO, UPON, IN OR INTO THE SURFACE OR SUBSURFACE OF LAND. FOR PURPOSE OF THIS SECTION, THE WORD "POLLUTANT" SHALL MEAN ANY SOLID, LIQUID, GASEOUS OR THERMAL IRRITANT OR CONTAMINANT, INCLUDING BUT NOT LIMITED TO SMOKE, VAPOR, SCOT, FUMES, ACIDS, ALKALIS, CHEMICALS AND WASTE AND SHALL INCLUDE ANY HAZARDOUS SUBSTANCE. THE CAPACITY OF THE FACILITY AND THE DESIGN OF ANY OF ITS PARTS, SO AS TO PREVENT THE ESCAPE, RELEASE, DISCHARGE, DISPERSAL OR SATURATION OF POLLUTANTS SHALL BE THE SOLE RESPONSIBILITY OF THE CUSTOMER.

NOTE: UNLESS OTHERWISE AGREED IN WRITING, GRAY IS THE SOLE OWNER OF ALL PROPRIETARY RIGHTS, INCLUDING COPYRIGHTS AND ANY TRADE SECRETS IN THE MATTER CONTAINED HEREIN. ANY DISCLOSURE, REPRODUCTION OR REVISION OF THIS DOCUMENT OR ANY PORTION THEREOF IS SPECIFICALLY PROHIBITED UNLESS PREVIOUSLY APPROVED IN WRITING BY GRAY.

CORP. SEAL

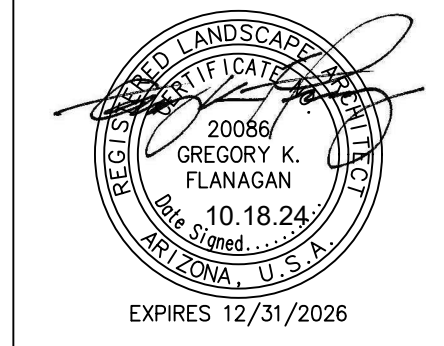

A NEW MANUFACTURING FACILITY EXPANSION FOR  
**MPCA - AZ4**  
6560 S. Mountain Rd., Mesa, AZ 85212

**PLANTING PLAN**

JOB NUMBER	SHEET NUMBER
2024045	L-101

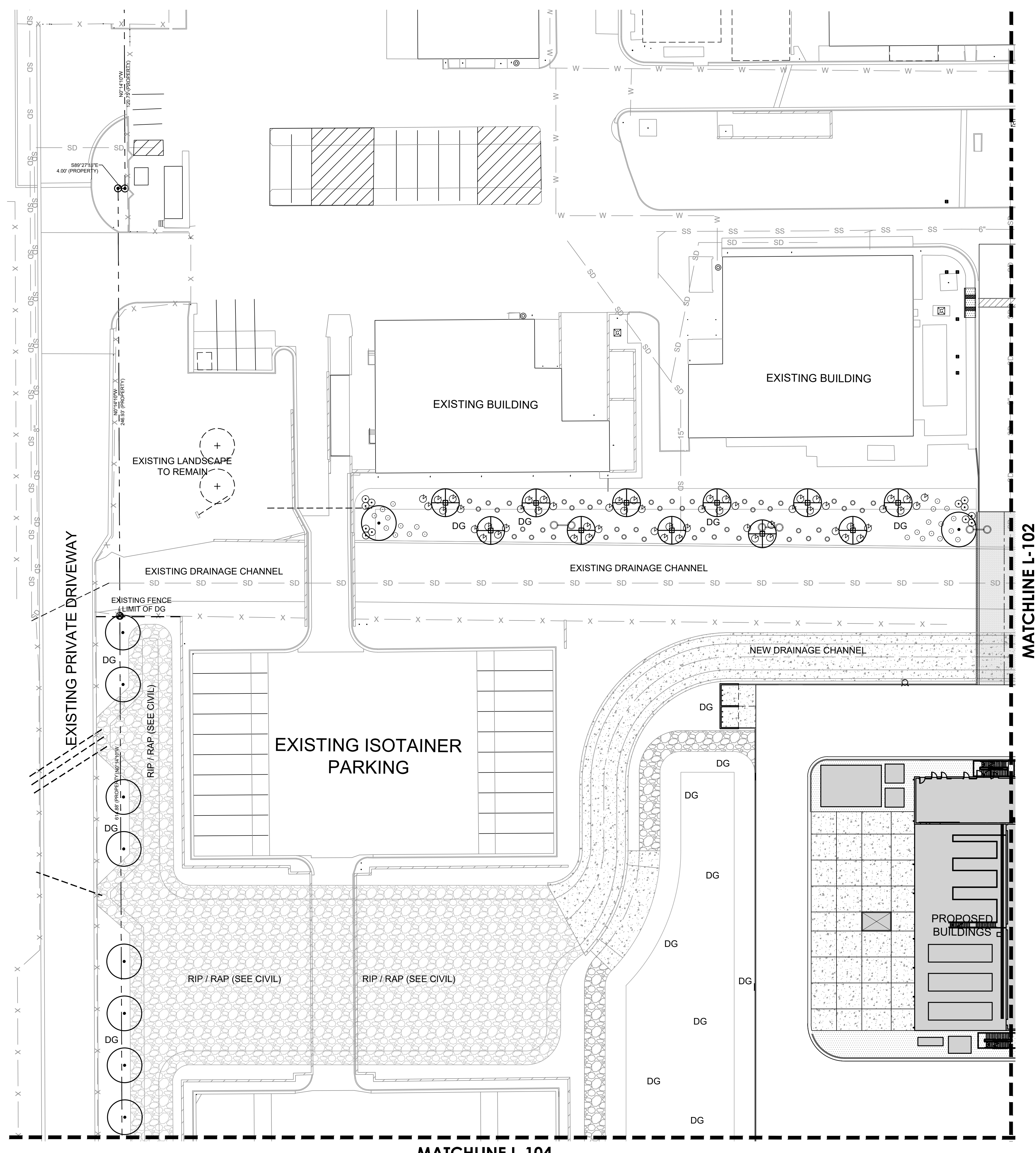

**PROPOSED PLANT PALETTE**

TREES	SIZE/COMMENTS
EXISTING TREE (TO REMAIN)	N/A
CERCIDIUM FLORIDUM BLUE PALO VERDE	36" BOX / LOW BREAKING MATCHED / 15 QTY
PROSOPIS VELUTINA NATIVE MESQUITE	36" BOX / LOW BREAKING MATCHED / 29 QTY
PROSOPIS 'COOPERI' HYBRID MESQUITE	24" BOX / LOW BREAKING MATCHED / 27 QTY
CHILOPSIS LINEARIS DESERT WILLOW	24" BOX / LOW BREAKING MATCHED / 43 QTY
CERCIDIUM MACROPHYLLA FOOTHILL PALO VERDE	24" BOX / LOW BREAKING MATCHED / 46 QTY
SHRUBS	SIZE/COMMENTS
OPUNTIA ENGELMANNII PRICKLY PEAR	10 PAD MINIMUM / 8 QTY
HESPERALOE PARVIFLORA RED YUCCA	5 GAL / 112 QTY
JUSTICIA CALIFORNICA CHUPAROSA	5 GAL / 298 QTY
RUPELLIA PENINSULARIS BAJA RUPELLIA	5 GAL / 116 QTY
SIMMONDSIA CHINENSIS JOJOBA	5 GAL / 139 QTY
DODONAEA VISCOSA HOPBUSH	5 GAL / 123 QTY
GROUNDCOVER	SIZE/COMMENTS
E. FARINOSA / A. DELTOIDEA BRITTLEBUSH / BURSAGE	50 / 50 MIX 1 GAL EA. / 438 QTY
ERICAMERIA LARICIFOLIA TURPENTINE BUSH	1 GAL EA. / 395 QTY
DECOMPOSED GRANITE ROCK PROS - DATE CREEK GOLD	2" THICK TYP. 1/2" MINUS

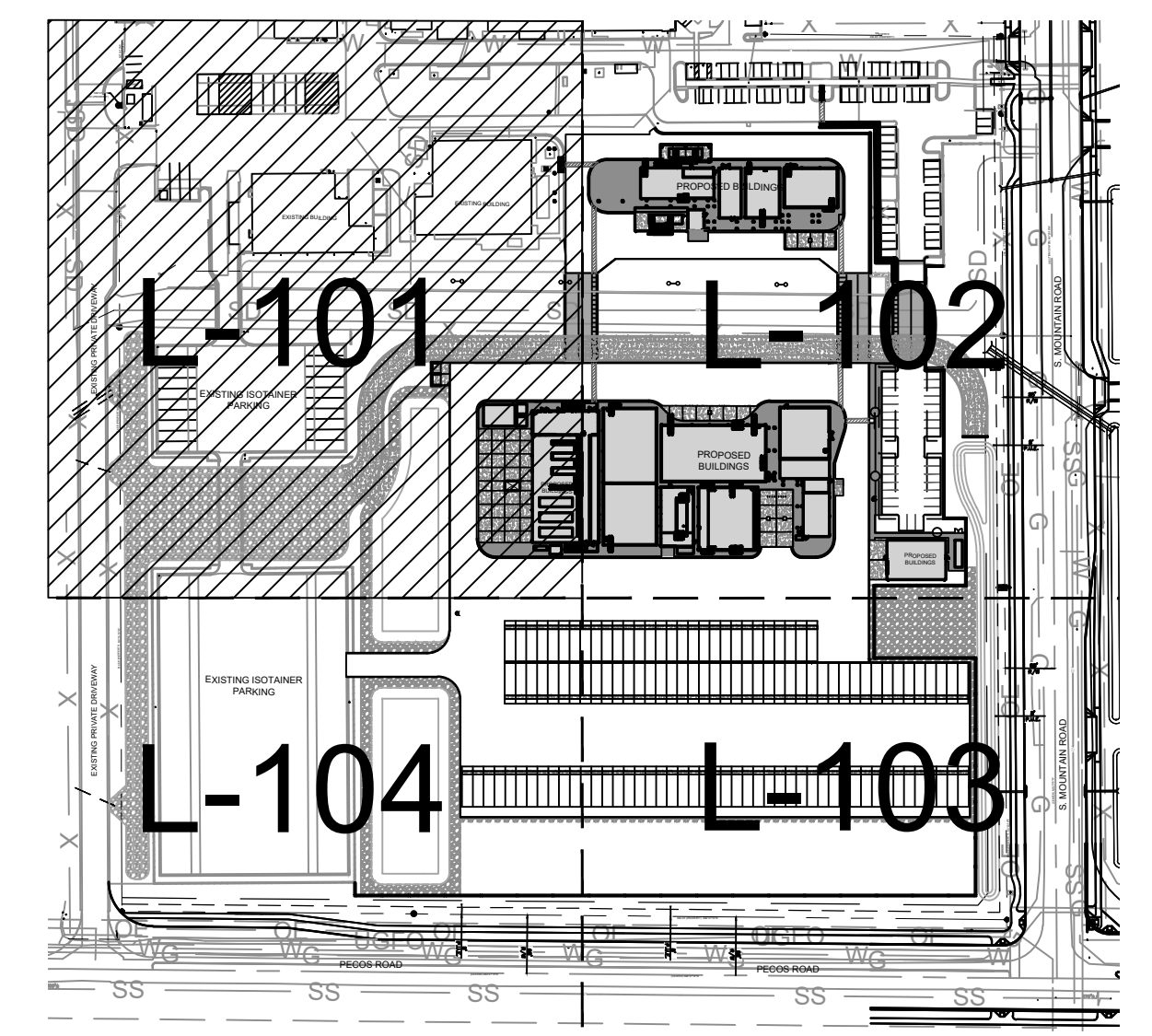

SHEET INDEX - KEY MAP  
N.T.S. Ref. North

CONCEPTUAL PLANTING PLAN  
SCALE: 1"=30'-0"  
0 15' 30' 60' Ref. North

Contact Arizona 811 at least two full working days before you begin excavation



Call 811 or click Arizona811.com

FINAL: FOR DESIGN REVIEW  
BOARD APPROVAL 11/12/2024

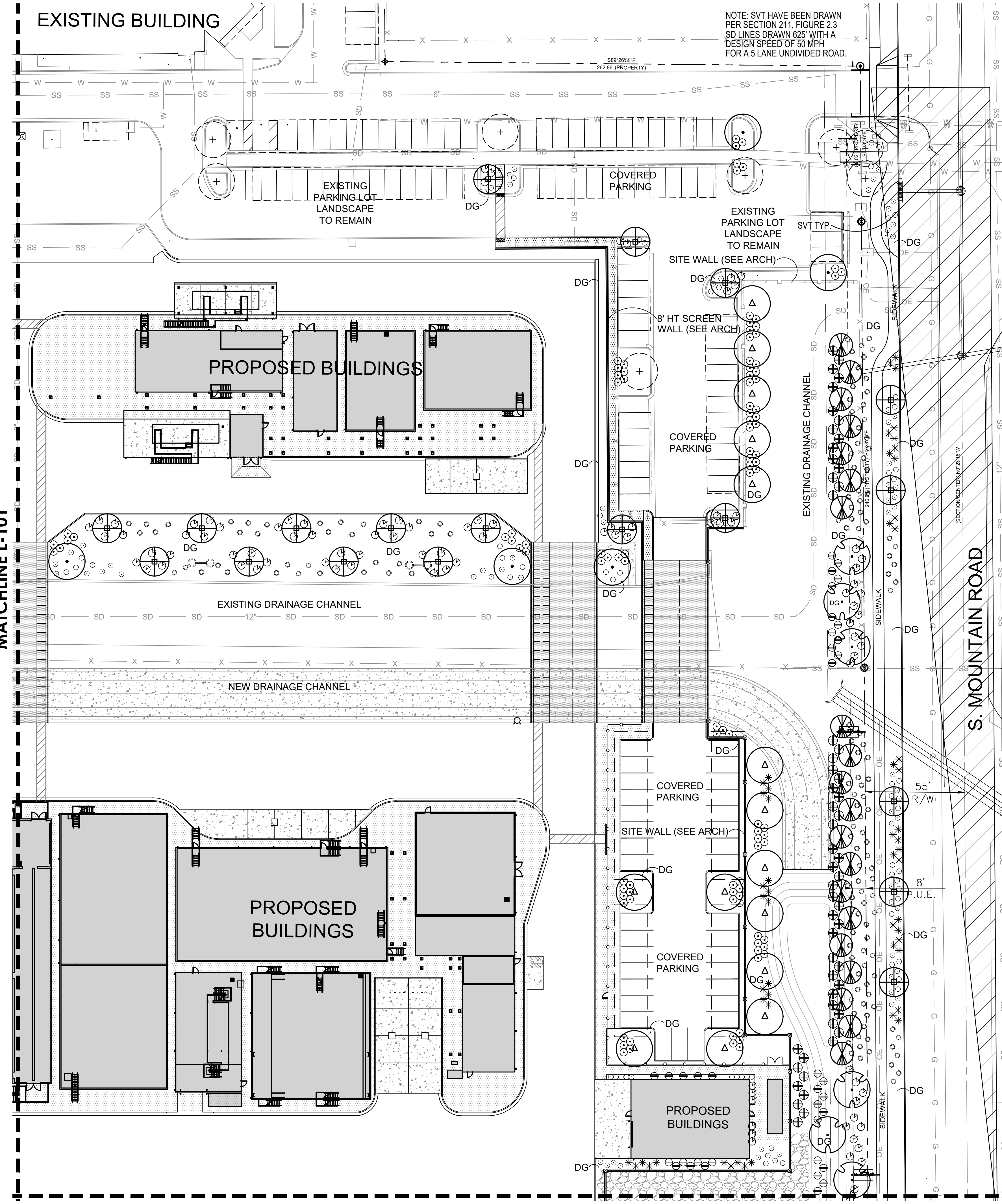

**PROPOSED PLANT PALETTE**

TREES	SIZE/COMMENTS
EXISTING TREE (TO REMAIN)	N/A
CERCIDIUM FLORIDUM BLUE PALO VERDE	36" BOX / LOW BREAKING MATCHED / 15 QTY
PROSOPIS VELUTINA NATIVE MESQUITE	36" BOX / LOW BREAKING MATCHED / 29 QTY
PROSOPIS 'COOPER' HYBRID MESQUITE	24" BOX / LOW BREAKING MATCHED / 27 QTY
CHILOPSIS LINEARIS DESERT WILLOW	24" BOX / LOW BREAKING MATCHED / 43 QTY
CERCIDIUM MACROPHYLLA FOOTHILL PALO VERDE	24" BOX / LOW BREAKING MATCHED / 46 QTY
SHRUBS	SIZE/COMMENTS
OPUNTIA ENGELMANII PRICKLY PEAR	10 PAD MINIMUM / 8 QTY
HESPERALOE PARVIFLORA RED YUCCA	5 GAL / 112 QTY
JUSTICIA CALIFORNICA CHUPAROSA	5 GAL / 298 QTY
RUPELLIA PENINSULARIS BAJA RUELLIA	5 GAL / 116 QTY
SIMMONDSIA CHINENSIS JOJOBA	5 GAL / 139 QTY
DODONAEA VISCOSA HOPBUSH	5 GAL / 123 QTY
GROUNDCOVER	SIZE/COMMENTS
E. FARINOSA / A. DELTOIDEA BRITTLEBUSH / BURSAGE	50 / 50 MIX 1 GAL EA. / 438 QTY
ERICAMERIA LARICIFOLIA TURPENTINE BUSH	1 GAL EA. / 395 QTY
DECOMPOSED GRANITE ROCK PROS - DATE CREEK GOLD	2" THICK TYP. 1/2" MINUS

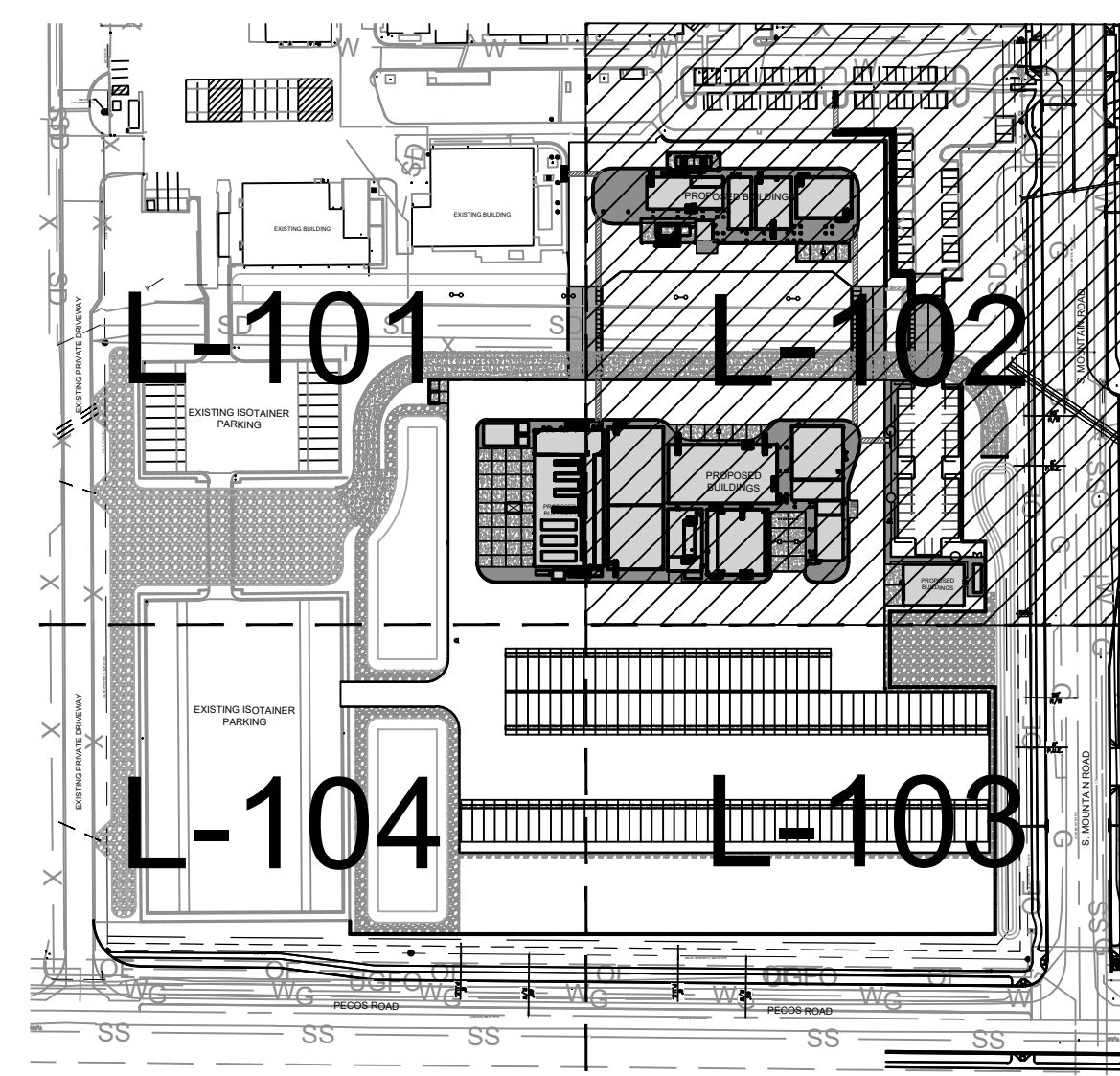

DOC. REL.#	DATE	DESCRIPTION
8	08/21/2024	PERMIT DOCUMENTS
10	09/23/2024	PERMIT DOCUMENTS
	10/18/2024	PERMIT DOCUMENTS

**Gray**

10 Quality Street  
Lexington, Kentucky 40507-1450  
Telephone: (859) 281-6000  
Facsimile: (859) 252-5300

Food & Beverage | Manufacturing  
Automotive | Distribution  
Mission Critical | Commercial

**Gray**

GRAY AE, PSC  
10 Quality Street  
Lexington, Kentucky 40507-1450  
Telephone: (859) 281-6000  
Facsimile: (859) 252-5300

**G.K. FLANAGAN ASSOCIATES**

4626 N. 44th Street  
PHOENIX, AZ 85018  
602 . 912 . 9691  
602 . 912 . 9693 fax

POLLUTANTS FROM OWNER'S OPERATIONS... CUSTOMER'S KNOWLEDGE OF ITS ACTIVITIES THAT WILL BE CONDUCTED WITHIN THE FACILITY TO BE DESIGNED BY GRAY AND CONSTRUCTED BY GRAY... THE MATERIALS INVOLVED IN THOSE ACTIVITIES IS SUPERIOR TO GRAY'S KNOWLEDGE... ACCORDINGLY, AND ANYTHING CONTAINED IN THE CONTRACT DOCUMENTS TO THE CONTRARY NOTWITHSTANDING, ANY DUTY OR WARRANTY BY GRAY HEREIN SHALL NOT APPLY TO THE DISCHARGE, DISPOSAL, ESCAPE, RELEASE OR CONTAMINATION OF ANY POLLUTANT INTO THE ATMOSPHERE OR ANY BODY OF WATER OR ON, INTO, UPON, IN OR INTO THE SURFACE OR SUBSURFACE OF LAND... FOR PURPOSE OF THIS SECTION, THE WORD "POLLUTANT" SHALL MEAN ANY SOLID, LIQUID, GASEOUS, OR THERMAL, IRRITANT OR CONTAMINANT, INCLUDING BUT NOT LIMITED TO SMOKE, VAPOR, SOOT, FUMES, ACIDS, ALKALIS, CHEMICALS AND WASTE AND SHALL INCLUDE ANY HAZARDOUS SUBSTANCE... THE CAPACITY OF THE FACILITY AND THE DESIGN OF ANY OF ITS PARTS, SO AS TO PREVENT THE ESCAPE, RELEASE, DISCHARGE, DISPOSAL, OR SATURATION OF POLLUTANTS SHALL BE THE SOLE RESPONSIBILITY OF THE CUSTOMER.

NOTICE: UNLESS OTHERWISE AGREED IN WRITING, GRAY IS THE SOLE OWNER OF ALL PROPRIETARY RIGHTS, INCLUDING COPYRIGHTS AND ANY TRADE SECRETS IN THE MATTER CONTAINED HEREIN. ANY DISCLOSURE, REPRODUCTION OR REVISION OF THIS DOCUMENT OR ANY PORTION THEREOF IS SPECIFICALLY PROHIBITED UNLESS PREVIOUSLY APPROVED IN WRITING BY GRAY.

CORP. SEAL

**A NEW MANUFACTURING FACILITY EXPANSION FOR MPCA - AZ4**

6560 S. Mountain Rd., Mesa, AZ 85212

**PLANTING PLAN**

JOB NUMBER	SHEET NUMBER
2024045	L-102

Contact Arizona 811 at least two full working days before you begin excavation

Call 811 or click Arizona811.com

FINAL: FOR DESIGN REVIEW  
BOARD APPROVAL 11/12/2024

DOC. REL.#	DATE	DESCRIPTION
8	08/21/2024	PERMIT DOCUMENTS
10	09/23/2024	PERMIT DOCUMENTS
10	10/18/2024	PERMIT DOCUMENTS

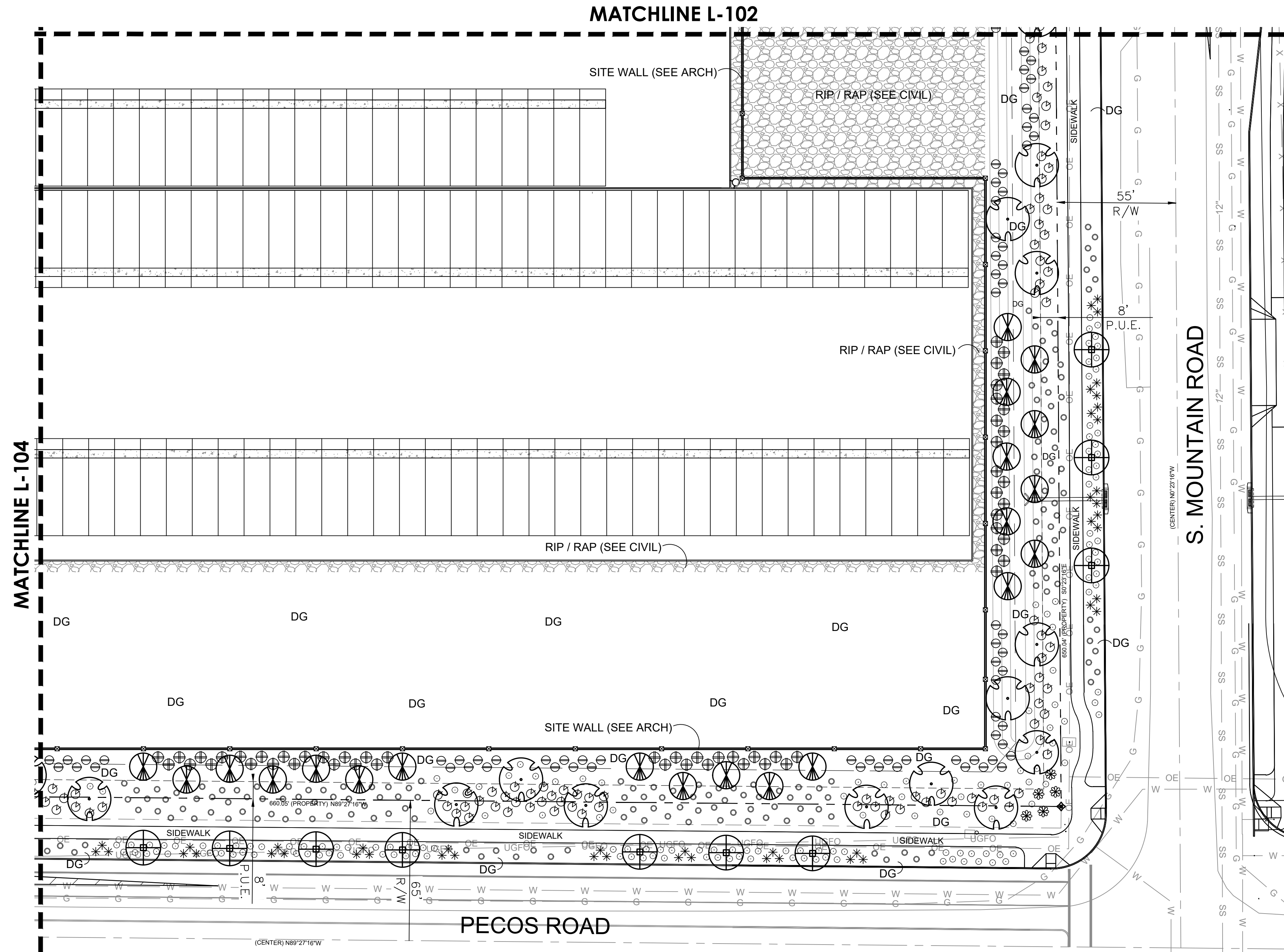

### PROPOSED PLANT PALETTE

TREES	SIZE/COMMENTS
EXISTING TREE (TO REMAIN)	N/A
ERCIDIUM FLORIDUM BLUE PALO VERDE	36" BOX / LOW BREAKING MATCHED / 15 QTY
PROSOPIS VELUTINA NATIVE MESQUITE	36" BOX / LOW BREAKING MATCHED / 29 QTY
PROSOPIS 'COOPERI' HYBRID MESQUITE	24" BOX / LOW BREAKING MATCHED / 27 QTY
CHILOPSIS LINEARIS DESERT WILLOW	24" BOX / LOW BREAKING MATCHED / 43 QTY
ERCIDIUM MACROPHYLLA FOOTHILL PALO VERDE	24" BOX / LOW BREAKING MATCHED / 46 QTY
SHRUBS	SIZE/COMMENTS
OPUNTIA ENGELMANII PRICKLY PEAR	10 PAD MINIMUM / 8 QTY
HESPERALOE PARVIFLORA RED YUCCA	5 GAL / 112 QTY
JUSTICIA CALIFORNICA CHUPAROSA	5 GAL / 298 QTY
RUPELLIA PENINSULARIS BAJA RUPELLIA	5 GAL / 116 QTY
SIMMONDSIA CHINENSIS JOJABA	5 GAL / 139 QTY
DODONAEA VISCOSA HOPBUSH	5 GAL / 123 QTY
GROUNDCOVER	SIZE/COMMENTS
E. FARINOSA / A. DELTOIDEA BRITTLEBUSH / BURSAGE	50 / 50 MIX 1 GAL EA. / 438 QTY
ERICAMERIA LARICIFOLIA TURPENTINE BUSH	1 GAL EA. / 395 QTY
DECOMPOSED GRANITE ROCK PROS - DATE CREEK GOLD	2" THICK TYP. 1/2" MINUS

CONCEPTUAL PLANTING PLAN  
SCALE 1"=30'-0"  
Ref. North

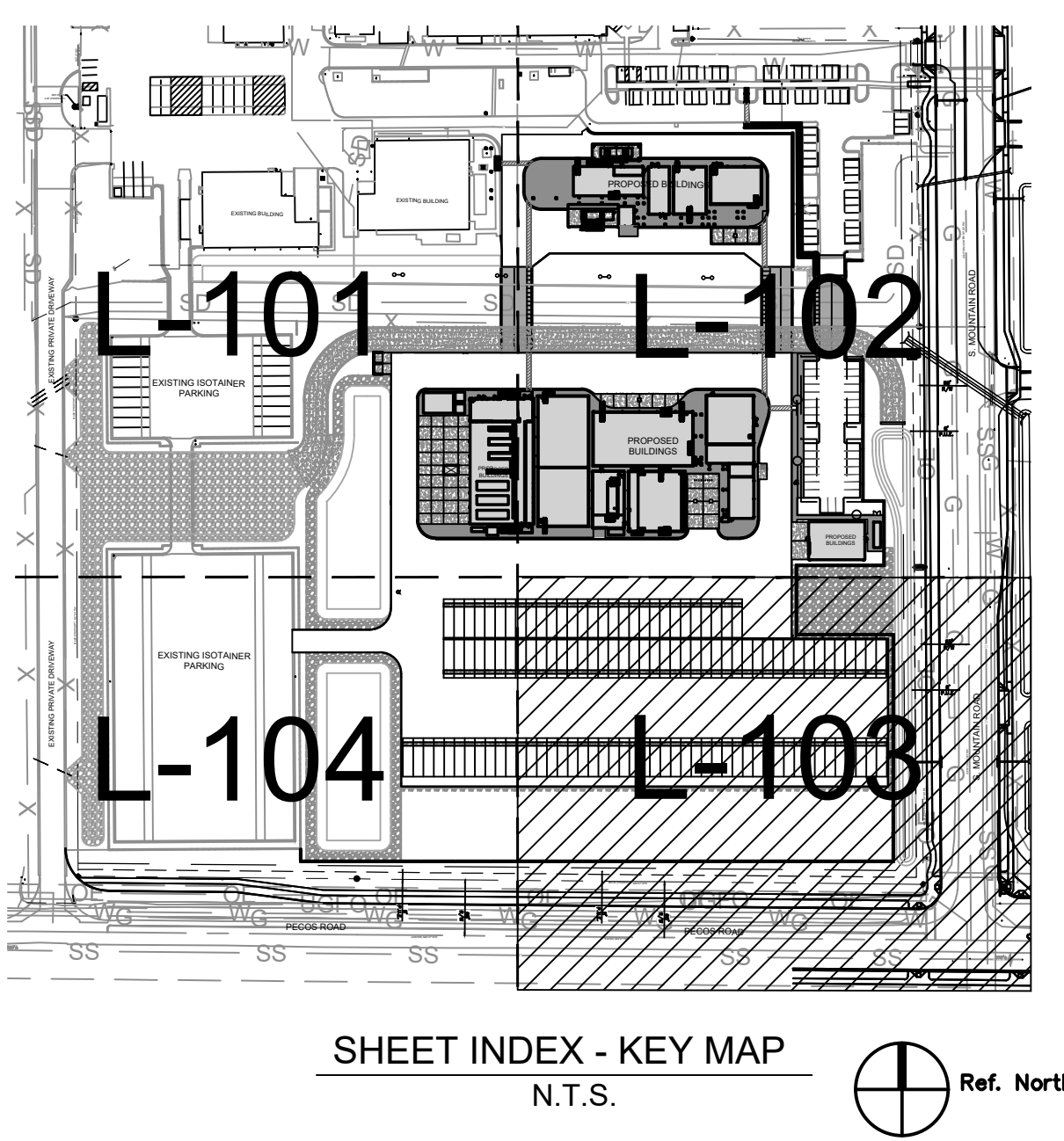

10 Quality Street  
Lexington, Kentucky 40507-1450  
Telephone: (859) 281-5000  
Facsimile: (859) 252-5300  
Food & Beverage | Manufacturing  
Automotive | Distribution  
Mission Critical | Commercial

GRAY AE, PSC  
10 Quality Street  
Lexington, Kentucky 40507-1450  
Telephone: (859) 281-5000  
Facsimile: (859) 252-5300

4626 N. 44th Street  
PHOENIX, AZ 85018  
602 . 912 . 9691  
602 . 912 . 9693 fax

POLLUTANTS FROM OWNER'S OPERATIONS... CUSTOMER'S KNOWLEDGE OF ITS ACTIVITIES THAT WILL BE CONDUCTED WITHIN THE FACILITY TO BE DESIGNED BY GRAY AND CONTRACTED BY GRAY AND THE MATERIALS INVOLVED IN THOSE ACTIVITIES IS SUPERIOR TO GRAY'S KNOWLEDGE, ACCORDINGLY, AND ANYTHING CONTAINED IN THE CONTRACT DOCUMENTS IS BY THE CONTRACTOR WITH THE EXCEPT OF MATERIALS TO BE USED HEREIN SHALL NOT APPLY TO THE DISCHARGE, DISPERSAL, ESCAPE, RELEASE OR SITUATION OF ANY POLLUTANT INTO THE ATMOSPHERE OR ANY BODY OF WATER OR ON, INTO, UPON, IN OR INTO THE SURFACE OR SUBSURFACE OF LAND, FOR PURPOSE OF THIS SECTION THE WORD "POLLUTANT" SHALL MEAN ANY SOLID, LIQUID, GASEOUS OR THERMAL IRRITANT OR CONTAMINANT, INCLUDING BUT NOT LIMITED TO SMOKE, VAPOR, SOOT, FUMES, ACIDS, ALKALIS, CHEMICALS AND WASTE AND SHALL INCLUDE ANY HAZARDOUS SUBSTANCE THE CAPACITY OF THE FACILITY AND THE DESIGN OF ANY OF ITS PARTS, SO AS TO PREVENT THE ESCAPE, RELEASE, DISCHARGE, DISPERSAL OR SITUATION OF POLLUTANTS SHALL BE THE SOLE RESPONSIBILITY OF THE CUSTOMER.

NOTICE: UNLESS OTHERWISE AGREED IN WRITING, GRAY IS THE SOLE OWNER OF ALL PROPRIETARY RIGHTS, INCLUDING COPYRIGHTS AND ANY TRADE SECRETS IN THE MATTER CONTAINED HEREIN. ANY DISCLOSURE, REPRODUCTION OR REVISION OF THE DOCUMENT OR ANY PORTION THEREOF IS SPECIFICALLY PROHIBITED UNLESS PREVIOUSLY APPROVED IN WRITING BY GRAY.

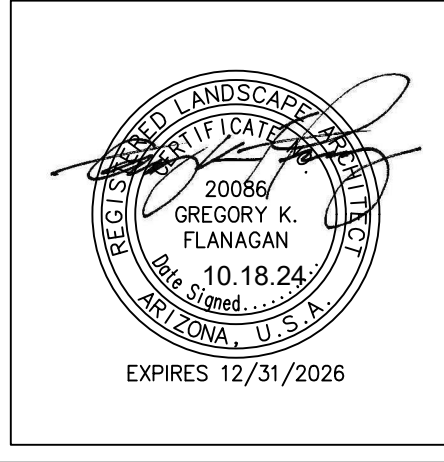

A NEW MANUFACTURING FACILITY  
EXPANSION FOR  
**MPCA - AZ4**  
6560 S. Mountain Rd., Mesa, AZ 85212

PLANTING PLAN

JOB NUMBER	SHEET NUMBER
2024045	L-103

FINAL: FOR DESIGN REVIEW  
BOARD APPROVAL 11/12/2024

Contact Arizona 811 at least two full working days before you begin excavation

Call 811 or click Arizona811.com

DOC. REL.#	DATE	DESCRIPTION
8	08/21/2024	PERMIT DOCUMENTS
10	09/23/2024	PERMIT DOCUMENTS
	10/18/2024	PERMIT DOCUMENTS

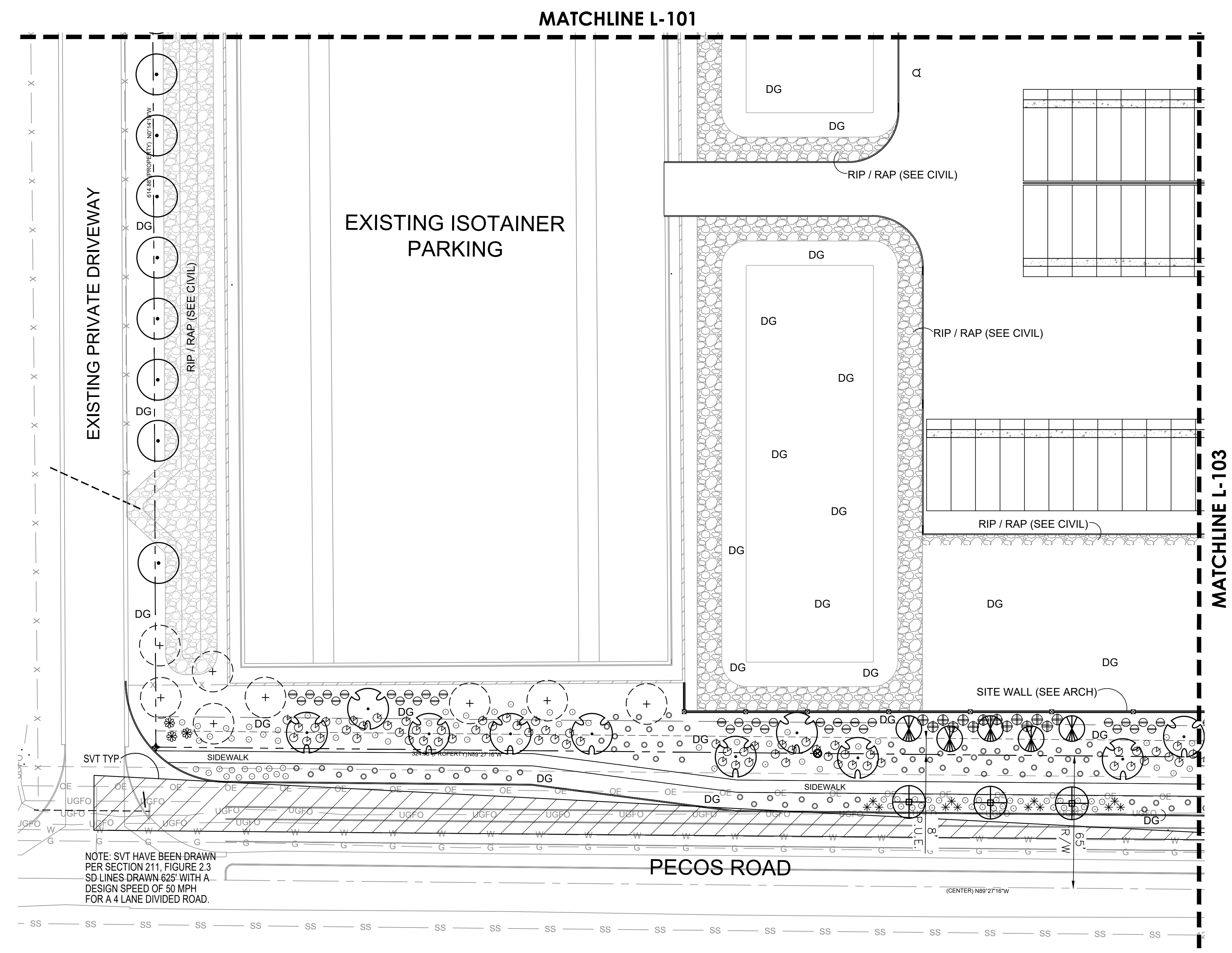

PROPOSED PLANT PALETTE

TREES	SIZE/COMMENTS
EXISTING TREE (TO REMAIN)	N/A
CERCIDIUM FLORIDUM BLUE PALO VERDE	36" BOX / LOW BREAKING MATCHED / 15 QTY
PROSOPIS VELUTINA NATIVE MESQUITE	36" BOX / LOW BREAKING MATCHED / 29 QTY
PROSOPIS 'COOPERI' HYBRID MESQUITE	24" BOX / LOW BREAKING MATCHED / 27 QTY
CHILOPSIS LINEARIS DESERT WILLOW	24" BOX / LOW BREAKING MATCHED / 43 QTY
CERCIDIUM MACROPHYLLA FOOTHILL PALO VERDE	24" BOX / LOW BREAKING MATCHED / 46 QTY
SHRUBS	SIZE/COMMENTS
OPUNTIA ENGELMANII PRICKLY PEAR	10 PAD MINIMUM / 8 QTY
HESPERALOE PARVIFLORA RED YUCCA	5 GAL / 112 QTY
JUSTICIA CALIFORNICA CHUPAROSA	5 GAL / 298 QTY
RUELLIA PENINSULARIS BAJA RUELLIA	5 GAL / 116 QTY
SIMMONDSIA CHINENSIS JOJOBA	5 GAL / 139 QTY
DODONAEA VISCOSA HOPBUSH	5 GAL / 123 QTY
GROUND COVER	SIZE/COMMENTS
E. FARINOSA / A. DELTOIDEA BRITTLEBUSH / BURSAGE	50 / 50 MIX 1 GAL EA. / 438 QTY
ERICAMERIA LARICIFOLIA TURPENTINE BUSH	1 GAL EA. / 395 QTY
DG DECOMPOSED GRANITE ROCK PROS - DATE CREEK GOLD	2" THICK TYP. 1/2" MINUS

CONCEPTUAL PLANTING PLAN  
SCALE 1"=30'-0"  
0 15' 30' 60' Ref. North

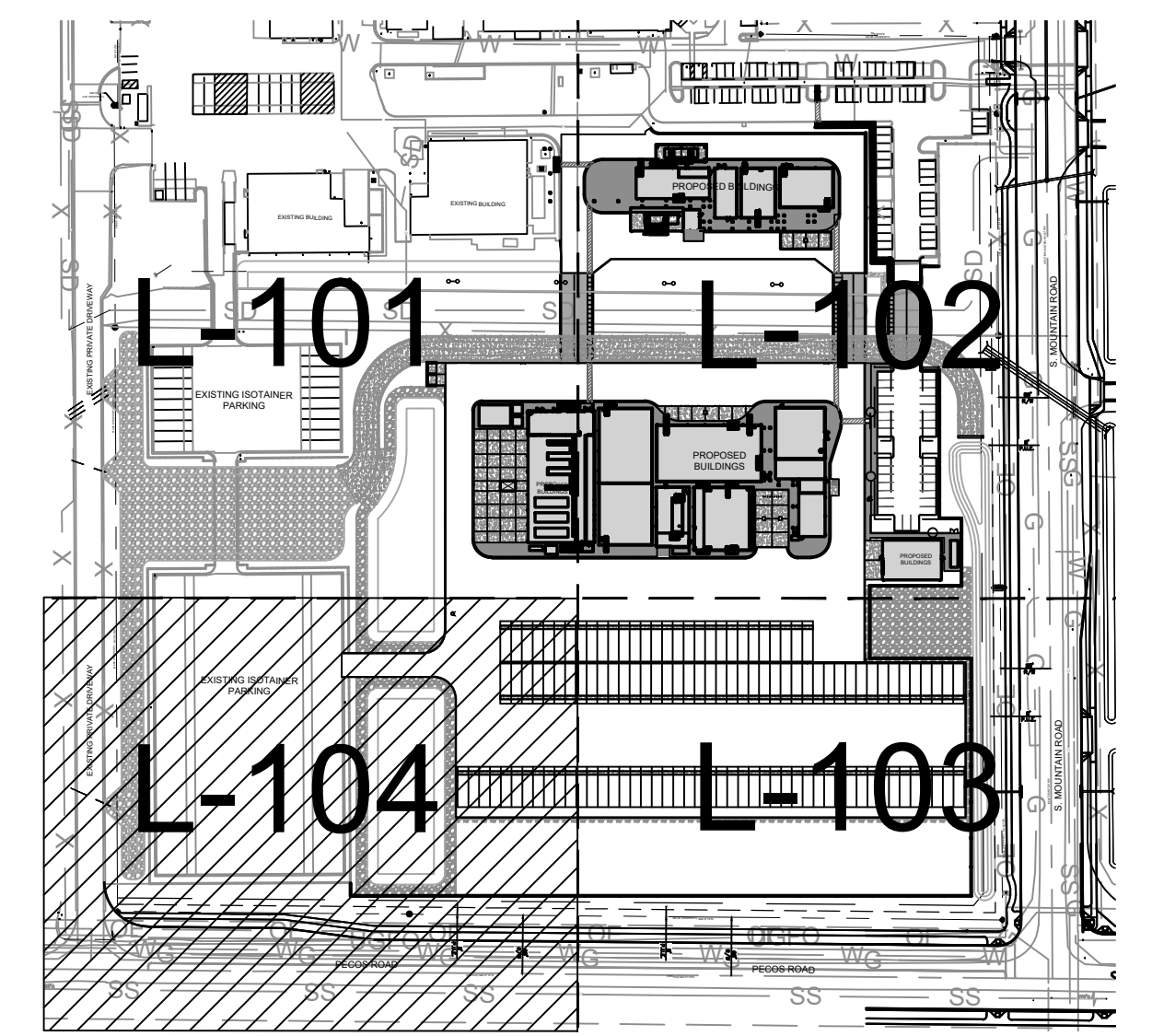

SHEET INDEX - KEY MAP  
N.T.S. Ref. North

Contact Arizona 811 at least two full working days before you begin excavation  
ARIZONA 811  
Call 811 or click Arizona811.com

**Gray**  
10 Quality Street  
Lexington, Kentucky 40507-1450  
Telephone: (859) 281-5000  
Facsimile: (859) 252-5300  
Food & Beverage | Manufacturing  
Automotive | Distribution  
Mission Critical | Commercial

**Gray**  
GRAY AE, PSC  
10 Quality Street  
Lexington, Kentucky 40507-1450  
Telephone: (859) 281-5000  
Facsimile: (859) 252-5300

**G.K. FLANAGAN ASSOCIATES**  
4626 N. 44th Street  
PHOENIX, AZ 85018  
602 . 912 . 9691  
602 . 912 . 9693 fax

POLLUTANTS FROM OWNER'S OPERATIONS. CUSTOMER'S KNOWLEDGE OF ITS ACTIVITIES THAT MAY BE CONDUCTED WITHIN THE FACILITY TO BE DESIGNED BY GRAY AND CONTRACTED BY GRAY AND THE MATERIALS INVOLVED IN THESE ACTIVITIES IS SUPERIOR TO GRAY'S KNOWLEDGE. ACCORDINGLY, ANYTHING CONTAINED IN THE CONTRACT DOCUMENTS TO THE CONTRACT NOTWITHSTANDING, ANY CITY OR WARRANTY BY GRAY HEREIN SHALL NOT APPLY TO THE DISCHARGE, DISPERSAL, ESCAPE, RELEASE OR SATURATION OF ANY POLLUTANT INTO THE AIRWATER OR ANY BODY OF WATER OR ON, INTO, UPON, IN OR INTO THE SURFACE OR SUBSURFACE OF LAND. FOR PURPOSE OF THIS SECTION, THE WORD "POLLUTANT" SHALL MEAN ANY SOLID, LIQUID, GAS, OR OTHER IRRITANT OR CONTAMINANT INCLUDING BUT NOT LIMITED TO SMOKE, VAPOR, SPOUT, FUMES, ACIDS, ALKALIS, CHEMICALS AND WASTE AND SHALL INCLUDE ANY HAZARDOUS SUBSTANCE. THE CAPACITY OF THE FACILITY AND THE DESIGN OF ANY OF ITS PARTS, SO AS TO PREVENT THE ESCAPE, RELEASE, DISCHARGE, DISPERSAL OR SATURATION OF POLLUTANTS SHALL BE THE SOLE RESPONSIBILITY OF THE CUSTOMER.

NOTE: UNLESS OTHERWISE AGREED IN WRITING, GRAY IS THE SOLE OWNER OF ALL PROPRIETARY RIGHTS, INCLUDING COPYRIGHTS AND ANY TRADE SECRETS IN THE MATTER CONTAINED HEREIN. ANY DISCLOSURE, REPRODUCTION OR DIVULSION OF THIS DOCUMENT OR ANY PORTION THEREOF IS SPECIFICALLY PROHIBITED UNLESS PREVIOUSLY APPROVED IN WRITING BY GRAY.

CORP. SEAL  
GREGORY K. FLANAGAN  
Professional Engineer  
No. 10,1824  
State of Arizona  
EXPIRES 12/31/2026

A NEW MANUFACTURING FACILITY EXPANSION FOR  
**MPCA - AZ4**  
6560 S. Mountain Rd., Mesa, AZ 85212

PLANTING PLAN

JOB NUMBER 2024045	SHEET NUMBER <b>L-104</b>
-----------------------	------------------------------

FINAL: FOR DESIGN REVIEW  
BOARD APPROVAL 11/12/2024