

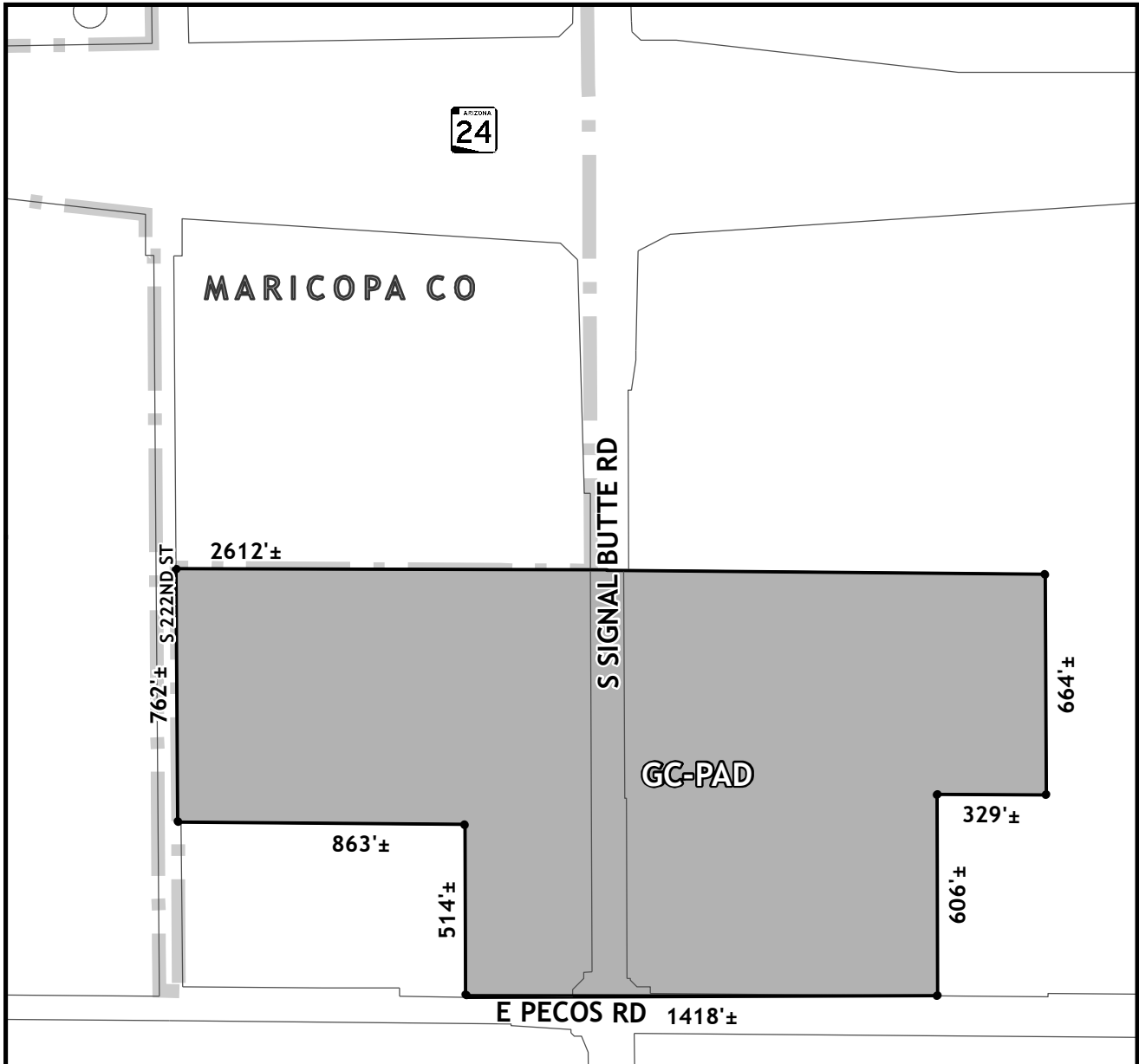

OFFICIAL SUPPLEMENTARY ZONING MAP AMENDING THE CITY OF MESA ZONING MAP



CASE: ZON22-00435
 ACREAGE: 62±
 REQUEST: Rezone from Agricultural (AG), Light Industrial (LI), and General Industrial (GI) to General Commercial with a Planned Area Development overlay (GC-PAD).
 ORDINANCE: 5884

Please be advised that the attached zoning changes were approved by the Mesa City Council on October 21, 2024 by Ordinance #5884. If you have any questions concerning these changes, contact the City of Mesa Planning Division at 480-644-2385.

_____ ATTEST: _____ DATE: _____
 MAYOR CITY CLERK