

SITE DATA

PARCEL NUMBER: 304-04-923
 EXISTING ZONING: LC (LIMITED COMMERCIAL)
 MAX. ALLOWABLE HEIGHT BY CODE: 30'-0" (LC ZONING)
 (HEIGHT MORE THAN 30') VARIANCE/APPROVAL REQUIRED
 GROSS PARCEL AREA: 20.58 ACRES (896,657 S.F.)
 NET PARCEL AREA: 16.99 ACRES (740,385 S.F.)
 MAX. ALLOWABLE LOT COVERAGE: 80%

PROPOSED USE: RETAIL / RESTAURANTS / TIRE STORE
 OFFICE / MEDICAL OFFICE / HOTEL

BUILDING AREA:	TOTAL AREA:
PAD 1A: RESTAURANT W-DT	2,000 S.F.
PAD 1A: RESTAURANT	2,250 S.F.
PAD 1A: RESTAURANT PATIO	1,600 S.F.
PAD 1A: RETAIL - SHELL	3,500 S.F.
PAD 2A: RESTAURANT W-DT	2,180 S.F.
PAD 2B: RESTAURANT W-DT	2,600 S.F.
PAD 2B: RESTAURANT	1,700 S.F.
PAD 2B: RESTAURANT PATIO	300 S.F.
PAD 2B: RETAIL - SHELL	4,700 S.F.
PAD 3A: RESTAURANT W-DT	3,200 S.F.
PAD 3A: RESTAURANT PATIO	200 S.F.
PAD 3B: RESTAURANT W-DT	1,800 S.F.
PAD 3B: RESTAURANT PATIO	200 S.F.
PAD 3B: MEDICAL OFFICE	5,500 S.F.
PAD 3B: RETAIL - SHELL	1,200 S.F.
PAD 3C: RETAIL - TIRE STORE	7,680 S.F.
PAD 4: RESTAURANT W-DT	2,400 S.F.
PAD 4: RESTAURANT PATIO	800 S.F.
PAD 5: RESTAURANT W-DT	1,250 S.F.
PAD 5: RESTAURANT	1,650 S.F.
PAD 5: RESTAURANT PATIO	400 S.F.
PAD 5: MEDICAL OFFICE	5,600 S.F.
PAD 6: RESTAURANT	5,400 S.F.
PAD 6: RESTAURANT PATIO	1,600 S.F.
PAD 6: RETAIL - SHELL	4,050 S.F.
PAD 6: FITNESS	4,100 S.F.
TOTAL PAD BUILDING AREA:	67,860 S.F.
TOTAL 4 STORY HOTEL AREA:	60,979 S.F.
TOTAL MEDICAL OFFICE AREA:	32,400 S.F.
TOTAL OVER ALL AREA:	161,239 S.F.

PARKING REQUIRED:	TOTAL AREA:
PAD 1A: RESTAURANT W-DT: 1 PER 100	20 SPACES REQ: 20 SPACES
PAD 1A: RESTAURANT : 1 PER 75	30 SPACES PROV: 71 SPACES
PAD 1A: RESTAURANT PATIO: 1 PER 200	08 SPACES
PAD 1A: RETAIL SHELL : 1 PER 275	13 SPACES
PAD 2A: RESTAURANT W-DT: 1 PER 100	22 SPACES REQ: 91 SPACES
PAD 2B: RESTAURANT W-DT: 1 PER 100	26 SPACES PROV: 100 SPACES
PAD 2B: RESTAURANT : 1 PER 75	23 SPACES
PAD 2B: RESTAURANT PATIO: 1 PER 200	02 SPACES
PAD 2B: RETAIL SHELL : 1 PER 275	17 SPACES
PAD 3A: RESTAURANT W-DT: 1 PER 100	32 SPACES REQ: 106 SPACES
PAD 3A: RESTAURANT PATIO: 1 PER 200	01 SPACES PROV: 114 SPACES
PAD 3B: RESTAURANT W-DT : 1 PER 100	18 SPACES
PAD 3B: RESTAURANT PATIO: 1 PER 200	01 SPACES
PAD 3B: MEDICAL OFFICE: 1 PER 200	28 SPACES
PAD 3B: RETAIL - SHELL : - 1 PER 275	05 SPACES
PAD 3C: RETAIL - SHELL - TIRE STORE - 1 PER 375	21 SPACES
PAD 4: RESTAURANT W-DT: 1 PER 100	24 SPACES REQ: 28 SPACES
PAD 4: RESTAURANT PATIO: 1 PER 200	04 SPACES PROV: 32 SPACES
PAD 5: RESTAURANT W-DT : 1 PER 100	13 SPACES
PAD 5: RESTAURANT : 1 PER 75	22 SPACES REQ: 65 SPACES
PAD 5: RESTAURANT PATIO: 1 PER 200	02 SPACES PROV: 67 SPACES
PAD 5: MEDICAL OFFICE : - 1 PER 200	28 SPACES
PAD 6: RESTAURANT : 1 PER 75	72 SPACES REQ: 136 SPACES
PAD 6: RESTAURANT PATIO: 1 PER 200	08 SPACES PROV: 135 SPACES
PAD 6: RETAIL - SHELL : - 1 PER 275	15 SPACES
PAD 6: FITNESS - 1 PER 100	41 SPACES
HOTEL - 107 ROOMS TOTAL - 1 PER ROOM	107 SPACES PROV: 118 SPACES
MEDICAL OFFICE - 1 PER 200	162 SPACES PROV: 170 SPACES

TOTAL PARKING REQUIRED:	766 SPACES
TOTAL PARKING PROVIDED:	807 SPACES
TOTAL ACCESSIBLE PARKING REQUIRED:	32 SPACES
TOTAL ACCESSIBLE PARKING PROVIDED:	36 SPACES
TOTAL PARKING BICYCLE REQUIRED:	80 SPACES
TOTAL PARKING BICYCLE PROVIDED:	98 SPACES

ENLARGED SITE PLAN - SOUTH PART (FOR REFERENCE ONLY)

SCALE: 1" = 40'-0"

NOT A PART

NOT A PART

± 1,240'

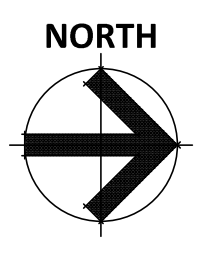

ELLIOT RETAIL

NEC OF ELLIOT ROAD AND ELLSWORTH ROAD

MESA ARIZONA 85212

DATE: 01-31-2023 (PRELIMINARY)

SP-1.1
SOUTH

RKAA# 20115.00

© 2017 R K A A ARCHITECTS, INC. ALL RIGHTS RESERVED. THIS DRAWING IS AN INSTRUMENT OF SERVICE. IT IS THE PROPERTY OF R K A A ARCHITECTS, INC. AND MAY NOT BE REPRODUCED, COPIED, OR DISCLOSED WITHOUT WRITTEN PERMISSION OF THE ARCHITECT.



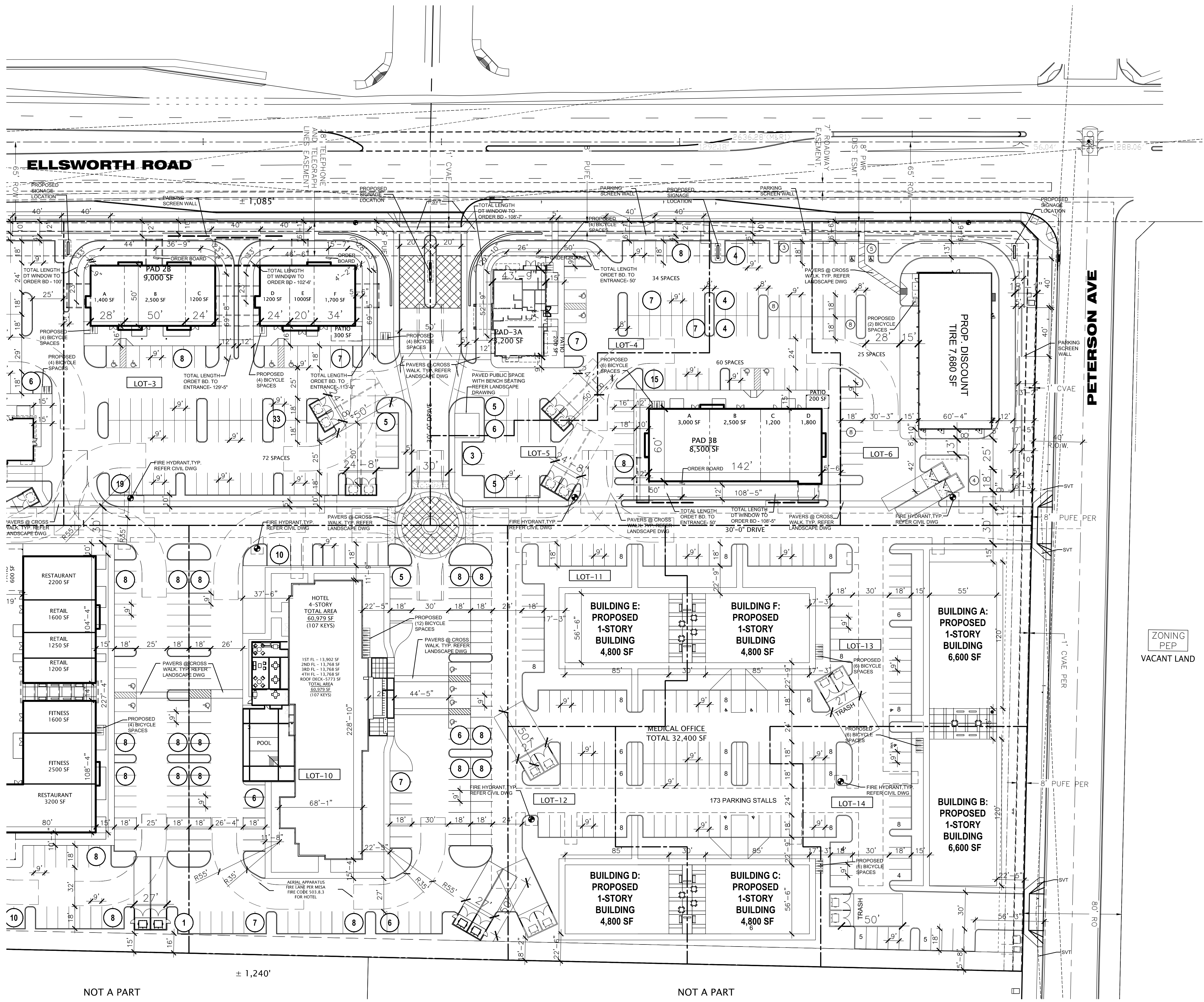

SITE DATA

PARCEL NUMBER: 304-04-923
 EXISTING ZONING: LC (LIMITED COMMERCIAL)
 MAX. ALLOWABLE HEIGHT BY CODE: 30'-0" (LC ZONING)
 (HEIGHT MORE THAN 30') VARIANCE/APPROVAL REQUIRED
 GROSS PARCEL AREA: 20.58 ACRES (896,657 S.F.)
 NET PARCEL AREA: 16.99 ACRES (740,385 S.F.)
 MAX. ALLOWABLE LOT COVERAGE: 80%

PROPOSED USE: RETAIL / RESTAURANTS / TIRE STORE
 OFFICE / MEDICAL OFFICE / HOTEL

BUILDING AREA:	TOTAL AREA:
PAD 1A: RESTAURANT W-DT	2,000 S.F.
PAD 1A: RESTAURANT	2,250 S.F.
PAD 1A: RESTAURANT PATIO	1,600 S.F.
PAD 1A: RETAIL - SHELL	3,500 S.F.
PAD 2A: RESTAURANT W-DT	2,180 S.F.
PAD 2B: RESTAURANT W-DT	2,600 S.F.
PAD 2B: RESTAURANT	1,700 S.F.
PAD 2B: RESTAURANT PATIO	300 S.F.
PAD 2B: RETAIL - SHELL	4,700 S.F.
PAD 3A: RESTAURANT W-DT	3,200 S.F.
PAD 3A: RESTAURANT PATIO	200 S.F.
PAD 3B: RESTAURANT W-DT	1,800 S.F.
PAD 3B: RESTAURANT PATIO	200 S.F.
PAD 3B: MEDICAL OFFICE	5,500 S.F.
PAD 3B: RETAIL - SHELL	1,200 S.F.
PAD 3C: RETAIL - TIRE STORE	7,680 S.F.
PAD 4: RESTAURANT W-DT	2,400 S.F.
PAD 4: RESTAURANT PATIO	800 S.F.
PAD 5: RESTAURANT W-DT	1,250 S.F.
PAD 5: RESTAURANT	1,650 S.F.
PAD 5: RESTAURANT PATIO	400 S.F.
PAD 5: MEDICAL OFFICE	5,600 S.F.
PAD 6: RESTAURANT	5,400 S.F.
PAD 6: RESTAURANT PATIO	1,600 S.F.
PAD 6: RETAIL - SHELL	4,050 S.F.
PAD 6: FITNESS	4,100 S.F.
TOTAL PAD BUILDING AREA:	67,860 S.F.
TOTAL 4 STORY HOTEL AREA:	60,979 S.F.
TOTAL MEDICAL OFFICE AREA:	32,400 S.F.
TOTAL OVER ALL AREA:	161,239 S.F.

PARKING REQUIRED:	TOTAL AREA:
PAD 1A: RESTAURANT W-DT: 1 PER 100	20 SPACES REQ: 20 SPACES
PAD 1A: RESTAURANT : 1 PER 75	30 SPACES REQ: 30 SPACES
PAD 1A: RESTAURANT PATIO: 1 PER 200	08 SPACES REQ: 08 SPACES
PAD 1A: RETAIL SHELL : 1 PER 275	13 SPACES REQ: 13 SPACES
PAD 2A: RESTAURANT W-DT: 1 PER 100	22 SPACES REQ: 22 SPACES
PAD 2B: RESTAURANT W-DT: 1 PER 100	26 SPACES REQ: 26 SPACES
PAD 2B: RESTAURANT : 1 PER 75	23 SPACES REQ: 23 SPACES
PAD 2B: RESTAURANT PATIO: 1 PER 200	02 SPACES REQ: 02 SPACES
PAD 2B: RETAIL SHELL : 1 PER 275	17 SPACES REQ: 17 SPACES
PAD 3A: RESTAURANT W-DT: 1 PER 100	32 SPACES REQ: 32 SPACES
PAD 3A: RESTAURANT PATIO: 1 PER 200	01 SPACES REQ: 01 SPACES
PAD 3B: RESTAURANT W-DT : 1 PER 100	18 SPACES REQ: 18 SPACES
PAD 3B: RESTAURANT PATIO: 1 PER 200	01 SPACES REQ: 01 SPACES
PAD 3B: MEDICAL OFFICE: 1 PER 200	28 SPACES REQ: 28 SPACES
PAD 3B: RETAIL - SHELL : - 1 PER 275	05 SPACES REQ: 05 SPACES
PAD 3C: RETAIL - SHELL - TIRE STORE - 1 PER 375	21 SPACES REQ: 21 SPACES
PAD 4: RESTAURANT W-DT: 1 PER 100	24 SPACES REQ: 24 SPACES
PAD 4: RESTAURANT PATIO: 1 PER 200	04 SPACES REQ: 04 SPACES
PAD 5: RESTAURANT W-DT : 1 PER 100	13 SPACES REQ: 13 SPACES
PAD 5: RESTAURANT : 1 PER 75	22 SPACES REQ: 22 SPACES
PAD 5: RESTAURANT PATIO: 1 PER 200	02 SPACES REQ: 02 SPACES
PAD 5: MEDICAL OFFICE : - 1 PER 200	28 SPACES REQ: 28 SPACES
PAD 6: RESTAURANT : 1 PER 75	72 SPACES REQ: 72 SPACES
PAD 6: RESTAURANT PATIO: 1 PER 200	08 SPACES REQ: 08 SPACES
PAD 6: RETAIL - SHELL : - 1 PER 275	15 SPACES REQ: 15 SPACES
PAD 6: FITNESS - 1 PER 100	41 SPACES REQ: 41 SPACES
HOTEL - 107 ROOMS TOTAL - 1 PER ROOM	107 SPACES REQ: 107 SPACES
MEDICAL OFFICE - 1 PER 200	162 SPACES REQ: 162 SPACES

TOTAL PARKING REQUIRED: 766 SPACES
 TOTAL PARKING PROVIDED: 807 SPACES

TOTAL ACCESSIBLE PARKING REQUIRED: 32 SPACES
 TOTAL ACCESSIBLE PARKING PROVIDED: 36 SPACES

TOTAL PARKING BICYCLE REQUIRED: 80 SPACES
 TOTAL PARKING BICYCLE PROVIDED: 98 SPACES

ENLARGED SITE PLAN - NORTH PART (FOR REFERENCE ONLY)
 SCALE: 1" = 40'-0"

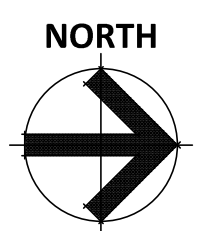

ELLIOT RETAIL
 NEC OF ELLIOT ROAD AND ELLSWORTH ROAD
 MESA ARIZONA 85212
 DATE: 01-31-2023 (PRELIMINARY)

SP-1.2
 NORTH
 RKAA# 20115.00



© 2017 RKAA ARCHITECTS, INC. ALL RIGHTS RESERVED. THIS DRAWING IS AN INSTRUMENT OF SERVICE. IT IS THE PROPERTY OF RKAA ARCHITECTS, INC. AND MAY NOT BE REPRODUCED, COPIED, OR DISCLOSED WITHOUT WRITTEN PERMISSION OF THE ARCHITECT.

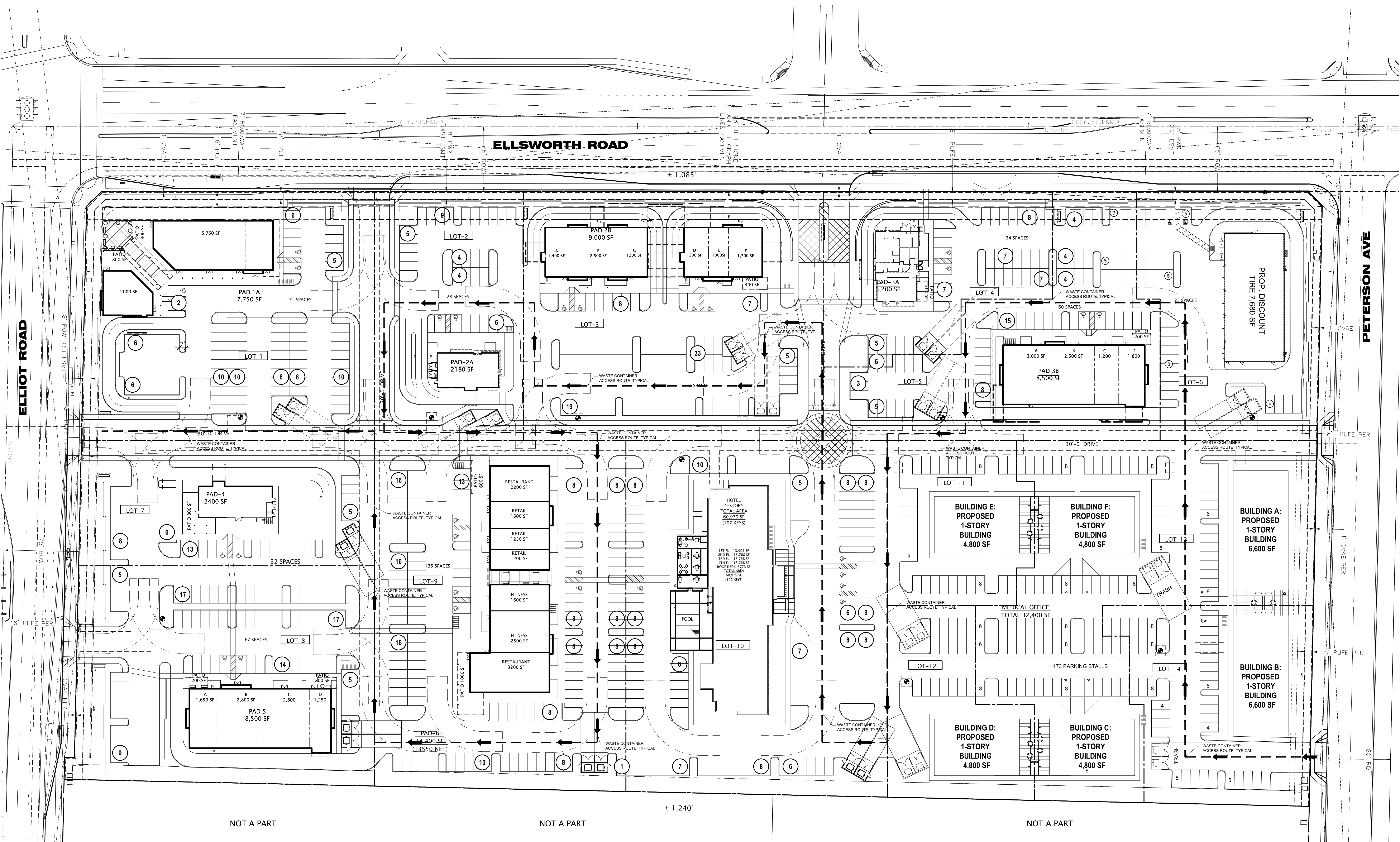

ENLARGED SITE PLAN - WASTE PICKUP ROUTE

SCALE: 1" = 60'-0"

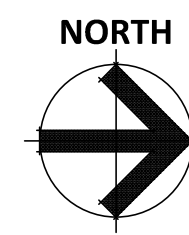
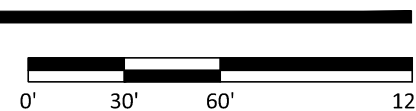

ELLIOT RETAIL

NEC OF ELLIOT ROAD AND ELLSWORTH ROAD

MESA ARIZONA 85212

DATE: 01-31-2023(PRELIMINARY)

© 2017 R K A A ARCHITECTS, INC. ALL RIGHTS RESERVED. THIS DRAWING IS AN INSTRUMENT OF SERVICE. IT IS THE PROPERTY OF R K A A ARCHITECTS, INC. AND MAY NOT BE DUPLICATED, USED OR DISCLOSED WITHOUT WRITTEN PERMISSION OF THE ARCHITECT.

**SP-2.1
CLEAR**

RKAA# 20115.00



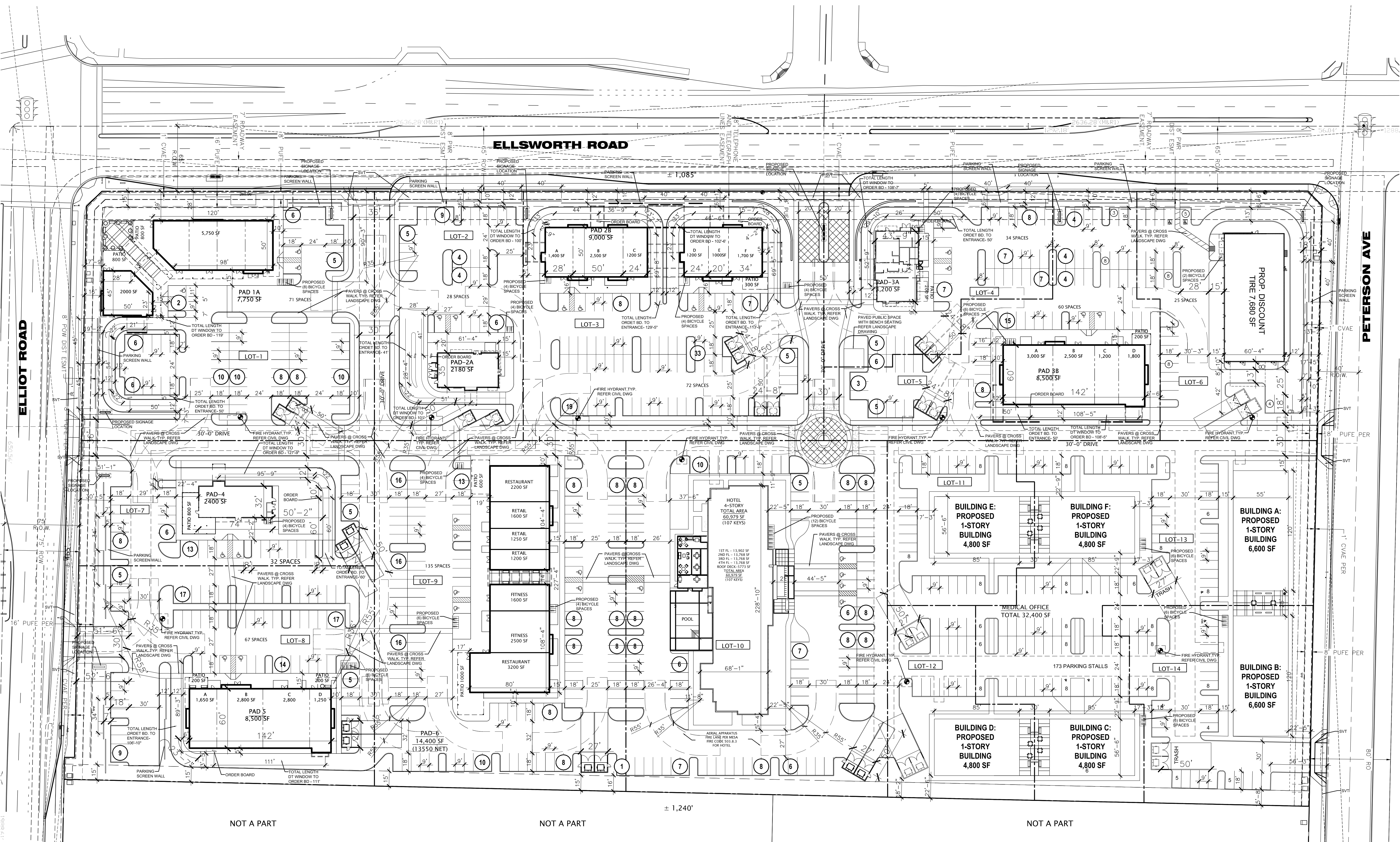

ENLARGED SITE PLAN
SCALE: 1" = 60'-0"

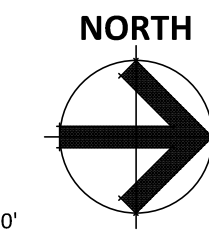
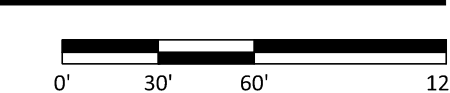

ELLIOT RETAIL
NEC OF ELLIOT ROAD AND ELLSWORTH ROAD
MESA ARIZONA 85212
DATE: 01-31-2023 (PRELIMINARY)

SP-2
RKAA# 20115.00

© 2017 RKAA ARCHITECTS, INC. ALL RIGHTS RESERVED. THIS DRAWING IS AN INSTRUMENT OF SERVICE. IT IS THE PROPERTY OF RKAA ARCHITECTS, INC. AND MAY NOT BE DUPLICATED, USED OR DISCLOSED WITHOUT WRITTEN PERMISSION OF THE ARCHITECT.



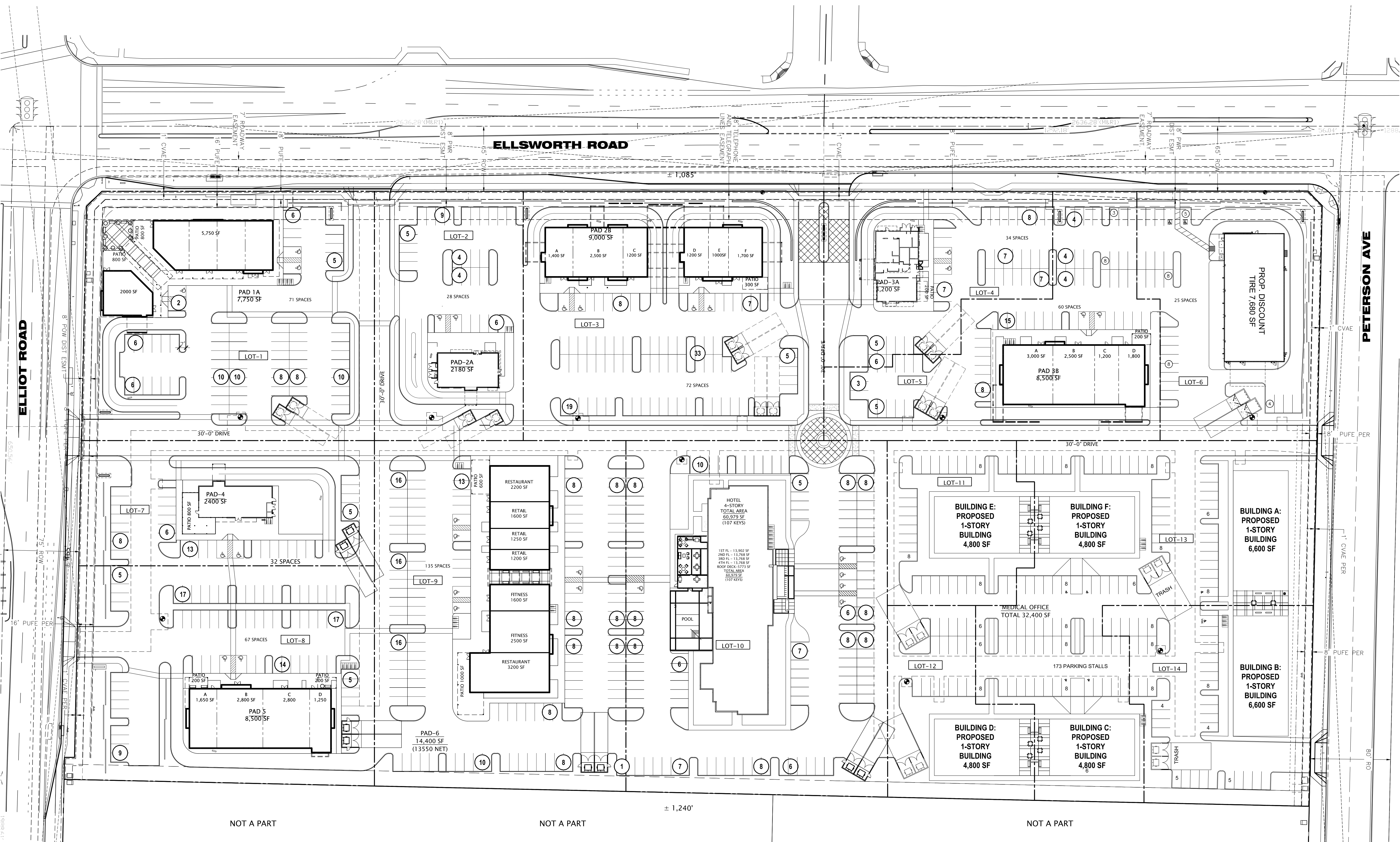

ENLARGED SITE PLAN - FOR REFERENCE ONLY

SCALE: 1" = 60'-0"

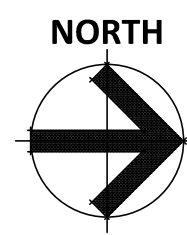
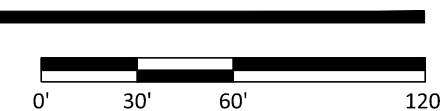

ELLIOT RETAIL

NEC OF ELLIOT ROAD AND ELLSWORTH ROAD

MESA ARIZONA 85212

DATE: 01-31-2023(PRELIMINARY)

**SP-3.0
CLEAR**

RKAA# 20115.00

© 2017 RKAA ARCHITECTS, INC. ALL RIGHTS RESERVED. THIS DRAWING IS AN INSTRUMENT OF SERVICE. IT IS THE PROPERTY OF RKAA ARCHITECTS, INC. AND MAY NOT BE DUPLICATED, USED OR DISCLOSED WITHOUT WRITTEN PERMISSION OF THE ARCHITECT.



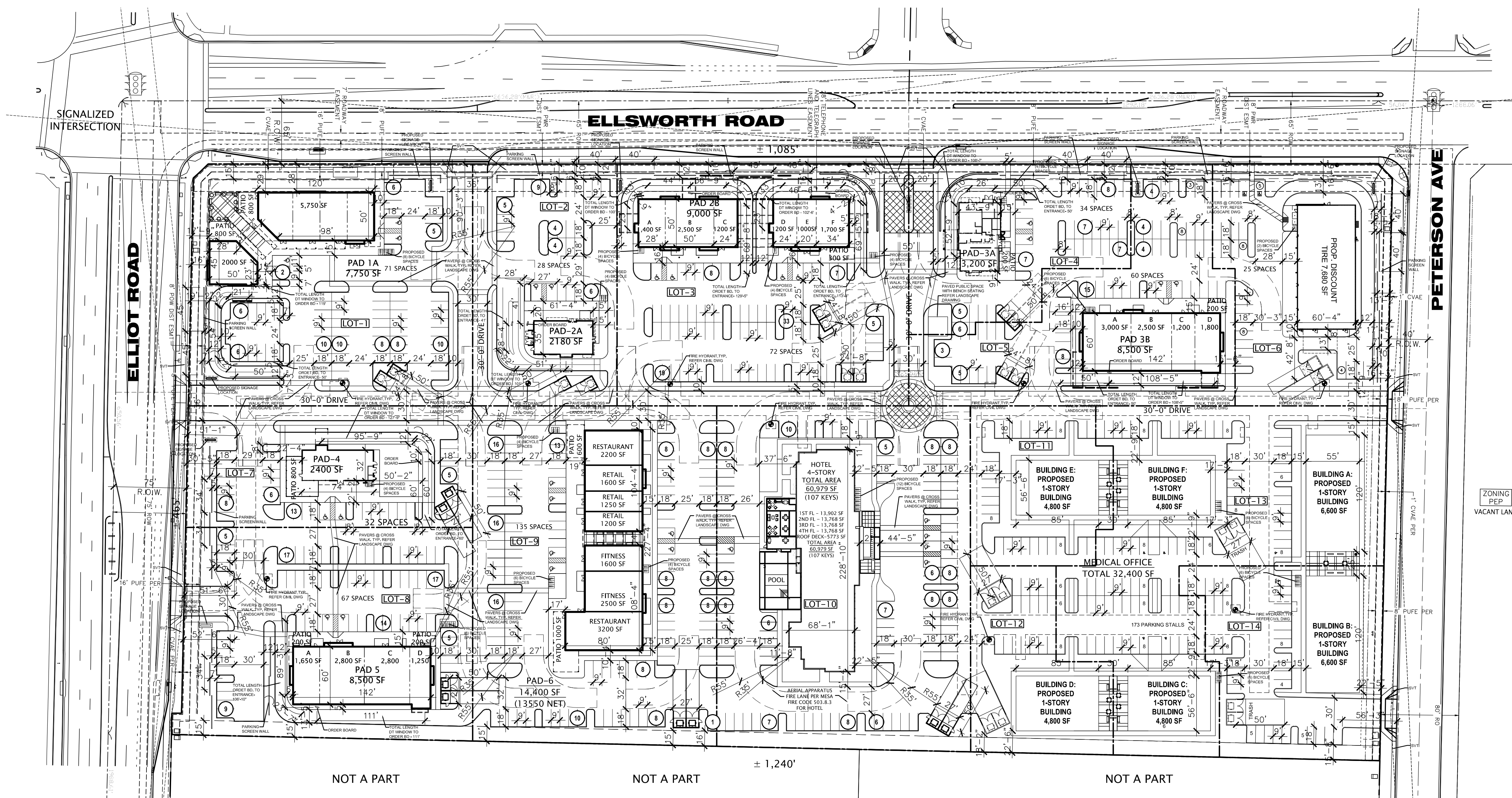

SITE DATA

PARCEL NUMBER: 304-04-923
 EXISTING ZONING: LC (LIMITED COMMERCIAL)
 MAX. ALLOWABLE HEIGHT BY CODE: 30'-0" (LC ZONING)
 (HEIGHT MORE THAN 30') VARIANCE/APPROVAL REQUIRED
 GROSS PARCEL AREA: 20.58 ACRES (896,657 S.F.)
 NET PARCEL AREA: 16.99 ACRES (740,385 S.F.)
 MAX. ALLOWABLE LOT COVERAGE: 80%

PROPOSED USE: RETAIL / RESTAURANTS / TIRE STORE
 OFFICE / MEDICAL OFFICE / HOTEL

BUILDING AREA:	TOTAL AREA:
PAD 1A: RESTAURANT W-DT	2,000 S.F.
PAD 1A: RESTAURANT	2,250 S.F.
PAD 1A: RESTAURANT PATIO	1,600 S.F.
PAD 1A: RETAIL - SHELL	3,500 S.F.
PAD 2A: RESTAURANT W-DT	2,180 S.F.
PAD 2B: RESTAURANT W-DT	2,600 S.F.
PAD 2B: RESTAURANT	1,700 S.F.
PAD 2B: RESTAURANT PATIO	300 S.F.
PAD 2B: RETAIL - SHELL	4,700 S.F.
PAD 3A: RESTAURANT W-DT	3,200 S.F.
PAD 3A: RESTAURANT PATIO	200 S.F.
PAD 3B: RESTAURANT W-DT	1,800 S.F.
PAD 3B: RESTAURANT PATIO	200 S.F.
PAD 3B: MEDICAL OFFICE	5,500 S.F.
PAD 3B: RETAIL - SHELL	1,200 S.F.
PAD 3C: RETAIL - TIRE STORE	7,680 S.F.
PAD 4: RESTAURANT W-DT	2,400 S.F.
PAD 4: RESTAURANT PATIO	800 S.F.
PAD 5: RESTAURANT W-DT	1,250 S.F.
PAD 5: RESTAURANT	1,650 S.F.
PAD 5: RESTAURANT PATIO	400 S.F.
PAD 5: MEDICAL OFFICE	5,600 S.F.
PAD 6: RESTAURANT	5,400 S.F.
PAD 6: RESTAURANT PATIO	1,600 S.F.
PAD 6: RETAIL - SHELL	4,050 S.F.
PAD 6: FITNESS	4,100 S.F.
TOTAL PAD BUILDING AREA:	67,860 S.F.
TOTAL 4 STORY HOTEL AREA:	60,979 S.F.
TOTAL MEDICAL OFFICE AREA:	32,400 S.F.
TOTAL OVER ALL AREA:	161,239 S.F.

PARKING REQUIRED:	TOTAL AREA:
PAD 1A: RESTAURANT W-DT: 1 PER 100	20 SPACES REQ: 71 SPACES
PAD 1A: RESTAURANT : 1 PER 75	30 SPACES PROV: 71 SPACES
PAD 1A: RESTAURANT PATIO: 1 PER 200	08 SPACES
PAD 1A: RETAIL SHELL : 1 PER 275	13 SPACES
PAD 2A: RESTAURANT W-DT: 1 PER 100	22 SPACES REQ: 91 SPACES
PAD 2B: RESTAURANT W-DT: 1 PER 100	26 SPACES PROV: 100 SPACES
PAD 2B: RESTAURANT : 1 PER 75	23 SPACES
PAD 2B: RESTAURANT PATIO: 1 PER 200	02 SPACES
PAD 2B: RETAIL SHELL : 1 PER 275	17 SPACES
PAD 3A: RESTAURANT W-DT: 1 PER 100	32 SPACES REQ: 106 SPACES
PAD 3A: RESTAURANT PATIO: 1 PER 200	01 SPACES PROV: 119 SPACES
PAD 3B: RESTAURANT W-DT : 1 PER 100	18 SPACES
PAD 3B: RESTAURANT PATIO: 1 PER 200	01 SPACES
PAD 3B: MEDICAL OFFICE: 1 PER 200	28 SPACES
PAD 3B: RETAIL - SHELL : - 1 PER 275	05 SPACES
PAD 3C: RETAIL - SHELL - TIRE STORE - 1 PER 375	21 SPACES
PAD 4: RESTAURANT W-DT: 1 PER 100	24 SPACES REQ: 28 SPACES
PAD 4: RESTAURANT PATIO: 1 PER 200	04 SPACES PROV: 32 SPACES
PAD 5: RESTAURANT W-DT : 1 PER 100	13 SPACES
PAD 5: RESTAURANT : 1 PER 75	22 SPACES REQ: 65 SPACES
PAD 5: RESTAURANT PATIO: 1 PER 200	02 SPACES PROV: 67 SPACES
PAD 5: MEDICAL OFFICE : - 1 PER 200	28 SPACES
PAD 6: RESTAURANT : 1 PER 75	72 SPACES REQ: 136 SPACES
PAD 6: RESTAURANT PATIO: 1 PER 200	08 SPACES PROV: 135 SPACES
PAD 6: RETAIL - SHELL : - 1 PER 275	15 SPACES
PAD 6: FITNESS - 1 PER 100	41 SPACES
HOTEL - 107 ROOMS TOTAL - 1 PER ROOM	107 SPACES PROV: 118 SPACES
MEDICAL OFFICE - 1 PER 200	162 SPACES PROV: 170 SPACES

TOTAL PARKING REQUIRED:	766 SPACES
TOTAL PARKING PROVIDED:	812 SPACES
TOTAL ACCESSIBLE PARKING REQUIRED:	32 SPACES
TOTAL ACCESSIBLE PARKING PROVIDED:	36 SPACES
TOTAL PARKING BICYCLE REQUIRED:	80 SPACES
TOTAL PARKING BICYCLE PROVIDED:	98 SPACES

SITE PLAN

SCALE: 1" = 60'-0"

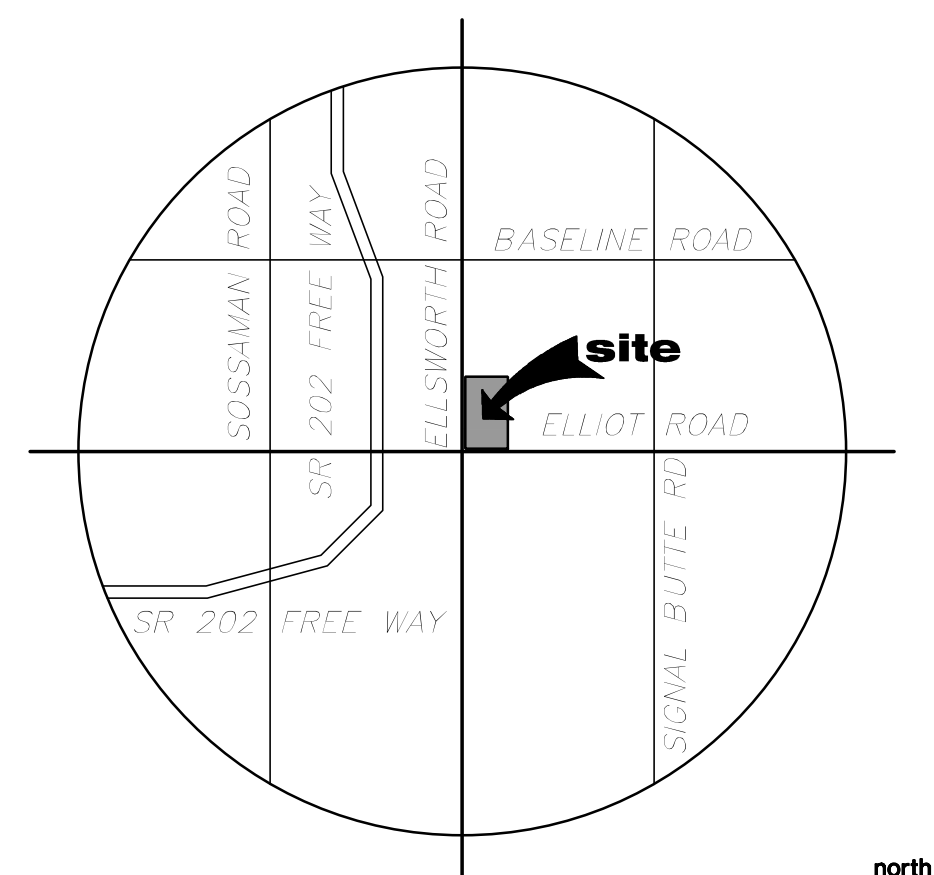
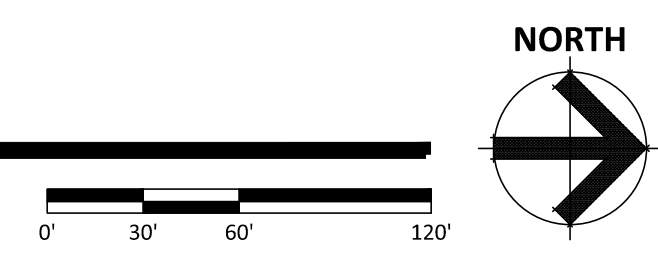

LOT COVERAGE CALCULATIONS

LOT NO	NET LOT AREA	TOTAL FOOTPRINT	LOT COVERAGE
LOT 1:	71,964 S.F.	9,350 S.F.	12.99%
LOT 2:	36,944 S.F.	2,180 S.F.	5.90%
LOT 3:	74,637 S.F.	9,300 S.F.	12.46%
LOT 4:	32,995 S.F.	3,400 S.F.	10.30%
LOT 5:	48,007 S.F.	8,700 S.F.	18.12%
LOT 6:	42,044 S.F.	7,680 S.F.	18.26%
LOT 7:	36,725 S.F.	3,200 S.F.	8.71%
LOT 8:	64,610 S.F.	8,900 S.F.	13.77%
LOT 9:	87,197 S.F.	15,160 S.F.	17.38%
LOT 10:	92,128 S.F.	13,902 S.F.	15.08%
LOT 11:	22,771 S.F.	4,800 S.F.	21.08%
LOT 12:	22,501 S.F.	4,800 S.F.	21.33%
LOT 13:	72,428 S.F.	16,200 S.F.	22.36%
LOT 14:	35,434 S.F.	6,600 S.F.	18.62%
TOTAL	740,385 S.F.	114,162 S.F.	15.41%

LANDSCAPE DATA

GROSS SITE AREA:	20.58 ACRES (896,657 S.F.)
NET SITE AREA:	17.00 ACRES (740,742 S.F.)
LANDSCAPE AREA:	164,240 S.F.
LANDSCAPE COVERAGE:	22%

PUBLIC OPEN SPACE DATA

5 S.F. PER 1000 S.F. BUILDING FLOOR AREA	161,239 S.F.
TOTAL BUILDING FLOOR AREA:	806 S.F.
OPEN SPACE REQUIRED:	7,353 S.F.
OPEN SPACE PROVIDED:	

ELLIOT RETAIL

NEC OF ELLIOT ROAD AND ELLSWORTH ROAD
 MESA ARIZONA 85212
 DATE: 01-31-2023 (PRELIMINARY)

© 2017 R K A A ARCHITECTS, INC. ALL RIGHTS RESERVED. THIS DRAWING IS AN INSTRUMENT OF SERVICE. IT IS THE PROPERTY OF R K A A ARCHITECTS, INC. AND MAY NOT BE DUPLICATED, USED OR DISCLOSED WITHOUT WRITTEN PERMISSION OF THE ARCHITECT.

SP-1

RKAA# 20115.00



THIS SITE PLAN HAS BEEN PREPARED WITHOUT THE AID OF A SURVEY. ALL PROPERTY BOUNDARIES ARE ROUGH APPROXIMATIONS. THIS DRAWING IS TO BE USED FOR CONCEPTUAL PURPOSES ONLY AND IT IS NOT TO BE THE BASIS FOR ANY LEGALLY BINDING DOCUMENTATION.