

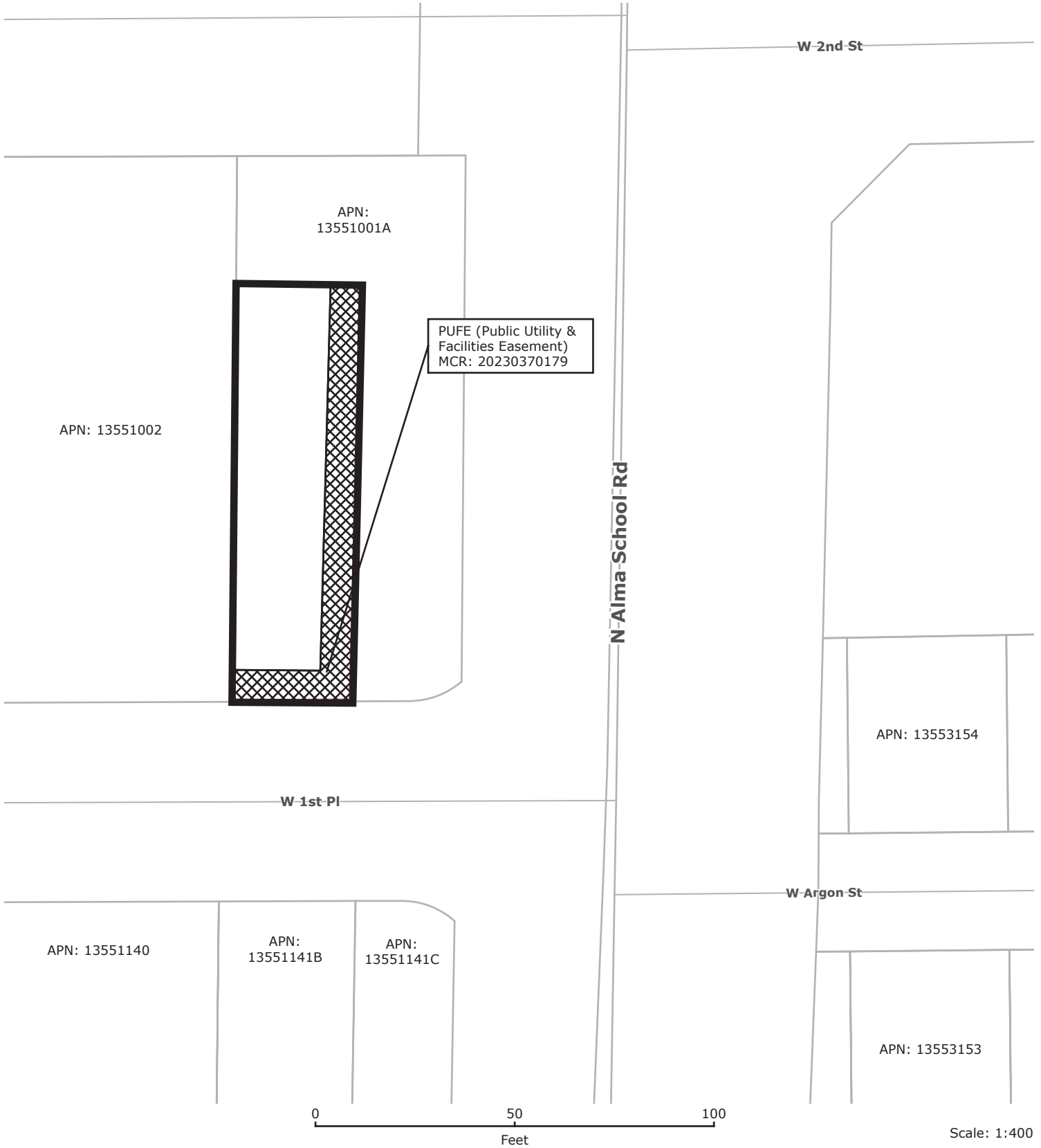

Map created by Engineering GIS DATE SAVED: 8/17/2023 Path: I:\GIS_Mapping\Project_Files\Real_Estate\Council\Maps\NW\AlmaSchoolRdandWest1stPlace\ExcessPropertySale.aprx



PUFE (Public Utility & Facilities Easement)
MCR: 20230370179

Sale Portion

N Alma School Rd & W 1st Pl
141-51-001A
Excess Property Sale

Existing PUF&FE (Public Utility & Facilities Easement)
MCR: 20230370179