

RESOLUTION NO. _____

A RESOLUTION OF THE CITY COUNCIL OF THE CITY OF MESA, MARICOPA COUNTY, ARIZONA, AUTHORIZING THE CITY MANAGER OR HIS DESIGNEE TO ENTER INTO A LEASE AGREEMENT WITH OAKWOOD CREATIVE CARE, INC. FOR A PORTION OF THE PROPERTY LOCATED AT 247 NORTH MACDONALD, MESA, ARIZONA.

WHEREAS, the City-owned property identified as the Senior Center Facility located at 247 North Macdonald, Mesa, AZ as described and depicted in the attached *Exhibit A* and *Exhibit B*, has been identified as available for lease;

WHEREAS, the City Council desires to provide City of Mesa residents with access to social services that improve the quality of life for members of the Mesa community which Oakwood Creative Care, Inc. provides; and

WHEREAS, the City Council has determined that it is appropriate for the City to lease the property and, therefore, it is appropriate to enter into a lease agreement with Oakwood Creative Care. Inc.

NOW THEREFORE, BE IT RESOLVED BY THE CITY COUNCIL OF THE CITY OF MESA, MARICOPA COUNTY, ARIZONA AS FOLLOWS:

Section 1: The City Manager, or his designated representative, is hereby authorized and directed, on behalf of the City of Mesa, to execute the necessary and/or related documents, including any amendments or modifications thereto, to enter into a lease agreement with Oakwood Creative Care, Inc. for the City-owned property depicted in the attached *Exhibit A* and *Exhibit B*, which are incorporated into this Resolution by this reference. The City Clerk is authorized and directed to attest the signature of the City Manager thereon.

PASSED AND ADOPTED by the City Council of the City of Mesa, Maricopa County, Arizona this 11th day of July, 2022.

APPROVED:

Mayor

ATTEST:

City Clerk

EXHIBIT 'A'

247 North Macdonald, Mesa, Arizona
Legal Description

Commencing at the Northwest corner of Lot 1, Tract A, Block 29, Mesa, according to the Plat of Record on file in the office of the County Recorder of Maricopa County, Arizona, Book 23 of Maps, page 18 thereof, said point also known as the True Point of Beginning:

Thence East along the North line of said Tract A, a distance of 331.60 feet;

Thence South, an assumed bearing, a distance of 450.00 feet;

Thence West, an assumed bearing, a distance of 165.70 feet;

Thence North, a distance of 20.00 feet;

Thence West, an assumed bearing, a distance of 165.70 feet;

Thence North, along the West line of said Block 29, a distance of 430.00 feet to the True Point of Beginning, containing 145,920 square feet, or 3.35 acres, more or less.

The City of Mesa also owns the buildings on the above described site.



W-3rd Pl

N-Macdonald

N-Drew St

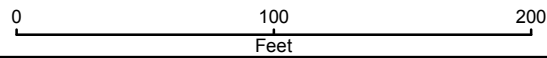
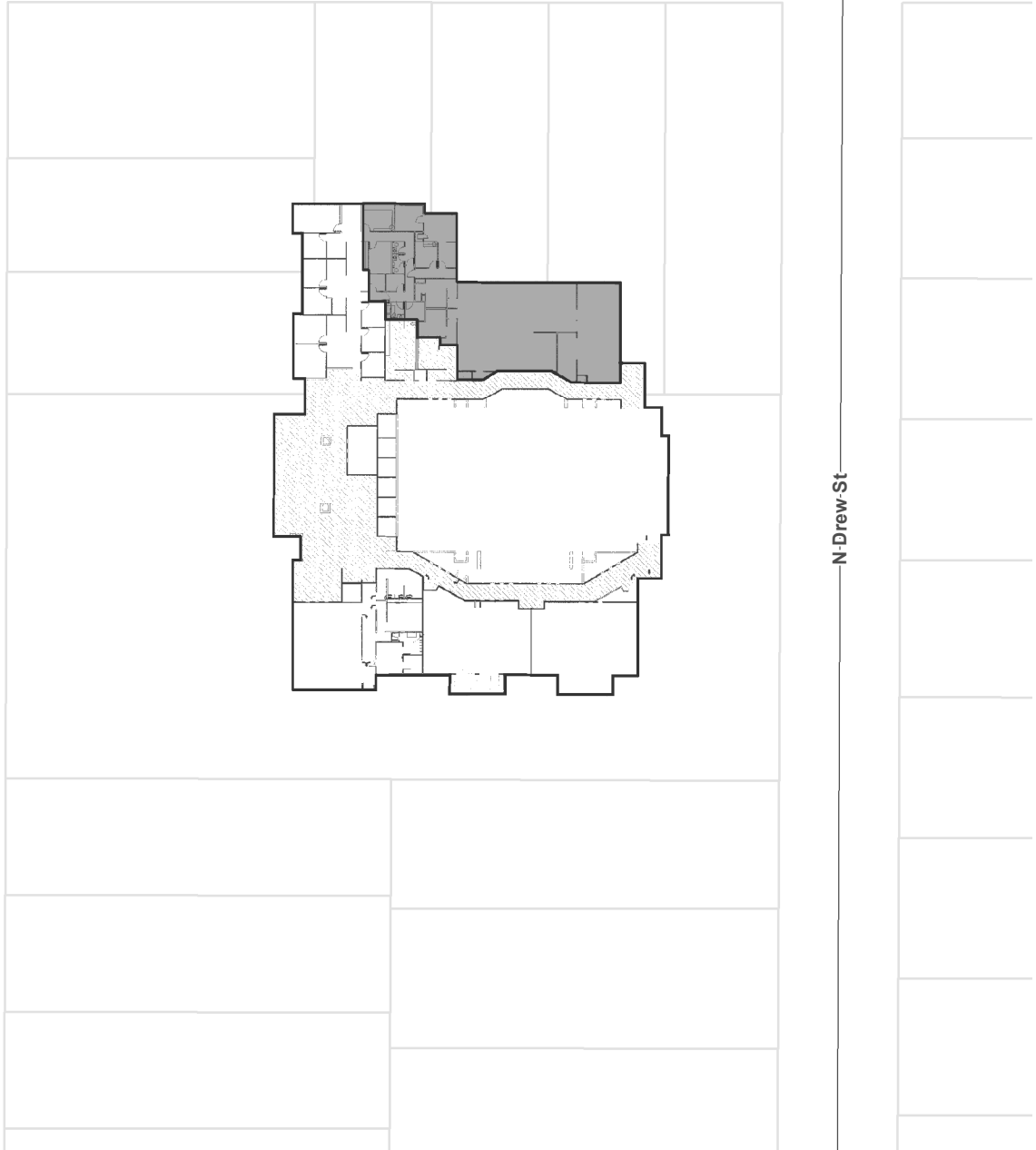

Oakwood Creative Care Leased Premises

The Leased Premises shall consist of 4,176 square feet of the property described in Exhibit A, the location and area of which is depicted in the site map above.

-  Leased Area
-  Remaining