

PLANT SCHEDULE

BOTANICAL NAME	COMMON NAME	SIZE	QTY	COMMENTS
TREES				
Acacia aneura	Mulga Acacia	24" Box (1" Cal.)	73	Std Trunk, Dense Canopy Mature Coverage - 180 SF
Acacia willardiana	Palo Blanco	24" Box (1.5" Cal.)	15	Std Trunk, Dense Canopy Mature Coverage - 80 SF
Caesalpinia pulcherrima	Mexican Bird of Paradise	24" Box (1.5" Cal.)	42	Multi-Trunk, Dense Canopy Mature Coverage - 60 SF
Chilopsis linearis 'Art's Seedless'	Desert Willow Seedless	24" Box (1.5" Cal.)	16	Multi-Trunk, Dense Canopy Mature Coverage - 225 SF
Chitalpa tashkentensis	Chitalpa	36" Box (2.5" Cal.)	14	Multi-Trunk, Dense Canopy Mature Coverage - 225 SF
Parkinsonia hybrid 'Desert Museum'	Desert Museum Palo Verde	24" Box (1.75" Cal.)	22	Multi Trunk, Dense Canopy Mature Coverage - 225 SF
Phoenix dactylifera	Date Palm	18" CTH	19	Matching Form, Diamond Cut Mature Coverage - 100 SF
Pinus halepensis	Aleppo Pine	24" Box (1.5" Cal.)	12	Std Trunk, Dense Canopy Mature Coverage - 225 SF
Prosopis x Phoenix	Thornless Grafted Mesquite	36" Box (2.5" Cal.)	12	Multi Trunk, Dense Canopy Mature Coverage - 225 SF
Pistacia x 'Red Push'	Red Push Pistachio	36" Box (2.5" Cal.)	45	Std Trunk, Dense Canopy Mature Coverage - 225 SF
Quercus virginiana 'Heritage'	Southern Live Oak	24"/36" Box (1/2" Cal.)	85	Std Trunk, Dense Canopy Mature Coverage - 225 SF
ACCENTS/VINES				
Aloe barbadensis	Medicinal Aloe	5-Gal	198	As Per Plan
Asclepias subulata	Desert Milkweed	5-Gal	27	As Per Plan
Dasyliyon wheeleri	Desert Spoon	5-Gal	121	As Per Plan
Hesperaloe funifera	Giant Hesperaloe	15-Gal	7	As Per Plan
Hesperaloe parviflora 'Perla'	Brakelights Hesperaloe	5-Gal	72	As Per Plan
Muhlenbergia rigida 'Nashville'	Nashville Grass	5-Gal	311	As Per Plan
Opuntia santarita	Prickly Pear	15-Gal	42	As Per Plan
SHRUBS				
Dodonaea viscosa 'Purplea'	Purple Hopseed Bush	5 Gal.	93	As Per Plan
Calliandra x 'Maricopa Red'	Sierra Starr Fairy Duster	5 Gal.	29	As Per Plan
Eremophila glabra	Winter Blaze	5 Gal.	81	As Per Plan
Eremophila hygrophana	Blue Bells	5 Gal.	179	As Per Plan
Ericameria laricina	Turpentine Bush	5 Gal.	56	As Per Plan
Leucophyllum langmaniae 'Rio Bravo'	Rio Bravo Sage	5 Gal.	144	As Per Plan
Justicia californica	Red Chuperosa	5 Gal.	55	As Per Plan
Olea europaea 'Montra'	Little Ollie	5 Gal.	125	As Per Plan
Russelia equisetiformis	Coral Fountain	5 Gal.	101	As Per Plan
Ruellia simplex	Mexican Petunia	5 Gal.	165	As Per Plan
Senna artemisioides	Silver Cassia	5 Gal.	50	As Per Plan
Tecoma hybrid 'Bells of Fire'	Bells of Fire	5 Gal.	149	As Per Plan
Tecoma stans	Arizona Yellow Bells	5 Gal.	46	As Per Plan
GROUND COVERS				
Bougainvillea x 'Yani's Delight'	Yani's Delight Bougainvillea	5 Gal.	77	As Per Plan
Callistemon citrinus 'Little John'	Little John Bottlebrush	1 Gal.	232	As Per Plan
Eremophila glabra 'Mindenev Gold'	Outback Sunrise	1 Gal.	146	As Per Plan
Lantana hybrid 'New Gold'	New Gold Lantana	1 Gal.	384	As Per Plan
Lantana montevidensis	Purple Trailing Lantana	1 Gal.	188	As Per Plan
Rosmarinus officinalis 'Prostrata'	Creeping Rosemary	1 Gal.	246	As Per Plan
MISCELLANEOUS				
DG	Decomposed Granite - Color: Carmel by Rock Pros	Size: 3" minus, 2" depth in all planting areas (typ)		123,215 SF
TURF	Synthetic Turf - Manuf: ForeverLawn - Type: Fusion Elite or Equal			1,115 SF
LAWN	Lawn - Hybrid Bermuda Sod			2,410 SF
	Eastmark Seed Mix - All weight is in Pure Live Seed			See Matrix Below - 4,275 SF
SEED MIX MATRIX				
LBS/Ac.	Botanical Name	Common Name		
1.0	Encelia farinosa	Brittlebush		
3.0	Ambrosia deltoidea	Triangle-leaf Bursage		
2.0	Baileya multiradiata	Desert Marigold		
2.0	Senna covesii	Desert Senna		
3.0	Eschscholzia californica ssp Mexicana	Mexican Gold Poppy		
2.0	Lupinus shockleyi	Desert Lupine		
1.5	Penstemon parryi	Parry Penstemon		
2.0	Aristida purpurea	Purple Three Awl		
1.0	Bouteloua curtipendula	Side Oats Grama		

COMMUNITY MASTER PLAN - SECTION 12

	REQUIRED	PROVIDED
STREET PERIMETER LANDSCAPE (802' LF / 16,040 SF) 1 TREES / 50 LF 1 PLANT / 50 SF	17 320	23 322
SURFACE PARKING AREA (34,442 SF PARKING / 14,725 SF LANDSCAPE) 1 TREE / 2,300 SF PARKING 1 PLANT / 50 SF LANDSCAPE	15 295	38 325

DRIVE THRU LANDSCAPE - ORDINANCE NO. 5813

	REQUIRED	PROVIDED
DRIVE THRU SCREENING/BUFFERING (160' LF) 1 TREES / 50 LF + 2 TREES / 25LF 2 SHRUBS / TREE	17 34	17 86

SHADE TOTAL (TREES ARE COOL)
60,580 SF 60,580 / 511,465 = 11.9% Based on areas provided by City of Mesa, see species specific sizes above in comments column

* Plants not on the Phoenix AMA Low Water Use / Drought Tolerant Plants List. Not to be planted in project ROW.
** Approved Plants for use in SRP ROW

CONCEPTUAL GENERAL NOTES

- CONCEPTUAL LANDSCAPE PLAN IS SCHEMATIC IN NATURE. AT THE TIME OF LANDSCAPE CONSTRUCTION DRAWINGS ACTUAL LOCATIONS, QUANTITIES, SIZES, AND SPECIES SHALL BE DETERMINED AND WILL BE PER CITY CODES.
- ALL TREES USED WITHIN THIS PROJECT SHALL BE NURSERY GROWN OR SALVAGED FROM ON SITE. EXACT LOCATIONS AND QUANTITIES SHALL BE DETERMINED ON LANDSCAPE CONSTRUCTION DRAWINGS. ALL EXISTING TREES SHALL BE PROTECTED DURING CONSTRUCTION.
- ALL LANDSCAPE AREAS SHALL RECEIVE AN AUTOMATIC IRRIGATION SYSTEM.
- ALL PLANT MATERIAL SHALL BE INSTALLED PER CITY REQUIREMENTS. PLANT MATERIAL INSTALLED WITHIN SIGHT DISTANCE TRIANGLES SHALL BE OF A SPECIES THAT DOES NOT GROW TO A HEIGHT OF MORE THAN 30' AND SHALL BE MAINTAINED PER CITY REQUIREMENTS.
- ALL NON-TURF AREAS SHALL RECEIVE A 2" DEPTH OF DECOMPOSED GRANITE.
- THE RETENTION SHOWN ON THE PLANS IS CONCEPTUAL IN NATURE. REFER TO THE ENGINEERING PLANS FOR ACTUAL GRADING AND DRAINAGE CONFIGURATIONS.
- ALL EARTHWORK WILL BE DONE TO DRAIN AWAY FROM SIDEWALKS AND STRUCTURES.
- ADDITIONAL PLANT MATERIAL MAY BE INTRODUCED AS DIFFERENT VARIETIES BECOME AVAILABLE THROUGH LOCAL NURSERIES AND IF THEY ARE CONSISTENT WITH THE OVERALL THEME OF THIS PROJECT.

CONCEPTUAL LANDSCAPE PLAN

SCALE: 1"=60'-0"



CONCEPTUAL LANDSCAPE PLAN

DESIGNED BY:	PV/SH
DRAWN BY:	PV/SH
CHECKED BY:	PV/MD
DATE:	08/29/2025
REVISIONS:	CITY COMMENTS 09/22/2025
	SITE PLAN REVISION 11/17/2025
	SITE PLAN REVISION 12/19/2025
	CITY COMMENTS 02/18/2026
	CITY COMMENTS 04/13/2026
	CITY COMMENTS 05/04/2026

THE HOMESTEAD AT SIGNAL BUTTE

CLS-1

**LANDSCAPE RENOVATION
THE HOMESTEAD AT SIGNAL BUTTE
SWC OF RUBIDIUM AVE. AND SIGNAL BUTTE RD. - MESA, AZ**



EXPIRES 06 / 30 / 2028

LANDSCAPE RENOVATION THE HOMESTEAD AT SIGNAL BUTTE
 SWC OF RUBIDIUM AVE. AND SIGNAL BUTTE RD. - MESA, AZ

CONCEPTUAL LANDSCAPE PLAN

DESIGNED BY:	PV/SH
DRAWN BY:	PV/SH
CHECKED BY:	PV/MD
DATE:	08/29/2025
REVISIONS:	CITY COMMENTS 09/22/2025
	SITE PLAN REVISION 11/17/2025
	SITE PLAN REVISION 12/19/2025
	CITY COMMENTS 02/18/2026
	CITY COMMENTS 04/13/2026
	CITY COMMENTS 05/04/2026

THE HOMESTEAD AT SIGNAL BUTTE

CLS-2

PLANT SCHEDULE

BOTANICAL NAME	COMMON NAME	SIZE	QTY	COMMENTS
TREES				
Acacia aneura	Mulga Acacia	24" Box (1" Cal.)	73	Std Trunk, Dense Canopy, Mature Coverage - 180 SF
Acacia willardiana	Palo Blanco	24" Box (1.5" Cal.)	15	Std Trunk, Dense Canopy, Mature Coverage - 80 SF
Caesalpinia pulcherrima	Mexican Bird of Paradise	24" Box (1.5" Cal.)	42	Multi-Trunk, Dense Canopy, Mature Coverage - 60 SF
Chilopsis linearis 'Art's Seedless'	Desert Willow Seedless	24" Box (1.5" Cal.)	16	Multi-Trunk, Dense Canopy, Mature Coverage - 225 SF
Chitalpa tashkentensis	Chitalpa	36" Box (2.5" Cal.)	14	Multi-Trunk, Dense Canopy, Mature Coverage - 225 SF
Parkinsonia hybrid 'Desert Museum'	Desert Museum Palo Verde	24" Box (1.75" Cal.)	22	Multi-Trunk, Dense Canopy, Mature Coverage - 225 SF
Phoenix dactylifera	Date Palm	18" CTH	19	Matching Form, Diamond Cut, Mature Coverage - 100 SF
Pinus halepensis	Aleppo Pine	24" Box (1.5" Cal.)	12	Std Trunk, Dense Canopy, Mature Coverage - 225 SF
Prosopis x Phoenix	Thornless Grafted Mesquite	36" Box (2.5" Cal.)	12	Multi-Trunk, Dense Canopy, Mature Coverage - 225 SF
Pistacia x 'Red Push'	Red Push Pistache	38" Box (2.5" Cal.)	45	Std Trunk, Dense Canopy, Mature Coverage - 225 SF
Quercus virginiana 'Heritage'	Southern Live Oak	24"/38" Box (1/2" Cal.)	85	Std Trunk, Dense Canopy, Mature Coverage - 225 SF
ACCENTS/VINES				
Aloe barbadensis	Medicinal Aloe	5-Gal	198	As Per Plan
Asclepias subulata	Desert Milkweed	5-Gal	27	As Per Plan
Dasyliion wheeleri	Desert Spoon	5-Gal	121	As Per Plan
Hesperaloe funifera	Giant Hesperaloe	15-Gal	7	As Per Plan
Hesperaloe parviflora	Brakelights Hesperaloe	5-Gal	72	As Per Plan
Muhlenbergia rigida 'Nashville'	Nashville Grass	5-Gal	311	As Per Plan
Opuntia santarita	Prickly Pear	15-Gal	42	As Per Plan
SHRUBS				
Dodonaea viscosa 'Purpurea'	Purple Hopseed Bush	5 Gal.	93	As Per Plan
Calliandra x 'Maricopa Red'	Sierra Starr Fairy Duster	5 Gal.	29	As Per Plan
Eremophila glabra	Winter Blaze	5 Gal.	81	As Per Plan
Eremophila hydropnana	Blue Bells	5 Gal.	179	As Per Plan
Ericameria laricifolia	Turpentine Bush	5 Gal.	56	As Per Plan
Leucophyllum langmaniae 'Rio Bravo'	Rio Bravo Sage	5 Gal.	144	As Per Plan
Justicia californica	Red Chuperosa	5 Gal.	55	As Per Plan
Olea europaea 'Montra'	Little Ollie	5 Gal.	125	As Per Plan
Russelia equisetiformis	Coral Fountain	5 Gal.	101	As Per Plan
Ruellia simplex	Mexican Petunia	5 Gal.	165	As Per Plan
Senna artemisioides	Silver Cassia	5 Gal.	50	As Per Plan
Tecoma hybrid 'Bells of Fire'	Bells of Fire	5 Gal.	149	As Per Plan
Tecoma stans	Arizona Yellow Bells	5 Gal.	46	As Per Plan
GROUND COVERS				
Bougainvillea x 'Yani's Delight'	Yani's Delight Bougainvillea	5 Gal.	77	As Per Plan
Callistemon citrinus 'Little John'	Little John Bottlebrush	1 Gal.	232	As Per Plan
Eremophila glabra 'Mindenev Gold'	Outback Sunrise	1 Gal.	146	As Per Plan
Lantana hybrid 'New Gold'	New Gold Lantana	1 Gal.	384	As Per Plan
Lantana montevidensis	Purple Trailing Lantana	1 Gal.	188	As Per Plan
Rosmarinus officinalis 'Prostrata'	Creeping Rosemary	1 Gal.	246	As Per Plan
MISCELLANEOUS				
DG	Decomposed Granite - Color: Carmel by Rock Pros - Size: 3" minus, 2" depth in all planting areas (typ)	123,215 SF		
TURF	Synthetic Turf - Manuf: ForeverLawn - Type: Fusion Elite or Equal	1,115 SF		
LAWN	Lawn - Hybrid Bermuda Sod	2,410 SF		
	Eastmark Seed Mix - All weight is in Pure Live Seed See Matrix Below - 4,275 SF			
SEED MIX MATRIX				
LBS/Ac.	Botanical Name	Common Name		
1.0	Encelia farinosa	Brittlebush		
3.0	Ambrosia deltoidea	Triangle-leaf Bursage		
2.0	Baileya multiradiata	Desert Marigold		
2.0	Senna covesii	Desert Senna		
3.0	Eschscholzia californica ssp Mexicana	Mexican Gold Poppy		
2.0	Lupinus shockleyi	Desert Lupine		
1.5	Penstemon parryi	Parry Penstemon		
2.0	Anistida purpurea	Purple Three Awn		
1.0	Bouteloua curtipendula	Side Oats Grama		

SHADE TOTAL (TREES ARE COOL)

60,580 SF 60,580 / 511,465 = 11.9% Based on areas provided by City of Mesa, see species specific sizes above in comments column

Plants not on the Phoenix AMA Low Water Use / Drought Tolerant Plants List. Not to be planted in project ROW.
 Approved Plants for use in SRP ROW

COMMUNITY MASTER PLAN - SECTION 12

	REQUIRED	PROVIDED
STREET PERIMETER LANDSCAPE (802' LF / 16,040 SF)		
1 TREES / 50 LF	17	23
1 PLANT / 50 SF	320	322
SURFACE PARKING AREA (34,442 SF PARKING / 14,725 SF LANDSCAPE)		
1 TREE / 2,300 SF PARKING	15	38
1 PLANT / 50 SF LANDSCAPE	295	325

DRIVE THRU LANDSCAPE - ORDINANCE NO. 5813

	REQUIRED	PROVIDED
DRIVE THRU SCREENING/BUFFERING (160' LF)		
1 TREES / 50 LF + 2 TREES / 25LF	17	17
2 SHRUBS / TREE	34	86

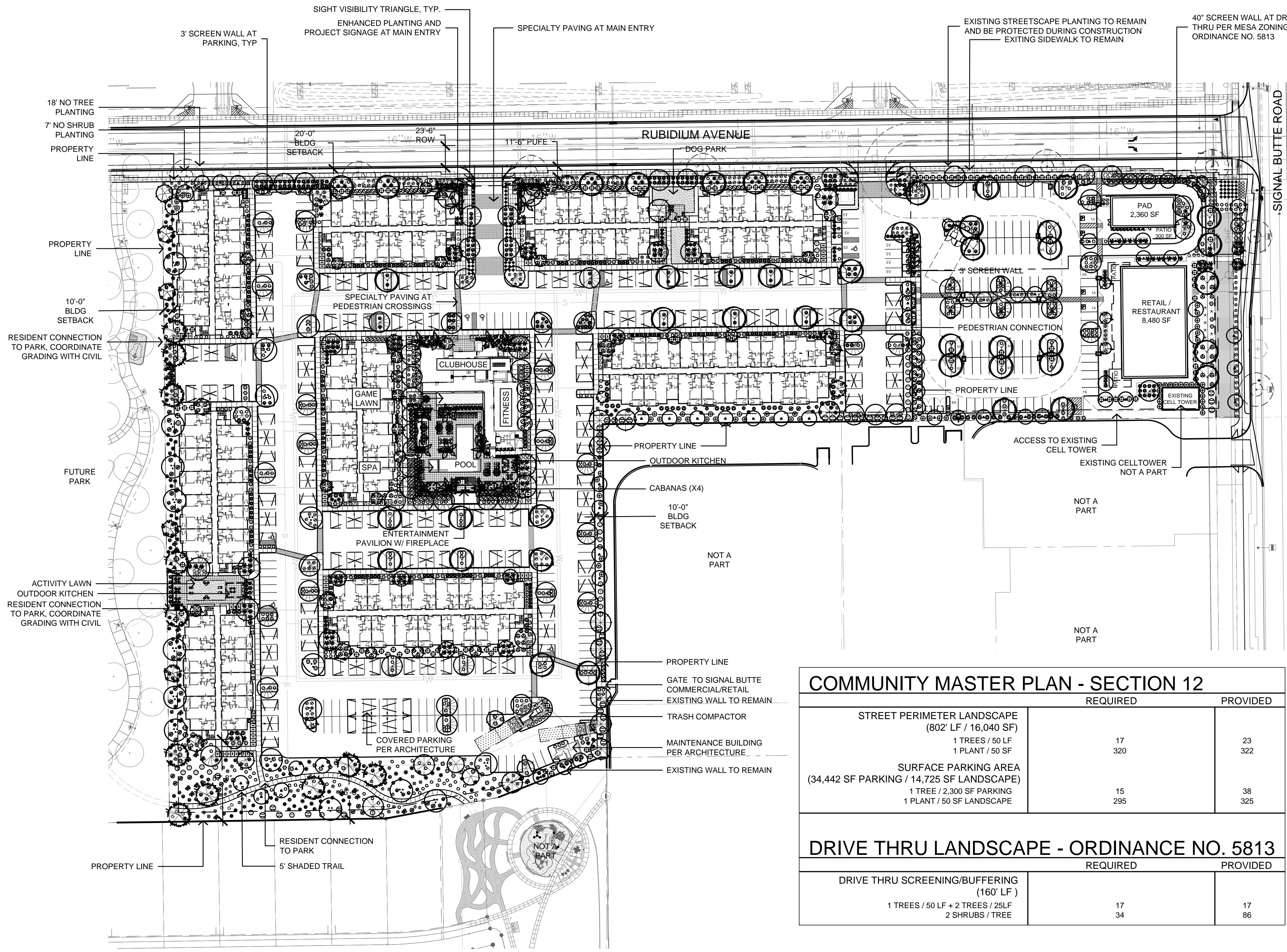

CONCEPTUAL LANDSCAPE PLAN

SCALE: 1"=60'-0"

