

hillman
workshop
landscape architecture
2901 e. highland ave
phoenix, az 85016
480-686-2001

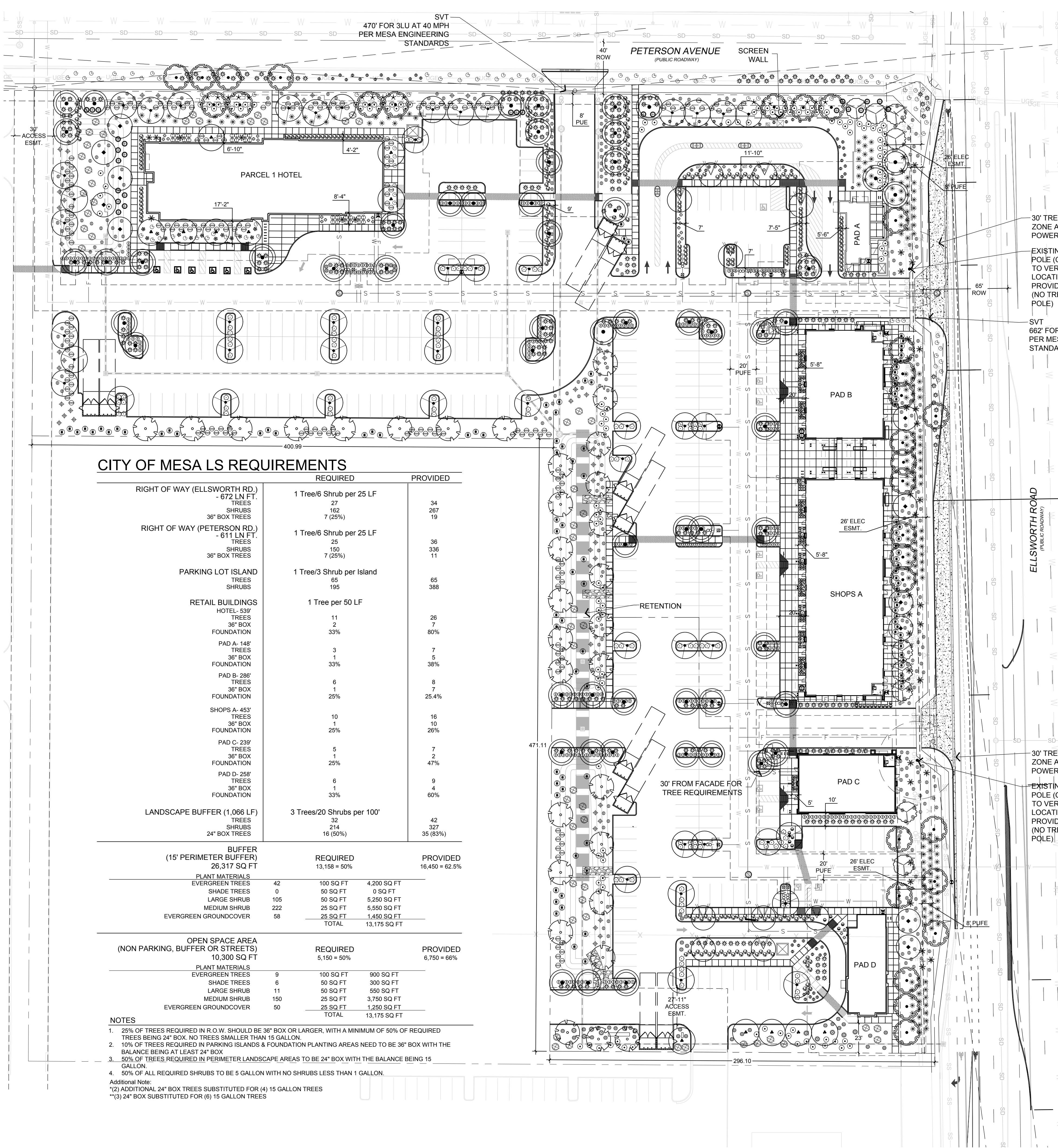

EXPIRES 09/30/25

REVISIONS:

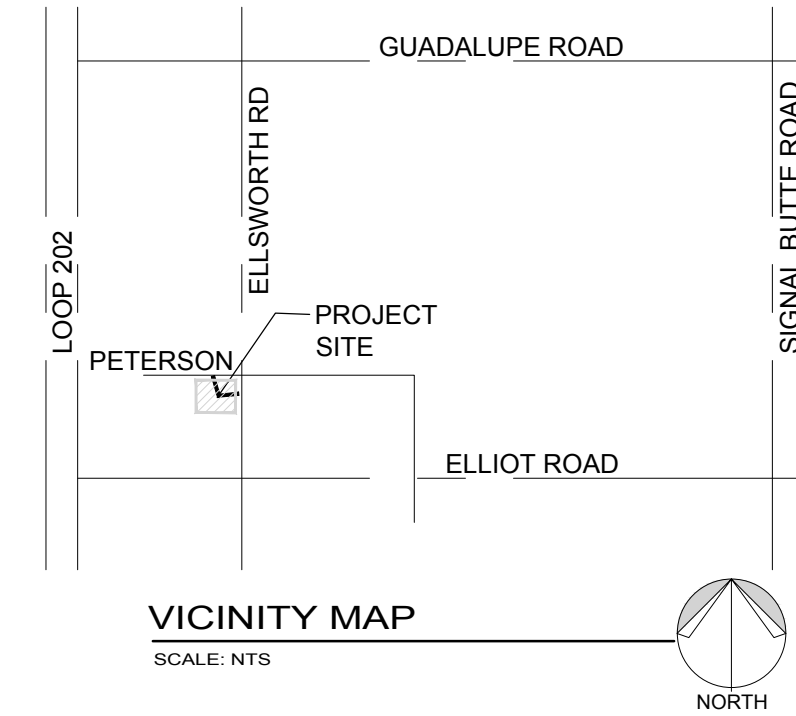

PLANT PALETTE

SYMBOL	BOTANICAL NAME	COMMON NAME	SIZE	QTY	COMMENTS
TREES/PALMS					
●	*Acacia anaura	Mulga	36" Box	32	Standard Trunk Dense Canopy
●	Acacia salicina	Willow Acacia	24" Box	32	Standard Trunk Dense Canopy
●	*Caesalpinia mexicana	Mexican Bird of Paradise	15 Gal	11	Multi-Trunk Dense Canopy
●	Nerium Oleander	Oleander Tree	24" Box	12	Standard Trunk Dense Canopy
●	Pistacia 'Red Push'	'Red Push' Pistache	24" Box	50	Standard Trunk Dense Canopy
●	*Sophora secundiflora	Texas Mountain Laurel	24" Box	11	Multi-Trunk Dense Canopy
●	Quercus virginiana	Southern Live Oak	24" Box	59	Standard Trunk Dense Canopy
●	Ulmus parvifolia	Evergreen Elm	24" Box	10	Standard Trunk Dense Canopy
ACCENTS					
●	Aloe barbadensis	Medicinal Aloe	5-Gal	37	Yellow Flower
●	Aloe 'Blue Elf'	'Blue Elf' Aloe	5-Gal	82	As Per Plan
●	*Chamaerops humilis	Mediterranean Fan Palm	5-Gal	39	Multi-Trunk
●	Bougainvillea 'Torch Glow'	'Torch Glow' Bougainvillea	5-Gal	28	As Per Plan
●	Dasyliroton longissimum	Toothless Spoon	5-Gal	18	As Per Plan
●	Dasyliroton wheeleri	Desert Spoon	5-Gal	11	As Per Plan
●	Hesperaloe funifera	Giant Hesperaloe	5-Gal	57	As Per Plan
●	Hesperaloe p. 'Perpa'	Brakelights Red Yucca	5-Gal	375	As Per Plan
●	*Muhlenbergia 'Nashville'	'Nashville' Grass	5-Gal	190	As Per Plan
●	Pedilanthus macrocarpus	Lady Slipper	5-Gal	14	As Per Plan
●	*Tecoma 'Orange Jubilee'	Orange Jubilee Vine	5-Gal	55	As Per Plan
SHRUBS					
●	Callistemon 'Little John'	'Little John' Bottlebrush	5-Gal	25	As Per Plan
●	*Dodonaea viscosa	Hopseed Bush	5-Gal	108	As Per Plan
●	Eremophila hygrophana	Blue Bells	5-Gal	260	As Per Plan
●	Leucophyllum spp	'Lynns Legacy' Sage	5-Gal	107	As Per Plan
●	Leucophyllum langmaniae	Rio Bravo Sage	5-Gal	136	As Per Plan
●	'Rio Bravo'	Myrtle communis	5-Gal	20	As Per Plan
●	Myrtus communis	'Compacta'	5-Gal	20	As Per Plan
●	Olea europaea	'Little Ollie'	5-Gal	258	As Per Plan
●	Russaelia equisetiformis	Coral Bush	5-Gal	28	As Per Plan
●	Ruellia pensularis	Baja Ruellia	5-Gal	212	As Per Plan
GROUND COVERS					
●	*Eremophila 'Outback Sunrise'	Outback Sunrise	1-Gal	327	As Per Plan
●	*Lantana montevidensis	Purple Lantana	1-Gal	110	As Per Plan
●	*Lantana 'New Gold'	New Gold Lantana	1-Gal	40	As Per Plan
●	Portulacaria afra	Trailing Elephants Food	1-Gal	89	As Per Plan
●	Rosmarinus officinalis	Upright Rosemary	1-Gal	21	As Per Plan
●	'Pyramidalis'				
MISCELLANEOUS					
DG	Decomposed Granite- 1/2" Screened 'Mahogany Brown' by RockPros				
	2" depth in all planting areas				
	* Denotes plants on SRP plant list for use in easement.				

PLANTING NOTES

- CLARIFICATION OF DISCREPANCIES BETWEEN THE CONSTRUCTION DOCUMENTS AND THE SITE SHOULD BE BROUGHT TO THE ATTENTION OF THE LANDSCAPE ARCHITECT.
- ALL PLANT MATERIAL MUST MEET ANA SPECIFICATIONS.
- THE LANDSCAPE ARCHITECT AND/OR OWNER'S REPRESENTATIVE RESERVES THE RIGHT TO REFUSE ANY PLANT MATERIAL HE DEEMS UNACCEPTABLE. ALL PLANT MATERIAL SHALL BE INSPECTED PRIOR TO INSTALLATION.
- PLANTS TO BE LOCATED AWAY FROM OBSTACLES SUCH AS FIRE HYDRANTS, TRANSFORMERS, POWER POLES, AND LIGHT FIXTURES AS NECESSARY. DO NOT INSTALL PLANT MATERIAL IN ANY AREA WHICH WILL CAUSE HARM TO ADJACENT IMPROVEMENTS.
- VERIFY PLANT QUANTITIES PRIOR TO INSTALLATION. QUANTITIES ARE LISTED FOR CONVENIENCE ONLY. THE ACTUAL NUMBER OF SYMBOLS INDICATED ON THE PLANTING PLANS SHALL HAVE PRIORITY OVER QUANTITIES DESIGNATED. NOTIFY THE LANDSCAPE ARCHITECT OF QUANTITY DISCREPANCIES IMMEDIATELY.
- PLANT TREES, SHRUBS, AND CACTI PLUMB, AND FACED TO GIVE THE BEST APPEARANCE OR RELATIONSHIP TO ADJACENT PLANTS OR VIEWS.
- NOTIFY OWNER AND LANDSCAPE ARCHITECT IMMEDIATELY SHOULD SOIL CONDITIONS BE PRESENT WHICH WOULD PREVENT PROPER SOIL DRAINAGE AND ALLOW WATER TO STAND IN PLANTING PITS.
- DOUBLE STAKE ALL TREES OUTSIDE ROOTBALL, EXCEPT FOR SALVAGED TREES.
- LANDSCAPE CONTRACTOR TO PERFORM A SOILS TEST PRIOR TO LANDSCAPE CONSTRUCTION TO DETERMINE ANY NUTRIENT DEFICIENCIES. IF ANY DEFICIENCIES EXIST, IT SHALL BE THE RESPONSIBILITY OF THE CONTRACTOR TO AMEND THE SOIL ACCORDINGLY.
- SIGNS REQUIRE SEPARATE APPROVALS AND PERMITS.

CITY OF MESA LS REQUIREMENTS

	REQUIRED	PROVIDED	
RIGHT OF WAY (ELLSWORTH RD.) - 672 LN FT.	1 Tree/6 Shrub per 25 LF		
TREES	27	34	
SHRUBS	162	207	
36" BOX TREES	7 (25%)	19	
RIGHT OF WAY (PETERSON RD.) - 611 LN FT.	1 Tree/6 Shrub per 25 LF		
TREES	25	36	
SHRUBS	150	336	
36" BOX TREES	7 (25%)	11	
PARKING LOT ISLAND	1 Tree/3 Shrub per Island		
TREES	65	65	
SHRUBS	195	388	
RETAIL BUILDINGS	1 Tree per 50 LF		
HOTEL: 539'			
TREES	11	26	
36" BOX	2	7	
FOUNDATION	33%	80%	
PAD A: 148'			
TREES	3	7	
36" BOX	1	5	
FOUNDATION	33%	38%	
PAD B: 286'			
TREES	6	8	
36" BOX	1	7	
FOUNDATION	25%	25.4%	
SHOPS A: 453'			
TREES	10	16	
36" BOX	1	10	
FOUNDATION	25%	26%	
PAD C: 239'			
TREES	5	7	
36" BOX	1	2	
FOUNDATION	25%	47%	
PAD D: 258'			
TREES	6	9	
36" BOX	1	4	
FOUNDATION	33%	60%	
LANDSCAPE BUFFER (1,066 LF)	3 Trees/20 Shrubs per 100'		
TREES	32	42	
SHRUBS	214	327	
24" BOX TREES	16 (50%)	35 (83%)	
BUFFER (15' PERIMETER BUFFER) 26,317 SQ FT	REQUIRED 13,158 = 50%	PROVIDED 16,450 = 62.5%	
PLANT MATERIALS			
EVERGREEN TREES	42	100 SQ FT	4,200 SQ FT
SHADE TREES	0	50 SQ FT	0 SQ FT
LARGE SHRUB	105	50 SQ FT	5,250 SQ FT
MEDIUM SHRUB	222	25 SQ FT	5,550 SQ FT
EVERGREEN GROUNDCOVER	58	25 SQ FT	1,450 SQ FT
TOTAL			13,175 SQ FT
OPEN SPACE AREA (NON PARKING, BUFFER OR STREETS) 10,300 SQ FT	REQUIRED 5,150 = 50%	PROVIDED 6,750 = 66%	
PLANT MATERIALS			
EVERGREEN TREES	9	100 SQ FT	900 SQ FT
SHADE TREES	6	50 SQ FT	300 SQ FT
LARGE SHRUB	11	50 SQ FT	550 SQ FT
MEDIUM SHRUB	150	25 SQ FT	3,750 SQ FT
EVERGREEN GROUNDCOVER	50	25 SQ FT	1,250 SQ FT
TOTAL			13,175 SQ FT

- NOTES**
- 25% OF TREES REQUIRED IN R.O.W. SHOULD BE 36" BOX OR LARGER, WITH A MINIMUM OF 50% OF REQUIRED TREES BEING 24" BOX. NO TREES SMALLER THAN 15 GALLON.
 - 10% OF TREES REQUIRED IN PARKING ISLANDS & FOUNDATION PLANTING AREAS NEED TO BE 36" BOX WITH THE BALANCE BEING AT LEAST 24" BOX.
 - 50% OF TREES REQUIRED IN PERIMETER LANDSCAPE AREAS TO BE 24" BOX WITH THE BALANCE BEING 15 GALLON.
 - 90% OF ALL REQUIRED SHRUBS TO BE 5 GALLON WITH NO SHRUBS LESS THAN 1 GALLON.
- Additional Note:
 *(2) ADDITIONAL 24" BOX TREES SUBSTITUTED FOR (4) 15 GALLON TREES
 *(3) 24" BOX SUBSTITUTED FOR (6) 15 GALLON TREES

PLANTING PLAN

SCALE: 1"=40'-0"

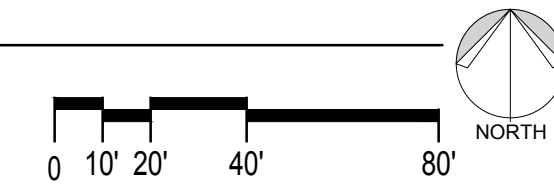

Peterson & Ellsworth
SWC of Peterson Ave & Ellsworth Road, Mesa, Arizona

DATE: 03.13.24

Planting Plan

L-1

1 of 1

