

APN: 304-62-146  
 ZONING: LI

APN: 304-62-943  
 ZONING: LI

APN: 304-62-144  
 ZONING: LI

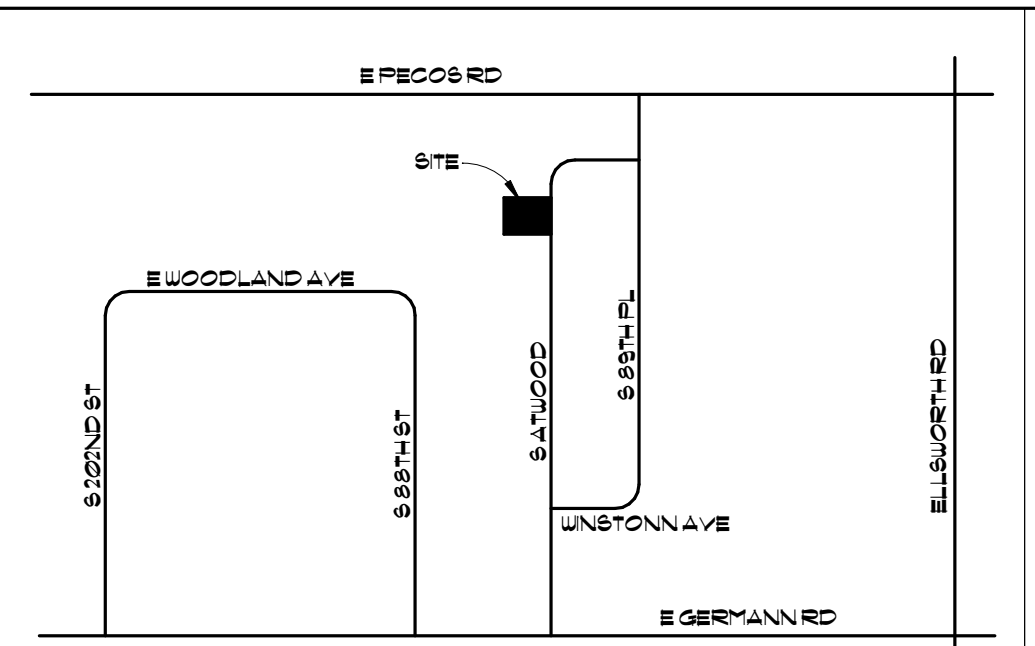

VICINITY MAP  
 N.T.S.

**SITE INFORMATION**

OWNER:  
 GLEN SCOTT LLC

SITE ADDRESS:  
 1262 S. ATWOOD  
 MESA, AZ 85212

APN:  
 304-62-146

ZONING:  
 LI

LOT:  
 2

NET LOT AREA:  
 34,286 SQ.FT. (0.78 ACRES)

GROSS LOT AREA:  
 39,763 SQ.FT. (0.91 ACRES)

LOT COVERAGE:  
 27,178 SQ. FT. (69.8%)

BUILDING HEIGHT:  
 22'-0"

**PROJECT DESCRIPTION**

CONSTRUCTION OF NEW COMMERCIAL WAREHOUSE

**COMMON OPEN SPACE**

425 SQ. FT. PROVIDED AT MAIN ENTRANCE OF BUILDING

300 SQ. FT. OF EMPLOYEE AMENITY SPACE PROVIDED

**PARKING**

9,984 SQ. FT. / 500 SQ. FT. = 19.9 SPACES (REQUIRED)  
 20 SPACES PROVIDED

**SITE PLAN NOTES:**

- 40' CMU SCREEN WALL
- ASPHALT PAVING, SEE GRADING
- DRAINAGE FOR SLOPE AND DRAINAGE
- 6'-0" CMU SCREEN WALL
- VERTICAL CURB
- 10'x20' VISIBILITY TRIANGLE
- EXISTING LIGHT POLE
- EXISTING CURB & GUTTER
- 6' CURB
- BICYCLE PARKING
- BENCH
- REFUGE BN.
- TABLE
- NEW 8'-0" CMU SITE WALL
- TRASH ENCLOSURE PER C.O.M. DETS. M62-01-M-62-042
- COVERED PARKING SPACES

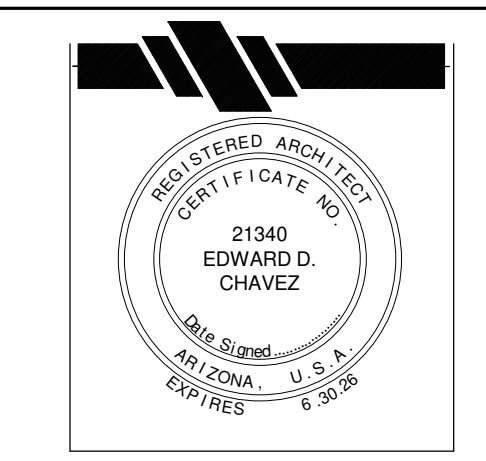

**GLEN SCOTT LLC**  
 1262 S. ATWOOD, MESA, AZ

**(H A V E Z) A I A**

ARCHITECTURE • DEVELOPMENT • COMMERCIAL • RESIDENTIAL • INTERIOR DESIGN

4720 EAST CHOLLA STREET PHOENIX, ARIZONA  
 602.693.9711 / 992.8600 / EMAIL: ECHAVEZ@ECHAVEZ.NET

SINCE 1972

DATE	BY	REVISIONS

JOB NUMBER

SHEET DESCRIPTION  
 SITE PLAN

DATE  
 JANUARY 23, 2025

