



ENLARGED SITE PLAN

SCALE: 1" = 30'0"



KEYNOTES:

- 1 EXISTING CONCRETE DRIVE APRON - SEE CIVIL DRAWINGS
- 2 NEW CONCRETE DRIVE APRON - SEE CIVIL DRAWINGS
- 3 LANDSCAPE AREA - SEE LANDSCAPE DRAWINGS
- 4 LANDSCAPE/RETENTION AREA - SEE CIVIL AND LANDSCAPE DRAWINGS
- 5 CONCRETE CURB AND GUTTER - SEE CIVIL DRAWINGS
- 6 ADA CURB RAMP - SEE CIVIL DRAWINGS
- 7 ADA PARKING SPACE
- 8 ASPHALT PAVING, TYP. - SEE CIVIL DRAWINGS
- 9 CONCRETE SIDEWALK CROSS SLOPE 1:50 MAX. LINE OF TRAVEL SLOPE 1:20 MAX. - SEE CIVIL DRAWINGS
- 10 S.E.S. - SEE ELECTRICAL DRAWINGS
- 11 FIRE VEHICLE ACCESS LANE
- 12 ACCESSIBLE PATH OF TRAVEL
- 13 NEW LIGHT POLE AND LIGHT FIXTURE - SEE ELECTRICAL DRAWINGS
- 14 3'-4" HIGH SITE SCREEN WALL - SEE DETAIL 3/SP1.4
- 15 TRASH ENCLOSURE PER CITY OF MESA STANDARDS W/ CONCRETE SLAB AT ENCLOSURE - SEE CIVIL DRAWINGS & DETAIL 1/SP1.4
- 16 50'-0" REFUSE SERVICES CLEARANCE ZONE PER CITY OF MESA STANDARDS
- 17 MONUMENT SIGN PER OWNER - UNDER SEPARATE PERMIT
- 18 FIRE HYDRANT - SEE CIVIL DRAWINGS
- 19 PROPOSED LOCATION OF TRANSFORMER, PER SRP STANDARDS - SEE ELECTRICAL DRAWINGS
- 20 PAINT FIRE LANE CURBS RED AND PLACE RED REFLECTORS AT 75'-0" O.C. AT FIRE TRUCK ACCESS AISLES WITHOUT CURBS
- 21 CONCRETE CURB - SEE CIVIL DRAWINGS
- 22 TUBE STEEL BICYCLE RACK - SEE DETAIL 5/SP1.4
- 23 3" HIGH DECORATIVE COLORED CONCRETE PEDESTRIAN CROSS WALK PER COM SECTION 11-32-4(G) OF THE MZO - SEE DETAIL 4/SP1.4
- 24 PROPOSED LOCATION OF SHADE CANOPIES

SITE GENERAL NOTES:

- A. ALL WORK DONE IN THE PUBLIC RIGHT OF WAY REQUIRES A SEPARATE PERMIT.
- B. CONTRACTOR SHALL VERIFY LOCATION OF ALL EXISTING UTILITIES PRIOR TO COMMENCING WITH CONSTRUCTION, TYPICAL.
- C. CONTRACTOR SHALL MAINTAIN A SAFE AND CLEAR SITE AT ALL TIMES DURING THE COURSE OF CONSTRUCTION, TYPICAL.
- D. ALL MATERIALS TO BE REMOVED FROM THE SITE SHALL BE DISPOSED OF IN THE PROPER MANNER IN THE APPROPRIATE AREA.
- E. CONTRACTOR SHALL MAINTAIN FIRE LANE ACCESS DURING THE COURSE OF CONSTRUCTION. FIRE LANE ACCESS SHALL MEET REQUIREMENTS PUT FORTH BY THE CITY OF MESA.
- F. THE USE OF ANY PROFANITY, TOBACCO, ALCOHOL OR OTHER DRUGS WILL NOT BE ALLOWED ON THIS SITE. FAILURE TO ADHERE TO THESE RULES SHALL RESULT IN REMOVAL FROM THE PROJECT SITE.
- G. CONTRACTOR SHALL VERIFY ALL SITE CONDITIONS AND DIMENSIONS PRIOR TO BEGINNING CONSTRUCTION, NOTIFY ARCHITECT OF ANY AND ALL DISCREPANCIES IMMEDIATELY.
- H. DEVELOPMENT AND USE OF THIS SITE SHALL CONFORM WITH ALL APPLICABLE CODES, ORDINANCES, AND GUIDELINES.
- I. ALL NEW AND RELOCATED UTILITIES SHALL BE PLACED UNDERGROUND.
- J. COORDINATE NEW LIGHT POLE LOCATIONS WITH ELECTRICAL AND ARCHITECTURAL DRAWINGS.
- K. PROVIDE HORIZONTAL AND VERTICAL CONTROL JOINTS AT ALL FLATWORK TRANSITIONS SHOWN ON PLANS, TYPICAL.
- L. EXPANSION JOINTS IN FLATWORK SHALL BE 20'-0" SPACING, TYPICAL.
- M. SEE CIVIL DRAWINGS FOR ADDITIONAL INFORMATION ON GRADING AND DRAINAGE DESIGN.

architecture - design - management - adm group

2100 WEST 15TH STREET | TEMPE, AZ 85281 | 480.285.3900



SKYBRIDGE ARIZONA AT PHOENIX-MESA GATEWAY AIRPORT - LOT 116B
 6613 SOUTH SOSSAMAN ROAD
 MESA, ARIZONA 85212
 MIXED USE DEVELOPMENT AT 116B



REVISION	DATE	DESCRIPTION

Project Number 7025-116B	Date 8-11-2023	Drawn By GK	Checked By JF/JS
-----------------------------	-------------------	----------------	---------------------

ENLARGED SITE PLAN
SP1.1

© COPYRIGHT 2023 BY ADM GROUP INC. THESE DOCUMENTS IN PRINTED AND ELECTRONIC FORM ARE INSTRUMENTS OF SERVICE FOR USE SOLELY WITH RESPECT TO THIS PROJECT. ADM GROUP INC. RETAINS ALL COMMON LAW, STATUTORY AND OTHER RIGHTS, INCLUDING COPYRIGHTS. NO LICENSE OR RIGHT TO REPRODUCE OR USE THESE DOCUMENTS IS GRANTED OR IMPLIED, EXCEPT WITH THE WRITTEN PERMISSION OF ADM GROUP INC. UNAUTHORIZED REPRODUCTION OR USE IS STRICTLY PROHIBITED, VIOLATES THE COPYRIGHT LAWS OF THE UNITED STATES AND WILL SUBJECT THE VIOLATOR TO LEGAL PROSECUTION.

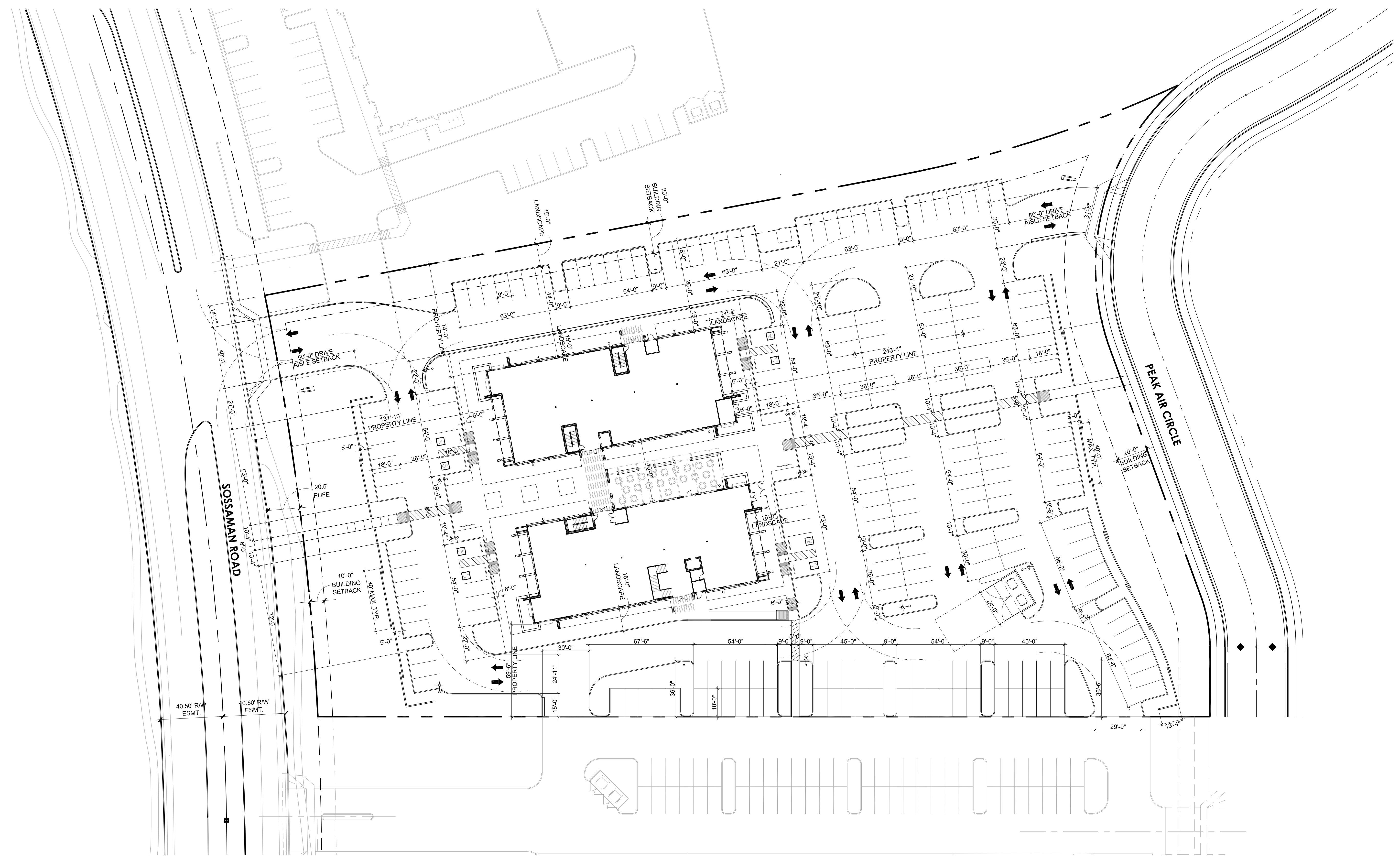

DIMENSIONED SITE PLAN

SCALE: 1" = 30'0"



SITE GENERAL NOTES:

- A. ALL WORK DONE IN THE PUBLIC RIGHT OF WAY REQUIRES A SEPARATE PERMIT.
- B. CONTRACTOR SHALL VERIFY LOCATION OF ALL EXISTING UTILITIES PRIOR TO COMMENCING WITH CONSTRUCTION, TYPICAL.
- C. CONTRACTOR SHALL MAINTAIN A SAFE AND CLEAR SITE AT ALL TIMES DURING THE COURSE OF CONSTRUCTION, TYPICAL.
- D. ALL MATERIALS TO BE REMOVED FROM THE SITE SHALL BE DISPOSED OF IN THE PROPER MANNER IN THE APPROPRIATE AREA.
- E. CONTRACTOR SHALL MAINTAIN FIRE LANE ACCESS DURING THE COURSE OF CONSTRUCTION. FIRE LANE ACCESS SHALL MEET REQUIREMENTS PUT FORTH BY THE CITY OF MESA.
- F. THE USE OF ANY PROFANITY, TOBACCO, ALCOHOL, OR OTHER DRUGS WILL NOT BE ALLOWED ON THIS SITE. FAILURE TO ADHERE TO THESE RULES SHALL RESULT IN REMOVAL FROM THE PROJECT SITE.
- G. CONTRACTOR SHALL VERIFY ALL SITE CONDITIONS AND DIMENSIONS PRIOR TO BEGINNING CONSTRUCTION, NOTIFY ARCHITECT OF ANY AND ALL DISCREPANCIES IMMEDIATELY.
- H. DEVELOPMENT AND USE OF THIS SITE SHALL CONFORM WITH ALL APPLICABLE CODES, ORDINANCES, AND GUIDELINES.
- I. ALL NEW AND RELOCATED UTILITIES SHALL BE PLACED UNDERGROUND.
- J. COORDINATE NEW LIGHT POLE LOCATIONS WITH ELECTRICAL AND ARCHITECTURAL DRAWINGS.
- K. PROVIDE HORIZONTAL AND VERTICAL CONTROL JOINTS AT ALL FLATWORK TRANSITIONS SHOWN ON PLANS, TYPICAL.
- L. EXPANSION JOINTS IN FLATWORK SHALL BE 20'-0" SPACING, TYPICAL.
- M. SEE CIVIL DRAWINGS FOR ADDITIONAL INFORMATION ON GRADING AND DRAINAGE DESIGN.

CONSTRUCTION NOTES:

- A. *COMPLY WITH ALL PROVISIONS AND REQUIREMENTS OF MESA BUILDING CODE (MBC) CHAPTER 33 - SAFEGUARDS DURING CONSTRUCTION, MESA FIRE CODE (MFC), FIRE SAFETY DURING CONSTRUCTION, AND NFPA 241 FOR ITEMS NOT SPECIFICALLY ADDRESSED BY MFC CHAPTER 33.*
 FIRE APPARATUS ROADS ARE ESSENTIAL DURING CONSTRUCTION TO ALLOW EMERGENCY RESPONSE TO THE SITE FOR BOTH FIRE AND MEDICAL EMERGENCIES. ACCESS ROADS SHALL BE IN PLACE PRIOR TO THE START OF VERTICAL CONSTRUCTION. IT IS IMPORTANT TO DEVELOP ACCESS ROADS AT AN EARLY STAGE OF CONSTRUCTION TO ALLOW FOR FIRE DEPARTMENT ACCESS TO THE SITE IN CASE OF FIRE OR INJURY.
- B. *REQUIRED FIRE APPARATUS ACCESS ROAD DURING CONSTRUCTION OR DEMOLITION SHALL COMPLY WITH MESA FIRE AND MEDICAL DEPARTMENT STANDARD DETAIL FPD 3310.1.
 THE ACCESS ROAD SHALL BE A MINIMUM OF 20 FEET WIDE OF ALL-WEATHER DRIVING SURFACE, GRADED TO DRAIN STANDING WATER AND ENGINEERED TO BEAR THE IMPOSED LOADS OF FIRE APPARATUS. (78,000 LBS. / 24,000 LBS. FRONT AXLE, 54,000 LBS. REAR AXLE)
 WHEN ROADS ARE WET, ALL OPEN TRENCHES THAT CROSS AN ACCESS ROAD SHALL HAVE STEEL PLATES CAPABLE OF MAINTAINING THE INTEGRITY OF THE ACCESS ROAD DESIGN. THESE ACCESS ROADS MAY BE TEMPORARY OR PERMANENT. THIS POLICY ONLY APPLIES DURING CONSTRUCTION AND/OR DEMOLITION. PERMANENT ACCESS PER THE SITE SHALL BE IN PLACE PRIOR TO ANY FINAL INSPECTION OR CERTIFICATE OF OCCUPANCY.*
- C. *WATER SUPPLY FOR FIRE PROTECTION. AN APPROVED WATER SUPPLY FOR CONSTRUCTION SITE SHALL MEET THE REQUIREMENTS OF MFC APPENDIX CHAPTERS B AND C. THE MINIMUM FIRE FLOW REQUIREMENT WHEN CONTRACTOR OR DEVELOPER BRINGS COMBUSTIBLE MATERIALS ON SITE IS 1500 GPM AT 20 PSI. AT LEAST ONE FIRE HYDRANT SHALL BE WITHIN 500 FEET OF ANY COMBUSTIBLE MATERIAL AND CAPABLE OF DELIVERING THE MINIMUM FIRE FLOW REQUIREMENT. THIS HYDRANT OR HYDRANTS MAY BE EITHER TEMPORARY OR PERMANENT AS THE PROJECT SCHEDULE PERMITS.
 IN ADDITION, THERE ARE TIMES WHEN HYDRANTS AND VALVES MUST BE CLOSED TEMPORARILY FOR REPAIR WORK OR CONSTRUCTION OF THE WATER SYSTEM. THE DEVELOPER/CONTRACTOR IS RESPONSIBLE FOR ENSURING THAT THE WATER SUPPLY IS ALWAYS AVAILABLE, WHEN THE WORK IS COMPLETE, DEVELOPER/CONTRACTOR SHALL MAKE SURE THAT THE FIRE HYDRANTS ARE ACTIVE, AND THE VALVES ARE OPEN.*

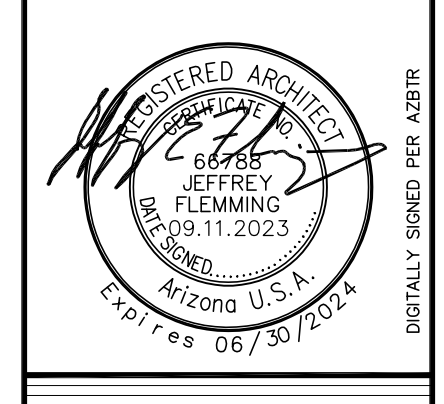

REVISION	DATE	DESCRIPTION

Project Number 7025-116B	Date 8-11-2023	Drawn By CK	Checked By JFJS
-----------------------------	-------------------	----------------	--------------------

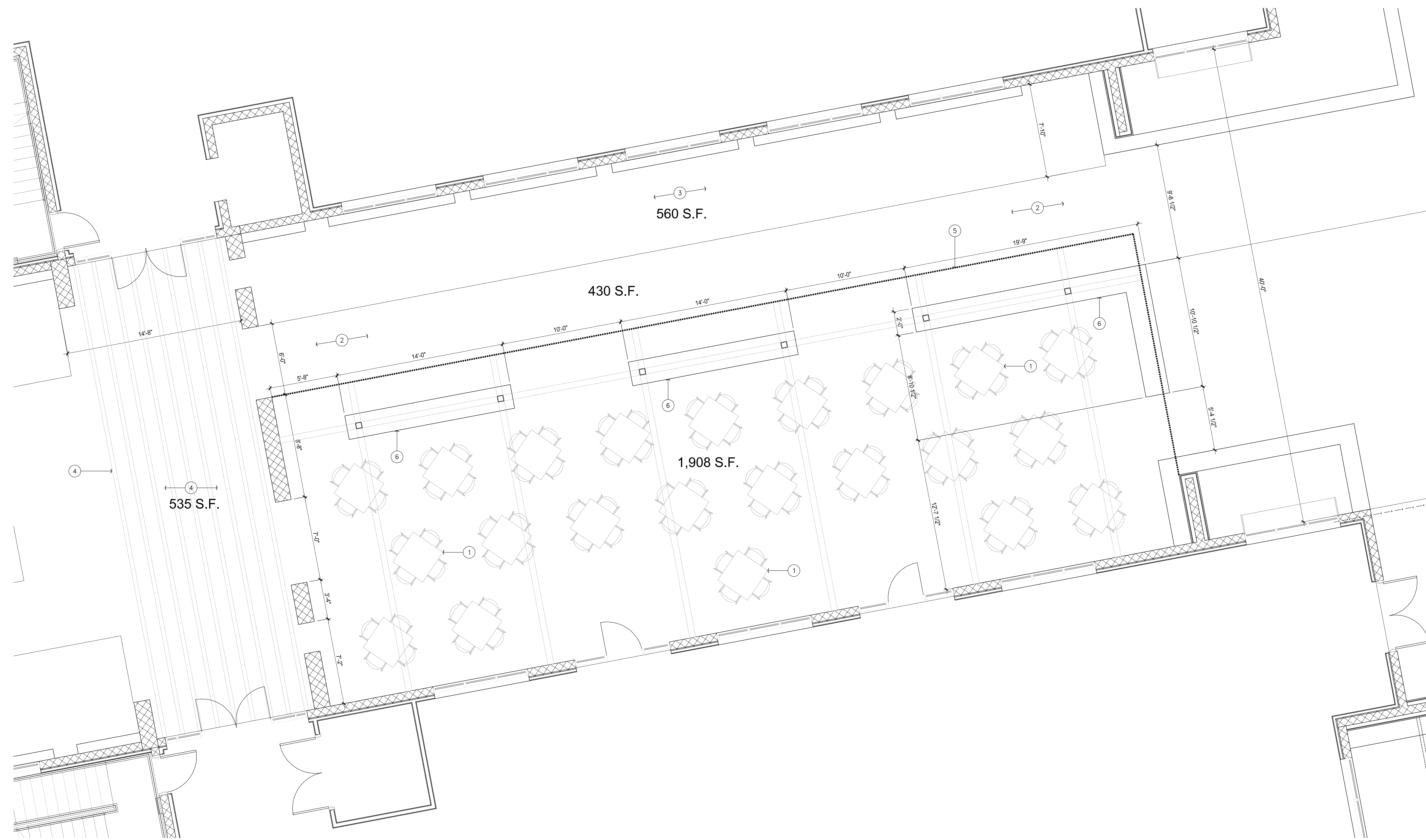

ENLARGED AMENITY OPEN SPACE PLAN

SCALE: 1/4" = 1'-0"



KEYNOTES:

- 1 TABLE AND CHAIRS, TYPICAL
- 2 NEW CONCRETE SIDEWALK - SEE CIVIL DRAWINGS
- 3 LANDSCAPE AREA - SEE LANDSCAPE DRAWINGS
- 4 PAINTED STEEL SHADE STRUCTURE ABOVE - 12'-0" A.F.F.
- 5 FULLY COVERED CANOPY WITH (3) SKYLIGHTS - 12'-0" A.F.F.
- 6 CONCRETE BENCH

SITE GENERAL NOTES:

- A. ALL WORK DONE IN THE PUBLIC RIGHT OF WAY REQUIRES A SEPARATE PERMIT.
- B. CONTRACTOR SHALL VERIFY LOCATION OF ALL EXISTING UTILITIES PRIOR TO COMMENCING WITH CONSTRUCTION, TYPICAL.
- C. CONTRACTOR SHALL MAINTAIN A SAFE AND CLEAR SITE AT ALL TIMES DURING THE COURSE OF CONSTRUCTION, TYPICAL.
- D. ALL MATERIALS TO BE REMOVED FROM THE SITE SHALL BE DISPOSED OF IN THE PROPER MANNER IN THE APPROPRIATE AREA.
- E. CONTRACTOR SHALL MAINTAIN FIRE LANE ACCESS DURING THE COURSE OF CONSTRUCTION. FIRE LANE ACCESS SHALL MEET REQUIREMENTS PUT FORTH BY THE CITY OF MESA.
- F. THE USE OF ANY PROFANITY, TOBACCO, ALCOHOL OR OTHER DRUGS WILL NOT BE ALLOWED ON THIS SITE. FAILURE TO ADHERE TO THESE RULES SHALL RESULT IN REMOVAL FROM THE PROJECT SITE.
- G. CONTRACTOR SHALL VERIFY ALL SITE CONDITIONS AND DIMENSIONS PRIOR TO BEGINNING CONSTRUCTION, NOTIFY ARCHITECT OF ANY AND ALL DISCREPANCIES IMMEDIATELY.
- H. DEVELOPMENT AND USE OF THIS SITE SHALL CONFORM WITH ALL APPLICABLE CODES, ORDINANCES, AND GUIDELINES.
- I. ALL NEW AND RELOCATED UTILITIES SHALL BE PLACED UNDERGROUND.
- J. COORDINATE NEW LIGHT POLE LOCATIONS WITH ELECTRICAL AND ARCHITECTURAL DRAWINGS.
- K. PROVIDE HORIZONTAL AND VERTICAL CONTROL JOINTS AT ALL FLATWORK TRANSITIONS SHOWN ON PLANS, TYPICAL.
- L. EXPANSION JOINTS IN FLATWORK SHALL BE 20'-0" SPACING, TYPICAL.
- M. SEE CIVIL DRAWINGS FOR ADDITIONAL INFORMATION ON GRADING AND DRAINAGE DESIGN.

architecture - design - management.
adm group
 2100 WEST 15TH STREET | TEMPE, AZ 85281 | 480.285.3000



SKYBRIDGE ARIZONA AT PHOENIX-MESA GATEWAY AIRPORT - LOT 116B
 6613 SOUTH SOSSAMAN ROAD
 MESA, ARIZONA 85212
 MIXED USE DEVELOPMENT AT 116B



REVISION	DATE	DESCRIPTION

Project Number 7024-116B	Date 8/11/2023	Drawn By GJK	Checked By JFJUS
-----------------------------	-------------------	-----------------	---------------------

OPEN SPACE PLAN
SP1.3