

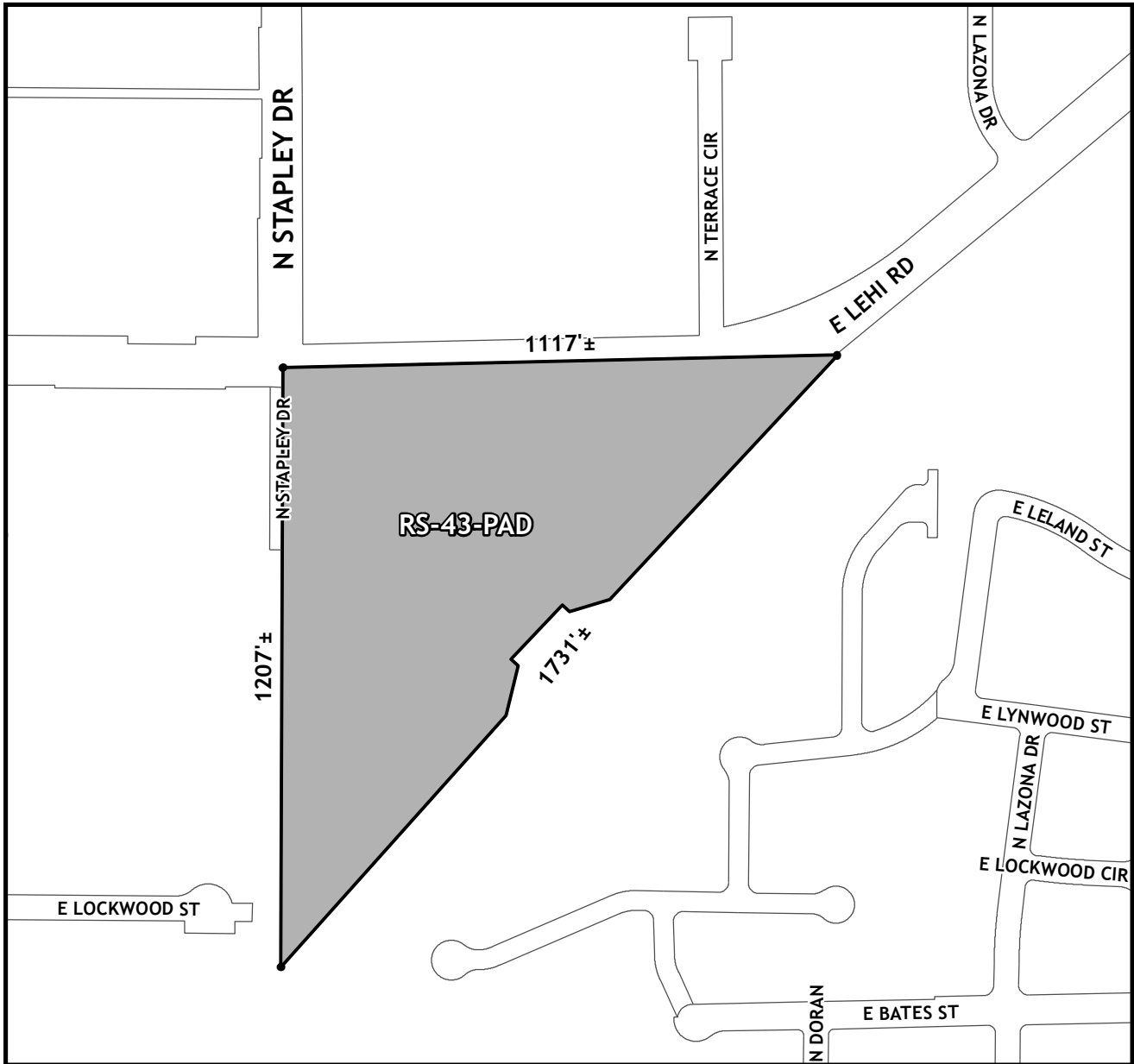

OFFICIAL SUPPLEMENTARY ZONING MAP AMENDING THE CITY OF MESA ZONING MAP



CASE: ZON22-00835
ACREAGE: 15±
REQUEST: Rezone from Single Residence-43 (RS-43) to Single-Residence-43 with a Planned Area Development overlay (RS-43-PAD).

ORDINANCE: 5811

Please be advised that the attached zoning changes were approved by the Mesa City Council on September 18, 2023 by Ordinance # 5811. If you have any questions concerning these changes, contact the City of Mesa Planning Division at 480-644-2385.

_____ ATTEST: _____ DATE: _____
 MAYOR CITY CLERK