

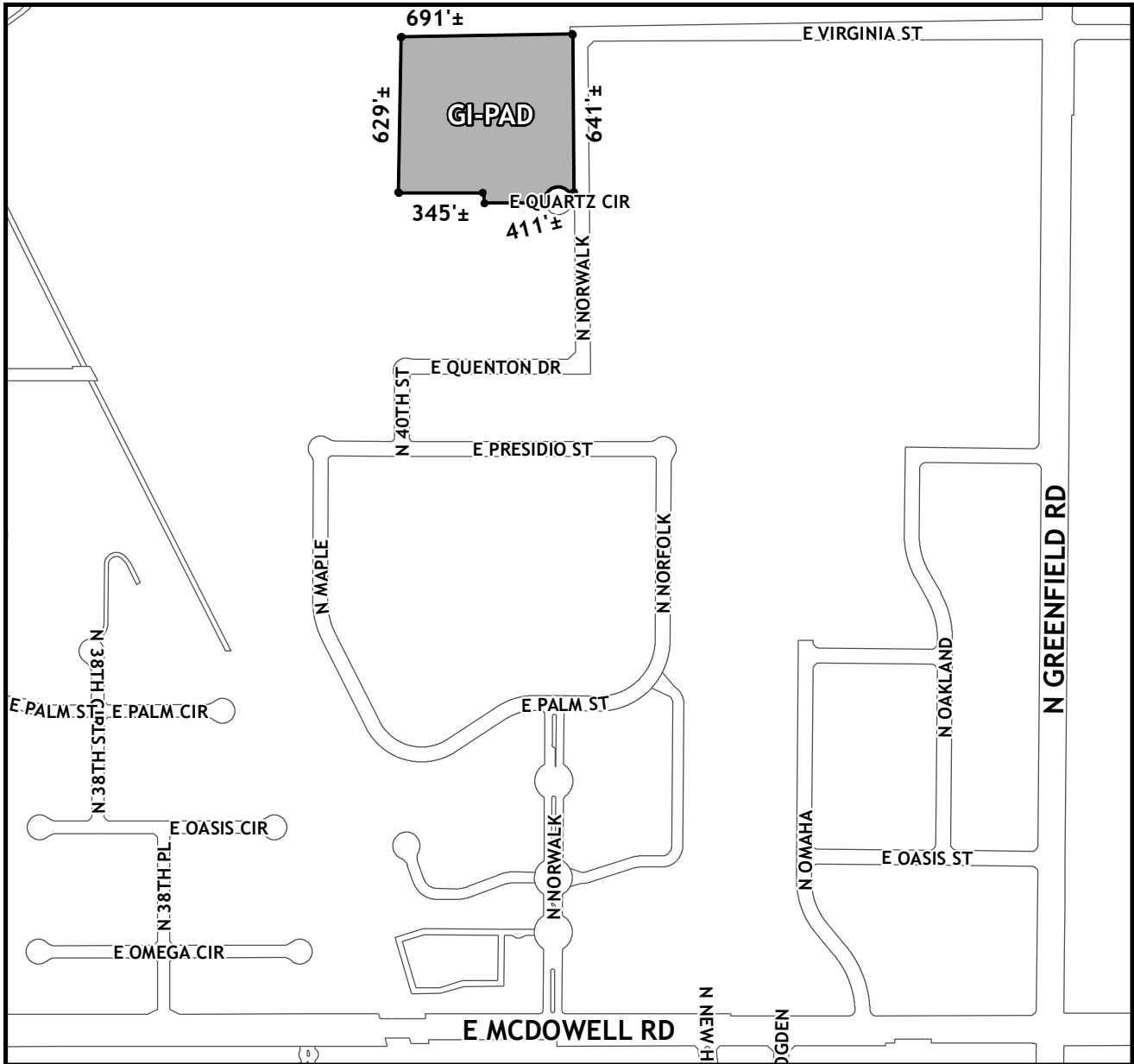

# OFFICIAL SUPPLEMENTARY ZONING MAP AMENDING THE CITY OF MESA ZONING MAP



**CASE: ZON24-00498**  
**ACREAGE: 10.2±**  
**REQUEST: Rezone from General Industrial (GI) and Light Industrial (LI) to General Industrial with a Planned Area Development overlay (GI-PAD) and Major Site Plan Modification.**

**ORDINANCE: 5887**

Please be advised that the attached zoning changes were approved by the Mesa City Council on November 4, 2024 by Ordinance #5887. If you have any questions concerning these changes, contact the City of Mesa Planning Division at 480-644-2385.

\_\_\_\_\_ ATTEST: \_\_\_\_\_ DATE: \_\_\_\_\_  
MAYOR CITY CLERK