

VAL VISTA DRIVE

THOMAS ROAD

SEE SHEET C-00-106 FOR PROFILE 2

EMERGENCY OVERFLOW INLET PER MAG STD DETAIL 538 INLET TYPE H GRATE ELEVATION 1291.5

EXISTING 30" SD PROTECT IN PLACE

SEE SHEET C-00-107 FOR PROFILE 3

MAINTENANCE PATHWAY

RETENTION BASIN  
VOLUME REQUIRED = 0.11 ACRE-FT  
VOLUME PROVIDED = 0.16 ACRE-FT

8 FOOT WIDTH RIPRAP  
D50 = 6 INCHES  
DEPTH = 1 FOOT

0.5 MG TANK

CONCRETE DRIVE

SURGE TANK

IPS PUMP (3)

SWING GATE (TYP)

GRADE BREAK

PROPERTY LINE

SRP XFRM  
STEP-DOWN XFRM

ELECTRICAL BUILDING

STORMWATER CHANNEL

6" VALLEY GUTTER PER MODIFIED MAG STD DETAIL 240

8'H CMU BLOCK WALL

SEE SHEET C-00-106 FOR SEE PROFILE 1

NOTE:  
1. ALL AREAS NOT CALLED OUT FOR MATERIAL ASSUMED AS DECOMPOSED GRANITE PER MAG DETAIL 607-1 AND MAG SPECIFICATION 430.8.

NOT FOR CONSTRUCTION

**BLACK & VEATCH**  
Black & Veatch Corporation  
Phoenix, Arizona

FINAL	CITY OF MESA ENGINEERING DEPARTMENT	
	CENTRAL MESA REUSE PIPELINE-PLANTS INTERMEDIATE PUMP STATION	
NOT FOR CONSTRUCTION OR RECORDING	CIVIL	C-00-102
	SITE GRADING AND DRAINAGE PLAN	
DRAWN BY: DDH ENGINEER: PJO APPROVED BY: PJO	SHEET	CATALOG NUMBER:
ACTIVITY: PROJ. NO.: CP0896	OF	

DATE SAVED: 2/8/24 C:\PW\_WORKING\BW\_AMERICAS\_2\1720644\C-00-102.DWG



DATE SAVED: 2/5/24 C:\PW\_WORKING\B\M\_AMERICAS\_2\01720644\C-00-103 AND 104.DWG

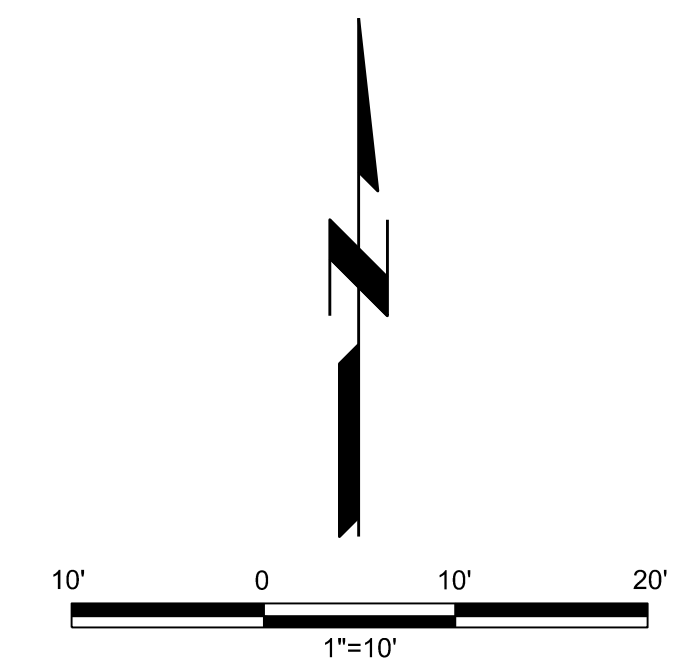
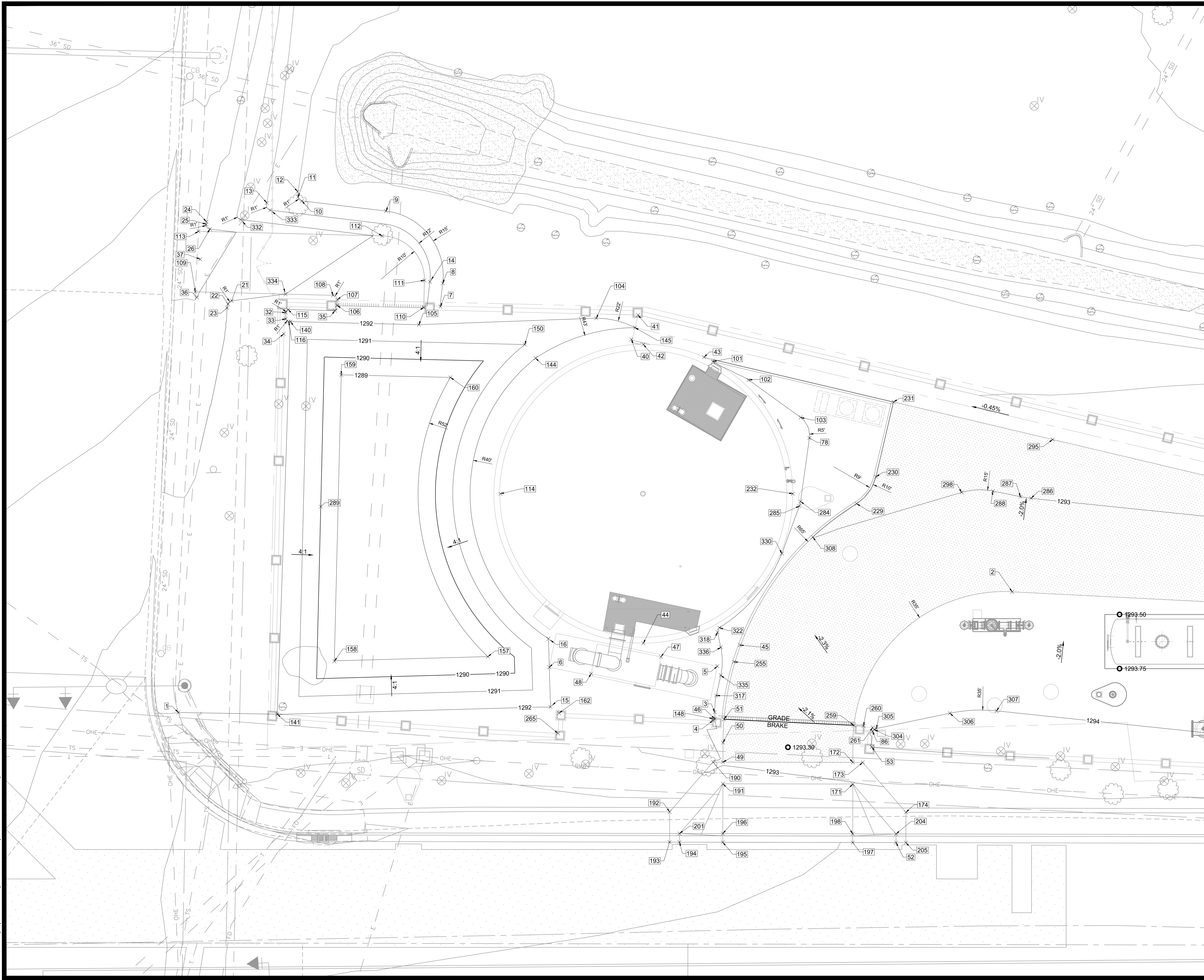

MATCHLINES SEE SHEET C-00-104

NOT FOR CONSTRUCTION

**BLACK & VEATCH**  
 Black & Veatch Corporation  
 Phoenix, Arizona



FINAL  NOT FOR CONSTRUCTION OR RECORDING	CITY OF MESA ENGINEERING DEPARTMENT		C-00-103
	CENTRAL MESA REUSE PIPELINE-PLANTS INTERMEDIATE PUMP STATION		
DRAWN BY: DDH ENGINEER: CA APPROVED BY: PJO	CIVIL SITE ENLARGED GRADING PLAN - 1		CATALOG NUMBER:  SHEET OF
	ACTIVITY: PROJ. NO.: CP0896		



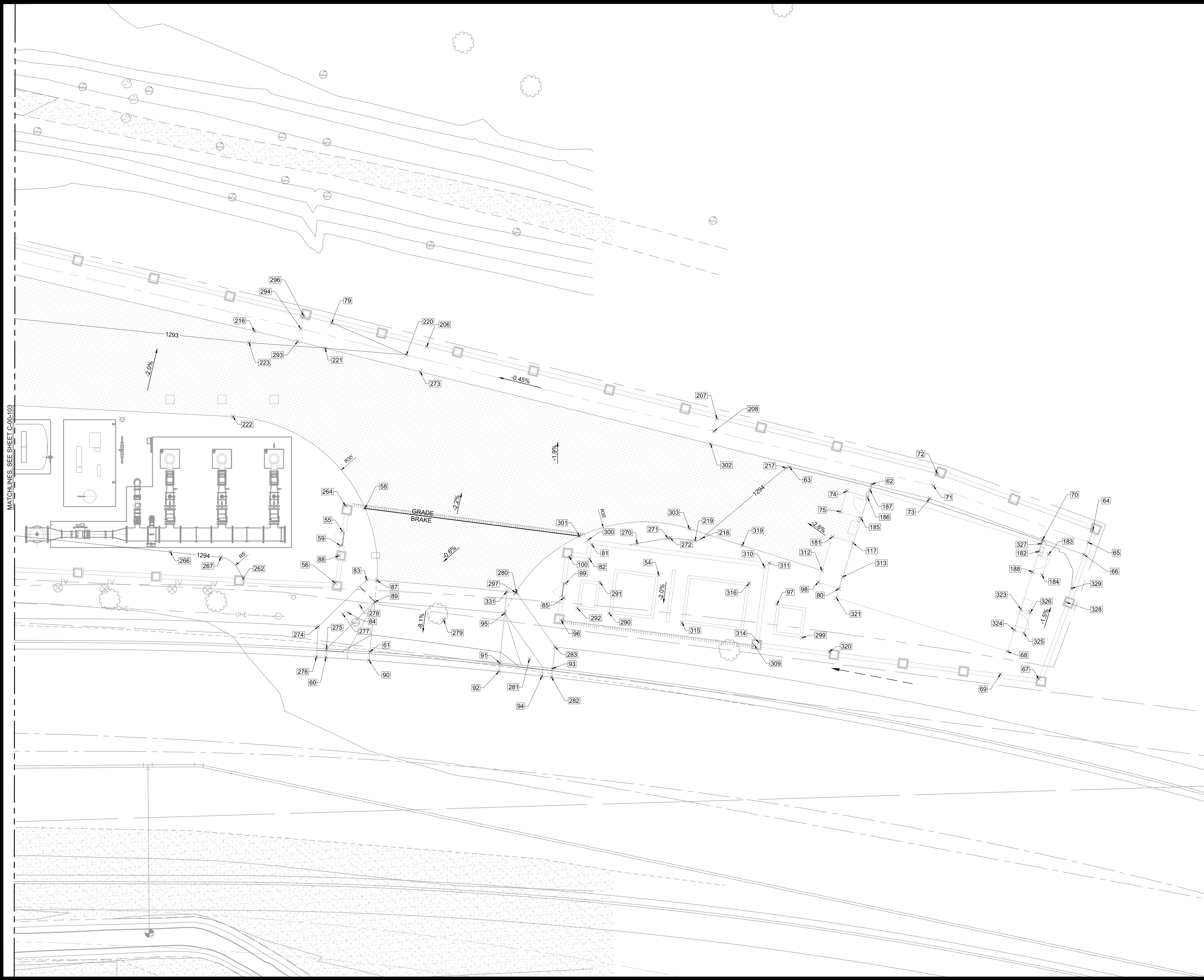
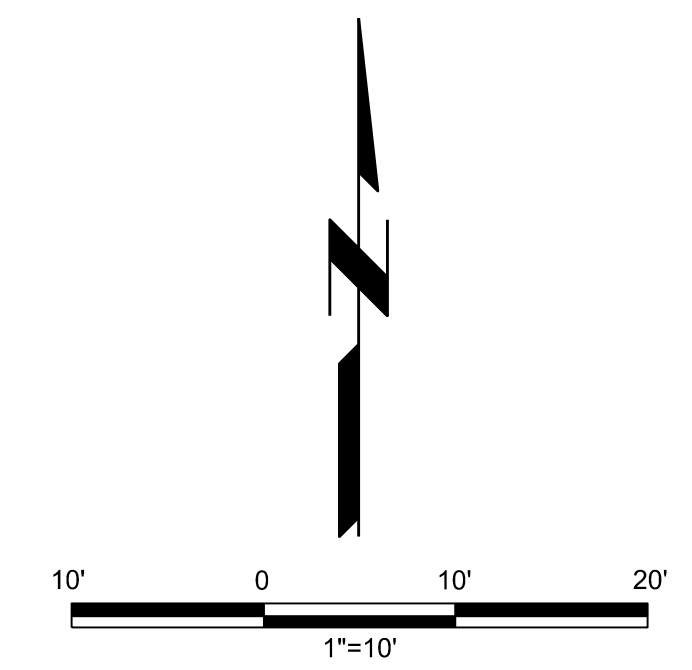

MATCHLINES SEE SHEET C-00-103

DATE SAVED: 2/5/24 C:\PW\_WORKING\B\W\_AMERICAS\_2\01720644\C-00-103 AND 104.DWG

NOT FOR CONSTRUCTION

**BLACK & VEATCH**  
 Black & Veatch Corporation  
 Phoenix, Arizona



FINAL  NOT FOR CONSTRUCTION OR RECORDING	CITY OF MESA ENGINEERING DEPARTMENT	
	CENTRAL MESA REUSE PIPELINE-PLANTS INTERMEDIATE PUMP STATION	
DRAWN BY: DDH ENGINEER: APPROVED BY:	CIVIL	C-00-104
	SITE ENLARGED GRADING PLAN - 2	
ACTIVITY: PROJ. NO.: CP0896	SHEET OF	CATALOG NUMBER:

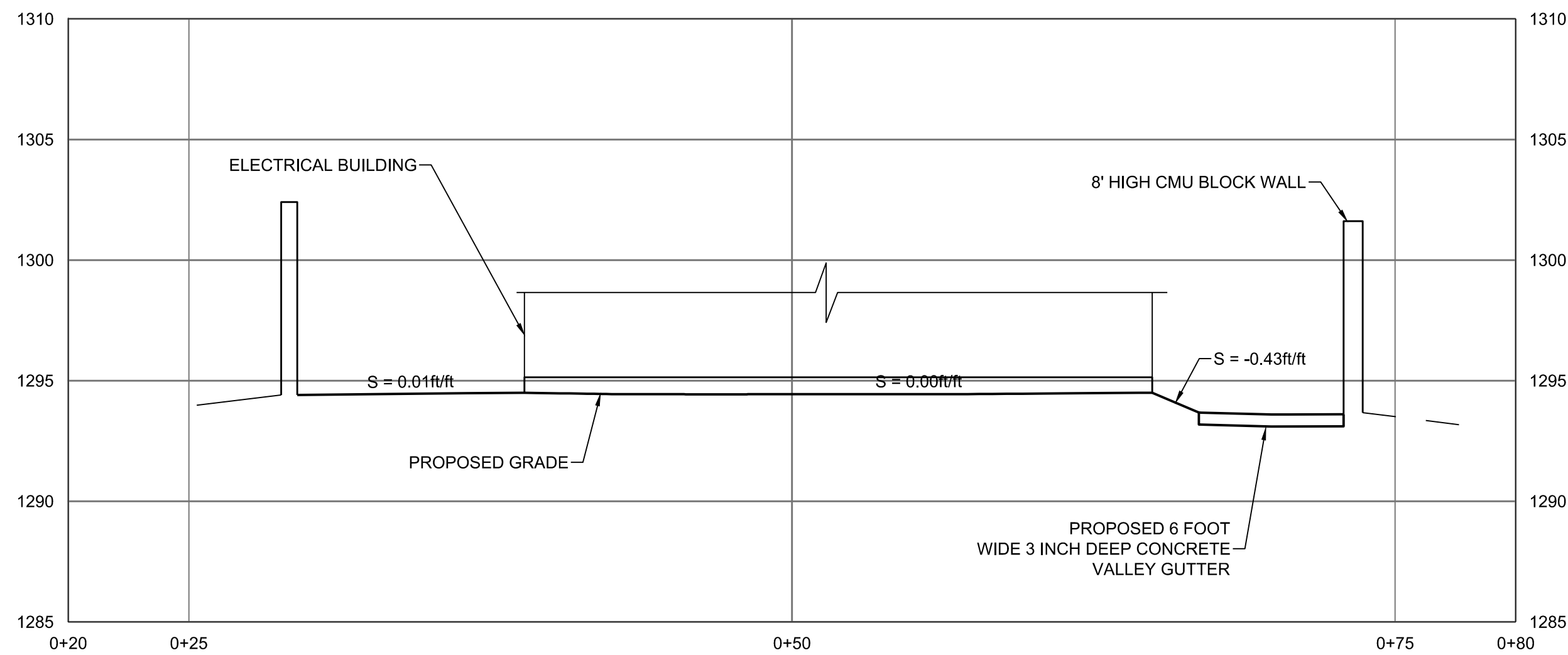

**SECTION - 1**  
SCALE = HOR 1" : 5'  
VER 1" : 1'

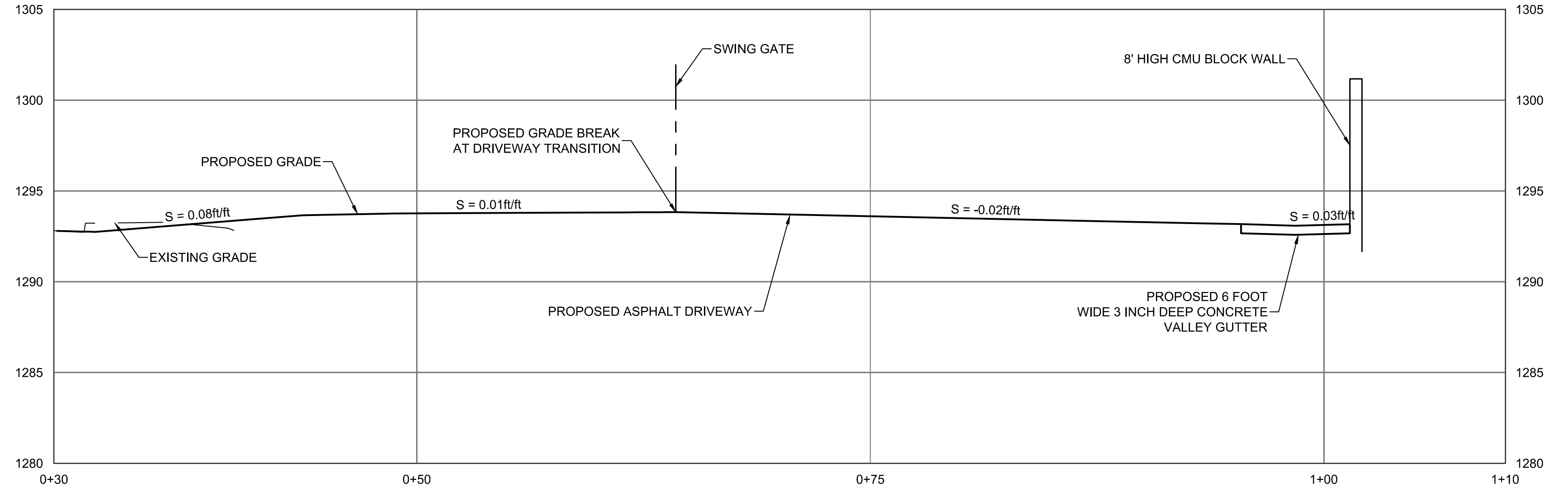

**SECTION - 2**  
SCALE = HOR 1" : 5'  
VER 1" : 1'

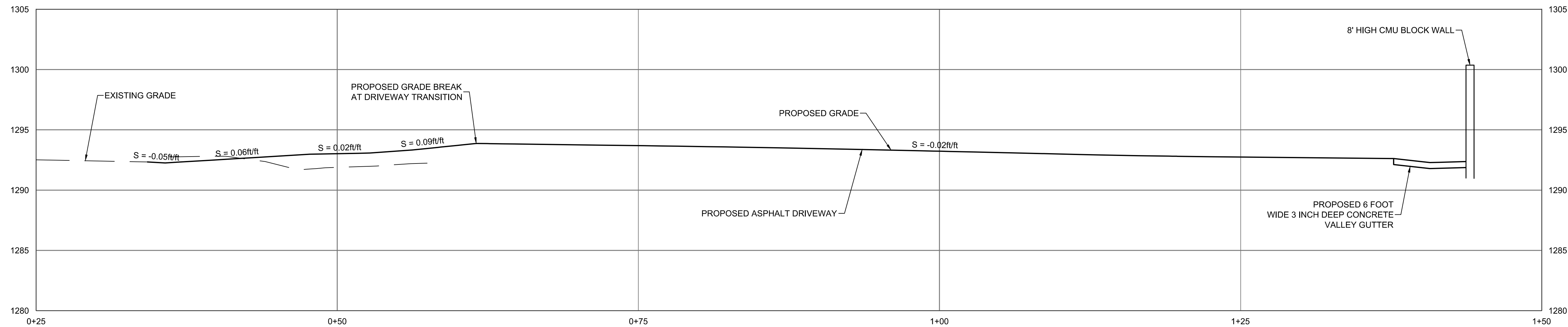

**SECTION - 3**  
SCALE = HOR 1" : 5'  
VER 1" : 1'

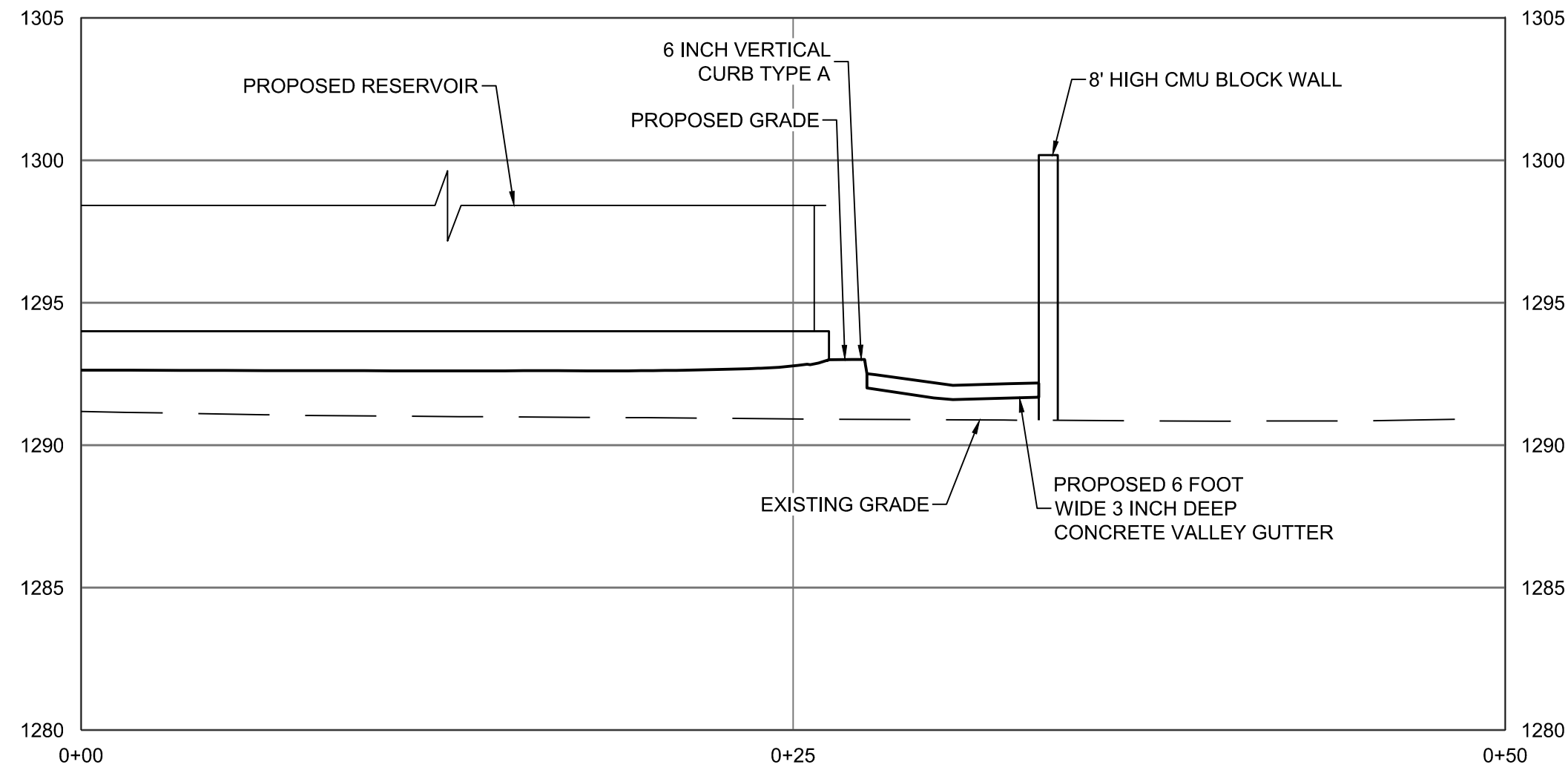

**SECTION - 4**  
SCALE = HOR 1" : 5'  
VER 1" : 1'

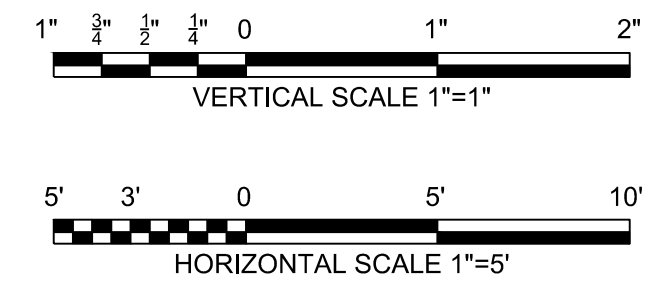

NOT FOR CONSTRUCTION



FINAL	CITY OF MESA ENGINEERING DEPARTMENT	
	CENTRAL MESA REUSE PIPELINE-PLANTS INTERMEDIATE PUMP STATION	
NOT FOR CONSTRUCTION OR RECORDING	CIVIL GRADING SECTIONS	C-00-105
DRAWN BY: DDH ENGINEER: CA APPROVED BY: PJO	SHEET OF	CATALOG NUMBER:
ACTIVITY: PROJ. NO.: CP0896		



DATE SAVED: 2/18/24 C:\PW\_WORKING\B\W\_AMERICAS\_2\1720644\C-00-106 AND 107.DWG

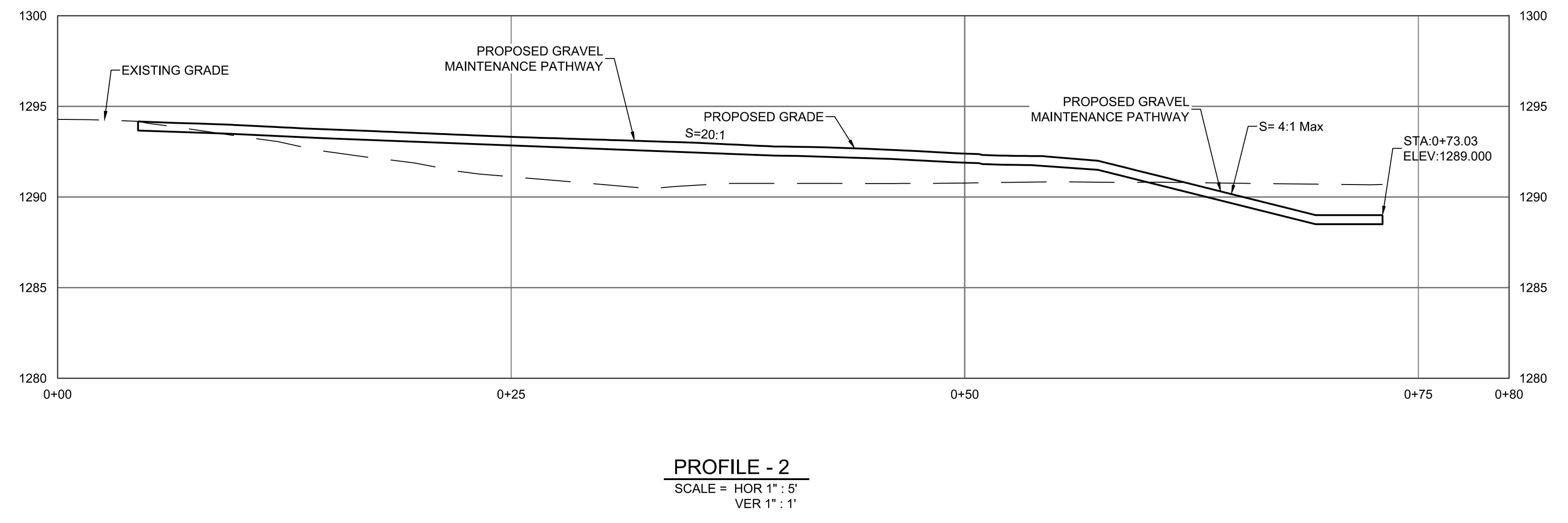
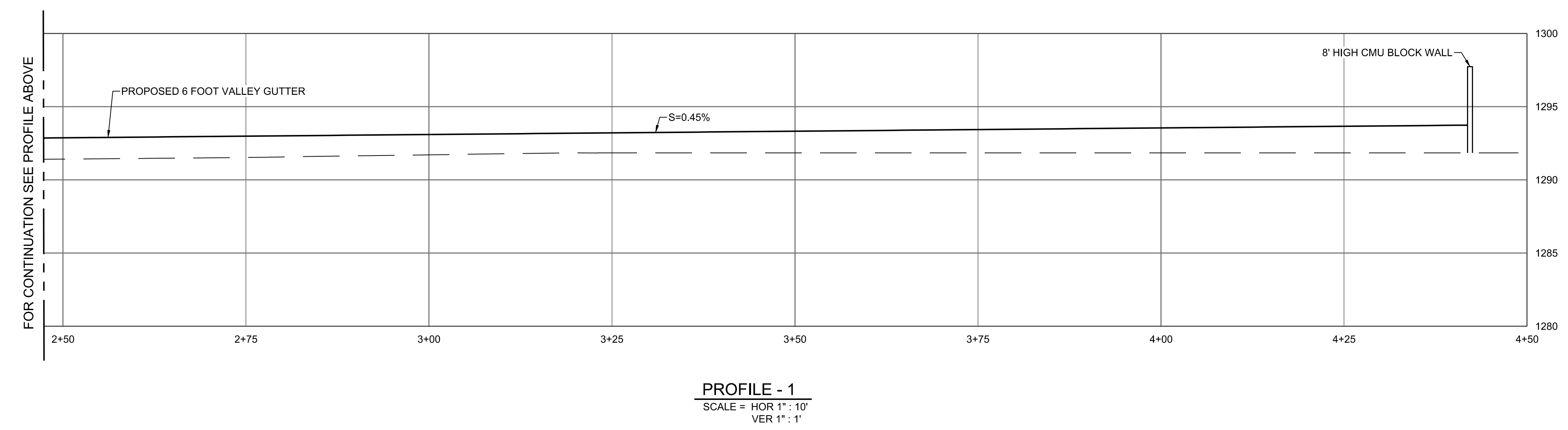
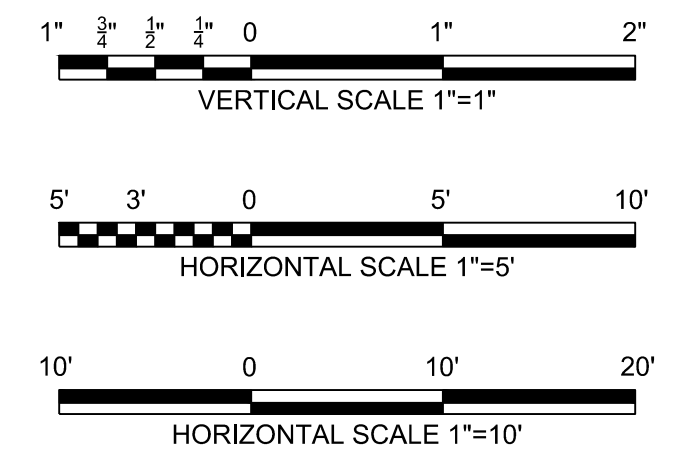
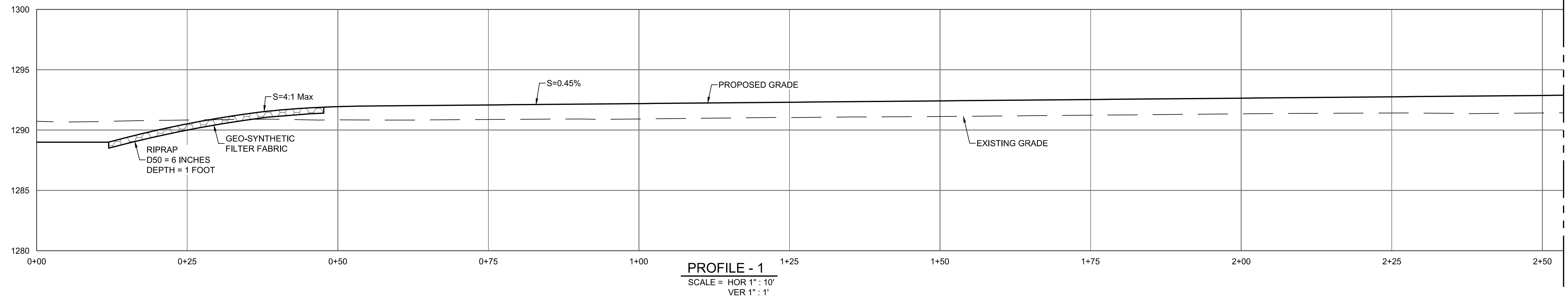

NOT FOR CONSTRUCTION

**BLACK & VEATCH**  
Black & Veatch Corporation  
Phoenix, Arizona

Call at least two full working days before you begin construction.  
**ARIZONA**  
Professional Seal  
Civil Engineer  
No. 12345  
Exp. 12/31/2025  
In Maricopa County (R001245123)

FINAL	CITY OF MESA ENGINEERING DEPARTMENT	
	CENTRAL MESA REUSE PIPELINE-PLANTS INTERMEDIATE PUMP STATION	
NOT FOR CONSTRUCTION OR RECORDING	CIVIL	C-00-106
	GRADING PROFILES 1	
DRAWN BY: DDH ENGINEER: CA APPROVED BY: PJO	SHEET OF	CATALOG NUMBER:
ACTIVITY: PROJ. NO.: CP0896		

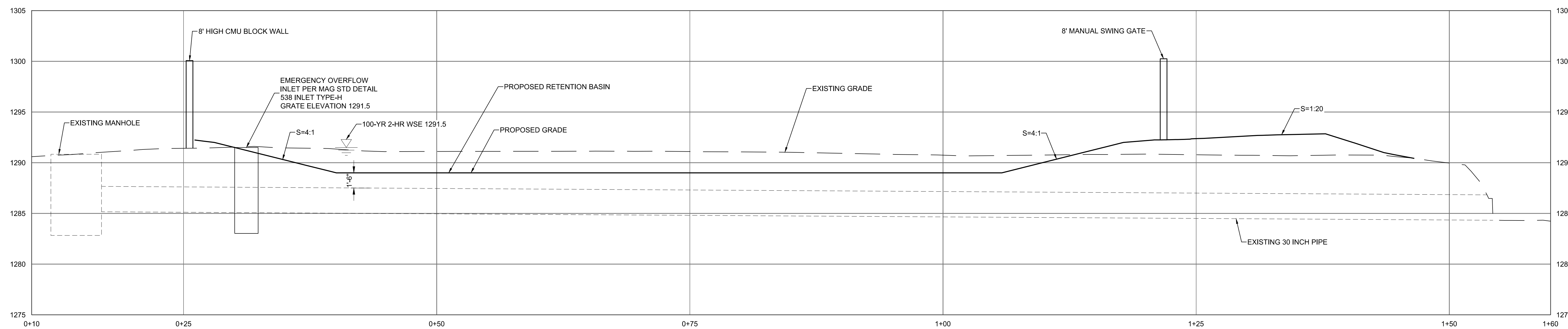
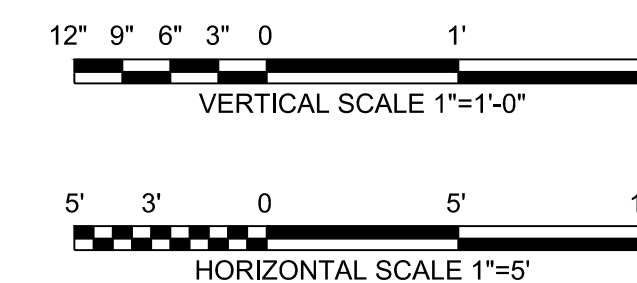

PROFILE - 3  
SCALE = HOR 1" : 5'  
VER 1" : 1'

DATE SAVED: 2/5/24 C:\PW\WORKING\BWW\_AMERICAS\_2\1720644\C-00-106 AND 107.DWG

NOT FOR CONSTRUCTION



FINAL	CITY OF MESA ENGINEERING DEPARTMENT	
	CENTRAL MESA REUSE PIPELINE-PLANTS INTERMEDIATE PUMP STATION	
NOT FOR CONSTRUCTION OR RECORDING	CIVIL	C-00-107
	GRADING PROFILES 2	
DRAWN BY: DDH ENGINEER: APPROVED BY:	SHEET OF	CATALOG NUMBER:
ACTIVITY: PROJ. NO.: CP0896		

**NOTES:**

1. ALL CONCRETE TO BE CLASS 'A' UNLESS OTHERWISE APPROVED (SECTION 725).
2. EITHER A CONSTRUCTION JOINT OR CONTRACTION JOINT IS REQUIRED AT THE STREET CENTERLINE.
3. A SEPARATE CONCRETE PAD IS REQUIRED AT ALL EXPANSION JOINTS AND ALL CONSTRUCTION JOINTS.
4. EXPANSION JOINTS SHALL COMFORM TO SECTION 340.
5. CONTRACTION JOINTS SHALL SEPARATE LARGE AGGREGATE BY MOVING THE AGGREGATE TO EITHER SIDE OF THE JOINT FOR A MINIMUM DEPTH OF 2½ INCHES. THE FINISHED JOINT SHALL HAVE ¼ INCH MAXIMUM RADII AT THE TOP SURFACE AND BE A MINIMUM OF ¾ INCHES OF DEPTH.

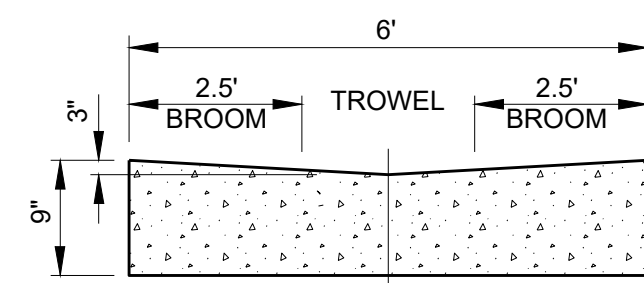

**SECTION A-A  
VALLEY GUTTER**

**MODIFIED MAG STD DETAIL 240  
VALLEY GUTTER**  
NO SCALE

DATE SAVED: 2/9/24 C:\PW\WORKING\B\W\_AMERICAS\_2\01720644\C-00-505.DWG

NOT FOR CONSTRUCTION

**BLACK & VEATCH**  
Black & Veatch Corporation  
Phoenix, Arizona



FINAL	CITY OF MESA ENGINEERING DEPARTMENT	
	CENTRAL MESA REUSE PIPELINE-PLANTS INTERMEDIATE PUMP STATION	
NOT FOR CONSTRUCTION OR RECORDING	CIVIL	C-00-505
	MISCELLANEOUS SITE DETAILS 5	
<small>DRAWN BY: BR ENGINEER: JMW APPROVED BY: PJO</small>	SHEET OF	CATALOG NUMBER:
<small>ACTIVITY: _____ PROJ. NO.: CP0896</small>		