

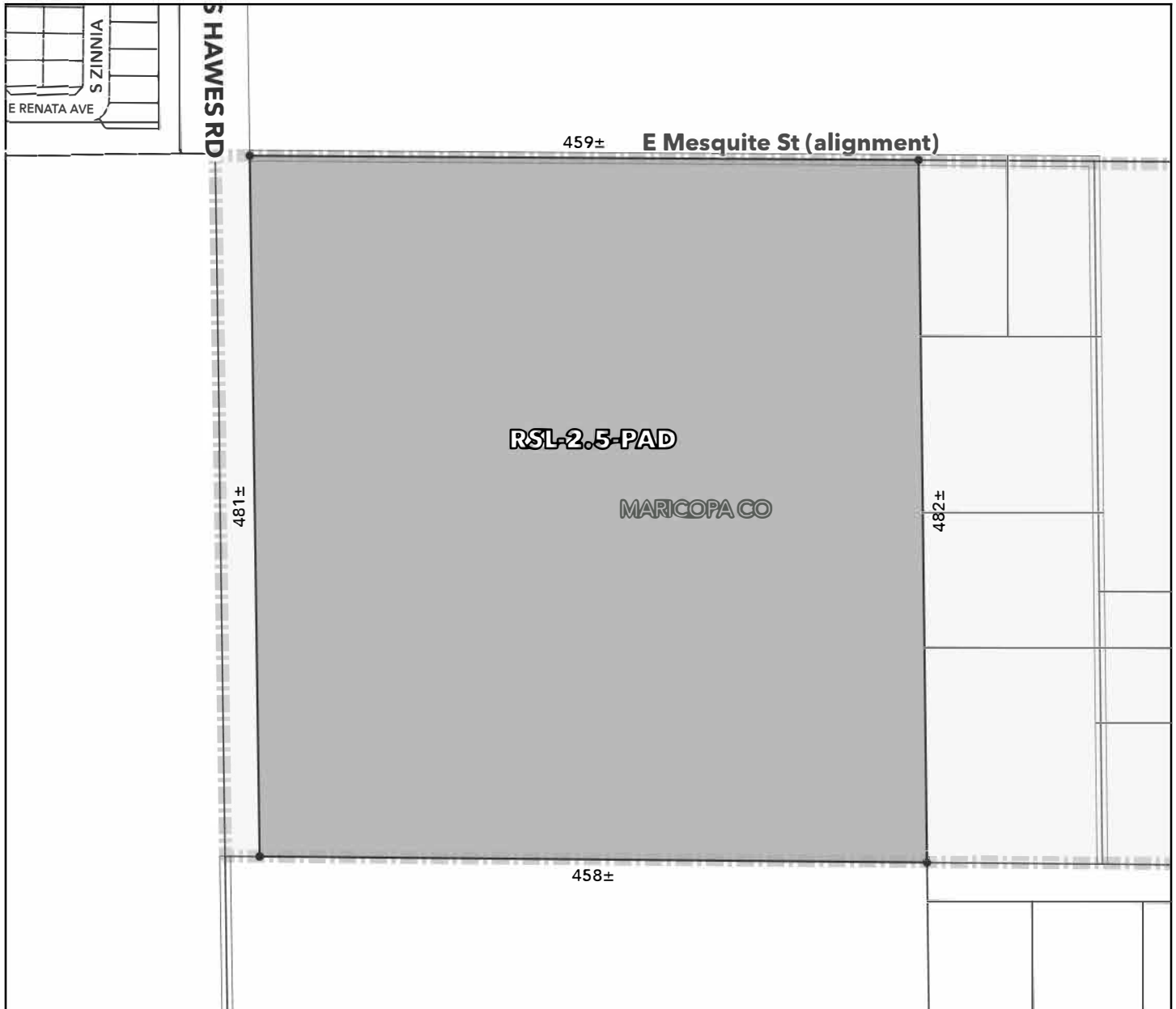

OFFICIAL SUPPLEMENTARY ZONING MAP AMENDING THE CITY OF MESA ZONING MAP



CASE: ZON25-00234

ACREAGE: 38±

REQUEST: Rezoning from Agricultural (AG) to Residential Small-Lot 2.5 with a Planned Area Development overlay (RSL-2.5-PAD) and approval of residential product.

ORDINANCE: 6011

Please be advised that the attached zoning changes were approved by the Mesa City Council on May 4, 2026 by Ordinance #6011. If you have any questions concerning these changes, contact the City of Mesa Planning Division at 480-644-2385.