

Planning and Zoning Vicinity Map: ZON20-00377

Case Details

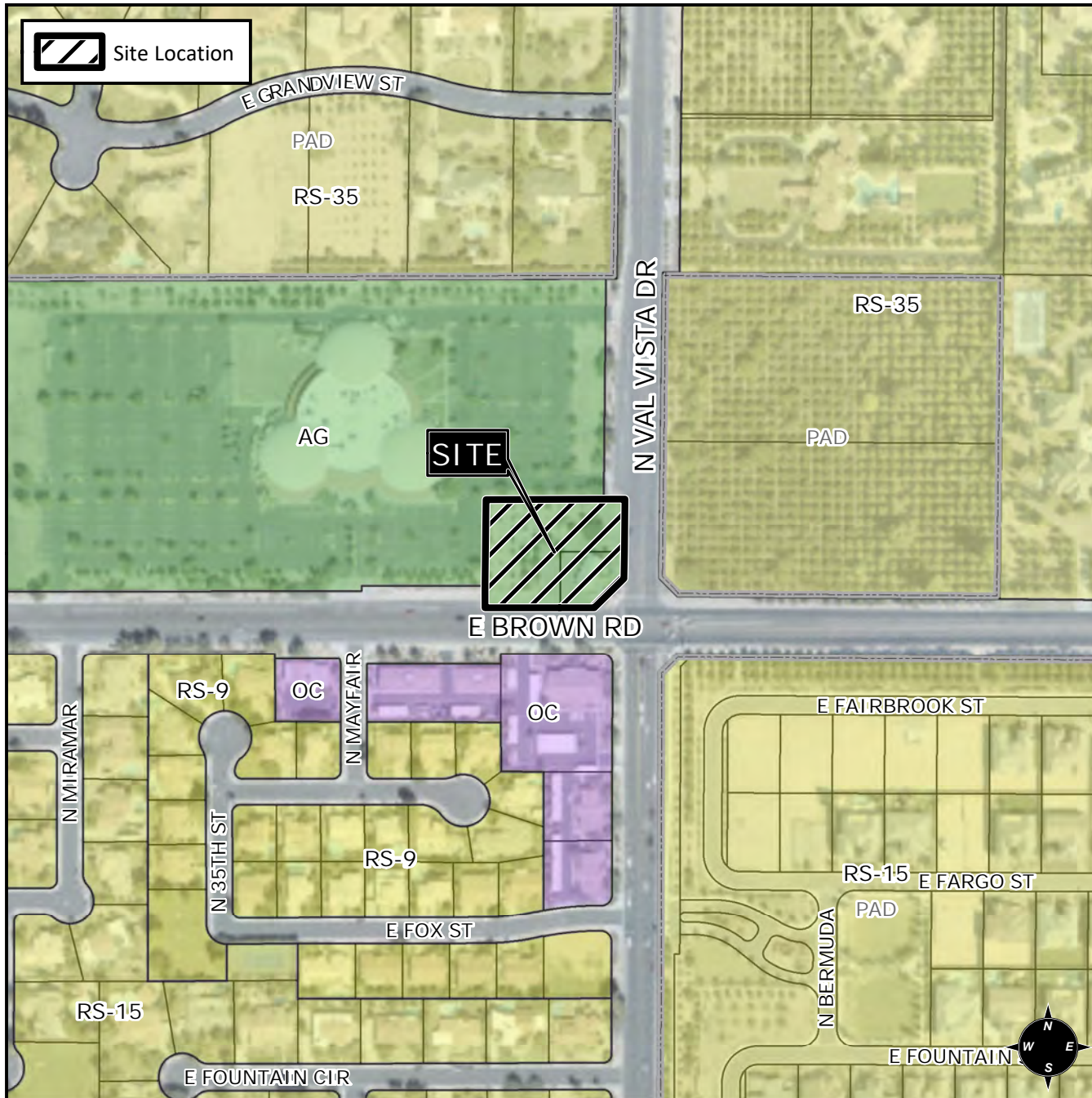

CASE:

PRE-PLAT : ☐

ZON20-00377

SITE / ADDRESS:

District 1. Within the 3500 block of East Brown Road (north side) and the 1200 block of North Val Vista Drive (west side). Located at the northwest corner of Brown Road and Val Vista Drive. (1.2± acres)

REQUEST:

Rezone from AG to OC-BIZ; and Site Plan Review. This request will allow for the development of a medical and professional office building and use.

