

SEE SHEET GD-2

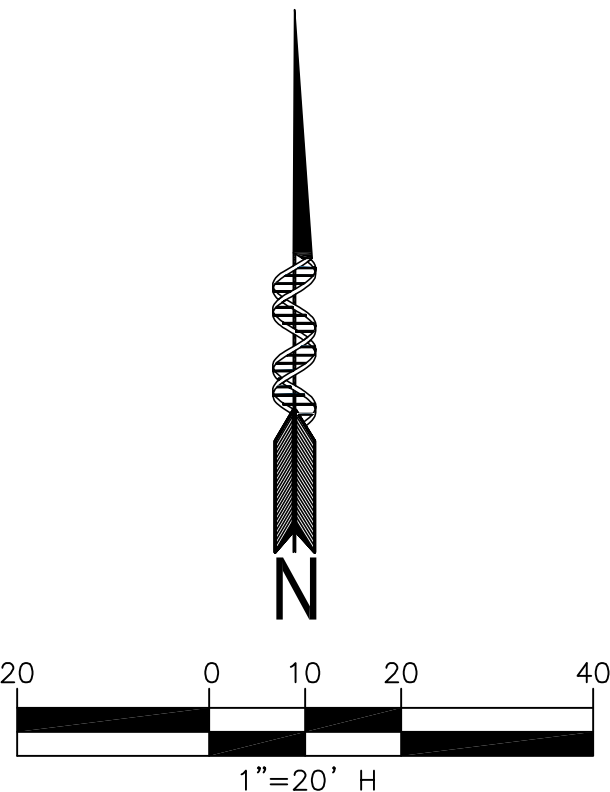

KEYED NOTES

1. EXISTING DRIVE TO REMAIN
2. CONNECT TO EXISTING STORM DRAIN
3. NEW ONSITE STORM DRAIN
4. NEW ONSITE INLET
5. EXISTING FIRE HYDRANT
6. NEW FIRE HYDRANT
7. NEW FIRELINE CONNECTION PER COM STD DET M-31.07. PLACE DOUBLE CHECK 3' BEHIND CURB.
8. NEW SEWER TAP TO EXISTING 8" IN LONGBOW
9. NEW ONSITE PAVING
10. HANDRAIL SIDEWALK
11. CONSTRUCT BASIN TO POND 1' DEEP UNTIL DEVELOPMENT ON SOUTH SIDE OF LONGBOW.
12. TEMPORARY CURB
13. NEW DOMESTIC/LDSC WATER SERVICE



NARRATIVE:
PROJECT IS THE ONSITE DEVELOPMENT OF A SINGLE COMMERCIAL SITE.

PER THE LONGBOW BUSINESS PARKING AND GOLF CLUB ADDENDUM TO MASTER DRAINAGE REPORT, A PORTION OF THE NORTH SIDE OF LONGBOW DRIVE WOULD BE RETAINED IN THE GOLF COURSE AREAS. A PIPE CROSSING 800' WEST OF THE INTERSECTION AT RECKER AND LONGBOW IS DESIGNED TO CONVEY 0.5 ACRE FEET ACROSS LONGBOW.

IN REVIEW OF LONGBOW PHASE 1 (EAST AND NORTH OF THIS SITE) AND THE FATCATS PROJECT (NORTH OF THIS PROJECT), NEITHER OF THOSE PROJECTS CONVEYED TO THIS PIPE AND BOTH PROJECTS RETAINED THE 100 YEAR 2 HOUR ONSITE. THIS PIPE CROSSING LONGBOW IS NOT YET UTILIZED BY THIS PROJECT.

THIS PROJECT IS THE LAST DEVELOPMENT FOR THE AREAS CONTRIBUTING TO THIS INDIVIDUAL PIPE CROSSING, THEREFORE 0.5 ACRE FEET IS AVAILABLE. THIS PROJECT WILL REQUIRE 0.32 ACRE FEET OF RETENTION (13,363 CF) AND WILL THEREFORE CONVEY ALL RETENTION TO THIS PIPE. UNTIL DEVELOPMENT OF THE AREAS SOUTH OF LONGBOW CONSTRUCT THE CONVEYANCE SYSTEM TO THE GOLF COURSE, A BASIN WILL RETAIN THE 0.32 ACRE FEET IN A 1' DEEP BASIN. HIGH WATER IN THE BASIN WILL BE BELOW EXISTING GRADE, HOWEVER FOOTPRINT SHALL BE LARGE ENOUGH FOR THE 100 YEAR 2 HR VOLUME TO POND 1' DEEP.

SITE IS LOCATED IN FEMA ZONE X (SHADED)

NAME	AREA	C FACTOR	100YR 2HR DEPTH	VOL REQ
BASIN1	82,491	0.9	0.18	13,363 CF

CLIENT:
STINE ENTERPRISES, INC.

10851 NORTH BLACK CANYON HWY,
SUITE 850
PHOENIX, ARIZONA 85029
CONTACT: STEVE STINE
PHONE: (602) 843-0530
EMAIL: STEVE@STINEENTERPRISES.COM

PRELIMINARY



Helix Engineering, LLC
Engineering / Surveying / Consulting

3240 E Union Hills
Suite 112
Phoenix AZ 85050
(PH) 602-788-2616
www.hxeng.com

THIS DRAWING IS COPYRIGHTED AND IS THE SOLE PROPERTY OF THE OWNER. IT IS PRODUCED SOLELY FOR USE BY THE OWNER AND ITS AFFILIATES. REPRODUCTION OR USE OF THIS DRAWING AND/OR THE INFORMATION CONTAINED IN IT IS FORBIDDEN WITHOUT THE WRITTEN PERMISSION OF THE OWNER.

TWO WORKING DAYS BEFORE YOU DIG.
CALL FOR THE BLUE STAKES
1-800-782-5348
BLUE STAKE CENTER

RELEASE	
DATE	
8-30-19	PRELIM GD
9-25-19	REV SP

REVISIONS	
NO.	DATE
1	
2	
3	

PROJECT NAME

DENNYS

5854 E. Longbow Pkwy
Mesa, AZ

PROJECT

HELIX JOB NUMBER

433

SHEET TITLE

IN HOUSE

DRAWN BY: HXE

CHECKED BY: SB

PRELIM GD PLAN

SHEET

GD-1

PAGE

1 OF 2

PLOT SCALE: 1:1 @ 24"x36"; 1:2.2 @ 11"x17"

10851 NORTH BLACK CNYN HWY,
SUITE 850
PHOENIX, ARIZONA 85029
CONTACT : STEVE STINE
PHONE : (602) 843-0530
EMAIL : STEVE@STINEENTERPRISES.COM

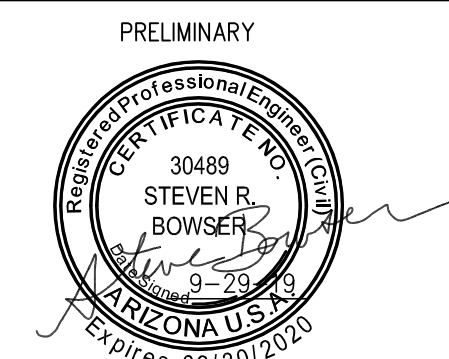

X Engineering / Surveying / Consulting

**3240 E Union Hills
Suite 112
Phoenix AZ 85050**
(ph) 602-788-2616
www.hxenq.com

THIS DRAWING IS COPYRIGHTED AND IS THE SOLE PROPERTY OF THE OWNER. IT IS PRODUCED SOLELY FOR USE BY THE OWNER AND ITS AFFILIATES. REPRODUCTION OR USE OF THIS DRAWING AND/OR THE INFORMATION CONTAINED IN IT IS FORBIDDEN WITHOUT THE WRITTEN PERMISSION OF THE OWNER.

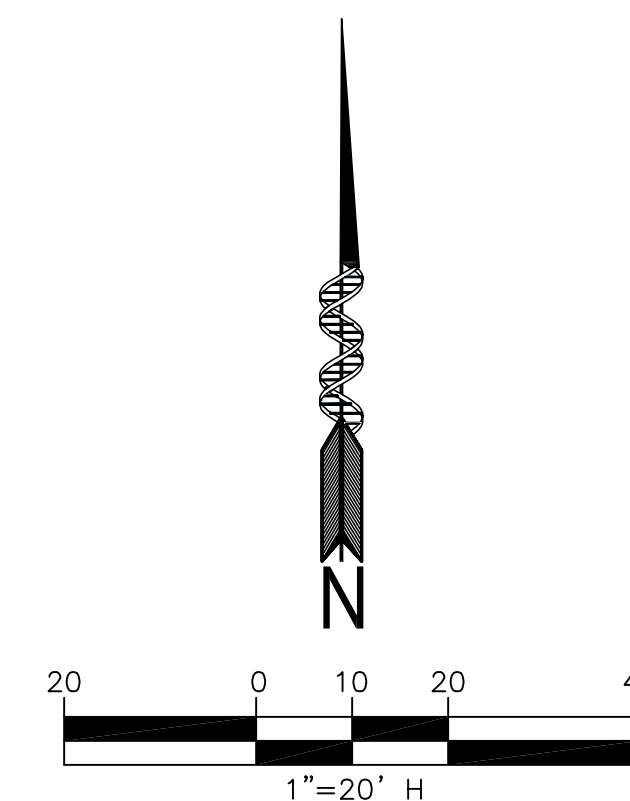
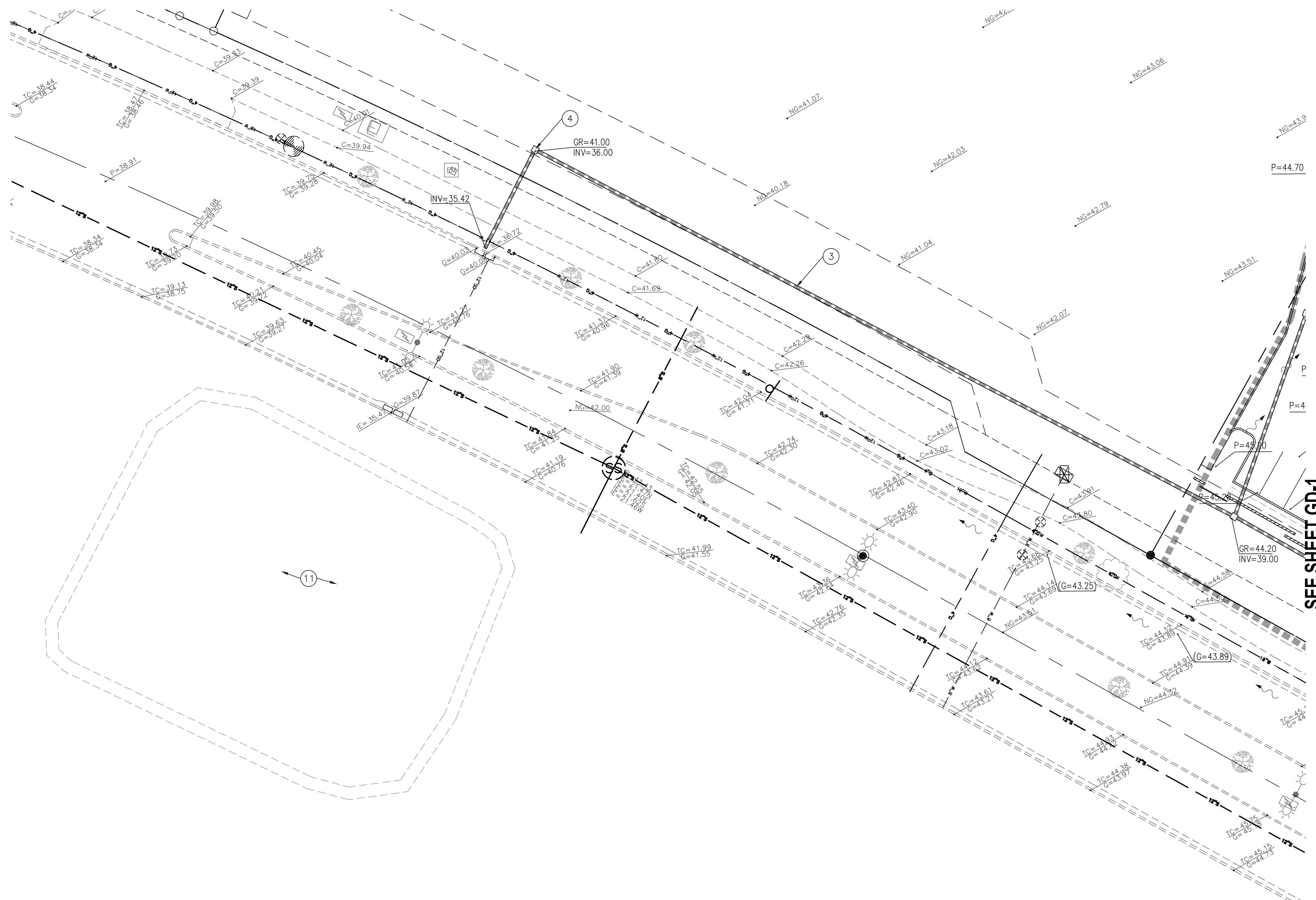

RELEASE	
DATE	
8-30-19	PRELIM GD
9-25-19	REV SP

REVISIONS		
NO.	DATE	
1		
2		
3		

PROJECT NAME

DENNYS

PROJECT

HELIX JOB NUMBER

IN HOUSE

DRAWN BY: HXE
CHECKED BY: SB

SHEET TITLE

PRELIM GD PLAN

SHEET

PAGE

GD-2

2 OF 2

PLOT SCALE: 1:1 @ 24"x36"; 1:2.2 @ 11"x17"

Sep 29, 2019 - 2:12pm
Q:\JOBS\433 Longbow Dennis\DWGS\XREF\433 impr plans.dwg

COMLOG: 70N19-00684