

UCA19-02213

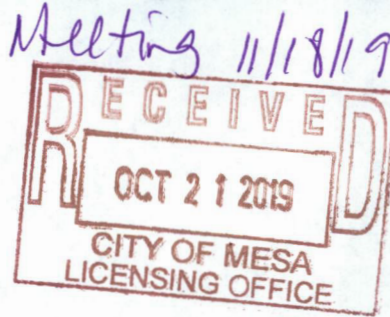

Licensing Office
55 North Center Street PO Box
1466
Mesa, Arizona 85211-1466
480-644-2316 Telephone
480-644-3999 Fax
mesaaz.gov/business/licensing

SPECIAL EVENT AND EXTENSION OF PREMISES INFORMATION SHEET

12/31/19

GC #4

If you are having alcohol sales you will need to obtain a Special Event Liquor License or an Extension of Premises from City of Mesa Licensing Office. This must be submitted at least 60 days prior to the event. A license is required with special provision outlined. Plan a minimum of 60 days to complete this process.

Check all that apply:

- ☐ Free/Host Alcohol
☒ Alcohol Sales
☐ Host and Sale Alcohol

- ☐ Beer
☐ Beer and Wine
☒ Beer, Wine and Distilled Spirits

Do you plan to secure a:

☒ **Special Event Liquor License** - The Special Event Liquor License fee is \$25 and must be approved by the City Council. After city approval, your application must be submitted to and approved by the State of Arizona. There are fees involved at the State. A non-profit association must obtain this license. (Complete attached State of Arizona Special Event Liquor Application and site plan.)

OR

☐ **Extension of Premises License** - There is no fee involved with the Extension of Premises. This is allowed when a liquor license is already in affect and you want to extend the area where liquor is sold. (Complete attached State of Arizona Extension of Premises Application and site plan.)

Please describe your security plan to ensure the safe sale or distribution of alcohol at your event Bel-Beer
Entertainment plans to utilize private security and
off-duty police officers together with Race Masters
Bar-tenders

If applying for a Special Event Liquor License the following must be provided:

Charity's or Organization's Name	Southwest Arizona Sisters	501 (C)(3)#
Name of Contact at Charity/Organization	Melissa Seliger Secretary	REDACTED
Title with Organization	"Alex" Bernardino Barera	Phone Number
On-Site Agent Responsible for Liquor		

How will attendees over the age of 21 be identified? No one under the age of 21
will be admitted. ID checks at the door by
private security.

What controls will be used to keep attendees under the age of 21 from obtaining alcohol at the event? No one
under 21 will be admitted

Will food be served? ☐ Yes ☒ No If yes, what type of food will be served _____

Seating capacity of designated area: # 400



Arizona Department of Liquor Licenses and Control
800 W Washington 5th Floor
Phoenix, AZ 85007-2934
www.azliquor.gov
(602) 542-5141

FOR DLLC USE ONLY

Received Date:

Job #:

CSR:

License #:

APPLICATION FOR SPECIAL EVENT LICENSE

Fees: \$25.00 per day for 1-10 days (consecutive) Cash Checks or Money Orders Only
A service fee of \$25.00 will be charged for all dishonored checks (A.R.S § 44-6852)

IMPORTANT INFORMATION: This document must be fully completed or it will be returned.
The Department of Liquor Licenses and Control must receive this application ten (10) business days prior to the event.

SECTION 1 Applicant must be a member of a qualifying nonprofit organization, political party, or Government entity and authorized by an Officer, Director, or Chairperson of the Organization.

1. Applicant: Seliger, Melissa Lynn

REDACTED

2. Applicant's mailing address: 6436 W Sun Dance Drive, Queen Creek AZ 8514

Date of Birth

3. Applicant's home/cell phone: () REDACTED

City

Applicant's business phone: () REDACTED

4. Applicant's email address: sasiattitude@gmail.com

SECTION 2 Name of Organization, Candidate or Political Party/Gov.: Southwest Arizona Sisters, Inc.

SECTION 3 Non-Profit/IRS Tax Exempt Number: 45-3089583

SECTION 4 Event Location: Versalles Hall

Event Address: 1422 E Main Street, Mesa Az 85203

SECTION 5 Dates and Hours of Event. Days must be consecutive but may not exceed 10 consecutive days.
See A.R.S. § 4-244(15) and (17) for legal hours of service.

PLEASE FILL OUT A SEPARATE APPLICATION FOR EACH "NON-CONSECUTIVE" DAY

	Date	Day of Week	Event Start Time AM/PM	License End Time AM/PM
DAY 1:	<u>12/31/2019</u>	<u>Tuesday</u>	<u>8:00 pm</u>	<u>2:00 am</u>
DAY 2:	<u> </u>	<u> </u>	<u> </u>	<u> </u>
DAY 3:	<u> </u>	<u> </u>	<u> </u>	<u> </u>
DAY 4:	<u> </u>	<u> </u>	<u> </u>	<u> </u>
DAY 5:	<u> </u>	<u> </u>	<u> </u>	<u> </u>
DAY 6:	<u> </u>	<u> </u>	<u> </u>	<u> </u>
DAY 7:	<u> </u>	<u> </u>	<u> </u>	<u> </u>
DAY 8:	<u> </u>	<u> </u>	<u> </u>	<u> </u>
DAY 9:	<u> </u>	<u> </u>	<u> </u>	<u> </u>
DAY 10:	<u> </u>	<u> </u>	<u> </u>	<u> </u>

SECTION 6 What type of security and control measures will you take to prevent violations of liquor laws at this event?
(List type and number of police/security personnel and type of fencing or control barriers, if applicable.)

3 Number of Police 5 Number of Security Personnel ☐ Fencing ☒ Barriers

Explanation: During the event, we will have a minimum of 5 security officers patrolling the area together with 3 police officers. We are also using Pour Masters certified bartenders.

SECTION 7 Will this event be held on a currently licensed premise and within the already approved premises? ☐ Yes ☒ No
(If yes, Local Governing Body Signature not required)

Name of Business

License Number

Phone (Include Area Code)

SECTION 8 How is this special event going to conduct all dispensing, serving, and selling of spirituous liquors? Please read R-19-318 for explanation and check one of the following boxes.

- ☐ Place license in non-use
☐ Dispense and serve all spirituous liquors under retailer's license
☒ Dispense and serve all spirituous liquors under special event
☐ Split premise between special event and retail location

(IF USING RETAIL LICENSE, PLEASE SUBMIT A LETTER OF AGREEMENT FROM THE AGENT/OWNER OF THE LICENSED PREMISES TO SUSPEND OR RUN CONCURRENT WITH THE PERMANENT LICENSE DURING THE EVENT. IF THE SPECIAL EVENT IS ONLY USING A PORTION OF THE PREMISES, AGENT/OWNER WILL NEED TO SUSPEND THAT PORTION OF THE PREMISES.)

SECTION 9 What is the purpose of this event?

- ☒ On-site consumption ☐ Off-site (auction/wine/distilled spirits pull) ☐ Both

SECTION 10

1. Has the applicant been convicted of a felony, or had a liquor license revoked within the last five (5) years?
☐ Yes ☒ No (If yes, attach explanation.)

2. How many special event days have been issued to this organization during the calendar year? 5
(The number cannot exceed 10 days per year.)

3. Is the Organization using the services of a Licensed Contractor?

☐ Yes ☒ No If yes, please provide the following: Name of Licensed Contractor: _____

4. Is the organization using the services of a series 6, 7, 11, or 12 licensee to manage the sale or service of alcohol?

☐ Yes ☒ No If yes, please provide the following: Name of Licensee _____ License #: _____

5. List all people and organizations who will receive the proceeds. Account for 100% of the proceeds. The organization applying must receive 25% of the gross revenues of the special event liquor sales. Attach an additional page if necessary.

Name Southwest Arizona Sisters, Inc. Percentage: 25%

Address 6436 W Sun Dance Drive, Queen Creek, Az 85142

Name Bel-Ber Entertainment Percentage: 75%

Address 3624 E Granada, Phoenix AZ 85008

Street

City

State

Zip

Please read A.R.S. § 4-203.02 Special event license; rules and R19-1-205 Requirements for a Special Event License.

Note: ALL ALCOHOLIC BEVERAGE SALES MUST BE FOR CONSUMPTION AT THE EVENT SITE ONLY.

NO ALCOHOLIC BEVERAGES SHALL LEAVE A SPECIAL EVENT UNLESS THEY ARE IN AUCTION WINE OR DISTILLED SPIRITS PULL SEALED CONTAINERS OR THE SPECIAL EVENT LICENSE IS STACKED WITH WINE /CRAFT DISTILLERY FESTIVAL LICENSE.

SECTION 11 License premises diagram. The licensed premises for your special event is the area in which you are authorized to sell, dispense or serve alcoholic beverages under the provisions of your license. Please attach a diagram of your special event licensed premises. Please show dimensions, serving areas, fencing, barricades, or other control measures and security position.

ATTACH DIAGRAM

If the special event will be held at a location without a permanent liquor license or if the event will be on any portion of a location that is not covered by the existing liquor license, this application must be approved by the local government before submission to the Department of Liquor Licenses and Control. Please contact the local governing board for additional application requirements and submission deadlines. Additional licensing fees may also be required before approval may be granted. For more information, please contact your local jurisdiction.

I, (Print Full Name) Melissa Seliger, hereby swear under penalty of perjury and in compliance with A.R.S. § 4-210(A)(2) and (3) that I have read and understand the foregoing and verify that the information and statements that I have made herein are true and correct to the best of my knowledge.

LOCAL GOVERNING BOARD

Applicant Signature: Melissa Seliger

Date Received: _____

I, _____ (Government Official) _____ (Title) recommend ☐ APPROVAL ☐ DISAPPROVAL

On behalf of _____ (City, Town, County) Signature _____ Date _____ Phone _____

DLLC USE ONLY

☐ APPROVAL ☐ DISAPPROVAL BY: _____ DATE: ____/____/____

A.R.S. § 41-1030. Invalidity of rules not made according to this chapter; prohibited agency action; prohibited acts by state employees; enforcement; notice

B. An agency shall not base a licensing decision in whole or in part on a licensing requirement or condition that is not specifically authorized by statute, rule or state tribal gaming compact. A general grant of authority in statute does not constitute a basis for imposing a licensing requirement or condition unless a rule is made pursuant to that general grant of authority that specifically authorizes the requirement or condition.

D. THIS SECTION MAY BE ENFORCED IN A PRIVATE CIVIL ACTION AND RELIEF MAY BE AWARDED AGAINST THE STATE. THE COURT MAY AWARD REASONABLE ATTORNEY FEES, DAMAGES AND ALL FEES ASSOCIATED WITH THE LICENSE APPLICATION TO A PARTY THAT PREVAILS IN AN ACTION AGAINST THE STATE FOR A VIOLATION OF THIS SECTION.

E. A STATE EMPLOYEE MAY NOT INTENTIONALLY OR KNOWINGLY VIOLATE THIS SECTION. A VIOLATION OF THIS SECTION IS CAUSE FOR DISCIPLINARY ACTION OR DISMISSAL PURSUANT TO THE AGENCY'S ADOPTED PERSONNEL POLICY.

F. THIS SECTION DOES NOT ABROGATE THE IMMUNITY PROVIDED BY SECTION 12-820.01 OR 12-820.

2/8/2019

Versalles Reception Hall
1422 E Main Street, Mesa AZ 85203

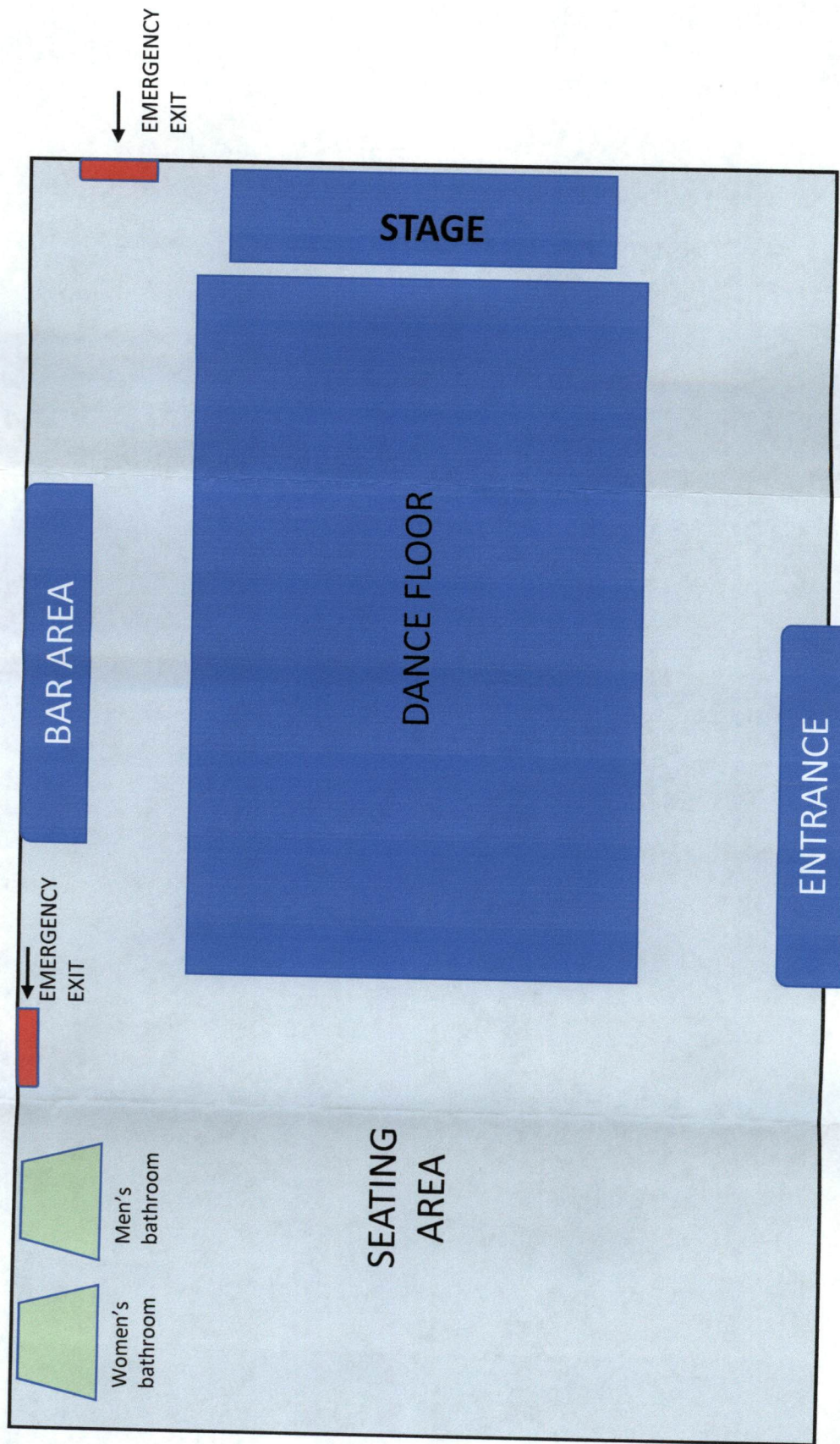



HELP ⓘ

MENU ☰

[Home](#) > [Tax Exempt Organization Search](#) > Southwest Arizona Sisters Incorporated[Back to Search Results](#)

Southwest Arizona Sisters Incorporated

EIN: 45-3089583 | Queen Creek, AZ, United States

[Other Names](#)

Publication 78 Data ⓘ

Organizations eligible to receive tax-deductible charitable contributions. Users may rely on this list in determining deductibility of their contributions.

On Publication 78 Data List: Yes**Deductibility Code:** PC

Form 990-N (e-Postcard) ⓘ

Organizations who have filed a 990-N (e-Postcard) annual electronic notice. Most small organizations that receive less than \$50,000 fall into this category.

[Tax Year 2018 Form 990-N \(e-Postcard\)](#)[Tax Year 2017 Form 990-N \(e-Postcard\)](#)[Tax Year 2016 Form 990-N \(e-Postcard\)](#)[Tax Year 2015 Form 990-N \(e-Postcard\)](#)