

CITY OF MESA NOTES:

CITY OF MESA GENERAL NOTES:

1. ALL WORK AND MATERIALS SHALL CONFORM TO THE CURRENT UNIFORM STANDARD SPECIFICATIONS AND DETAILS FOR PUBLIC WORKS CONSTRUCTION AS FURNISHED BY THE MARICOPA ASSOCIATION OF GOVERNMENTS AND AS AMENDED BY THE CITY OF MESA. ALL WORK AND MATERIALS NOT IN CONFORMANCE WITH THESE AMENDED SPECIFICATIONS AND DETAILS ARE SUBJECT TO REMOVAL AND REPLACEMENT AT THE CONTRACTOR'S EXPENSE.

2. SEPARATE RIGHT-OF-WAY PERMITS ARE REQUIRED FOR ALL PUBLIC UTILITIES, PUBLIC STREET IMPROVEMENTS, AND RIGHT-OF-WAY LANDSCAPING. FOR INFORMATION REGARDING AVAILABILITY AND COST OF RIGHT-OF-WAY PERMITS, CONTACT THE DEVELOPMENT SERVICES DEPARTMENT AT (480) 644-4273 OR AT HTTP://WWW.MESAAZ.GOV/DEVSUSTAIN/CONSTRUCTIONPERMITS.ASPX. THE CONTRACTOR SHALL OBTAIN ALL PERMITS REQUIRED UNLESS OTHERWISE NOTED. CONTRACTORS MUST HOLD THE APPROPRIATE CLASS OF LICENSE AND SHALL HAVE ON FILE WITH THE PERMIT SERVICES SECTION PROOF OF INSURANCE COVERAGE. PERMITS BECOME INVALID AND MUST BE UPDATED IF WORK HAS NOT BEGUN WITHIN NINETY (90) DAYS. PERMITS ALSO BECOME INVALID IF THE CONTRACTOR'S INSURANCE LAPSES OR IS VOIDED.

3. TWENTY FOUR (24) HOURS PRIOR TO THE COMMENCEMENT OF ANY WORK, CONSTRUCTION OR INSTALLATIONS ASSOCIATED WITH THIS PERMIT, THE PERMITTEE SHALL NOTIFY CITY OF MESA ENGINEERING ENGINEERING DEPARTMENT AT (480) 644-2251 OF INTENT TO BEGIN AND REQUEST/SCHEDULE PRELIMINARY FIELD REVIEW AT THE PROJECT SITE WITH THE CITY OF MESA ENGINEERING DEPARTMENT CONSTRUCTION INSPECTOR. FAILURE TO PROVIDE PROPER INSPECTION NOTIFICATION AS PRESCRIBED ABOVE, SHALL RESULT IN THIS PERMIT BECOMING INVALID AND WORK BEING STOPPED.

4. CONTRACTOR'S SHALL COMPLY WITH THE REQUIREMENTS TO OBTAIN THE NECESSARY RIGHT-OF-WAY PERMITS AND SHALL COMPLY WITH THE RIGHT-OF-WAY PERMIT CONDITIONS AS FOUND ON THE BACK OF THE PERMIT FORM.

5. THE CITY OF MESA PARKS & RECREATION DIVISION IS NOT REPRESENTED BY BLUE STAKE. WHEN THE CONTRACTOR EXCAVATES NEAR OR ADJACENT TO A CITY PARK, THE CONTRACTOR SHALL CONTACT THE PARKS & RECREATION ADMINISTRATION SECTION AT (480) 644-2354 TO REQUEST ASSISTANCE IN LOCATING ALL THEIR UNDERGROUND FACILITIES.

6. THE CONTRACTOR SHALL OBTAIN AN EARTH-MOVING PERMIT FROM THE MARICOPA COUNTY ENVIRONMENTAL SERVICES DEPARTMENT AND SHALL COMPLY WITH ITS REQUIREMENTS FOR DUST CONTROL.

7. THE ENGINEER HEREBY CERTIFIES AS EVIDENCED BY A PROFESSIONAL SEAL & SIGNATURE, THAT ALL AFFECTED UTILITY COMPANIES BOTH PUBLIC AND PRIVATE HAVE BEEN CONTACTED AND ALL EXISTING AND/OR PROPOSED UTILITY LINES AND OTHER RELATED INFORMATION HAVE BEEN TRANSFERRED ONTO THESE PLANS. THE ENGINEER OR ARCHITECT ALSO HEREBY CERTIFIES THAT ALL EXISTING AND/OR PROPOSED PUBLIC RIGHT-OF-WAY OR EASEMENTS HAVE BEEN CORRECTLY PLOTTED/SHOWN.

8. THE ENGINEER, OR LAND SURVEYOR OF RECORD SHALL CERTIFY UPON COMPLETION OF CONSTRUCTION THAT ALL PUBLIC IMPROVEMENTS (WATER AND SEWER UTILITIES, STORM SEWER, CONCRETE, PAVING, STREET LIGHTS, ETC.) HAVE BEEN INSTALLED AT THE LOCATIONS AND ELEVATIONS SHOWN ON THE APPROVED PLANS. ANY CHANGES SHALL BE REFLECTED ON "AS-BUILT" DRAWINGS PROVIDED BY THE ENGINEER TO THE ENGINEERING DEPARTMENT.

9. THE REGISTERED ENGINEER OR LAND SURVEYOR SHALL CERTIFY THAT THE MINIMUM HORIZONTAL AND VERTICAL SEPARATION BETWEEN UTILITIES WITHIN PUBLIC RIGHT-OF-WAY OR EASEMENTS HAS BEEN MAINTAINED AS REQUIRED BY LAW OR POLICY.

10. THE DEVELOPER SHALL PROVIDE ALL CONSTRUCTION STAKING FOR THE PROJECT.

11. THE DEVELOPER OR THE ENGINEER IS RESPONSIBLE FOR ARRANGING FOR THE RELOCATION OR REMOVAL OF ALL UTILITIES OR FACILITIES THAT ARE IN CONFLICT WITH THE PROPOSED PUBLIC IMPROVEMENTS. THE CONTRACTOR IS RESPONSIBLE FOR COORDINATING THE RELOCATION OF ALL UTILITIES, POWER POLES, IRRIGATION DRY-UPS, RESETS REMOVALS BY OTHERS, ETC.

12. THE CONTRACTORS SHALL LOCATE ALL UTILITIES PRIOR TO EXCAVATION AND AVOID DAMAGE TO SAME. CALL (602) 263-1100 FOR BLUE STAKE TWO WORKING DAYS PRIOR TO DIGGING. CALL SALT RIVER PROJECT FOR POLE BRACING, ELECTRIC SERVICE OR CONSTRUCTION SCHEDULING AT (602) 273-8888.

13. WHEN GAS MAINS AND/OR SERVICES ARE EXPOSED, CONTACT THE CITY OF MESA AT (480) 644-2261 FOR INSPECTION OF THE EXPOSED PIPE AND COATING PRIOR TO BACKFILLING OF THE TRENCH.

14. CONTRACTORS SHALL COMPLY WITH THE PROVISIONS FOR TRAFFIC CONTROL AND BARRICADING PER THE CURRENT CITY OF MESA TRAFFIC BARRICADE MANUAL.

15. IF A FIRE HYDRANT IS NEEDED TO OBTAIN CONSTRUCTION WATER, THE CONTRACTOR SHALL OBTAIN A FIRE HYDRANT METER FROM PERMIT SERVICES AND PAY ALL APPLICABLE FEES AND CHARGES.

16. IF DURING THE CONSTRUCTION OF A PUBLIC FACILITY, THE CONTRACTOR FAILS TO OR IS UNABLE TO COMPLY WITH A REQUEST OF THE ENGINEERING CONSTRUCTION INSPECTOR, AND IT IS NECESSARY FOR CITY FORCES TO DO WORK THAT IS NORMALLY THE CONTRACTOR'S RESPONSIBILITY, THE CITY SHALL BE JUSTIFIED IN BILLING THE CONTRACTOR. EACH INCIDENT REQUIRING WORK BY CITY FORCES SHALL BE COVERED BY A SEPARATE BILLING AT THE CURRENT APPLICABLE RATES.

17. THE CONTRACTOR IS ADVISED THAT DAMAGE TO PUBLIC SERVICES OR SYSTEMS AS A RESULT OF THIS PROJECT SHALL BE REPAIRED BY THE CONTRACTOR AND INSPECTED BY THE CITY INSPECTOR. UNLESS OTHERWISE APPROVED BY THE CITY, ALL REPAIRS SHALL BE DONE WITHIN 24 HOURS. THE CONTRACTOR IS ADVISED THAT ANY COSTS RELATED TO REPAIR OR REPLACEMENT OF DAMAGED PUBLIC SERVICES AND SYSTEMS AS A RESULT OF CONTRACTOR'S ACTIVITIES SHALL BE BORNE BY THE CONTRACTOR.

LEGEND:

●	BRASS CAP FLUSH
●	PROPERTY CORNER
(M)	MEASURED
(R)	RECORD
⊕	CATCH BASIN
⊞	ELECTRIC BOX
⊞	ELECTRIC CABINET
⊞	ELECTRIC TRANSFORMER
⊕	FIBER OPTICS MARKER
■	METAL GRATE (RECTANGULAR)
▲	TELECOMMUNICATIONS RISER
Ⓣ	TRAFFIC SIGNAL
⊞	CABLE TELEVISION RISER
Ⓢ	SANITARY SEWER MANHOLE
Ⓢ	STORM DRAIN MANHOLE
●	SEWER CLEANOUT
⊞	WATER METER
⊕	FIRE HYDRANT
⊗	WATER VALVE
Ⓞ	EXIST. GAS METER
////	MASONRY WALL
— — — — —	EASEMENT LINE
— EX-OHE —	EXIST. OVERHEAD ELECTRIC LINE
— EX-GAS —	EXIST. GAS LINE
— EX-COMS —	EXIST. COMMUNICATIONS LINE
— EX-6" SWR —	EXIST. SEWER LINE
— EX-6" WTR —	EXIST. WATER LINE
— EX-ELEG+ —	EXIST. UNDERGROUND ELECTRIC
■ ■ ■ ■ ■	STORM DRAIN
✻	EXIST. PALM TREE
☁	EXIST. MISC. TREE
FL=05.4	PROP. FLOW LINE GRADE
FG=05.4	PROP. FINISHED GRADE
C=05.40	PROP. CONCRETE GRADE
P=05.40	PROP. PAVEMENT GRADE
TC=05.73 G=05.40	PROP. TOP OF CURB GRADE PROP. GUTTER GRADE
TC=05.73 P=05.40	PROP. TOP OF CURB GRADE PROP. PAVEMENT GRADE
ctv	EXIST. CABLE TV BOX
PP	EXIST. POWER POLE
APN	ASSESSOR'S PARCEL NO.
P/L	PROPERTY LINE
1.6%	PROP. DRAINAGE SLOPE
—▶—	PROP. DRAINAGE PATTERN
☆	EXISTING LIGHT POLE
—	EXISTING GUY WIRE
—	EXISTING SIGN
—■—■—	EXISTING FENCE
— — — — —	MONUMENT LINE
— — — — —	PROPERTY/RIGHT-OF-WAY LINE
- - - - -	GRADE BREAK/FLOW LINE
▲	EXIST. NATURAL GRADE
▲	EXIST. PAVEMENT GRADE
▲	EXIST. CONCRETE GRADE

SITE PLAN MODIFICATION
FOR
CHILD CRISIS ARIZONA
817 N. COUNTRY CLUB DRIVE
MESA, ARIZONA 85201

LEGAL DESCRIPTION: (827 N. COUNTRY CLUB DR.)

THE EAST 133.00 FEET OF THE WEST 173.00 FEET OF THE NORTH 140.00 FEET OF THE SOUTH HALF OF THE SOUTHWEST QUARTER OF SOUTHWEST QUARTER OF THE NORTHWEST QUARTER OF SECTION 15, TOWNSHIP 1 NORTH, RANGE 5 EAST OF THE GILA AND SALT RIVER BASE AND MERIDIAN, MARICOPA COUNTY, ARIZONA;

EXCEPT THAT PART OF THE ABOVE PROPERTY DESCRIBED AS FOLLOWS:

COMMENCE AT THE NORTHWEST CORNER OF SECTION 15 OF THE GILA AND SALT RIVER BASE AND MERIDIAN;

THENCE SOUTH 00 DEGREES 10 MINUTES 28 SECONDS WEST A DISTANCE OF 2,311.23 FEET;

THENCE SOUTH 89 DEGREES 49 MINUTES 32 SECONDS EAST A DISTANCE OF 40.00 FEET TO THE POINT OF BEGINNING OF THE HEREIN DESCRIBED PARCEL;

THENCE SOUTH 00 DEGREES 10 MINUTES 28 SECONDS WEST A DISTANCE OF 140.00 FEET;

THENCE SOUTH 89 DEGREES 49 MINUTES 49 SECONDS EAST A DISTANCE OF 12.00 FEET;

THENCE NORTH 00 DEGREES 10 MINUTES 28 SECONDS EAST A DISTANCE OF 140.00 FEET;

THENCE NORTH 89 DEGREES 49 MINUTES 49 SECONDS WEST A DISTANCE OF 12.00 FEET TO THE POINT OF BEGINNING, AS SET FORTH IN INSTRUMENT NO. 1992-46897.

NOTE: THE LEGAL DESCRIPTION ABOVE WAS OBTAINED FROM THE DEED ON FILE WITH THE MARICOPA COUNTY RECORDERS OFFICE

ZONING:

LIMITED COMMERCIAL (LC)

LOT AREA:

AREA = 16,945 SQUARE FEET/0.39 ACRES

ASSESSORS PARCEL NO:

137-23-090

SITE ADDRESS:

827 N. COUNTRY CLUB DRIVE
MESA, ARIZONA 85201

PARKING CALCULATIONS:

ORIGINAL PARKING CALCULATIONS: (FOR ENTIRE CHILD CRISIS CENTER CAMPUS)

REFERENCE:
CITY APPROVED SITE PLAN: "FAMILY RESOURCES CENTER"
BY SAEMISCH-DI BELLA ARCHITECTS, INC. AND DATED MAY 17, 2006

REQUIRED PARKING SPACES:
CHILD CRISIS ARIZONA: 19,982 SF @ 1 PARKING SPACE/375 SF=53 SPACES
FIRST CHRISTIAN CHURCH OF MESA: 5,175 SF @ 1 PARKING SPACE/75 SF=69 SPACES

TOTAL REQUIRED PARKING SPACES=122 SPACES

PARKING SPACES PROVIDED: EXISTING CONDITION

CHILD CRISIS ARIZONA:
42 PARKING SPACES (1 REGULAR ADA SPACE & 1 VAN-ACCESSIBLE SPACE REQUIRED)
2 VAN-ACCESSIBLE SPACES PROVIDED

FIRST CHRISTIAN CHURCH OF MESA:
95 PARKING SPACES (3 REGULAR ADA & 1 VAN-ACCESSIBLE SPACES REQUIRED)
4 REGULAR ADA & 1 VAN-ACCESSIBLE SPACES PROVIDED

TOTAL PARKING SPACES PROVIDED:
137 SPACES INCLUDING 4 REGULAR ADA & 3 VAN-ACCESSIBLE SPACES)

PARKING SPACES PROVIDED: WITH NEW PARKING LOT

CHILD CRISIS ARIZONA:
71 PARKING SPACES (2 REGULAR ADA SPACES & 1 VAN-ACCESSIBLE SPACE REQUIRED)
2 REGULAR ADA & 1 VAN-ACCESSIBLE SPACES PROVIDED

FIRST CHRISTIAN CHURCH OF MESA:
95 PARKING SPACES (3 REGULAR ADA & 1 VAN-ACCESSIBLE SPACES REQUIRED)
3 REGULAR ADA & 2 VAN-ACCESSIBLE SPACES PROVIDED

TOTAL PARKING SPACES PROVIDED:
166 SPACES INCLUDING 5 REGULAR ADA & 3 VAN-ACCESSIBLE SPACES)

PARKING SPACES PROVIDED: WITH NEW PLAYGROUND IN NE PARKING LOT (DISPLACING 16 PARKING SPACES)

CHILD CRISIS ARIZONA:
55 PARKING SPACES (2 REGULAR ADA SPACES & 1 VAN-ACCESSIBLE SPACE REQUIRED)
2 REGULAR ADA & 1 VAN-ACCESSIBLE SPACES PROVIDED

FIRST CHRISTIAN CHURCH OF MESA:
95 PARKING SPACES (3 REGULAR ADA & 1 VAN-ACCESSIBLE SPACES REQUIRED)
3 REGULAR ADA & 2 VAN-ACCESSIBLE SPACES PROVIDED

TOTAL PARKING SPACES PROVIDED:
150 SPACES INCLUDING 5 REGULAR ADA & 3 VAN-ACCESSIBLE SPACES)

OWNER OF LOT 1:

FIRST CHRISTIAN CHURCH OF MESA
805 N. COUNTRY CLUB DRIVE
MESA, ARIZONA 85201
(480) 833-7312
CONTACT: LIZ DEWESE

CIVIL ENGINEER:

HENDERSON ENGINEERING GROUP, LLC
1533 S. PARKCREST CIRCLE
MESA, ARIZONA 85206
(480) 334-7507
CONTACT: BRENT L. HENDERSON P.E.

OWNER OF LOT 2:

CHILD CRISIS ARIZONA
817 N. COUNTRY CLUB DRIVE
MESA, ARIZONA 85201
(480) 834-9424
CONTACT: EJ HUGHES

LAND SURVEYOR:

AW LAND SURVEYING, LLC
P.O. BOX 2170
CHANDLER, ARIZONA 85244
(480) 244-7630
CONTACT: DANIEL D. ARMIJO, R.L.S.

SHEET INDEX:

SP-1 COVER SHEET
SP-2 SITE PLAN MODIFICATION

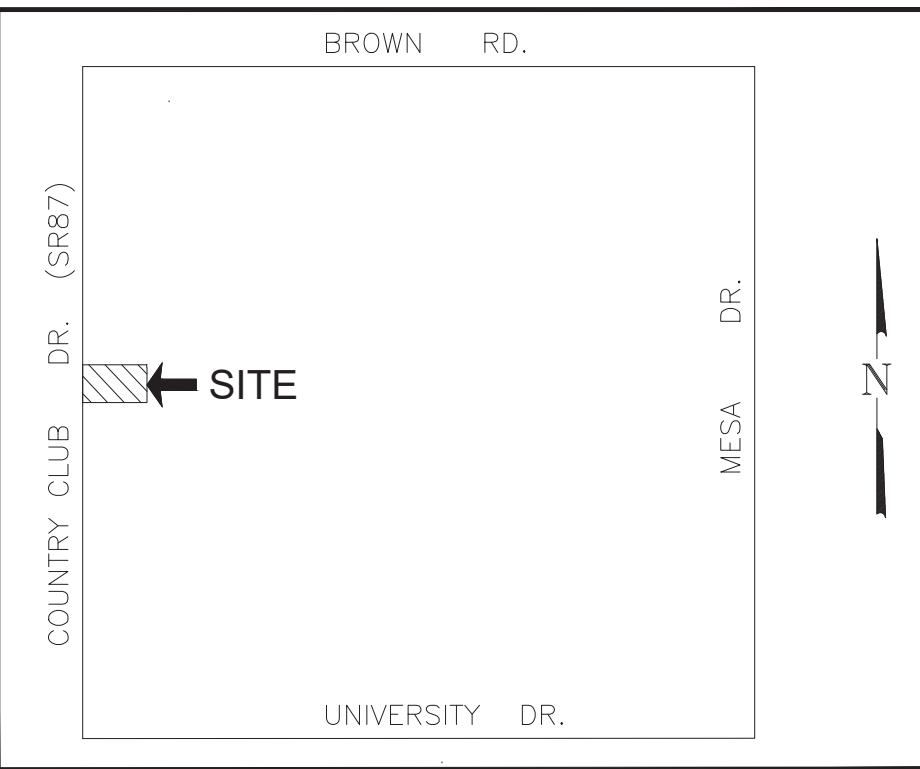

VICINITY MAP
N.T.S.

LEGAL DESCRIPTION: (805 N. COUNTRY CLUB DR.)

A PARCEL OF LAND SITUATED IN A PORTION OF THE NORTHWEST QUARTER OF SECTION 15, TOWNSHIP 1 NORTH, RANGE 5 EAST OF THE GILA AND SALT RIVER BASE AND MERIDIAN, MARICOPA COUNTY, ARIZONA, MORE PARTICULARLY DESCRIBED AS FOLLOWS:

LOT 1, FINAL PLAT FOR CHILD CRISIS CENTER, AS RECORDED IN BOOK 912, PAGE 48, MARICOPA COUNTY RECORDS.

EXCEPT:

A PORTION OF LOT 1 AS SHOWN ON THE FINAL PLAT OF CHILD CRISIS CENTER, RECORDED IN BOOK 912, PAGE 48, OF MARICOPA COUNTY RECORDS, LYING WITHIN THE NORTHWEST QUARTER OF SECTION 15, TOWNSHIP 1 NORTH, RANGE 5 EAST OF THE GILA AND SALT RIVER BASE AND MERIDIAN, MARICOPA COUNTY, ARIZONA, MORE PARTICULARLY DESCRIBED AS FOLLOWS:

COMMENCING AT THE SOUTHEAST CORNER OF SAID LOT 1;

THENCE ALONG THE EASTERLY LINE OF SAID LOT 1, NORTH 00 DEGREES 23 MINUTES 04 SECONDS EAST, A DISTANCE OF 60.85 FEET, TO THE POINT OF BEGINNING;

THENCE LEAVING SAID EASTERLY LINE, 89 DEGREES 45 MINUTES 07 SECONDS WEST, A DISTANCE OF 46.84 FEET;

THENCE NORTH 33 DEGREES 58 MINUTES 36 SECONDS WEST, A DISTANCE OF 52.74 FEET TO AN EASTERLY LINE OF LOT 1;

THENCE ALONG SAID EASTERLY LINE, SOUTH 75 DEGREES 29 MINUTES 55 SECONDS EAST, A DISTANCE OF 78.99 FEET;

THENCE SOUTH 00 DEGREES 23 MINUTES 04 SECONDS WEST, A DISTANCE OF 24.16 FEET, TO THE POINT OF BEGINNING;

ZONING:

OFFICE COMMERCIAL (OC)

LOT AREA:

AREA = 114,721 SQUARE FEET/2.63 ACRES

ASSESSORS PARCEL NO:

137-23-121B

SITE ADDRESS:

805 N. COUNTRY CLUB DRIVE
MESA, ARIZONA 85201

LEGAL DESCRIPTION: (817 N. COUNTRY CLUB DR.)

A PARCEL OF LAND SITUATED IN A PORTION OF THE NORTHWEST QUARTER OF SECTION 15, TOWNSHIP 1 NORTH, RANGE 5 EAST OF THE GILA AND SALT RIVER BASE AND MERIDIAN, MARICOPA COUNTY, ARIZONA, MORE PARTICULARLY DESCRIBED AS FOLLOWS:

LOT 2, FINAL PLAT FOR CHILD CRISIS CENTER, AS RECORDED IN BOOK 912, PAGE 48, MARICOPA COUNTY RECORDS.

AND:

A PORTION OF LOT 1 AS SHOWN ON THE FINAL PLAT OF CHILD CRISIS CENTER, RECORDED IN BOOK 912, PAGE 48, OF MARICOPA COUNTY RECORDS, LYING WITHIN THE NORTHWEST QUARTER OF SECTION 15, TOWNSHIP 1 NORTH, RANGE 5 EAST OF THE GILA AND SALT RIVER BASE AND MERIDIAN, MARICOPA COUNTY, ARIZONA, MORE PARTICULARLY DESCRIBED AS FOLLOWS:

COMMENCING AT THE SOUTHEAST CORNER OF SAID LOT 1;

THENCE ALONG THE EASTERLY LINE OF SAID LOT 1, NORTH 00 DEGREES 23 MINUTES 04 SECONDS EAST, A DISTANCE OF 60.85 FEET, TO THE POINT OF BEGINNING;

THENCE LEAVING SAID EASTERLY LINE, 89 DEGREES 45 MINUTES 07 SECONDS WEST, A DISTANCE OF 46.84 FEET;

THENCE NORTH 33 DEGREES 58 MINUTES 36 SECONDS WEST, A DISTANCE OF 52.74 FEET TO AN EASTERLY LINE OF LOT 1;

THENCE ALONG SAID EASTERLY LINE, SOUTH 75 DEGREES 29 MINUTES 55 SECONDS EAST, A DISTANCE OF 78.99 FEET;

THENCE SOUTH 00 DEGREES 23 MINUTES 04 SECONDS WEST, A DISTANCE OF 24.16 FEET, TO THE POINT OF BEGINNING;

ZONING:

OFFICE COMMERCIAL (OC)

LOT AREA:

AREA = 66,980 SQUARE FEET/1.54 ACRES

ASSESSORS PARCEL NO'S:

137-23-121A/137-23-122

SITE ADDRESS:

817 N. COUNTRY CLUB DRIVE
MESA, ARIZONA 85201

BENCHMARK:

CITY OF MESA BRASS TAG LOCATED ON TOP OF CURB AT THE NORTHWEST CORNER OF THE INTERSECTION OF COUNTRY CLUB DRIVE AND BROWN ROAD, MESA, ARIZONA

ELEVATION = 1250.36' NAVD 88 (CITY OF MESA DATUM)

 EXPIRES 03/31/21	 Henderson Engineering Group, LLC Site Development • Storm Water • Planning • Transportation/Traffic Structural • Forensics • Project Management • Water/Wastewater 1533 SOUTH PARKCREST CIRCLE MESA, AZ 85206 (480) 334-7507 BRENT@HEG-LLC.COM WWW.HEG-LLC.COM	
	CHILD CRISIS ARIZONA 817 N. COUNTRY CLUB DRIVE	
COVER SHEET		SHEET NO:
SCALE: N/A DATE: 02/05/19 PROJECT NO: 180601		SP-1
DESIGNED BY: BLH	DRAWN BY: BLH CHECKED BY: BLH	

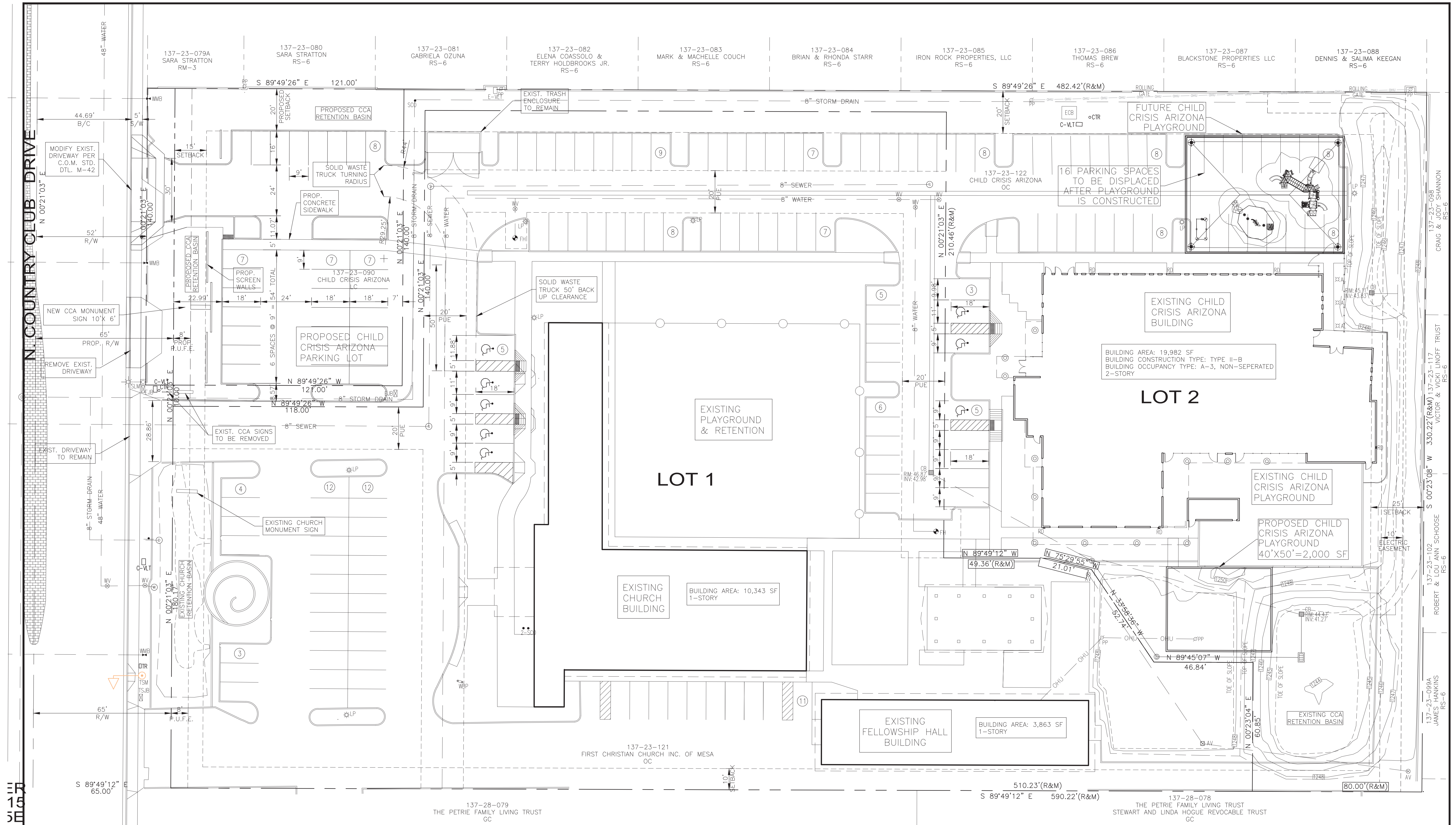

315 SE

(1) = PARKING SPACE COUNT

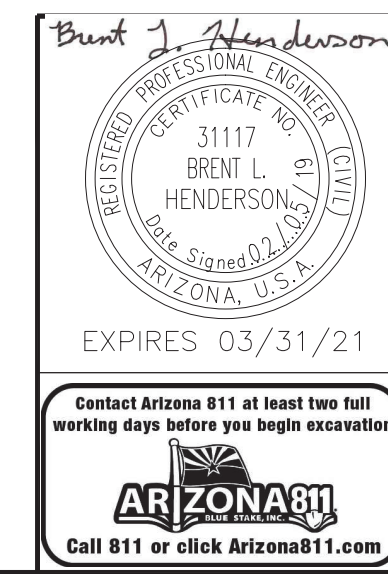
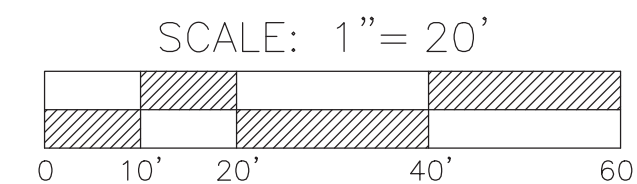

Henderson Engineering Group, LLC
Site Development • Storm Water • Planning • Transportation/Traffic
Structural • Forensics • Project Management • Water/Wastewater
1533 SOUTH PARKCREST CIRCLE MESA, AZ 85206
(480) 334-7507 BRENT@HEG-LLC.COM WWW.HEG-LLC.COM

CHILD CRISIS ARIZONA
817 N. COUNTRY CLUB DRIVE







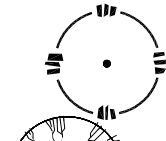
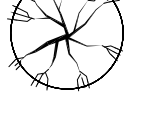

SITE PLAN

DATE: 02/05/19 PROJECT NO: 180601
DESIGNED BY: BLH DRAWN BY: BLH CHECKED BY: BLH

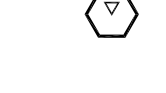









SHEET NO: **SP-2**
2 OF 2

CHILD CRISIS ARIZONA LANDSCAPE PACKAGE

PLANTING MATERIAL LEGEND

TREES	SIZE	NOTES	QTY
 Acacia mulga	24" Box	*ADWR	11
 Quercus virginiana	36" Box	*ADWR	4
GROUNDCOVERS			
 Lantana montevidensis	5 Gallon	*ADWR	18
 Gazania rigens	5 Gallon	*ADWR	35
SHRUBS / ACCENTS			
 Hesperaloe parviflora 'brakelights'	5 Gallon	*ADWR	36
 Leucophyllum frutescens	5 Gallon	*ADWR	21
 Caesalpinia pulcherrima	5 Gallon	*ADWR	4
 Muhlenbergia capillaris	5 Gallon	*ADWR	15
LANDSCAPE MATERIALS			
 Decomposed Granite, 3/4" screened "Express Gold" 2" deep in planting areas per plan. Match existing color/size.			6,860 sq ft
*ADWR = Arizona Department of Water Resources Approved Low-Water Use Plant			

IRRIGATION LEGEND

SYMBOL		
	SERVICE POINT	CONNECT TO EXISTING IRRIGATION SYSTEM MAINLINE WATER SERVICE
	GATE VALVE	NIBCO GATE VALVE, SIZE PER LINE BRONZE MATERIAL
	DRIP VALVE	HUNTER ICV SERIES WITH 150 MESH WYE-STRAINER SIZE PER PLAN
	DRIP FLUSH CAP	SPEARS FLUSH CAP 1/2" FLUSH VALVE
	PRESSURE REG.	SENNIGER 30 PSI - LOCATE IN SEPARATE BOXES MEDIUM FLOW 2-20GPM - 30 PSI (100 MESH)
N/S	EMITTER - SP	BOWSMITH 1.0 GPH (1 PER PLANT)
	EMITTER - MP	BOWSMITH 1.0 GPH 6 PORT (2 PER TREE)
PIPE LEGEND		
	MAINLINE - 1" SIZE	PVC SCH. 40
	TREE LATERAL	PVC SCH. 40 - SOLVENT WELD
	SHRUB LATERAL	PVC SCH. 40 - SOLVENT WELD
	PIPE SLEEVE	PVC SCH. 40 - 2 X PIPE SIZE MINIMUM

CITY OF MESA LANDSCAPE NOTES

- LANDSCAPE CONTRACTOR SHALL CONFIRM LOCATION OF ALL UNDERGROUND UTILITIES PRIOR TO ANY EXCAVATION AND SHALL BE RESPONSIBLE FOR THE FOLLOWING:
A) DAMAGES TO SUCH UTILITIES CAUSED AS A RESULT OF THE CONTRACTORS ACTIVITIES.
B) DAMAGES TO EXISTING WALKS, WALLS, DRIVES, CURBS, ETC.
C) INSPECTING THE SITE IN ORDER TO BE FULLY AWARE OF EXISTING CONDITIONS PRIOR TO SUBMITTING A BID.
- INSTALLATION OF ALL LANDSCAPE AND IRRIGATION MATERIAL SHALL COMPLY WITH SECTIONS 424, 425, 757, AND 795 OF THE MAG STANDARD SPECIFICATIONS AS AMENDED BY THE CITY OF MESA IN THE CURRENT EDITION OF THE MESA ENGINEERING PROCEDURES MANUAL LANDSCAPE & IRRIGATION STANDARDS.
- CONTRACTOR SHALL REPAIR ANY DAMAGE MADE TO THE EXISTING SPRINKLER SYSTEM TO THE SATISFACTION OF THE CITY AT NO ADDITIONAL COST TO THE CITY.
- LANDSCAPE REMOVAL IS A NON-PAY ITEM UNLESS OTHERWISE NOTED.
- ALL EXISTING VEGETATION, WEEDS, DEBRIS, ETC., SHALL BE REMOVED FROM PROJECT AREA AND DISPOSED OF PROPERLY OFF THE SITE AT THE CONTRACTORS EXPENSE (SCARIFY EXISTING SUBGRADE, MIN. SIZE (6) INCHES DEPTH).
- DAMAGE TO TURF SHALL BE REPAIRED BY CONTRACTOR, IE RUTS FILLED WITH CLEAN SOIL, COMPACTED TO MATCH SURROUNDING GRADES, EXCESS SOIL, ROCK, ETC., SHALL BE REMOVED TO LEAVE THE SITE CLEAN.
- ALL PLANT MATERIAL, OTHER THAN TREES, SHALL CONFORM TO GRADING, TYPE, ETC., AS SET FORTH IN THE AMERICA STANDARD FOR NURSERY STOCK BY THE AMERICAN ASSOCIATION OF NURSERYMEN. ALL TREES SHALL CONFORM TO THE CURRENT ARIZONA NURSERY ASSOCIATION TREE SPECIFICATIONS AND MAG SPEC 795.7. SHOULD ANY CONFLICTS IN THE SPECIFICATION OCCUR, THE ARIZONA NURSERY ASSOCIATION SPECIFICATIONS SHALL PREVAIL.
- CITY RESERVES THE RIGHT TO INSPECT SHRUBS AND CONTAINER TREES FOR CONDITION OF ROOTBALLS. FOR ANY SUCH INSPECTIONS WHICH MAY DESTROY ROOTBALL, CONTRACTOR SHALL SUPPLY ADDITIONAL PLANT AT NO COST TO CITY.
- PLANT PITS SHALL BE INSPECTED BY CITY PRIOR TO PLANTING BY THE CONTRACTOR BY REQUESTING AN INSPECTION 48 HOURS IN ADVANCE.
- ROUGH AND FINE GRADING TO ESTABLISH UNIFORM SMOOTH GRADE IS INCLUDED IN THIS PROJECT.
- SOIL TEST FOR FERTILITY AND ADDITIVE RECOMMENDATIONS (FOR TURF AND ORNAMENTALS) SHALL BE COMPLETED BY CONTRACTOR TO DETERMINE IF ADDITIVES ARE REQUIRED. CONTRACTOR SHALL PROVIDE COPY OF SOIL TEST RESULTS FOR REVIEW AND APPROVAL TO ENGINEERING INSPECTOR AT LEAST SEVEN (7) DAYS PRIOR TO ANTICIPATED PLANTING. AFTER APPROVAL BY THE CITY, THE CONTRACTOR SHALL PROVIDE AND INCORPORATE AND ADDITIVES REQUIRED PRIOR TO OR AT TIME OF PLANTING.
12. PLANT PIT SOIL MIXTURE SHALL CONSIST OF FOUR AND ONE-HALF PARTS NATURE FERTILE, FRIABLE SOIL AND ONE PART HUMUS BY VOLUME, THOROUGHLY MIXED PRIOR TO BACKFILLING IN PITS. BACKFILLING SHALL BE IN 6" LIFTS WITH EACH LIFT WATER SETTLED WITHOUT PUDDLING.
- CONTRACTOR SHALL STAKE TREE AND SHRUB LOCATIONS FOR 5-GALLON PLANTS AND LARGER. STAKES SHALL BE MARKED WITH PLANT NAME OR PLANT LEGEND ITEM NUMBER FORM PLANS.
- ALL EXISTING (GAS, ELECTRIC, WATER, ETC.,) COVERS AND BOXES SHALL REMAIN UNCOVERED. CONTRACTOR TO ADJUST TO FINAL GRADE AS NECESSARY.
- THE CONTRACTOR SHALL INSTALL WATER METER PROVIDED BY THE CITY OF MESA. THE CONTRACTOR SHALL PROVIDE ALL MATERIALS INCLUDING ALL APPURTENANCES AND LABOR NECESSARY TO INSTALL THE COMPLETE AUTOMATIC SPRINKLER SYSTEM FROM THE METER (WATER USAGE CHARGES SHALL BE PAID BY CONTRACTOR UNTIL PROJECT FINAL ACCEPTANCE BY CITY OF MESA). CONTRACTOR SHALL ORDER METER FROM DEVELOPMENT SERVICES.
- THE CONTRACTOR SHALL BE RESPONSIBLE FOR LOCATION THE UNDERGROUND SPRINKLER SYSTEM IN ADVANCE OF CONSTRUCTION. THE SPRINKLER SYSTEM LOCATIONS NOTED ON PLANS ARE FOR REFERENCE ONLY.
- CONTRACTOR TO VERIFY DEPTH OF ALL INLET STRUCTURES AND SPRINKLER SYSTEMS PRIOR TO TRENCHING FOR LOW-FLOW CHANNEL.
- CONTRACTOR TO PROVIDE PUMPING WITHIN FIVE (5) DAYS AFTER THE NOTICE TO PROCEED IS GIVE AS REQUIRED TO DRY THE AREA SUFFICIENTLY TO BEGIN CONSTRUCTION.
- CONTRACTOR SHALL ARRANGE FOR SPRINKLER SYSTEM SHUT DOWN DURING CONSTRUCTION BY CONTACTING THE ENGINEERING INSPECTOR.
- NO ROCKS LARGER THAN 1" IN DIAMETER SHALL BE ALLOWED IN THE TOP SIZE (6) INCHES OF TOPSOIL WHERE TURF ESTABLISHMENT IS SPECIFIED. ROCK REMOVALS AS NECESSARY IS INCLUDED IN THIS PROJECT.
- WHERE CALICHE IS ENCOUNTERED IN PLANT PITS, DEPTH AND WIDTH OF PIT SHALL BE INCREASED BY ONE-THIRD (1/3) OVER SPECIFICATION, AND A LIQUID PENETRATION "AL-KALICHE" OR EQUAL SHALL BE INCORPORATED FOR EACH PIT PER MANUFACTURERS RECOMMENDATIONS.
- PROJECT RECORD DRAWINGS FOR IRRIGATION SYSTEM:
A) MAINTAIN ON SITE AND SEPARATE FROM DOCUMENTS USED FOR CONSTRUCTION ,ONE COMPLETE SET OF CONTACT DOCUMENTS AS PROJECT RECORDS DOCUMENTS. KEEP DOCUMENT CURRENT. DON NOT PERMANENTLY COVER WORK UNTIL AS-BUILT INFORMATION IS RECORDED.
B) RECORD PIPE AND WIRING NETWORK ALTERATIONS. RECORD WORK WHICH IS INSTALLED DIFFERENTLY THAN SHOWN ON THE CONSTRUCTION DRAWINGS. RECORD ACCURATE REFERENCE DIMENSIONS, MEASURED FROM AT LEAST 2 PERMANENT REFERENCE POINT OF EACH IRRIGATION SYSTEM VALVE , EACH BACKFLOW PREVENTION DEVICE, EACH CONTROLLER OR CONTROL UNIT, EACH SLEEVE END, EACH STU-OUT FOR FUTURE PIPE OR WIRING CONNECTIONS, AND OTHER IRRIGATION COMPONENTS ENCLOSED WITHIN A VALVE BOX.
- FOR PARKS RETENTION BASINS: CONTRACTOR SHALL INSTALL DECOMPOSED GRANITE TO A ROLLED DEPTH OF TWO (2) INCHES. DECOMPOSED GRANITE SHALL BE 1/2" MINUS WITH THE COLOR AS SPECIFIED ON THE PLANS. PRE-EMERGENT HERBICIDE SHALL BE APPLIED BEFORE AND AFTER PLACEMENT OF DECOMPOSED GRANITE PER THE MANUFACTURES RECOMMENDATIONS. PRE-EMERGENT HERBICIDE SHALL BE SURFALAN, DACTHAL, OR APPROVED EQUAL, NOT MORE THAN 8% OF DECOMPOSED GRANITE SHALL PASS THROUGH A #200 MESH SCREEN, 15% THROUGH A #40 MESH SCREEN, 98% THROUGH A #4 MESH SCREEN, AND 100% SHALL PASS THROUGH A 1/2" MESH SCREEN. SAMPLE TO BE PROVIDED FOR CITY REVIEW AND APPROVAL.
- FOR STREET LANDSCAPE PROJECT: CONTRACTOR SHALL INSTALL DECOMPOSED GRANITE AS FOLLOWS:
A) DECOMPOSED GRANITE GROUND COVER SHALL BE 1/2" SIZE SCREENED AND WASHED.
B) PLACE AND ROLL TO TWO (2) INCH TOTAL DEPTH OVER 85% COMPACTED SUB-GRADE.
C) PRE-EMERGENT HERBICIDE SURFLAN, DACTHAL, OR APPROVED EQUAL SHALL BE APPLIED BEFORE AND AFTER GRANITE PLACEMENT.
D) DECOMPOSED GRANITE SAMPLE SHALL BE PROVIDED IN A RIGID PLASTIC CONTAINER FOR CITY REVIEW AND APPROVAL.
- RESTORE ALL EXISTING LANDSCAPE IRRIGATION SYSTEMS, COMPONENTS, AND LANDSCAPE AREAS IMPACTED BY ANY WORK UNDER THIS CONTACT. RESTORE ALL EXISTING IRRIGATION AND LANDSCAPE IN ACCORDANCE WITH THE LANDSCAPE RESTORATION NOTES INDICATED WITHIN THESE DOCUMENTS. AT A MINIMUM, ALL RESTORATION SHALL BE IN ACCORDANCE WITH MAG SPECIFICATION 107.9 - PROTECTION AND RESTORATION OF PROPERTY AND LANDSCAPE . ALL RESTORATION WORK SHALL BE COMPLETED TO THE SATISFACTION OF THE CITY OF MESA ENGINEER.
- ALL RESTORATION WORK SHALL BE COMPLETED IN ACCORDANCE WIT THE DETAILS PROVIDED.
- REFER TO LANDSCAPE PLANTING SHEETS AND ENGINEERING DRAWINGS FOR ADDITIONAL RESTORATION NOTES AND REQUIRED COORDINATION.

SHEET INDEX

SHEET	TITLE
L0.1	LANDSCAPE COVER
L10	LANDSCAPE PLAN
L2.0	IRRIGATION PLAN
L3.0	LANDSCAPE DETAILS
L4.0-4.1	IRRIGATION DETAILS

OWNER CONTACT

CHILD CRISIS ARIZONA
817 N. COUNTRY CLUB DRIVE
MESA, ARIZONA 85201
JACOB PROUD
(480) 834-9424

LANDSCAPE ARCHITECT

HARRINGTON PLANNING + DESIGN (HP+D)
3116 S. MILL AVENUE, SUITE 305
TEMPE, ARIZONA 85282
JASON HARRINGTON, RLA, ASLA, ASIC, APWA
(480) 250-0116
JASON@HARRINGTONPLANNINGDESIGN.COM

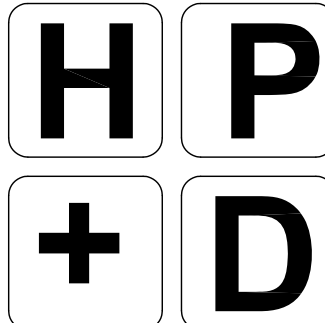

HARRINGTON
PLANNING + DESIGN

3116 S. Mill Avenue, Suite 305
Tempe, Arizona 85282
Tel: 480-250-0116
www.HarringtonPlanningDesign.com



Child Crisis Arizona
827 North Country Club Drive
Mesa, Arizona 85210

REV. COMMENT DATE

2ND REVIEW SET	01.29.19
1ST REVIEW SET	09.20.18
ISSUE	DATE

Landscape Plan

January 29, 2019	
DRAWN BY:	DCM
CHECK BY:	JEH
PROJ. NO.:	2018-040
CASE NO.:	NA

LANDSCAPE COVER

L0.1

1 of 6

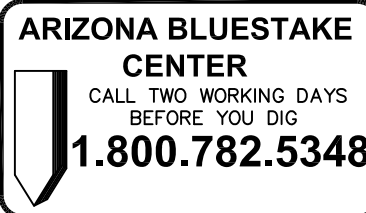

Reuse, reproduction by any method in part or in whole is prohibited without H+D written consent.

This drawing is an instrument of service and the property of Harrington Planning + Design and shall be restricted to the original site for which it was prepared and publication therefore is expressly limited to such use.

COUNTRY CLUB DR

N 00°21'03" E

SIGHT VISIBILITY TRIANGLE
PER CITY OF MESA
ENGINEERING AND DESIGN
STANDARDS, SECTION 211

EXISTING SIDEWALK TO
REMAIN

EXISTING CURB
AND GUTTER

EXISTING RW

SIGHT VISIBILITY TRIANGLE
PER CITY OF MESA
ENGINEERING AND DESIGN
STANDARDS, SECTION 211

EXISTING SIDEWALK TO
REMAIN

EXISTING 6' HIGH
WALL TO REMAIN

N.I.C.

S 89°49'26" E

121.00'

EXISTING OVERHEAD
POWER

EXISTING LANDSCAPE
TO REMAIN

EXISTING TREE
TO REMAIN

NEW 36" TALL SCREEN WALL
SEE CIVIL PLANS

PROPOSED
PARKING LOT
APN: 137-23-090

NEW 36" TALL SCREEN WALL
SEE CIVIL PLANS

NEW SIGN
SEE CIVIL PLANS

N.I.C.

CITY OF MESA
LANDSCAPE CALCULATIONS

	REQUIRED	PROVIDED
PERIMETER LANDSCAPE PER 11-33-3 MESA Z/O ARTERIAL STREET - U DESIGNATE	3 TREE / 24 SHRUB PER 100 FT FRONTAGE	COUNTRY CLUB DRIVE: 148' = 148 x 3 (4.44 TREES): 5 TREES PROVIDED. 148' = 148 x 24 (35.52 SHRUBS) 66 SHRUBS PROVIDED
COVERAGE AREA	50% OF LS AREA	55% COVERAGE
INTERIOR PARKING LANDSCAPE PER 11-33-4 MESA Z/O	1 TREE / 3 SHRUB PER PLANTER ISLAND	2 TREE / 3.5 SHRUB PROVIDED PER PARKING ISLAND (AVERAGE)
FOUNDATION LANDSCAPE PER 11-33-5 MESA Z/O*	1 TREE / 50 LF BUILDING FACE	NOT APPLICABLE - NO STRUCTURE THIS PROJECT

PLANTING MATERIAL LEGEND

TREES	SIZE	NOTES	QTY
Acacia mulga Mulga Caliper Size: 1.5"	24" Box	*ADWR	11
Quercus virginiana Live Oak Caliper Size: 2.5"	36" Box	*ADWR	4
GROUNDCOVERS			QTY
Lantana montevidensis Trailing Lantana - Dallas Red	5 Gallon	*ADWR	18
Gazania rigens Trailing Gazania	5 Gallon	*ADWR	35
SHRUBS / ACCENTS			QTY
Hesperaloe parviflora 'brakelights' Red Yucca 'Brakelights'	5 Gallon	*ADWR	36
Leucophyllum frutescens Texas Ranger Sage	5 Gallon	*ADWR	21
Caesalpinia pulcherrima Red Bird of Paradise	5 Gallon	*ADWR	4
Muhlenbergia capillaris Regal Mist Grass	5 Gallon	*ADWR	15
LANDSCAPE MATERIALS			
Decomposed Granite. 3/4" screened "Express Gold" 2" deep in planting areas per plan. Match existing color/size.			6,860 sq ft
*ADWR = Arizona Department of Water Resources Approved Low-Water Use Plant			

SITE LANDSCAPE NOTES

1. FIELD VERIFY EXISTING SITE PRIOR TO BID AND CONSTRUCTION.
2. REFER TO CIVIL ENGINEERING PLANS FOR VERTICAL AND HORIZONTAL CONTROL.
3. PROTECT ALL UTILITIES DURING CONSTRUCTION.

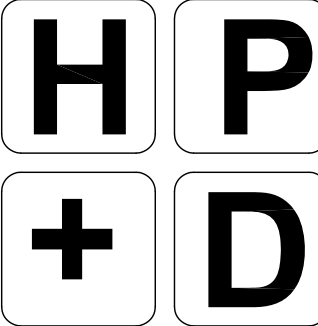

HARRINGTON
PLANNING + DESIGN

3116 S. Mill Avenue, Suite 305
Tempe, Arizona 85282
Tel: 480-250-0116
www.HarringtonPlanningDesign.com



Child Crisis Arizona
827 North Country Club Drive
Mesa, Arizona 85210

REV. COMMENT DATE

2ND REVIEW SET 01.29.19

1ST REVIEW SET 09.20.18

ISSUE DATE

Landscape Plan

January 29, 2019

DRAWN BY: DCM

CHECK BY: JEK

PROJ. NO.: 2018-040

CASE NO.: NA

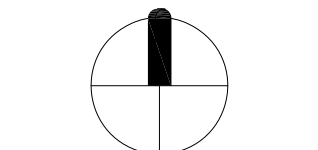

0 5 10 20

LANDSCAPE
PLAN

L1.0

2 of 6

ARIZONA BLUESTAKE
CENTER
CALL TWO WORKING DAYS
BEFORE YOU DIG
1.800.782.5348

COUNTRY CLUB DR

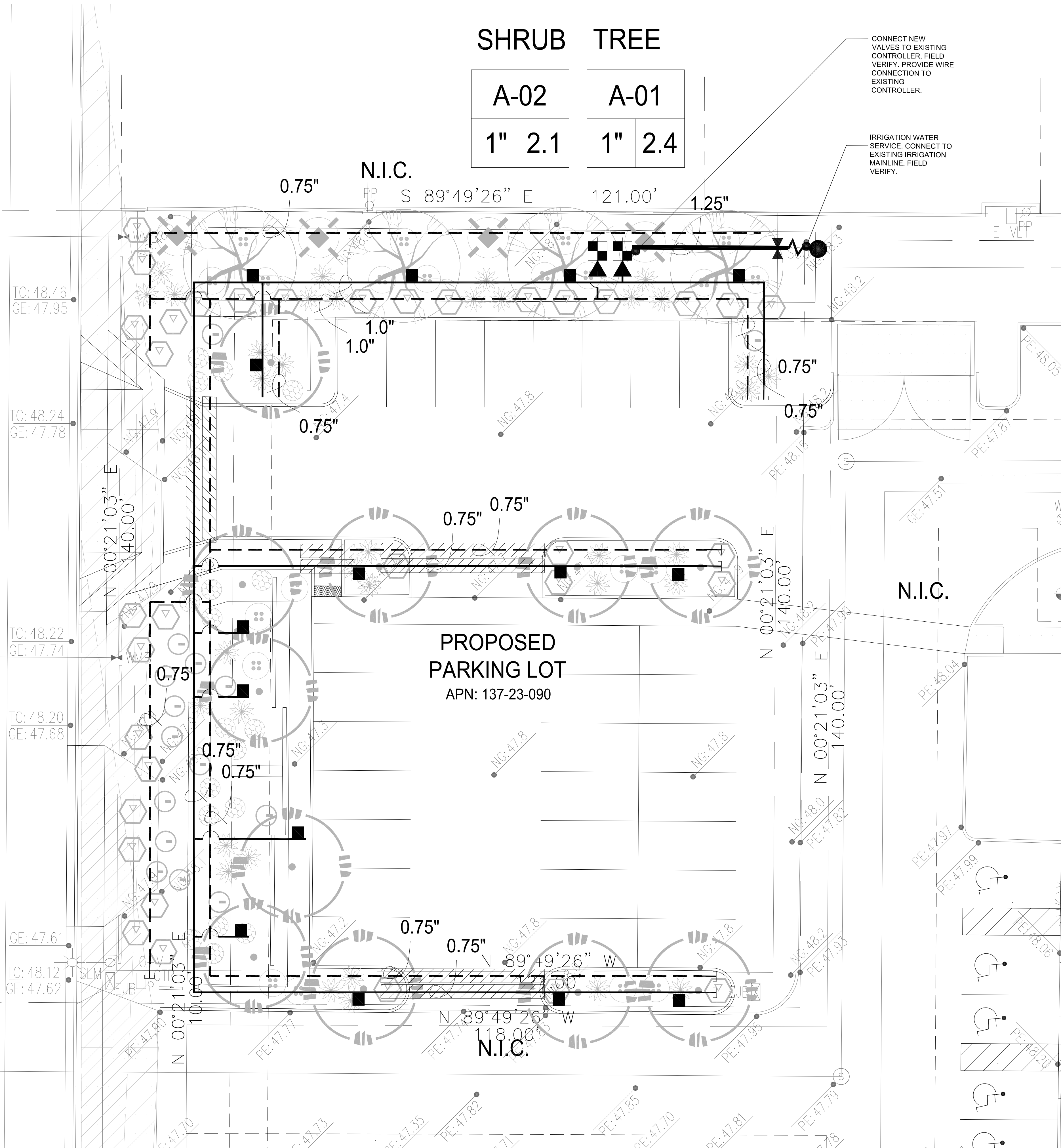

1. FIELD VERIFY EXISTING SITE PRIOR TO BID AND CONSTRUCTION.
2. REFER TO CIVIL ENGINEERING PLANS FOR VERTICAL AND HORIZONTAL CONTROL.
3. PROTECT ALL UTILITIES DURING CONSTRUCTION.
4. ALL VENDOR PRODUCTS LISTED MAY BE SUBMITTED WITH COMPARABLE / EQUAL AS APPROVED BY OWNER.

Child Crisis Arizona
827 North Country Club Drive
Mesa, Arizona 85210

REV.	COMMENT	DATE
	2ND REVIEW SET	01.29.19
	1ST REVIEW SET	09.20.18
	ISSUE	DATE

January 29, 2019	
DRAWN BY:	DCM
CHECK BY:	JEH
PROJ. NO.:	2018-040
CASE NO.:	NA

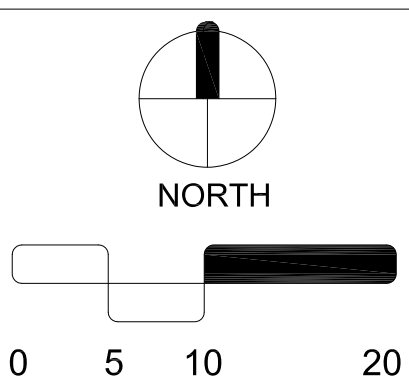

L2.0

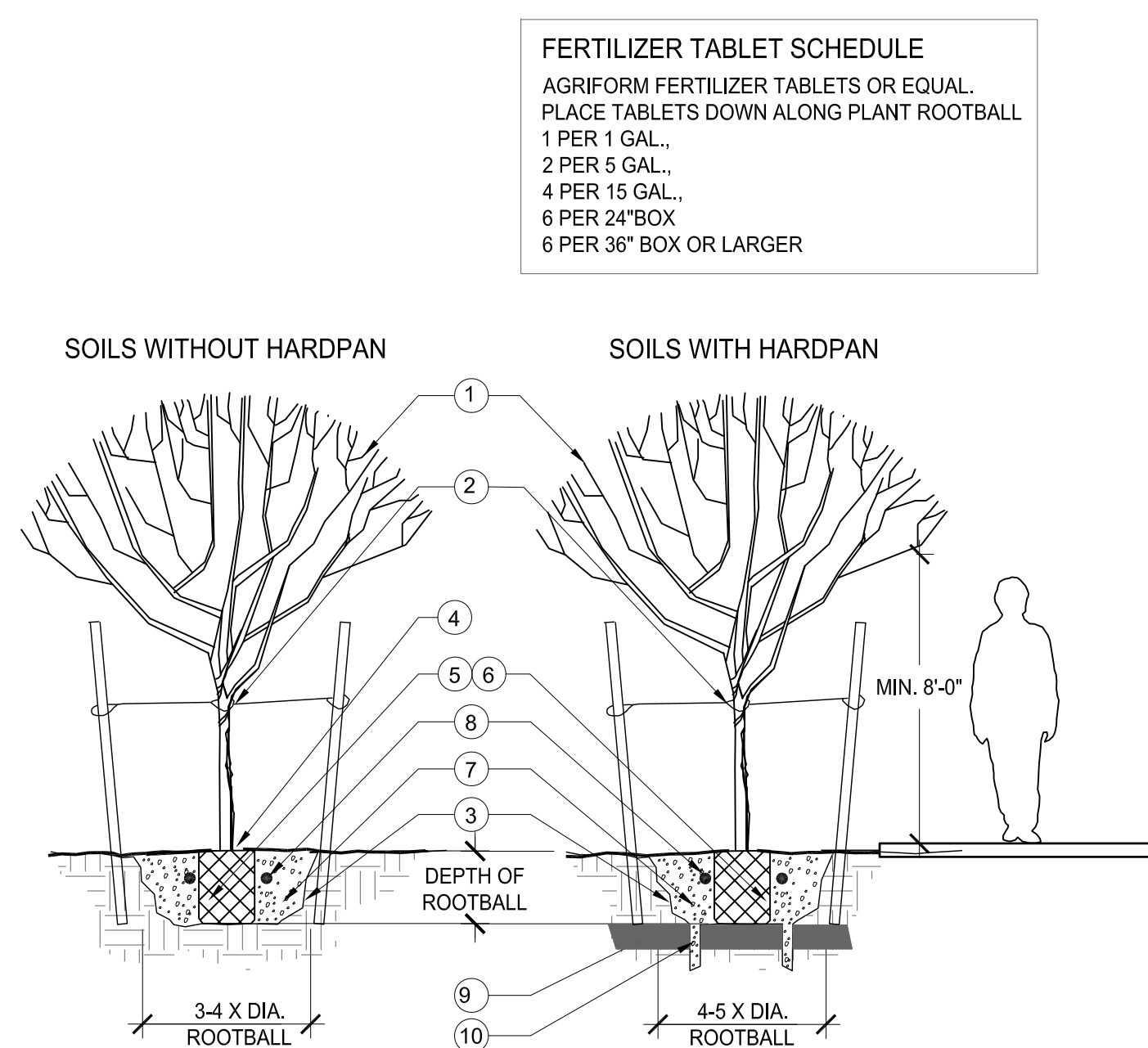

1 TREE PLANTING

SCALE: N.T.S.

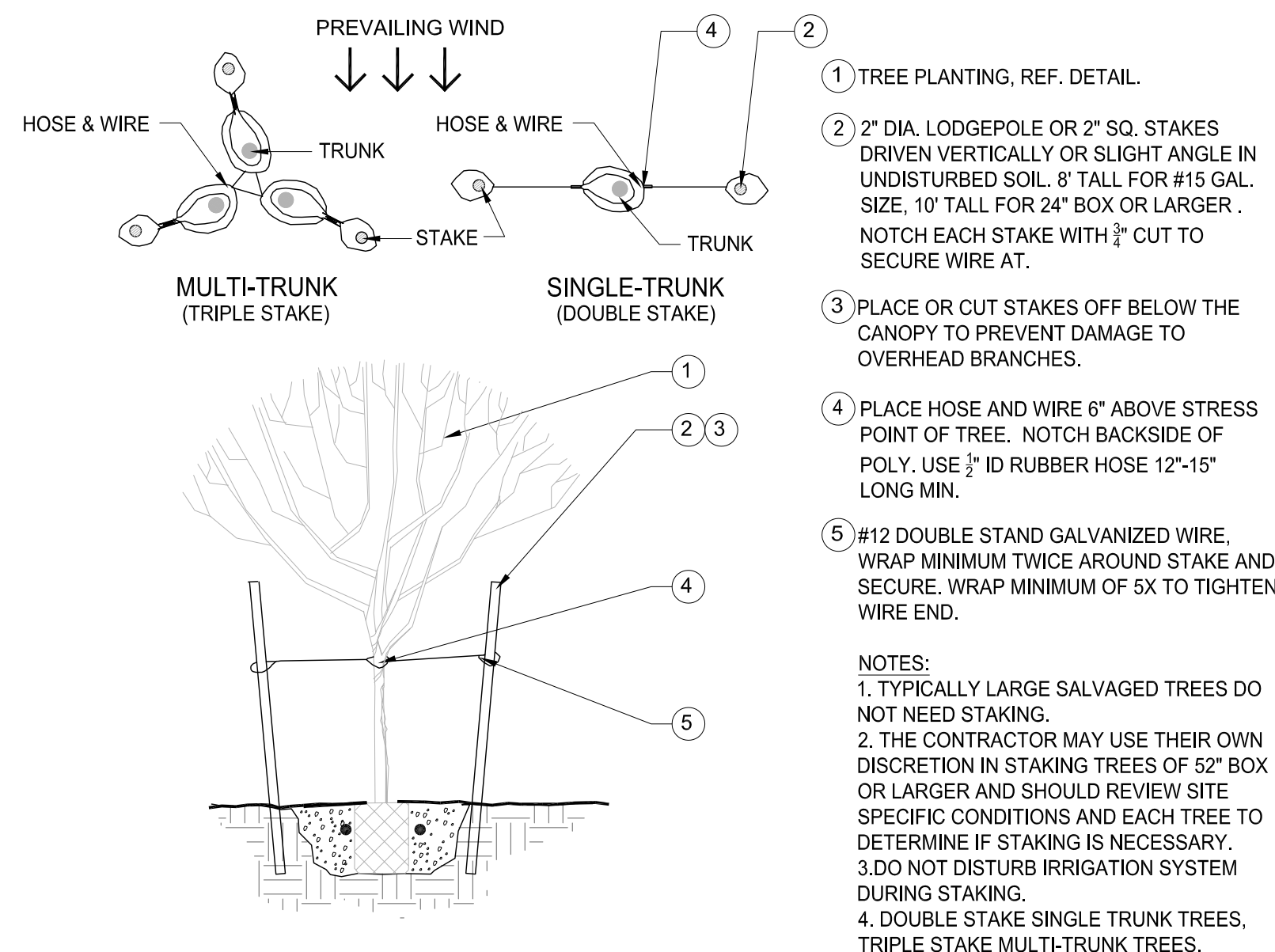

2 TREE STAKING DETAIL

SCALE: N.T.S.

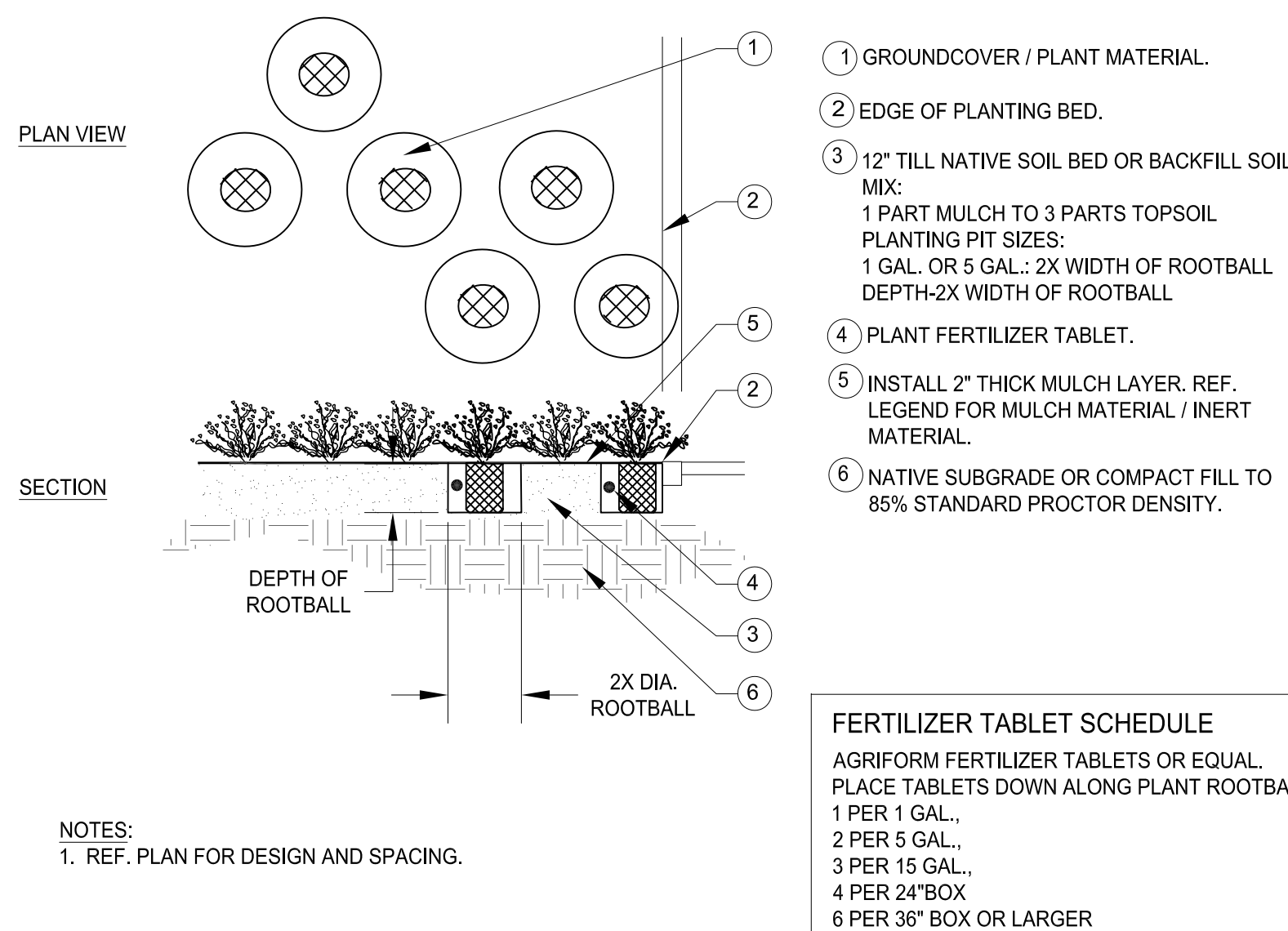

GROUNDCOVER PLANTING

SCALE: N.T.S.

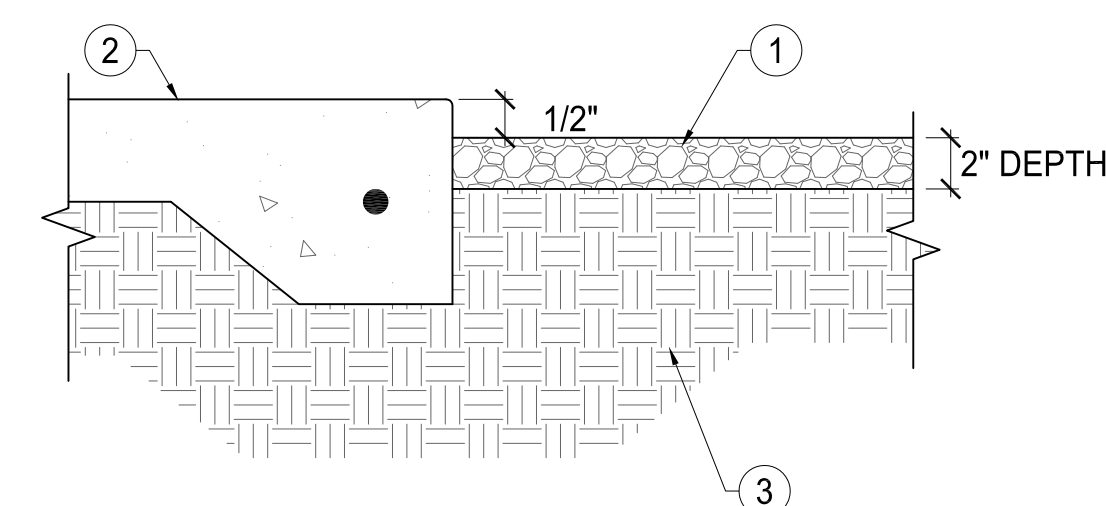

CONCRETE / GRANITE TRANSITION

SCALE: N.T.S.

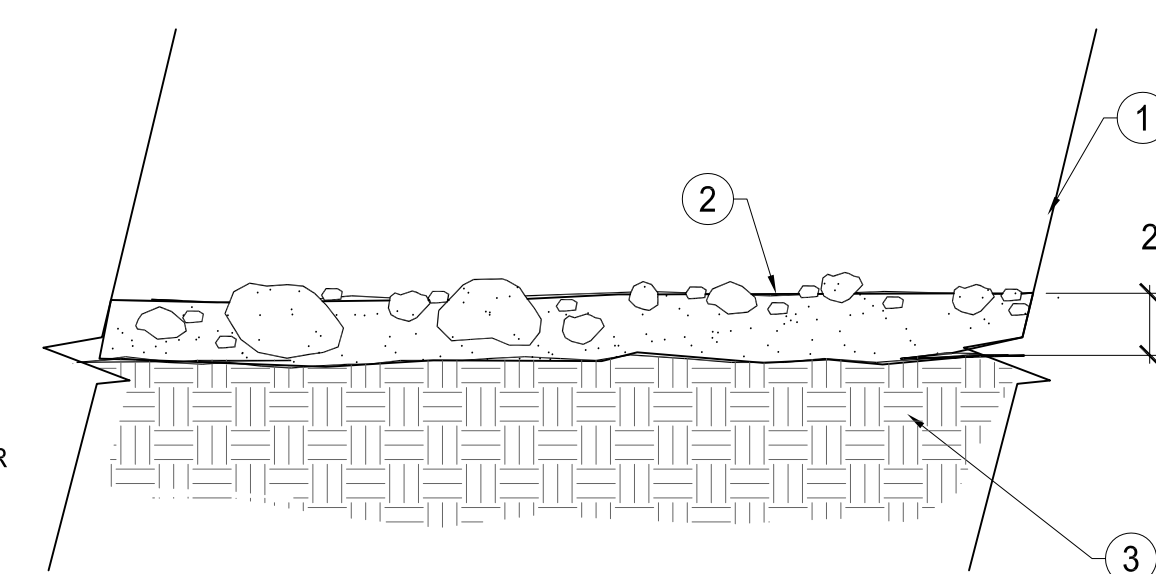

GRANITE INSTALLATION

SCALE: N.T.S.

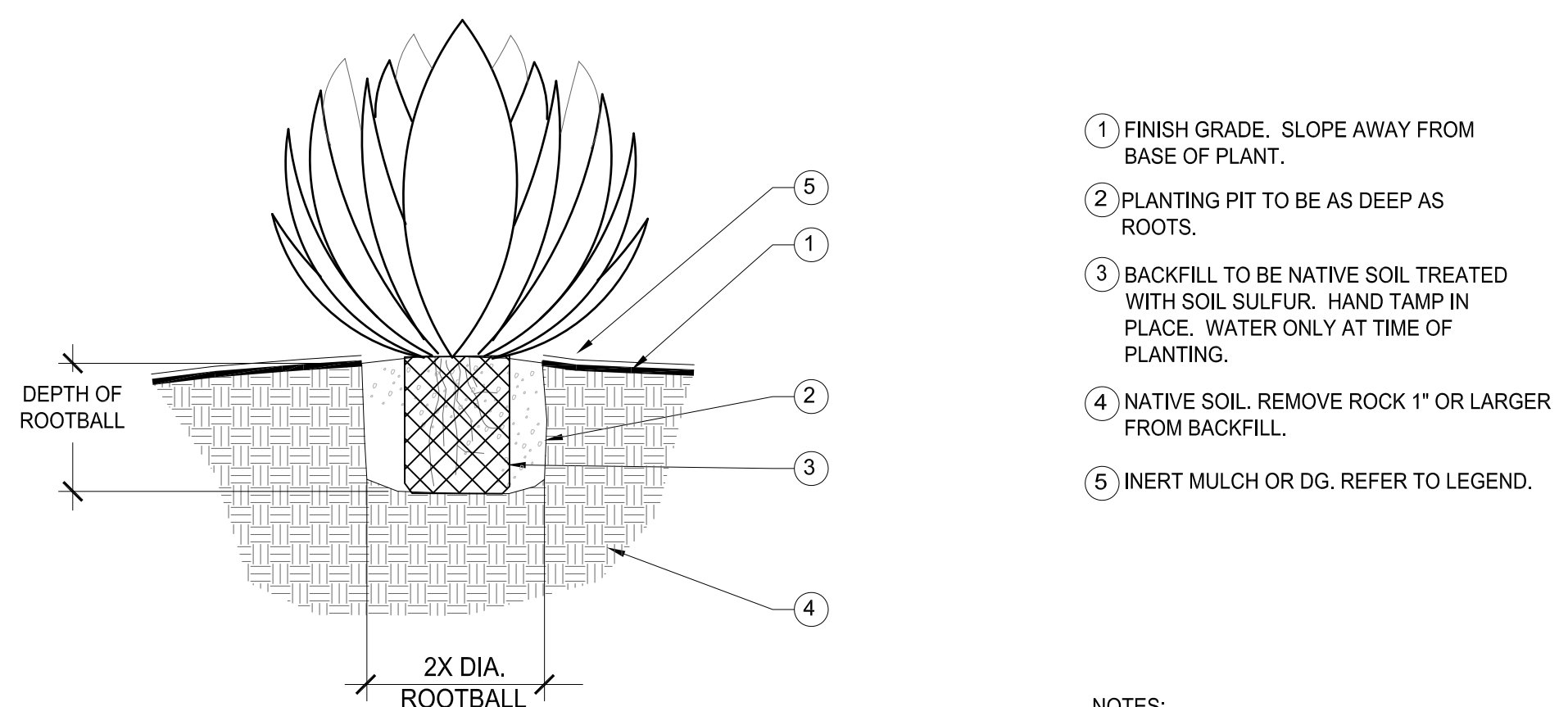

ACCENT PLANTING - CONTAINER

SCALE: N.T.S.

- 1 TREE.
- 2 REF. STAKING DETAIL.
- 3 WALLS OF UNDISTURBED SOIL SHOULD BE SLOPED WITH ROUGH EDGES.
- 4 TOP OF ROOTBALL FLUSH OR SLIGHTLY ABOVE FINISH GRADE.
- 5 PLACE ROOTBALL ON UNDISTURBED SOIL.
- 6 FREE OR CUT CIRCLING ROOTS (UNLESS PLANTS ARE KNOWN TO HAVE SENSITIVE ROOTS HANDLED WITH MINIMAL DISTURBANCE).
- 7 BACKFILL:
PER SOIL AMENDMENT MIX OR NATIVE MATERIAL IF NONE DESCRIBED.
- 8 FERTILIZER TABLET. REFER TO FERTILIZER TABLET SCHEDULE.
- 9 UNDISTURBED HARDPAN
- 10 DIG A MIN. OF 3 DRAINAGE CHIMNEY HOLES BESIDE ROOT BALL AND THROUGH HARDPAN

NOTES:
1. TRIM AND MAINTAIN TO PROVIDE A MINIMUM 8'-0" CLEARANCE FROM PATH TO TREE CANOPY.

- 1 TREE PLANTING, REF. DETAIL.
- 2 2" DIA. LODGEPOLE OR 2" SO. STAKES
DRIVEN VERTICALLY OR SLIGHT ANGLE IN
UNDISTURBED SOIL. 8" TALL FOR #15 GAL.
SIZE, 10" TALL FOR 24" BOX OR LARGER.
NOTCH EACH STAKE WITH $\frac{3}{8}$ " CUT TO
SECURE WIRE AT.
- 3 PLACE OR CUT STAKES OFF BELOW THE
CANOPY TO PREVENT DAMAGE TO
OVERHEAD BRANCHES.
- 4 PLACE HOSE AND WIRE 6" ABOVE STRESS
POINT OF TREE. NOTCH BACKSIDE OF
POLY. USE $\frac{1}{2}$ " ID RUBBER HOSE 12"-15"
LONG MIN.
- 5 #12 DOUBLE STAND GALVANIZED WIRE.
WRAP MINIMUM TWICE AROUND STAKE AND
SECURE. WRAP MINIMUM OF 5X TO TIGHTEN
WIRE END.

NOTES:

1. TYPICALLY LARGE SALVAGED TREES DO NOT NEED STAKING.
2. THE CONTRACTOR MAY USE THEIR OWN DISCRETION IN STAKING TREES OF 52" BOX OR LARGER AND SHOULD REVIEW SITE SPECIFIC CONDITIONS AND EACH TREE TO DETERMINE IF STAKING IS NECESSARY.
3. DO NOT DISTURB IRRIGATION SYSTEM DURING STAKING.
4. DOUBLE STAKE SINGLE TRUNK TREES, TRIPLE STAKE MULTI-TRUNK TREES.

2 SHRUB PLANTING

SCALE: N.T.S.

- ① PLANT.
- ② WALLS OF UNDISTURBED SOIL SHOULD BE SLOPED WITH ROUGH EDGES.
- ③ TOP OF ROOTBALL FLUSH OR SLIGHTLY ABOVE FINISH GRADE.
- ④ PLANT ROOTBALL ON UNDISTURBED SOIL.
- ⑤ FREE OR CUT CIRCLING ROOTS (UNLESS PLANTS ARE KNOWN TO HAVE SENSITIVE ROOTS HANDLE WITH MINIMAL DISTURBANCE).
- ⑥ BACKFILL:
PER SPECIFIED SOIL AMENDMENT MIX, OR NATIVE MATERIAL IF NONE DESCRIBED.
REMOVE ALL ROCK 1" OR GREATER FROM BACKFILL.
- ⑦ FERTILIZER TABLET. REFER TO FERTILIZER TABLET SCHEDULE .
- ⑧ INERT MULCH OR DG. REFER TO LEGEND.

NOTES:
1. PROVIDE ADEQUATE DRAINAGE. REFER TO DETAIL REGARDING SOILS WITH HARDPAN OR CALICHE.

FERTILIZER TABLET SCHEDULE
 AGRIFORM FERTILIZER TABLETS OR EQUAL.
 PLACE TABLETS DOWN ALONG PLANT ROOTBALL

1 PER 1 GAL.,
2 PER 5 GAL.,
4 PER 15 GAL.,
6 PER 24" BOX
6 PER 36" BOX OR LARGER

- ① DECOMPOSED GRANITE PER PLANTING LEGEND.
- ② FINISH GRADE PER PLANS. ENSURE PLANTING AREAS ARE FREE OF DEBRIS AND WEEDS.
- ③ COMPACT TO 85% PROCTOR DENSITY. PRE-TREAT FINISH GRADED LANDSCAPE AREAS WITH PRE-EMERGENT CHEMICAL APPLICATION.

NOTES:

1. COORDINATE FINAL GRADES WITH LANDSCAPE ARCHITECT AND PER PLANS.
2. REAPPLY DG TO AREAS THAT SETTLE.
3. WET DG ROCK AFTER INSTALL TO REMOVE DUST AND SETTLE ROCK.
4. WASH DG FROM ADJACENT PAVEMENTS.
5. APPLY POST EMERGENT WEED CONTROL AFTER LANDSCAPE INSTALL COMPLETED.

- ① DECOMPOSED GRANITE PER PLANTING LEGEND.
- ② CONCRETE CURB OR WALK PER CIVIL PLANS.
- ③ ENSURE PLANTING AREAS ARE FREE OF DEBRIS AND WEEDS. COMPACT TO 85% PROCTOR DENSITY. PRE-TREAT FINISH GRADED LANDSCAPE AREAS WITH PRE-EMERGENT CHEMICAL APPLICATION.

NOTES:

1. COORDINATE FINAL GRADES WITH LANDSCAPE ARCHITECT AND PER CIVIL PLANS.
2. REAPPLY DG TO AREAS THAT SETTLE.
3. WET DG ROCK AFTER INSTALL TO REMOVE DUST AND SETTLE ROCK.
4. WASH DG FROM ADJACENT PAVEMENTS
5. APPLY POST EMERGENT WEED CONTROL AFTER LANDSCAPE INSTALL COMPLETED.

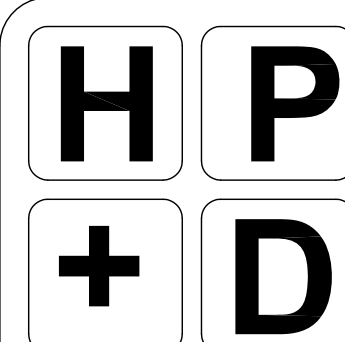

HARRINGTON
PLANNING + DESIGN

3116 S. Mill Avenue, Suite 300
Tempe, Arizona 85282
Tel: 480-250-0116
www.HarringtonPlanningDesign.com



Child Crisis Arizona
827 North Country Club Drive
Mesa, Arizona 85210

REV.	COMMENT	DATE
------	---------	------

2ND REVIEW SET	01.29.19
1ST REVIEW SET	09.20.18
ISSUE	DATE

Landscape Plan

January 29, 2019

DRAWN BY:	DCM
CHECK BY:	JEH
PROJ. NO.:	2018-040
CASE NO.:	NA

LANDSCAPE
DETAILS

L3.0

4 of 6

Reuse, reproduction by any method in part or in whole is prohibited without HP+D written consent.

This drawing is an instrument of service and the property of Harrington Planning + Design and shall be restricted to the original site for which it was prepared and publication therefore is expressly limited to such use.

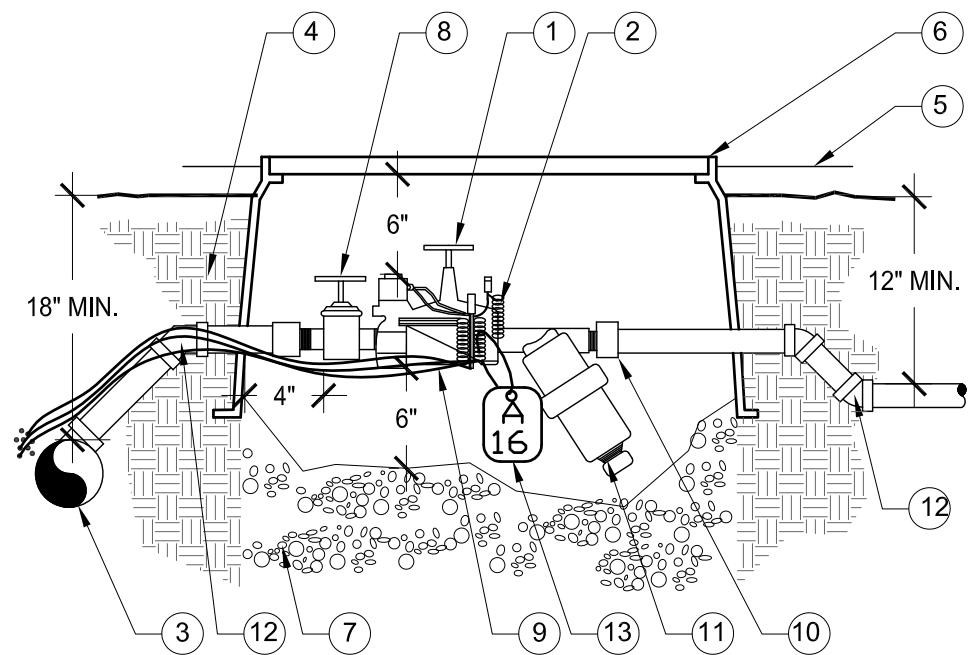

NOTES:

1. PROVIDE EXPANSION COILS AT EACH WIRE CONNECTION IN VALVE BOX. (WRAP WIRE AROUND PIPE 15 TIMES).
2. SET VALVE BOX PARALLEL W/ GRADE.
3. SEAL THREADED JOINTS WITH TEFLON .
4. DO NOT REST VALVE BOX ON MAIN LINE.
5. LOCATE ONLY 1 VALVE ASSEMBLY PER VALVE BOX
6. PROVIDE SUPPORT BRICKS TO VALVE BOX AS NECESSARY.
7. PROVIDE STAINLESS STEEL FASTENERS FOR LOCKING COVER.

1 DRIP VALVE ASSEMBLY

SCALE: N.T.S.

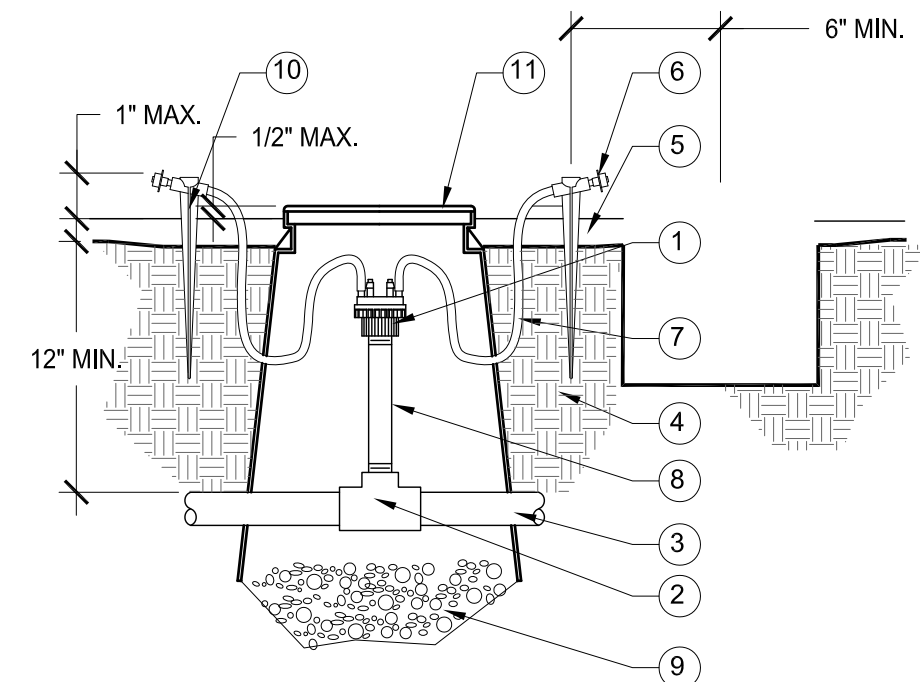

NOTES:

1. MULTI PORT EMITTER FOR TREES AND MASSES PLANTS ONLY.
2. TEFLON SEAL ALL THREAD JOINTS.
3. ON SLOPE CONDITIONS, PLACE EMITTER ON UPHILL SIDE OF PLANT.
4. DO NOT DISTURB ROOTBALL WITH PVC PIPE.
5. SPACE EMITTER TUBING EQUALLY AROUND DRIP LINE OF TREE.
6. INSTALL EMITTERS ONLY AFTER SYSTEM FLUSH OF LATERALS.
7. PROVIDE SUPPORT BRICKS TO VALVE BOX AS NECESSARY.
8. PROVIDE STAINLESS STEEL FASTENERS FOR LOCKING COVER.

4 MULTI PORT EMITTER W/ DISTRIBUTION TUBING

SCALE: N.T.S.

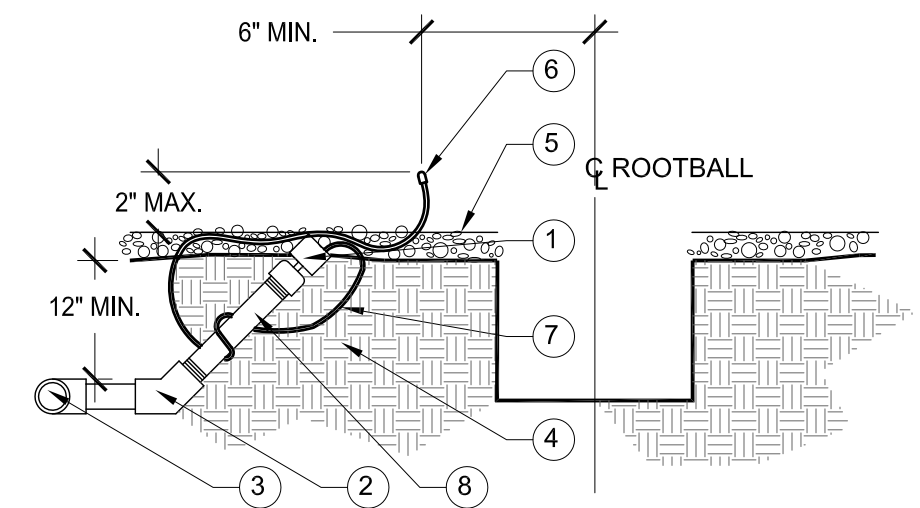

NOTES:

1. SINGLE PORT EMITTER FOR SHRUBS, ACCENTS, AND GROUND COVERS ONLY.
2. SEAL THREAD JOINTS WITH TEFLON .
3. SLOPE CONDITIONS: PLACE EMITTER ON UPHILL SIDE OF PLANT.
4. DO NOT DISTURB ROOTBALL WITH PVC PIPE.
5. INSTALL EMITTERS ONLY AFTER SYSTEM FLUSH OF LATERALS.

7 SINGLE PORT EMITTER W/ DISTRIBUTION TUBING

SCALE: N.T.S.

- 1 ELECTRIC REMOTE VALVE PER LEGEND.
- 2 EPOXY FILLED CYLINDER WIRE CONNECTORS.
- 3 PVC SCH 40 MAINLINE.
- 4 COMPACT SOIL AROUND CONTROL VALVE PIT ASSEMBLY TO SAME DENSITY AS UNDISTURBED ADJACENT SOIL.
- 5 FINISH GRADE / TOP OF DG.
- 6 12" VALVE BOX WITH LOCKING COVER, CARSON, AMETEK, OR APPROVED EQUAL. TAN COLOR IN DG, GREEN IN TURF.
- 7 3/8" WASHED PEA GRAVEL SUMP, 2 CU. FT MIN.
- 8 PVC ISOLATION BALL VALVE.
- 9 CONTROLLER WIRE, TAPE AND BUNDLE AT 10' INTERVALS.
- 10 PVC SCH 80 UNION.
- 11 WYE FILTER (#150 MESH) WITH STAINLESS STEEL SCREEN, POSITION TO ONE SIDE AND DOWNWARD.
- 12 PVC SCH 80 FITTINGS.
- 13 VALVE TAG. STANDARD VALVE I.D. AND LETTER TO CORRESPOND TO CONTROLLER AND VALVE NUMBER. AFFIX TO CONTROL WIRE W/ ELECTRICAL WIRE TIE.

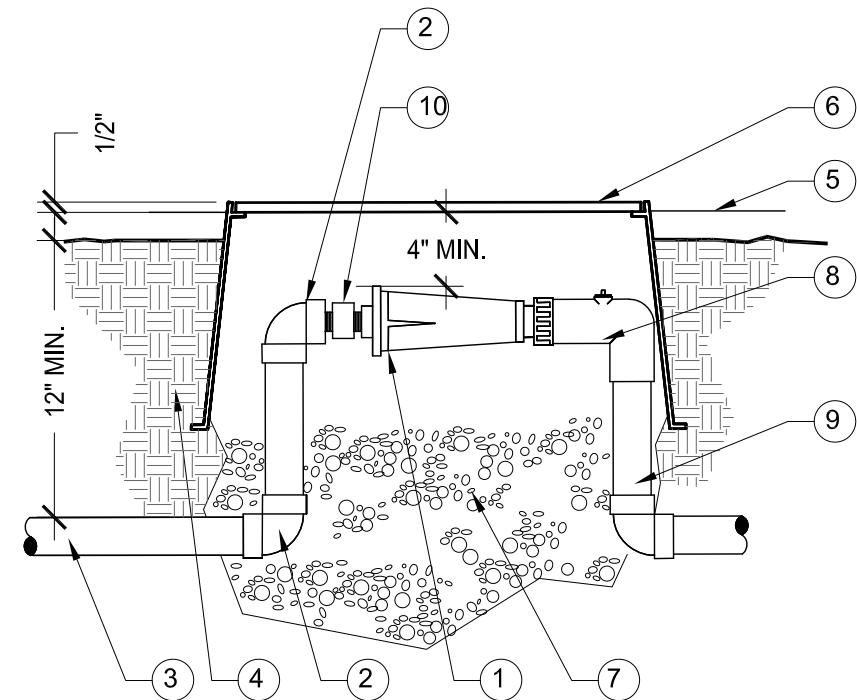

NOTES:

1. SET VALVE BOX PARALLEL WITH GRADE.
2. SEAL THREADED JOINTS WITH TEFLON .
3. DO NOT REST VALVE BOX ON MAIN LINE.
4. LOCATE ONLY 1 PRESSURE REGULATOR PER VALVE BOX.
5. PROVIDE SUPPORT BRICKS TO VALVE BOX AS NECESSARY.
6. PROVIDE STAINLESS STEEL FASTENERS FOR LOCKING COVER.

2 PRESSURE REGULATOR - DRIP VALVE

SCALE: N.T.S.

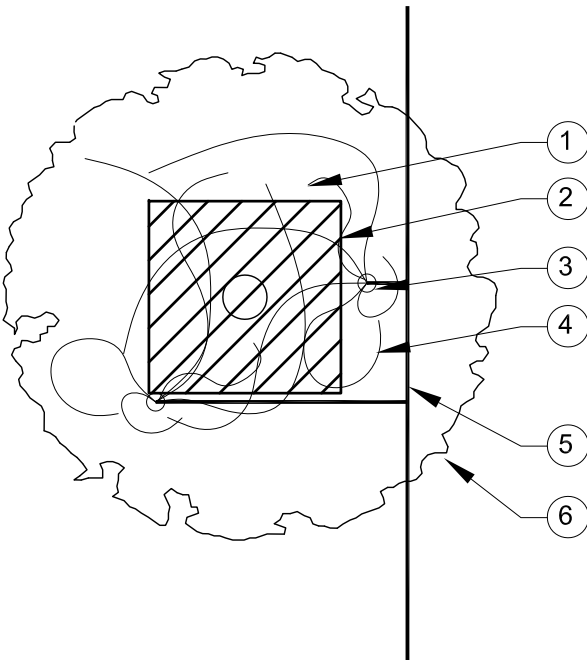

NOTES:

1. MAXIMUM LENGTH OF DISTRIBUTION TUBING SHALL BE 5 FEET.
2. PLACE EMISSION POINT AT EDGE OF ROOTBALL ON UPHILL SIDE OF PLANT.
3. ADJUST EMITTER LOCATIONS AS DRIPLINE OF TREE INCREASES WITH GROWTH.
4. PLACE 50% OF DISTRIBUTION TUBES OUTSIDE OF TREE ROOTBALL DURING INSTALL FOR FUTURE GROWTH.

5 EMITTER LOCATIONS - TREES

SCALE: N.T.S.

- 1 PRESET PRESSURE REGULATOR, 30 PSI OR PER LEGEND.
- 2 PVC SCH 80 FITTINGS.
- 3 PVC SCH 40 MAINLINE / LATERAL.
- 4 COMPACT SOIL AROUND PRESSURE REGULATOR ASSEMBLY TO SAME DENSITY AS UNDISTURBED ADJACENT SOIL.
- 5 FINISH GRADE / TOP OF DG.
- 6 12" VALVE BOX WITH LOCKING COVER, CARSON, AMETEK, OR APPROVED EQUAL. COLOR TO BE TAN IN DG, GREEN IN TURF.
- 7 3/8" WASHED PEA GRAVEL SUMP, 1 CU. FT. (12"X12"X12") MIN.
- 8 PCV ELL, 3/4" HT SWIVEL W/ SCHRADER PRESSURE CHECK VALVE.
- 9 PVC SCH 40 LATERAL OR PER IRRIGATION LEGEND.
- 10 PVC SCH 80 UNION.

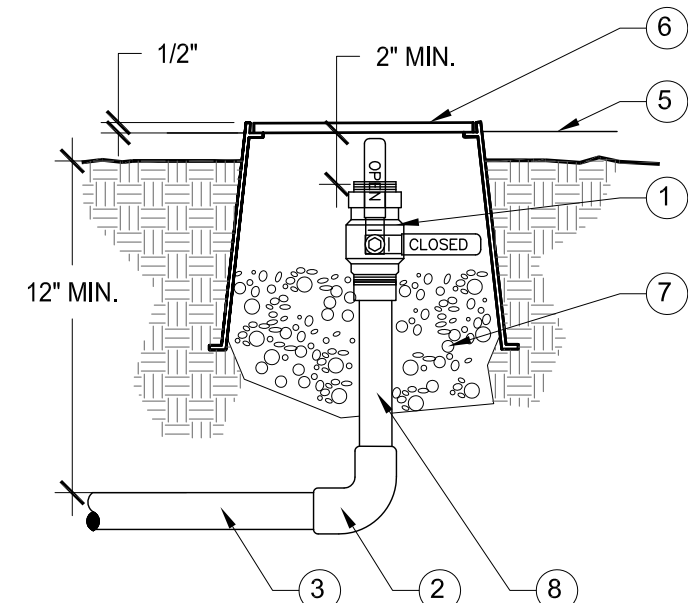

NOTES:

1. SET VALVE BOX PARALLEL W/ GRADE.
2. SEAL THREADED JOINTS WITH TEFLON .
3. DO NOT REST VALVE BOX ON MAIN LINE.
4. LOCATE ONLY ONE FLUSH CAP PER VALVE BOX.
5. PROVIDE SUPPORT BRICKS TO VALVE BOX AS NECESSARY.
6. PROVIDE STAINLESS STEEL FASTENERS FOR LOCKING COVER.

3 DRIP BALL VALVE FLUSH CAP

SCALE: N.T.S.

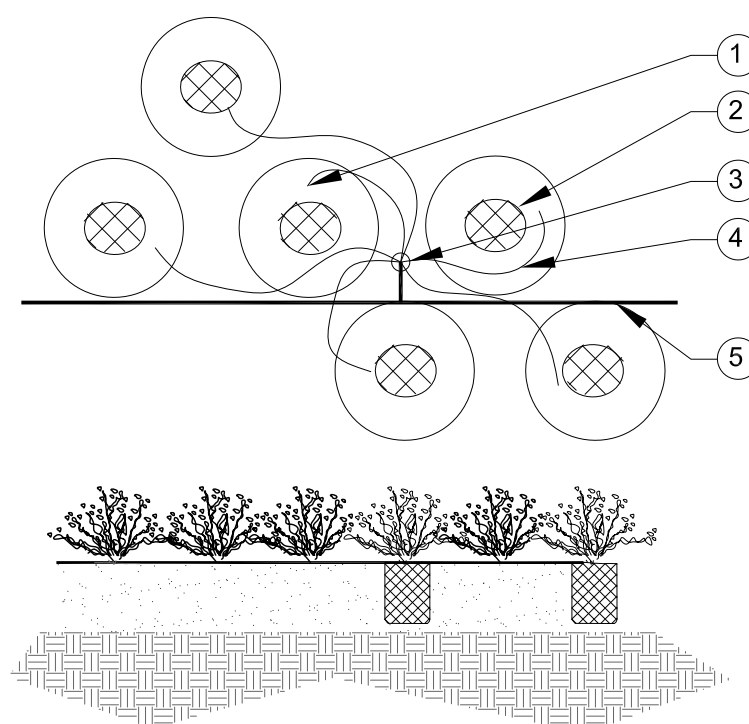

NOTES:

1. MORE THAN ONE SHRUB MAY BE WATERED FROM A SINGLE MULTI-PORT EMITTER.
2. MAXIMUM LENGTH OF DISTRIBUTION TUBING SHALL BE 5 FEET.
3. IF MORE THAN ONE DISTRIBUTION TUBE USED PER SHRUB, EQUALLY SPACE AROUND PLANT ROOTBALL.
4. PLACE EMISSION POINT AT EDGE OF ROOTBALL ON UPHILL SIDE OF PLANT.

6 EMITTER LOCATIONS - SHRUBS

SCALE: N.T.S.

- 1 BRONZE 1/2" THREADED FULL-PORT BALL VALVE.
- 2 PVC SCH 80 FITTINGS.
- 3 PVC SCH 40 LATERAL OR PER IRRIGATION LEGEND.
- 4 COMPACT SOIL AROUND FLUSH CAP ASSEMBLY TO SAME DENSITY AS UNDISTURBED ADJACENT SOIL.
- 5 FINISH GRADE / TOP OF DG.
- 6 VALVE BOX WITH LOCKING COVER, CARSON, AMETEK, OR APPROVED EQUAL. 10" MIN. SIZE. COLOR TO BE TAN IN DG, GREEN IN TURF.
- 7 3/8" WASHED PEA GRAVEL SUMP, 1 CU. FT MIN.
- 8 PVC SCH 80 1/2" NIPPLE RISER (LENGTH AS REQUIRED).

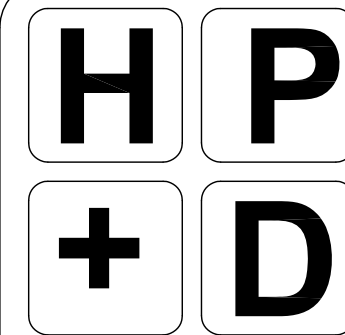

HARRINGTON
PLANNING + DESIGN

3116 S. Mill Avenue, Suite 305
Tempe, Arizona 85282
Tel: 480-250-0116
www.HarringtonPlanningDesign.com



Child Crisis Arizona
827 North Country Club Drive
Mesa, Arizona 85210

REV. COMMENT DATE

2ND REVIEW SET 01.29.19
1ST REVIEW SET 09.20.18
ISSUE DATE

Landscape Plan

January 29, 2019

DRAWN BY: DCM
CHECK BY: JEH
PROJ. NO.: 2018-040
CASE NO.: NA

IRRIGATION DETAILS

L4.0

5 of 6

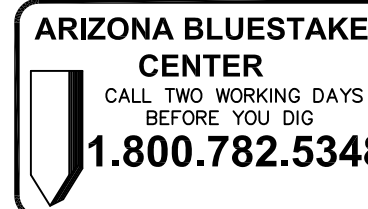

Reuse, reproduction by any method in part or in whole is prohibited without H+D written consent.

This drawing is an instrument of service and the property of Harrington Planning + Design and shall be restricted to the original site for which it was prepared and publication therefore is expressly limited to such use.

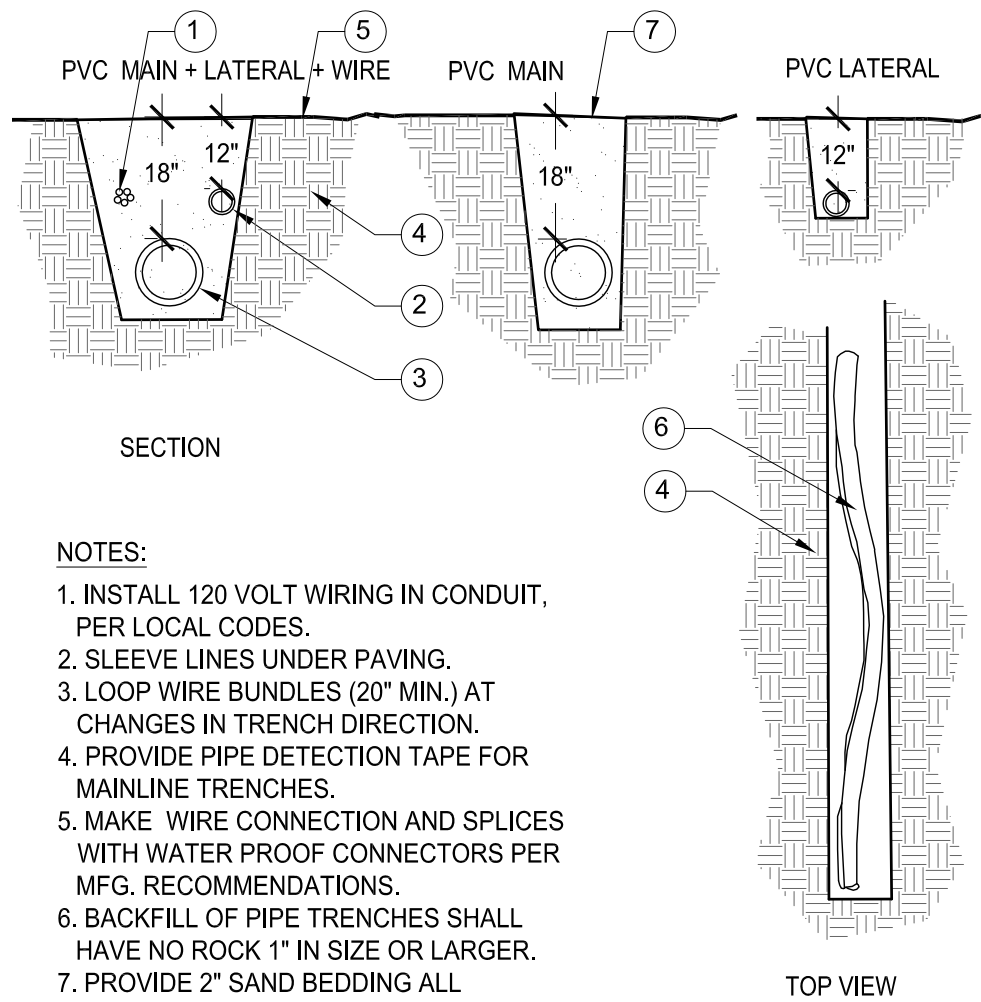

NOTES:

1. INSTALL 120 VOLT WIRING IN CONDUIT, PER LOCAL CODES.
2. SLEEVE LINES UNDER PAVING.
3. LOOP WIRE BUNDLES (20" MIN.) AT CHANGES IN TRENCH DIRECTION.
4. PROVIDE PIPE DETECTION TAPE FOR MAINLINE TRENCHES.
5. MAKE WIRE CONNECTION AND SPLICES WITH WATER PROOF CONNECTORS PER MFG. RECOMMENDATIONS.
6. BACKFILL OF PIPE TRENCHES SHALL HAVE NO ROCK 1" IN SIZE OR LARGER.
7. PROVIDE 2" SAND BEDDING ALL AROUND PIPE IF ROCKY SOILS PRESENT.

1 IRRIGATION TRENCH

SCALE: N.T.S.

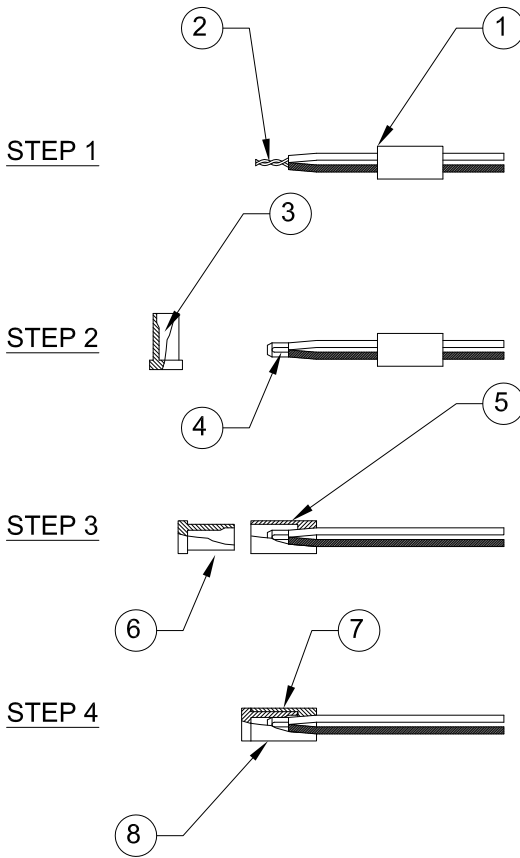

NOTE: FOR WIRE SIZES NO.14, NO.12, AND NO.10

4 IRRIGATION WIRE CONNECTIONS

SCALE: N.T.S.

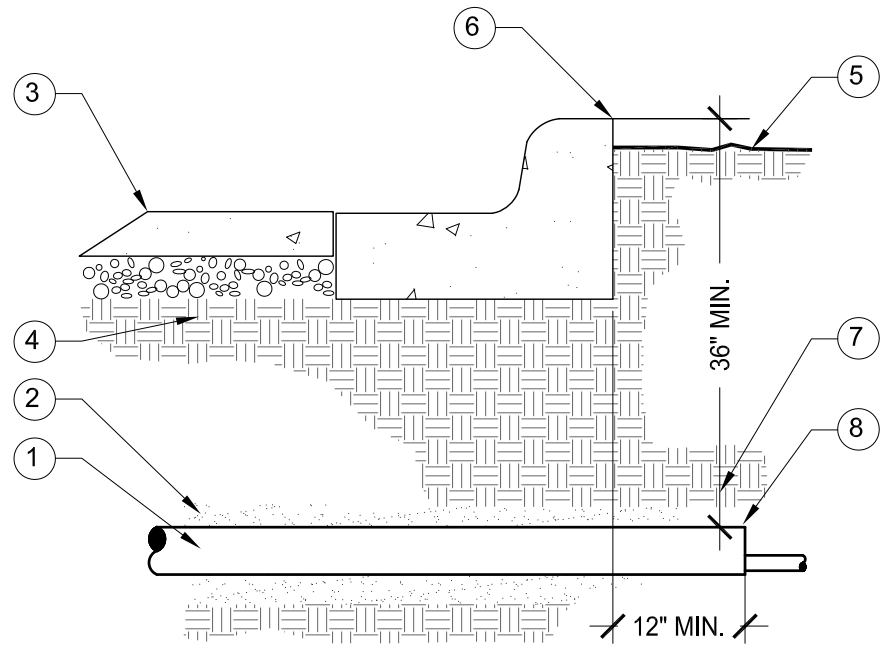

NOTES:

1. CAP SLEEVES UNTIL USE.
2. MULTIPLE SLEEVES REQUIRE 4" SEPERATION WITHIN SAME SLEEVE TRENCH.
3. PROVIDE SEPERATE WATER LINE AND WIRE SLEEVES AS REQUIRED. NO WIRES IN WATER SLEEVES.

2 IRRIGATION SLEEVE

SCALE: N.T.S.

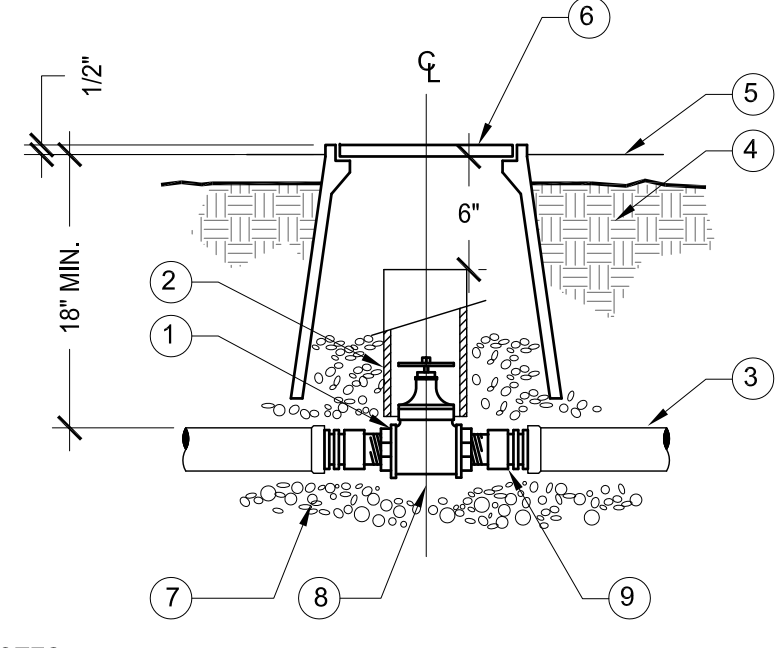

NOTES:

1. SET VALVE BOX 1/2" ABOVE FINISHED GRADE.
2. PROVIDE GATE VALVE KEY - LENGTH AS REQUIRED.
3. DO NOT REST VALVE BOX ON MAIN LINE.
4. PROVIDE SUPPORT BRICKS TO VALVE BOX AS NECESSARY.
5. PROVIDE STAINLESS STEEL FASTENERS FOR LOCKING COVER.

3 GATE VALVE ASSEMBLY

SCALE: N.T.S.

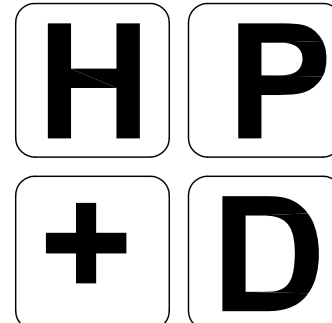

HARRINGTON
PLANNING + DESIGN

3116 S. Mill Avenue, Suite 305
Tempe, Arizona 85282
Tel: 480-250-0116
www.HarringtonPlanningDesign.com



Child Crisis Arizona
827 North Country Club Drive
Mesa, Arizona 85210

REV. COMMENT DATE

2ND REVIEW SET	01.29.19
1ST REVIEW SET	09.20.18
ISSUE	DATE

Landscape Plan

January 29, 2019

DRAWN BY:	DCM
CHECK BY:	JEH
PROJ. NO.:	2018-040
CASE NO.:	NA

IRRIGATION DETAILS

L4.1

