

#### CITY OF MESA GENERAL NOTES

1. ALL WORK AND MATERIALS SHALL CONFORM TO THE CURRENT UNIFORM STANDARD SPECIFICATIONS AND DETAILS FOR PUBLIC WORKS CONSTRUCTION AS FURNISHED BY THE MARICOPA ASSOCIATION OF ENGINEERS AND AS AMENDED BY THE CITY OF MESA. ALL WORK AND MATERIALS NOT IN CONFORMANCE WITH THESE AMENDED SPECIFICATIONS AND DETAILS SHALL BE SUBJECT TO REMOVAL AND REPLACEMENT AT THE CONTRACTOR'S EXPENSE.
2. SUBMITTAL OF RIGHT-OF-WAY PERMITS ARE REQUIRED FOR ALL PUBLIC UTILITIES, PUBLIC STREET IMPROVEMENTS AND RIGHT-OF-WAY LANDSCAPING. FOR INFORMATION REGARDING AVAILABILITY AND COST OF RIGHT-OF-WAY PERMITS, CONTACT THE DEVELOPMENT SERVICES DEPARTMENT AT (480) 644-4273 OR AT [HTTP://WWW.MESA.AZ.GOV/DEVSTAIN/CONSTRUCTION/PERMITS.ASPX](http://www.mesaaz.gov/devsustain/construction/permits.aspx). THE CONTRACTOR SHALL OBTAIN ALL PERMITS REQUIRED UNDER THE CITY OF MESA. CONTRACTORS MUST HOLD THE APPROPRIATE CLASS OF LICENSE AND SHALL HAVE ON FILE WITH THE PERMITS SECTION A PROOF OF INSURANCE COVERAGE. PERMITS BECOME INVALID AND MUST BE UPDATED IF WORK HAS NOT BEGUN WITHIN NINETY (90) DAYS. PERMITS ALSO BECOME INVALID IF THE CONTRACTOR'S INSURANCE LAPSES OR IS VOIDED.
3. TWENTY FOUR (24) HOURS PRIOR TO THE COMMENCEMENT OF ANY WORK, THE CONTRACTOR OR INSTALLATIONS ASSOCIATED WITH THIS PERMIT, THE PERMITTEE SHALL NOTIFY CITY OF MESA ENGINEERING DEPARTMENT AT (480) 644-2251 OF INTENT TO BEGON AND REQUEST/SCHEDULE PRELIMINARY FIELD REVIEW AT THE PROJECT SITE WITH THE CITY OF MESA ENGINEERING DEPARTMENT CONSTRUCTION INSPECTOR (CITY INSPECTOR). FAILURE TO PROVIDE PROPER INSPECTION NOTIFICATION AS PRESCRIBED ABOVE SHALL RESULT IN THIS PERMIT BECOMING INVALID AND WORK BEING STOPPED.
4. THE CONTRACTOR SHALL COMPLY WITH THE REQUIREMENTS TO OBTAIN THE NECESSARY RIGHT-OF-WAY PERMITS AND SHALL COMPLY WITH THE RIGHT-OF-WAY PERMIT CONDITIONS AS FOUND ON THE BACK OF THE PERMIT FORM.
5. THE CITY OF MESA PARKS & RECREATION DIVISION IS NOT REPRESENTED BY BLUE STAKE. WHEN THE CONTRACTOR EXCAVATES NEAR OR ADJACENT TO A CITY PARK, THE CONTRACTOR SHALL CONTACT THE PARKS & RECREATION ADMINISTRATION SECTION AT (480) 644-2354 TO REQUEST ASSISTANCE IN LOCATING ALL THEIR RECREATION FACILITIES.
6. THE CONTRACTOR SHALL OBTAIN AN EARTH-MOVING PERMIT FROM THE MARICOPA COUNTY ENVIRONMENTAL SERVICES DEPARTMENT AND SHALL COMPLY WITH ITS REQUIREMENTS FOR DUST CONTROL.
7. THE ENGINEER HEREBY CERTIFIES AS EVIDENCED BY A PROFESSIONAL SEAL & SIGNATURE THAT ALL AFFECTED UTILITY COMPANIES BOTH PUBLIC AND PRIVATE HAVE BEEN CONTACTED AND ALL EXISTING AND/OR PROPOSED UTILITY LINES AND ALL EXISTING INFORMATION HAVE BEEN TRANSFERRED INTO THESE PLANS. THE ENGINEER OR ARCHITECT ALSO HEREBY CERTIFIES THAT ALL EXISTING AND/OR PROPOSED PUBLIC RIGHT-OF-WAY AND EASEMENTS HAVE BEEN CORRECTLY PLOTTED/SHOWN.
8. THE ENGINEER, OR LAND SURVEYOR OF RECORD SHALL CERTIFY UPON COMPLETION OF CONSTRUCTION THAT ALL PUBLIC IMPROVEMENTS (WATER AND SEWER UTILITIES, STORM SEWER, CONCRETE, PAVING, STREET LIGHTS, ETC.) HAVE BEEN INSTALLED AT THE LOCATIONS AND ELEVATIONS SHOWN ON THESE PLANS. ANY CHANGES SHALL BE REFLECTED ON "AS-BUILT" DRAWINGS PROVIDED BY THE ENGINEER TO THE CITY'S ENGINEERING DEPARTMENT.
9. THE REGISTERED ENGINEER OR LAND SURVEYOR SHALL CERTIFY THAT THE MINIMUM HORIZONTAL AND VERTICAL SEPARATIONS BETWEEN UTILITIES WITHIN PUBLIC RIGHT-OF-WAY AND EASEMENTS HAVE BEEN MAINTAINED AS REQUIRED BY LAW OR POLICY.
10. THE DEVELOPER SHALL PROVIDE ALL CONSTRUCTION STAKING FOR THE PROJECT.
11. THE DEVELOPER OR THE ENGINEER IS RESPONSIBLE FOR ARRANGING FOR THE RELOCATION OR REMOVAL OF ALL UTILITIES OR FACILITIES THAT ARE IN CONFLICT WITH THE PROPOSED PUBLIC IMPROVEMENTS. THE CONTRACTOR IS RESPONSIBLE FOR COORDINATING THE RELOCATION OF ALL UTILITIES, POWER POLES, IRRIGATION SYSTEMS, RESETS REMOVALS BY OTHERS, ETC.
12. THE CONTRACTORS SHALL LOCATE ALL UTILITIES PRIOR TO EXCAVATION AND AVOID DAMAGE TO SAME. CALL (602) 263-1100 FOR BLUE STAKE TWO WORKING DAYS PRIOR TO DIGGING. CALL SALT RIVER PROJECT FOR POLE BRACING, ELECTRIC PERMITS OR CONSTRUCTION SCHEDULING AT (602) 273-8888.
13. WHEN GAS MAINS AND/OR SERVICES ARE EXPOSED, CONTACT THE CITY OF MESA AT (480) 644-2261 FOR INSPECTION OF THE EXPOSED PIPE AND COATING PRIOR TO BACKFILLING OF THE TRENCH.
14. CONTRACTORS SHALL COMPLY WITH THE PROVISIONS FOR TRAFFIC CONTROL AND STAGING FOR THE CURRENT CITY OF MESA STANDARD SPECIFICATIONS. IF A FIRE HYDRANT IS NEEDED TO OBTAIN CONSTRUCTION WATER, THE CONTRACTOR SHALL OBTAIN A FIRE HYDRANT TAPER FROM THE CITY OF MESA AND PAY ALL APPLICABLE FEES AND CHARGES.
15. IF DURING THE CONSTRUCTION OF A PUBLIC FACILITY, THE CONTRACTOR FAILS TO OR IS UNABLE TO COMPLY WITH A REQUEST OF THE CITY INSPECTOR, AND IT IS NECESSARY FOR CITY FORCES TO DO WORK THAT IS NORMALLY THE CONTRACTOR'S RESPONSIBILITY, THE CITY SHALL BE JUSTIFIED IN BILLING THE CONTRACTOR. EACH INCIDENT REQUIRING WORK BY CITY FORCES SHALL BE COVERED BY A SEPARATE BILLING AT THE CURRENT APPLICABLE RATES.
16. THE CONTRACTOR IS ADVISED THAT DAMAGE TO PUBLIC SERVICES OR SYSTEMS AS A RESULT OF THIS PROJECT SHALL BE REPAIRED BY THE CONTRACTOR AND INSPECTED BY THE CITY INSPECTOR. UNLESS OTHERWISE APPROVED BY THE CITY, ALL REPAIRS SHALL BE DONE WITHIN 24 HOURS. THE CONTRACTOR IS ADVISED THAT ANY COSTS RELATED TO REPAIR OR REPLACEMENT OF DAMAGED PUBLIC SERVICES AND SYSTEMS AS A RESULT OF CONTRACTOR'S ACTIVITIES SHALL BE BORNE BY THE CONTRACTOR.

#### CITY OF MESA PUBLIC STREET/RIGHT-OF-WAY IMPROVEMENTS NOTES

1. THE DEVELOPER AND THE CONTRACTOR ARE REQUIRED TO COORDINATE THE PLACEMENT OR INSTALLATION OF DRIVEWAYS IN ORDER TO AVOID CONFLICT WITH UTILITY SERVICES.
2. ALL FRAMES, COVERS, VALVE BOXES, MANHOLES, ETC., SHALL BE INSTALLED TO FINISH GRADE OR SHALL BE ADJUSTED TO FINISH GRADE AFTER PLACING OF ASPHALTIC SURFACE COURSE BY THE CONTRACTOR PER M.A.G. STANDARD DETAIL 270 AND 422.
3. THE CONTRACTOR SHALL ADJUST ALL FRAMES, COVERS, VALVE BOXES, MANHOLES, ETC. THAT ARE LOCATED WITHIN THE PARKWAY AREA AFTER FINAL GRADING AND INSTALLATION OF LANDSCAPING.
4. ALL LANDSCAPING IMPROVEMENTS, INCLUDING IRRIGATION SYSTEMS WITHIN THE PUBLIC RIGHT-OF-WAY OR RETENTION BASINS THAT ARE TO BE MAINTAINED BY THE CITY OF MESA, SHALL BE IN ACCORDANCE WITH THE LANDSCAPING AND IRRIGATION STANDARDS BOOKLET.
5. THE STREET PAVING PERMITTEE/CONTRACTOR IS HEREBY NOTIFIED THAT IN THE EVENT THAT ACCEPTANCE OF THE PUBLIC STREET PAVING IS DELAYED, SIX MONTHS OR MORE AFTER THE PAVEMENT WAS INSTALLED, THE PERMITTEE/CONTRACTOR SHALL APPLY A SEAL COAT TO THE PAVEMENT, TYPE OF MATERIAL AND RATE OF APPLICATION WILL BE DIRECTED BY THE CITY OF MESA ENGINEERING DEPARTMENT - FIELD SUPERVISING ENGINEER.
6. A STANDARD RESIDENTIAL DRIVEWAY APPROACH SHALL BE CONSTRUCTED TO A MAXIMUM WIDTH OF 30 FEET UNLESS SPECIAL APPROVAL HAS BEEN OBTAINED.

#### FIRE NOTES

1. STRUCTURE CONSTRUCTION, ALTERATION OR DEMOLITION SHALL COMPLY WITH IFC CHAPTER 14 AND NFPA 241.
2. VERTICAL CONSTRUCTION WITH COMBUSTIBLE MATERIALS SHALL NOT BEGIN PRIOR TO ACCEPTANCE OF FIRE ACCESS ROADS AND FIRE HYDRANTS.

#### CITY PUBLIC WASTEWATER UTILITY NOTES

1. CONTRACTORS SHALL VERIFY ALL INVERT ELEVATIONS BEFORE PROCEEDING WITH THE BALANCE OF THE UTILITY TRENCHING.
2. ALL MANHOLES PER M.A.G. DETAILS MUST NECK DOWN TO USE THE STANDARD 30-INCH FRAME AND COVER. STEPS SHALL NOT BE INSTALLED WITHIN THE MANHOLE.

#### CITY OF MESA PUBLIC WATER UTILITY NOTES

1. ALL PUBLIC WATER MAIN MATERIALS SHALL BE PER SECTION 610.3 OF THE M.A.G. UNIFORM STANDARD SPECIFICATIONS. ALL DUCTILE IRON PIPE (D.I.P.) WATER MAINS SHALL HAVE POLYETHYLENE CORROSION PROTECTION PER SECTION 610.5 OF THE M.A.G. UNIFORM STANDARD SPECIFICATIONS.
2. ALL NEW WATERLINES THAT REQUIRE SERVICE DISRUPTION IN ORDER TO CONNECT TO THE CITY SYSTEM SHALL REQUIRE A DAYTIME TIE-IN. THE CONTRACTOR SHALL COMPLETE ALL WORK NECESSARY TO RESTORE UTILITY SERVICE AND FULLY OPEN THE TIE-IN AREA TO VEHICULAR TRAFFIC WITHIN THE TIME FRAME ALLOWED BY THE CITY OF MESA ENGINEERING CONSTRUCTION INSPECTOR.
3. THE CONTRACTOR SHALL INSTALL A TEMPORARY PLUG OR VALVE ON A SECTION OF NEW WATER LINE TO TEST LINES BEFORE CONNECTING TO THE EXISTING PUBLIC WATER SYSTEM WHERE THERE IS NO WATER VALVE ON THE EXISTING LINE.
4. WATER LINE TESTS SHALL BE CONDUCTED SO THAT EXISTING WATER LINES WILL NOT BE INCLUDED IN THE TEST OF THE NEW LINE.
5. THE REQUIRED BACKFLOW PREVENTION ASSEMBLY SHALL BE A MANUFACTURER AND MODEL DESIGNATED IN THE CURRENT "LIST OF APPROVED BACKFLOW PREVENTION ASSEMBLIES" AS PUBLISHED BY THE FOUNDATION FOR CROSS-CONNECTION CONTROL AND HYDRAULIC RESEARCH, UNIVERSITY OF SOUTHERN CALIFORNIA.
6. THE BACKFLOW PREVENTION ASSEMBLY SHALL BE TESTED AND APPROVED BY A CERTIFIED TECHNICIAN DESIGNATED IN THE CURRENT CITY OF MESA "LIST OF APPROVED INSPECTORS" PRIOR TO THE REQUEST FOR FINAL INSPECTION.
7. IN ACCORDANCE WITH ARIZONA ADMINISTRATIVE CODE (A.A.C.) R18-4-119, ALL MATERIALS ADDED AFTER JANUARY 1, 1993, WHICH MAY COME INTO CONTACT WITH DRINKING WATER, SHALL CONFORM TO NATIONAL SANITATION FOUNDATION STANDARDS 60 AND 61.
8. PER CITY ORDINANCE NO. 2341, ALL WATER METERS ARE TO BE PURCHASED FROM THE CITY OF MESA. METERS TWO INCHES OR LESS WILL BE DELIVERED AND INSTALLED BY CITY FORCES. METERS LARGER THAN TWO INCHES WILL BE DELIVERED BY THE CITY AND INSTALLED BY THE CONTRACTOR AND REQUIRE SCHEDULING AND INSPECTIONS WITH CITY FORCES (CONTACT DEVELOPMENT SERVICES DEPARTMENT AT 480-644-4273 FOR THE SPECIFIC PROCEDURE).

#### SHELL BUILDING FOR LFLP GREENFIELD, LLC

A PORTION OF THE SOUTHWEST QUARTER OF SECTION 15, TOWNSHIP 1 NORTH, RANGE 6 EAST, OF THE G.&S.R.B.&M., MARICOPA COUNTY, ARIZONA  
4418 E. UNIVERSITY DRIVE

#### RETENTION CALCULATIONS

DRAINAGE AREA 1 = 21608 SF  
AREA CONCRETE (C=0.95) = 2400 SF  
AREA PAVEMENT, ROOF (C=0.85) = 14848 SF  
AREA DESERT LANDSCAPE (C=0.50) = 4360 SF  
WEIGHTED C = (2400(0.95)+14848(0.85)+4360(0.50))/=0.79  
21608

VOLUME REQUIRED = 21608 SF \* 0.79 \* (2.16"/12) = 3073 CF  
VOLUME PROVIDED = (5281.SF + 365.SF)\*1' = 3323 CF  
2

DRAINAGE AREA 2 = 4186 SF  
C=0.85  
VOLUME REQUIRED = 4186 SF \* 0.85 \* (2.16"/12) = 640 CF  
VOLUME PROVIDED = (2035.SF + 122.SF)\*0.9' = 971 CF  
2

SCALE 1" = 20'

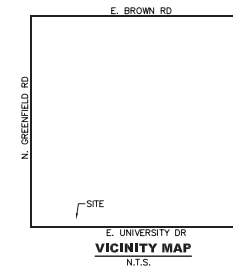

#### LEGAL DESCRIPTION

LOT 4, AMENDED PLAT OF FRY'S GREENFIELD PLAZA ACCORDING TO BOOK 315, PAGE 29, RECORDS OF MARICOPA COUNTY, ARIZONA.

#### OWNER

LFLP GREENFIELD LLC  
8710 N. THORNDALE ROAD, SUITE 120  
TUSCON, AZ 85742

#### BENCHMARK

BRASS TAG IN TOP OF CURB AT THE NORTHWEST CORNER OF GREENFIELD ROAD AND UNIVERSITY.  
ELEVATION = 1321.82' (CITY OF MESA DATUM)

#### SITE DATA

APN 140-15-282  
ZONING: LC  
NET AREA = 11204 SF

#### ARCHITECT

ON POINT ARCHITECTURE  
ATTN: NICOLE POSTEN-THOMPSON  
1341 E. FAIRFIELD ST  
MESA, AZ  
480-227-5259  
NICOLE@ONPOINTARCHITECTURE.COM

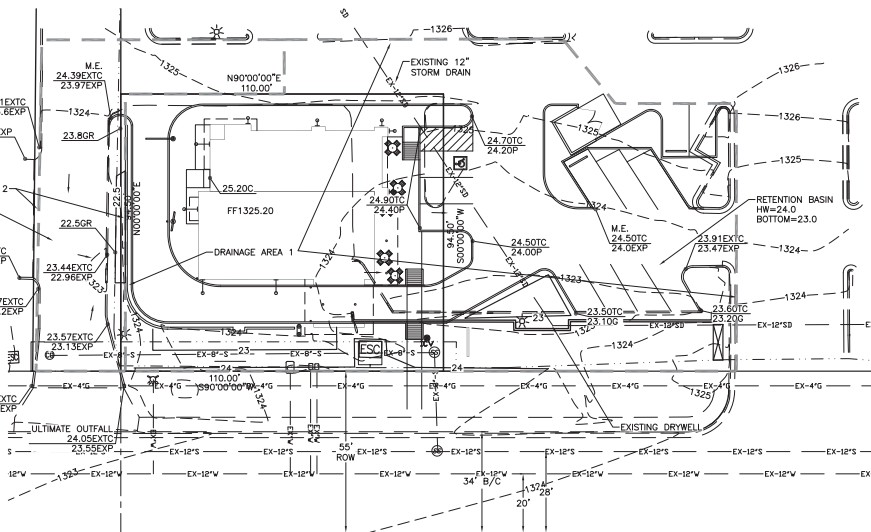

#### UNIVERSITY DRIVE



	<b>GarnerGroup</b> engineering E:\MAIL\CLINTON@GARNERGROUP.COM 2094 E. WINDGETT ST. MESA, AZ 85213	JOB NUMBER	18-186	SHELL BUILDING FOR LFLP GREENFIELD, LLC				REVISION		DATE
		DRAWING	PC018186	PRELIMINARY GRADING AND DRAINAGE & UTILITY PLAN						
		DATE	01-07-19	4418 E. UNIVERSITY DR						
		SHEET	1 OF 1	MESA, AZ						