

D  
C  
B  
A

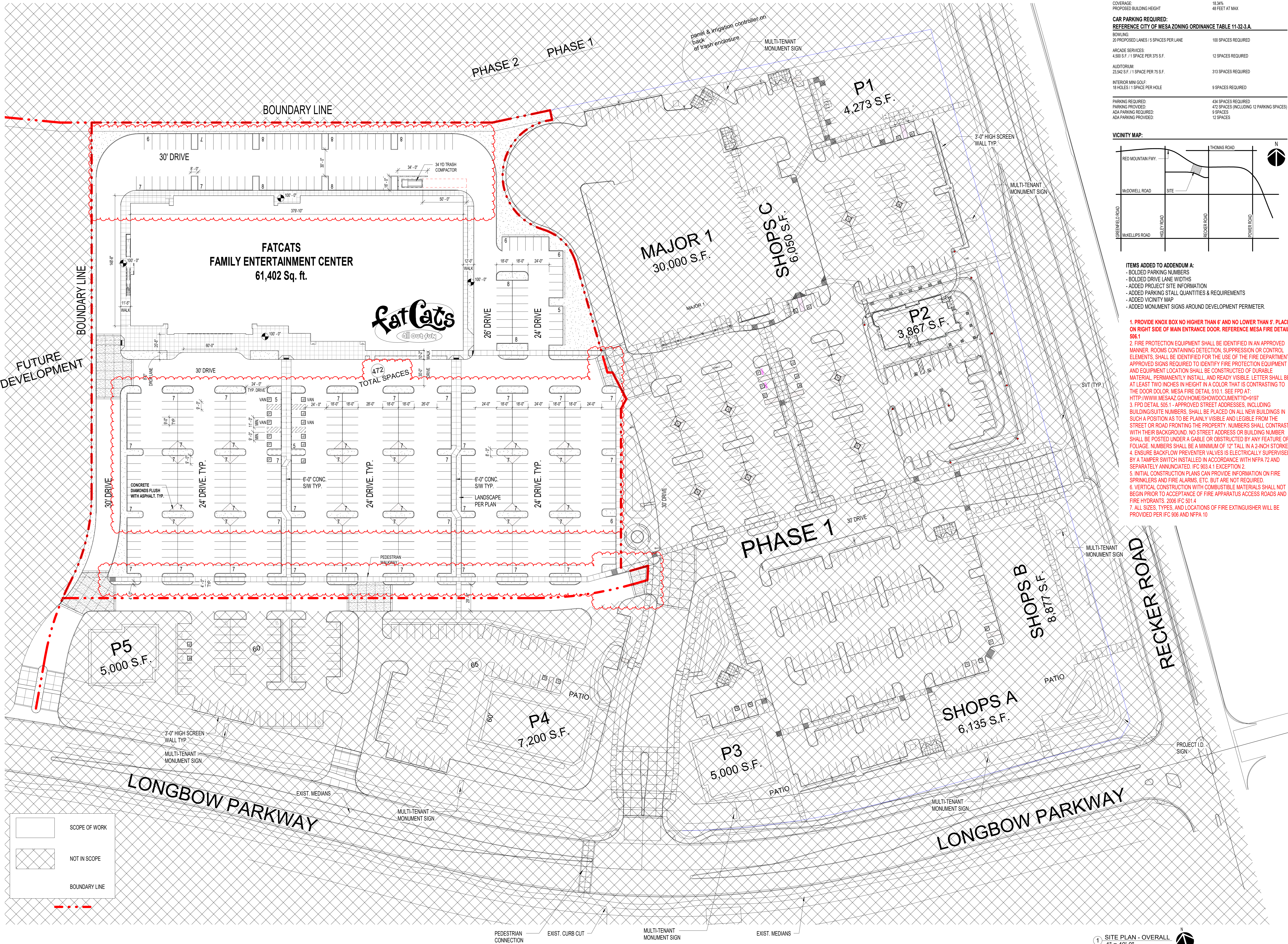

**PROJECT DATA:**

ZONING:	LC
APN:	141-41-020
SITE AREA:	334,765 S.F.
BUILDING AREA:	81,402 S.F.
COVERAGE:	18.34%
PROPOSED BUILDING HEIGHT:	48 FEET AT MAX

**CAR PARKING REQUIRED:**  
**REFERENCE CITY OF MESA ZONING ORDINANCE TABLE 11-32-3.A.**

BOWLING: 20 PROPOSED LANES / 5 SPACES PER LANE	100 SPACES REQUIRED
ARCADE SERVICES: 4,500 S.F. / 1 SPACE PER 375 S.F.	12 SPACES REQUIRED
AUDITORIUM: 23,542 S.F. / 1 SPACE PER 75 S.F.	313 SPACES REQUIRED
INTERIOR MINI GOLF: 18 HOLES / 1 SPACE PER HOLE	9 SPACES REQUIRED
PARKING PROVIDED: ADA PARKING PROVIDED:	434 SPACES REQUIRED 472 SPACES (INCLUDING 12 PARKING SPACES) 8 SPACES 12 SPACES

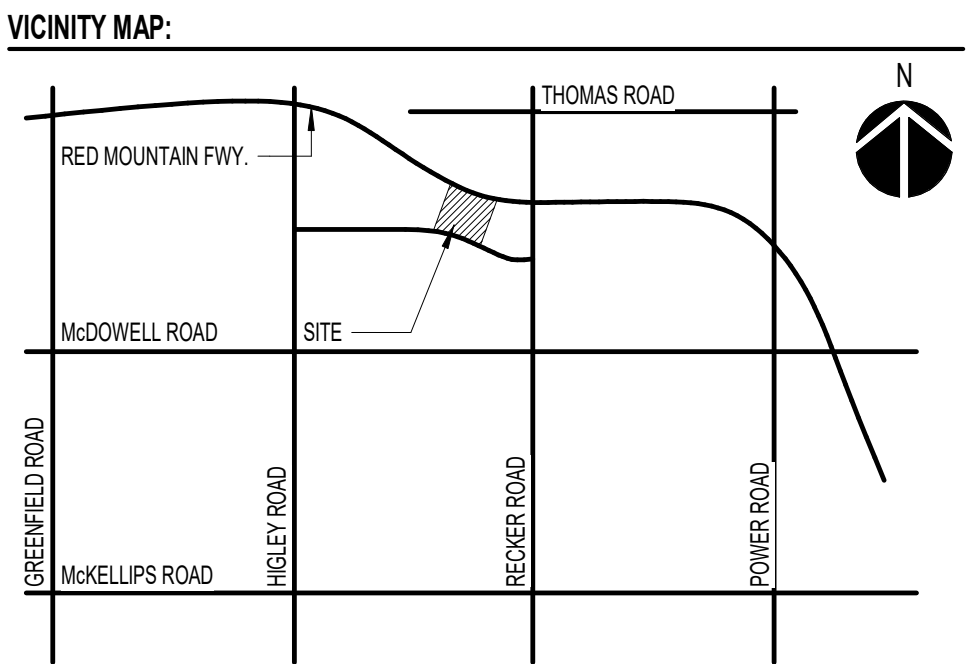

- ITEMS ADDED TO ADDENDUM A:**
- BOLD PARKING NUMBERS
  - BOLD DRIVE LANE WIDTHS
  - ADDED PROJECT SITE INFORMATION
  - ADDED PARKING STALL QUANTITIES & REQUIREMENTS
  - ADDED VICINITY MAP
  - ADDED MONUMENT SIGNS AROUND DEVELOPMENT PERIMETER.
- 1. PROVIDE KNOX BOX NO HIGHER THAN 6" AND NO LOWER THAN 5". PLACE ON RIGHT SIDE OF MAIN ENTRANCE DOOR. REFERENCE MESA FIRE DETAIL 506.1**
- 2. FIRE PROTECTION EQUIPMENT SHALL BE IDENTIFIED IN AN APPROVED MANNER. ROOMS CONTAINING DETECTION, SUPPRESSION OR CONTROL ELEMENTS, SHALL BE IDENTIFIED FOR THE USE OF THE FIRE DEPARTMENT. APPROVED SIGNS REQUIRED TO IDENTIFY FIRE PROTECTION EQUIPMENT AND EQUIPMENT LOCATION SHALL BE CONSTRUCTED OF DURABLE MATERIAL, PERMANENTLY INSTALL, AND READY VISIBLE. LETTER SHALL BE AT LEAST TWO INCHES IN HEIGHT IN A COLOR THAT IS CONTRASTING TO THE DOOR COLOR. MESA FIRE DETAIL 510.1. SEE FPD AT: [HTTP://WWW.MESA.AZ.GOV/HOME/SHOWDOCUMENT?ID=9197](http://www.mesaaz.gov/home/showdocument?id=9197)**
- 3. FPD DETAIL 505.1 - APPROVED STREET ADDRESSES, INCLUDING BUILDING/SUITE NUMBERS, SHALL BE PLACED ON ALL NEW BUILDINGS IN SUCH A POSITION AS TO BE PLAINLY VISIBLE AND LEGIBLE FROM THE STREET OR ROAD FRONTING THE PROPERTY. NUMBERS SHALL CONTRAST WITH THEIR BACKGROUND. NO STREET ADDRESS OR BUILDING NUMBER SHALL BE POSTED UNDER A GABLE OR OBSTRUCTED BY ANY FEATURE OR FOLIA. NUMBERS SHALL BE A MINIMUM OF 12" TALL IN A 2 INCH STROKE.**
- 4. ENSURE BACKFLOW PREVENTER VALVES IS ELECTRICALLY SUPERVISED BY A TAMPER SWITCH INSTALLED IN ACCORDANCE WITH NFPA 72 AND SEPARATELY ANNUNCIATED. IFC 903.4.1 EXCEPTION 2.**
- 5. INITIAL CONSTRUCTION PLANS CAN PROVIDE INFORMATION ON FIRE SPRINKLERS AND FIRE ALARMS, ETC. BUT ARE NOT REQUIRED.**
- 6. VERTICAL CONSTRUCTION WITH COMBUSTIBLE MATERIALS SHALL NOT BEGIN PRIOR TO ACCEPTANCE OF FIRE APPARATUS ACCESS ROADS AND FIRE HYDRANTS. 2006 IFC 501.4**
- 7. ALL SIZES, TYPES, AND LOCATIONS OF FIRE EXTINGUISHER WILL BE PROVIDED PER IFC 906 AND NFPA 10**

**TK ARCHITECTS INTERNATIONAL**

1100 Main Street  
Suite 2200  
Kansas City, Missouri 64105

Phone : 816-842-7552  
Fax : 816-842-1302

DRAWINGS & SPECIFICATIONS REMAIN THE PROPERTY OF THE DESIGN PROFESSIONAL. THESE DRAWINGS & SPECIFICATIONS RETAINED BY THE CLIENT MAY BE UTILIZED ONLY FOR THEIR USE & FOR OCCUPANCY OF THE PROJECT FOR WHICH THEY WERE PREPARED & NOT FOR CONSTRUCTION OF ANY OTHER PROJECT.

**FATCATS MESA ARIZONA**

**5740 E LONGBOW PARKWAY**

**MESA, AZ 85215**

**PERMIT**

**08.27.2018**

REVISIONS	
NO.	DESCRIPTION
A	08.01.2018 ZONING COMMENTS
C	09.05.2018 Revision 3

**PROJECT #17104**

**SITE PLAN**

**SHEET NUMBER**

**100**