

LANDSCAPE DATA -	
Gross Site Area:	629,956 S.F. (14.46 AC.)
Building Area:	142,937 S.F.
Landscape on-site Area:	95,844 S.F.
Landscape off-site Area:	26,851 S.F.
<b>TOTAL Landscape Area:</b>	<b>122,695 S.F.</b>
Plant Density (1 shrub / 25 SF) :	(4,908 required)
*does not include Seed Mix	<b>4,994 provided</b>

MATCHLINE: SEE PL-02

## Preliminary Landscape Plan - North

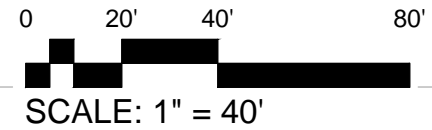

### LANDSCAPE LEGEND

ALL TREES TO MEET OR EXCEED A.N.A. SPECIFICATIONS

During bid it shall be the responsibility of the Contractor to determine required quantities of plants, as no compensation will be made for error in plant quantities. If plant counts occur on plant legend, it is for the convenience of the contractor only. Verify plant counts with plan. In case of discrepancy, plan shall govern.

TREES	SIZE	QTY
Washingtonia filifolia Hybrid Filifera / Robusta	18" trunk ft. straight skinned, matching	53
Pistacia chinensis Chinese Pistache	36" box, matching UON 48" box, matching	77 28
Parkinsonia hybrid 'Desert Museum' Desert Museum Palo Verde	36" box standard low breaking	30
Fraxinus velutina 'Rio Grande' Fan-Tex Ash	24" box, matching	16
Acacia aneura "Mulga" - standard Mulga acacia	24" box, std. matching	103
Quercus virginiana 'Cathedral' Oak	36" box u.o.n. 48" box 6" caliper 'Icon tree' (specimen)	4 2 1
Pinus halepensis Aleppo Pine	36" box	16
Prosopis Hybrid AZT Thornless Hybrid Mesquite "AZT"	24" box multi.	7
Prosopis x Phoenix® (Thornless) Thornless grafted Mesquite	24" box stand.	20
Fouquieria splendens Ocotillo	10' - 8 cane min.	8
Existing Tree to remain and be protected	selectively trim to 7' canopy	

### SHRUBS

### SIZE

### SHRUBS

### SIZE

Aloe barbadensis Medicinal Aloe	5 gal.	Convolvulus cneorum Bush Morning Glory	5 gal.
Rosemarinus officinalis 'Huntington Carpet' Trailing Rosemary	5 gal.	Dodonaea viscosa 'Purpurea' Purple Hopseed Bush	5 gal.
Ericameria laricifolia Aguirre™ Turpentine Bush	5 gal.	Leucophyllum frutescens 'compacta' Compact Texas Sage	5 gal.
Callestemon citrinus "Better John" Better John Bottle Brush	5 gal.	Tecoma alata 'Orange Jubilee' Orange Jubilee	5 gal.
Hesperaloe parviflora 'Perpa' Brakelights Brakelight Red Yucca	5 gal.	Dalea capitata 'Sierra Gold' Sierra Gold Dalea	5 gal.
Simmondsia chinensis Jojoba	5 gal.	Muhlenbergia capillaris Pink Muhley	5 gal. u.o.n.
Caesalpinia pulcherrima Red Bird of Paradise	5 gal.	Bougainvillea 'San Diego Red' San Diego Red Bougainvillea	5 gal.
Russelia equistiformis Coral Fountain	5 gal.	Euphorbia antispythetica Candelilla	5 gal.
Eremophila maculata 'Valentine' Valentine Bush	5 gal.	Opuntia santa rita Purple Prickly Pear	6 pad min.
Dasyliion quadrangulatum Toothless Desert Spoon	5 gal.	Yucca Pallida Pale leaf yucca	5 gal.
Agave americana "Marginata" Variegated Century Plant	5 gal.	Callistemon 'Little John' Little John (Dwarf Bottlebrush)	5 gal.
Hesperaloe sp. Pink Parade Pink Parade Hesperaloe	5 gal.	Yucca rupicola Twisted Leaf Yucca	5 gal.
Bougainvillea 'Barbara Karst' Barbara Karst Bougainvillea	5 gal.	Ruellia brittoniana Ruellia	5 gal.

### GROUND COVER

### SIZE

Lantana montevidensis Trailing Lantana 'Purple & Gold mound'	5 gal u.o.n.
Eremophila glabra 'Mingenew Gold' Outback Sunrise Emu	5 gal.

### INERT MATERIAL

### SIZE

Decomposed Granite - Express Caramel	(3" minus)
2" min thickness in all L.S. areas	
Submit samples to LA for approval	
Fractured Granite rip-rap (Express Brown)	(4" to 6")
install at down-spouts, roof drains & drainage outlets	

(hatch indicates) **Eastmark Native Seed Mix**  
(all weight is in pure live seed)

LBS/Ac	Botanical Name:	Common Name:
1.0	Encelia farinosa	Brittle Bush
3.0	Ambrosia Deltoidea	Triangle Leaf Bursage
2.0	Baileya multiradiata	Desert Marigold
2.0	Senna covensis	Desert Senna
3.0	Escholtzia californica	Mexican Gold Poppy
2.0	Lupinus sparsiflorus	Desert Lupine
1.5	Penstemon parryi	Parry Penstemon
2.0	Aristida purpurea	Purple three Awn
1.0	Buteloua curtipendula	Side Oats Grama

\*\*APPROVED PLANTS FOR USE IN SRP ROW / EASEMENTS

### PRELIMINARY LANDSCAPE PLAN NOTES:

- The entire site will be maintained in accordance with City of Mesa standards.
- All trees will be 24" box or larger.
- an automatic irrigation system will be installed guaranteeing 100% coverage to all landscape areas.
- Decomposed granite, 2" minimum thickness, to be placed in all landscape areas not designated for rip-rap
- All earthwork will be done so that all water drains away from sidewalks, structures and will not impede natural drainage easements.
- Structures and landscaping within a Sight Visibility triangle or Sight Visibility line will not exceed 24" inches.
- Final landscape plans to meet or exceed minimum City standards.
- Quantities are for submittal purposes only.
- All trees shall comply with the latest amended edition of the 'Arizona Nursery Association recommended tree specifications.
- Location of all trees in SVT to be surveyed and staked by contractor, locations to be approved by City transportation department prior to install. all trees within SVT to be of a species that when fully mature will have a trunk diameter of under 12".
- At time of completion, all trees in svt. to be prune to 8' measured from top of curb to bottom of canopy, and 14' ht. as measured from highest point of adjacent pavement.
- All trees located within SVT to be 36" box + Standard Trunk.



LASKIN & ASSOCIATES, INC.  
LANDSCAPE ARCHITECTS  
67 E. Weldon Ave.  
Suite 230  
Phoenix, Arizona 85012  
p (602) 840-7771  
f (602) 840-8021  
www.laskindesign.com

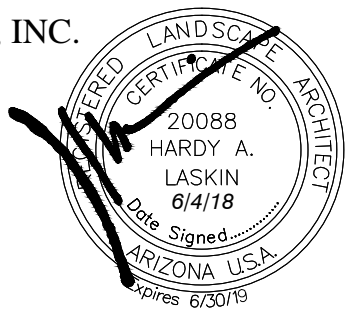

**EASTMARK**  
The Point at Eastmark  
Point Twenty Two and Signal Butte  
Mesa, Arizona

PL-01  
sheet 1 of 2

6.4.2018  
17090-ST10  
**Bdg**  
Butler Design Group, Inc  
architects & planners



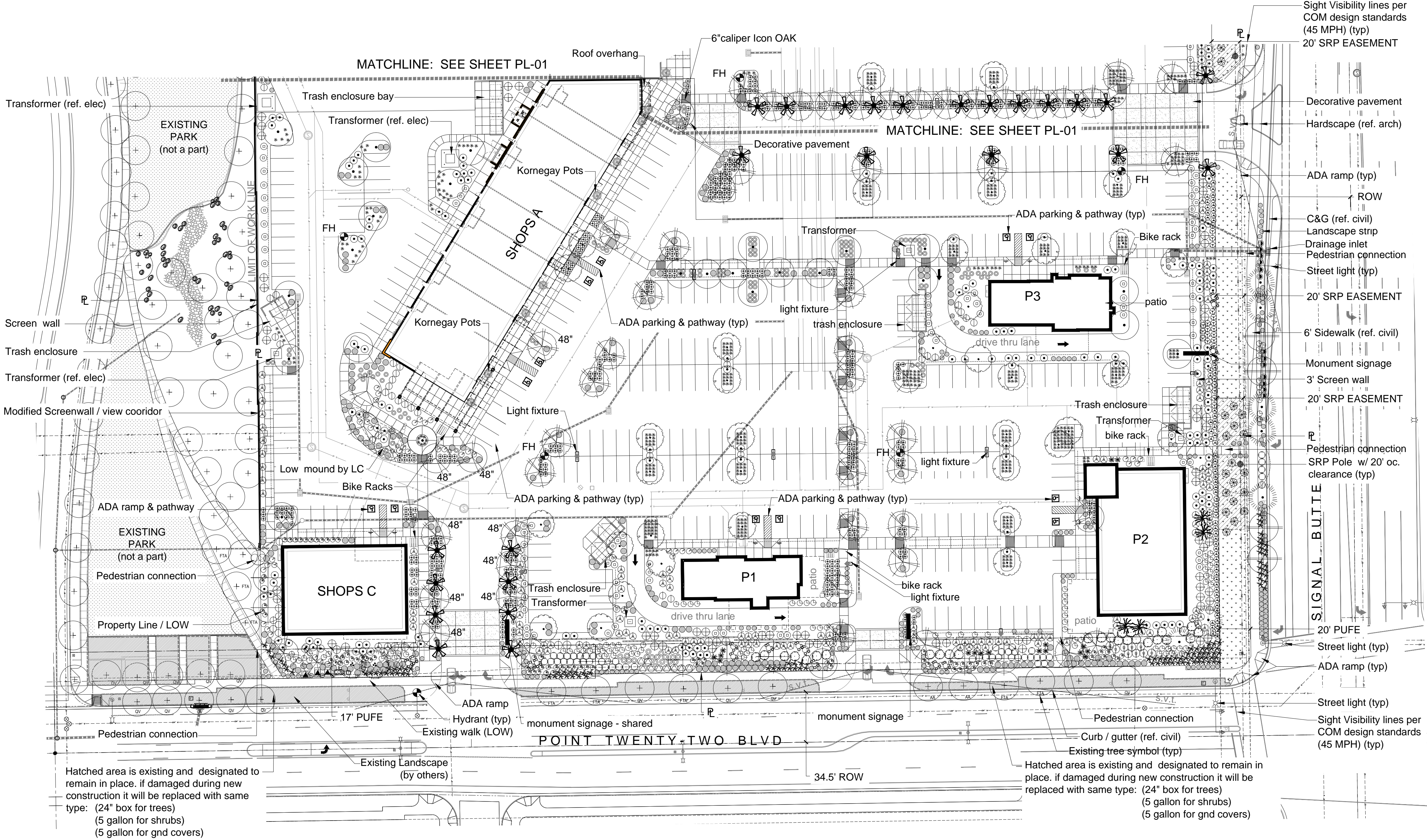

- EXISTING LANDSCAPING AND IRRIGATION NOTES:**
1. SITE VERIFY ALL EXISTING CONDITIONS PRIOR TO BIDDING. ANY DISCREPANCIES ARE TO BE BROUGHT TO THE LANDSCAPE ARCHITECT IMMEDIATELY.
  2. ALL PLANT MATERIAL DESIGNATED AS "EXISTING TO REMAIN" SHALL BE PROTECTED DURING ALL PHASES OF CONSTRUCTION. ANY TREE THAT DIES DUE TO LACK OF WATER, MAINTENANCE/CARE, NEGLIGENCE OR VANDALISM SHALL BE REPLACED BY A LIKE TYPE TREE 48" BOX MINIMUM. ALL SHRUBS AND GROUND COVER SHALL BE REPLACED WITH 5 GALLON PLANTS. AT NO ADDITIONAL COST TO THE OWNER.
  3. LANDSCAPE AREAS DISTURBED BY NEW CONSTRUCTION SHALL BE REPAIRED WITH NEW DECOMPOSED GRANITE MATCHING EXISTING. BLEND ALL DISTURBED AREAS WITH UNDISTURBED SO THERE IS A SMOOTH TRANSITION BETWEEN ALL EDGES. REPLACE ALL DISTURBED, BROKEN OR DAMAGED HEADERS WITH MATCHING TYPE.
  4. ALL EXISTING PLANT MATERIAL AND ADJACENT PLANT MATERIAL SHALL HAVE UNINTERRUPTED WATERING DURING ALL PHASES OF CONSTRUCTION. THIS SHALL INCLUDE BUT NOT BE LIMITED TO: HAND WATERING, TEMPORARY ABOVE GROUND IRRIGATION, EXISTING SYSTEM ETC....
  5. EXISTING IRRIGATION SYSTEM SHALL BE PROTECTED, MAINTAINED AND REPAIRED DURING ALL PHASES OF CONSTRUCTION. IF THE EXISTING SYSTEM IS TIED INTO ADJACENT PROPERTIES, ALL EQUIPMENT SUCH AS MAINLINE, WIRES, LATERALS, HEADS, VALVES ETC... SHALL BE REPAIRED AND REPLACED TO MAINTAIN CONTINUOUS WATERING.
  6. PROVIDE NEW SCHEDULE 40 SLEEVES AT ALL NEW DRIVES (SEE SLEEVE SCHEDULE)
  7. ALL EXISTING TO REMAIN TREES AND SHRUBS, SHALL BE SELECTIVELY PRUNED PER LANDSCAPE ARCHITECTS DIRECTIONS, AND GUARANTEED 100% IRRIGATION COVERAGE DURING ALL CONSTRUCTION PHASES.
  8. ALL EXISTING SHRUBS WITHIN THE Sight DISTANCE LINES AND Visibility TRIANGLES SHALL BE SELECTIVELY PRUNED TO A MAXIMUM HEIGHT OF 30".
  9. ALL EXISTING TREES WITHIN THE Sight DISTANCE LINES AND Visibility TRIANGLES SHALL HAVE ITS CANOPY BE LIFTED TO A CLEAR HEIGHT OF 7'.
  10. LANDSCAPE CONTRACTOR SHALL BORE UNDER EXISTING SIDEWALK RATHER THAN SAW CUT TO PLACE NEW SLEEVES.
  11. L.C. AND G.C. ARE RESPONSIBLE FOR LOCATING ALL EXISTING IRRIGATION SLEEVES PRIOR TO SETTING ANY PAVERS AND/OR CONCRETE.

## Preliminary Landscape Plan -South

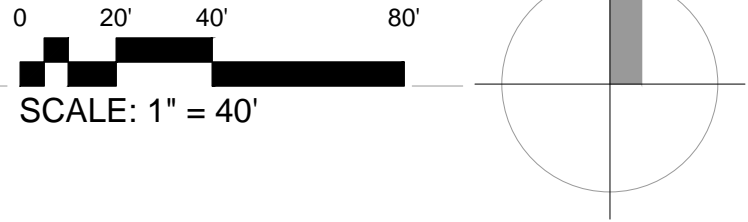

# The Point at Eastmark

Point Twenty Two and Signal Butte  
Mesa, Arizona

## LANDSCAPE LEGEND

ALL TREES TO MEET OR EXCEED A.N.A. SPECIFICATIONS  
During bid it shall be the responsibility of the Contractor to determine required quantities of plants, as no compensation will be made for error in plant quantities. If plant counts occur on plant legend, it is for the convenience of the contractor only. Verify plant counts with plan, in case of discrepancy, plan shall govern.

TREES	SIZE
Washintonia filibusta Hybrid Filifera / Robusta	18" trunk ft. straight skinned, matching
Pistacia chinensis Chinese Pistache	36" box, matching UON 48" box, matching
Parkinsonia hybrid 'Desert Museum' Desert Museum Palo Verde	36" box standard low breaking
Fraxinus velutina 'Rio Grande' Fan-Tex Ash	24" box, matching
Acacia aneura " Mulga" - standard Mulga acacia	24" box, std. matching
Quercus virginiana 'Cathedral' Oak	36" box u.o.n. 48" box 6" caliper "Icon tree" (specimen)
Pinus halepensis Aleppo Pine	36" box
Prosopis Hybrid AZT Thornless Hybrid Mesquite "AZT"	24" box multi.
Prosopis x Phoenix® (Thornless) Thornless grafted Mesquite	24" box stand.
Fouquieria splendens Ocotillo	10" - 8 cane min.
Existing Tree to remain and be protected	selectively trim to 7' canopy

SHRUBS	SIZE	SHRUBS	SIZE
Aloe barbadensis Medicinal Aloe	5 gal.	Convolvulus cneorum Bush Morning Glory	5 gal.
Rosemarinus officinalis 'Huntington Carpet' Trailing Rosemary	5 gal.	Dodonaea viscosa 'Purpurea' Purple Hopseed Bush	5 gal.
Ericameria laricifolia Aguirre™ Turpentine Bush	5 gal.	Leucophyllum frutescens 'compacta' Compact Texas Sage	5 gal.
Calistemon citrinus " Better John" Better John Bottle Brush	5 gal.	Tecoma alata 'Orange Jubilee' Orange Jubilee	5 gal.
Hesperaloe parviflora 'Perpa' Brakelights Brakelight Red Yucca	5 gal.	Dalea capitata 'Sierra Gold' Sierra Gold Dalea	5 gal.
Simmondsia chinensis Jojoba	5 gal.	Muhlenbergia capillaris Pink Muhley	5 gal. u.o.n.
Caesalpinia pulcherrima Red Bird of Paradise	5 gal.	Bougainvillea 'San Diego Red' San Diego Red Bougainvillea	5 gal.
Russellia equistiformis Coral Fountain	5 gal.	Euphorbia antispythilica Candelilla	5 gal.
Eremophila maculata 'Valentine' Valentine Bush	5 gal.	Opuntia santa rita Purple Prickly Pear	6 pad min.
Dasyliro quadrangulatum Toothless Desert Spoon	5 gal.	Yucca Pallida Pale leaf yucca	5 gal.
Agave americana "Marginata" Variegated Century Plant	5 gal.	Callistemon 'Little John' Little John (Dwarf Bottlebrush)	5 gal.
Hesperaloe sp. Pink Parade Pink Parade Hesperaloe	5 gal.	Yucca rupicola Twisted Leaf Yucca	5 gal.
Bougainvillea 'Barbara Karst' Barbara Karst Bougainvillea	5 gal.	Ruellia brittoniana Ruellia	5 gal.

GROUND COVER	SIZE
Lantana montevidensis Trailing Lantana 'Purple & Gold mound'	5 gal
Eremophila glabra "Mingenew Gold" Outback Sunrise Emu	5 gal.

INERT MATERIAL	SIZE
Decomposed Granite - Express Caramel (3" minus) 2" min thickness in all L.S. areas Submit samples to LA for approval	
Fractured Granite rip-rap (Express Brown) (4" to 6") install at down-spouts, roof drains & drainage outlets	
(hatch indicates) Eastmark Native Seed Mix (all weight is in pure live seed)	
LBS/Ac Botanical Name: Common Name:	
1.0 Encelia farinosa Brittle Bush	
3.0 Ambrosia Deltoidea Triangle Leaf Bursage	
2.0 Bailey multiradiata Desert Marigold	
2.0 Senna covesii Desert Senna	
3.0 Escholtzia californica Mexican Gold Poppy	
2.0 Lupinus sparsiflorus Desert Lupine	
1.5 Penstemon parryi Parry Penstemon	
2.0 Aristida purpurea Purple three Awn	
1.0 Buteloua curtipendula Side Oats Grama	

\*\*APPROVED PLANTS FOR USE IN SRP ROW / EASEMENTS

## PRELIMINARY LANDSCAPE PLAN NOTES:

1. The entire site will be maintained in accordance with City of Mesa standards.
2. All trees will be 24" box or larger.
3. an automatic irrigation system will be installed guaranteeing 100% coverage to all landscape areas.
4. Decomposed granite, 2" minimum thickness, to be placed in all landscape areas not designated for rip-rap
5. All earthwork will be done so that all water drains away from sidewalks, structures and will not impede natural drainage easements.
6. Structures and landscaping within a Sight Visibility triangle or Sight Visibility line will not exceed 24" inches.
7. Final landscape plans to meet or exceed minimum City standards.
8. Quantities are for submittal purposes only.
9. All trees shall comply with the latest amended edition of the 'Arizona Nursery Association recommended tree specifications.
10. Location of all trees in SVT to be surveyed and staked by contractor, locations to be approved by City transportation department prior to install. all trees within SVT to be of a species that when fully mature will have a trunk diameter of under 12".
11. At time of completion, all trees in svt. to be prune to 8' measured from top of curb to bottom of canopy, and 14' ht. as measured from highest point of adjacent pavement.
12. All trees located within SVT to be 36" box + Standard Trunk.

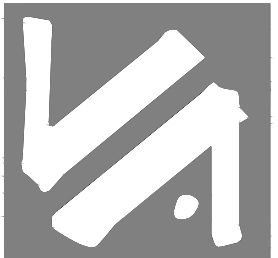

LASKIN & ASSOCIATES, INC.  
LANDSCAPE ARCHITECTS  
67 E. Weldon Ave.  
Suite 230  
Phoenix, Arizona 85012  
p (602) 840-7771  
f (602) 840-8021  
www.laskindesign.com



PL-02  
sheet 2 of 2

