

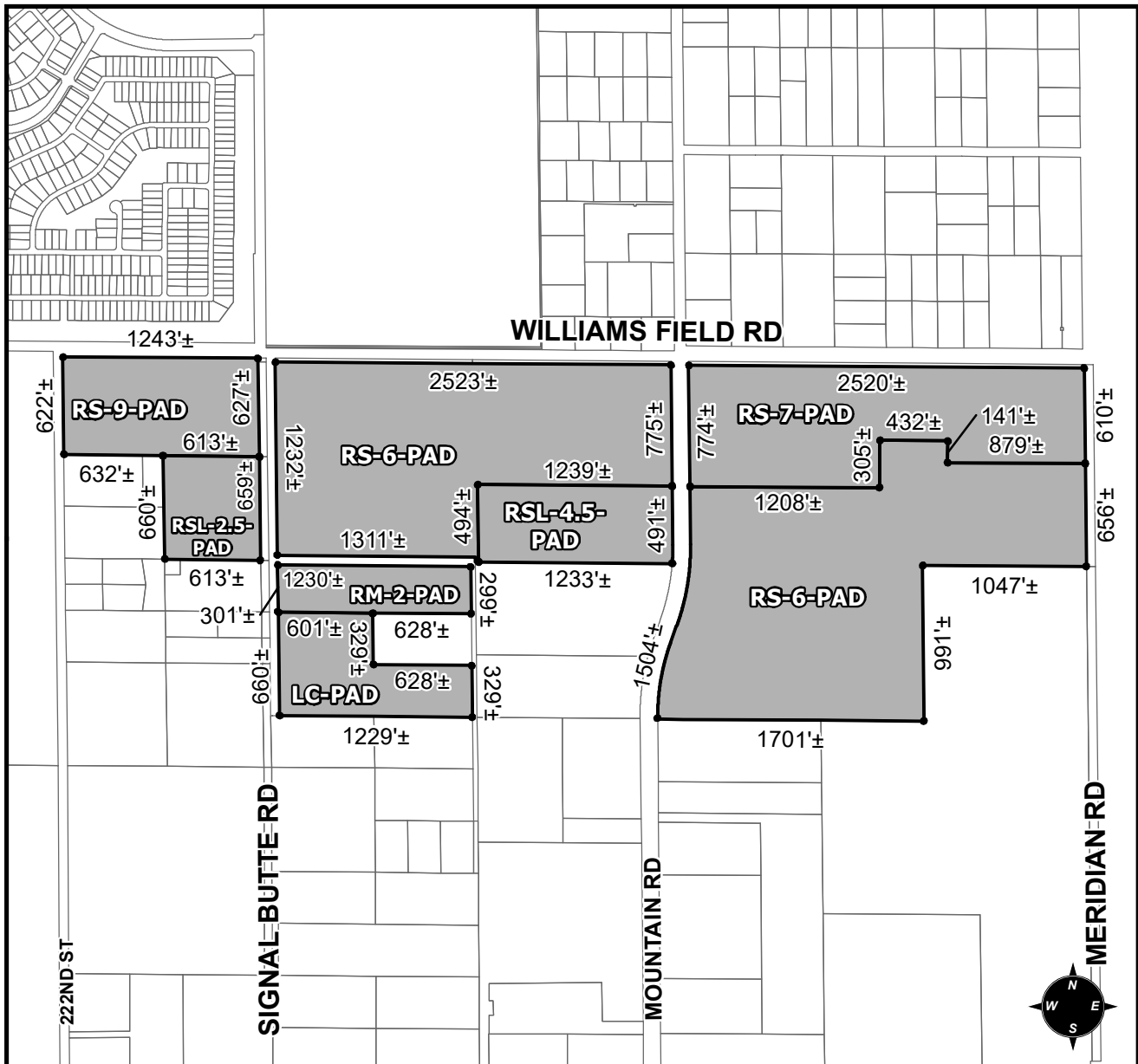

OFFICIAL SUPPLEMENTARY ZONING MAP AMENDING THE CITY OF MESA ZONING MAP



CASE: ZON17-00247

ACREAGE: 251±

REQUEST: REZONE FROM AG AND GI-CUP TO A PLANNED AREA DEVELOPMENT (PAD) OVERLAY WITH UNDERLYING RM-2, RSL- 2.5, RSL-4.5, RS-6, RS-7 AND RS-9 FOR 236± ACRES AND LC FOR 15± ACRES.

ORDINANCE: _____

Please be advised that the attached zoning changes were approved by the Mesa City Council on _____, 2018 by Ordinance # _____. If you have any questions concerning these changes, contact the City of Mesa Planning Division at 480-644-2385.

ATTEST: _____ DATE: _____

MAYOR

CITY CLERK