

LANDSCAPE NOTES

1. CONTRACTOR TO OBTAIN PERMITS FROM LOCAL AGENCIES AND UTILITY COMPANIES HAVING JURISDICTION OVER THIS SITE.
2. CONTRACTOR TO VERIFY LOCATIONS OF ALL UNDERGROUND UTILITIES PRIOR TO ANY INSTALLATION.
3. CONTRACTOR SHALL PROVIDE ALL LABOR, MATERIALS, AND EQUIPMENT NECESSARY TO INSTALL THE WORK INDICATED ON THE LANDSCAPE DOCUMENTS. HE SHALL BE RESPONSIBLE FOR CAREFUL SITE INSPECTION, DETAILED REVIEW OF THE PLANS, AND COORDINATION WITH OTHER CONTRACTORS ON-SITE PRIOR TO ANY INSTALLATION. ANY DISCREPANCIES SHALL IMMEDIATELY BE BROUGHT TO THE ATTENTION OF THE OWNER'S AGENT.
4. PRIOR TO INITIATING THESE LANDSCAPE IMPROVEMENTS, THE LANDSCAPE CONTRACTOR MUST SCHEDULE A PRE- CONSTRUCTION MEETING ON-SITE WITH THE APPROVAL OF THE OWNER AND THE GENERAL CONTRACTOR. THE OWNER'S REPRESENTATIVE AND/OR THE PROJECT LANDSCAPE ARCHITECT MUST BE PRESENT. THE PURPOSE OF THIS MEETING IS TO RESOLVE ANY EXISTING SITE CONDITIONS THAT MAY BE IN CONFLICT WITH THESE LANDSCAPE CONSTRUCTION DOCUMENTS AND THEREFORE IMPACT THE INSTALLATION OF ANY OF THESE PROPOSED IMPROVEMENTS. THIS FIRST MEETING SHOULD BE SCHEDULED TO OCCUR AFTER THE COMPLETION OF ON-SITE AND OFF-SITE IMPROVEMENTS INCLUDING: ALL UNDERGROUND UTILITIES, MASS GRADING, AND STREET IMPROVEMENTS.
5. DAMAGE TO EXISTING LANDSCAPING, UNDERGROUND UTILITIES, IRRIGATION LINES, ELECTRICAL LINES, ETC. SHALL BE REPAIRED AT CONTRACTORS EXPENSE.
6. ANY DISCREPANCIES FOUND BETWEEN THE PLANS AND THE SITE CONDITIONS SHALL BE BROUGHT TO THE ATTENTION OF THE LANDSCAPE ARCHITECT.
7. ALL QUANTITIES PROVIDED ARE FOR BIDDING PURPOSES ONLY. LANDSCAPE CONTRACTOR SHALL VERIFY ALL QUANTITIES PRIOR TO CONSTRUCTION.
8. THE CONTRACTOR SHALL BE RESPONSIBLE FOR ALL FINISH GRADES IN LANDSCAPED AREAS. HE SHALL DETERMINE, WITH THE GENERAL CONTRACTOR, THE EXTENT OF ROUGH GRADING AND/OR FINE GRADING TO BE ESTABLISHED BY OTHERS.
9. ALL GRADING AND DRAINAGE SHALL BE IN ACCORDANCE WITH THE PLANS PREPARED BY THE PROJECT CIVIL ENGINEER, OR AS DIRECTED BY THE OWNER'S AGENT. PROVIDE POSITIVE DRAINAGE AWAY FROM THE BUILDING(S) IN ALL CONDITIONS. CONTRACTOR TO MEET ALL EXISTING GRADES AT PROJECT BOUNDARIES. FINISH GRADE SHALL BE 3" BELOW THE TOP OF ADJACENT WALKS AND CURBS PRIOR TO RECEIVING MULCH OR DECOMPOSED GRANITE.
10. ALL AREAS DISTURBED DURING CONSTRUCTION TO BE FINE GRADED. ADJACENT UNDISTURBED AREAS DAMAGED OR DISTURBED TO BE RESTORED TO ITS ORIGINAL CONDITION AT THE CONTRACTOR'S EXPENSE.
11. CONTRACTOR SHALL FINE GRADE ENTIRE LANDSCAPED AREA AS REQUIRED FOR INSTALLATION OF PLANTING. ALL GRADES SHALL BE NEAT, RAKED SMOOTH AND BE FREE OF DEBRIS PRIOR TO SUBSTANTIAL COMPLETION.
12. PRIOR TO SPREADING MATERIAL GROUNDCOVERS, ADJUST AND COMPACT FINISH GRADES. APPLY WEED PRE-EMERGENT SURFLAN AS PER MANUFACTURER'S INSTRUCTIONS. THEN SPREAD DECOMPOSED GRANITE, RIVER RUN, OR MULCH AS INDICATED ON PLANS. DECOMPOSED GRANITE SHALL BE WATERED, THEN COMPACTED WITH A SOD ROLLER TO A MINIMUM DEPTH OF 2" AFTER COMPACTION. PROVIDE A SECOND APPLICATION OF THE PRE-EMERGENT SURFLAN AT THE END OF THE MAINTENANCE PERIOD.
13. ALL LANDSCAPED AREAS SHALL RECEIVE A 2" TOP DRESSING OF DECOMPOSED GRANITE AS SPECIFIED IN THE LANDSCAPE PLANT SCHEDULE. PROVIDE SAMPLE OF SIZE AND COLOR FOR APPROVAL BY OWNER'S AGENT PRIOR TO DELIVERY.
14. STAKE LOCATIONS OF ALL TREES FOR APPROVAL PRIOR TO INSTALLATION OF ANY PLANT MATERIAL.
15. ALL PLANT MATERIAL SHALL BE HEALTHY, VIGOROUS, WELL BRANCHED AND DENSELY FOLIATED (WHEN IN-LEAF) AS IS TYPICAL FOR THE SPECIES. THEY SHALL HAVE HEALTHY, WELL DEVELOPED ROOT SYSTEMS (NOT POT BOUND), A NORMAL HABIT OF GROWTH CONSISTENT WITH INDUSTRY STANDARDS, AND FREE OF ANY BRUISES, CUTS, OR OTHER ABNORMALITIES. PLANT MATERIAL SHALL BE SIZED IN ACCORDANCE WITH THE AMERICAN STANDARD FOR NURSERY STOCK, LATEST EDITION, PUBLISHED BY THE AMERICAN ASSOCIATION OF NURSERYMAN, AND THE ARIZONA NURSERYMAN ASSOCIATION STANDARDS.
16. ALL RIGHT-OF-WAY PLANT MATERIAL MUST BE IN COMPLIANCE WITH THE DEPARTMENT OF WATER RESOURCES LOW WATER USE PLANT LIST. NO PLANT SUBSTITUTIONS, TYPE, OR QUANTITY DEVIATIONS FROM THE APPROVED LANDSCAPE PLANS WITHOUT PRIOR APPROVAL FROM THE CITY OF MESA.
17. BACKFILL MIXTURES, EXCEPT AS NOTED, TO BE COMPRISED OF 75% NATIVE SOIL AND 25% DECOMPOSED GRANULAR BARK MULCH, AND 2 LBS. DISPERSAL PER CUBIC YARD OF BACKFILL.
18. ADD AGRI-FORM FERTILIZER TABLETS AT THE FOLLOWING RATES: 1 GALLON PLANT - 1 TABLET 15 GALLON PLANT - 4 TABLETS 5 GALLON PLANT - 2 TABLET BOXED TREE - 6 TABLETS (MIN.) TABLETS TO BE PLACED NO DEEPER THAN 6" BELOW SOIL SURFACE.
19. LANDSCAPE CONTRACTOR IS RESPONSIBLE FOR ALL PLANTS SHOWN ON PLANTING PLAN. DO NOT SUBSTITUTE PLANTS BY TYPE OR QUANTITY WITHOUT WRITTEN APPROVAL FROM THE LANDSCAPE ARCHITECT OR OWNER'S AGENT.
20. THE OWNER'S AGENT RESERVES THE RIGHT TO REJECT ANY SELECTION OF PLANT MATERIAL THAT DOES NOT SATISFY THE INTENT OF THE LANDSCAPE DESIGN BASED ON SIZE, SHAPE, EVIDENCE OF STRESS OR IMPROPER CARE.
21. PRIOR TO INITIATING THE 90-DAY MAINTENANCE PERIOD, COMPLETE ANY INITIAL PUNCH LIST ITEMS, THEN OBTAIN APPROVAL FROM OWNER'S AGENT OF SUBSTANTIAL COMPLETION. DETERMINE WITH OWNER'S AGENT THE START DATE FOR THE 90-DAY MAINTENANCE PERIOD. CONTRACTOR TO THEN MAINTAIN LANDSCAPE WHICH MAY INCLUDE WATERING, WEEDING PRUNING, AND REPLACEMENT OF ANY MATERIAL THAT HAS DIED OR IS SHOWING EVIDENCE OF STRESS. SUBMIT WRITTEN REQUEST FOR FINAL PUNCH LIST ONE WEEK PRIOR TO END OF MAINTENANCE PERIOD.
22. PROVIDE OWNER WITH A WRITTEN GUARANTEE OF SIX (6) MONTHS FOR ALL PLANT MATERIAL DATED FROM START OF MAINTENANCE PERIOD AGAINST DEFECTS INCLUDING DEATH AND UNSATISFACTORY GROWTH. PROVIDE OWNER WITH WRITTEN INSTRUCTIONS OUTLINING MAINTENANCE PROCEDURES TO BE ADOPTED IN ORDER TO PROTECT GUARANTEE. INCLUDE WATERING SCHEDULE AND FERTILIZER PROGRAM. (1) YEAR GUARANTEE FOR PALMS.
23. INSTALL ALL SIDEWALKS PER A.D.A. REQUIREMENTS.

CITY OF MESA NOTES

1. THERE ARE NO OVERHEAD POWERLINES ON SITE
2. ALL NEW SIGNAGE TO BE UNDER SEPARATE REVIEW AND PERMIT
3. ALL EXISTING SIGNAGE TO BE BROUGHT INTO CURRENT CODE CONFORMANCE
4. ENTIRE PERIMETER WALL AND LANDSCAPING REQUIRED WITH FIRST PHASE OF DEVELOPMENT
5. PARALLEL FENCE WILL NOT BE PERMITTED ANYWHERE ON THE PROJECT
6. OWNER IS RESPONSIBLE FOR MAINTENANCE OF ALL LANDSCAPING INSTALLED WITH THIS PROJECT- INCLUDING R.O.W. LANDSCAPING

PLANT SCHEDULE

SYMBOL	BOTANICAL/COMMON NAME	CLPR/SIZE	MAT. SIZE (HxW)	QTY.	REMARKS
TREES					
	ACACIA ANEURA MULGA	2"/24" BOX.	15'X15'	-	STAKE AS REQUIRED
	PARKINSONIA FLORIDUM BLUE PALO VERDE	2"/24" BOX.	20'X20'	-	STAKE AS REQUIRED
	DALBERGIA SISSOO SISSOO TREE	1"/15 GAL.	20'X20'	-	STAKE AS REQUIRED
	PROSOPIS CHILENSIS 'THORNLESS' THORNLESS CHILEAN MESQUITE	1"/15 GAL.	25'X25'	-	STAKE AS REQUIRED
SHRUBS					
	CAESALPINIA PULCHERRIMA RED BIRD OF PARADISE	5 GAL.	6'X6'	-	1 GPH EMITTER
	CALLIANDRA CALIFORNICA RED FAIRY DUSTER	5 GAL.	4'X4'	-	1 GPH EMITTER
	EREMOPHILA HYGROPHANA BLUE BELLS™ BLUE BELLS	5 GAL.	2'X3'	-	1 GPH EMITTER
	LEUCOPHYLLUM LANGMANIAE 'RIO BRAVO'™ RIO BRAVO SAGE	5 GAL.	4'X4'	-	1 GPH EMITTER
	RUELLIA PENINSULARIS BAJA RUELLIA	5 GAL.	4'X4'	-	1 GPH EMITTER
	TECOMA SPP. 'ORANGE JUBILEE'	5 GAL.	8'X6'	-	1 GPH EMITTER
ACCENTS					
	HESPERALOE PARVIFLORA RED YUCCA	5 GAL.	3'X4'	-	1 GPH EMITTER
GROUNDCOVER					
	ACACIA REDOLENS 'DESERT CARPET' N.C.N.	1 GAL.	2'X6'	-	1 GPH EMITTER
	CYNODON DACTYLON 'MIDIRON' MIDIRON HYBRID BERMUDA	SOD	-	-	POP-UP SPRAY HEADS
	LANTANA SPP. 'NEW GOLD' LANTANA	1 GAL.	2'X3'	-	1 GPH EMITTER
	CONCRETE HEADER	6" x 6"	-	-	SEE DETAIL
	DECOMPOSED GRANITE 'EXPRESS CARMEL'	1/2" SCREENED	-	-	2" DEPTH ALL LANDSCAPE AREAS

- NOTES:
- 1) TREE HEIGHTS AND CALIPERS WILL COMPLY WITH "ARIZONA NURSERY ASSOCIATION SPECIFICATIONS" FOR THAT TYPE AND SIZE OF TREE
 - 2) LANDSCAPE TO BE WATERED BY AN UNDERGROUND AUTOMATIC IRRIGATION SYSTEM.

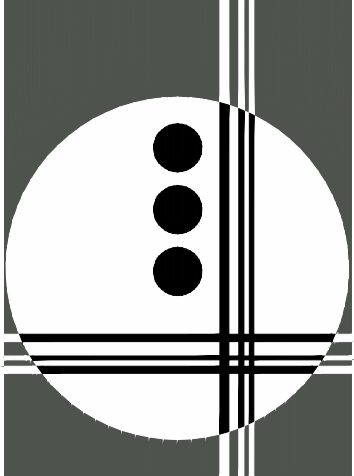
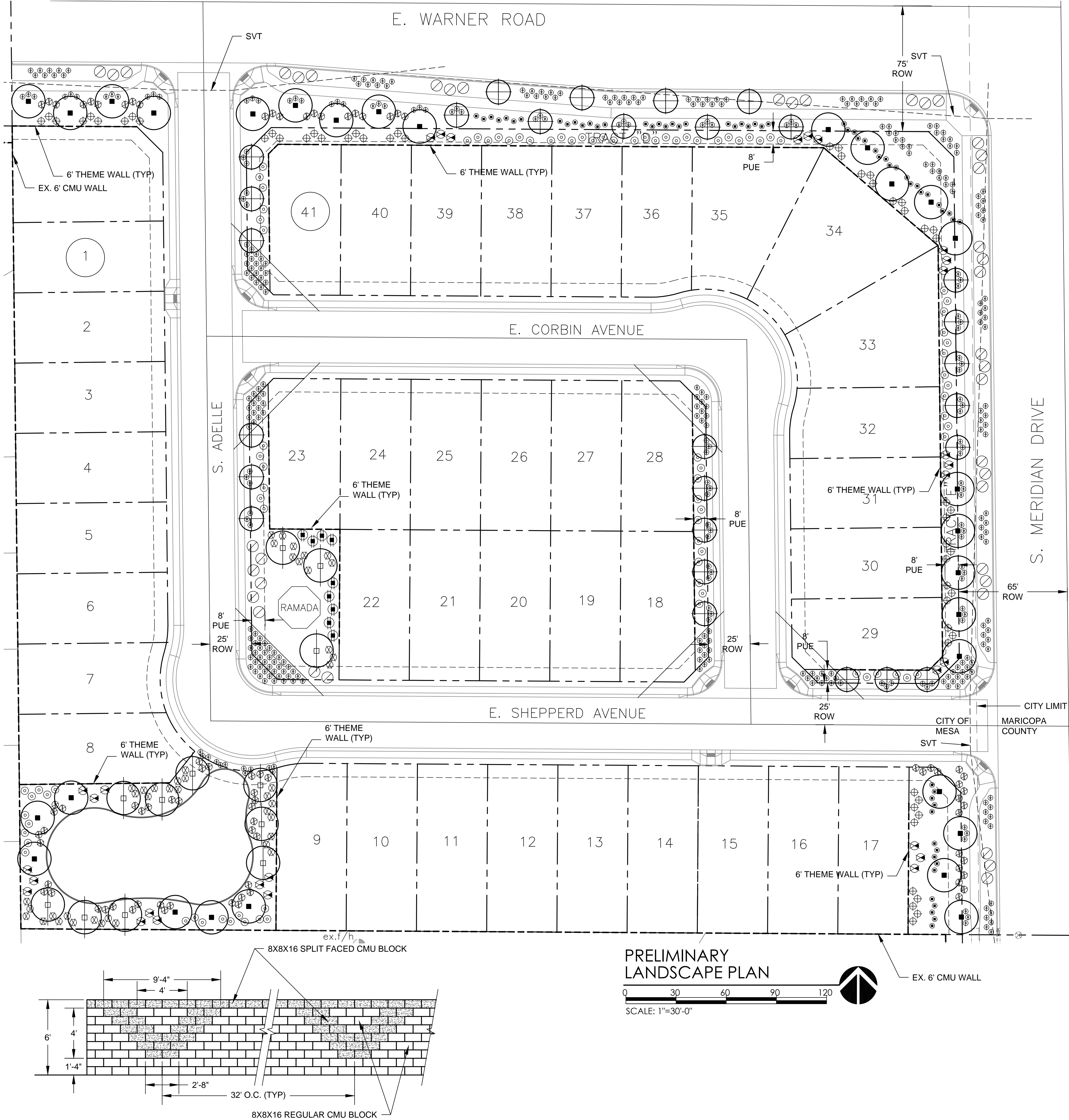

GILMORE
PLANNING & LANDSCAPE ARCHITECTURE

2211 N. 7th Street
Phoenix, Az 85006
T 602.266.5622
F 602.266.5707
www.getgilmore.com

PLANNING
LANDSCAPE ARCHITECTURE

WARNER ENCLAVE
SWC OF WARNER & MERIDIAN ROADS
MESA, AZ
PREPARED FOR: PROGRESS CONSTRUCTION LLC.

JOB NO. 15029
DRAWN BY. TCB
APPROVED BY. JJG
DATE. 11.8.16

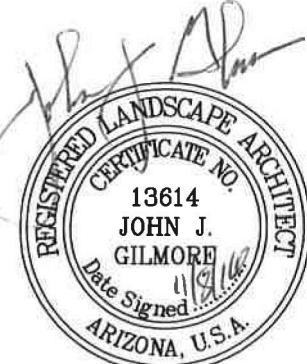

Expires 12/31/2017

REVISIONS.

- 1.
- 2.
- 3.
- 4.

PRELIMINARY
LANDSCAPE PLAN
& WALL PLAN

SHEET

L1.1

1 OF 1