

# BOARD OF ADJUSTMENT VICINITY MAP: BA17-016

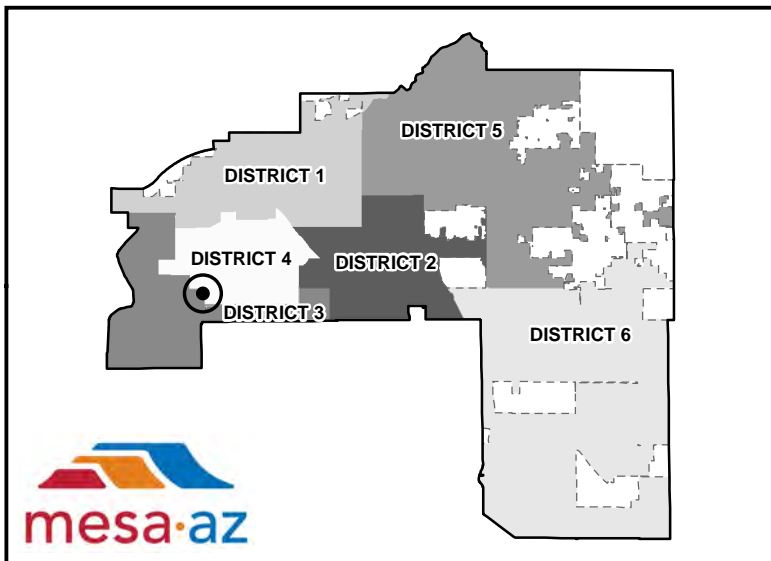
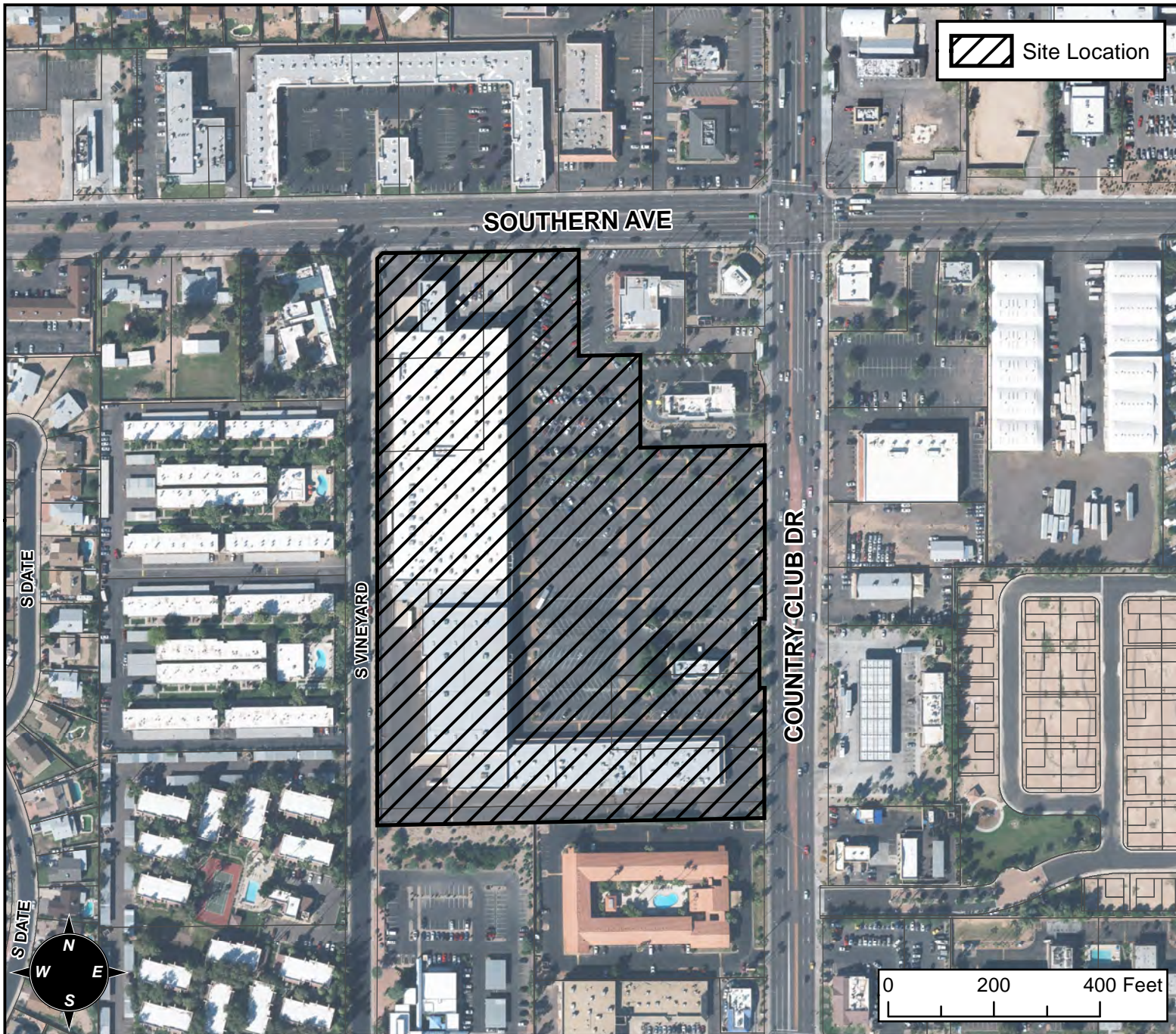

## CASE DETAIL

### CASE:

BA17-016

### SITE / ADDRESS:

1300 S. COUNTY CLUB DRIVE - (DISTRICT 3)

### REQUEST:

REQUESTING A SUBSTANTIAL CONFORMANCE IMPROVEMENT PERMIT (SCIP) TO ALLOW REDEVELOPMENT OF A COMMERCIAL CENTER IN THE LC DISTRICT.