

WALL CONTRACTOR IS RESPONSIBLE IN OBTAINING ALL NECESSARY PERMITS FROM THE CITY OF MESA BUILDING DEPARTMENT.

A THOROUGH ATTEMPT HAS BEEN MADE TO SHOW THE LOCATIONS OF ALL UNDERGROUND OBSTRUCTIONS AND UTILITY LINES IN THE WORK AREA. HOWEVER, THE CONTRACTOR SHALL BE RESPONSIBLE FOR ANY DAMAGES TO OBSTRUCTIONS AND UTILITY LINES ENCOUNTERED DURING CONSTRUCTION AND SHALL DETERMINE THE EXACT LOCATION OF UTILITIES IN ADVANCE OF TRENCHING.

BEFORE ANY DIGGING, CALL 'BLUE-STAKE'

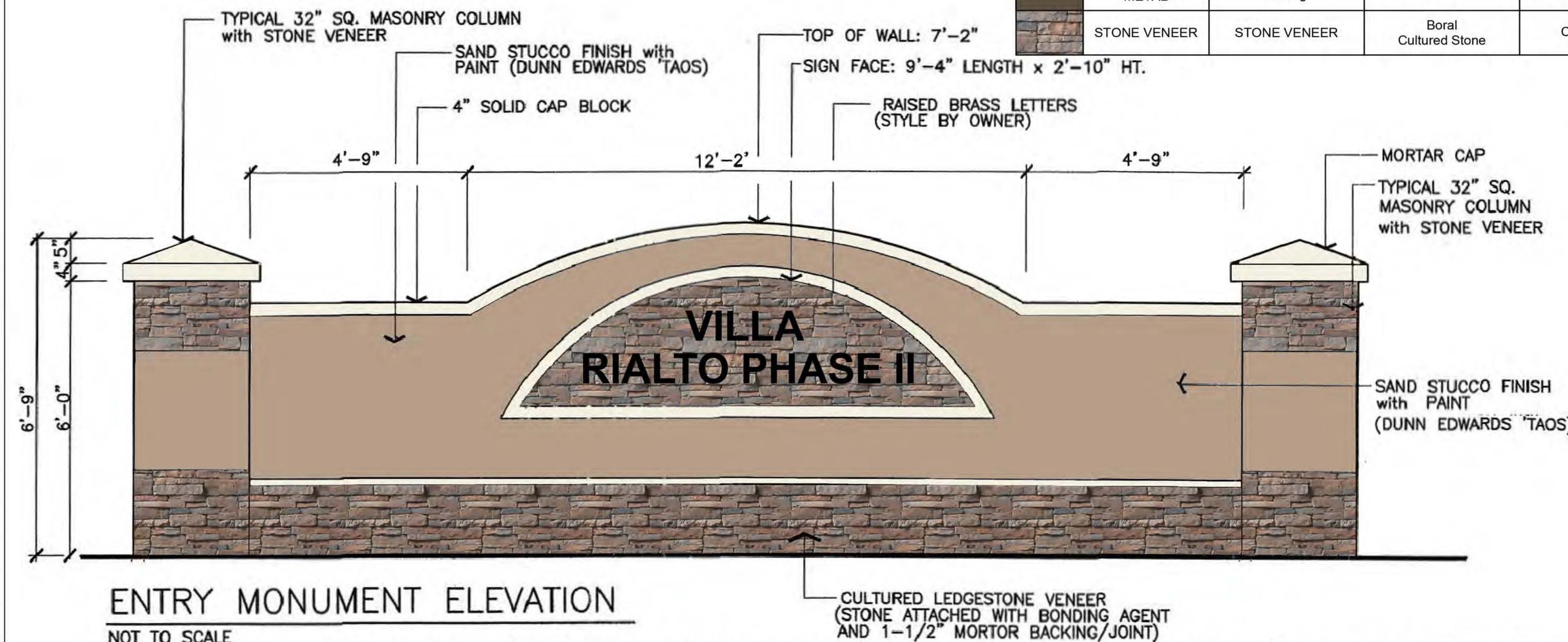

NOTE: ALL EXTERIOR SIGNS REQUIRE A SEPARATE SIGN PERMIT AND COMPATIBILITY WITH BUILDING ARCHITECTURE.

**NOTE: SIGNAGE MONUMENT/SIGNS WILL BE COVERED UNDER A SEPERATE CITY OF MESA PERMIT.**

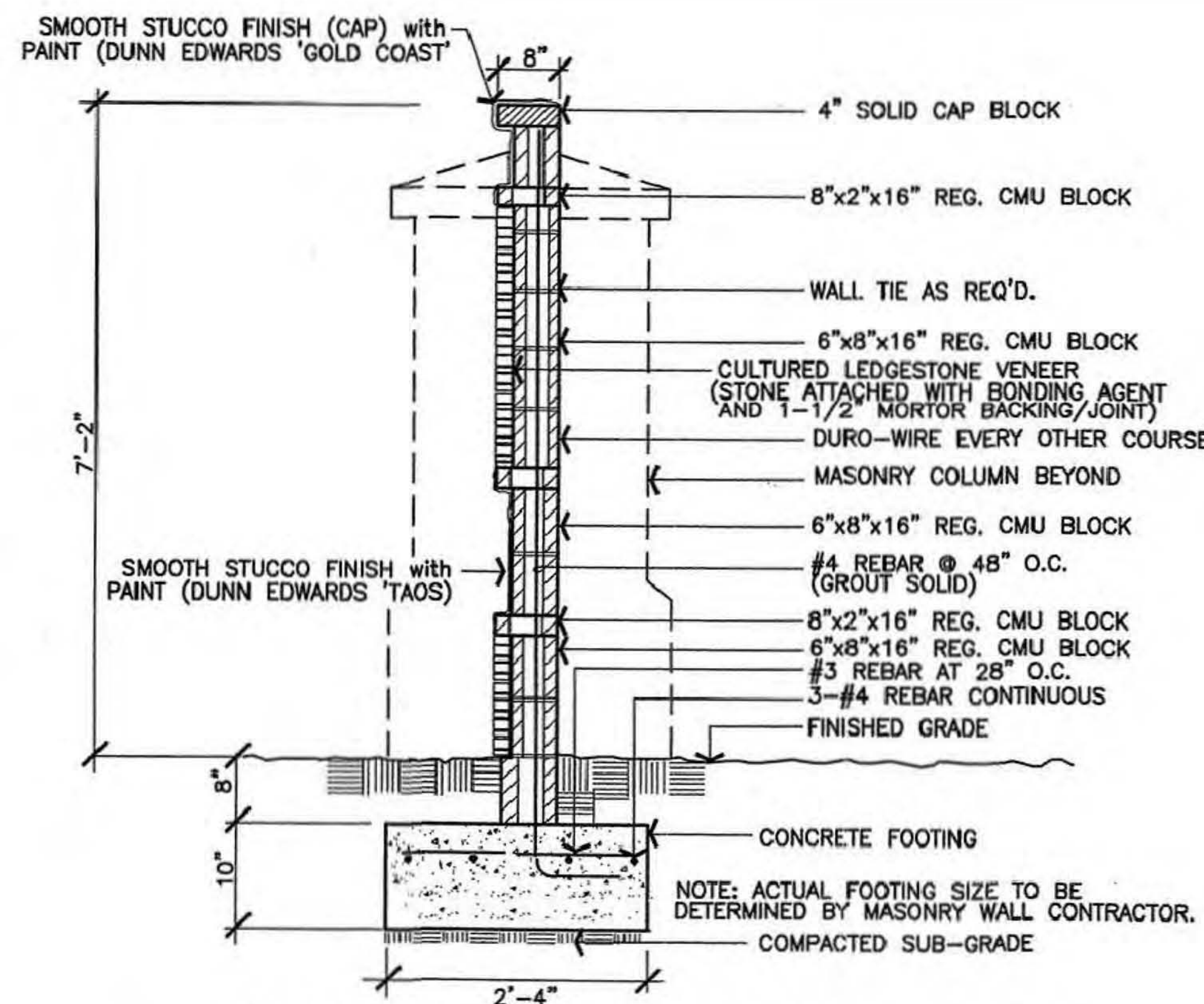

#### MATERIALS FINISH SCHEDULE

	MATERIAL	FINISH	MANUFACTURER	COLOR MATERIAL PRODUCT CODE
	1-KOTE STUCCO SYSTEM	PAINT Accent Color - Cap	Dunn Edwards	Daydreaming DET 678
	1-KOTE STUCCO SYSTEM	PAINT Body Color	Dunn Edwards	Baked Potato DEC 717
	1-KOTE METAL	PAINT Railing	Shervin-Williams	Best Bronze SW6160
	STONE VENEER	STONE VENEER	Boral Cultured Stone	Chardonnay

#### NOTES:

1. ALL MASONRY WALLS TO BE STRUCTURALLY ENGINEERED FOR PROPER STABILITY BY A CERTIFIED STRUCTURAL ENGINEER.
2. ALL SIGNAGE PER REQUIRED SEPARATE PERMIT FROM CITY OF MESA.
3. SIGNAGE FACE AND LETTERING TO CONFORM TO CITY OF SCOTTSDALE SIGNAGE CODES AND SPECIFICATIONS.

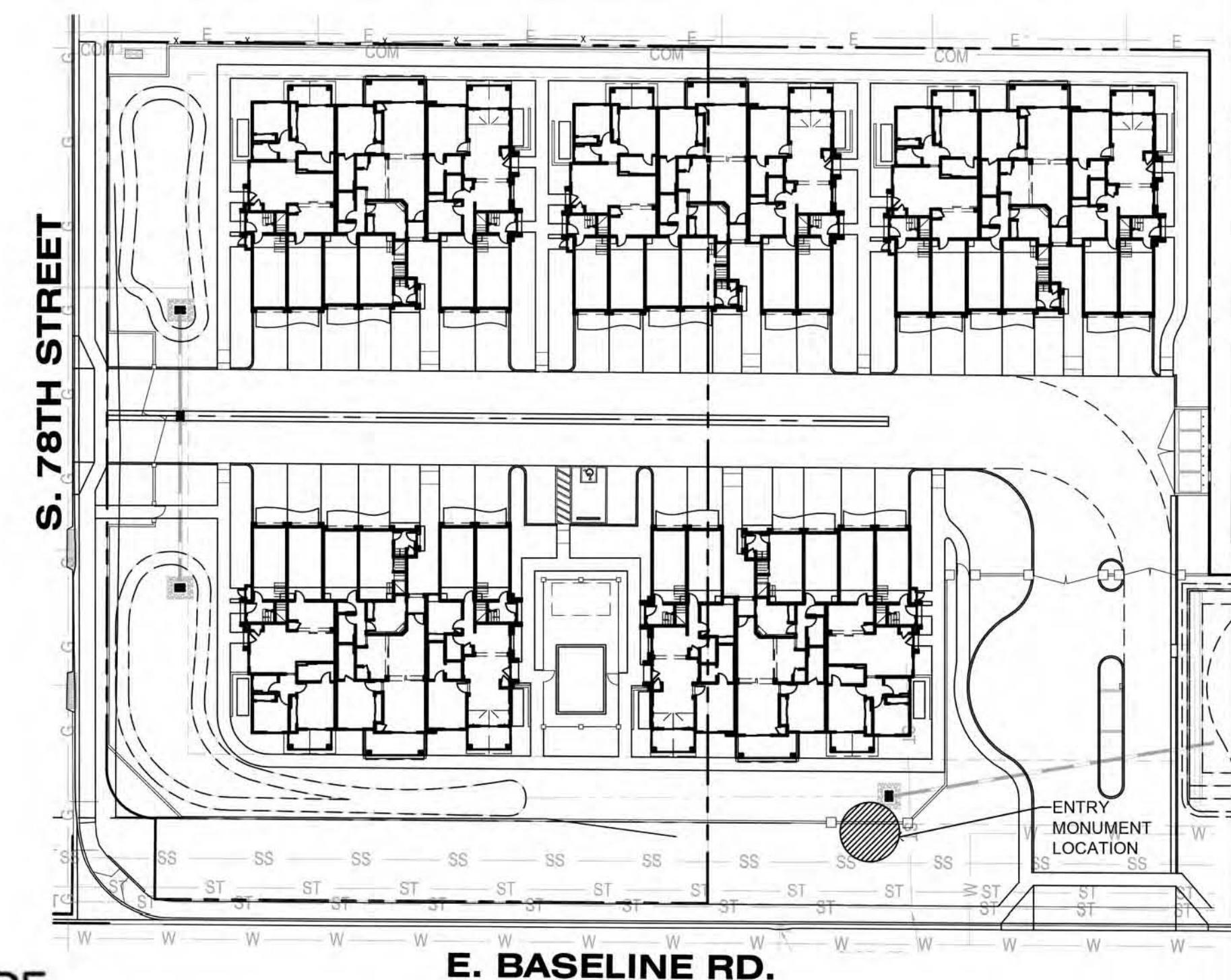
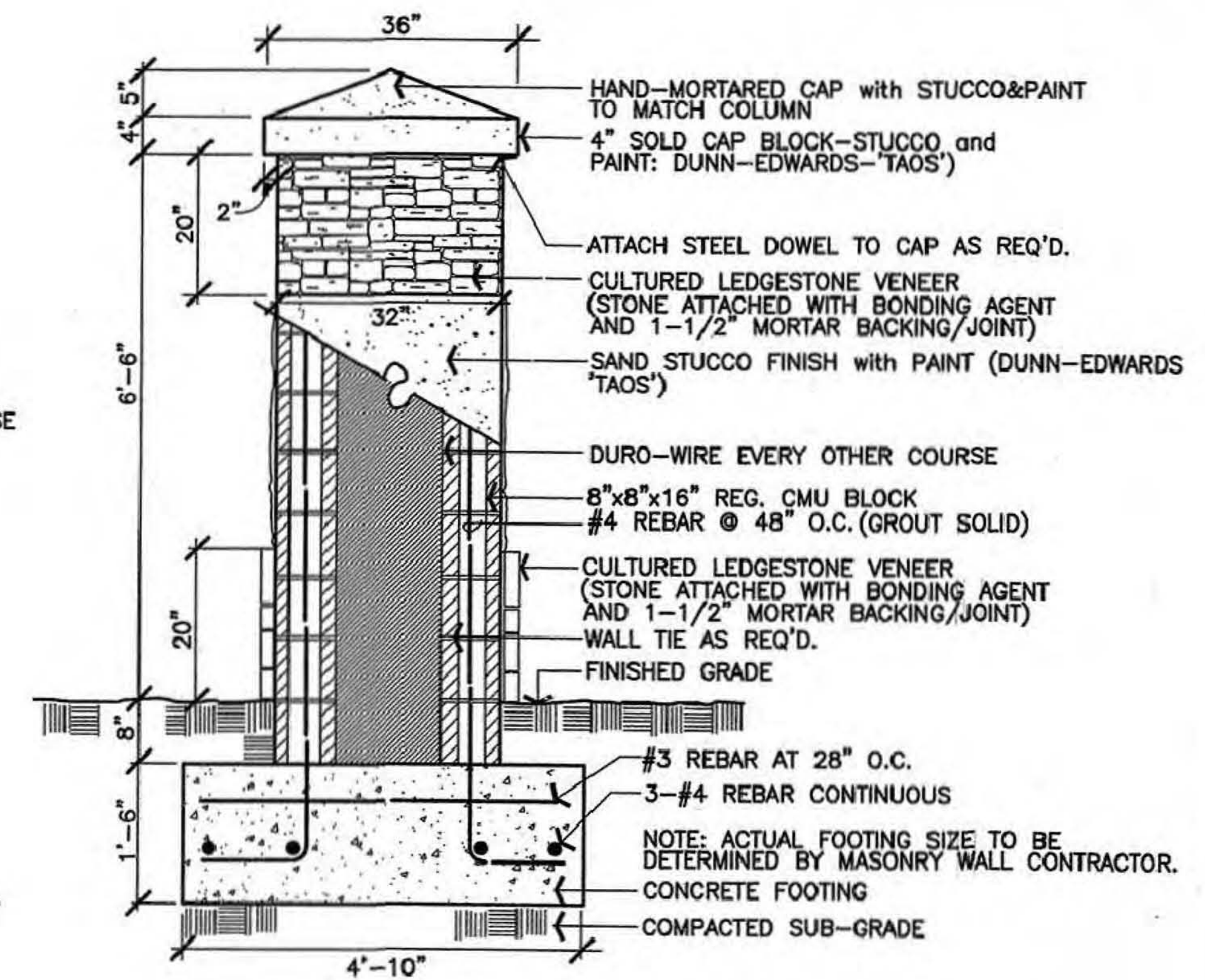

Rev.	Date	Submittal
	04-20-2016	Pre-Application



EXPIRATION DATE: 09/30/2017  
SIGNED AND SEALED  
ELECTRONICALLY 04-20-2016

Copyright reserved:  
e-project 2015-2016  
This document / drawing is protected by federal copyright law. No copies, reproductions or electronic transfer of this document / drawing may be made without written authorization. Civil proceedings claiming damages or other remedies may be brought against persons found copying this document without permission of copyright.

**Villa Rialto  
Phase II**  
By KDI Investments, LLC  
7820 East Baseline Road, Mesa, AZ 85208

#### Site Details

Date:	04-20-2016
Project No.	0813-2
Drawn By:	ED
Checked By:	ED
Approved By:	ED

Scale: AS NOTED

**A130**

5 OF 14





SCALE: 1"=20'-0"

These Landscape Architectural Design plan documents contain information which may be confidential, subject to privilege or exempt from disclosure under applicable law. These plan documents are solely for the use of the intended recipient and are not to be distributed to any other person. These documents you are hereby notified that any distribution, disclosure, printing, copying, storage, modification or the taking of any action in reliance upon these plan documents is strictly prohibited. Delivery of these plan documents to any person other than the intended recipient shall not compromise the confidentiality, privilege or exemption from disclosure as to this communication.

## MATERIALS FINISH SCHEDULE



SCALE : N.T.S



BEFORE ANY DIGGING  
CALL 'BLUE-STAKE'



SCALE : N.T.S.

**NOTE:**

THE GATE CONTROLLER RELEASES THE GATE(S) AUTOMATICALLY UPON LOSS OF POWER. IF BATTERY BACK-UP IS INSTALLED, UPON LOSS OF POWER OR LOW BATTERY, THE GATES WILL OPEN AND REMAIN OPEN. EXCEPTION: IF THE GATE IS LINKED TO AN EMERGENCY GENERATOR ON SITE AS A SECOND SOURCE OF POWER.

**NOTES.**

- PROVIDE A KNOX BOX ACCESS SYSTEM.
- EMERGENCY GATE SHALL BE FULLY AUTOMATIC FOR FIRE DEPT. USE ONLY

**33'x33' SIGHT VISIBILITY TRIANGLE NOTE:**  
NO STRUCTURES, LANDSCAPING, IRRIGATION COMPONENTS, FENCE, WALL, BERM TERRACE OR OTHER OBSTRUCTION TO VIEW IN EXCESS OF TWO FEET IN HEIGHT AS MEASURED FROM THE CENTERLINE OF THE STREET SHALL BE PLACED WITHIN THE REQUIRED 33x33 FOOT SIGHT VISIBILITY TRIANGLES.

**SIGHTLINE NOTE**

ALL TREES WITHIN THE SIGHT VISIBILITY LINES TO BE TRIMMED UP AND MAINTAINED AT A 7' MIN CANOPY HEIGHT, AND ALL GROUND COVER TO BE MAINTAINED AT A MAX. HEIGHT OF 24". NO SHRUBS ARE ALLOWED IN THE SIGHT VISIBILITY LINES.

A THOROUGH ATTEMPT HAS BEEN MADE TO SHOW THE LOCATIONS OF ALL UNDERGROUND OBSTRUCTIONS AND UTILITY LINES IN THE WORK AREA. HOWEVER, THE CONTRACTOR SHALL BE RESPONSIBLE FOR ANY DAMAGES TO OBSTRUCTIONS AND UTILITY LINES ENCOUNTERED DURING CONSTRUCTION AND SHALL DETERMINE THE EXACT LOCATION OF UTILITIES IN ADVANCE OF TRENCHING.



SCALE : 1" = 10'-0"

WROUGHT IRON PEDESTRIAN GATE-

EXPIRATION DATE: 09/30/2017  
SIGNED AND SEALED  
ELECTRONICALLY 04-20-2016

Copyright reserved:  
**e-project** 2015-2016

This document / drawing is protected by federal copyright law. No copies, reproductions or electronic transfer of this document / drawing may be made without written authorization. Civil proceedings claiming damages or other remedies may be brought against persons found copying this document without permission © copyright.

# Villa Rialto

## Phase II

KDL Investments, L

By KDL Investments, LLC  
7820 East Baseline Road Mesa AZ 85208

## Site Details

Scale: AS NOTED

# A140

6 OF 14