

ENTRY MONUMENT

A

NOTE: THE CONTRACTOR SHALL PROVIDE SHOP DRAWINGS TO THE LANDSCAPE ARCHITECT FOR REVIEW AND APPROVAL PRIOR TO THE BEGINNING OF CONSTRUCTION.
NOTE: FINAL STONE TYPE AND WALL COLOR BY OWNER.

SCALE: 3/8" = 1'-0"







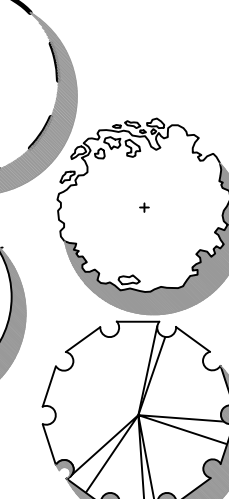

THEME WALL

B

NOTE: THE CONTRACTOR SHALL PROVIDE SHOP DRAWINGS TO THE LANDSCAPE ARCHITECT FOR REVIEW AND APPROVAL PRIOR TO THE BEGINNING OF CONSTRUCTION.
NOTE: FINAL STONE TYPE AND WALL COLOR BY OWNER.

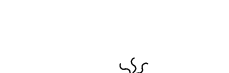
SCALE: 3/8" = 1'-0"

PLANT LEGEND

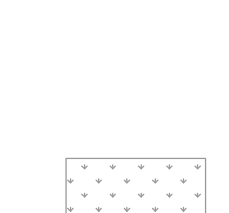
SYMBOL	BOTANICAL NAME	COMMON NAME	SIZE	QTY
TREES				
	EXISTING TREE	ALL EXISTING TREES TO BE REMOVED	EXISTING	4
	ACACIA ANEURA	MULGA	24" BOX	14
	ACACIA SALICINA	WILLOW ACACIA	24" BOX	13
	DALBERGIA SISSOO	SISSOO TREE	15 GAL.	8
SHRUBS				TREE SUBTOTAL 35
	LEUCOPHYLLUM LAEVIGATUM	CHIHUAHUAN SAGE	5 GAL.	52
	NERIUM OLEANDER	PETITE PINK OLEANDER	5 GAL.	41
	RUELLIA BRITTONIANA	BRITISH RUELLIA	5 GAL.	70
ACCENTS				SHRUB SUBTOTAL 163
	AGAVE DESMETTIANA	AGAVE	5 GAL.	32
GROUNDCOVER				ACCENT SUBTOTAL 32
	EUPHORBIA RIGIDA	GOPHER PLANT	1 GAL.	32
	LANTANA 'NEW GOLD'	NEW GOLD LANTANA	1 GAL.	99
	RUELLIA BRITTONIANA 'KATIE'	KATIE RUELLIA	1 GAL.	67
	SPHAGNETICOLA TRILOBATA	YELLOW DOT	1 GAL.	86
INERT GROUNDCOVER				GROUNDCOVER SUBTOTAL 284
	DECOMPOSED GRANITE	EXPRESS BROWN	1/2" SCREENED	12,630 S.F. (106 TONS)
	TURF	BERMUDA		3,806 S.F.
	4" X 6" CONCRETE HEADER	PLAIN CONCRETE		315 L.F.

PRELIMINARY LANDSCAPE NOTES

PLANTING

THE SITE WILL BE LANDSCAPED IN ACCORDANCE WITH THE CITY OF MESA STANDARDS. ALL TREES AND SHRUBS ARE TO BE STAKED AND PLANTED IN ACCORDANCE WITH THE ARIZONA NURSERY ASSOCIATION PUBLISHED STANDARDS.

SIZES OF TREES AND SHRUBS WILL CORRESPOND WITH REQUIREMENTS SET BY THE CITY OF MESA. ALL PLANTING AREAS WILL RECEIVE A 2" DEPTH DECOMPOSED GRANITE AND SHALL BE TREATED WITH PRE-EMERGENT HERBICIDE.

IRRIGATION

THE IRRIGATION SYSTEM WILL CONSIST OF DRIP EMITTERS AND PRESSURE REGULATORS CONNECTED TO AUTOMATIC VALVES AND WILL BE TIED INTO AUTOMATIC CONTROLLERS AS REQUIRED. THE IRRIGATION SYSTEM SHALL PROVIDE 100% COVERAGE.

GRADING

ALL EARTHWORK WILL BE DONE SO THAT ALL MOISTURE DRAINS OFF AND AWAY FROM SIDEWALKS AND STRUCTURES. THE MAJORITY OF ONSITE DRAINAGE WILL DRAIN INTO THE RETENTION BASINS LOCATED ON SITE.

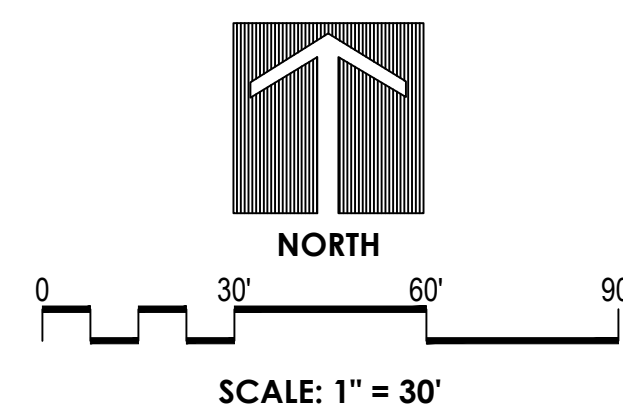
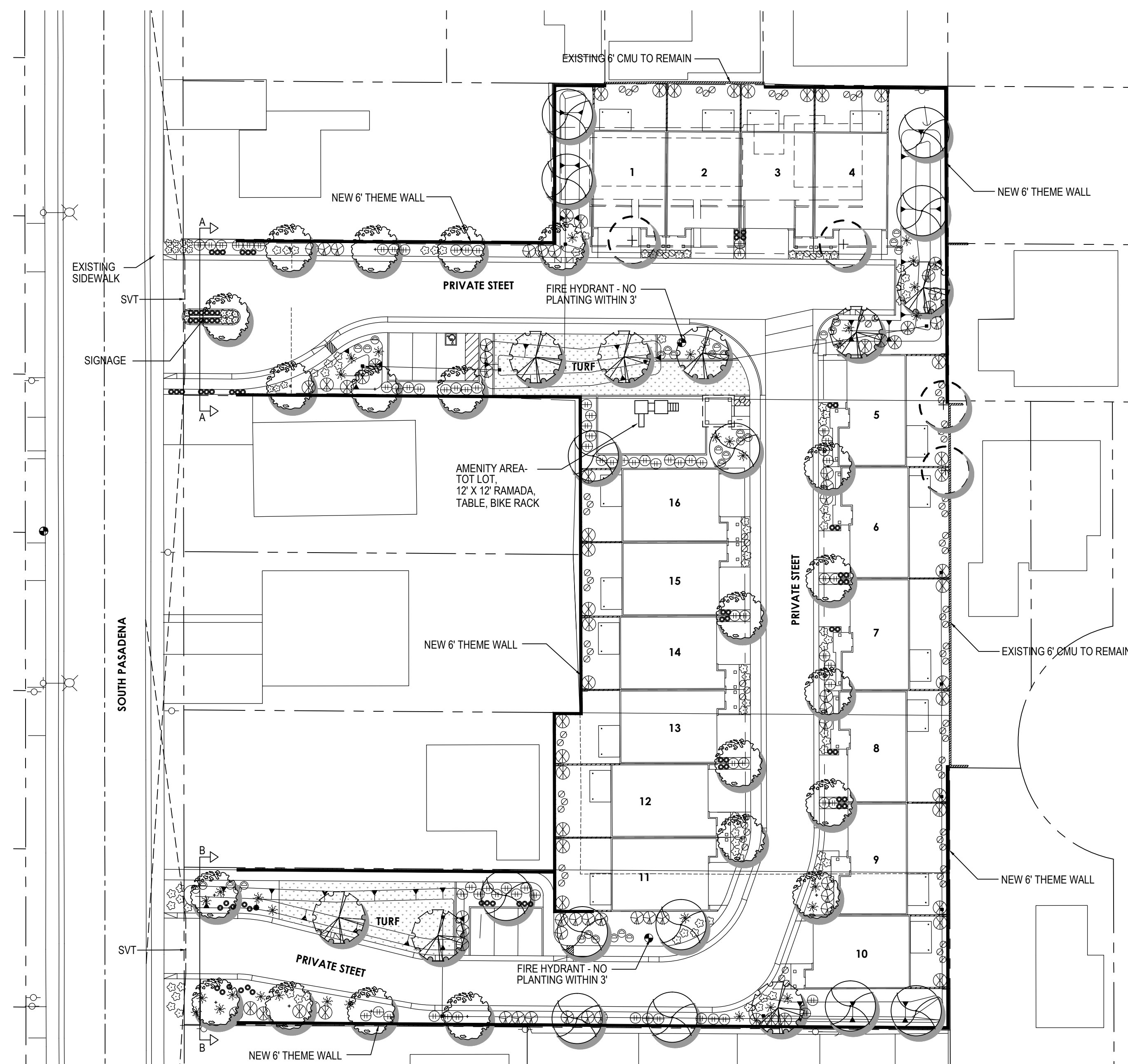

523 S PASADENA,
MESA AZ

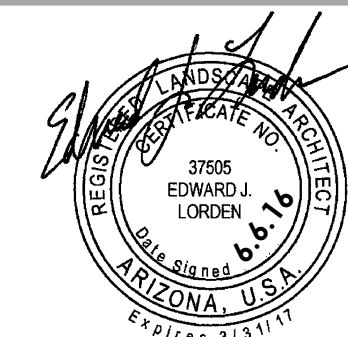

PLOTTED: DOLSEN ON 07/16/2016 AT 04:41 PM
 THIS DRAWING AND ANY ELECTRONIC MEDIA IS AN INSTRUMENT OF SERVICE AND SHALL REMAIN THE PROPERTY OF PINNACLE DESIGN, INC. WHETHER THE PROJECT FOR WHICH THIS DRAWING IS MADE IS EXECUTED OR NOT. THEY ARE NOT TO BE USED BY THE OWNER ON OTHER PROJECTS OR EXTENSIONS OF THIS PROJECT EXCEPT BY WRITTEN AGREEMENT AND/OR APPROPRIATE COMPENSATION TO PINNACLE DESIGN, INC. COPYRIGHT © 2012 PINNACLE DESIGN, INC.

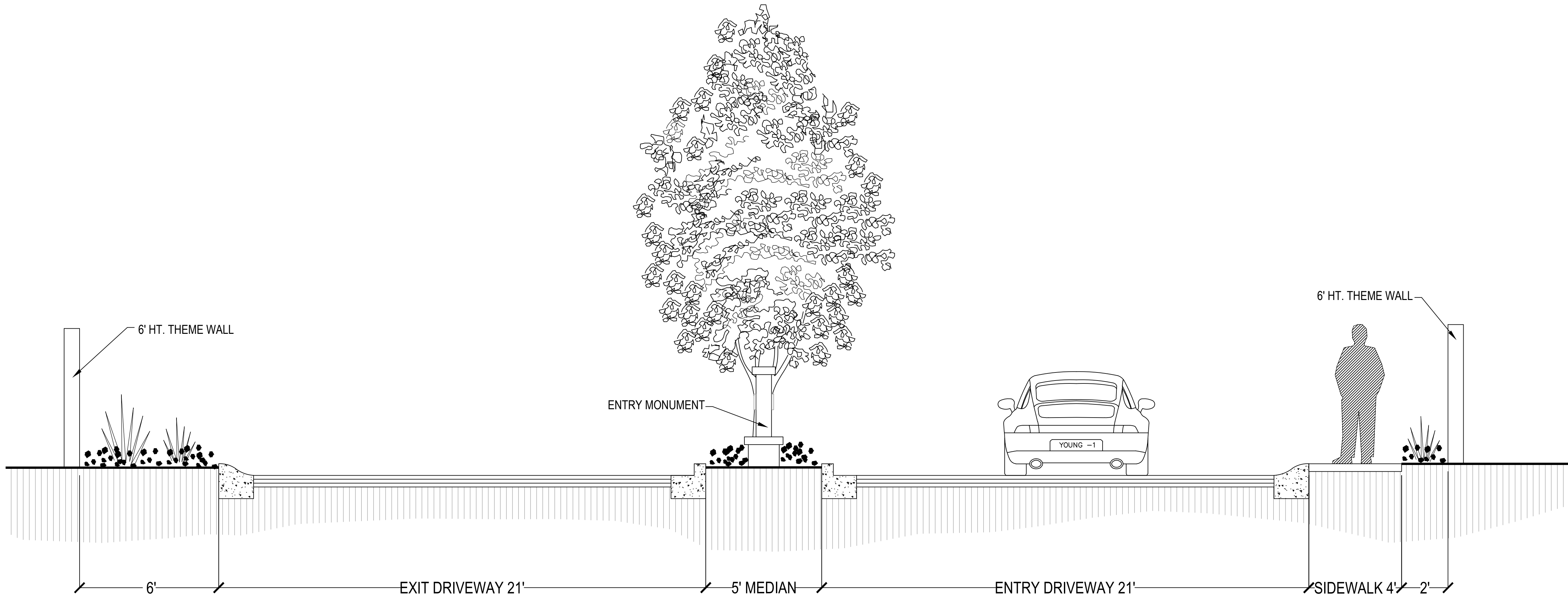

A NORTH SECTION

SCALE: 3/8" = 1'-0"

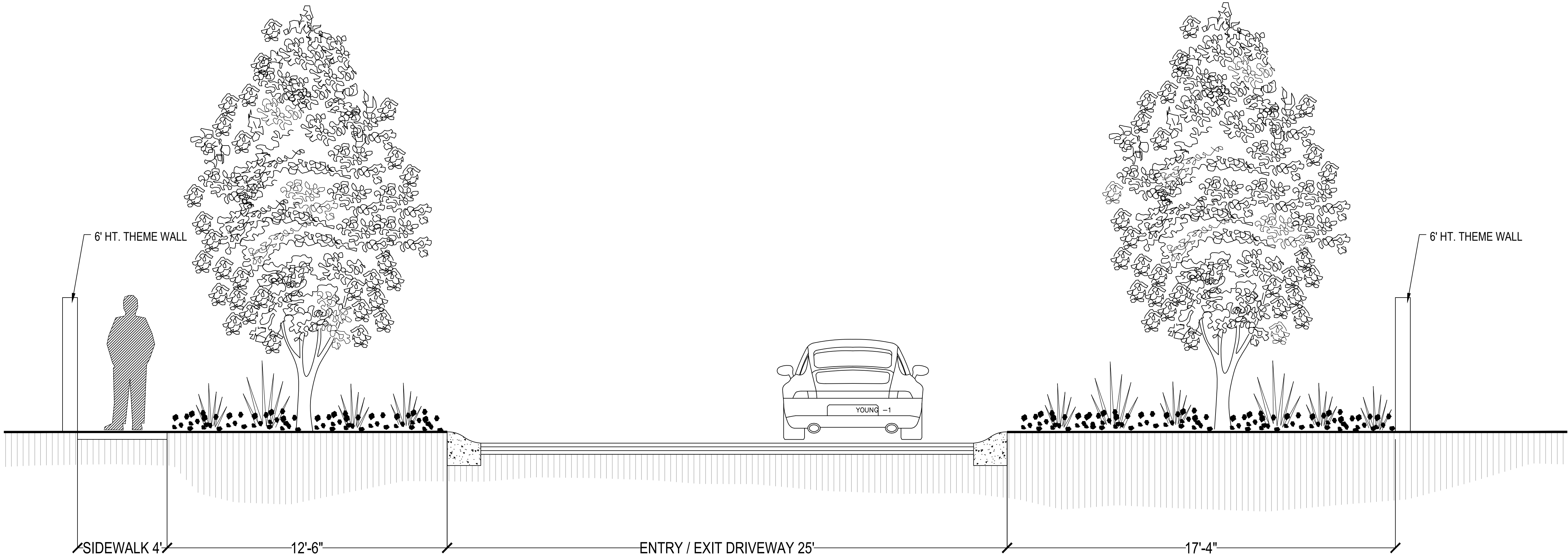

B SOUTH SECTION

SCALE: 3/8" = 1'-0"

523 S PASADENA,
 MESA AZ



Drawn By:	DO
Job No:	16009
Date:	3.30.16
CITY COMMENTS	6.6.16
PL-2	of 2