

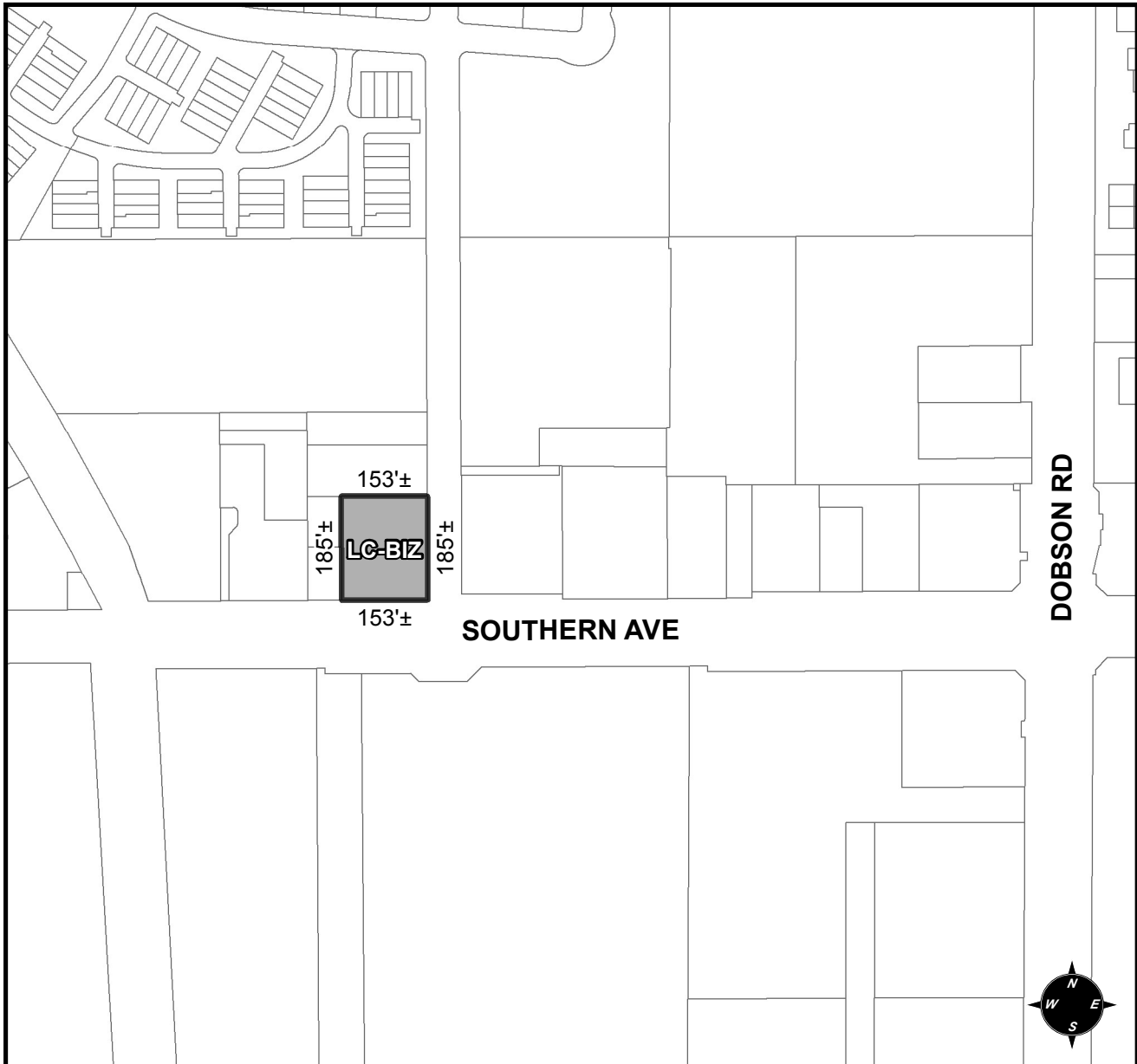

# OFFICIAL SUPPLEMENTARY ZONING MAP AMENDING THE CITY OF MESA ZONING MAP



**CASE: Z15-033**

**ACREAGE: 0.65±**

**REQUEST: REZONE FROM OC TO LC-BIZ. THIS REQUEST WILL ALLOW THE DEVELOPMENT OF COMMERCIAL SPACE WITH A DRIVE-THRU.**

**ORDINANCE: \_\_\_\_\_**

Please be advised that the attached zoning changes were approved by the Mesa City Council on \_\_\_\_\_, 2016 by Ordinance # \_\_\_\_\_. If you have any questions concerning these changes, contact the City of Mesa Planning Division at 480-644-2385.

\_\_\_\_\_  
**MAYOR**

**ATTEST: \_\_\_\_\_ DATE: \_\_\_\_\_**

**CITY CLERK**