

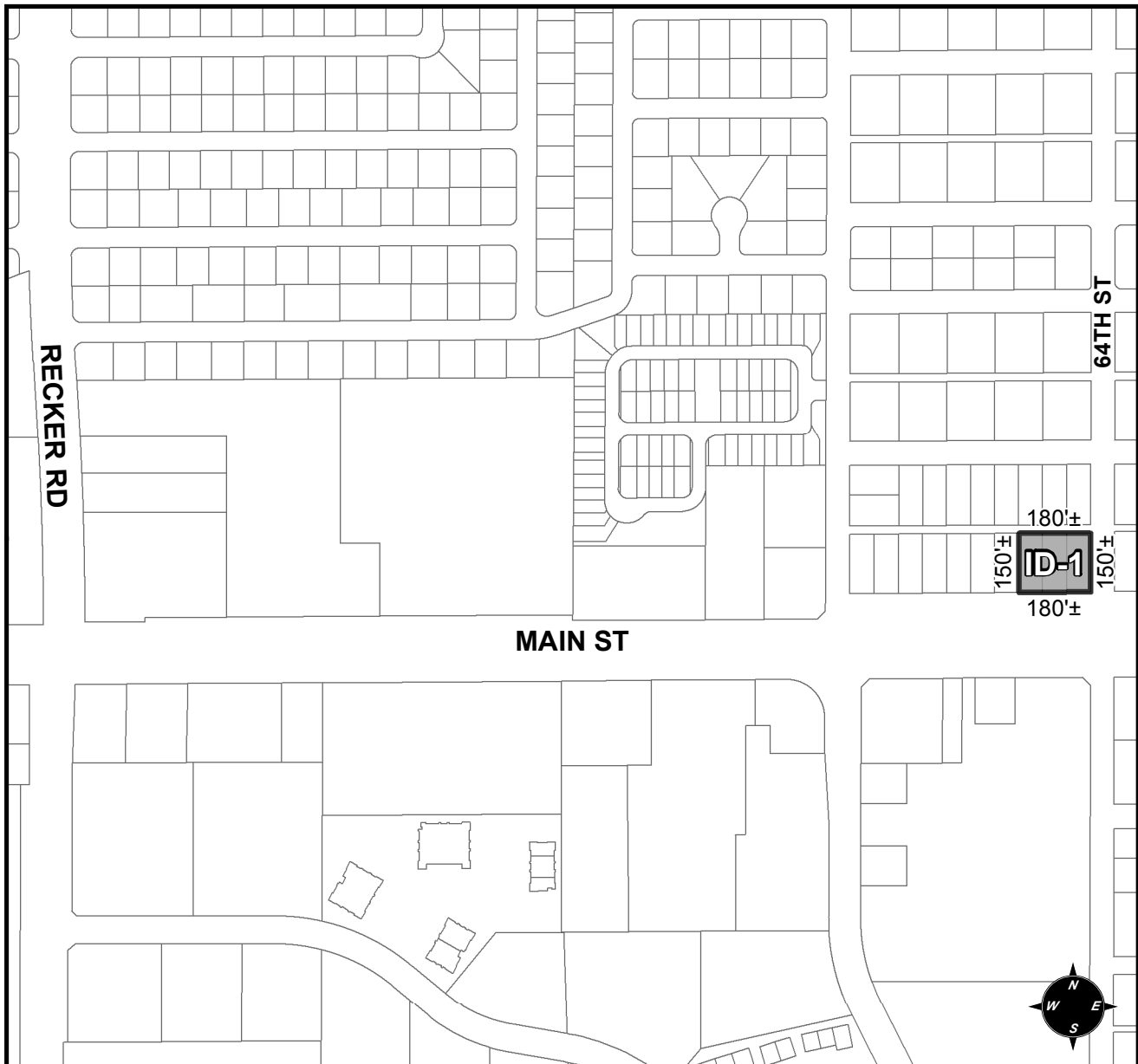

OFFICIAL SUPPLEMENTARY ZONING MAP AMENDING THE CITY OF MESA ZONING MAP



CASE: Z15-030

ACREAGE: 1±

REQUEST: REZONE FROM LC TO ID-1 AND SITE PLAN REVIEW. THIS REQUEST WILL FACILITATE INFILL DEVELOPMENT ON EAST MAIN STREET.

ORDINANCE: _____

Please be advised that the attached zoning changes were approved by the Mesa City Council on _____, 2015 by Ordinance # _____. If you have any questions concerning these changes, contact the City of Mesa Planning Division at 480-644-2385.

ATTEST: _____ DATE: _____

MAYOR

CITY CLERK