

#117734

Meeting 11/9/15

Agenda 10/20/15

LI
#3

LIQ 115129

Special Event Liquor License Application Attachment B

Licensing Office
55 North Center Street
PO Box 1466
Mesa, Arizona 85211-1466
480-644-2316 Telephone
480-644-3999 Fax
www.mesaaz.gov



RECEIVED
mesa.az
OCT 08 2015

CITY OF MESA
LICENSING OFFICE

If you are having alcohol sales you will need to obtain a Special Event Liquor License or an Extension of Premises from City of Mesa Licensing Office. This must be submitted at least 60 days prior to the event. A license is required with special provision outlined. Plan a minimum of 60 days to complete this process.

Check all that apply:

- ☐ Free/Host Alcohol
☒ Alcohol Sales
☒ Host and Sale Alcohol

- ☒ Beer
☒ Beer and Wine
☒ Beer, Wine and Distilled Spirits

Do you plan to secure a:

☒ **Special Event Liquor License** - The Special Event Liquor License fee is \$25 and must be approved by the City Council. After city approval, your application must be submitted to and approved by the State of Arizona. There are fees involved at the State. A non-profit association must obtain this license. (Complete State of Arizona Special Event Liquor Application and site plan.)

OR

☐ **Extension of Premises License** - There is no fee involved with the Extension of Premises. This is allowed when a liquor license is already in affect and you want to extend the area where liquor is sold. (Complete State of Arizona Extension of Premises Application and site plan.)

Please describe your security plan to ensure the safe sale or distribution of alcohol at your event 8F+ chain link fence, Team Security, Police Officers

If applying for a Special Event Liquor License the following must be provided:

Usual Suspects Law Enforcement Motorcycle club, Arizona Chapter 20-346205
Charity's or Organization's Name
Steven Rachter
Treasurer
501 (C)#
602-809-0604
Name of Contact at Charity/Organization
Steven Rachter
Title with Organization
Phone Number
On-Site Agent Responsible for Liquor

How will attendees over the age of 21 be identified? Team Security, off premise before entering through secured gates

What controls will be used to keep attendees under the age of 21 from obtaining alcohol at the event? over 21
Event NO MINORS

Will food be served? ☒ Yes ☐ No If yes, what type of food will be served Common Menu Burger, Sandwiches, App

Seating capacity of designated area: # 300



Arizona Department of Liquor Licenses and Control
800 W Washington 5th Floor
Phoenix, AZ 85007-2934
www.azliquor.gov
(602) 542-5141

FOR DLLC USE ONLY

Event Date(s):

Event time start/end:

CSR:

License:

APPLICATION FOR SPECIAL EVENT LICENSE

Fee= \$25.00 per day for 1-10 days (consecutive)

A service fee of \$25.00 will be charged for all dishonored checks (A.R.S. § 44-6852)

IMPORTANT INFORMATION: This document must be fully completed or it will be returned.

The Department of Liquor Licenses and Control must receive this application ten (10) business days prior to the event. If the special event will be held at a location without a permanent liquor license or if the event will be on any portion of a location that is not covered by the existing liquor license, this application must be approved by the local government before submission to the Department of Liquor Licenses and Control (see Section 15).

SECTION 1 Name of Organization: Usual Suspects Law Enforcement Motorcycle Club, Arizona Chapter

SECTION 2 Non-Profit/IRS Tax Exempt Number: 20-3146205

SECTION 3 The organization is a: (check one box only)

- ☒ Charitable ☐ Fraternal (must have regular membership and have been in existence for over five (5) years)
☐ Religious ☐ Civic (Rotary, College Scholarship) ☐ Political Party, Ballot Measure or Campaign Committee

SECTION 4 Will this event be held on a currently licensed premise and within the already approved premises? ☒ Yes ☐ No

Mad Dog Saloon

06075017

480-813-5878

Name of Business

License Number

Phone (Include Area Code)

SECTION 5 How is this special event going to conduct all dispensing, serving, and selling of spirituous liquors? Please read R-19-318 for explanation (look in special event planning guide) and check one of the following boxes.

- ☐ Place license in non-use
☐ Dispense and serve all spirituous liquors under retailer's license
☒ Dispense and serve all spirituous liquors under special event
☐ Split premise between special event and retail location

(If not using retail license, submit a letter of agreement from the agent/owner of the licensed premise to suspend the license during the event. If the special event is only using a portion of premise, agent/owner will need to suspend that portion of the premise.)

SECTION 6 What is the purpose of this event? ☒ On-site consumption ☐ Off-site (auction) ☐ Both

SECTION 7 Location of the Event: Mad Dog Saloon

Address of Location: 1860 S Stapley Drive, Mesa Maricopa/Arizona 85204

Street

City

COUNTY

State

Zip

SECTION 8 Will this be stacked with a wine festival/craft distiller festival? ☐ Yes ☒ No

SECTION 9 Applicant must be a member of the qualifying organization and authorized by an Officer, Director or Chairperson of the Organization named in Section 1. (Authorizing signature is required in Section 13.)

1. Applicant: Raether Steven Lloyd REDACTED
Last First Middle Date of Birth

2. Applicant's mailing address: 2747 E University #31742 Mesa Arizona 85213
Street City State Zip

3. Applicant's home/cell phone: (REDACTED) Applicant's business phone: (REDACTED)

4. Applicant's email address: sraether@q.com

SECTION 10

1. Has the applicant been convicted of a felony, or had a liquor license revoked within the last five (5) years?

☐ Yes ☒ No (If yes, attach explanation.)

2. How many special event licenses have been issued to this location this year? 0
(The number cannot exceed 12 events per year; exceptions under A.R.S. §4-203.02(D).)

3. Is the organization using the services of a promoter or other person to manage the event? ☐ Yes ☒ No
(If yes, attach a copy of the agreement.)

4. List all people and organizations who will receive the proceeds. Account for 100% of the proceeds. The organization applying must receive 25% of the gross revenues of the special event liquor sales. Attach an additional page if necessary.

Name Usual Suspects Law Enforcement Motorcycle Club Percentage: 100

Address 2747 E University #31742 Mesa Arizona 85213
Street City State Zip

Name _____ Percentage: _____

Address _____
Street City State Zip

5. Please read A.R.S. § 4-203.02 Special event license; rules and R19-1-205 Requirements for a Special Event License.

Note: ALL ALCOHOLIC BEVERAGE SALES MUST BE FOR CONSUMPTION AT THE EVENT SITE ONLY.

"NO ALCOHOLIC BEVERAGES SHALL LEAVE SPECIAL EVENT UNLESS THEY ARE IN AUCTION SEALED CONTAINERS OR THE SPECIAL EVENT LICENSE IS STACKED WITH WINE /CRAFT DISTILLERY FESTIVAL LICENSE"

6. What type of security and control measures will you take to prevent violations of liquor laws at this event?
(List type and number of police/security personnel and type of fencing or control barriers, if applicable.)

2 Number of Police 15 Number of Security Personnel ☒ Fencing ☐ Barriers

Explanation: 8ft Chain Link Fencing on extension of patio, with existing iron fencing on patios. Team security on exterior of fencing...

SECTION 11 Date(s) and Hours of Event. May not exceed 10 consecutive days.

See A.R.S. § 4-244(15) and (17) for legal hours of service.

	Date	Day of Week	Event Start Time AM/PM	License End Time AM/PM
DAY 1:	<u>11/14/2015</u>	<u>Saturday</u>	<u>12:00 pm</u>	<u>2:00 am</u>
DAY 2:	_____	_____	_____	_____
DAY 3:	_____	_____	_____	_____
DAY 4:	_____	_____	_____	_____
DAY 5:	_____	_____	_____	_____
DAY 6:	_____	_____	_____	_____
DAY 7:	_____	_____	_____	_____
DAY 8:	_____	_____	_____	_____
DAY 9:	_____	_____	_____	_____
DAY 10:	_____	_____	_____	_____

Bar

Security

Fence 8ft

SECTION 12 License premises diagram. The licensed premises for your special event is the area in which you are authorized to sell, dispense or serve alcoholic beverages under the provisions of your license. The following space is to be used to prepare a diagram of your special event licensed premises. Please show dimensions, serving areas, fencing, barricades, or other control measures and security position.

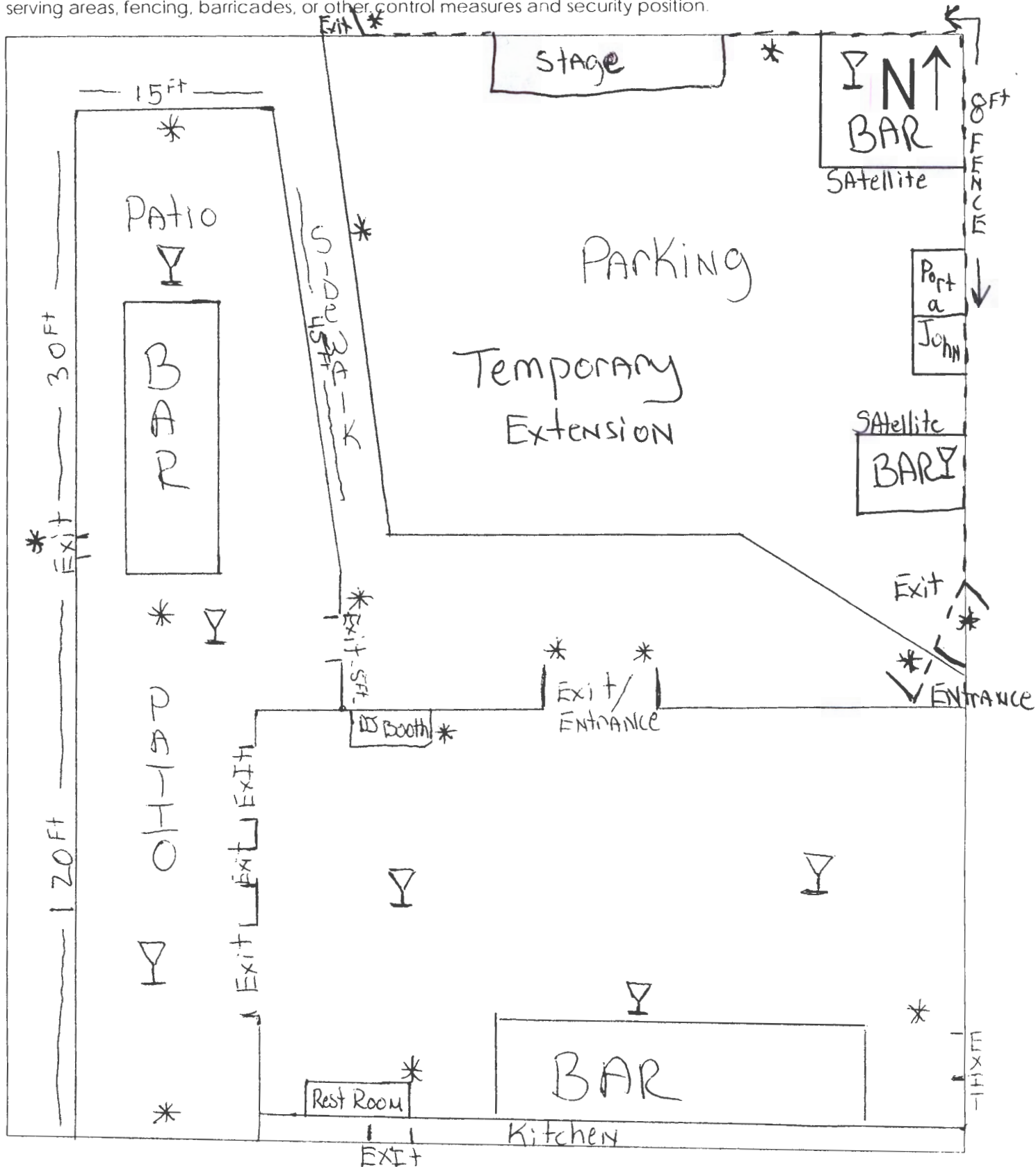

Google Maps Google Maps



Imagery ©2015 Google, Map data ©2015 Google 20 ft

Temporary
Extension

SECTION 13 To be completed only by an Officer, Director or Chairperson of the organization named in Section 1.

I, Steven Lloyd Raether declare that I am an OFFICER, DIRECTOR, or CHAIRPERSON
(Print Full Name)
appointing the applicant listed in Section 9, to apply on behalf of the foregoing organization for a Special Event
Liquor License.

X [Signature] Treasurer 10/8/15 REDACTED
(Signature) Title/ Position Date

The foregoing instrument was acknowledged before me this 8th October 2015
Day Month Year
State Arizona County of Maricopa

My Commission Expires on: 10-31-2016
Date
[Signature] Signature of Notary Public

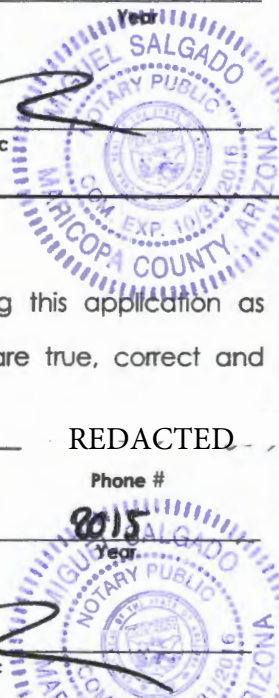

SECTION 14 This section is to be completed only by the applicant named in Section 9.

I, Steven Lloyd Raether declare that I am the APPLICANT filing this application as
(Print Full Name)
listed in Section 9. I have read the application and the contents and all statements are true, correct and
complete.

X [Signature] Treasurer 10/8/15 REDACTED
(Signature) Title/ Position Date Phone #

The foregoing instrument was acknowledged before me this 8th October 2015
Day Month Year
State Arizona County of Maricopa

My Commission Expires on: 10-31-2016
Date
[Signature] Signature of Notary Public

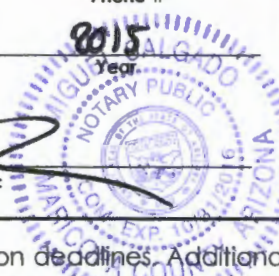

Please contact the local governing board for additional application requirements and submission deadlines. Additional
licensing fees may also be required before approval may be granted. For more information, please contact your local
jurisdiction: http://www.azliquor.gov/assets/documents/homepage_docs/spec_event_links.pdf.

SECTION 15 Local Governing Body Approval Section

I, _____ recommend ☐ APPROVAL ☐ DISAPPROVAL
(Government Official) (Title)

on behalf of _____
(City, Town, County) Signature Date Phone

FOR DEPARTMENT OF LIQUOR LICENSES AND CONTROL USE ONLY

☐ APPROVAL ☐ DISAPPROVAL BY: _____ DATE: _____

A.R.S. § 41-1030. Invalidity of rules not made according to this chapter; prohibited agency action; prohibited acts by state employees; enforcement; notice

B. An agency shall not base a licensing decision in whole or in part on a licensing requirement or condition that is not specifically authorized by statute, rule or state tribal gaming compact. A general grant of authority in statute does not constitute a basis for imposing a licensing requirement or condition unless a rule is made pursuant to that general grant of authority that specifically authorizes the requirement or condition.

D. THIS SECTION MAY BE ENFORCED IN A PRIVATE CIVIL ACTION AND RELIEF MAY BE AWARDED AGAINST THE STATE. THE COURT MAY AWARD REASONABLE ATTORNEY FEES, DAMAGES AND ALL FEES ASSOCIATED WITH THE LICENSE APPLICATION TO A PARTY THAT PREVAILS IN AN ACTION AGAINST THE STATE FOR A VIOLATION OF THIS SECTION.

E. A STATE EMPLOYEE MAY NOT INTENTIONALLY OR KNOWINGLY VIOLATE THIS SECTION. A VIOLATION OF THIS SECTION IS CAUSE FOR DISCIPLINARY ACTION OR DISMISSAL PURSUANT TO THE AGENCY'S ADOPTED PERSONNEL POLICY.

F. THIS SECTION DOES NOT ABROGATE THE IMMUNITY PROVIDED BY SECTION 12-820.01 OR 12-820.02.



Department of the Treasury
Internal Revenue Service

P.O. Box 2508, Room 4010
Cincinnati OH 45201

14 DEC 4 11:19 AM '10

In reply refer to: 4077550279
Apr. 13, 2012 LTR 4168C 0
20-3146205 000000 00

00034956

BODC: TE

USUAL SUSPECTS L E M C-ARIZONA
CHAPTER
% STEVE RAETHER
3750 E FARMDALE AVE
MESA AZ 85206

011693

Employer Identification Number: 20-3146205
Person to Contact: Sophia Brown
Toll Free Telephone Number: 1-877-829-5500

Dear Taxpayer:

This is in response to your Mar. 02, 2012, request for information regarding your tax-exempt status.

Our records indicate that you were recognized as exempt under section 501(c)(3) of the Internal Revenue Code in a determination letter issued in March 2006.

Our records also indicate that you are not a private foundation within the meaning of section 509(a) of the Code because you are described in section(s) 509(a)(1) and 170(b)(1)(A)(vi).

Donors may deduct contributions to you as provided in section 170 of the Code. Bequests, legacies, devises, transfers, or gifts to you or for your use are deductible for Federal estate and gift tax purposes if they meet the applicable provisions of sections 2055, 2106, and 2522 of the Code.

Please refer to our website www.irs.gov/eo for information regarding filing requirements. Specifically, section 6033(j) of the Code provides that failure to file an annual information return for three consecutive years results in revocation of tax-exempt status as of the filing due date of the third return for organizations required to file. We will publish a list of organizations whose tax-exempt status was revoked under section 6033(j) of the Code on our website beginning in early 2011.



Mad Dog Saloon
1860 South Stapley Drive
Mesa, Arizona 85204

October 15th, 2015

To Whom It May Concern,

I Dominic Riccobono being the owner and operator of Mad Dog Saloon. Will be giving my permission to suspend the Liquor License of Mad Dog Saloon for the event of Nov 14th, 2015. The time and date for this event are as follows; 8am Nov 14th – 6am Nov 15th. Name of Organization Usual Suspects Law Enforcement Motorcycle Club. Arizona Chapter.

If you have any questions please feel free to contact me.

Sincerely,

Dominic Riccobono

X _____

C: (602)-481-6661

O: (480) 813-5878