

Agenda 11/6/15 meeting 11/26/15

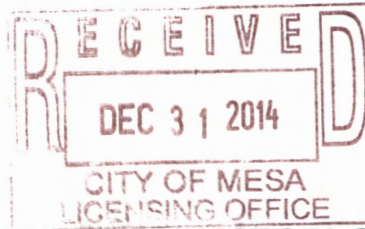

Licensing Office
55 North Center Street
PO Box 1466
Mesa, Arizona 85211-1466
480-644-2316 Telephone
480-644-3999 Fax
www.cityofmesa.org

#117241

SPECIAL EVENT AND EXTENSION OF PREMISES INFORMATION SHEET

2/14/15

IS-6 PAD
#3

If you are having alcohol sales you will need to obtain a Special Event Liquor License or an Extension of Premises from City of Mesa Licensing Office. This must be submitted at least 60 days prior to the event. A license is required with special provision outlined. Plan a minimum of 60 days to complete this process.

Check all that apply:

- ☐ Free/Host Alcohol
☐ Alcohol Sales
☐ Host and Sale Alcohol

- ☐ Beer
☒ Beer and Wine
☐ Beer, Wine and Distilled Spirits

Do you plan to secure a:

☒ **Special Event Liquor License** - The Special Event Liquor License fee is \$25 and must be approved by the City Council. After city approval, your application must be submitted to and approved by the State of Arizona. There are fees involved at the State. A non-profit association must obtain this license. (Complete attached State of Arizona Special Event Liquor Application and site plan.) Valentine Dinner/Dance

OR

☐ **Extension of Premises License** - There is no fee involved with the Extension of Premises. This is allowed when a liquor license is already in affect and you want to extend the area where liquor is sold. (Complete attached State of Arizona Extension of Premises Application and site plan.)

Please describe your security plan to ensure the safe sale or distribution of alcohol at your event only advance tickets will be sold to adults over the age of 21. No one else will be permitted in the facility

If applying for a Special Event Liquor License the following must be provided:

ST Timothy Catholic Church 32-0267724
Charity's or Organization's Name 501 (C)(3)#
Fr. Charles Goraich Pastor
Name of Contact at Charity/Organization Title with Organization
Robert Behnke Co-ord Married couples ministry Phone Number
On-Site Agent Responsible for Liquor REDACTED

How will attendees over the age of 21 be identified? Advanced tickets will only be sold to adults over the age of 21. Doors will be monitored and only persons with tickets will be permitted in the facility

What controls will be used to keep attendees under the age of 21 from obtaining alcohol at the event? No attendees without pre-purchased tickets will be admitted

Will food be served? ☒ Yes ☐ No If yes, what type of food will be served Dinner Prime Rib + chicken Dinner

Seating capacity of designated area: # 160 Expecting which is fewer than capacity

Arizona Department of Liquor Licenses and Control
800 W. Washington 5th Floor
Phoenix AZ 85007-2934
www.azliquor.gov

FOR DLLC USE ONLY

Event date(s):

Event time start/end:

APPLICATION FOR SPECIAL EVENT LICENSE

Fee= \$25.00 per day for 1-10 days (consecutive)

A service fee of \$25.00 will be charged for all dishonored checks (A.R.S. §44-6852)

IMPORTANT INFORMATION: This document must be fully completed or it will be returned.

The Department of Liquor Licenses and Control must receive this application ten (10) business days prior to the event. If the special event will be held at a location without a permanent liquor license or if the event will be on any portion of a location that is not covered by the existing liquor license, this application must be approved by the local government before submission to the Department of Liquor Licenses and Control (see Section 15).

SECTION 1 Name of Organization: St. Timothy Catholic Church

SECTION 2 Non-Profit/IRS Tax Exempt Number: 32-0267724

SECTION 3 The organization is a: (check one box only)

- ☒ Charitable (501.C) ☐ Fraternal (must have regular membership and have been in existence for over five (5) years)
☒ Religious ☐ Civic (Rotary, College Scholarship) ☐ Political Party, Ballot Measure or Campaign Committee

SECTION 4 Will this event be held on a currently licensed premise and within the already approved premises?

☐ Yes ☐ No

N/A

Name of Business

License Number

Phone (include Area Code)

SECTION 5 How is this special event going to conduct all dispensing, serving, and selling of spirituous liquors? Please read R-19-318 for explanation (look in special event planning guide) and check one of the following boxes.

- ☐ Place license in non-use
☐ Dispense and serve all spirituous liquors under retailer's license
☒ Dispense and serve all spirituous liquors under special event
☐ Split premise between special event and retail location

(If not using retail license, submit a letter of agreement from the agent/owner of the licensed premise to suspend the license during the event. If the special event is only using a portion of premise, agent/owner will need to suspend that portion of the premise.)

SECTION 6 What is the purpose of this event? ☒ On-site consumption ☐ Off-site (auction) ☐ Both Valentine Dinner/Dance

SECTION 7 Location of the Event: St. Timothy Catholic Church

Address of Location: 1730 W. Guadalupe Rd Mesa AZ 85202
Street City County/State Zip

SECTION 8 Will this be stacked with a wine festival/craft distiller festival? ☐ Yes ☒ No

SECTION 9 Applicant must be a member of the qualifying organization and authorized by an Officer, Director or Chairperson of the Organization named in Section 1. (Authorizing signature is required in Section 13.)

1. Applicant: Behnke Robert P. REDACTED
Last First Middle Date of Birth

2. Applicant's mailing address: 2558 W. Jacinto Cir Mesa AZ 85202
Street City State Zip

3. Applicant's home/cell phone: (REDACTED) Applicant's business phone: () None

4. Applicant's email address: boblinda.b@cox.net

1. Has the applicant been convicted of a felony, or had a liquor license revoked within the last five (5) years?
☐ Yes ☒ No (If yes, attach explanation.)

3. Is the organization using the services of a promoter or other person to manage the event? ☐ Yes ☒ No
(If yes, attach a copy of the agreement.)

Name St. Timothy Catholic Church Percentage 100%
Address 1730 W. Guadalupe Rd Mesa AZ 85202
Street City State Zip

"NO ALCOHOLIC BEVERAGES SHALL LEAVE SPECIAL EVENT UNLESS THEY ARE IN AUCTION SEALED CONTAINERS OR THE SPECIAL EVENT LICENSE IS STACKED WITH WINE /CRAFT DISTILLERY FESTIVAL LICENSE"

Explanation: Security control will begin with advanced ticket sales only to adults 21 years or older. We will have designated security personnel, and can add more if necessary

	Date	Day of Week	Event Start Time AM/PM	License End Time AM/PM
DAY 1:	Feb 14, 2015	Saturday	6:30 A.M	10:30 P.m
DAY 2:				
DAY 3:				
DAY 4:				
DAY 5:				
DAY 6:				
DAY 7:				
DAY 8:				
DAY 9:				
DAY 10:				

SECTION 12 License premises diagram. The licensed premises for your special event is the area in which you are authorized to sell, dispense or serve alcoholic beverages under the provisions of your license. The following space is to be used to prepare a diagram of your special event licensed premises. Please show dimensions, serving areas, fencing, barricades, or other control measures and security position.

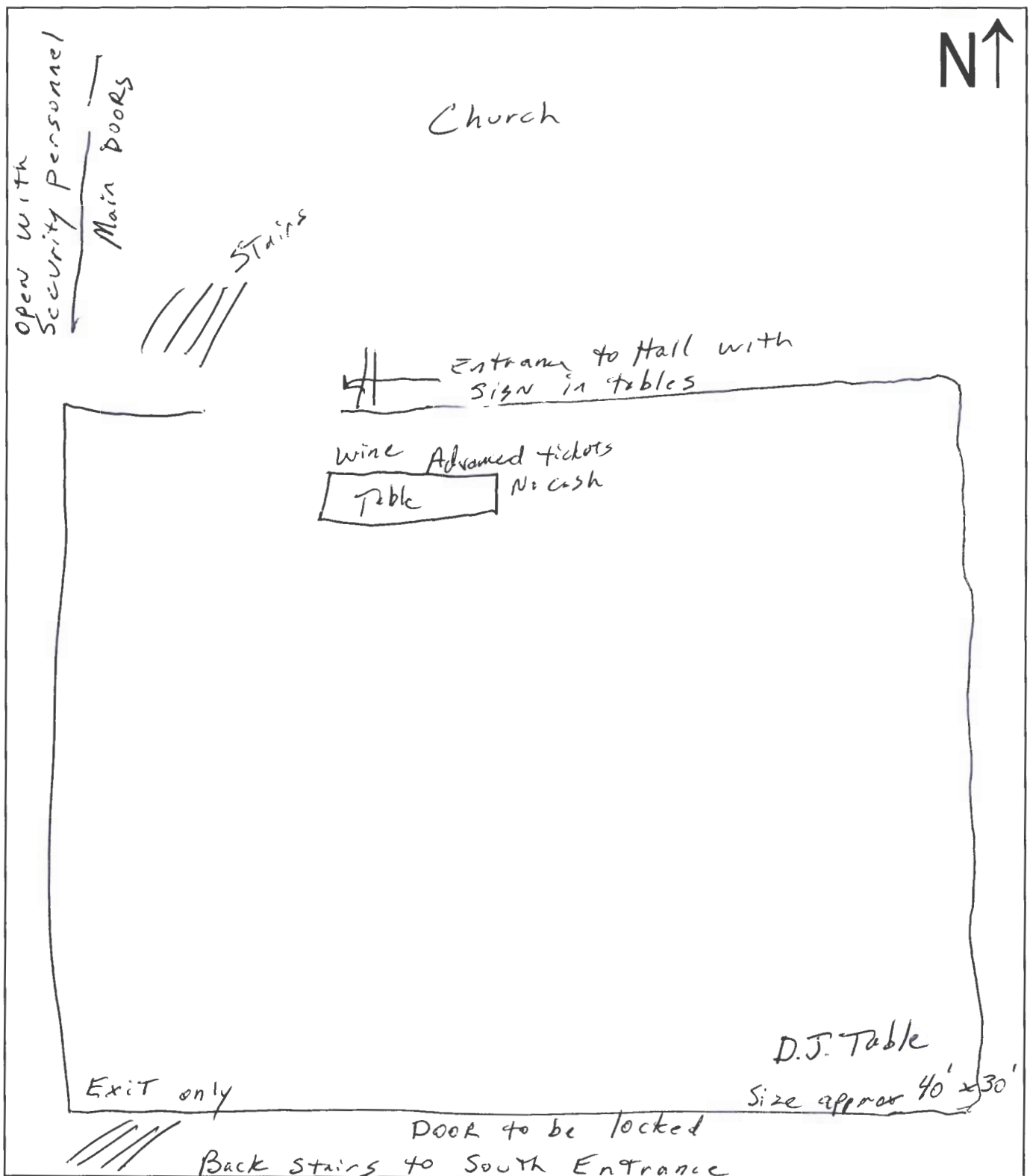

SECTION 13 This section is to be completed only by an Officer, Director or Chairperson of the organization named in Section 1.

I, FR CHARLES GORMIER declare that I am an OFFICER, DIRECTOR, or CHAIRPERSON
(Print full name)
appointing the applicant listed in Section 9, to apply on behalf of the foregoing organization for a Special Event
Liquor License.

x Fr Charles Gormier Pastor 12/30/14 REDACTED
(Signature) Title/ Position Date Phone #

The foregoing instrument was acknowledged before me this 30th December 2014
Day Month Year
State Arizona County of Maricopa

My Commission Expires on: 09/07/18
Date

Rose Marie Parsons
Signature of Notary Public
ROSE MARIE PARSONS
Notary Public - Arizona
Maricopa County
My Comm. Expires Sep 7, 2018

SECTION 14 This section is to be completed only by the applicant named in Section 9.

I, Robert P. Behnke declare that I am the APPLICANT filing this application as
(Print full name)
listed in Section 9. I have read the application and the contents and all statements are true, correct and
complete.

x Robert P. Behnke Married couple 12/30/14 REDACTED
(Signature) Ministry Head Date Phone #

The foregoing instrument was acknowledged before me this 30th December 2014
Day Month Year

State Arizona County of Maricopa

My Commission Expires on: 09/07/18
Date

Rose Marie Parsons
Signature of Notary Public
ROSE MARIE PARSONS
Notary Public - Arizona
Maricopa County
My Comm. Expires Sep 7, 2018

The local governing body may require additional applications to be completed and submitted. Please check with local government as to how far in advance they require these applications to be submitted. Additional licensing fees may also be required before approval may be granted. For more information, please contact your local jurisdiction: http://www.azliquor.gov/assets/documents/homepage_docs/spec_event_links.pdf.

SECTION 15 Local Governing Body Approval Section

I, _____ recommend ☐ APPROVAL ☐ DISAPPROVAL
(government official) (Title)

on behalf of _____
(City, Town, County) Signature Date Phone

FOR DEPARTMENT OF LIQUOR LICENSES AND CONTROL USE ONLY

☐ APPROVAL ☐ DISAPPROVAL BY: _____ DATE: _____

12/31/2014

Arizona Corporation Commission
State of Arizona Public Access System

10:10 AM

Jump To...

[Annual Reports](#) [Scanned Documents](#) [Microfilm](#)[E-FILE An Annual Report Online << Click Here](#)

FORMS For Annual Reports To Be Printed And Mailed

NEW

Subscribe to Annual Report Email Reminder

NEW

Corporate Inquiry

File Number: -1458892-0

[Check Corporate Status](#)

Corp. Name: ST. TIMOTHY ROMAN CATHOLIC PARISH MESA

Domestic Address

1730 W GUADALUPE RD

MESA, AZ 85202-7424

Statutory Agent Information

Agent Name: DENNIS M NAUGHTON

Agent Mailing/Physical Address:

400 E MONROE ST

PHOENIX, AZ 85004

Agent Status: APPOINTED 07/25/2012

Agent Last Updated: 09/12/2008

Additional Corporate Information

Corporation Type: NON-PROFIT

Business Type: RELIGIOUS

Incorporation Date: 07/01/2008

Corporate Life Period: PERPETUAL

Domicile: ARIZONA

County: MARICOPA

Approval Date: 07/15/2008

Original Publish Date: 09/08/2008

Officer Information

CHARLES GORAIEB

PRESIDENT

1730 W GUADALUP RD

MESA, AZ 85202

Date of Taking Office: 07/06/2011

Last Updated: 06/25/2014

BERTICA GARCIA DUBUS

SECRETARY

1629 W MANOR ST

CHANDLER, AZ 85224

Date of Taking Office: 12/01/2013

Last Updated: 06/25/2014

12/31/2014

Arizona Corporation Commission
State of Arizona Public Access System

10:10 AM

Corporate Status Inquiry**File Number: -1458892-0****Corp. Name: ST. TIMOTHY ROMAN CATHOLIC PARISH MESA****This Corporation is in Good Standing**

This information is provided as a courtesy and does not constitute legally binding information regarding the status of the entity listed above. To obtain an official Certificate indicating that the entity is in good standing click on Print Certificate and follow printing instructions. To re-print a previously generated Certificate of Good Standing click Reprint Certificate.

[Print Certificate](#)[Reprint Certificate](#)[Return to Corporate Inquiry](#)