

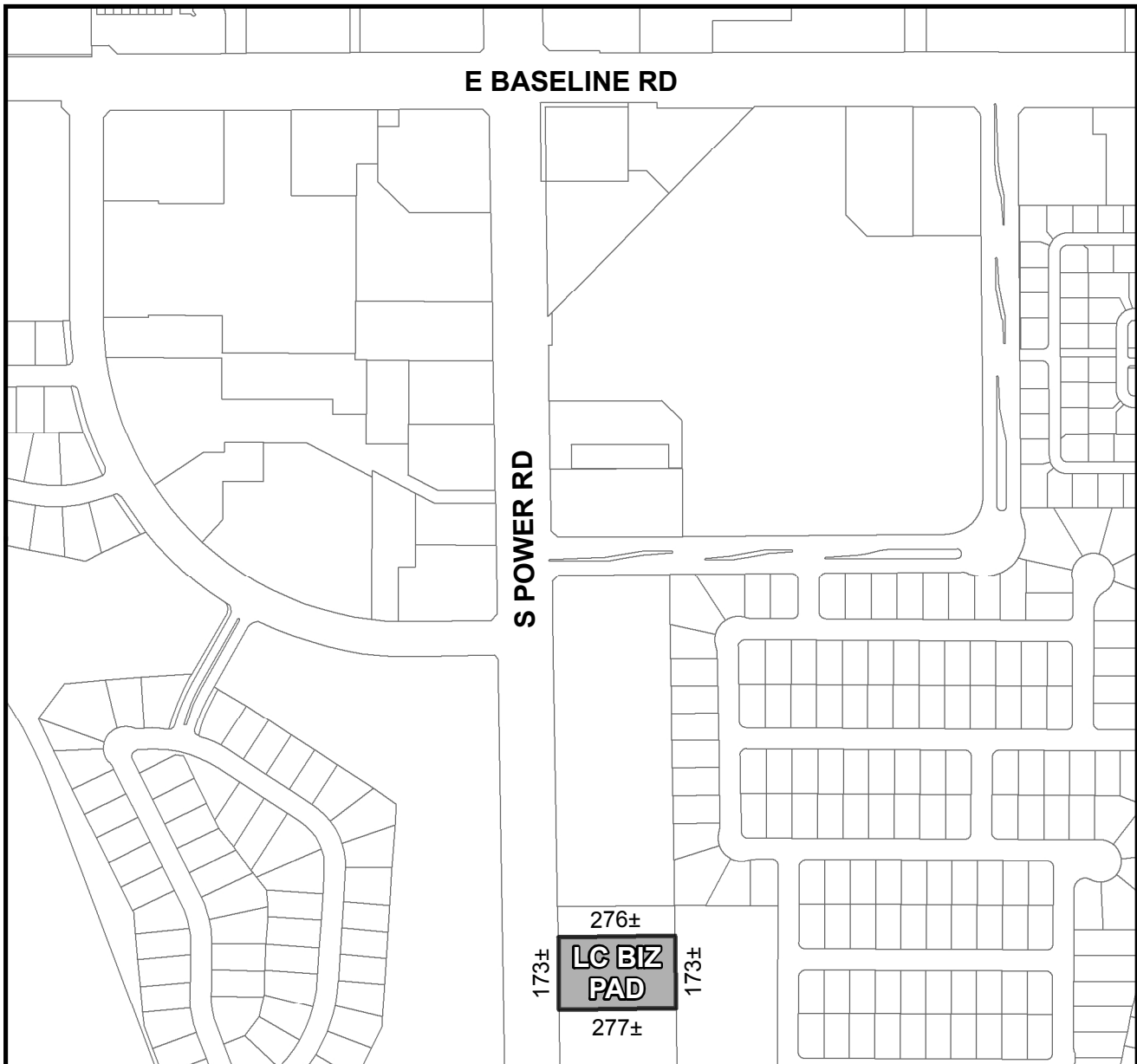

**OFFICIAL SUPPLEMENTARY ZONING MAP
AMENDING THE CITY OF MESA ZONING MAP**



CASE: Z14-058

ACREAGE: 1.1±

REQUEST: REZONE FROM LC PAD TO LC BIZ PAD AND SITE PLAN MODIFICATION. THIS REQUEST WILL ALLOW FOR THE EXPANSION OF A VETERINARY CLINIC.

ORDINANCE: _____

Please be advised that the attached zoning changes were approved by the Mesa City Council on _____, 2015 by Ordinance # _____. If you have any questions concerning these changes, contact the City of Mesa Planning Division at 480-644-2385.

ATTEST: _____ DATE: _____

MAYOR

CITY CLERK