

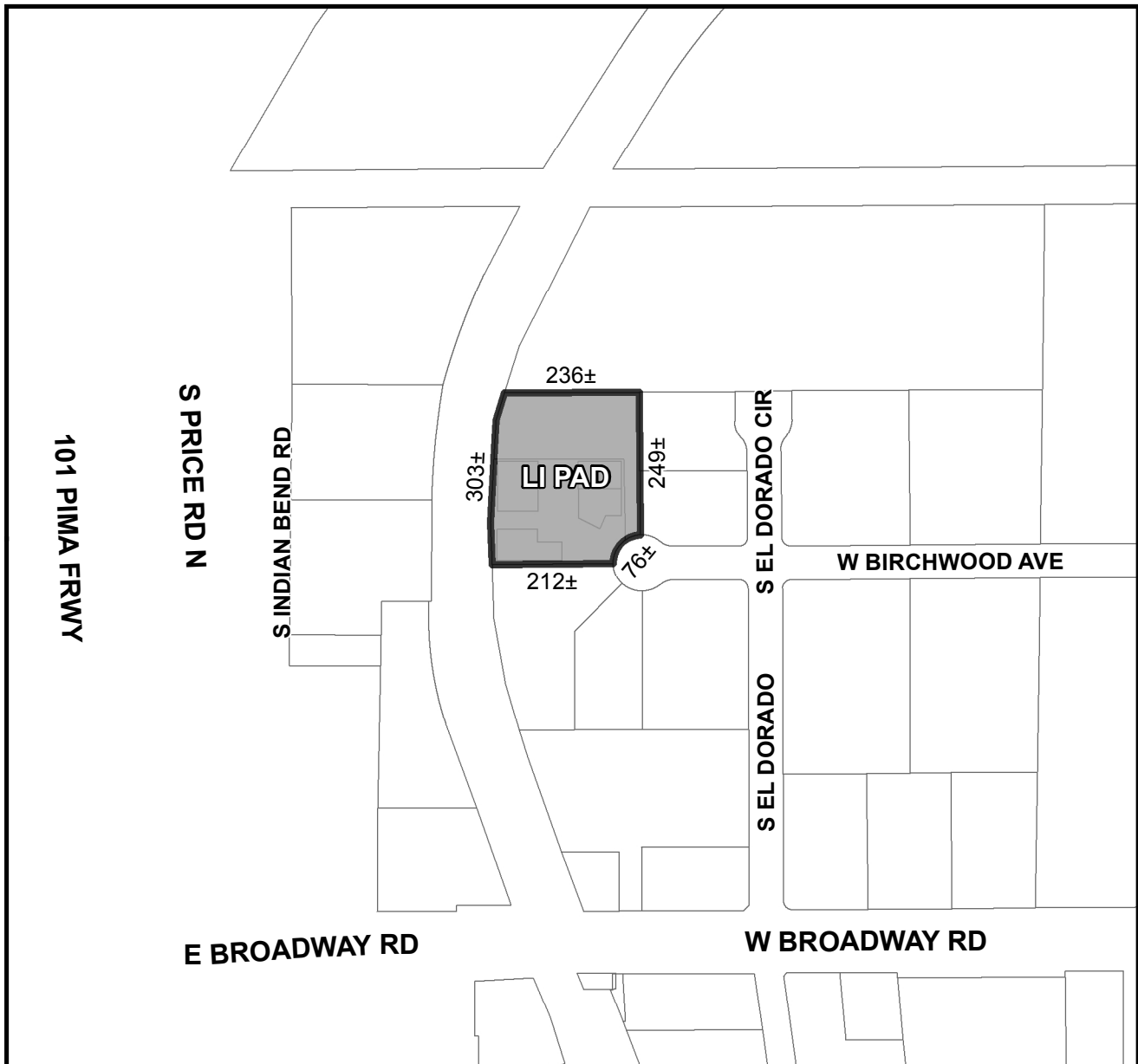

**OFFICIAL SUPPLEMENTARY ZONING MAP
AMENDING THE CITY OF MESA ZONING MAP**



CASE: Z14-052
ACREAGE: 1.7±
REQUEST: REZONE FROM LI AND LI PAD TO LI PAD AND MODIFICATION OF THE PAD OVERLAY. THIS REQUEST WILL ALLOW THE SUBDIVISION OF AN EXISTING BUSINESS PARK.
ORDINANCE: _____

Please be advised that the attached zoning changes were approved by the Mesa City Council on _____, 2015 by Ordinance # _____. If you have any questions concerning these changes, contact the City of Mesa Planning Division at 480-644-2385.

MAYOR

ATTEST: _____
CITY CLERK

DATE: _____