

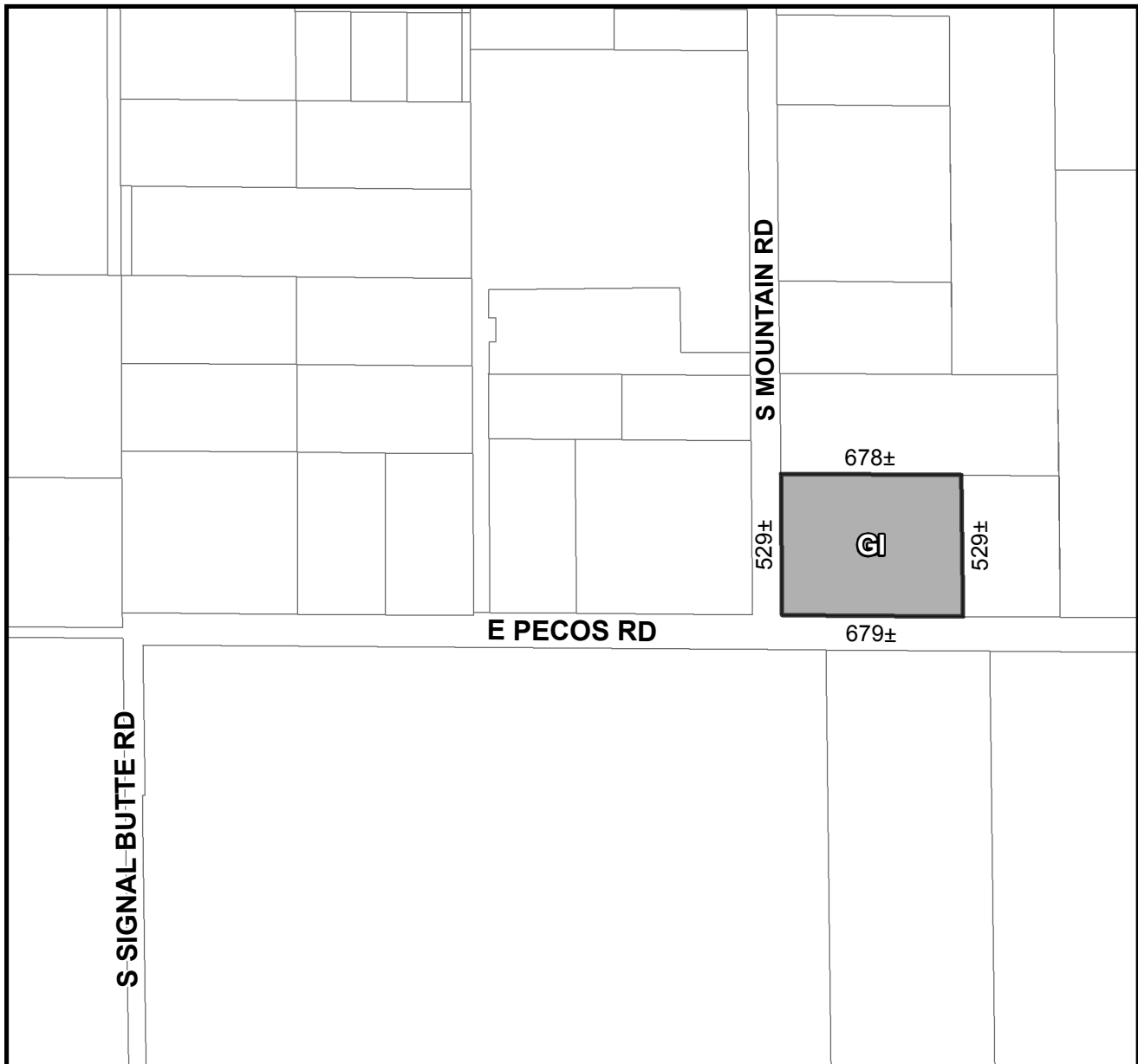

OFFICIAL SUPPLEMENTARY ZONING MAP AMENDING THE CITY OF MESA ZONING MAP



CASE: Z14-057

ACREAGE: 8.3±

REQUEST: REZONE FROM AG TO GI AND SITE PLAN REVIEW. THIS REQUEST WILL ALLOW FOR THE DEVELOPMENT OF AN INDUSTRIAL BUILDING.

ORDINANCE: _____

Please be advised that the attached zoning changes were approved by the Mesa City Council on _____, 2015 by Ordinance # _____. If you have any questions concerning these changes, contact the City of Mesa Planning Division at 480-644-2385.

ATTEST: _____ DATE: _____

MAYOR

CITY CLERK