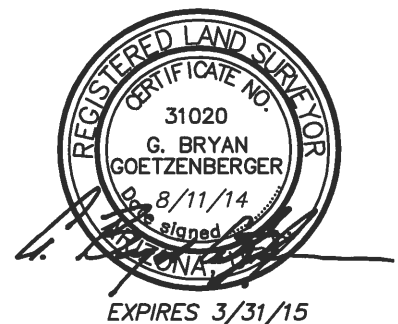

EXHIBIT A

The 3.00 foot Public Utility Easement over the East 3.00 feet of Lot 18, MESA COMMERCE CENTER, recorded in Book 292 of Maps, Page 21, records of Maricopa County, Arizona, being a portion of Section 10, Township 1 North, Range 6 East of the Gila and Salt River Base and Meridian, Maricopa County, Arizona. EXCEPT any portion lying within the North 8.00 feet of said Lot 18.



JOB NO.: 140613
SECTION: 10
TOWNSHIP: 1 NORTH
RANGE: 6 EAST
DATE: AUGUST 11, 2014
SHEET 1 OF 2



STATEWIDE SERVICE IN ARIZONA
www.alliancelandsurveying.com

7900 N. 70th AVENUE TEL (623) 972-2200
SUITE 104 FAX (623) 972-1616
GLENDALE, AZ 85303

EXHIBIT A

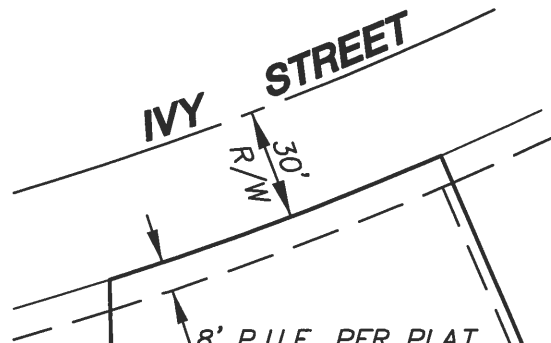

8' P.U.E. PER PLAT
BK. 292, PG. 21,
M.C.R.

3' P.U.E. PER PLAT
BK. 292, PG. 21, M.C.R.
(TO BE ABANDONED)

LEGEND

CENTERLINE
PROPERTY LINE
EASEMENT LINE
RIGHT-OF-WAY
PUBLIC UTILITY EASEMENT

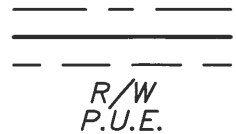

N.T.S.

LOT 17

LOT 18
PLAT BK. 292, PG. 21, M.C.R.

LOT 19



10.00'

TRACT 'B'

35'
R/W

MCLELLAN

ROAD

JOB NO.: 140613
SECTION: 10
TOWNSHIP: 1 NORTH
RANGE: 6 EAST
DATE: AUGUST 11, 2014
SHEET 2 OF 2



STATEWIDE SERVICE IN ARIZONA
www.alliancelandsurveying.com

7900 N. 70th AVENUE TEL (623) 972-2200
SUITE 104 FAX (623) 972-1616
GLENDALE, AZ 86303