

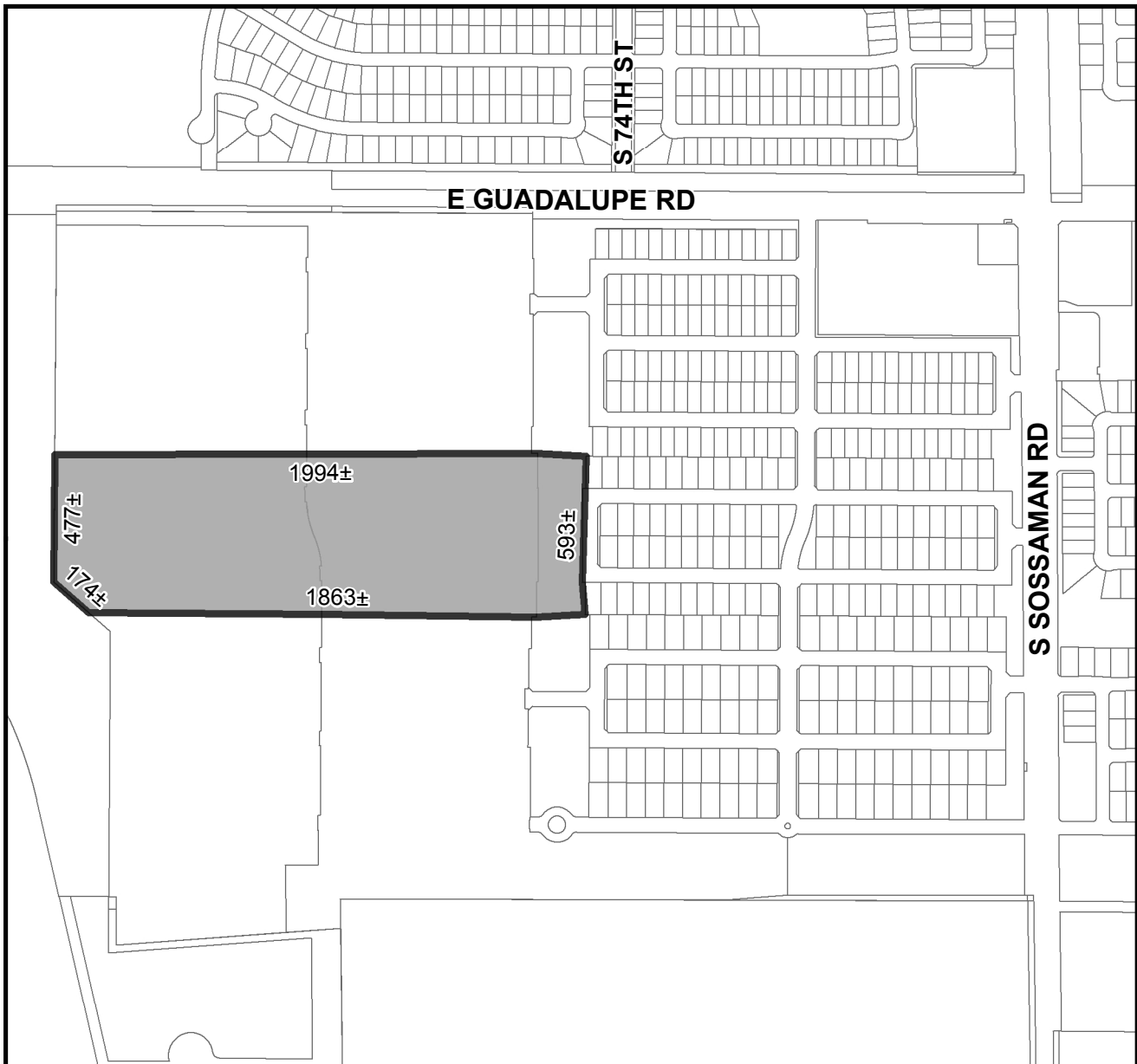

OFFICIAL SUPPLEMENTARY ZONING MAP AMENDING THE CITY OF MESA ZONING MAP



CASE: Z14-040
ACREAGE: 22.46±
REQUEST: MODIFICATION OF THE PAD FOR DESERT PLACE AT MORRISON RANCH PHASE 2, LOTS 87-133 AND PHASE 3, LOTS 93-142 IN THE RS-7-PAD-PAD ZONING DISTRICT TO ALLOW RESIDENTIAL LOT COVERAGE INCREASE FROM 45% TO 50%
ORDINANCE: _____

Please be advised that the attached zoning changes were approved by the Mesa City Council on _____, 2014 by Ordinance # _____. If you have any questions concerning these changes, contact the City of Mesa Planning Division at 480-644-2385.

MAYOR

ATTEST: _____ DATE: _____

CITY CLERK